

Sprint PCSSM

RESHMA (PH54XC138A)
10421 E. MCDOWELL MTN. RANCH RD.
SCOTTSDALE, AZ.
MARICOPA COUNTY

POLICE: N/A
FIRE: N/A
WATER: N/A
SEWER: N/A
ELECTRIC: APS
TELEPHONE: QWEST

THE PROJECT CONSISTS OF THE INSTALLATION AND OPERATION OF ANTENNAS AND ASSOCIATED EQUIPMENT CABINET FOR SPRINT SPECTRUM'S PERSONAL COMMUNICATION SERVICES (PCS) WIRELESS TELECOMMUNICATIONS NETWORK. (3) PANEL ANTENNAS MOUNTED ON TOP ELEVATOR SHAFT AND 1 RADIO CABINET LOCATED IN AN EXISTING ROOM ON THE SECOND FLOOR.

PROJECT DESCRIPTION

ALL WORK AND MATERIALS SHALL BE PERFORMED AND INSTALLED IN ACCORDANCE WITH THE CURRENT EDITIONS OF THE FOLLOWING CODES AS ADOPTED BY THE LOCAL GOVERNING AUTHORITIES. NOTHING IN THESE PLANS IS TO BE CONSTRUED TO PERMIT WORK NOT CONFORMING TO THESE CODES.

ADA COMPLIANCE - UNMANNED
UNIFORM BUILDING CODE 1997 W/ JURISDICTION AMMENDMENTS
NEC 1996

CODE COMPLIANCE

| SHEET | DESCRIPTION | REV. |
|-------|------------------------------------|------|
| T1 | TITLE SHEET | 1 |
| LS1 | TOPOGRAPHICAL SITE SURVEY | 2 |
| Z1 | OVERALL SITE PLAN | 1 |
| Z2 | PARTIAL SECOND FLOOR AND ROOF PLAN | 1 |
| Z3 | ELEVATIONS | 1 |

SHEET INDEX

ZONING

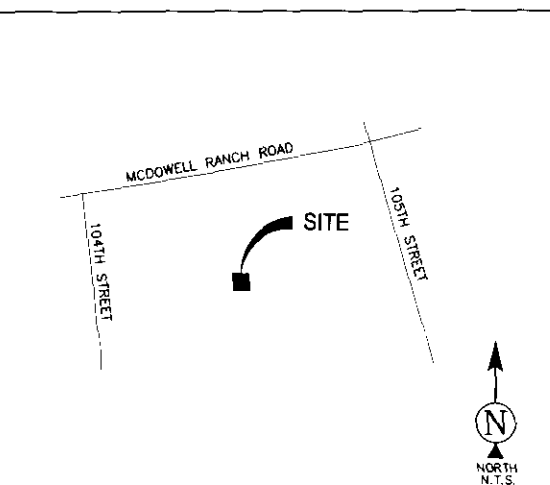

VICINITY MAP

START GOING N. ON S. CENTRAL AVE. TURN RIGHT ONTO E. MARICOPA FRWY. TAKE I-17 S TO I-10 W. TAKE AZ-51 N. TAKE THE GREENWAY RD. EXIT (STAY TO THE RIGHT). TURN LEFT ONTO SCOTTSDALE RD. TURN RIGHT ONTO N. GREENWAY HAYDEN LOOP. TURN RIGHT ONTO E. FRANK LLOYD WRIGHT BLVD. TURN LEFT ONTO N. THOMPSON PEAK PKWY. TURN RIGHT ONTO E. MCDOWELL MOUNTAIN RANCH RD.

DRIVING DIRECTIONS

APPLICANT/LESSEE
SPRINT PCS
4683 CHABOT DRIVE, SUITE 100
PLEASANTON, CA 94588
IMPLEMENTATION ENGINEER: JEFF LEBER

TOWER OWNER
N/A

PROPERTY OWNER
OWNER: 105 STREET & MCDOWELL LLC
CONTACT: LUIGI TALARICO
PHONE: (602) 991-3660

OCCUPANCY TYPE: UN-MANNED
CONSTRUCTION TYPE: 2-N
CURRENT ZONING: C-2 ESL
APN: 217-17-001-H
LEASE AREA: 449 SQ. FT.
PARENT PARCEL OVERALL SITE AREA: 594,272.63 SQ. FT.
PERCENTAGE: .08%
HANDICAP REQUIREMENTS: FACILITY IS UNMANNED AND NOT FOR HUMAN HABITATION. HANDICAPPED ACCESS NOT REQUIRED.

PROJECT SUMMARY

CIVIL ENGINEER:
MACTEC ENGINEERING AND CONSULTING, INC.
3630 E. WIER AVE.
PHOENIX, AZ 85040
CONTACT: BERNARD VALDEZ
PHONE: (602) 437-0250 FAX: (602) 437-3675

SURVEYOR:
CALVADA SURVEYING, INC.
7755 E. GRAY RD. #101
SCOTTSDALE, AZ 85260
CONTACT: DWAYNE L. HAUGHT
PHONE: (480) 596-6514 FAX: (480) 596-2674

PROJECT TEAM

DO NOT SCALE DRAWINGS

CONTRACTOR SHALL VERIFY ALL PLANS AND EXISTING DIMENSIONS AND CONDITIONS ON THE JOB SITE AND SHALL IMMEDIATELY NOTIFY THE ARCHITECT IN WRITING OF ANY DISCREPANCIES BEFORE PROCEEDING WITH THE WORK OR BE RESPONSIBLE FOR SAME.

GENERAL CONTRACTOR NOTES



PROJECT INFORMATION:

RESHMA
PH54XC138A
10405 E. MCDOWELL MOUNTAIN RANCH RD.
BUILDING 8
SCOTTSDALE, AZ 85265

CURRENT ISSUE DATE:

3/19/03

ISSUED FOR:

ZONING

REV. DATE DESCRIPTION BY

| | | | |
|-----|--|--|--|
| 1 | | | |
| 2 | | | |
| 3 | | | |
| 4 | | | |
| 5 | | | |
| 6 | | | |
| 7 | | | |
| 8 | | | |
| 9 | | | |
| 10 | | | |
| 11 | | | |
| 12 | | | |
| 13 | | | |
| 14 | | | |
| 15 | | | |
| 16 | | | |
| 17 | | | |
| 18 | | | |
| 19 | | | |
| 20 | | | |
| 21 | | | |
| 22 | | | |
| 23 | | | |
| 24 | | | |
| 25 | | | |
| 26 | | | |
| 27 | | | |
| 28 | | | |
| 29 | | | |
| 30 | | | |
| 31 | | | |
| 32 | | | |
| 33 | | | |
| 34 | | | |
| 35 | | | |
| 36 | | | |
| 37 | | | |
| 38 | | | |
| 39 | | | |
| 40 | | | |
| 41 | | | |
| 42 | | | |
| 43 | | | |
| 44 | | | |
| 45 | | | |
| 46 | | | |
| 47 | | | |
| 48 | | | |
| 49 | | | |
| 50 | | | |
| 51 | | | |
| 52 | | | |
| 53 | | | |
| 54 | | | |
| 55 | | | |
| 56 | | | |
| 57 | | | |
| 58 | | | |
| 59 | | | |
| 60 | | | |
| 61 | | | |
| 62 | | | |
| 63 | | | |
| 64 | | | |
| 65 | | | |
| 66 | | | |
| 67 | | | |
| 68 | | | |
| 69 | | | |
| 70 | | | |
| 71 | | | |
| 72 | | | |
| 73 | | | |
| 74 | | | |
| 75 | | | |
| 76 | | | |
| 77 | | | |
| 78 | | | |
| 79 | | | |
| 80 | | | |
| 81 | | | |
| 82 | | | |
| 83 | | | |
| 84 | | | |
| 85 | | | |
| 86 | | | |
| 87 | | | |
| 88 | | | |
| 89 | | | |
| 90 | | | |
| 91 | | | |
| 92 | | | |
| 93 | | | |
| 94 | | | |
| 95 | | | |
| 96 | | | |
| 97 | | | |
| 98 | | | |
| 99 | | | |
| 100 | | | |

CONSULTANT

MACTEC
MACTEC ENGINEERING AND CONSULTING
OF GEORGIA, INC.
3630 E. WIER AVE., PHOENIX, ARIZONA 85040
PHONE: (602) 437-0250
FAX: (602) 437-3675

DESIGN NOTE

DRAWN BY: _____ CHK.: _____ APV.: _____
DAVE KLANN B.V.V.

LICENSURE

APPROVED

3/21/03

DATE

91-SA-03

INITIALS

SHEET TITLE:

TITLE SHEET

SHEET NUMBER: _____ REVISION: _____

T1 1

70225-2-0020 138A

Plans

Details