

Revision

8/7/00
CITY COMM

Date:
5/22/2000

© COPYRIGHT

THE SUMMIT

NELSEN ARCHITECTS, INC.
SCOTTSDALE, ARIZONA

Shee
ALI
Project
9902

Bronzelite

GMA6000

ORDERING GUIDE

GMA6000 Model	250 Wattage	MH Source	SP Optics	120 Voltage	DO Accessories
75-300	75-300	INC	SP	120	DSA
50-250	50-250	INC	FL	208	DSB
50-250	50-250	MV	FL	208	RCA
50-250	50-250	MH	H	240	RGB
28-42	28-42	HPS	H	277	DL
		F	SR	220-50HZ	DL
			FR	240-50HZ	DL

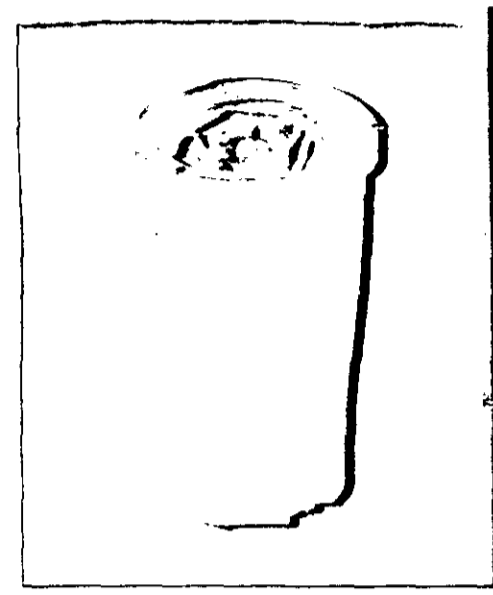

- For 70 and 150 Watt HQID horizontal lamps asymmetric and bisymmetric distributors are available. Specify HA or HB.
- Not suitable for use with rock guards.
- Optional. Concrete can be poured directly around fixture.

PHOTOMETRICS

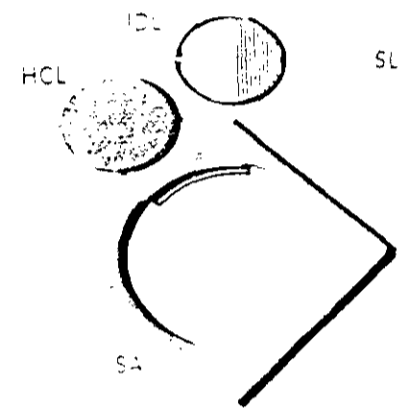
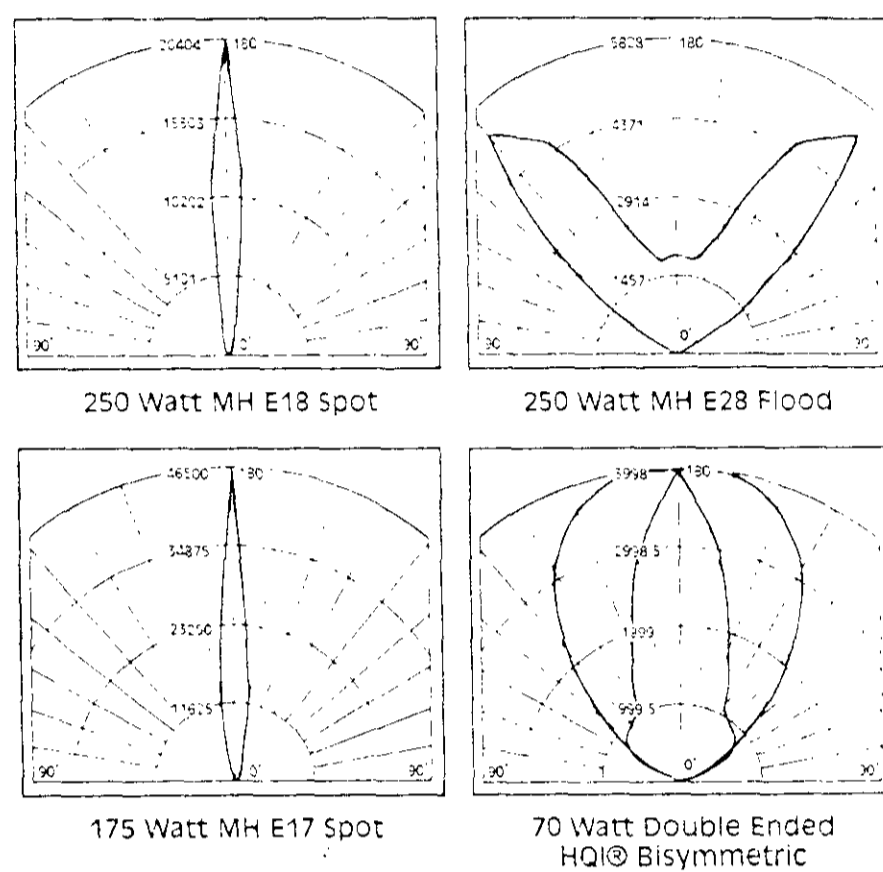

INGROUND

GMA6000

SPECIFICATIONS

FIXTURE AND HOUSING JUNCTION BOX
Housing and integral junction box are constructed of high temperature, resistant composite material. All 120V and 208V units are provided with provisions for a field-wired 50 amp three phase power source. Junction box is provided. Field-wired junction box will vary.

LENS AND GASKETING
All external lenses and clear high-impact tempered glass with 1/8" thick gaskets. External lenses are standard flat, and bearing drive over 3/16" convex internal seal of gaskets for leak and high-impact tempered glass with 1/8" thick gaskets. Junction box gasket is flat.

BALLAST MODULE
Standard high power factor ballast and ballast is totally encapsulated in waterproof heat dissipating composite resin. Ballast is gasketed with high temperature power cords and approved quick connectors. Standard voltage 120V. Other voltages available include 208, 240, 277, 220-50Hz and 240-50Hz. Specify.

FASTENERS
Fasteners are stainless steel or bronze.

LAMP MODULE
Lamp housing and lens ring are constructed of high temperature, resistant composite. Lamp module is gasketed with O-ring and stainless steel quick connector. Lens and junction box aluminum bodies require no fasteners for quick change.

CUTOFF SWITCH
A three pole cutoff switch automatically disconnects or main power to the ballast after the ballast module is removed for reaming.

SOCKETS
A. Sockets are high temperature gasketed design with the exception of sockets for fluorescent lamps which are high temperature plastic.

LAMPS
All lamps are provided, installed in show arrangement. Refer to ordering guide for specific lamp types. 75-300 Watt (Incandescent), 50-250 Watt (Mercury Vapor), 50-250 Watt (Metal Halide), 50-250 Watt (High Pressure Sodium), 28-42 Watt (Fluorescent).

AIMING
All lenses are provided, installed in show arrangement. Refer to ordering guide for specific lamp types. 75-300 Watt (Incandescent), 50-250 Watt (Mercury Vapor), 50-250 Watt (Metal Halide), 50-250 Watt (High Pressure Sodium), 28-42 Watt (Fluorescent).

DRAINAGE
No gravel bed or leaks. Make drainage required.

UL LISTED
CUL LISTED

LAMPING GUIDE

Lamp Wattage	28	42	50	70	100	150	175	250	300
Incandescent									
Mercury Vapor									
Metal Halide									
HPS									
Fluorescent									

FIXTURE TYPE SJ (2 of 2)

Photometric Report (Type C)

File Name: 2286.dwg
 Date: 8/22/00
 User: J. MELARA
 Project: 9902
 Location: 11574
 Maximum Candela = 23 399999135300 at 15.0 15.0

Classification:
 Road Classification: Type III, Very Short, Cutoff
 Street Classification: Street

Polar Candela Curves:
 Vertical Plane Through
 15.0 15.0 Horizontal

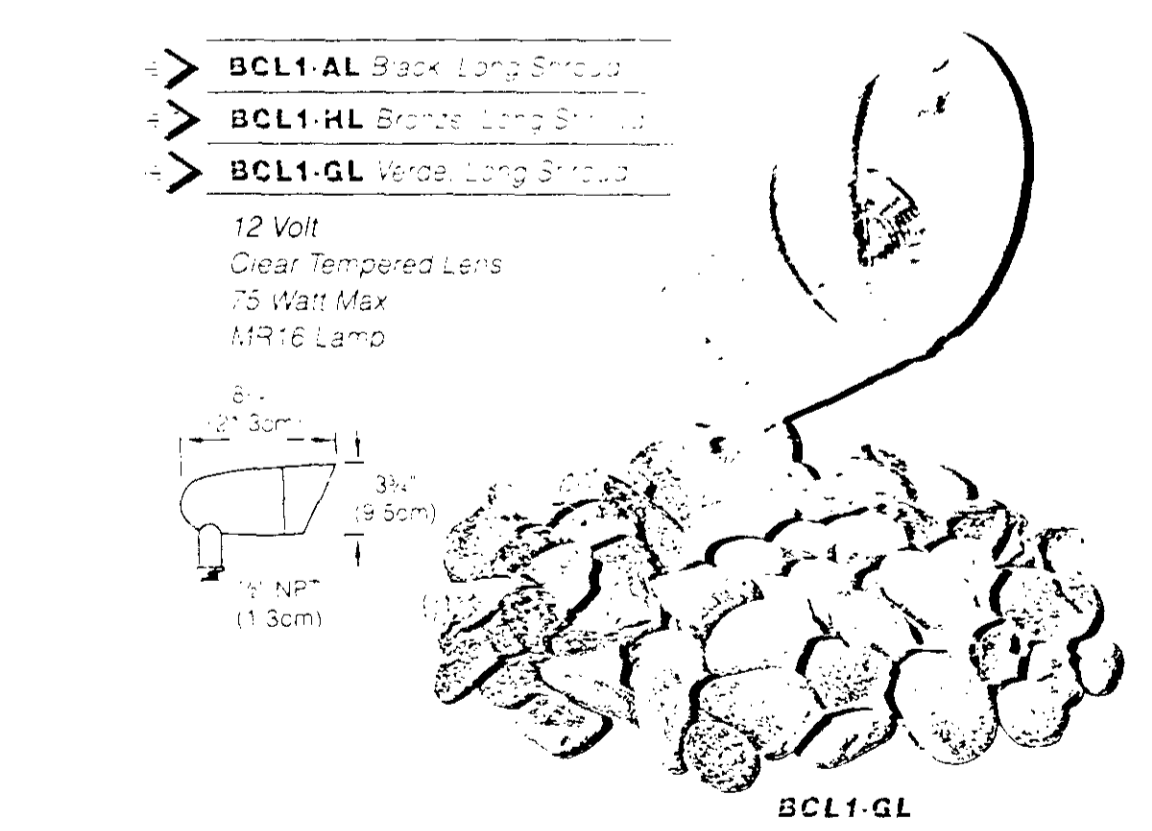
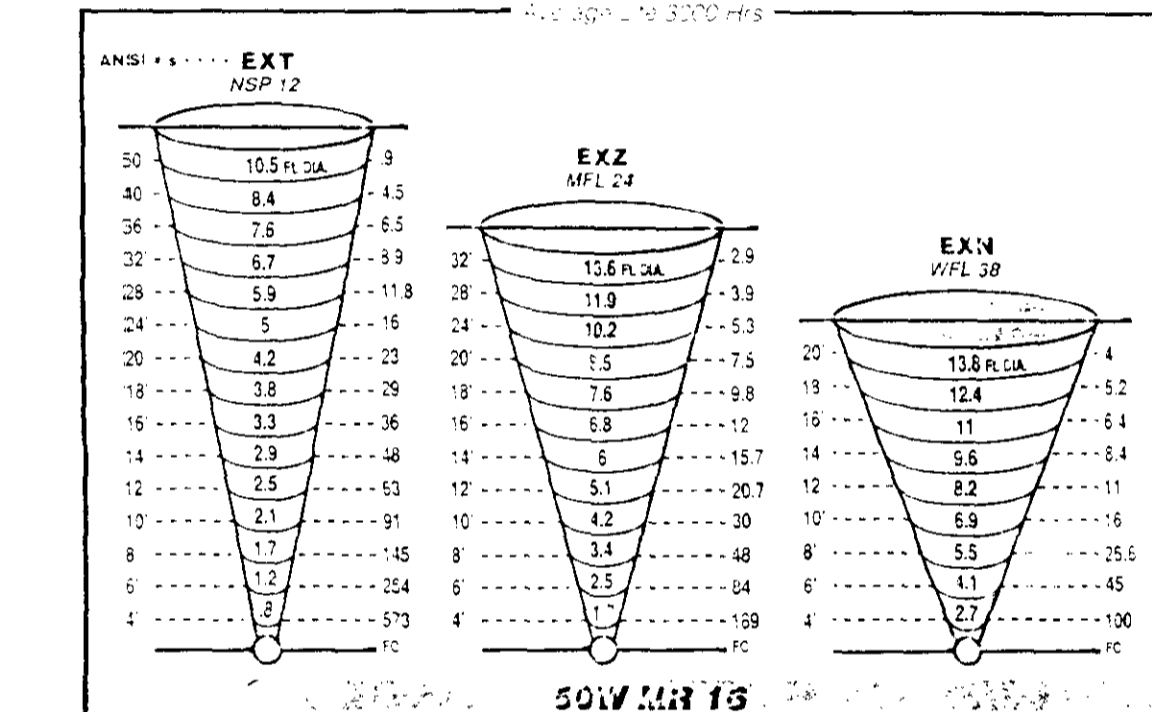
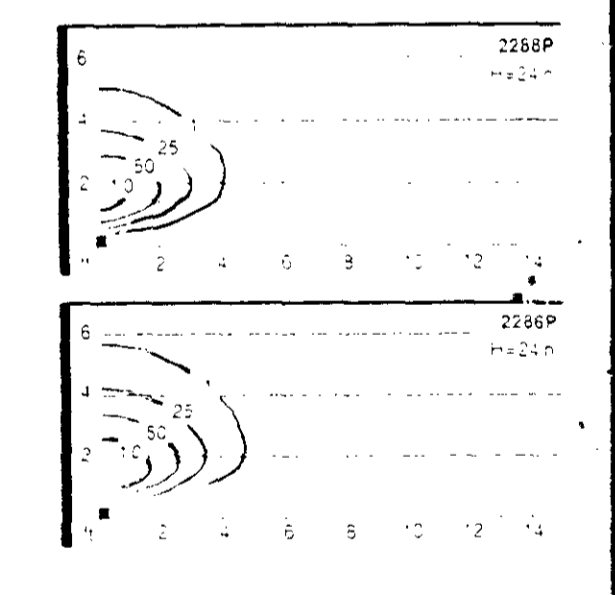
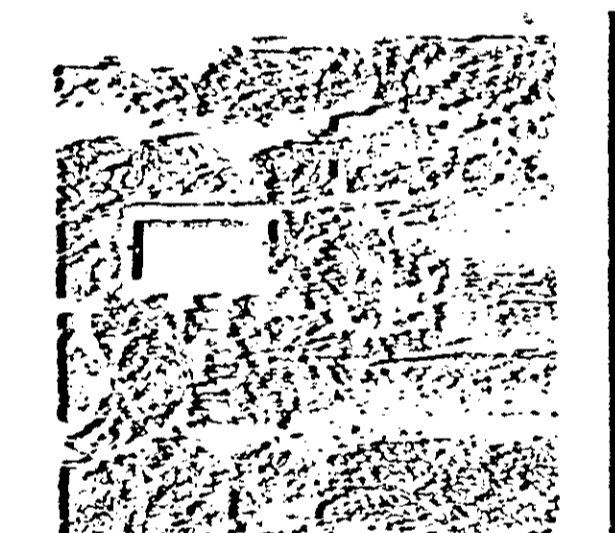
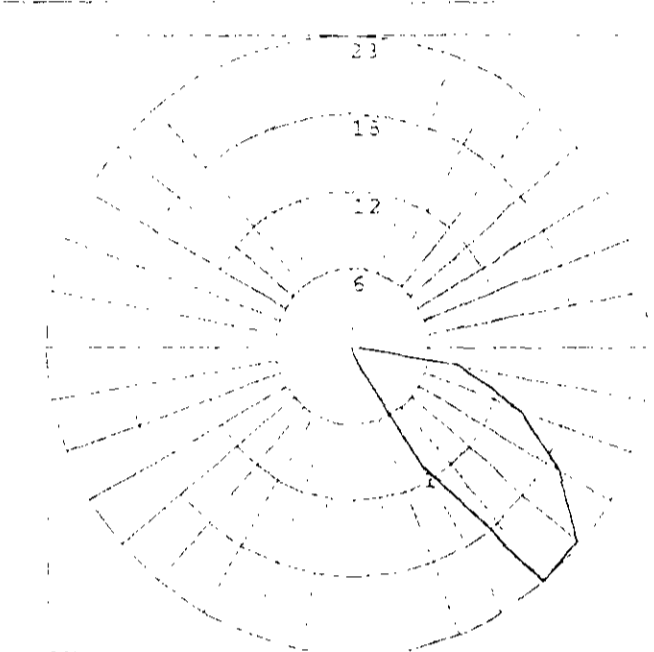

118-02-99
 APPROVED
 Cindy Kelly 10/6/2000
 5092-998

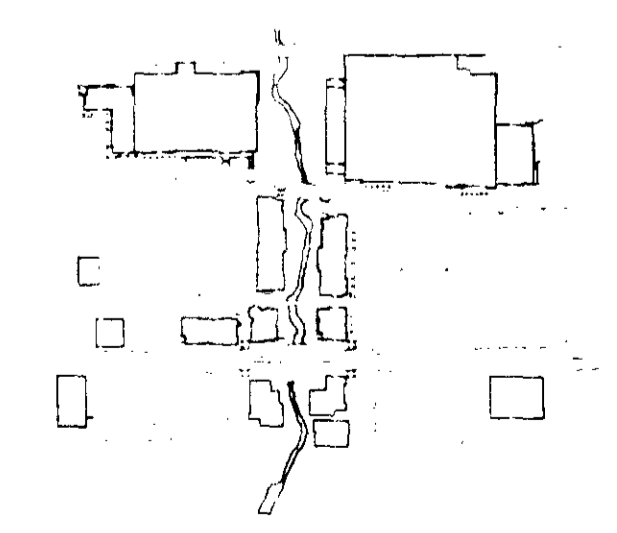

KEY PLAN

OUTDOOR FIXTURE CUT SHEET DATA

03 FIXTURE - SK

02 FIXTURE - SJ

01 FIXTURE - SE

712 HO VHO Fluorescent Outdoor Photometrics

Style: F151
 Reflector: Small umbrella, horizontal 40" long, clear acrylic lens, reflector housing is adjustable.
 Test No.: H-00078 or previous testing, applicable.
 Test Lamp: 20W T5, 120V, 10000 hours, 2900 lumens.
 Ballast: Energy Saver, LS-15 29-123.
 File Name: 4/20/03
 Multipliers for Other Lamps: 55W (F55T5HO) 5.70 lumens, 72

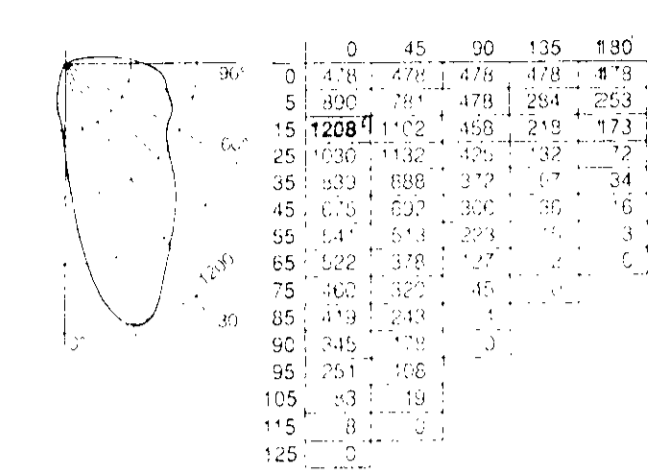

elliptipar

To Order

To form a Catalog Number
 F 1 5 1 T 1 2 3 4 5 6 7 8

1 Source
 F = Linear Fluorescent

2 Style
 151 = Small, outdoor, remote ballast

3 Lamp
 T = Lamp Code
 Lamp Voltage (see chart below)
 Reflector Configuration (see chart below)

4 Mounting
 H = Mounting Hub
 00 = No option
 01 = Remotes only, no ballast for dry, indoor location
 02 = Remotes only, no ballast for dry, outdoor location
 03 = Remotes only, no ballast, requires detailed description of mounting prior to specification

5 Finish
 02 = Semi-gloss white
 06 = Dark bronze
 07 = Green
 Note: No painting on reflector back

6 Voltage Ballast
 1 = 120V
 2 = 277V
 3 = 347V
 Note: Voltage representative, manufacturer of ballast and ballast type.

7 Option
 00 = No option
 01 = Remotes only, no ballast for dry, indoor location
 02 = Remotes only, no ballast for dry, outdoor location
 03 = Remotes only, no ballast, requires detailed description of mounting prior to specification

8 Standard
 0 = CSA, Canadian Standard, Multi-Canada
 1 = UL, Underwriters Laboratories

Example
F151 - T128 - H - 08 - 1 - 000

Lamp Voltage	Lamp Length	Lamp Diameter
120	120	1/2"
277	120	1/2"
277	180	1/2"
277	240	1/2"
277	300	1/2"
347	120	1/2"
347	180	1/2"
347	240	1/2"
347	300	1/2"

elliptipar

Uplighting, small outdoor, remote, clear acrylic lens, elliptical

Style 151

Cantilever / Pendant

Surface / Cove

Specifications

Finish

Mounting

Electrical

Performance

Options

Performance

Options

Performance

Options

Performance

Options

Performance

Options

Performance

Options

Performance

Style 151

Mounting Hubs

HOA00000

HOB00000

AFK0000

HOA00000

HOB00000

AFK0000

HOA00000

HOB00000

AFK0000

HOA00000

HOB00000

AFK0000

HOA00000

HOB00000

AFK0000

HOA00000

HOB00000

AFK0000

HOA00000

HOB00000

AFK0000

HOA00000

HOB00000

AFK0000

HOA00000

HOB00000

AFK0000

HOA00000

HOB00000

AFK0000

HOA00000

HOB00000

AFK0000

FIXTURE TYPE SN

KIRLIN

RECESSED ROUND, 75 WATT (MAX.) PAR 16, 20 and 30 TUNGSTEN-HALOGEN DOWNLIGHTS

Mini-PAR Sparkling Halogen Downlights in 4" Apertures

Features

Performance of a Glance

Options

Performance

Options

Performance

Options

Performance

Options

Performance

Options

Performance

Options

Performance

Options

Performance

Options

Performance

Options

118-D2-99
 Cindy Bally 10/3/2000
 5092-99C

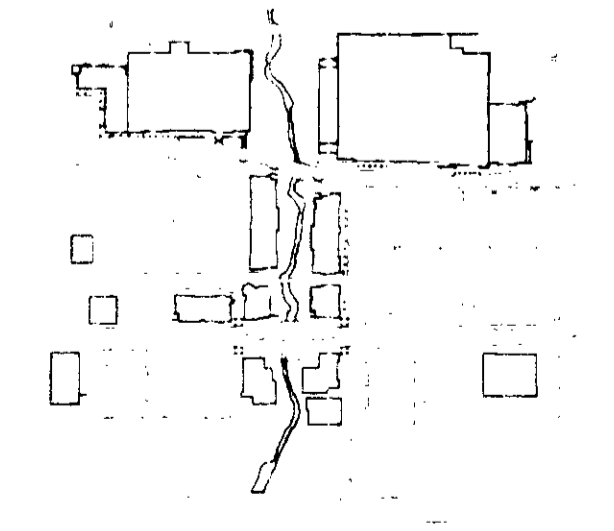

KEY PLAN

OUTDOOR FIXTURE CUT SHEET DATA

