

**LANDSCAPE CHARACTER**

The Summit at Scottsdale will provide a natural desert landscape of through the vegetation and preservation of the existing landscape providing other enhanced landscape areas. Enhanced landscaping will include areas within the streets right-of-way and adjacent to the buildings. The plant materials proposed for Scottsdale are indigenous to the area supplemented with additional selected plants. All plantings will conform to the Approved Plant List of the City of Scottsdale. Undisturbed desert areas including desert washes and designated by will be preserved in their existing condition. The undisturbed areas enhanced during the development of the Project. Where disturbance has occurred as a result of construction activity, the areas of disturbance will be revegetated using only plant materials native to the area. A habitat area will be provided along the edge of the central scenic wash. Approved Plant List. The plants on the following list are in conformance with the City of Scottsdale Approved Plant List and have been found to be compatible with the desert environment existing at the site.

**PLANT LEGEND**

**TREES**

PROSOPIA VELUTINA	24"
NATIVE MESQUITE	36"
ACACIA SMALL	36"
SAGE ACACIA	36"
CERCIDIUM PRAECOX	36"
PALO BREA	36"
SALVAGE TREE	FRQ
EXISTING TREE TO REMAIN	

**SHRUBS**

BAILEYA MULTIRADIATA	1' G
DESERT MARIGOLD	5' C
CALLIANDRA CALIFORNICA	5' C
BAJA FAIRY DUSTER	5' C
JUSTICIA CALIFORNICA	5' C
CHUPAROSA	5' C
EUPHORBIA BICOLORANULOSA	5' C
TRAILING EUPHORBIA	5' C
SALVIA OLEVANDI	5' C
CHAPARRAL SAGE	1' G
SALVIA COCCINEA	1' G
CHERRY BUD SAGE	1' G
SALVIA FARINACEA	5' C
MEALY-CUP SAGE	5' C
SALVIA GREGGII	1' G
RUTILEAN SAGE	1' G
SALVIA LEUCANTH	1' G
MEXICAN BUSH SAGE	1' G

**ACCENTS**

AGAVE COLORATA	5' C
MESCAL SENEA	5' C
AGAVE DESMONTIANA	5' C
GREEN AGAVE	5' C
DASYLIRION WHEELER	5' C
DESERT SPOON	5' C
ECHINOCACTUS GRISONII	5' C
GOLDEN BARREL CACTUS	5' C
DOTILLO	6-8'
SAGUARO	6' S
AGAVE ELATA	5' C
SOAP TREE YUCCA	5' C
AGAVE AMERICANA	5' C
CENTURY PLANT	5' C

**GROUND COVERS**

GRACONATHERA BERLANDERI	5' C
MEXICAN PRIMEROSE	5' C

**LANDSCAPE MATERIALS**

DECOMPOSED GRANITE "DESERT GOLD"	3" DE
3/8" SIZES THRU ALL NON-REVEGETATED AREAS	
SURFACE SELECT GRANITE BOULDERS, COLOR TO MATCH DECOMPOSED GRANITE ABOVE	3"-5"

**TABLE 2 - LIST OF HYDRO-SEED MATERIALS AND SIZES FOR MITIGATION**

SPECIES	SCIENTIFIC NAME	LIBS./
FRANGLE-LEAF	AMBROSIA DELTOIDEA	3'
ELM SAGE	ELM SAGE	3'
DESERT MARIGOLD	BAILEYA MULTIRADIATA	1' C
DESERT SENEA	CASSIA SP.	1' C
SWAMPWORT	QUICKWORT	3' S
CREOSOTE	LARREA TRIDENTATA	1' C

\* NOTE: INFORMATION PROVIDED BY SWCA INC.

design review  
alanis  
thompson

**THE SUMMIT AT SCOTTSDALE**  
Scottsdale Road and Ashler Hills Road  
Scottsdale, Arizona  
Nelsen Architects, Inc.

**e group**  
landscape architecture / environmental  
817 North Central Avenue, Phoenix, Arizona 85004  
e group # 99160  
11.22.99

**CONCEPTUAL LANDSCAPE**

NORTH 0 20' 40' 80'

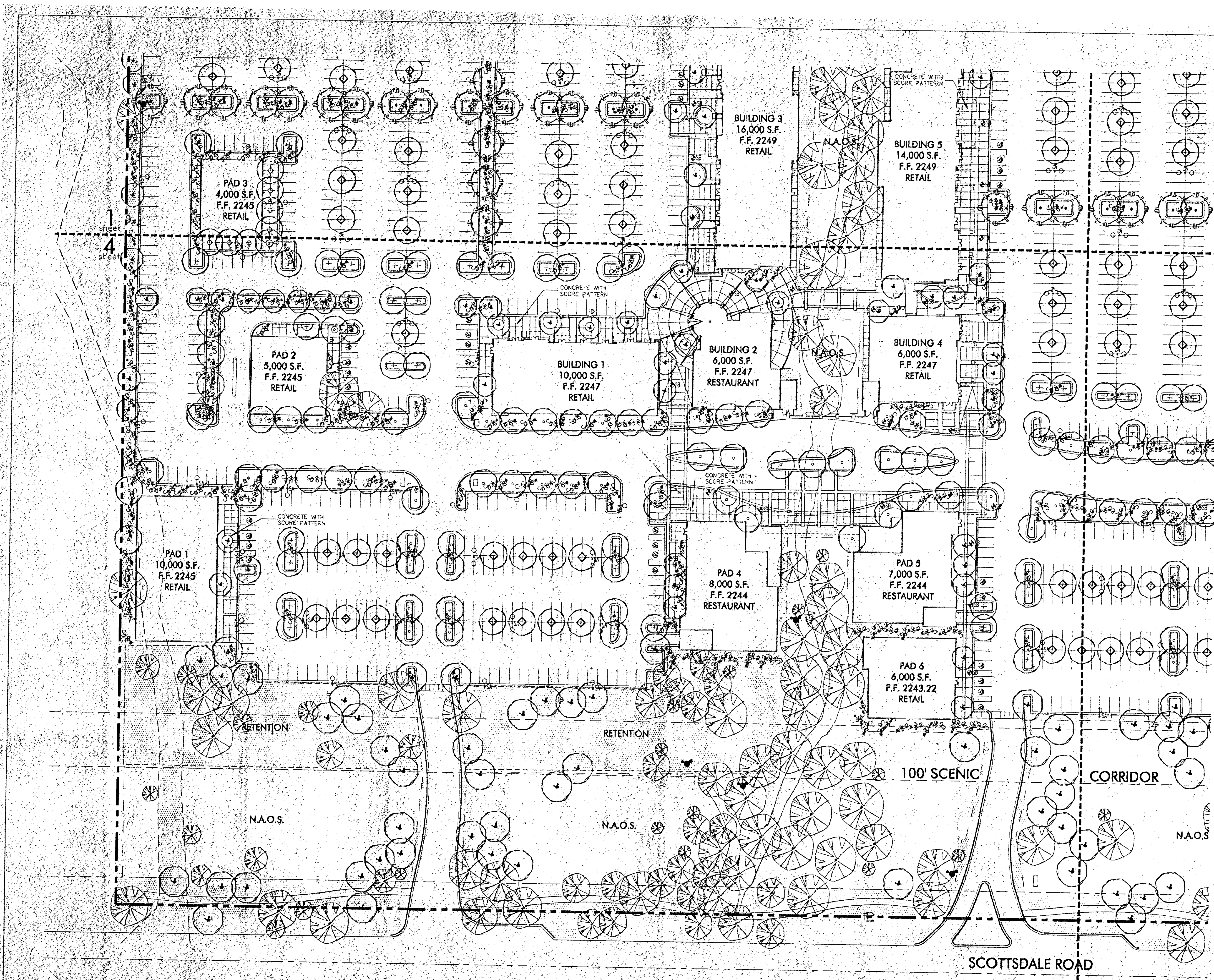

**LANDSCAPE CHARACTER**

The Summit at Scottsdale will provide a natural desert landscape character through the revegetation and preservation of the existing landscape and by providing other enhanced landscape areas. Enhanced landscaping will include areas within the streets right-of-way, parking areas and important activity nodes. The plant materials proposed for Summit at Scottsdale are indigenous to the area supplemented with additional native or adapted plantings. All plantings will conform to the Approved Plant List provided by the City of Scottsdale.

Undisturbed desert areas including desert washes and designated N.A.O.S. areas will be preserved in their existing condition; the undisturbed N.A.O.S. will be enhanced during the development of the Project. Where disturbance does occur as a result of construction activity, the areas of disturbance will be revegetated using only plant materials native to the area. A habitat mitigation area will be provided along the edge of the central main wash.

Approved Plant List

The plants on the following lists are in conformance with the City of Scottsdale Approved Plant List and have been found to be compatible with the natural desert environment existing at the site.

Native Plants

Turf will not be used on this project.

Additional Landscape Materials

Boulders, decomposed granite, and similar features will be limited either to materials indigenous to site or to materials similar in color and appearance.

**PLANT LEGEND**

TREES	SIZE
PROSOPIA VELUTINA	24" BOX
NATIVE MESQUITE	STANDARD
AGAVE SMALLI	36" BOX
SWEET ACACIA	STANDARD
CERODIUM PRAECOX	36" BOX
PALO BREA	36" BOX
SALVAGE TREE	FROM INVENT
EXISTING TREE TO REMAIN	

SHRUBS	SIZE
BAILEYA MULTIRADIATA	1 GALLON
DESERT MARIGOLD	
CALLANDRA CALIFORNICA	5 GALLON
BAJA FAIRY DUSTER	
JUSTICIA CALIFORNICA	5 GALLON
CHUPAROSA	
EUPHORBIA BISCANULOSA	5 GALLON
TRAILING EUPHORBIA	
SALVIA CLEVELANDII	5 GALLON
CHAPARRAL SAGE	
SALVIA COCCINEA	1 GALLON
CHERRY RED SAGE	
SALVIA FARINACEA	1 GALLON
MEALY-CUP SAGE	
SALVIA GREGGI	5 GALLON
AUTUMN SAGE	
SALVIA LEUCANTH	1 GALLON
MEXICAN BUSH SAGE	

ACCENTS	SIZE
AGAVE COLORATA	5 GALLON
MESCAL CENZA	
AGAVE DESMESTRANA	5 GALLON
GREEN AGAVE	
DASYLIRION WHEELERI	5 GALLON
DESERT SPOON	
ECHINOCACTUS GRUSONI	5 GALLON
GOLDEN BARREL CACTUS	
OCOTILLO	6-8 CANE
SAGUARO	8' SPEAR
AGAVE ELATA	5 GALLON
SOAP TREE YUCCA	
AGAVE AMERICANA	5 GALLON
CENTURY PLANT	

GROUND COVERS	SIZE
OREGONTHERA BERLANDIERI	5 GALLON
MEXICAN PRIMEVROSE	

**LANDSCAPE MATERIALS**

DECOMPOSED GRANITE "DESERT GOLD" 3" DEEP  
 3/8" SIZED THRU ALL NON-REVEGETATED AREAS  
 SURFACE SELECT GRANITE BOULDERS, COLOR TO MATCH DECOMPOSED GRANITE ABOVE 3'-5" DIA

**TABLE 2 - LIST OF HYDRO-SEED MATERIALS AND SIZES FOR MITIGATION AREA**

SPECIES	SCIENTIFIC NAME	LBS/ACRE
TRIPLE-LEAF BURSAGE	AMBRÓSIA DELTOIDEA	3.0
DESERT MARIGOLD	BAILEYA MULTIRADIATA	1.0
DESERT SENNA	SASSIA SP.	1.0
SNYWEED	OUTREWEEDIA SERRIFOLIA	0.5
CREOSOTE	LARREA TRISKANTATA	1.0

\* NOTES: INFORMATION PROVIDED BY SWCA INC.

design review

alanis

thompson

**THE SUMMIT AT SCOTTSDALE**  
 Scottsdale Road and Ashler Hills Road  
 Scottsdale, Arizona  
 Nelsen Architects, Inc.

**e group**  
 landscape architecture / environmental design  
 817 North Central Avenue Phoenix, Arizona 85004 602-482-9916  
 11.22.99

**CONCEPTUAL LANDSCAPE PLAN**

NORTH 0 20' 40' 80'

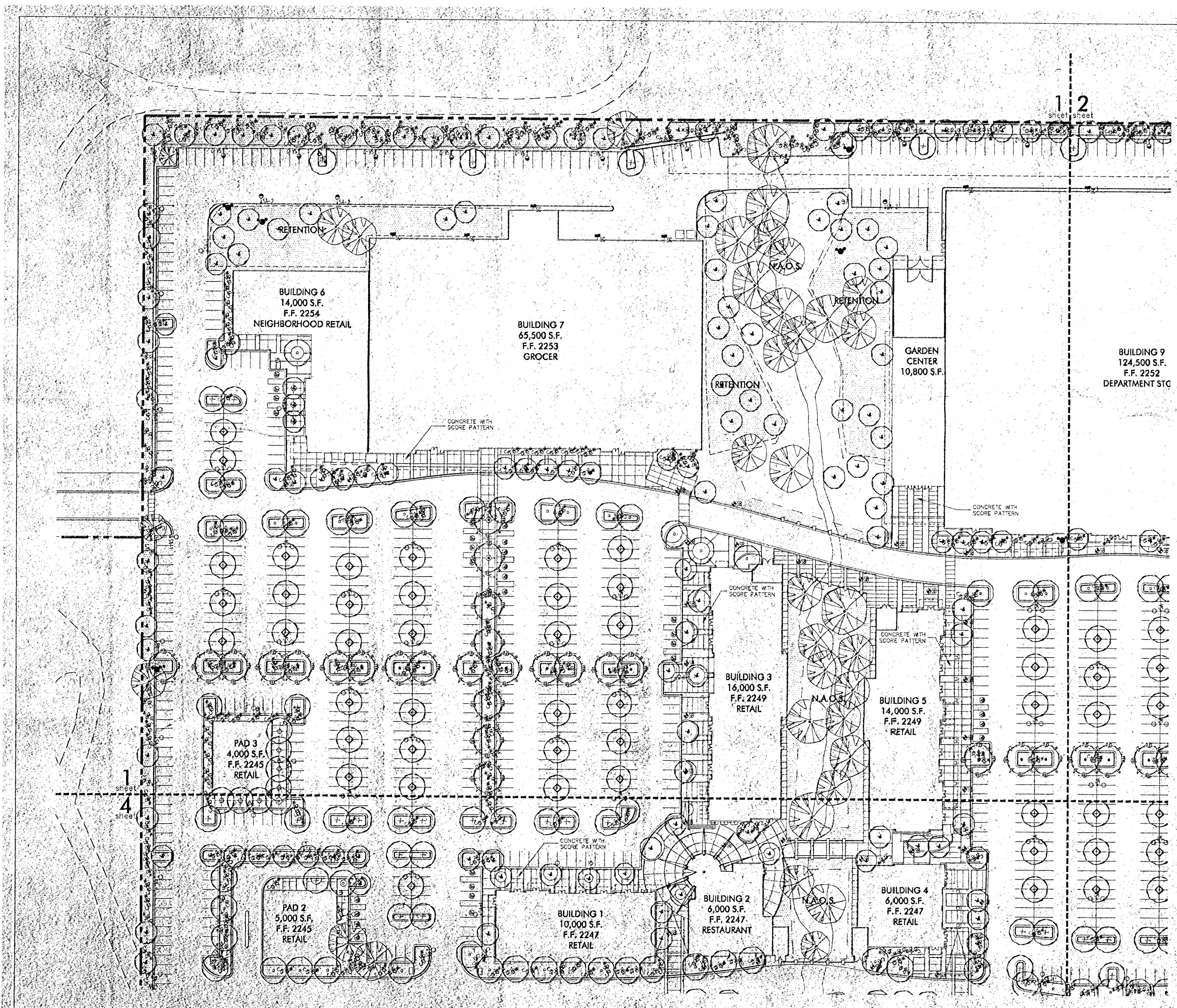

**LANDSCAPE CHARACTER**

The Summit at Scotts will provide a natural desert landscape character through the retention and preservation of the existing landscape or providing other enhanced landscape trees.

Enhanced landscaping will include areas which the streets right-of-way entries and important activity nodes. The plant materials proposed for Scotts are indigenous to the area supplemented with additional approved plantings. All plantings will adhere to the Approved Plant List of the City of Scottsdale.

Undisturbed desert areas including desert washes and designated NAOs will be preserved in their existing conditions. The undisturbed NAOs enhanced during the development of the Project. Where disturbance to site as a result of construction activity, the areas of disturbance will be revegetated using only plant materials native to the area. A habitat mow area will be provided along the edge of the central main walk.

Approved Plant List

The plants on the following list are in conformance with the City of Scottsdale's Approved Plant List and have been found to be compatible with the desert environment existing at the site.

Turf will not be used on this project.

Additional Landscape Materials

Boulders, decomposed granite, and similar features will be limited to materials indigenous to site or to materials similar in color and appearance.

**PLANT LEGEND**

**TREES**

SYMBOL	SCIENTIFIC NAME	SIZE
⊕	PROSOPIA VELUTINA	24" BK
⊕	NATIVE MESQUITE	STAND
⊕	ACACIA SMALL	36" BK
⊕	SWEET ACACIA	STAND
⊕	CECIDIUM PRAECOX	36" BK
⊕	PALO BREA	FROM
⊕	SALVAGE TREE	FROM
⊕	EXISTING TREE TO REMAIN	

**SHRUBS**

SYMBOL	SCIENTIFIC NAME	SIZE
⊕	BAILEYA MULTIRADIATA	5 GAL
⊕	DESERT MARIGOLD	5 GAL
⊕	CALLANDRA CALIFORNICA	5 GAL
⊕	BAJA FAIRY OUSTER	5 GAL
⊕	JUSTICIA CALIFORNICA	5 GAL
⊕	CHUPARROSA	5 GAL
⊕	EUPHORBIA BIGNONIOLOSA	5 GAL
⊕	TRAILING EUPHORBIA	5 GAL
⊕	SALVIA CLEVELANDII	5 GAL
⊕	CHAPARRAL SAGE	1 GAL
⊕	SALVIA COONDEA	1 GAL
⊕	CHERRY RED SAGE	1 GAL
⊕	SALVIA FARINACEA	1 GAL
⊕	WEALTHY-CUP SAGE	5 GAL
⊕	SALVIA GRECOA	5 GAL
⊕	AUTUMN SAGE	1 GAL
⊕	SALVIA LEUCANTH	1 GAL
⊕	MEXICAN BUSH SAGE	5 GAL

**ACCENTS**

SYMBOL	SCIENTIFIC NAME	SIZE
⊕	AGAVE COLORATA	5 GAL
⊕	MESCAL CENZEA	5 GAL
⊕	AGAVE DESMONTTIANA	5 GAL
⊕	GREEN AGAVE	5 GAL
⊕	DASYLIRION WHEELERII	5 GAL
⊕	DESERT SPIDON	5 GAL
⊕	ECHINOCACTUS GRUSONI	5 GAL
⊕	GOLDEN BARREL CACTUS	5 GAL
⊕	OCOTILLO	6-8 C
⊕	SAGUARO	6" SPE
⊕	AGAVE ELATA	5 GAL
⊕	SOAP TREE YUCCA	5 GAL
⊕	AGAVE AMERICANA	5 GAL
⊕	CENTURY PLANT	5 GAL

**GROUND COVERS**

SYMBOL	SCIENTIFIC NAME	SIZE
⊕	DIANTHERA BERLANDIERI	5 GAL
⊕	MEXICAN PRIMEROSE	5 GAL

**LANDSCAPE MATERIALS**

- ⊕ DECOMPOSED GRANITE "DESERT GOLD" 7" DEEP 3/8" SIZED THRU ALL NON-VEGETATED AREAS
- ⊕ "SURFACE SELECT" GRANITE BOULDERS, COLOR TO MATCH DECOMPOSED GRANITE ABOVE

TABLE 2 - LIST OF HYDRO-SEED MATERIALS AND SIZES FOR MITIGATION AREAS

SPECIES	SCIENTIFIC NAME	LIBS./AC
BANDED-LEAF BURSAGE	AMBROSIA DELTOIDEA	3.0
DESERT MARIGOLD	BAILEYA MULTIRADIATA	1.0
DESERT SPINNA	CASSIA SP.	3.0
SHAGBEE	GUTIERREZIA SAROTIBRAS	3.0
CREOSOTE	LARREA TRIDENTATA	1.0

\* NOTE: INFORMATION PROVIDED BY SWCA, INC.

design review ●

olanis ✍

thompson ✓

**THE SUMMIT AT SCOTTSDALE**  
 Scottsdale Road and Ashler Hills Road  
 Scottsdale, Arizona  
 Neilsen Architects, Inc.

**e group**  
 landscape architecture / environmental design  
 817 North Central Avenue Phoenix, Arizona 85004 602-258-8800  
 e group # 99160  
 11.22.99

**CONCEPTUAL LANDSCAPE**

NORTH 0 20' 40' 80'

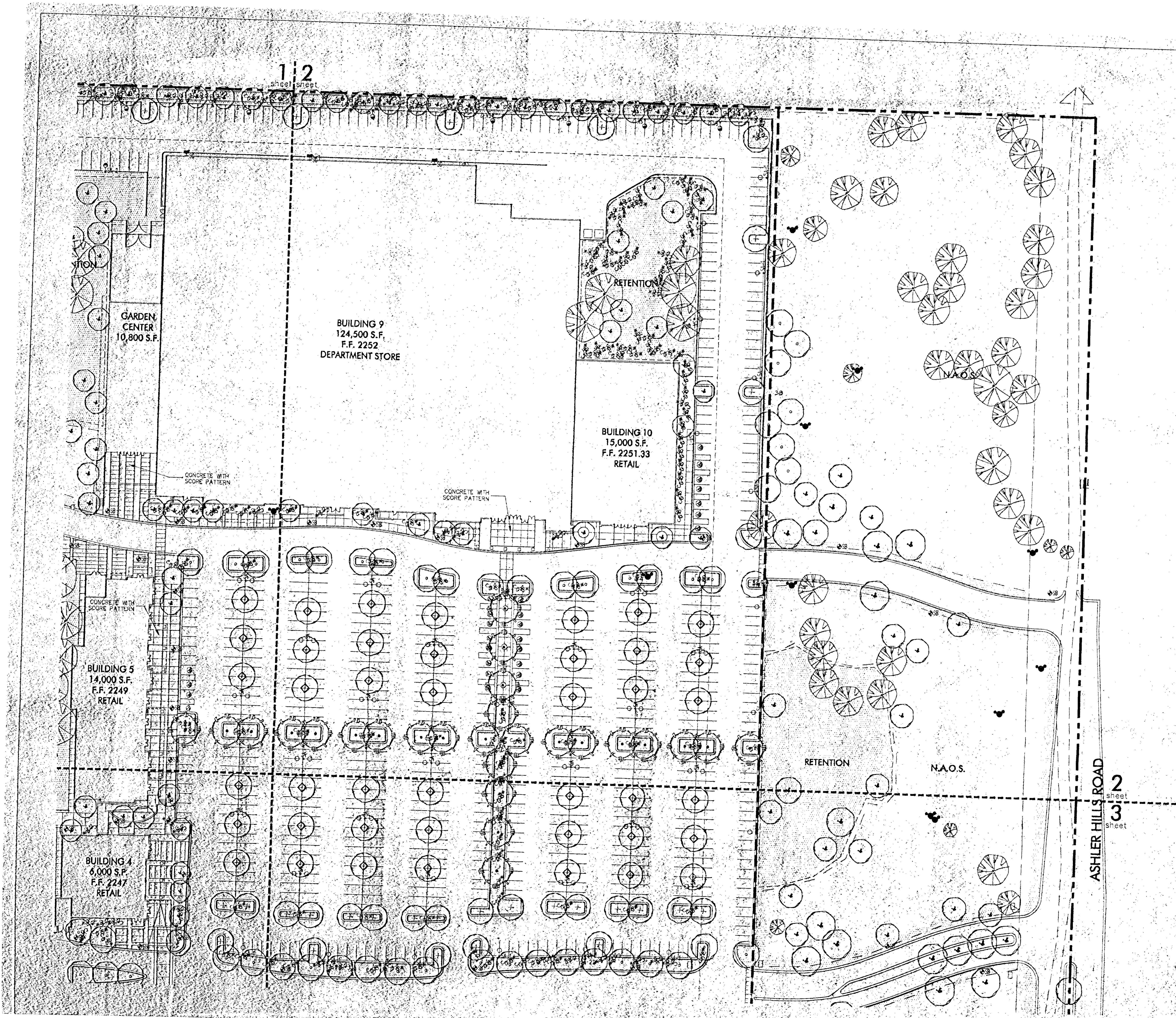

112  
sheet 1988

GARDEN CENTER  
10,800 S.F.

BUILDING 9  
124,500 S.F.  
F.F. 2252  
DEPARTMENT STORE

BUILDING 10  
15,000 S.F.  
F.F. 2251.33  
RETAIL

BUILDING 5  
14,000 S.F.  
F.F. 2249  
RETAIL

BUILDING 4  
6,000 S.F.  
F.F. 2247  
RETAIL

RETENTION

N.A.O.S.

ASHLER HILLS ROAD  
sheet 2  
sheet 3

**LANDSCAPE CHARACTER**

The Summit at Scottsdale will provide a natural desert landscape character through the retention and preservation of the existing landscape and by providing other enhanced landscape areas.  
Enhanced landscaping will include areas within the street right-of-way, open spaces and important activity nodes. The plant material selected for Summit at Scottsdale are indigenous to the area supplemented with additional native and adapted plantings. All plantings will adhere to the Approved Plant List provided by the City of Scottsdale.  
Undisturbed desert areas including desert washes and designated N.A.O.S. areas will be preserved in their existing conditions. The designated N.A.O.S. will be retained during the development of the Project. Where disturbance does occur as a result of construction activity, the areas of disturbance will be revegetated using only plant material native to the area. A habitat mitigation area will be provided along the edge of the central main way.  
Approved Plant List  
The plants on the following lists are in compliance with the City of Scottsdale Approved Plant List and have been found to be compatible with the natural desert environment existing at the site.  
Turf will not be used on this project.  
Additional Landscape Materials  
Boulders, decomposed granite, and similar features will be limited either to materials indigenous to the site or to materials similar in color and appearance.

**PLANT LEGEND**

TREES	SIZE
PROSOPIA VELUTINA	24" BOX
NATIVE MESQUITE	STANDARD
ACACIA SMALL	36" BOX
SWEET ACACIA	STANDARD
CERODIUM FRAECCOX	36" BOX
PAID BREA	36" BOX
SALVAGE TREE	FROM INVENTORY
EXISTING TREE TO REMAIN	

SHRUBS	SIZE
BAILEYA MULTIRADIATA	1 GALLON
DESERT MARIGOLD	5 GALLON
CALLIANDRA CALIFORNICA	5 GALLON
BALIA FAIRY DUSTER	5 GALLON
JUSTICIA CALIFORNICA	5 GALLON
CHUPAROSA	5 GALLON
EUPHORBIA BICLANDULOSA	5 GALLON
TRAILING EUPHORBIA	5 GALLON
SALVIA CLEVELANDII	5 GALLON
CHAMPAGNE SAGE	5 GALLON
SALVIA COCCINEA	1 GALLON
CHERRY RED SAGE	1 GALLON
SALVIA FARNACEA	1 GALLON
HEAVY-CUP SAGE	5 GALLON
SALVIA GREGGII	5 GALLON
AUTUMN SAGE	1 GALLON
SALVIA LEUCANTH	1 GALLON
MEXICAN BUSH SAGE	5 GALLON

ACCENTS	SIZE
AGAVE COLORATA	5 GALLON
MESCAL CENIZA	5 GALLON
AGAVE DESMENTIANA	5 GALLON
GREEN AGAVE	5 GALLON
DASYLIRION WHEELERI	5 GALLON
DESERT SPOON	5 GALLON
ECHINOCACTUS GRUSONI	5 GALLON
GOLDEN BARREL CACTUS	5 GALLON
COOTILLO	6-8 CANE B' TAL
SAGUARO	6" SPEAR
AGAVE ELATA	5 GALLON
SOAP TREE YUCCA	5 GALLON
AGAVE AMERICANA	5 GALLON
CENTURY PLANT	5 GALLON

GROUND COVERS	SIZE
ONONOTHERA BERLANDIERI	5 GALLON
MEXICAN PRIMROSE	5 GALLON

**LANDSCAPE MATERIALS**

DECOMPOSED GRANITE "DESERT GOLD"  
3/8" SIZED THRU ALL NON-VEGETATED AREAS  
"SURFACE SELECT" GRANITE BOULDERS, COLOR TO MATCH DECOMPOSED GRANITE ABOVE 3"-5" DIA.

TABLE 2 - LIST OF HYDRO-SEED MATERIALS AND SIZES FOR MITIGATION AREA

SPECIES	SCIENTIFIC NAME	LBS/ACRE
TANGLE-LEAF BURSAGE	AMARHESIA DELTOIDEA	3.0
DESERT MARIGOLD	BAILEYA MULTIRADIATA	1.0
DESERT SENNA	CASSIA SP.	1.0
SNAKEWEED	SUTHERREZZA SARTORIIAE	1.0
CREOSOTE	LARREA TRIDENTATA	1.0

\* NOTE: INFORMATION PROVIDED BY SWCA, INC.

design review  
alanis  
thompson

**THE SUMMIT AT SCOTTSDALE**  
Scottsdale Road and Ashler Hills Road  
Scottsdale, Arizona  
Nelson Architects, Inc.

**e group**  
landscape architecture / environmental design, inc.  
817 North Central Avenue, Phoenix, Arizona 85004, 602-462-9000  
e group # 99160  
11.22.99

**CONCEPTUAL LANDSCAPE PLAN**

NORTH 0 20' 40' 80'

**L1.2**

309-PA 99