

**BENCH MARK (THIS PROJECT)**  
 BRASS CAP IN HANDHOLE AT THE INTERSECTION  
 OF PARADISE LANE & SCOTTSDALE ROAD  
 ELEVATION=1495.66 (C.O.S. DATUM).  
 (ADD 1.772 FEET TO SITE DATUM FOR NAD 88 DATUM)

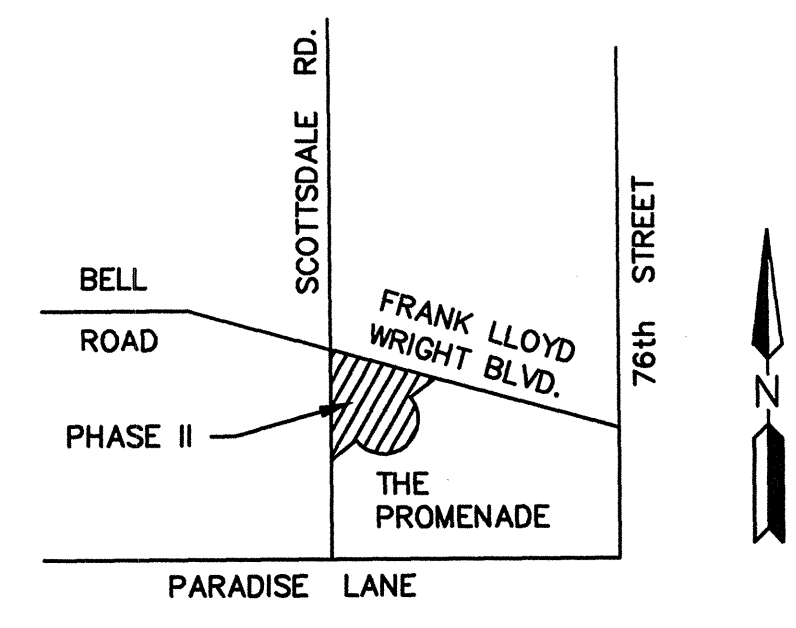

**VICINITY MAP**  
 N.T.S.

**LEGEND:**

- 1505 EXISTING CONTOURS
- TC= TOP OF CURB ELEVATION
- G= GUTTER GRADE
- P= PAVEMENT ELEVATION
- SW= SIDEWALK ELEVATION
- FG= FINISH GRADE
- GR= TOP OF GRATE ELEVATION
- L.F.E.= LOWEST FLOOR ELEVATION
- 2% DIRECTION & SLOPE OF DRAINAGE
- STORM DRAIN MANHOLE
- ▣ CATCH BASIN
- STORM DRAIN CLEANOUT
- ① IMPROVEMENTS CONSTRUCTED PER PLANS FOR PROMENADE INFRASTRUCTURE (PLAN CHECK NO. 371-99)
- ② EXISTING STORM DRAIN CONSTRUCTED PER PLANS FOR PROMENADE INFRASTRUCTURE (PLAN CHECK NO. 371-99)
- ③ NEW STORM DRAIN

**PRELIMINARY GRADING & DRAINAGE PLAN**

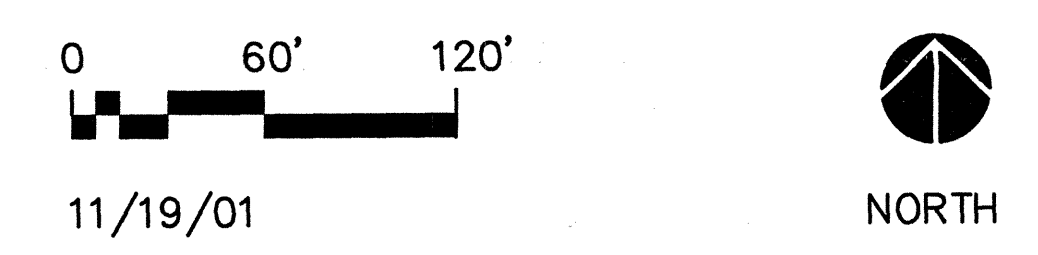

**STORMWATER DETENTION NOTE**

ALL STORMWATER DETENTION FOR THE PROMENADE INCLUDING THIS PROJECT, HAS BEEN PROVIDED IN A LARGE DETENTION BASIN LOCATED AT THE NWC OF PARADISE LANE AND 76TH STREET. (PLAN CHECK NO. 371-99).

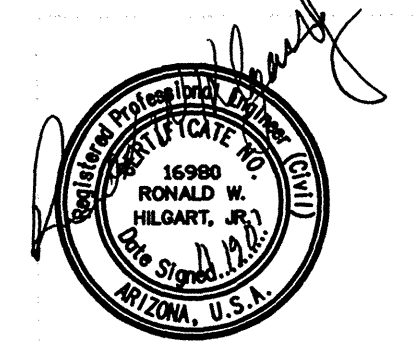

**CMX GROUP INC.**  
 1515 E. MISSOURI  
 PHOENIX, AZ 85014  
 (602)279-8436

ENGINEERING  
 PROJECT ADMINISTRATION  
 CONSTRUCTION ANALYSIS

PROJECT NUMBER 6380

