

SITE DATA

SITE AREA : 218,621 SF (5.013 ACRES)
 SITE AREA (NET) : 182,128 SF (4.18 ACRES)
 LANDSCAP'G REQUIRED : 182,128 SF OF SITE X 15% = 27,319 SF
 LANDSCAP'G PROVIDED : 67,320 SF (41.9% OF SITE)
 ZONING : IG

NATIVE PLANT NOTES:

RGH ASSOCIATES HAS SUBMITTED THE NATIVE PLANT INVENTORY.

NATIVE PLANT PERMIT NO. 79-NP-97

SCOTTSDALE 5-25 SIGHT DISTANCE TRIANGLE, TYP.

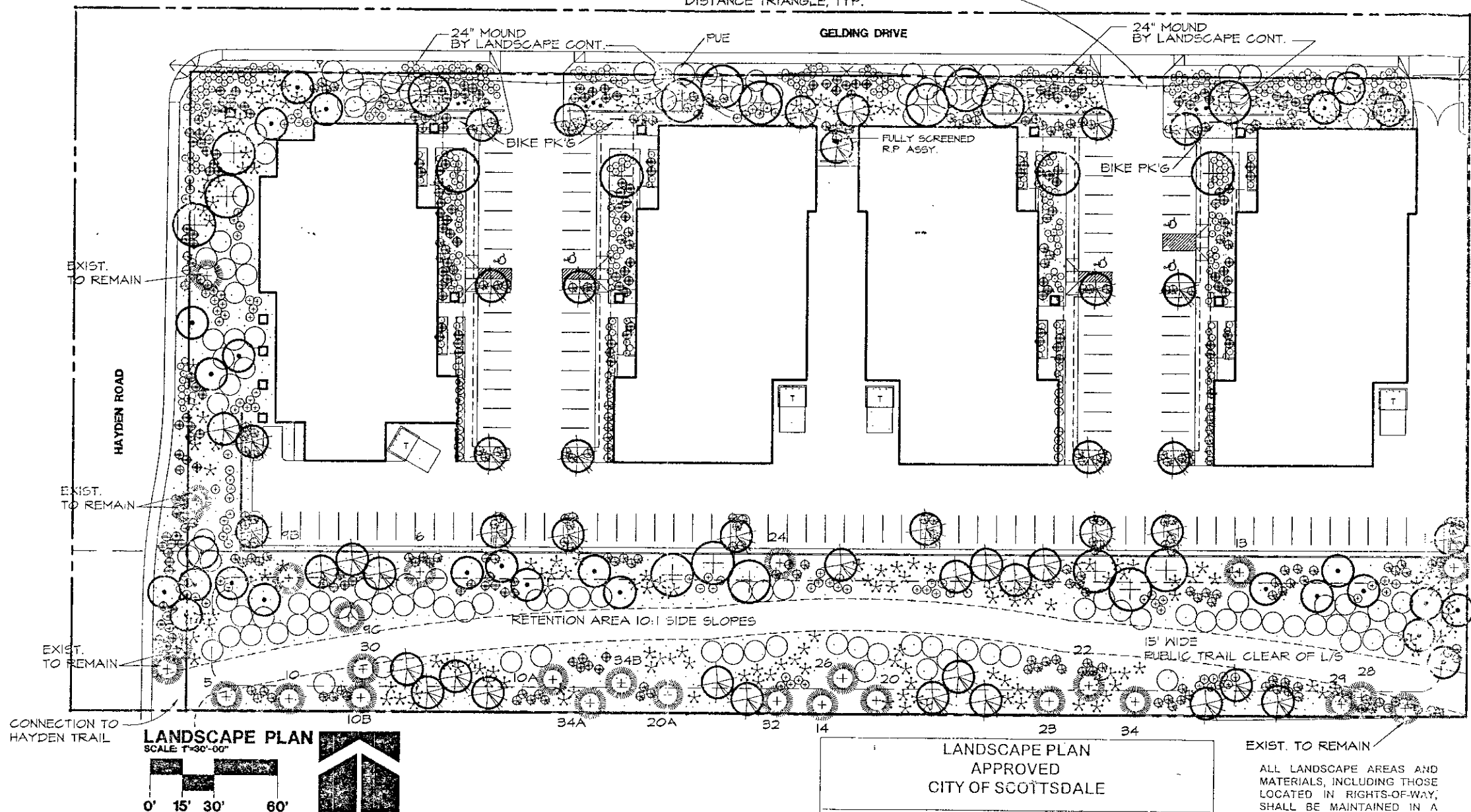

LANDSCAPE PLAN
SCALE: 1"=30'-00"



LANDSCAPE LEGEND

- CERCIDIUM PRAECOX SONORAN PALO VERDE 24" BOX (21)
- PROSOPIA CHILENSIS CHILEAN MESQUITE 15 GALLON (45)
- ACACIA SALICIA WILLOW ACACIA 24" BOX (28)
- DASYLERION WHEELERII DESERT SPOON 5 GALLON (212)
- LEUCOPHYLLUM FRUTESCENS 'GREEN CLOUD' SAGE 5 GALLON (251)
- CASSIA PHYLLODENIA CASSIA 5 GALLON (119)
- CAESALPINIA MEXICANA MEXICAN BIRD OF PARADISE 5 GALLON (187)
- ACACIA REDOLENS 'DESERT CARPET' TRAILING ACACIA 1 GALLON (116)
- CONVULVULUS CNEORUM BUSH MORNING GLORY

- CARNEGIA GIGANTEA SAGUARO SPEARS 6' TALL (8)

LANDSCAPE NOTES:

AN AUTOMATIC IRRIGATION SYSTEM WILL BE INSTALLED GUARANTEEING 100% COVERAGE TO ALL LANDSCAPE AREAS.

ALL PLANT MATERIAL WITHIN THE CITY OF SCOTTSDALE SIGHT DISTANCE TRIANGLES WILL NOT EXCEED 24" AT MATURITY. TREES SHALL HAVE A MINIMUM CANOPY OF 7' AT PLANTING.

ALL LANDSCAPE AREAS WILL BE TOP-DRESSED WITH A 2" DEPTH OF DECOMPOSED GRANITE. PROVIDE 3% SLOPE AWAY FROM WALK OR CURB FOR 5' ALONG ALL STREETS.

ALL LANDSCAPE AREAS & MATERIALS SHALL BE MAINTAINED IN A HEALTHY, NEAT, CLEAN, WEED-FREE CONDITION. THIS SHALL BE THE RESPONSIBILITY OF THE PROPERTY OWNER.

NO TURF AREAS ARE TO BE PROVIDED.

AREAS OF DECOMPOSED GRANITE WITHOUT PLANT MATERIALS SHALL NOT EXCEED 7' IN ANY ONE DIRECTION.

ALL ROW'S ADJACENT TO THIS PROPERTY SHALL BE LANDSCAPED AND MAINTAINED BY THE PROPERTY OWNER.

- NATIVE TAG #
- SALVAGED TREE TRANSPLANTED (23) SEE RGH INVENTORY

1/2" MINUS MADISON GOLD DECOMPOSED GRANITE 2" DEPTH IN ALL AREAS

LANDSCAPE PLAN
APPROVED
CITY OF SCOTTSDALE

114DR96
1240297
CASE NUMBER

Judy Anderson
APPROVED BY

9/24/97
DATE

CONSTRUCTION AND INSTALLATION SHALL BE IN ACCORDANCE WITH THIS PLAN AND ANY AND ALL DEVIATION WILL REQUIRE REAPPROVAL. LANDSCAPE INSTALLATION TO BE APPROVED BY CITY OF SCOTTSDALE INSPECTION SERVICES BEFORE CERTIFICATE OF OCCUPANCY IS ISSUED.

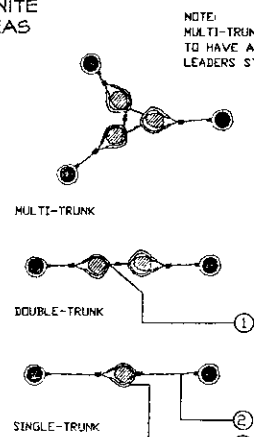

1. NOTCH TUBING LOOP WIRE THROUGH EXPOSED WIRE
2. #10 WIRE RUBBER COATED
3. 1/2" RUBBER HOSE

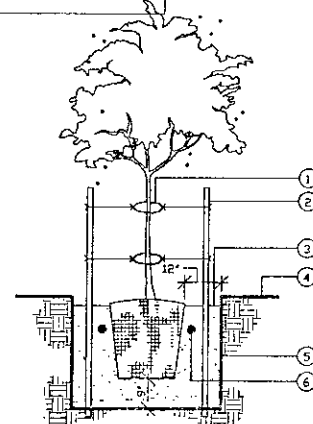

1. 1/2" RUBBER HOSE WITH #10 WIRE
2. TWO 2" ROUND BY 6" LONG GREEN TREE STAKES BURY 2" BELOW GRADE
3. 4" BASIN
4. GRADE
5. ROUGHEN SIDES OF PLANT PIT TO PREVENT GLAZING
6. AGRIFORM TABLETS

BACKFILL PLANT PIT WITH SOIL MIX NOTED IN SPECS.

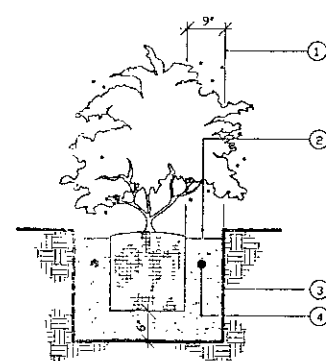

1. MINIMUM DIMENSION FOR 5 GAL. PLANTS
2. 1" BASIN
3. ROUGHEN SIDES OF PLANT PIT TO PREVENT GLAZING
4. AGRIFORM TABLETS SEE SPECS. FOR RATIO

BACKFILL PLANT PIT WITH SOIL MIX NOTED IN SPECS.

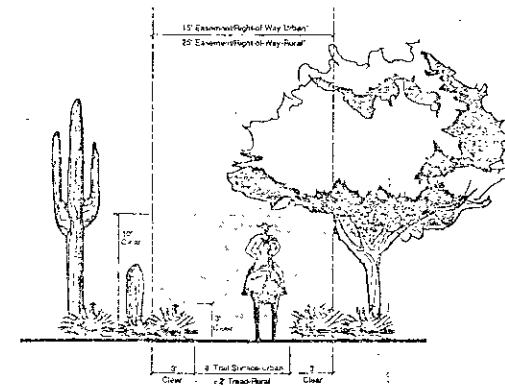

FIGURE 7.3-4
Minimum Trail Clearances

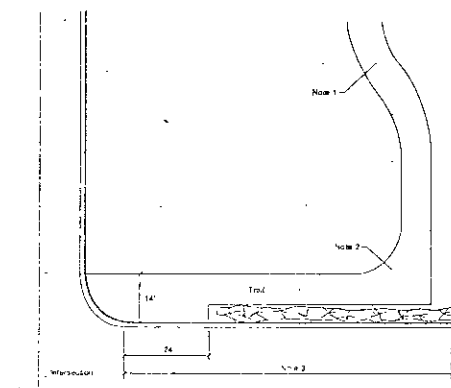
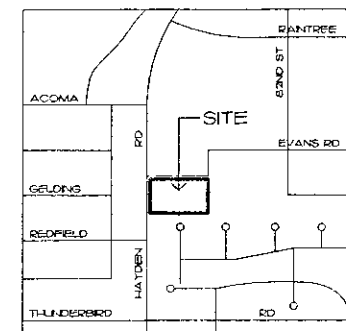
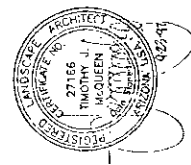

FIGURE 7.3-5
Urban Trail Alignment



LOCATION MAP
NO SCALE



STUDIO R
Architects



HAYDEN BUSINESS CENTER

14201 NORTH HAYDEN ROAD
SCOTTSDALE, ARIZONA

85259

9804 N. 100TH PLACE
SCOTTSDALE, ARIZONA 85258

902.914.5459 FAX
902.914.5459 PH

LANDSCAPE PLAN

REVISIONS
SCOTT 10-25

JOB NO. 96-05.1
FILE NO. 6081A1-R
DATE: 11-04-96

