

Landscape Concept Statement

The proposed Sereno Canyon development occupies a very unique and interesting parcel of land that lies just north of the McDowell Mountain Preserve. Many areas on the site were damaged in the mid 1990's during a wildfire that destroyed much of the native trees and cacti the once covered the landscape. Over the last 10+ years the site has been left undisturbed and had begun to naturally revegetate itself. Scattered throughout the project are many boulder features and topographical points of interest that are showcased in the plan shown here. Roads and site features have been designed to meander around natural features and have also aligned viewsheds and traffic sightlines to capitalize on the spectacular views the site has to offer.

As with any new development, roadway scarring and infrastructure improvements will leave behind some disturbed areas that must be addressed. New landscaping is proposed to be installed to revegetate these areas, including the water and sewer line easements and any other existing jeep trails and construction scarring left behind from previous owners. Enhanced desert landscaping is proposed to be included at the project entry points, intersections, roadway medians, and finally at the clubhouse facility. This enhanced landscape treatment will include many plants used in roadway revegetation areas, but will also employ the use of specimen type trees, cacti, and colorful accents to reinforce the landscape hierarchy which gives the viewer a visual cadence and sense of arrival.

Residents in Sereno Canyon will also be able to utilize three community amenity locations that are spread throughout the development. These amenities shall be designed to allow for the preservation of the existing landscape, but will add additional native trees and understory plantings to encourage wildlife activity. A watering hole concept will be implemented to allow a place for watching birds and other wildlife. Connecting the nature parks will be a network of trails (some public) that will allow for the residents to have an opportunity to interact with their surroundings in a more personal way.

The following plant palette has been adopted from the City of Scottsdale's E.S.L.O. plant list. (All species shown below are in conformance with E.S.L.O. standards)

TREES

- Whitethorn Acacia
- Catclaw Acacia
- Crucefixion Thorn
- Hackberry
- Blue Palo Verde
- Foothill Palo Verde
- Desert Willow
- One-seeded Juniper
- Ironwood
- Cottonwood
- Arizona Mesquite
- Scrub Oak
- Sugar Sumac
- Arizona Rosewood

- Acacia constricta*
- Acacia greggii*
- Canotia holocantha*
- Celtis pallida*
- Cercidium floridum*
- Cercidium microphyllum*
- Chilopsis linearis*
- Juniperus monosperma*
- Olneya tesota*
- Populus fremontii*
- Prosopis velutina*
- Quercus turbinella*
- Rhus ovata*
- Vauquelinia californica*

SUCCULENTS / CACTI

- Saguaro
- Hedgehog Cactus
- Compass Barrel
- Barrel
- Fishhook Barrel
- Ocotillo
- Fishhook Cactus
- Cactus
- Staghorn Cholla
- Cholla
- Teddy Bear Cholla
- Engelmann's Prickly-pear
- Chainfruit Cholla
- Desert Christmas Cholla
- Night-Blooming Cereus
- Banana Yucca
- Soaptree Yucca

- Carnegia gigantea*
- Echinocereus engelmannii*
- Ferocactus cylindraceus*
- Ferocactus wislizenii* Barrel
- Fouquieria splendens*
- Mammillaria microcarpa*
- Opuntia acanthocarpa*
- Opuntia bigelovii* Cholla
- Opuntia engelmannii*
- Opuntia fulgida*
- Opuntia leptocaulis*
- Peniocereus greggii*
- Yucca baccata*
- Yucca elata*

SHRUBS / BUSHES

- Giant Bursage
- Triangle-leaf Bursage
- White Bursage
- Desert Honeysuckle
- Fourwing Saltbush
- Quailbrush
- Desert Saltbush
- Red Barberry
- Fairy Duster
- Desert Senna
- Desert Hackberry

- Ambrosia ambrosioides*
- Ambrosia deltoidea*
- Ambrosia dumosa*
- Anisacanthus therberi*
- Atriplex canescens*
- Atriplex lentiformis*
- Atriplex polycarpa*
- Berberis haematocarpa*
- Calliandra eriophylla*
- Cassia covesii*
- Celtis pallida*

- Hopbush
- Sacred Datura
- Brittlebush
- Green Brittlebush
- Mormon Tea
- Turpentine Bush
- Flat-top Buckwheat
- Snakeweed
- Desert Lavender
- Chuparosa
- Creosote Bush
- Deer Vetch
- Wolfberry
- Arrow Weed
- Jojoba Bush
- Trixis
- Goldeneye
- Greythorn

- ANNUALS / PERENNIALS / VINES**
- Abronia villosa*
 - Amsinckia intermedia*
 - Baileya multiradiata*
 - Cucurbita digitata*
 - Dichostemma pulchellum*
 - Dyssodia pentachaeta*
 - Eriophyllum lanosum*
 - Eschscholzia mexicana*
 - Gaillardia aristata*
 - Gilia latifolia*
 - Janusia gracilis*
 - Lasthenia chrysostoma*
 - Lesquerella gordonii*
 - upinus sparsiflorus*
 - Machaeranthera asteroides*
 - Melampodium leucanthum*
 - Orthocarpus purpurascens*
 - Penstemon parryi*
 - Penstemon pseudospectabilis*
 - Phacelia campanularia*
 - Phacelia crenulata*
 - Platystemon californicus*
 - Proboscidea parviflora*
 - Psilostrophe cooperi*
 - Plantago purshii*
 - Rafinesquina neomexicana*
 - Salvia columbariae*
 - Sphaeralcea ambigua*
 - Stephanomeria pauciflora*

GRASSES

- Purple threeawn
- Needle grama
- Sideoats grama
- Curly mesquite
- Fluffgrass
- Aristida purpurea*
- Bouteloua aristidaoides*
- Bouteloua curtipendula*
- Hilaria berlandieri*
- Eriogonum pulchellum*

The following plant palette is in addition to the above referenced list. The following species will be used in and around the developments clubhouse and connected common areas. (These areas will not be counted as revegetated NAOS)

TREES

- Casualote
- Desert Willow
- Creng Ash
- Texas Ebony
- flexicaule

- Caesalpinia cacalaco
- Chilopsis linearis
- Fraxinus greggii
- Pithecolobium

SUCCULENTS / CACTI

- Desert Milkweed
- Agave
- Golden Barrel
- Giant Hesperaloe
- Senita
- Organ Pipe Cactus

- Asclepius subulata*
- Agave Species*
- Echinocactus grusonii*
- Hesperaloe funifera*
- Lophocereus schottii*
- Stenocereus thurberi*

SHRUBS / BUSHES

- Black Dalea
- Sage
- Baja Ruellia
- Desert Ruellia
- Autumn Sage

- Dalea frutescens*
- Leucophyllum species*
- Ruellia Brittoniana*
- Ruellia peninsularis*
- Salvia greggii*

ANNUALS / PERENNIALS / VINES

- Potted annual flowers
- Angelita Daisy
- Yellow morning glory
- By season
- Hymenoxis acaulis
- Merrima aurea

GRASSES

- Beargrass
- Hybrid bermuda lawn
- equal/Cynodon dactylon
- Nolina erumpens*
- (Tifway 419 or equal)

This list is intended as a guide and is subject to change. Any changes shall be approved by City staff as required.

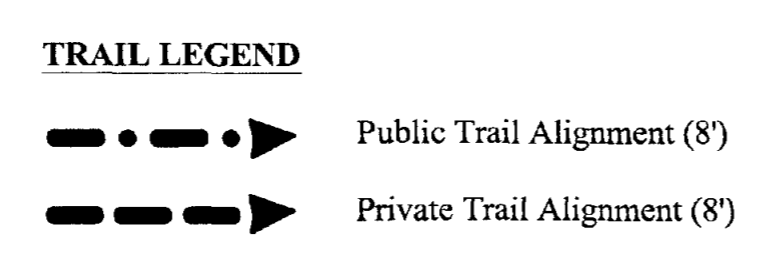
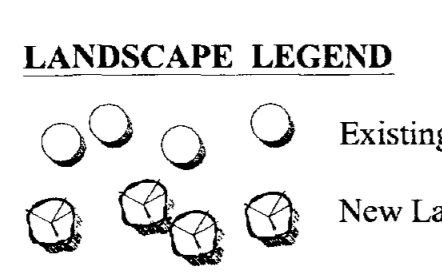
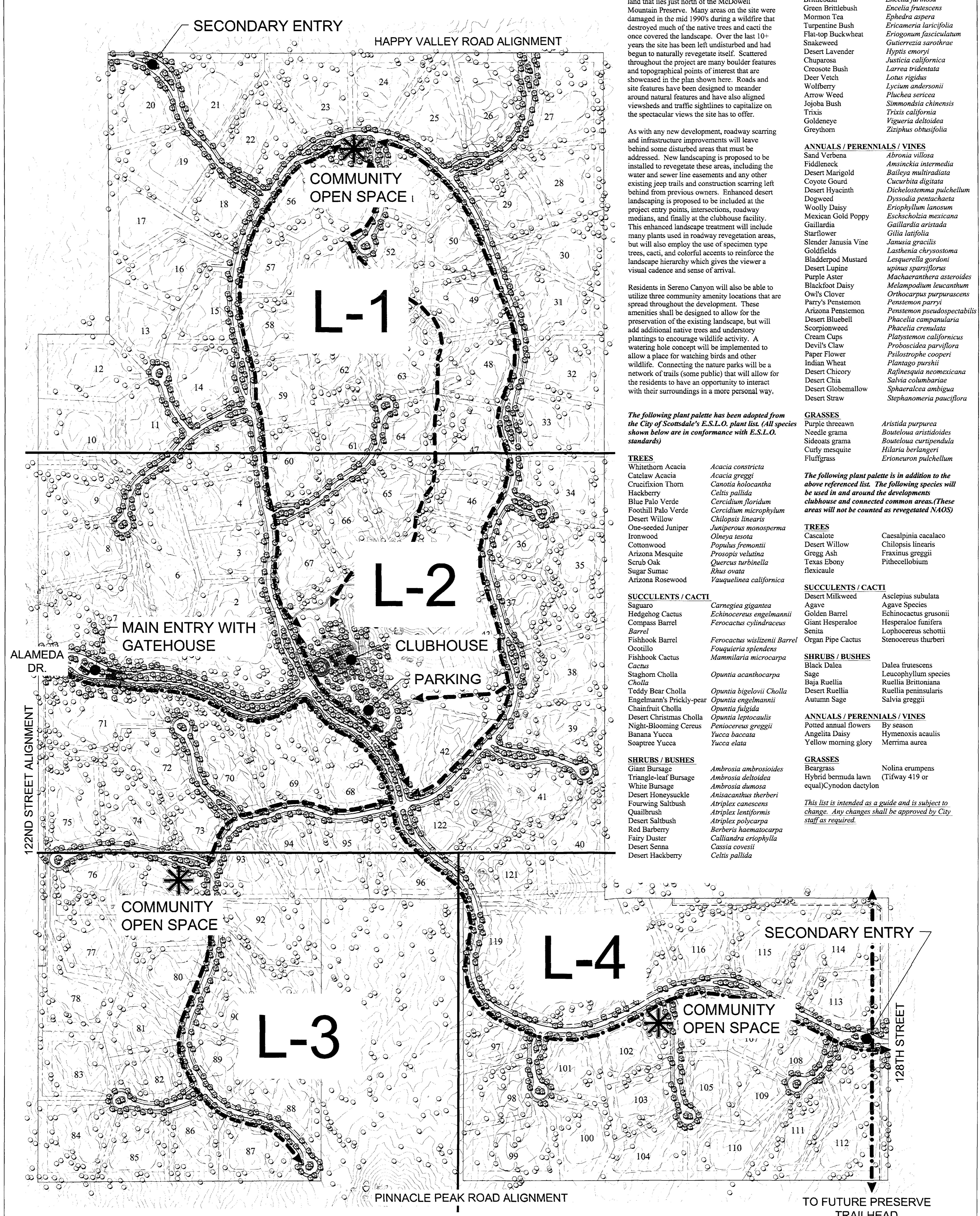

LANDSCAPE LIGHTING

Low voltage landscape lighting is proposed to be installed at the 3 project entry locations, the clubhouse entry, clubhouse parking lot, and near the clubhouse patio and pool areas. All lighting proposed is to have full cut off glare shields and will be used to only highlight landscape features. Fixtures selected shall be of a bronze or black finish and shall compliment the style of the building light fixtures.

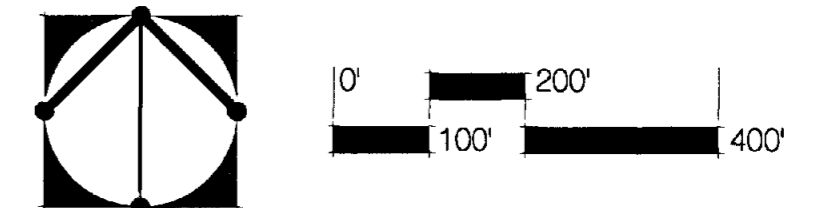

SHEET 1 OF 5



SERENO CANYON

OVERALL LANDSCAPE / SITE PLAN

Date: 12.07.05
 Job No: 0425
 Drawn by: JMY

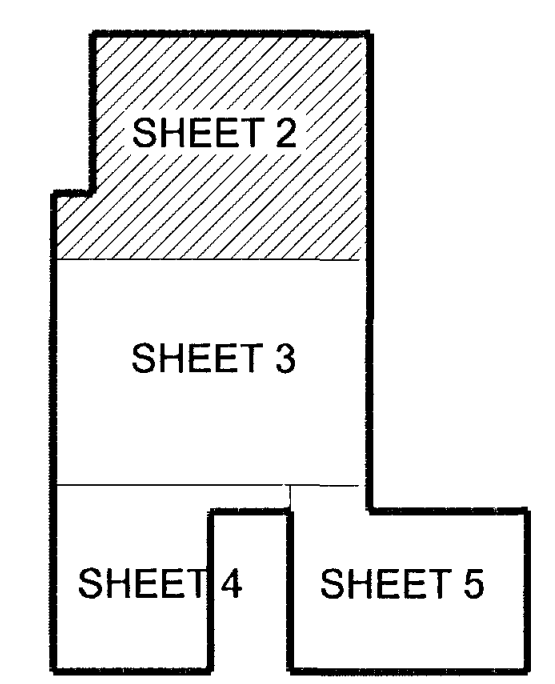
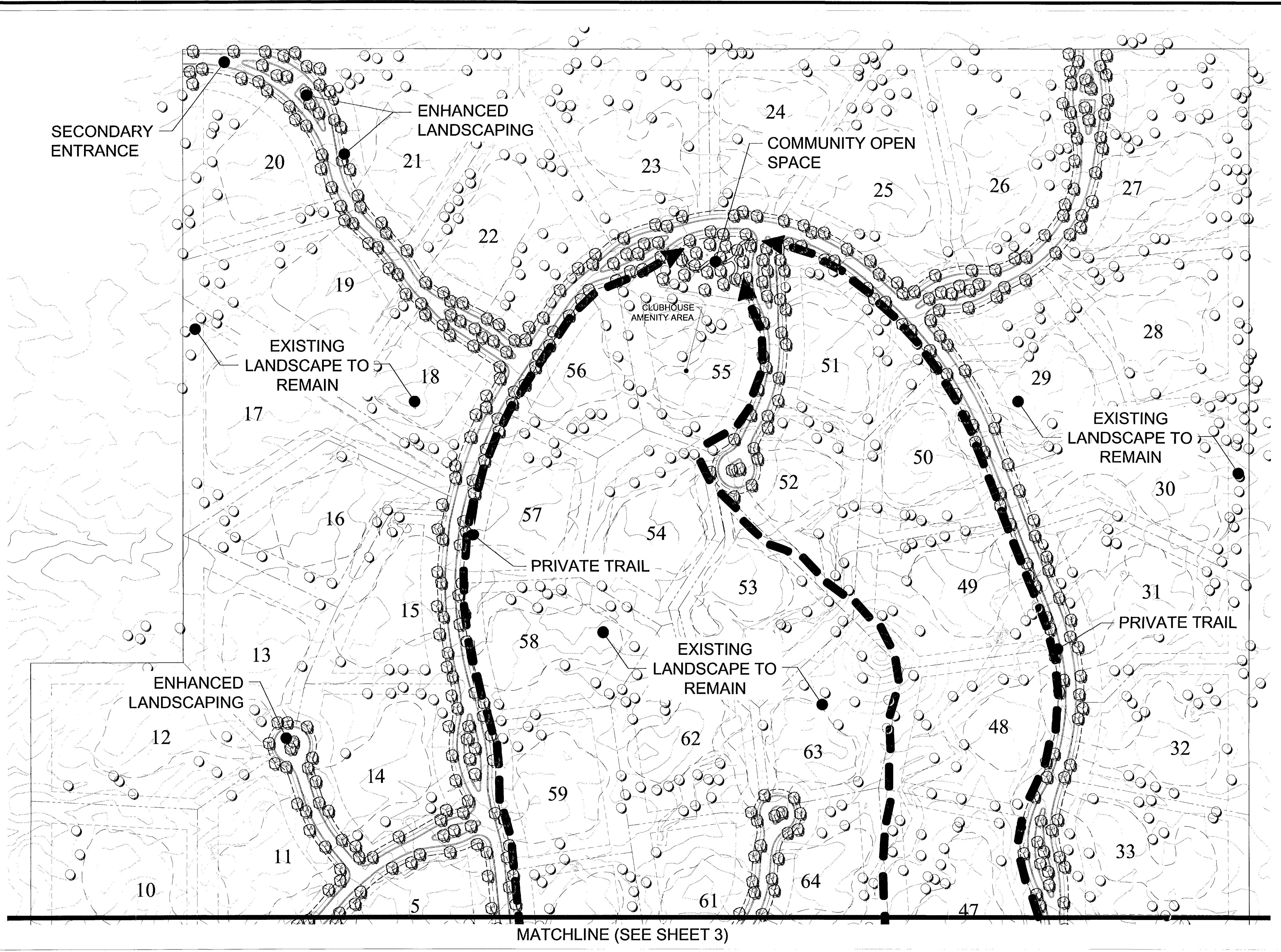

SHEET KEY
NO SCALE

LANDSCAPE LEGEND

- Existing Tree / Veg. to remain
- New Landscape / Enhanced Veg.

TRAIL LEGEND

- Public Trail Alignment (8')
- Private Trail Alignment (8')

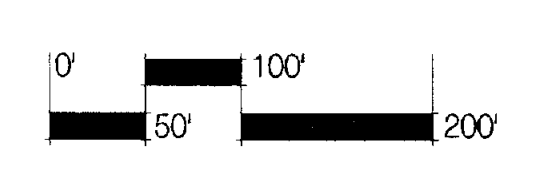
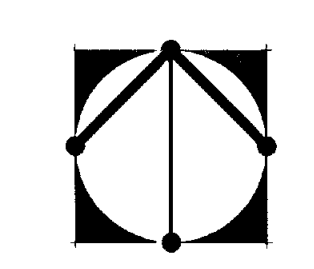

MATCHLINE (SEE SHEET 3)

SHEET
2 OF 5



Master Planned Communities,
Land Planning,
Site Planning & Design,
Environmental Analysis &
Landscape Design
7527 East Main Street
Scottsdale, Arizona 85251
Phone (480) 944-0294
Fax (480) 944-1332
www.lva-design.com

SERENO CANYON

LANDSCAPE PLAN / SITE PLAN ENLARGEMENT

Date:
12.07.05
Job No:
0425
Drawn by:
JMY

22-PP-05 & 113-06-05
12/19/05

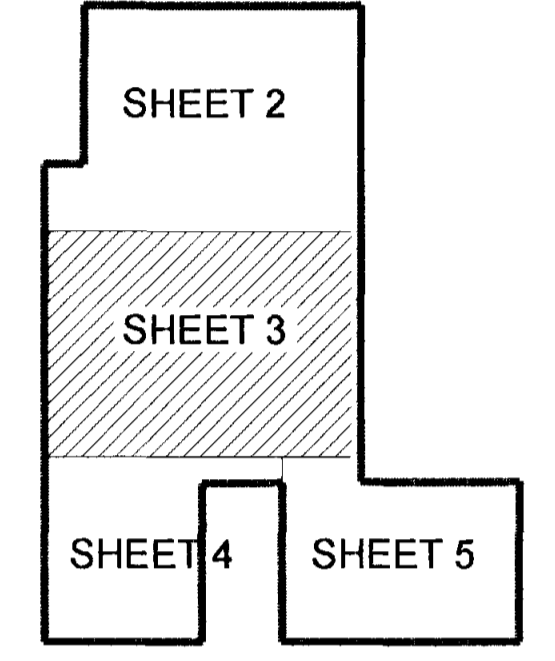
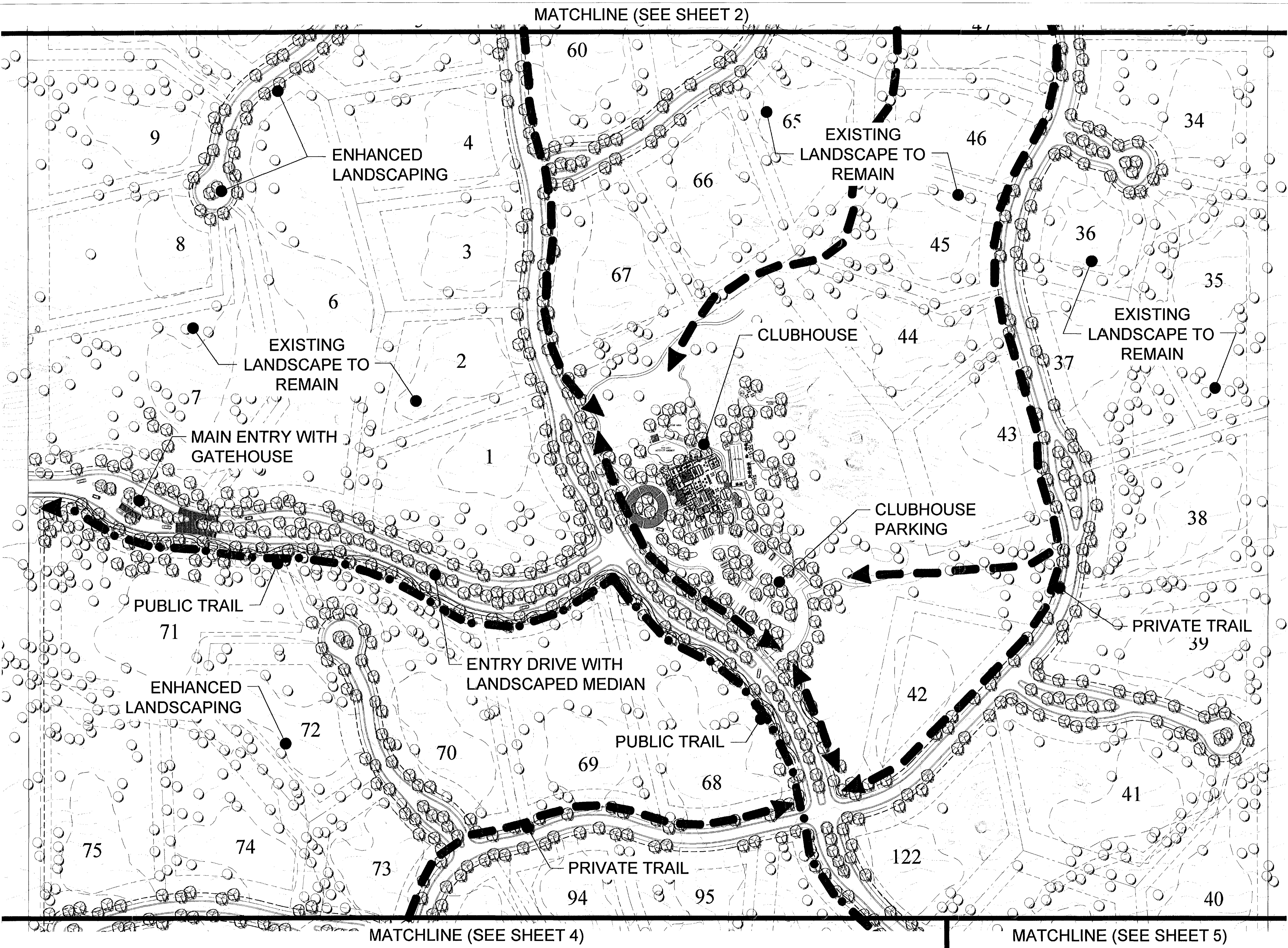

SHEET KEY
NO SCALE

- LANDSCAPE LEGEND**
- Existing Tree / Veg. to remain
 - New Landscape / Enhanced Veg.
- TRAIL LEGEND**
- Public Trail Alignment (8')
 - Private Trail Alignment (8')

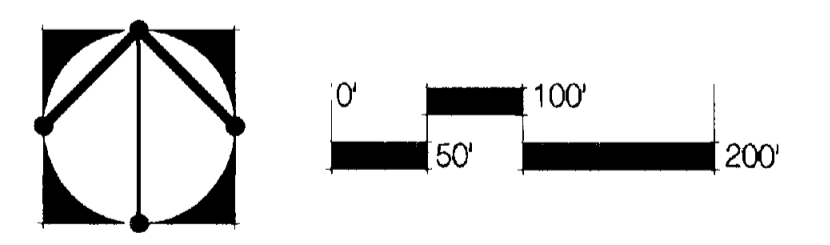

SHEET
3 OF 5

LVA
Urban Design
Studio L.L.C.

Master Planned Communities,
Land Planning,
Site Planning & Design,
Environmental Analysis &
Landscape Design

7502 East Main Street
Scottsdale, Arizona 85251
Phone (480) 994-0994
Fax (480) 994-7332
www.lva-design.com

SERENO CANYON

LANDSCAPE PLAN / SITE PLAN ENLARGEMENT

Date:
12.07.05
Job No:
0425
Drawn by:
JMY

MATCHLINE (SEE SHEET 3)

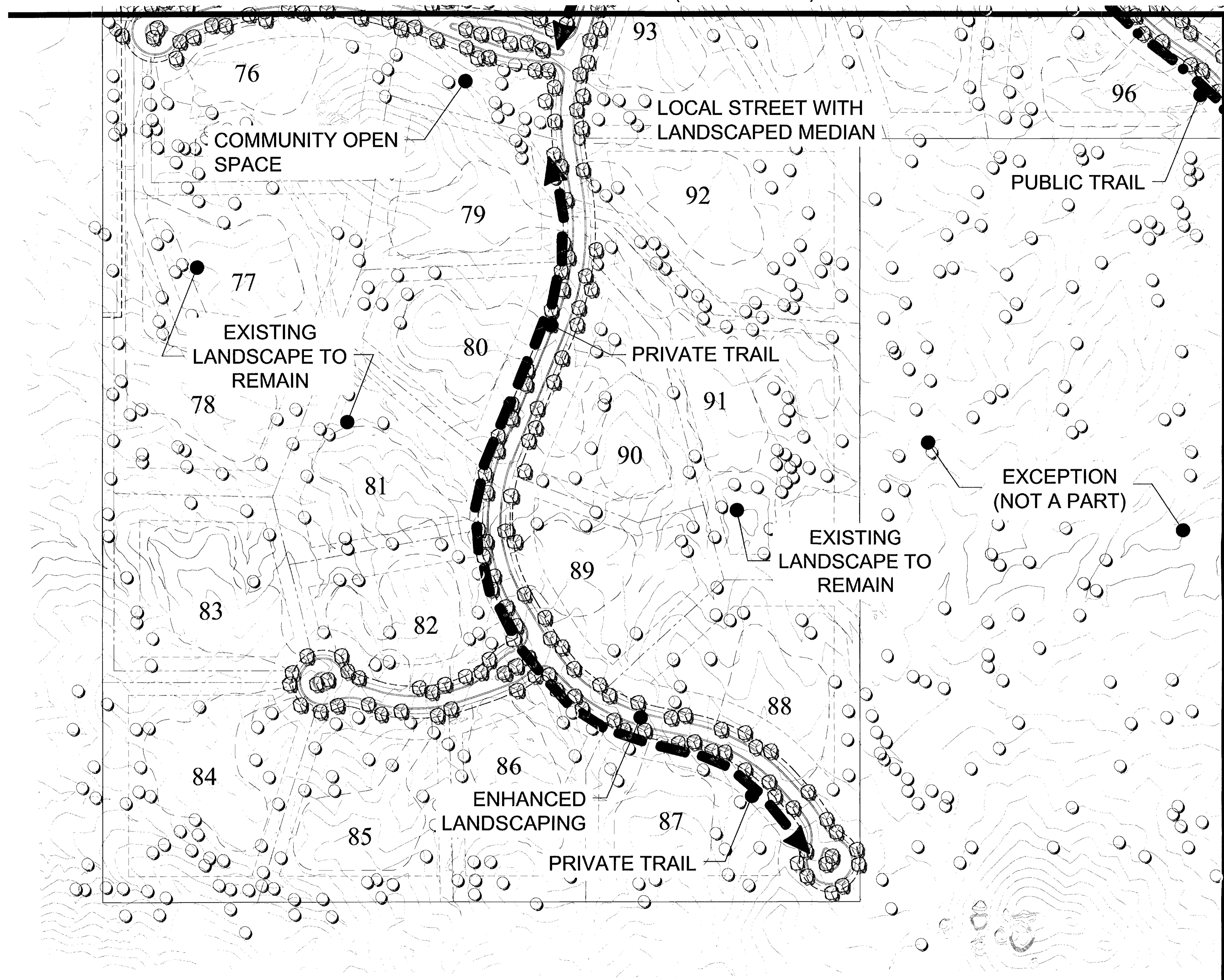

MATCHLINE (SEE SHEET 5)

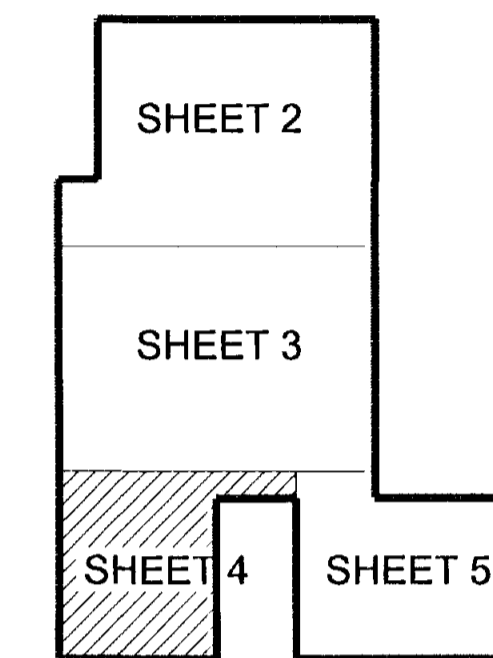

SHEET KEY
NO SCALE

LANDSCAPE LEGEND

- Existing Tree / Veg. to remain
- New Landscape / Enhanced Veg.

TRAIL LEGEND

- Public Trail Alignment (8')
- Private Trail Alignment (8')

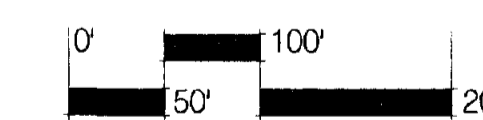

**SHEET
4 OF 5**

SERENO CANYON

LANDSCAPE PLAN / SITE PLAN ENLARGEMENT

MATCHLINE (SEE SHEET 3)

MATCHLINE (SEE SHEET 4)

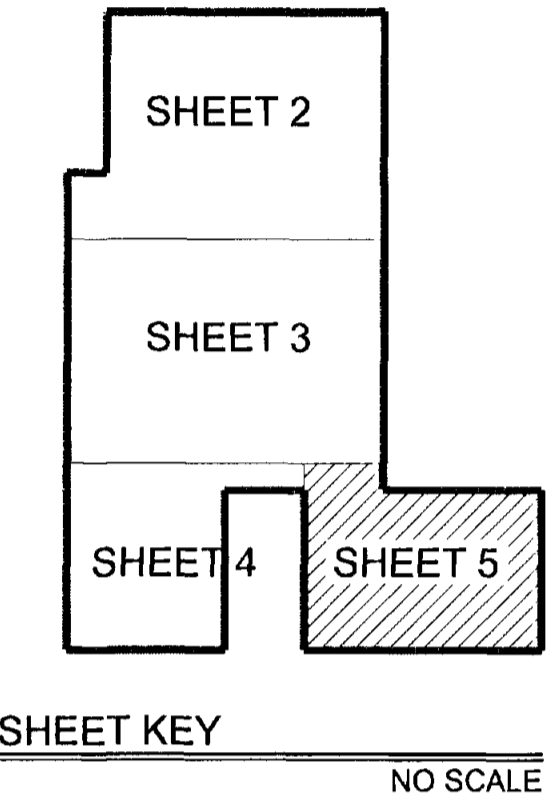
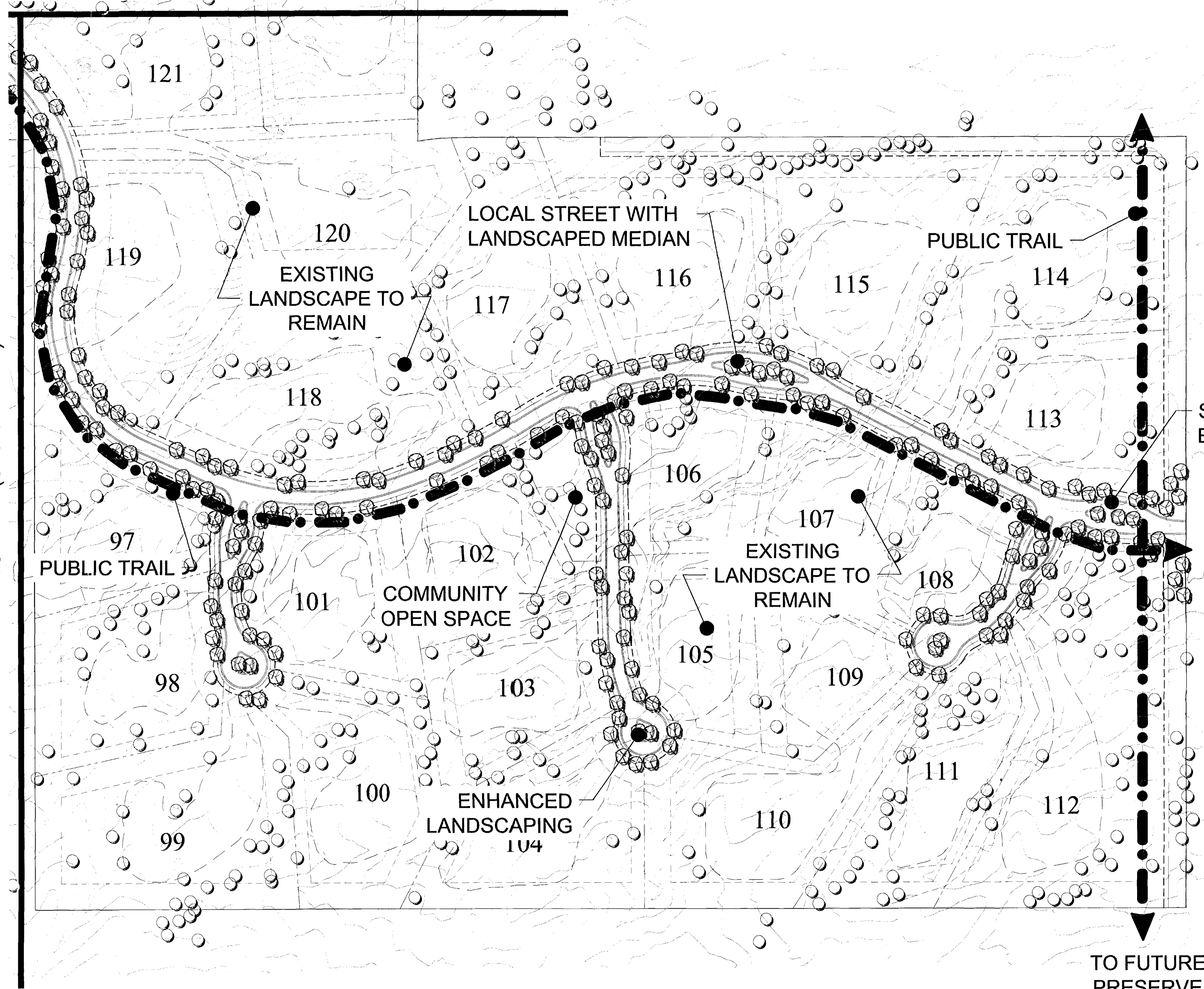

- LANDSCAPE LEGEND**
- Existing Tree / Veg. to remain
 - New Landscape / Enhanced Veg.
- TRAIL LEGEND**
- Public Trail Alignment (8')
 - Private Trail Alignment (8')

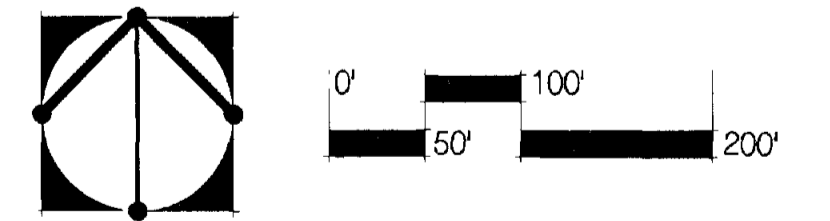

SHEET
5 OF 5

SERENO CANYON

LANDSCAPE PLAN / SITE PLAN ENLARGEMENT