

Landscape Concept Statement

The proposed Sereno Canyon development occupies a very unique and interesting parcel of land that lies just north of the McDowell Mountain Preserve. Many areas on the site were damaged in the mid 1990's during a wildfire that destroyed much of the native trees and cacti the once covered the landscape. Over the last 10+ years the site has been left undisturbed and had begun to naturally revegetate itself. Scattered throughout the project are many boulder features and topographical points of interest that are showcased in the plan shown here. Roads and site features have been designed to meander around natural features and have also aligned viewsheds and traffic sightlines to capitalize on the spectacular views the site has to offer.

As with any new development, roadway scarring and infrastructure improvements will leave behind some disturbed areas that must be addressed. New landscaping is proposed to be installed to revegetate these areas, including the water and sewer line easements and any other existing jeep trails and construction scarring left behind from previous owners. Enhanced desert landscaping is proposed to be included at the project entry points, intersections, roadway medians, and finally at the clubhouse facility. This enhanced landscape treatment will include many plants used in roadway revegetation areas, but will also employ the use of specimen type trees, cacti, and colorful accents to reinforce the landscape hierarchy which gives the viewer a visual cadence and sense of arrival.

Residents in Sereno Canyon will also be able to utilize three community amenity locations that are spread throughout the development. These amenities shall be designed to allow for the preservation of the existing landscape, but will add additional native trees and understory plantings to encourage wildlife activity. A watering hole concept will be implemented to allow a place for watching birds and other wildlife. Connecting the nature parks will be a network of trails (some public) that will allow for the residents to have an opportunity to interact with their surroundings in a more personal way.

The following plant palette has been adopted from the City of Scottsdale's E.S.L.O. plant list. (All species shown below are in conformance with E.S.L.O. standards)

TREES

- Whitethorn Acacia
- Caclaw Acacia
- Crucifixion Thorn
- Hackberry
- Blue Palo Verde
- Foothill Palo Verde
- Desert Willow
- One-seeded Juniper
- Ironwood
- Cottonwood
- Arizona Mesquite
- Scrub Oak
- Sugar Sumac
- Arizona Rosewood

- Acacia constricta
- Acacia greggii
- Canotia holocantha
- Celtis pallida
- Cercidium floribundum
- Cercidium microphyllum
- Chilopsis linearis
- Juniperus monosperma
- Olneya tesota
- Populus fremontii
- Prosopis juliflora
- Quercus turbinella
- Rhus ovata
- Vauquelinia californica

SUCCULENTS / CACTI

- Saguaro
- Hedgehog Cactus
- Compass Barrel
- Barrel
- Fishhook Barrel
- Ocotillo
- Fishhook Cactus
- Cactus
- Staghorn Cholla
- Cholla
- Teddy Bear Cholla
- Engelmann's Prickly-pear
- Chainfruit Cholla
- Desert Christmas Cholla
- Night-Blooming Cereus
- Banana Yucca
- Soap-tree Yucca

- Carnegiea gigantea
- Echinocereus engelmannii
- Ferocactus cylindraceus
- Ferocactus wislizenii Barrel
- Fouquieria splendens
- Mammillaria microcarpa
- Opuntia acanthocarpa
- Opuntia bigelovii Cholla
- Opuntia engelmannii
- Opuntia fulgida
- Opuntia leptocadis
- Peniocereus greggii
- Yucca baccata
- Yucca elata

SHRUBS / BUSHES

- Giant Bursage
- Triangle-leaf Bursage
- White Bursage
- Desert Honeysuckle
- Fourwing Saltbush
- Quailbush
- Desert Saltbush
- Red Barberry
- Fairy Duster
- Desert Senna
- Desert Hackberry

- Ambrosia ambrosioides
- Ambrosia deltoidea
- Ambrosia dumosa
- Anisacanthus thurberi
- Atriplex canescens
- Atriplex lentiformis
- Atriplex polycarpa
- Berberis haematocarpa
- Calliandra eriophylla
- Cassia covetii
- Celtis pallida

- Hopbush
- Sacred Datura
- Brittlebush
- Green Brittlebush
- Mormon Tea
- Turpentine Bush
- Flat-top Buckwheat
- Snakeweed
- Desert Lavender
- Chuparrosa
- Creosote Bush
- Deer Vetch
- Wolfberry
- Arrow Weed
- Joboba Bush
- Trixis
- Goldeneye
- Greythorn

ANNUALS / PERENNIALS / VINES

- Sand Verbena
- Fiddleneck
- Desert Marigold
- Coyote Gourd
- Desert Hyacinth
- Dogweed
- Woolly Daisy
- Mexican Gold Poppy
- Gaillardia
- Starflower
- Slender Janusia Vine
- Goldfields
- Bladderpod Mustard
- Desert Lupine
- Purple Aster
- Blackfoot Daisy
- Owl's Clover
- Parry's Penstemon
- Arizona Penstemon
- Desert Bluebell
- Scorpionweed
- Cream Cups
- Devil's Claw
- Paper Flower
- Indian Wheat
- Desert Chicory
- Desert Chia
- Desert Globemallow
- Desert Straw

GRASSES

- Purple Threeawn
- Needle grama
- Sideoats grama
- Curly mesquite
- Flutgrass

The following plant palette is in addition to the above referenced list. The following species will be used in and around the developments clubhouse and connected common areas. (These areas will not be counted as revegetated NAOS)

TREES

- Cascatote
- Desert Willow
- Gregg Ash
- Texas Ebony
- flexicaule
- Caesalpinia calacalo
- Chilopsis linearis
- Fraxinus greggii
- Pithecellobium

SUCCULENTS / CACTI

- Desert Milkweed
- Agave
- Golden Barrel
- Giant Hesperaloe
- Semta
- Organ Pipe Cactus
- Asclepius subulata
- Agave Species
- Echinocactus grasonii
- Hesperaloe funifera
- Lophocereus schottii
- Stenocereus thurberi

SHRUBS / BUSHES

- Black Dalea
- Sage
- Baja Ruellia
- Desert Ruellia
- Autumn Sage
- Dalea frutescens
- Leucophyllum species
- Ruellia Brittoniana
- Ruellia peninsularis
- Salvia greggii

ANNUALS / PERENNIALS / VINES

- Potted annual flowers
- Angelita Daisy
- Yellow morning glory
- By season
- Hymenoxys acaulis
- Merrima aurea

GRASSES

- Beargrass
- Hybrid bermuda lawn
- equal/Cynodon dactylon
- Nolina erumpens
- (Tifway 419 or

This list is intended as a guide and is subject to change. Any changes shall be approved by City staff as required.

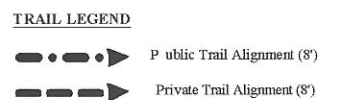
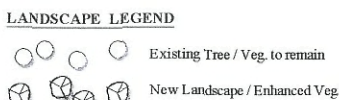
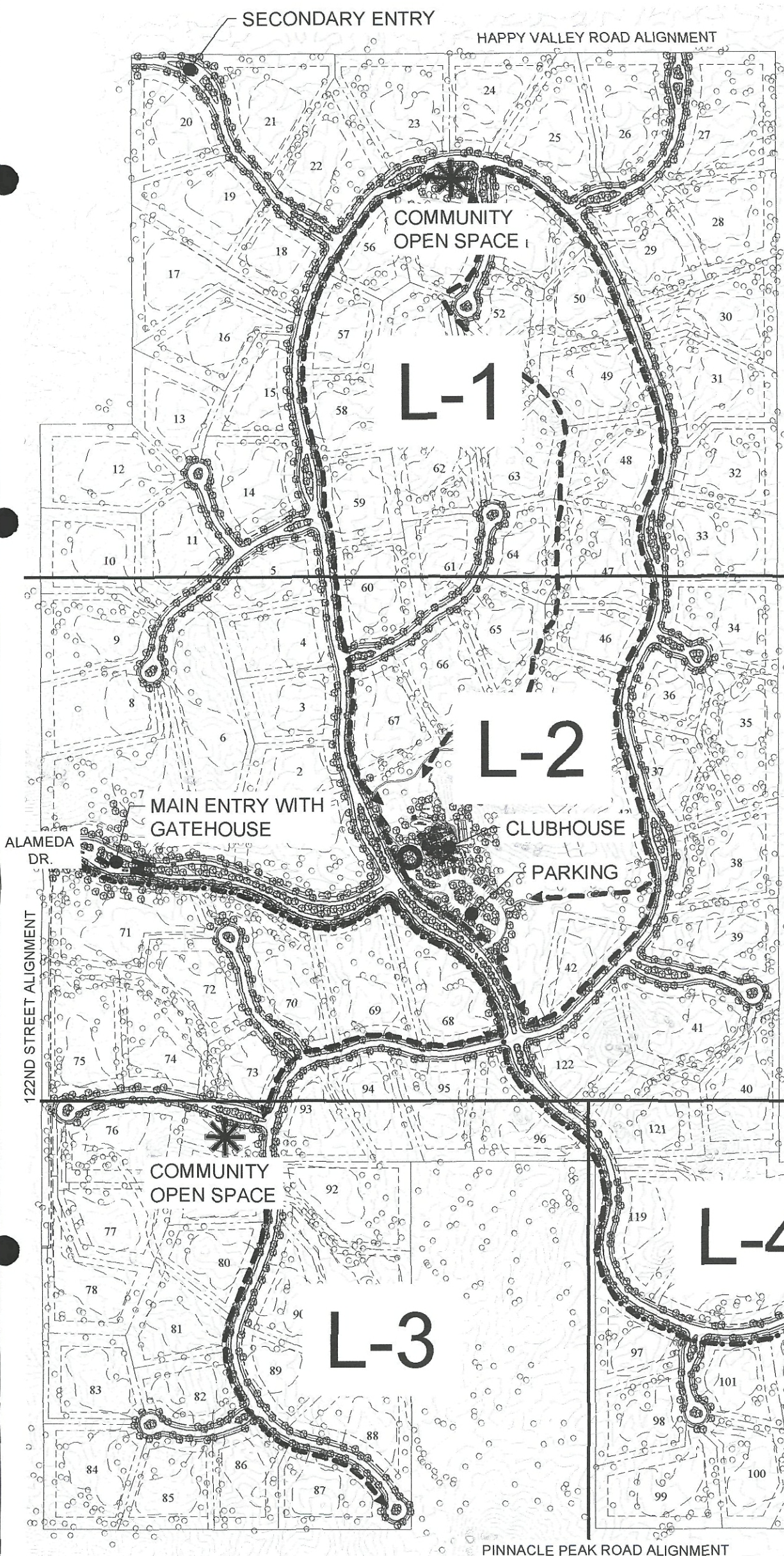

LANDSCAPE LIGHTING

Low voltage landscape lighting is proposed to be installed at the 3 project entry locations, the clubhouse entry, clubhouse parking lot, and near the clubhouse patio and pool areas. All lighting proposed is to have full cut off glare shields and will be used to only highlight landscape features. Fixtures selected shall be of a bronze or black finish and shall compliment the style of the building light fixtures.

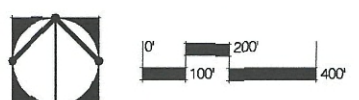

SHEET 1 OF 5



SERENO CANYON

OVERALL LANDSCAPE / SITE PLAN

Date: 12.07.05
 Job No: 0425
 Drawn by: JMY

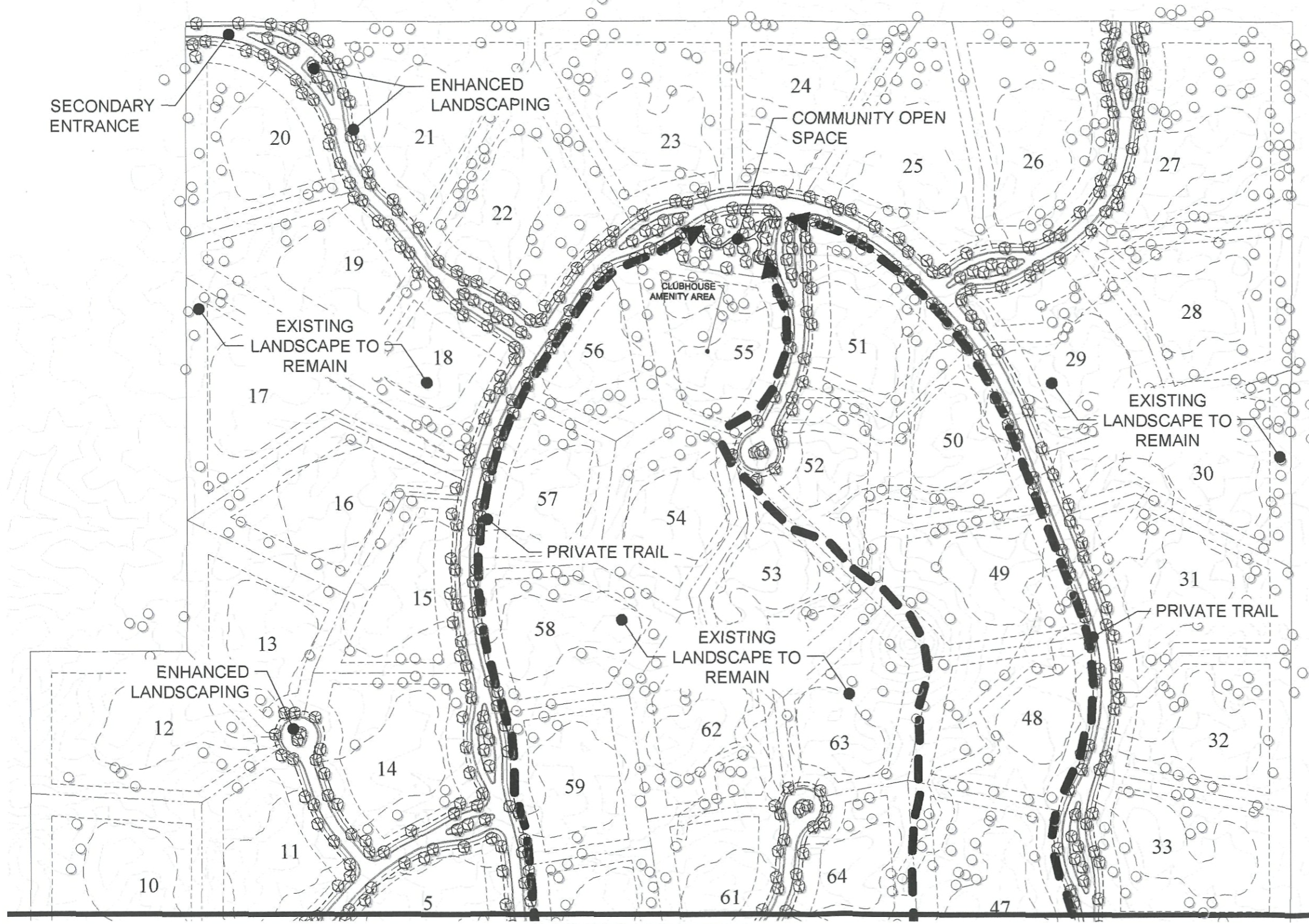

MATCHLINE (SEE SHEET 3)

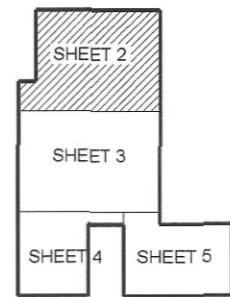

SHEET KEY
NO SCALE

- LANDSCAPE LEGEND**
- Existing Tree / Veg. to remain
 - New Landscape / Enhanced Veg.
- TRAIL LEGEND**
- Public Trail Alignment (8')
 - Private Trail Alignment (8')



SHEET
2 OF 5



Water Planning, Community,
Land Planning,
Site Planning & Design,
Environmental Analysis &
Landscape Design
3022 East Main Street
Scottsdale, Arizona 85251
Phone: 480.326.4200
Fax: 480.326.7322
www.lva.org

SERENO CANYON

LANDSCAPE PLAN / SITE PLAN ENLARGEMENT

Date:
12.07.05
Job No:
0425
Drawn by:
R.A.V.

22-PP-05 & 113-DR-05
12/19/05

MATCHLINE (SEE SHEET 2)

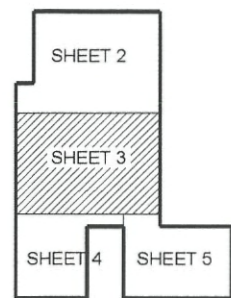
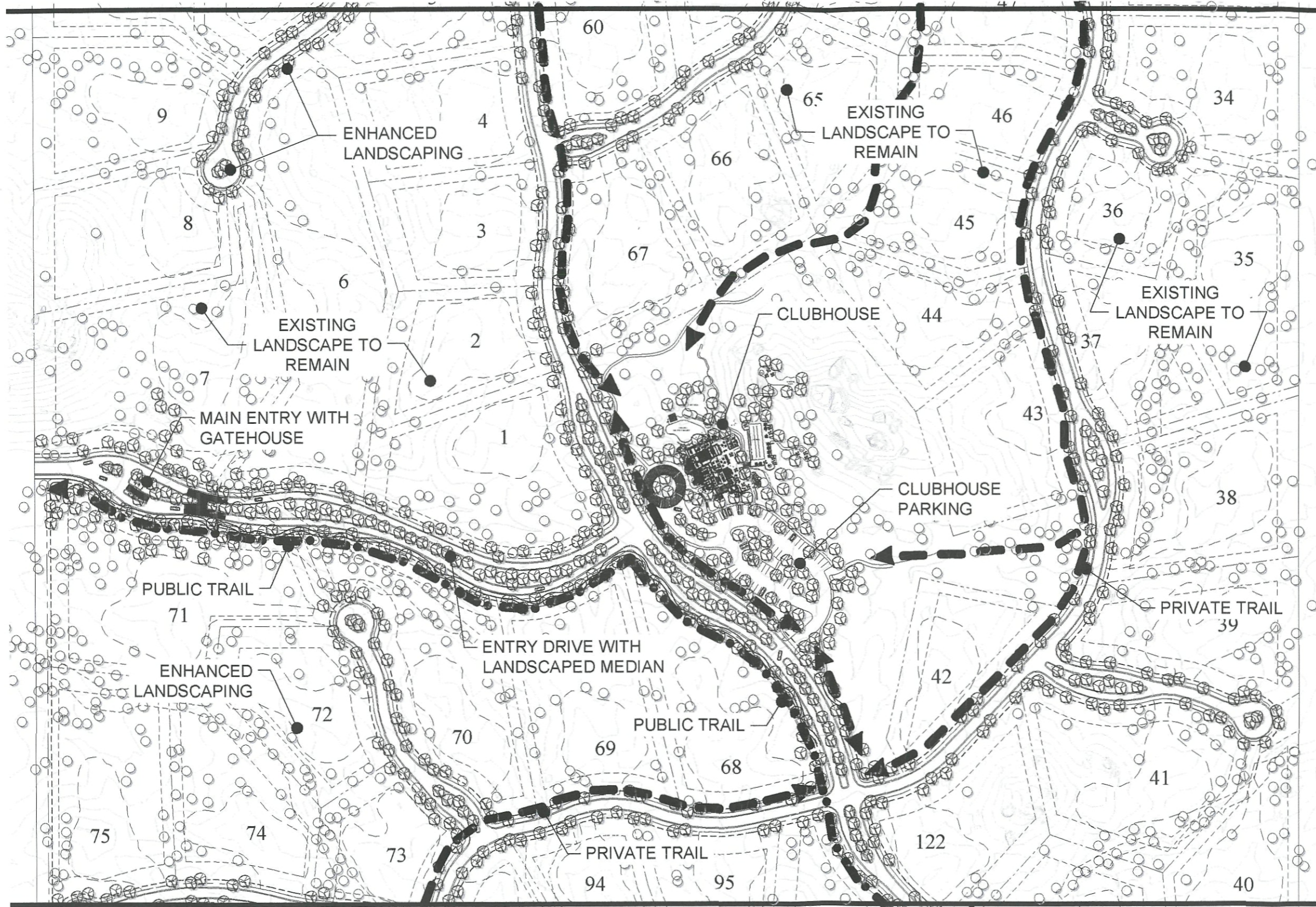

SHEET KEY
NO SCALE

LANDSCAPE LEGEND

- Existing Tree / Veg. to remain
- New Landscape / Enhanced Veg.

TRAIL LEGEND

- Public Trail Alignment (8')
- Private Trail Alignment (8')

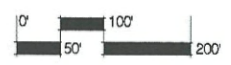

MATCHLINE (SEE SHEET 4)

MATCHLINE (SEE SHEET 5)

SHEET
3 OF 5



Master Planned Communities,
Land Planning,
Site Planning & Design,
Environmental Analysis &
Landscape Design

7102 East Main Street
Scottsdale, Arizona 85251
Phone: 480.354.0264
Fax: 480.354.7332
www.lvaaz.com

SERENO CANYON

LANDSCAPE PLAN / SITE PLAN ENLARGEMENT

Date:
12.07.05
Job No:
0425
Drawn by:

22-PP-05 & 113-DR-05
12/19/05

MATCHLINE (SEE SHEET 3)

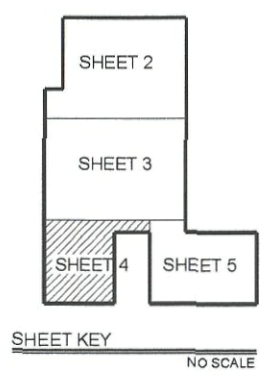
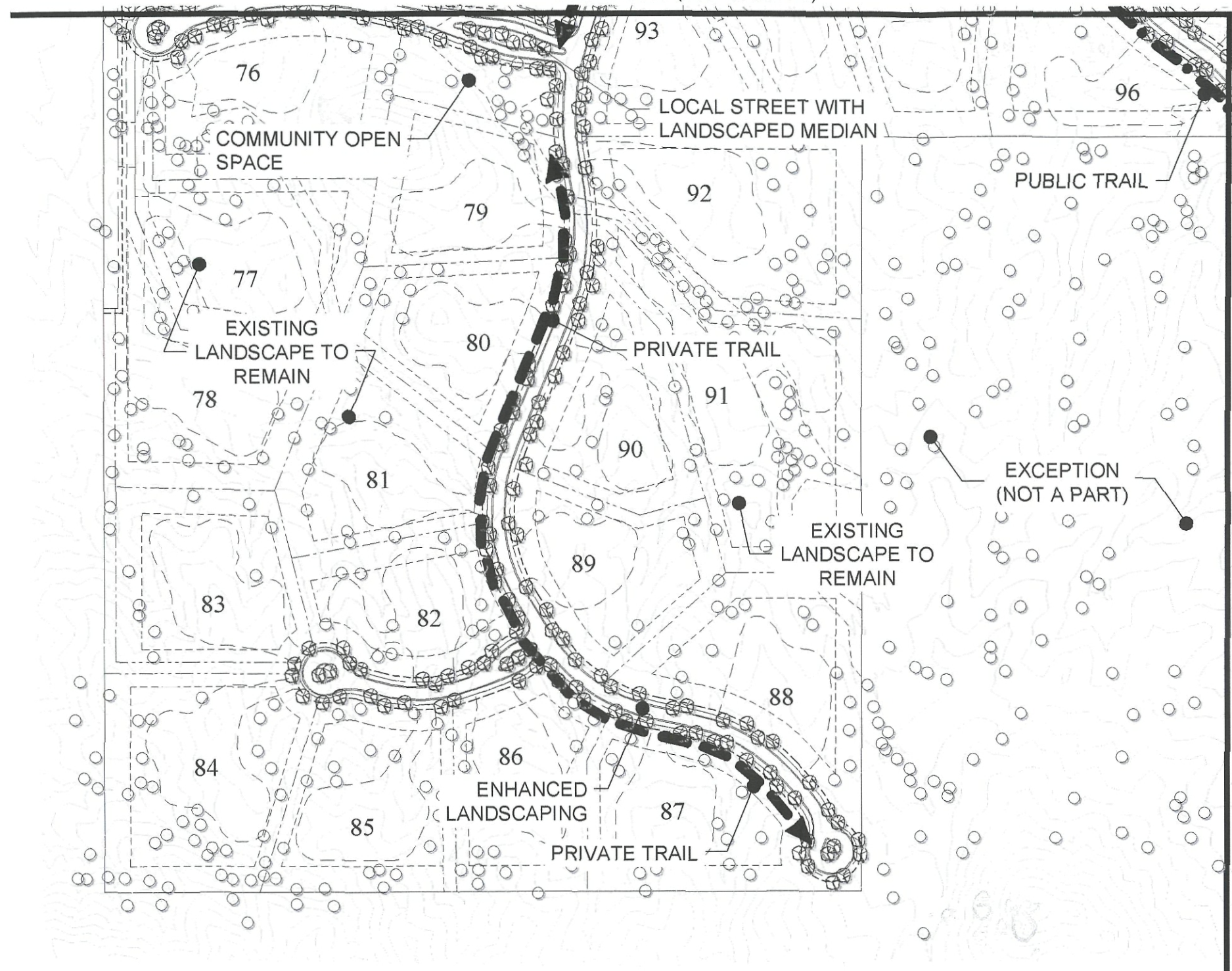

- LANDSCAPE LEGEND**
- Existing Tree / Veg. to remain
 - New Landscape / Enhanced Veg.
- TRAIL LEGEND**
- Public Trail Alignment (8')
 - Private Trail Alignment (8')



SHEET
4 OF 5



Master-Planned Communities,
Land Planning,
Site Planning & Design,
Environmental Analysis &
Landscape Design
7502 East Main Street
Scottsdale, Arizona 85261
Phone: (480) 944-4284
Fax: (480) 944-7332
www.lva-design.com

SERENO CANYON

LANDSCAPE PLAN / SITE PLAN ENLARGEMENT

Date:
12.07.05
Job No:
0425
Drawn by:
Y

-PP-05 & 113-DR-05
12/19/05

MATCHLINE (SEE SHEET 3)

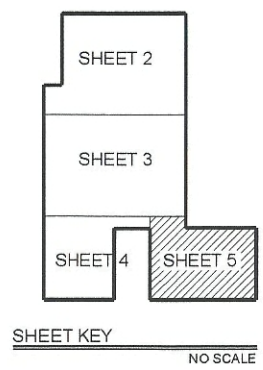
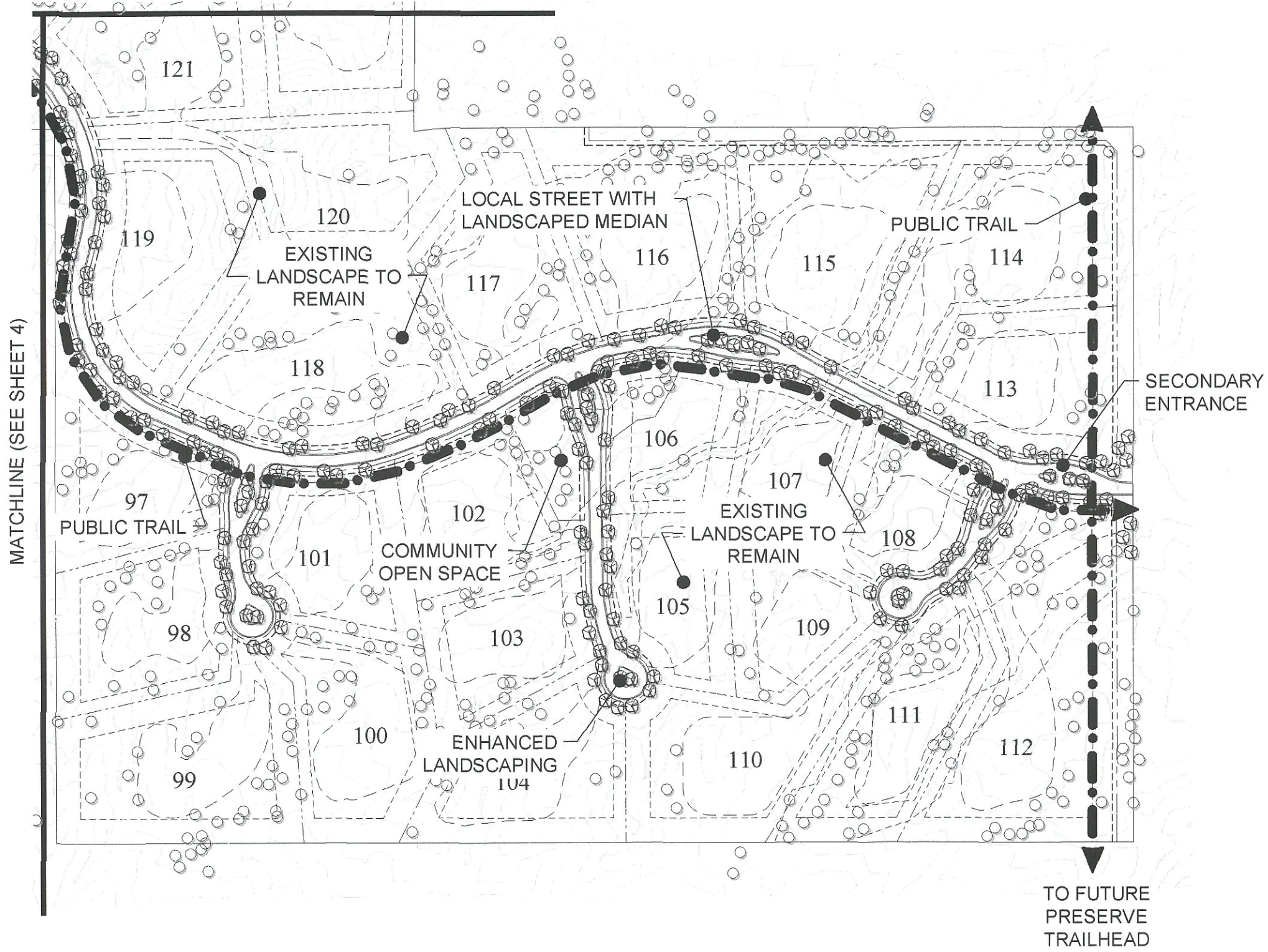

- LANDSCAPE LEGEND**
- Existing Tree / Veg. to remain
 - New Landscape / Enhanced Veg.
- TRAIL LEGEND**
- Public Trail Alignment (8')
 - Private Trail Alignment (8')

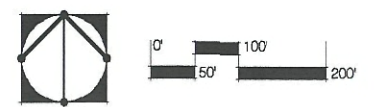

SHEET 5 OF 5



SERENO CANYON

LANDSCAPE PLAN / SITE PLAN ENLARGEMENT

Date: 12.07.05
Job No: 0425
Drawn by: 1Y

PP-05 & 113-DR-05
12/19/05