



CASE NO: _____

PROJECT LOCATION: NORTHSIGHT VILLAGE II - PAD 6
NWC BATHURUS / NORTHSIGHT BLVD.

COMMUNITY INPUT CERTIFICATION

In the City of Scottsdale it is important that all applicants for rezoning, use permit, and/or variances inform neighboring residents, affected school districts, and other parties that may be impacted by the proposed use, as well as invite their input. The applicant shall submit this completed certification with the application as verification that such contact has been made.

DATE	NAME (Person, Organization, Etc. and Address)	Type	Of	Contact
		Meeting	Phone	Letter
3/1/02	SEE ATTACHED LIST OF PROPERTY OWNERS & COPY OF LETTER & SITE PLAN SENT			

A handwritten signature in blue ink, appearing to be "K. G. ...", is written over a horizontal line.

Signature of owner/applicant

3/1/02

Nancy Kinney Macbeth
5507 N Palo Cristi Rd
Paradise Valley, AZ 85253-7516

Aspen Investors
PO Box 54250
Phoenix, AZ 85078-4250

Mall At The Crossroads Inc
19208 59Th Dr NE
Arlington, WA 98223-7708

Gisa Investments L L C
8420 E Butherus Dr #101
Scottsdale, AZ 85260-2572

Automotive L L C Goodys
8420 E Butherus Dr #102
Scottsdale, AZ 85260-2572

Der Enterprises Limited Partnership
5401 N 26Th St
Phoenix, AZ 85016-3637

Gordon-Darby Inc
3001 S 35Th St #4
Phoenix, AZ 85034-7233

Northsight Financial Office Park Inc
800 Newport Center Dr #300
Newport Beach, CA 92660-6315

Evans Corporate Park Llc
2944 N 44Th St #200
Phoenix, AZ 85018-7262

Con Vest Arizona Inc
14795 N 78Th Way #700
Scottsdale, AZ 85260-6915

Farmers New World Life Insurance Co
4680 Wilshire Blvd
Los Angeles, CA 90010-3807

Farmers New World Life Insurance C
4680 Wilshire Blvd
Los Angeles, CA 90010-3807

J & R Partnership Holdings Llc
PO Box 13311
Scottsdale, AZ 85267-3311

L L C Butherus
549 S 48Th St #108
Tempe, AZ 85281-2309



K & I ARCHITECTS & INTERIORS

February 28 2002

RE Northsight Village, Scottsdale, AZ

This letter is to advise you of a proposed development in the vicinity of your property in North Scottsdale. The proposed development includes:

Northsight Village II	Pad 6, a 8,690 SF retail building on an existing pad. The exterior of the building will match that of the existing buildings on Pads 4 & 5.
Northsight Village III	Site development of 2.5 acres and 23,511 SF retail shop building. The exterior of the building will be similar in character to the proposed Scottsdale Gun Club (major tenant to the south), as well as the shopping center to the north.

A site plan for both projects is attached. Should have any questions or comments regarding the development of either of these projects, please don't hesitate to give me a call.

Sincerely yours,

Kristjan Sigurdsson, President
K&I Architects & Interiors, LLC

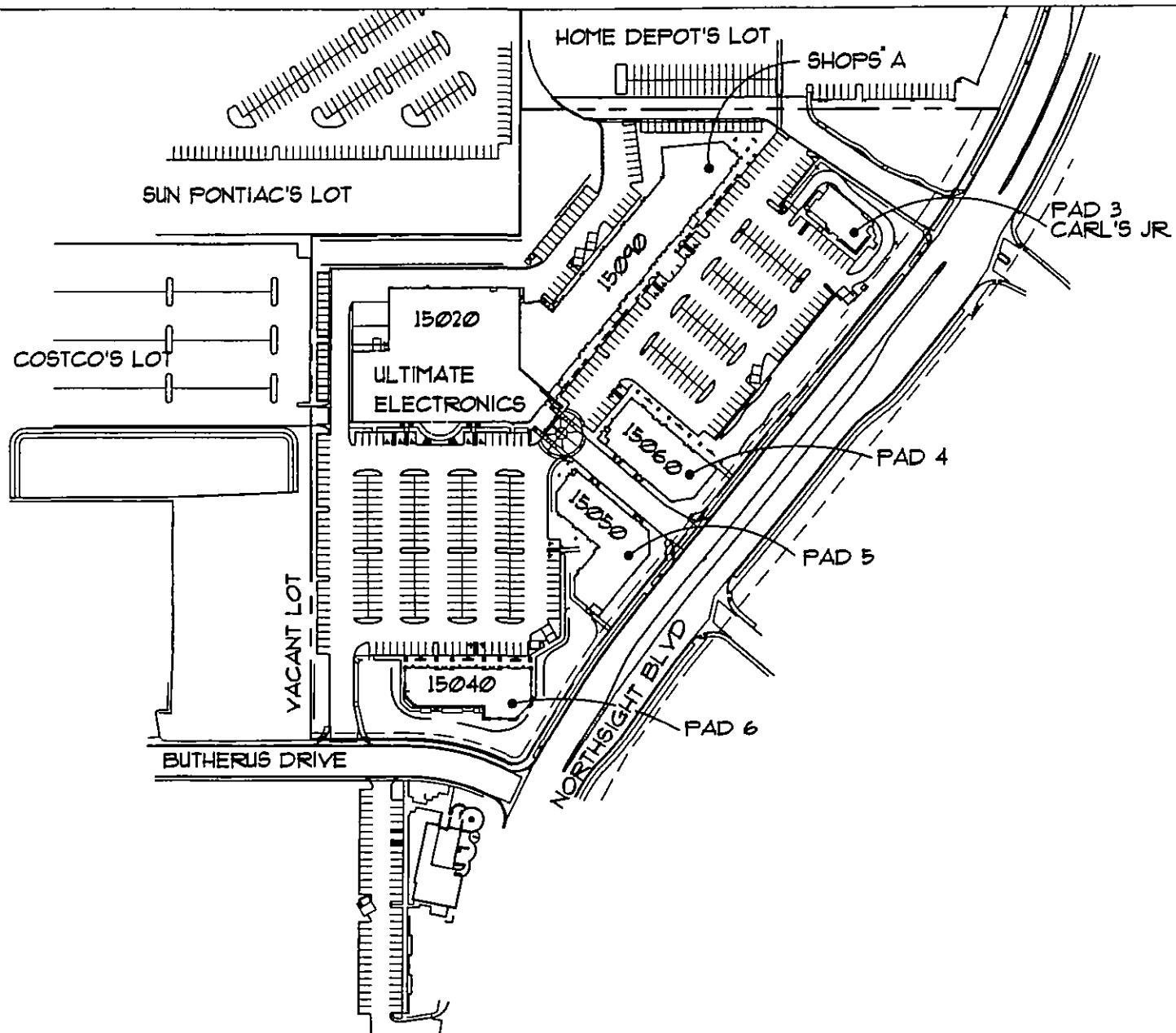

K & I

ARCHITECTS & INTERIORS LLC

1850 N CENTRAL AVE #335

PHOENIX, AZ 85004

PH 602-252-5202

FAX 602-252-5203

01100

DATE 2/21/02

NORTHSIGHT VILLAGE II

NWC BUTHERUS AND NORTHSIGHT BLVD

SCOTTSDALE, ARIZONA

OVERALL SITE PLAN



SCALE 1" = 200'-0"

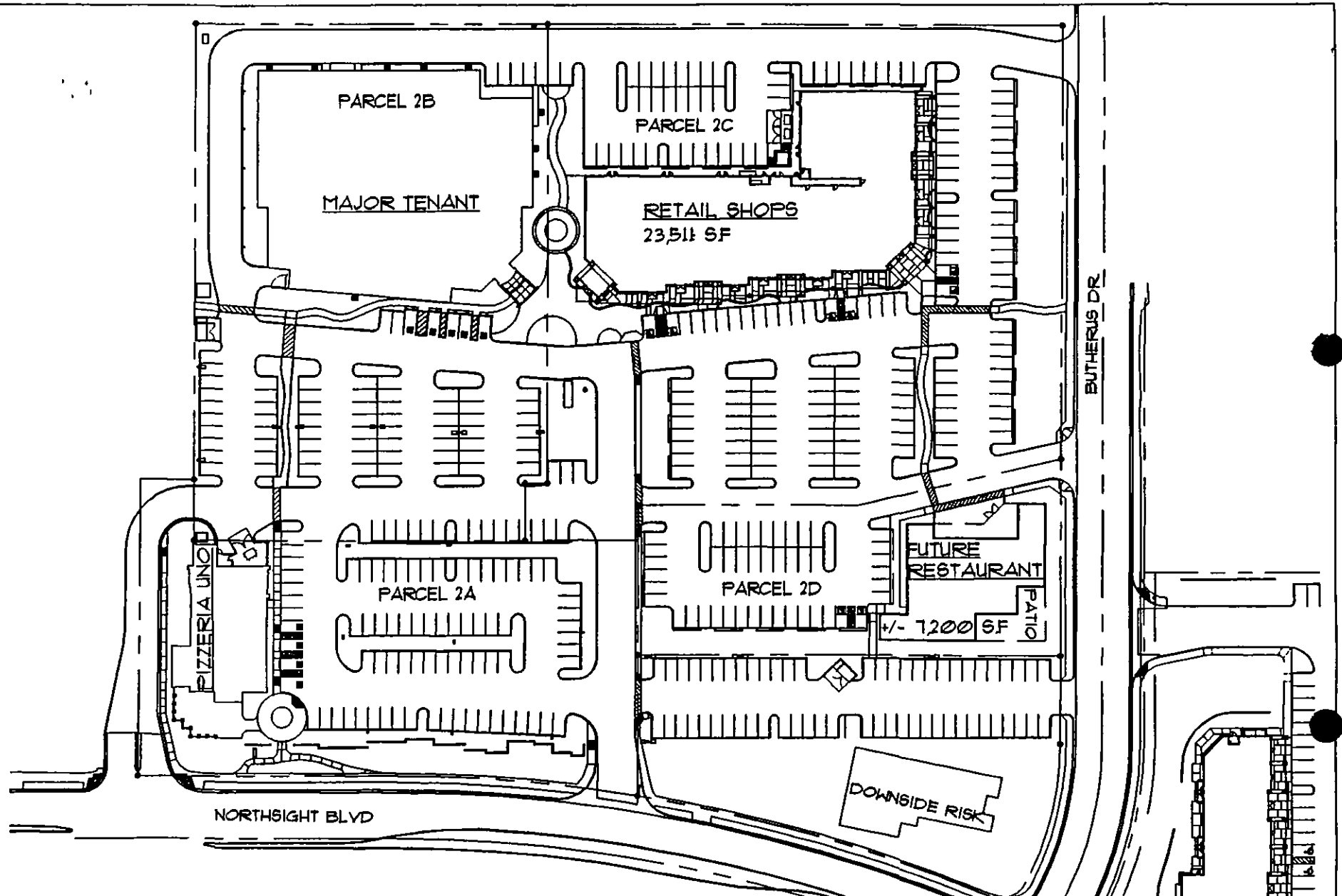

K & I

ARCHITECTS & INTERIORS LLC

1850 N CENTRAL AVE #335
PHOENIX, AZ 85004

PH 602-252-5202

FAX 602-252-5203

DATE: 1/18/02

01110

NORTHSIGHT VILLAGE III

SWC BUTHERUS AND NORTHSIGHT BLVD

SCOTTSDALE, ARIZONA

OVERALL SITE PLAN

NORTH

SCALE 1" = 100' - 0"