

Craig  
Wickersham Inc.  
Architects  
15821 N. 79th Street  
Suite 2  
Scottsdale, AZ 85260  
480 609-6766

**DISCLAIMER:**  
This drawing is prepared by the architect for the purpose shown and shall not be used for any other purpose without the written consent of the architect. The architect is not responsible for the accuracy of the information provided by others and does not warrant the accuracy of the information provided by others. The architect is not responsible for the accuracy of the information provided by others and does not warrant the accuracy of the information provided by others.

**REVISIONS:**

NO.	DATE	BY	DESCRIPTION
1			
2			
3			
4			
5			

**Sereno Canyon**  
 Crown Community Development



21-UP-2005  
2nd: 3/21/2007

JOB NO. 0702  
DATE: January 07  
SCALE: AS SHOWN  
DRAWN: WCW  
CHECKED: WCW

SHEET NO. XXXX

Site Plan 1/16" = 1-0  
21-UP-05  
3/2/07

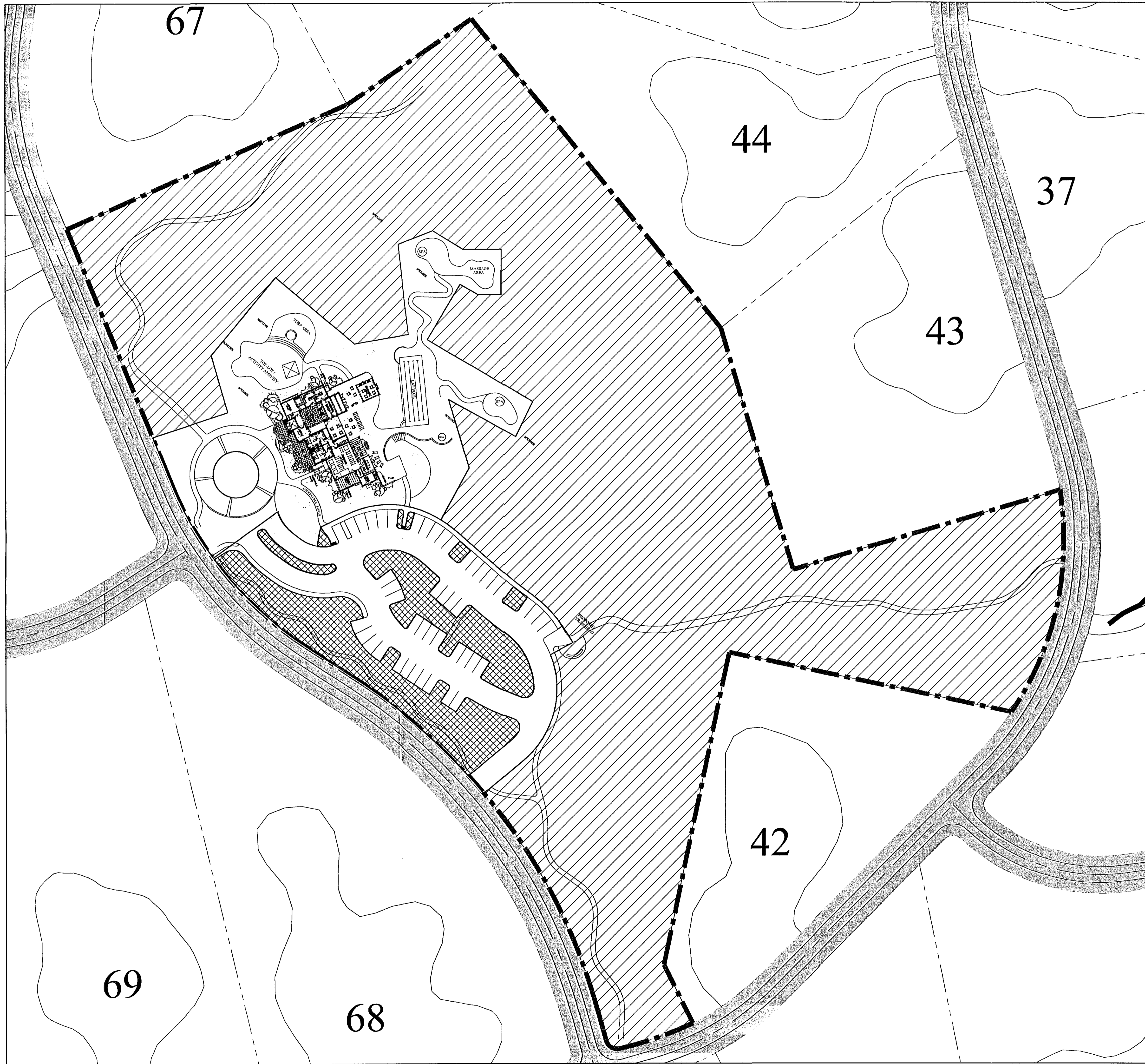

# Sereno Canyon

## SITE PLAN WORKSHEET

### OPEN SPACE CALCULATIONS:

 DENOTES OPEN SPACE OTHER THAN PARKING LOT LANDSCAPING (400,000 SQ.FT.)

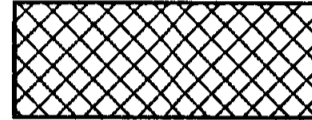
 DENOTES PARKING LOT LANDSCAPING AREA (16,300 SQ.FT.)

NET SITE AREA: 488,800 SQ.FT. (11.2 AC.)

REQUIRED OPEN SPACE:  
= 73,300 (15% OF NET SITE)

PROVIDED OPEN SPACE (NOT IN PARKING LOT AREA):  
= 228,100 SQ.FT.

PARKING LOT AREA: 65,300 SQ.FT. (1.5 AC.)

REQUIRED PARKING LOT O.S.  
= 9,800 SQ.FT. (15% OF PARKING LOT AREA)

PROVIDED PARKING LOT O.S.  
= 16,300 SQ.FT. (25% OF PARKING LOT AREA)

### SITE PLAN DATA:

EXISTING ZONING: R1-130 ESL

PROPOSED ZONING: R1-130 ESL D.I (Case# 1-ZN-2005)

GROSS FLOOR AREA: 5,895 Sq.Ft.

REQUIRED OPEN SPACE: N/A

PROVIDED OPEN SPACE: 244,400 Sq.Ft. (50% of Site Area)

SITE AREA (GROSS): 11.2 Acres or 488,792 Sq.Ft.

SITE AREA (NET): 11.2 Acres or 488,792 Sq.Ft.

REQUIRED PARKING SPACES: 30

PROVIDED PARKING SPACES: 47

TOTAL NON-ACCESSIBLE SPACES: 45

TOTAL ACCESSIBLE SPACES: 2

PHASING: 1 OF 1

BUILDING SETBACKS:

REQUIRED: FRONT: 60'

SIDE: 30'

REAR: 60'

PROVIDED: FRONT: 120' +/-

SIDE: 250'-300' +/-

REAR: 500' +/-



Scale: (+/-)

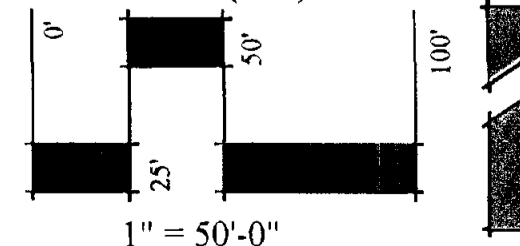

North



Date: 10.04.05  
Project: 0425  
By: AS  
Rev.: