

KEYNOTES

NEW DRAWING

SHEET NOTES

1. ALL LIGHTING AND POWER CONDUCTORS SHALL BE #10 AWG IN 3/4" CONDUIT MINIMUM, U.N.O.
2. ALL CIRCUITS VIA LOW VOLTAGE CONTROL PANEL #2.
3. FOR PANEL SCHEDULES, CONTROLS, LOAD CALCULATIONS, ETC. SEE BUILDING B ELECTRICAL PLANS.

**Ellermann Schick**  
 Architecture/planning

727 E. MARYLAND AVE  
 Phoenix, AZ 85014  
 phone: 602.266.6202  
 fax: 602.265.6212

THIS DRAWING IS AN INSTRUMENT OF SERVICE. IT IS THE PROPERTY OF ELLERMANN & SCHICK, INC. AND MAY NOT BE REPRODUCED WITHOUT WRITTEN PERMISSION.

**THE PROMENADE - PHASE 2**  
 HARDSCAPE AND PERFORMANCE PLAZA  
 AT  
 S.E.C. OF FRANK LLOYD WRIGHT & SCOTTSDALE ROAD  
 SCOTTSDALE, ARIZONA  
**THE PEDERSON GROUP**

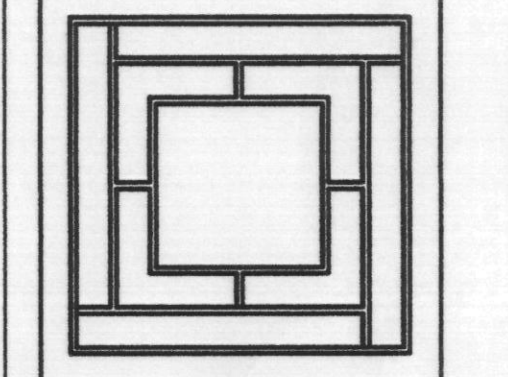

**Pederson GROUP INC.**

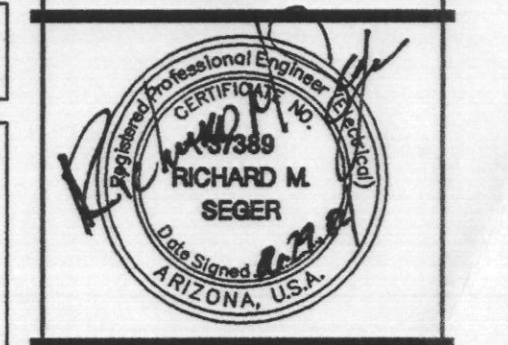

DATE	REVISION	DESCRIPTION
05/08/03		CITY COMMENTS
02/26/04		COORDINATION
05/24/04		OFFICE 'B' REVISIONS

SCHEMATIC	
DESIGN DEVELOPMENT	
CONSTRUCTION DOCUMENTS	
BID/PRICING PACKAGE	
BUILDING DEPT. APPROVAL	

DATE ISSUED 03.05.03  
 DRAWN BY TPS  
 CHECKED BY J. YURKUS  
 PROJECT NO. 22000  
 CADD FILE  
 SCALE: 1/8" = 1'-0"  
 DRAWING NO.

**E1.6**  
 HARDSCAPE ELECTRICAL

*Richard M. Seger*  
 OFFICE B  
 9.20.04  
 DATE

ARIZONA REVISED STATUTES 32-1129.01.  
 NOTICE OF EXTENDED CERTIFICATION AND APPROVAL PERIOD PROVISION.  
 This contract allows the owner to certify and approve billings and estimates within 30 days after the billings and estimates are received from the contractor.  
 NOTICE OF EXTENDED PAYMENT PROVISION.  
 This contract allows the owner to make payments within 30 days after certification and approval of billings and estimates.  
**T M A D** Engineers  
 Mechanical, and Electrical Consulting Engineers  
 7250 N. 16th Street, Suite 200  
 Phoenix, Arizona 85020  
 (602) 371-1333  
 Job No. 560X-00X.00

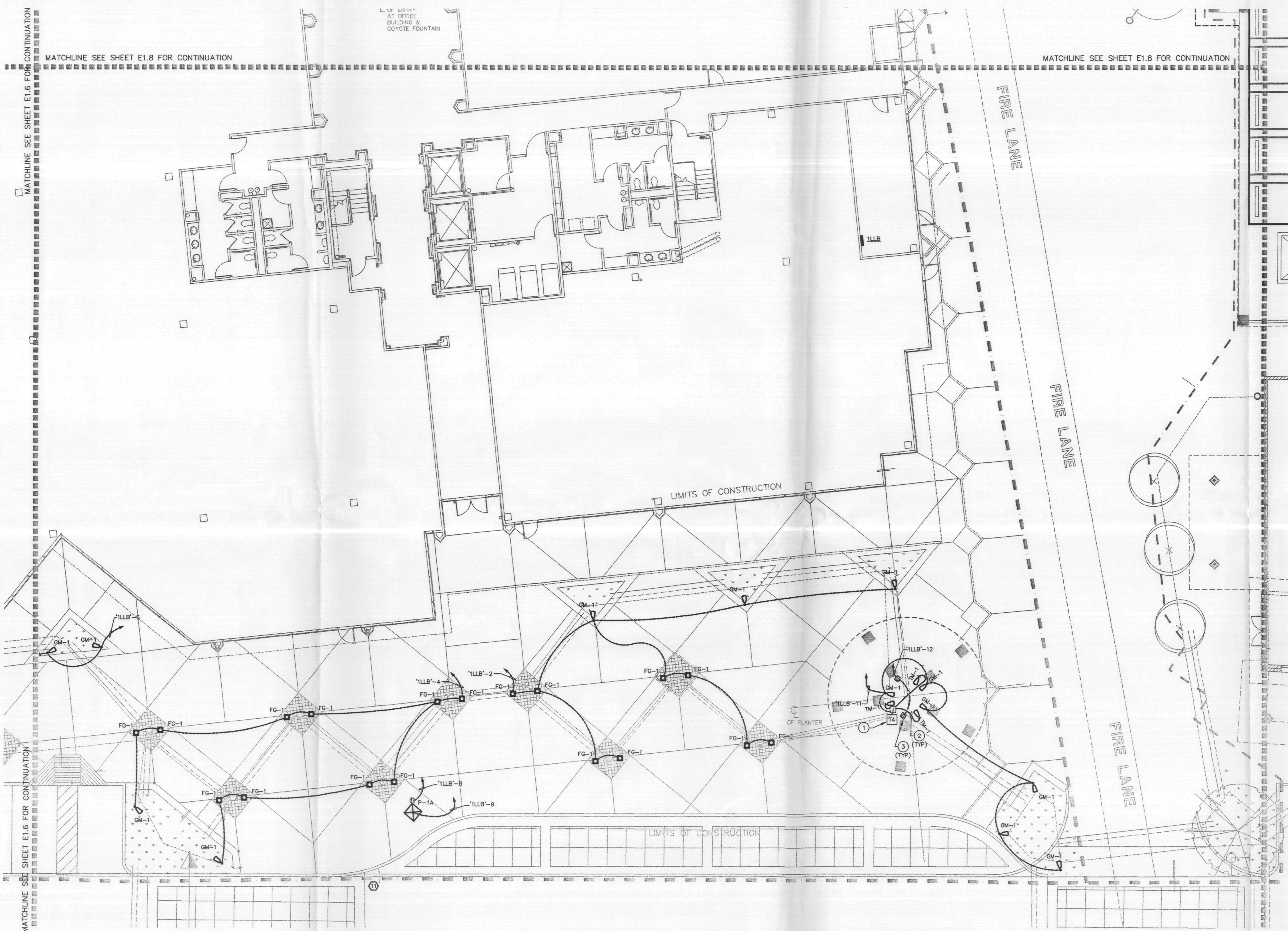

**KEYNOTES**

- 6" x 8" IN-GRADE SPICE BOX WITH "LIGHTING" COVER LOGO, COLOR TO MATCH SURROUNDING GROUND COVER. VERIFY WITH ARCHITECT. QUAZITE MODEL P0608BADS/P0608BADA0-29.
- 2#12 DIRECT BURY, LOW VOLTAGE LIGHTING CABLE (KIM KLV427) FROM SPICE BOX TO LIGHTS SUSPENDED IN TREES. FIELD VERIFY LIGHT LOCATIONS AND MOUNTING REQUIREMENTS WITH OWNER'S LIGHTING DESIGN CONSULTANT (CDL). PROVIDE EXTRA 20' CABLE IN EACH RUN COILED IN SPICE BOX FOR FUTURE TREE GROWTH.
- SEE CDL DRAWINGS AND SPECIFICATIONS FOR MOUNTING DETAILS.

NEW DRAWING

**SHEET NOTES**

- PANEL '1LLB' LOCATED IN SES ROOM 116.
- ALL LIGHTING AND POWER CONDUCTORS SHALL BE #10 AWG IN 3/4" CONDUIT MINIMUM, U.N.O.
- ALL CIRCUITS VIA LOW VOLTAGE CONTROL PANEL #2.
- FOR PANEL SCHEDULES, CONTROLS, LOAD CALCULATIONS, ETC. SEE BUILDING B ELECTRICAL PLANS.

**Ellermann Schick**  
architecturplanning

727 E. MARYLAND AVE  
PHOENIX, AZ 85014  
PHONE: 602.266.6202  
FAX: 602.265.6212

THIS DRAWING IS AN INSTRUMENT OF SERVICE. IT IS THE PROPERTY OF ELLERMANN & SCHICK, INC. AND MAY NOT BE REPRODUCED WITHOUT WRITTEN PERMISSION.

**THE PROMENADE - PHASE 2**  
HARDSCAPE AND PERFORMANCE PLAZA  
AT  
S.E.C. OF FRANK LLOYD WRIGHT & SCOTTSDALE ROAD  
SCOTTSDALE, ARIZONA  
**THE PEDERSON GROUP**

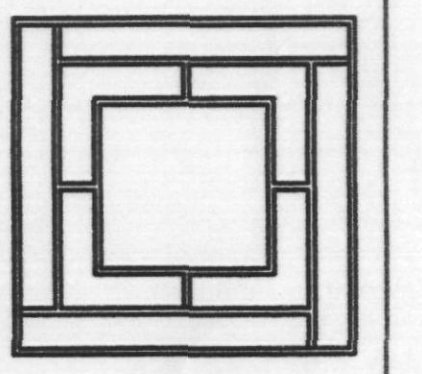

**Pederson**  
GROUP, INC.

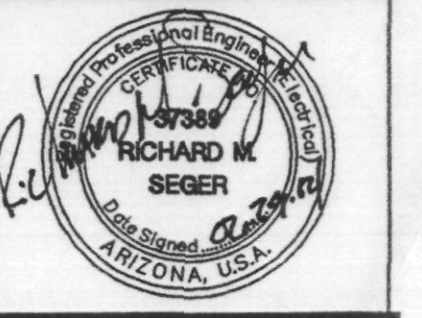

05/08/03	CITY COMMENTS
02/26/04	COORDINATION
03/24/04	OFFICE 'B' REVISIONS

	SCHEMATIC
	DESIGN DEVELOPMENT
	CONSTRUCTION DOCUMENTS
	BID/PRICING PACKAGE
	BUILDING DEPT. APPROVAL

DATE ISSUED	03.05.03
DRAWN BY	TPS
CHECKED BY	J. YURKUS
PROJECT NO.	22000
CADD FILE	
SCALE:	1/8" = 1'-0"
DRAWING NO.	

**E1.7**  
HARDSCAPE  
ELECTRICAL

ARIZONA REVISED STATUTES 32-1129.01.  
NOTICE OF EXTENDED CERTIFICATION AND APPROVAL PERIOD PROVISION.  
This contract allows the owner to certify and approve billings and estimates within 30 days after the billings and estimates are received from the contractor.  
NOTICE OF EXTENDED PAYMENT PROVISION.  
This contract allows the owner to make payments within 30 days after certification and approval of billings and estimates.

**T M A D** Engineers  
Mechanical, and Electrical Consulting Engineers  
7250 N. 16th Street, Suite 200  
Phoenix, Arizona 85020  
(602) 371-1333  
Job No. 560K-00X.00

*for Kurt Jones*  
**OFFICE B**  
APPROVED  
FINAL PLANS  
9.30.04  
DATE

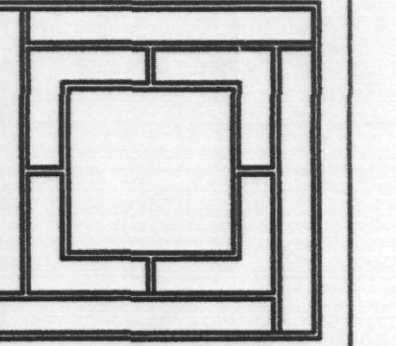

**Pederson**  
GROUP, INC.

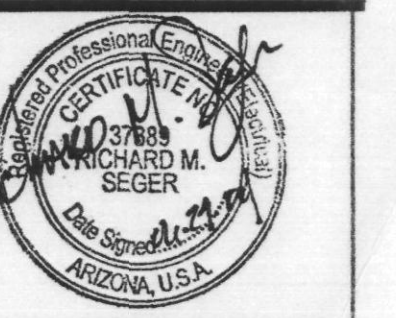

NO.	DATE	DESCRIPTION

SCHEMATIC  
DESIGN DEVELOPMENT  
CONSTRUCTION DOCUMENTS  
● BID/PRICING PACKAGE  
● BUILDING DEPT. APPROVAL

DATE ISSUED: 03.05.03  
DRAWN BY: TFS  
CHECKED BY: J. YURKUS  
PROJECT NO.: 22000  
CADD FILE:  
SCALE: 1/4" = 1'-0"

DRAWING NO. **E1.11**  
HARDSCAPE ELECTRICAL

**KEY NOTES**

- 1 ALL LIGHTING AND POWER CONDUCTORS SHALL BE #10 AWG IN 3/4" CONDUIT MINIMUM, U.I.C.O.
- 2 ALL CIRCUITS VIA LOW VOLTAGE CONTROL PANEL #2.
- 3 FOR PANEL SCHEDULES, CONTROLS, LOAD CALCULATIONS, ETC. SEE BUILDING 8 ELECTRICAL PLANS.

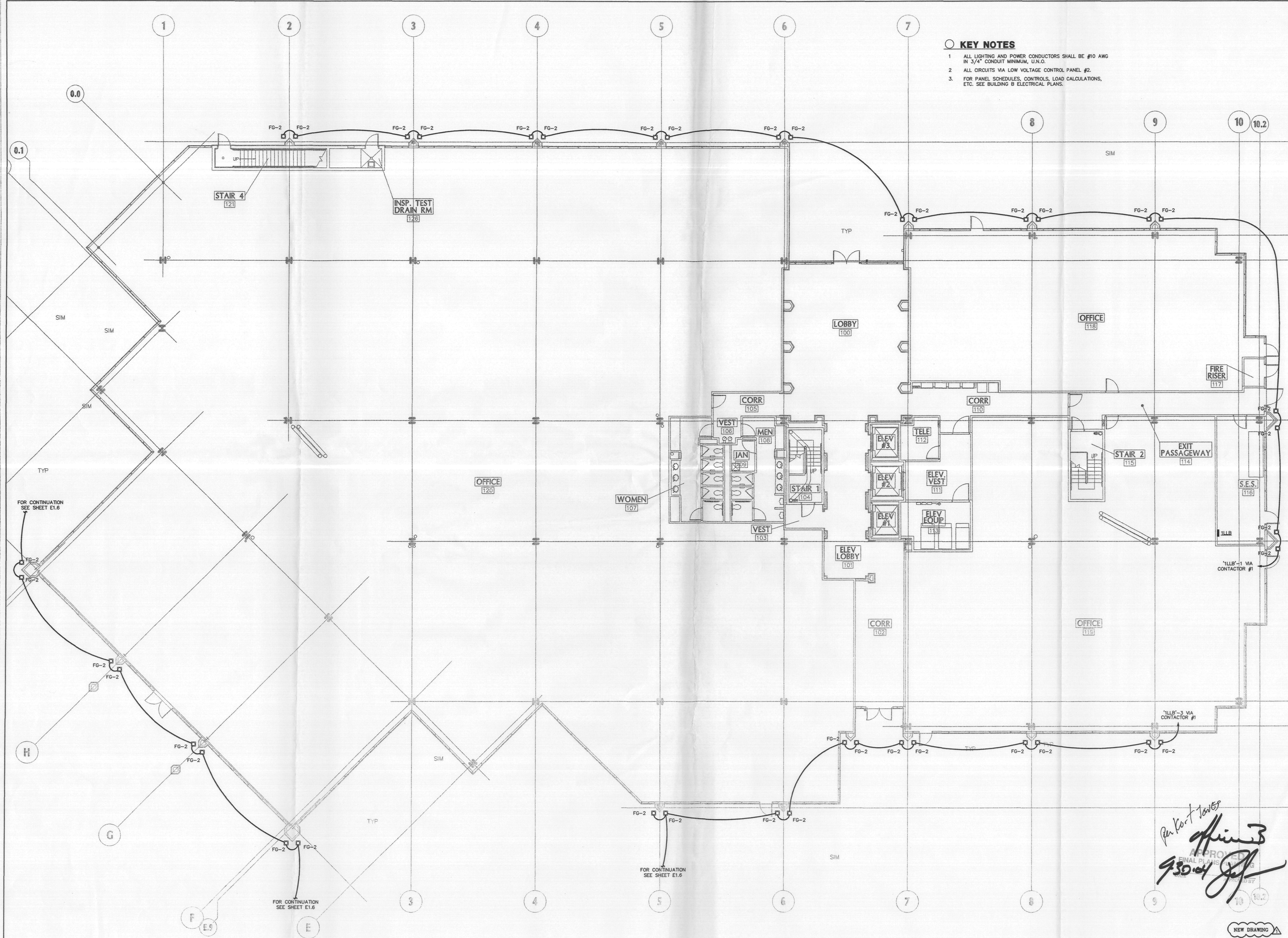

FOR CONTINUATION SEE SHEET E1.6

FOR CONTINUATION SEE SHEET E1.6

FOR CONTINUATION SEE SHEET E1.6

*Per Kurt Taylor*  
*offices*  
**APPROVED**  
FINAL PLANS  
9/30/04  
DRAWN BY

NEW DRAWING

KEYNOTES

Ellermann  
Schick  
Architecture/Planning

727 E. MARYLAND AVE  
Phoenix, AZ 85014  
phone: 602.266.6202  
fax: 602.265.6212

THIS DRAWING IS AN INSTRUMENT OF SERVICE. IT IS THE PROPERTY OF ELLERMANN & SCHICK, INC. AND MAY NOT BE REPRODUCED WITHOUT WRITTEN PERMISSION.

THE PROMENADE - PHASE 2  
HARDSCAPE AND PERFORMANCE PLAZA  
AT  
S.E.C. OF FRANK LLOYD WRIGHT & SCOTTSDALE ROAD  
SCOTTSDALE, ARIZONA  
FOR  
THE PEDERSON GROUP

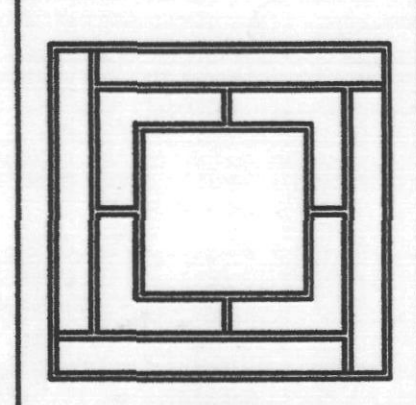

**Pederson**  
GROUP INC.

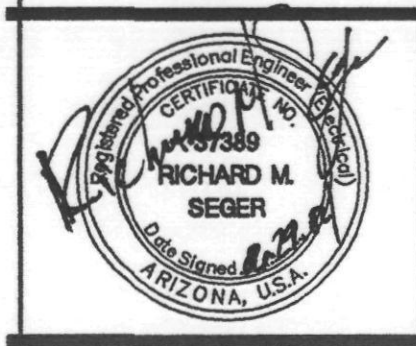

05/08/03	CITY COMMENTS
02/26/04	COORDINATION
05/24/04	OFFICE 'B' REVISIONS

<input type="checkbox"/>	SCHEMATIC
<input type="checkbox"/>	DESIGN DEVELOPMENT
<input type="checkbox"/>	CONSTRUCTION DOCUMENTS
<input type="checkbox"/>	BID/PRICING PACKAGE
<input type="checkbox"/>	BUILDING DEPT. APPROVAL

DATE ISSUED 03.05.03  
DRAWN BY TPS  
CHECKED BY J. YURKUS  
PROJECT NO. 22000  
CADD FILE  
SCALE: 1/8"=1'-0"  
DRAWING NO.

**E1.6**  
HARDSCAPE ELECTRICAL

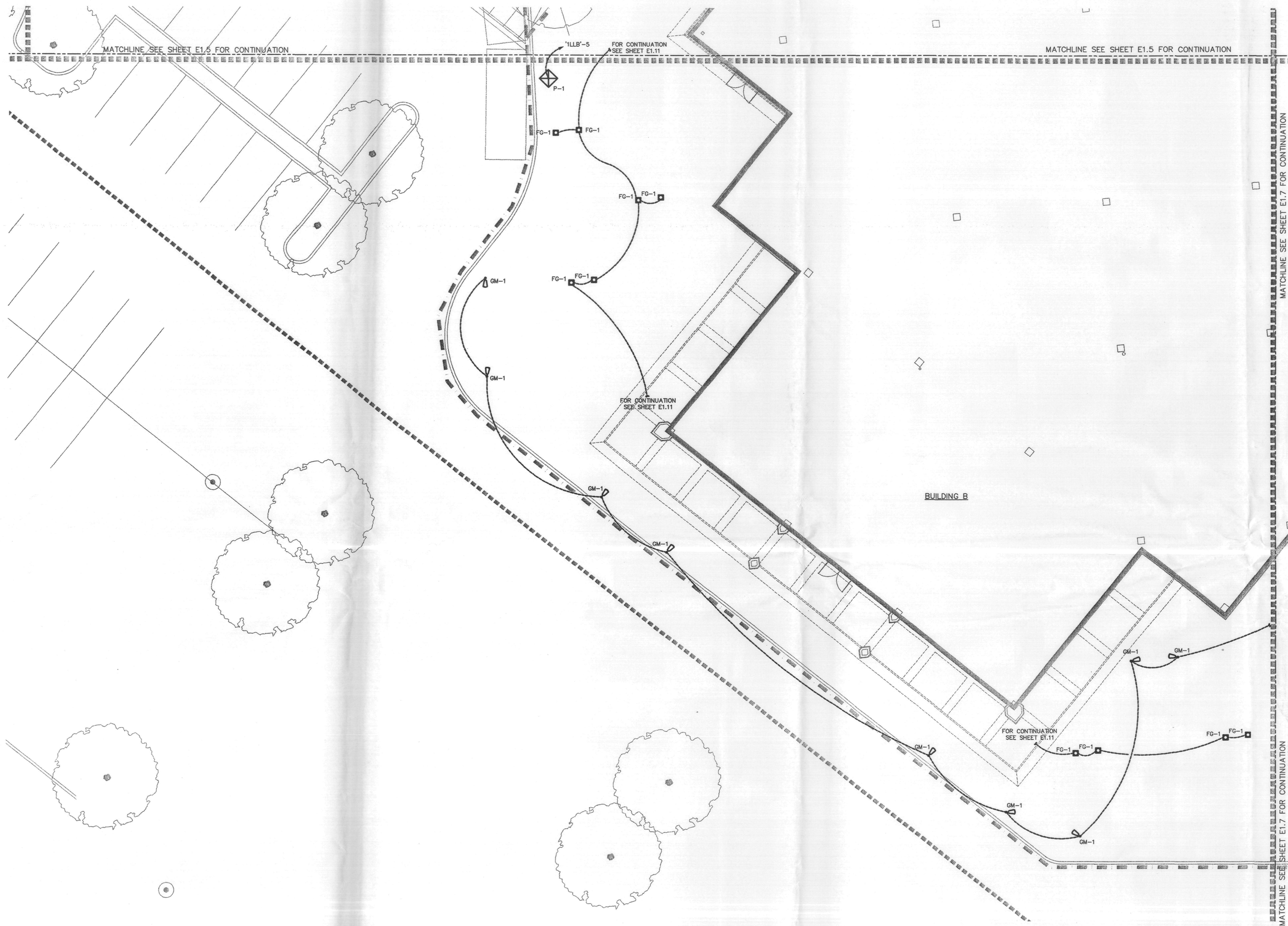

NEW DRAWING

SHEET NOTES

1. ALL LIGHTING AND POWER CONDUCTORS SHALL BE #10 AWG IN 3/4" CONDUIT MINIMUM, U.N.O.
2. ALL CIRCUITS VIA LOW VOLTAGE CONTROL PANEL #2.
3. FOR PANEL SCHEDULES, CONTROLS, LOAD CALCULATIONS, ETC. SEE BUILDING B ELECTRICAL PLANS.

ARIZONA REVISED STATUTES 32-1129.01.  
NOTICE OF EXTENDED CERTIFICATION AND APPROVAL PERIOD PROVISION.  
This contract allows the owner to certify and approve billings and estimates within 30 days after the billings and estimates are received from the contractor.  
NOTICE OF EXTENDED PAYMENT PROVISION.  
This contract allows the owner to make payments within 30 days after certification and approval of billings and estimates.

**T M A D** Engineers  
Mechanical, and Electrical Consulting Engineers  
7250 N. 16th Street, Suite 200  
Phoenix, Arizona 85020  
(602) 371-1333  
Job No. 560X-00X.00

*For K. Jones*  
APPROVED  
FINAL PLANS  
DATE: 03/05/03

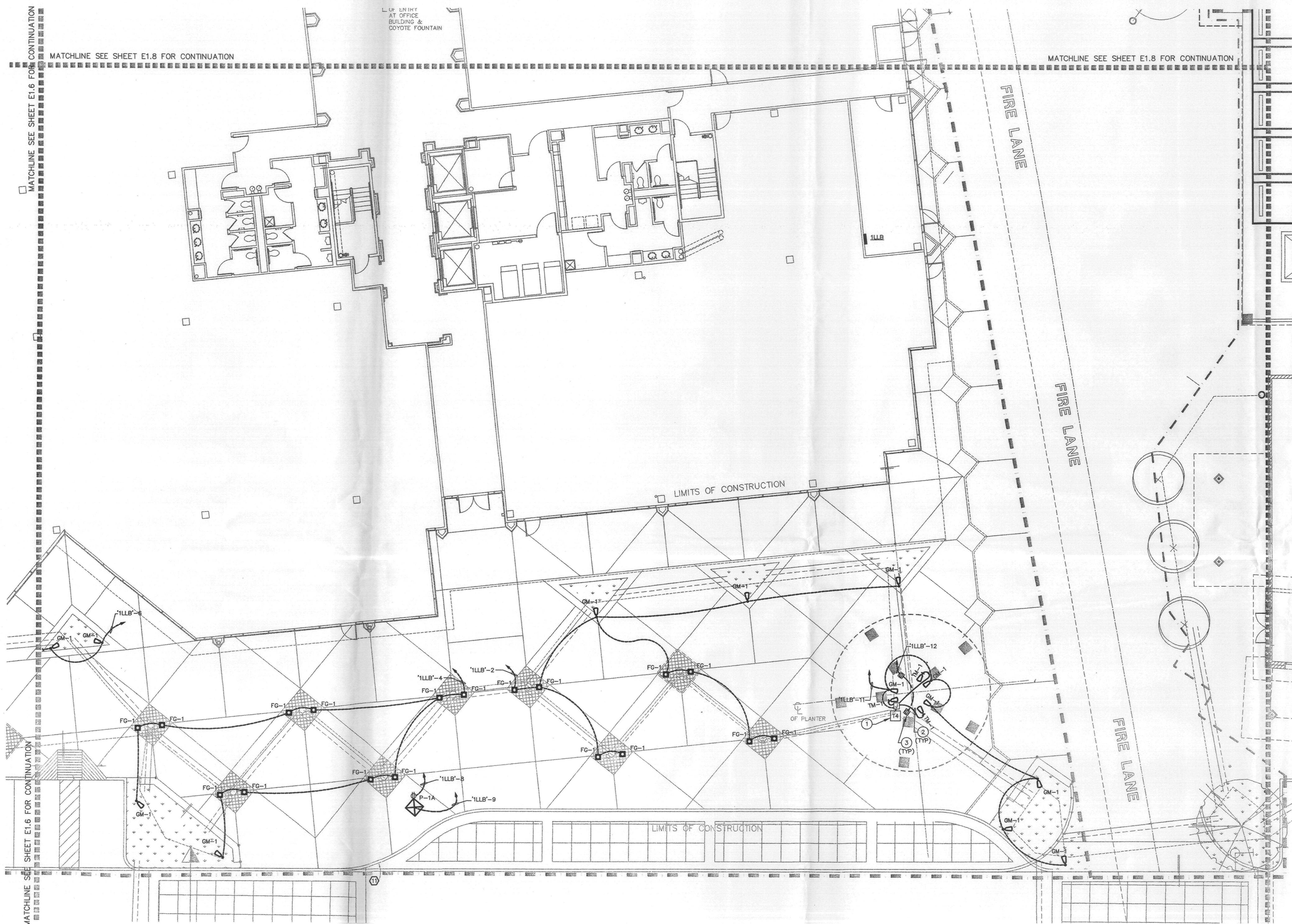

KEYNOTES

- 1 6" x 8" IN-GRADE SPLICE BOX WITH "LIGHTING" COVER. LOAD, COLOR TO MATCH SURROUNDING GROUND COVER. VERIFY WITH ARCHITECT. QUAZITE MODEL PC0608BA06/PC0608CA00-29.
- 2 2#12 DIRECT BURY, LOW VOLTAGE LIGHTING CABLE (KIM KLV427) FROM SPLICE BOX TO LIGHTS SUSPENDED IN TREES. FIELD VERIFY LIGHT LOCATIONS AND MOUNTING REQUIREMENTS WITH OWNER'S LIGHTING DESIGN CONSULTANT (CDL). PROVIDE EXTRA 20' CABLE IN EACH RUN COILED IN SPLICE BOX FOR FUTURE TREE GROWTH.
- 3 SEE CDL DRAWINGS AND SPECIFICATIONS FOR MOUNTING DETAILS.

NEW DRAWING

SHEET NOTES

1. PANEL 'ILLB' LOCATED IN SES ROOM 116.
2. ALL LIGHTING AND POWER CONDUCTORS SHALL BE #10 AWG IN 3/4" CONDUIT MINIMUM, U.N.O.
3. ALL CIRCUITS VIA LOW VOLTAGE CONTROL PANEL #2.
4. FOR PANEL SCHEDULES, CONTROLS, LOAD CALCULATIONS, ETC. SEE BUILDING B ELECTRICAL PLANS.

**Ellermann Schick**  
 architectureplanning  
 727 E. MARYLAND AVE  
 Phoenix, AZ 85014  
 phone: 602.266.6202  
 fax: 602.265.6212

THIS DRAWING IS AN INSTRUMENT OF SERVICE. IT IS THE PROPERTY OF ELLERMANN & SCHICK, INC. AND MAY NOT BE REPRODUCED WITHOUT WRITTEN PERMISSION.

**THE PROMENADE - PHASE 2**  
 HARDSCAPE AND PERFORMANCE PLAZA  
 AT  
 S.E.C. OF FRANK LLOYD WRIGHT & SCOTTSDALE ROAD  
 SCOTTSDALE, ARIZONA  
 FOR  
**THE PEDERSON GROUP**

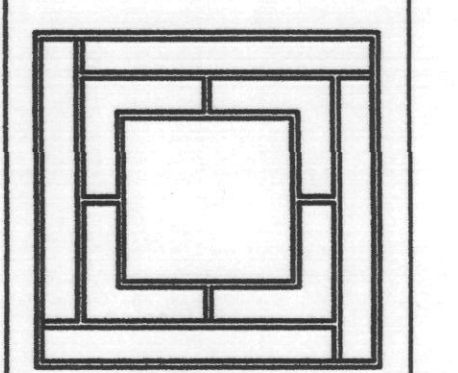

**Pederson GROUP, INC.**

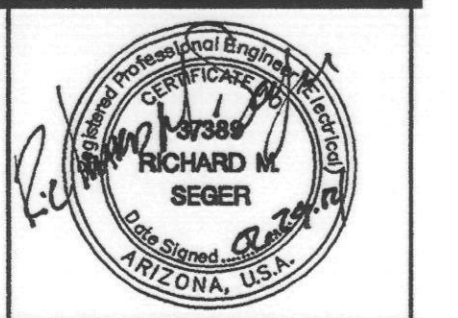

05/08/03	CITY COMMENTS
02/26/04	COORDINATION
05/24/04	OFFICE 'B' REVISIONS

- SCHEMATIC
- DESIGN DEVELOPMENT
- CONSTRUCTION DOCUMENTS
- BID/PRICING PACKAGE
- BUILDING DEPT. APPROVAL

DATE ISSUED 03.05.03  
 DRAWN BY TPS  
 CHECKED BY J. YURKUS  
 PROJECT NO. 22000  
 CADD FILE  
 SCALE: 1/8"=1'-0"

DRAWING NO.  
**E1.7**  
 HARDSCAPE ELECTRICAL

ARIZONA REVISED STATUTES 32-1129.01.  
 NOTICE OF EXTENDED CERTIFICATION AND APPROVAL PERIOD PROVISION.  
 This contract allows the owner to certify and approve billings and estimates within 30 days after the billings and estimates are received from the contractor.  
 NOTICE OF EXTENDED PAYMENT PROVISION.  
 This contract allows the owner to make payments within 30 days after certification and approval of billings and estimates.

**T M A D Engineers**  
 Mechanical, and Electrical Consulting Engineers  
 7250 N. 16th Street, Suite 200  
 Phoenix, Arizona 85020  
 (602) 371-1333  
 Job No. 560X-00X.00

*Approved*  
*8.6.04*  
 APPROVED  
 FINAL PLANS SETTING  
 APPROVED BY

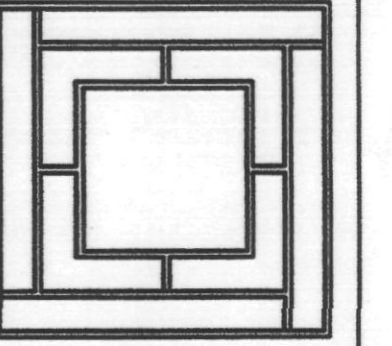

**Pederson**  
GROUP INC.



DATE	DESCRIPTION
09/24/04	OFFICE B' REVISIONS

<input type="checkbox"/>	SCHEMATIC
<input type="checkbox"/>	DESIGN DEVELOPMENT
<input type="checkbox"/>	CONSTRUCTION DOCUMENTS
<input type="checkbox"/>	BID/PRICING PACKAGE
<input type="checkbox"/>	BUILDING DEPT. APPROVAL

DATE ISSUED 03.05.03  
DRAWN BY TPS  
CHECKED BY J. YURKUS  
PROJECT NO. 22000  
CADD FILE  
SCALE: 1/4" = 1'-0"

DRAWING NO.  
**E1.11**  
HARDSCAPE ELECTRICAL

**KEY NOTES**

- 1 ALL LIGHTING AND POWER CONDUCTORS SHALL BE #10 AWG IN 3/4" CONDUIT MINIMUM, U.N.O.
- 2 ALL CIRCUITS VIA LOW VOLTAGE CONTROL PANEL #2.
- 3 FOR PANEL SCHEDULES, CONTROLS, LOAD CALCULATIONS, ETC. SEE BUILDING B ELECTRICAL PLANS.

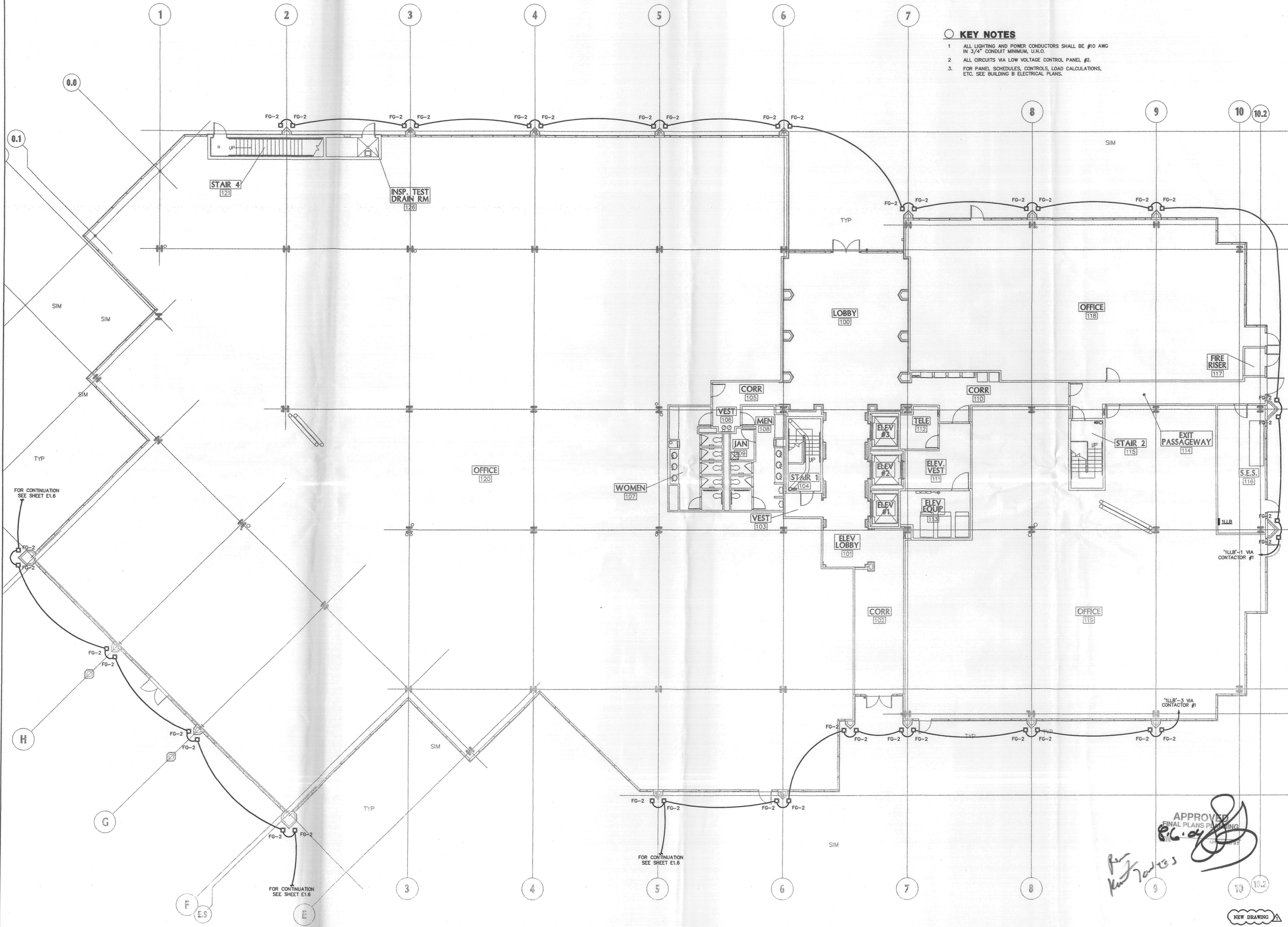

APPROVED  
FINAL PLANS PLANNING  
DATE: 03/05/03  
BY: [Signature]  
FOR KURT ZWISER

KEYNOTES

architecture planning  
 727 E. MARYLAND AVE  
 Phoenix, AZ 85014  
 phone: 602.266.6202  
 facsimile: 602.265.6212

THIS DRAWING IS AN INSTRUMENT OF SERVICE. IT IS THE PROPERTY OF ELLERMANN & SCHICK, INC. AND MAY NOT BE REPRODUCED WITHOUT WRITTEN PERMISSION.

THE PROMENADE - PHASE 2A  
 AT  
 SITE DEVELOPMENT  
 S.E.C. OF FRANK LLOYD WRIGHT & SCOTTSDALE ROAD  
 SCOTTSDALE, ARIZONA  
 FOR  
 THE PEDERSON GROUP

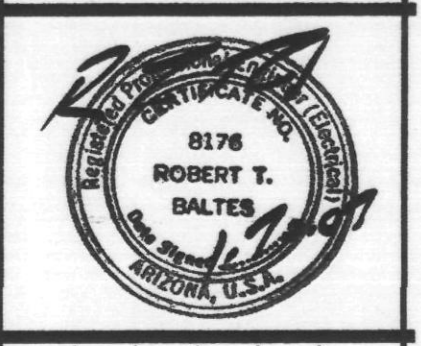
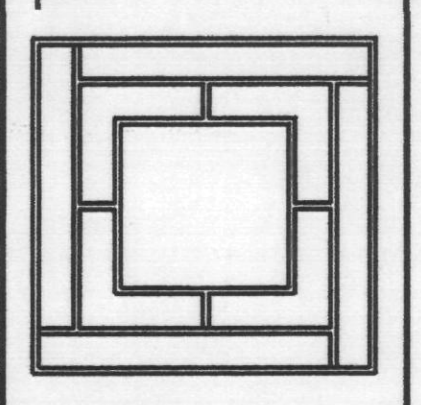

SHEET NOTES

- ALL LIGHTING AND POWER CONDUCTORS SHALL BE #10 AWG IN 3/4" CONDUIT MINIMUM, U.N.O.

*Robert Jones*  
 APPROVED  
 FINAL PLANS PLANNING  
 DATE 01.21.03

*Robert Jones*  
 APPROVED  
 DATE 01.21.03

KEY MAP

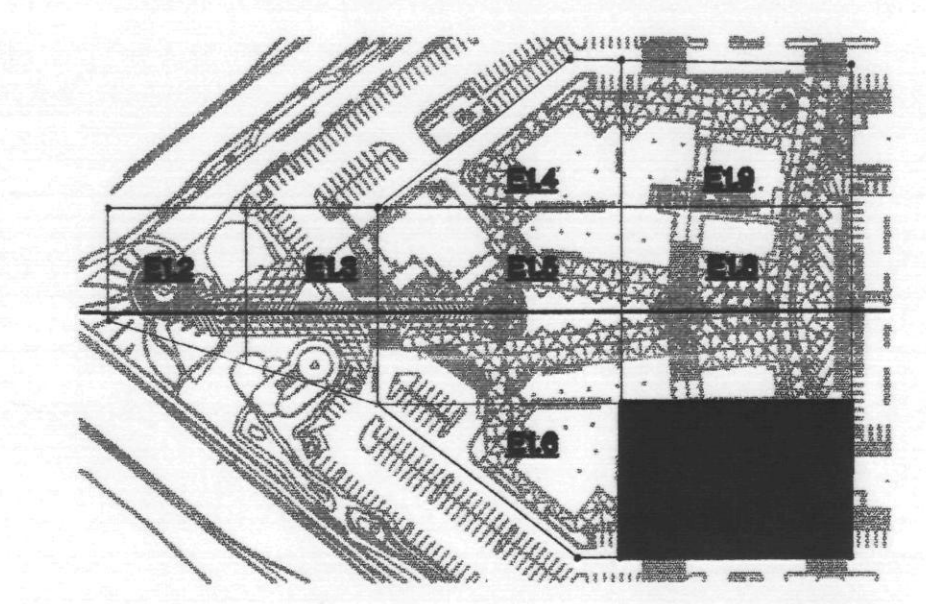

HARDSCAPE PLAN

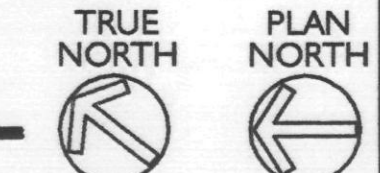

E1.7  
 HARDSCAPE ELECTRICAL

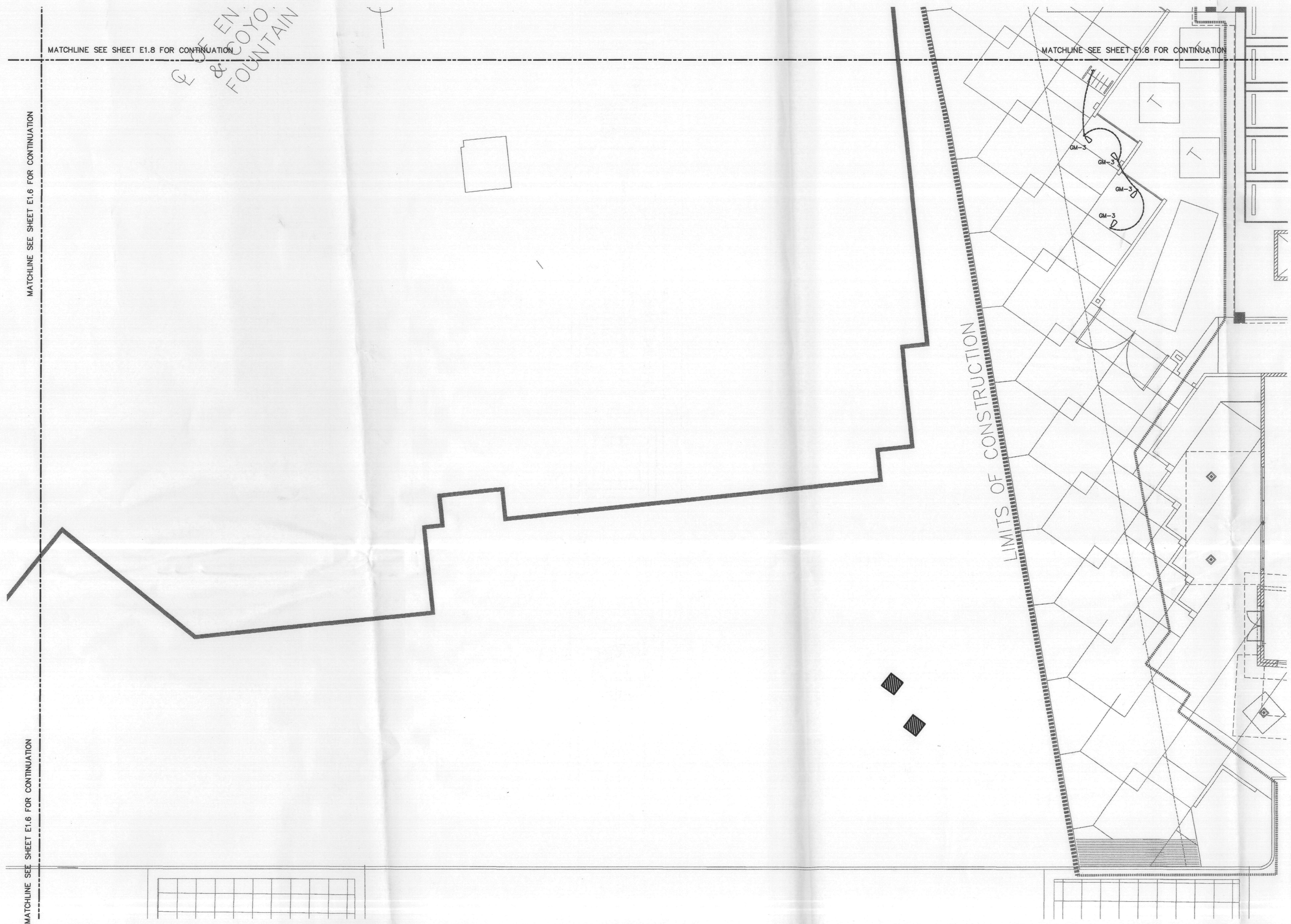

ARIZONA REVISED STATUTES 32-1129.01.

NOTICE OF EXTENDED CERTIFICATION AND APPROVAL PERIOD PROVISION.  
 This contract allows the owner to certify and approve billings and estimates within 30 days after the billings and estimates are received from the contractor.

NOTICE OF EXTENDED PAYMENT PROVISION.  
 This contract allows the owner to make payments within 30 days after certification and approval of billings and estimates.

**BVA**  
 Mechanical & Electrical Consulting Engineers  
 7250 N. 19th St., #102 • Phoenix, AZ 85020 • (602) 371-1333  
 www.bvaeng.com E-Mail: ena@bvaeng.com

DESIGNED BY: J. YURKUS  
 DRAWN BY: TPS

THIS DRAWING IS AN INSTRUMENT OF SERVICE AND THE PROPERTY OF BVA ENGINEERING ASSOCIATES LTD. THIS DRAWING MAY NOT BE REPRODUCED OR REPRODUCED HEREOF USED, WITHOUT WRITTEN PERMISSION. COPYRIGHT 2002 BVA ENGINEERING ASSOCIATES LTD. 7250 NORTH 19TH STREET, SUITE 102 PHOENIX, ARIZONA 85020 (602) 371-1333 FAX (602) 371-1333 E-MAIL: ena@bvaeng.com web:bvaeng.com

MATCHLINE SEE SHEET E1.5 FOR CONTINUATION

MATCHLINE SEE SHEET E1.5 FOR CONTINUATION

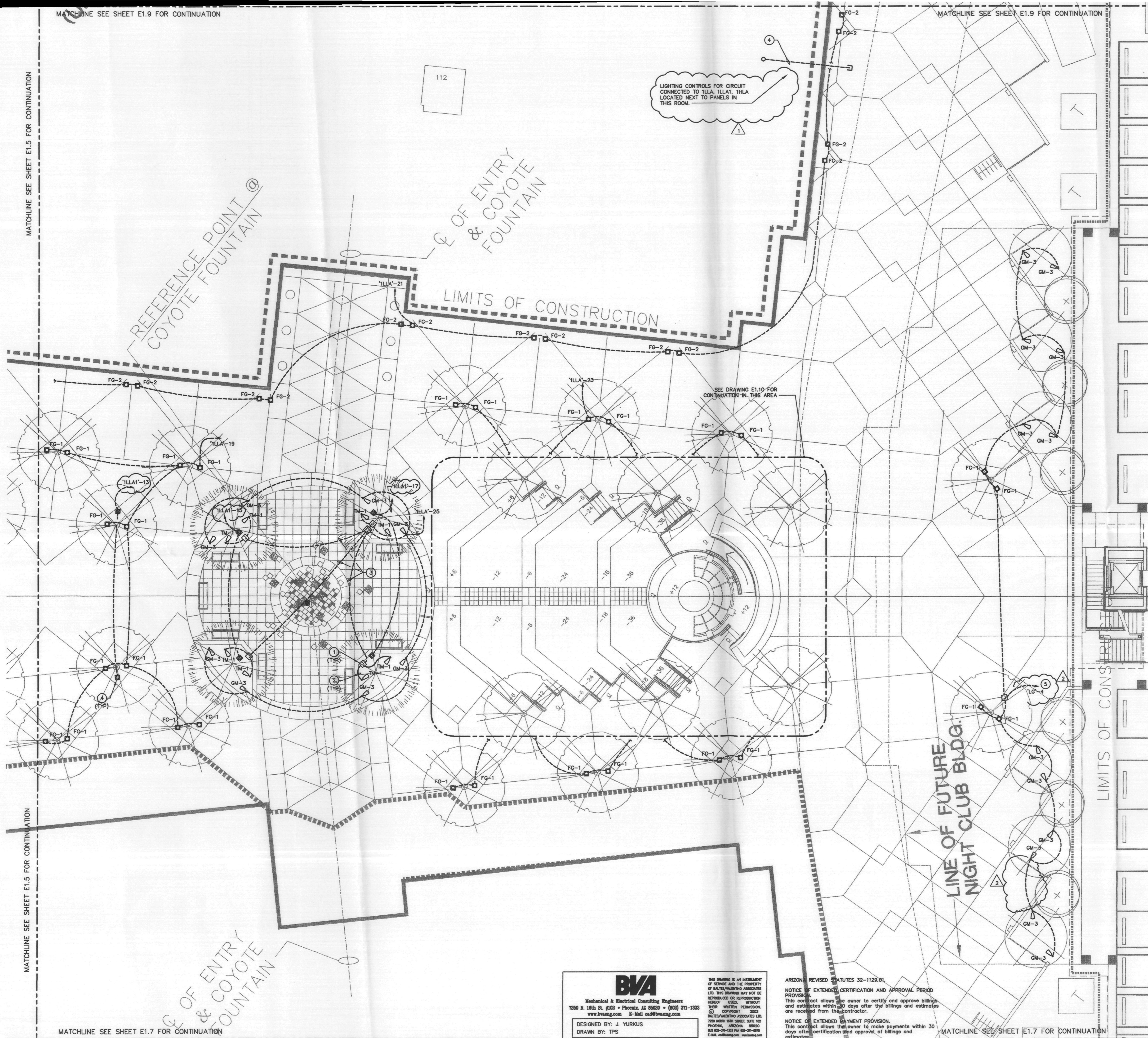

REFERENCE POINT @ COYOTE FOUNTAIN

LINE OF ENTRY & COYOTE FOUNTAIN

LIMITS OF CONSTRUCTION

LIMITS OF CONSTRUCTION

LINE OF FUTURE NIGHT CLUB BLDG.

LIGHTING CONTROLS FOR CIRCUIT CONNECTED TO 1LLA, 1LLA1, 1HLA LOCATED NEXT TO PANELS IN THIS ROOM.

SEE DRAWING E1.10 FOR CONTINUATION IN THIS AREA

KEYNOTES

- 6" x 8" IN-GRADE SPLICE BOX WITH "LIGHTING" COVER LOGO, COLOR TO MATCH SURROUNDING GROUND COVER VERIFY WITH ARCHITECT. QUANTITE MODEL PC0608BA06/PC0608CA00-28.
- 2#12 DIRECT BURY, LOW VOLTAGE LIGHTING CABLE (KIM KLV427) FROM SPLICE BOX TO LIGHTS SUSPENDED IN TREES. FIELD VERIFY LIGHT LOCATIONS AND MOUNTING REQUIREMENTS WITH OWNER'S LIGHTING DESIGN CONSULTANT (CDL). PROVIDE EXTRA 20' CABLE IN EACH RUN COILED IN SPLICE BOX FOR FUTURE TREE GROWTH.
- 2#8 LOW VOLTAGE CABLE (KIM KLV432).
- (22)-3/4"C.(26)-1"C. & (1) 1-1/2"C. STUBBED OUT UNDER BLDG. A PACKAGE FOR ALL SITE LIGHTING GOING TO PANELS 1HLA, 1LLA, 1LLA1 HARDSCAPE CONTRACTOR MAY COORDINATE WITH BUILDING A CONTRACTOR AND COMBINE HOMERUNS SO BUILDING A CONTRACTOR STUBS OUT ALL REQUIRED CONDUITS FOR HARDSCAPE PACKAGE.
- 2#8,1#10-1"C

SHEET NOTES

- ALL LIGHTING AND POWER CONDUCTORS SHALL BE #10 AWG IN 3/4" CONDUIT MINIMUM, U.N.O.
- ALL LIGHTING CONTROLS FOR CIRCUITS CONNECTED TO "1LLA" & "1LLA1" ARE LOCATED NEXT TO PANELS IN ELECTRIC ROOM, BUILDING A. SEE DWG E-205.
- ALL LIGHTING CONTROLS FOR CIRCUITS CONNECTED TO "LG" ARE LOCATED IN GARAGE. SEE DWG EG-300.

*Robert T. Balties*  
 APPROVED  
 FINAL PLANS PLANNING  
 DATE 6/10/03  
 APPROVED BY *Robert T. Balties*

KEY MAP

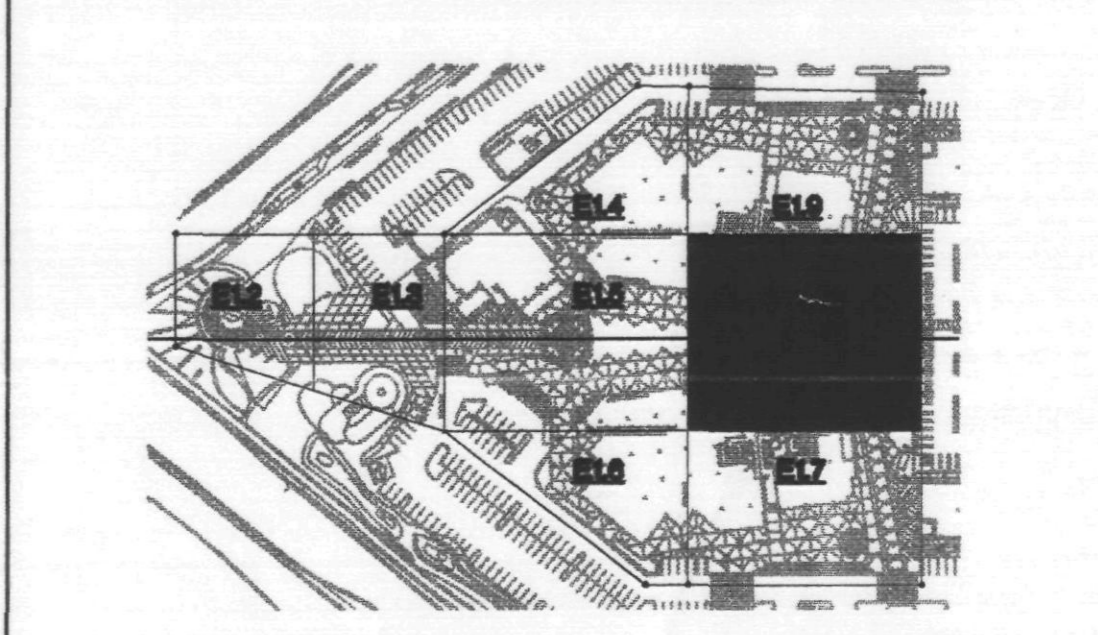

HARDSCAPE PLAN

architecture planning  
 727 E. MARYLAND AVE  
 PHOENIX, AZ 85014  
 PHONE: 602.266.6202  
 FACSIMILE: 602.265.6212

THIS DRAWING IS AN INSTRUMENT OF SERVICE. IT IS THE PROPERTY OF ELLERMAN & SCHICK, INC. AND MAY NOT BE REPRODUCED WITHOUT WRITTEN PERMISSION.

THE PROMENADE - PHASE 2A  
 SITE DEVELOPMENT  
 AT  
 S.E.C. OF FRANK LLOYD WRIGHT & SCOTTSDALE ROAD  
 SCOTTSDALE, ARIZONA  
 FOR  
 THE PEDERSON GROUP

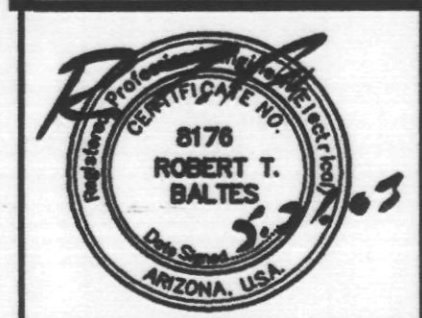
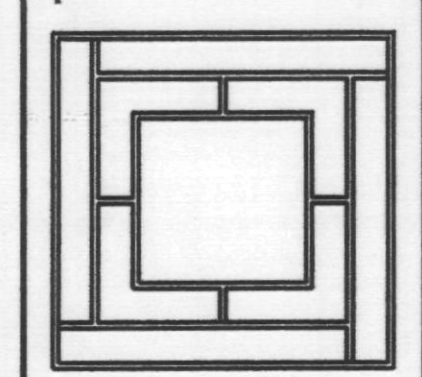

08 MAY 03	CITY COMMENTS
09 MAY 03	COORDINATION
10 MAY 03	APPROVAL
11 MAY 03	APPROVAL
12 MAY 03	APPROVAL
13 MAY 03	APPROVAL
14 MAY 03	APPROVAL
15 MAY 03	APPROVAL

SCHEMATIC	
DESIGN DEVELOPMENT	
CONSTRUCTION DOCUMENTS	
BID/PRICING PACKAGE	
BUILDING DEPT. APPROVAL	

DATE ISSUED	01.31.03
DRAWN BY	NT
CHECKED BY	J. YURKUS
PROJECT NO.	22000
CADD FILE	
SCALE:	1/8"=1'-0"
DRAWING NO.	

E1.8  
HARDSCAPE ELECTRICAL

**BVA**  
 Mechanical & Electrical Consulting Engineers  
 7250 N. 19th St. #100 • Phoenix, AZ 85020 • (602) 571-1333  
 www.bvaeng.com E-Mail: cad@bvaeng.com

DESIGNED BY: J. YURKUS  
 DRAWN BY: TPS

THIS DRAWING IS AN INSTRUMENT OF SERVICE AND THE PROPERTY OF BVA CONSULTING ASSOCIATES LTD. THIS DRAWING MAY NOT BE REPRODUCED OR REPRODUCED IN ANY MANNER WITHOUT THE WRITTEN PERMISSION OF BVA CONSULTING ASSOCIATES LTD. 7250 NORTH 19TH STREET, SUITE 100 PHOENIX, ARIZONA 85020 602.571.1333 FAX 602.571.0925 E-MAIL: cad@bvaeng.com www.bvaeng.com

ARIZONA REVISED STATUTES 32-1128.01.  
 NOTICE OF EXTENDED CERTIFICATION AND APPROVAL PERIOD PROVISION:  
 This contract allows the owner to certify and approve billings and estimates within 90 days after the billings and estimates are received from the contractor.

NOTICE OF EXTENDED PAYMENT PROVISION:  
 This contract allows the owner to make payments within 30 days after certification and approval of billings and estimates.



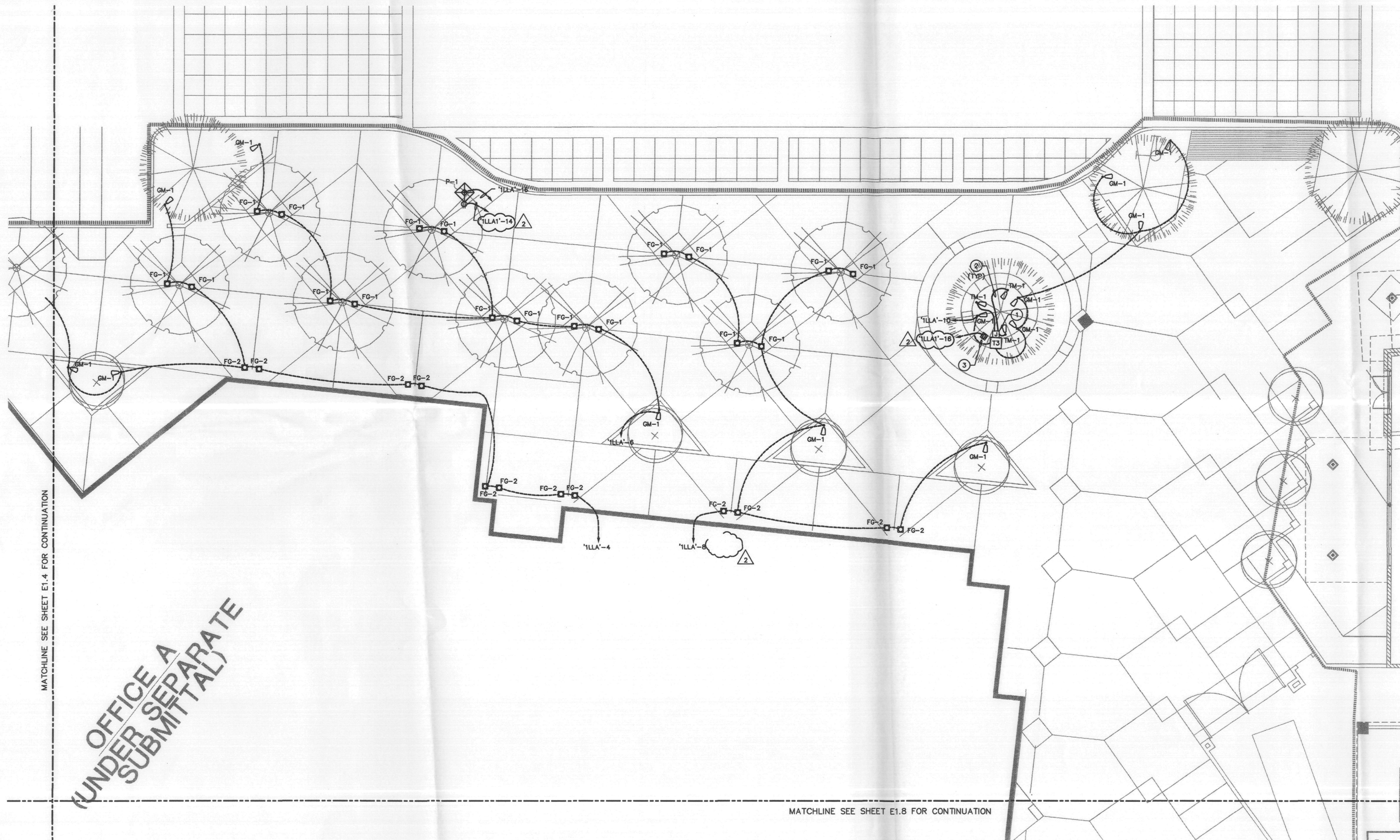

MATCHLINE SEE SHEET E1.4 FOR CONTINUATION

OFFICE A  
(UNDER SEPARATE  
SUBMITTAL)

MATCHLINE SEE SHEET E1.8 FOR CONTINUATION

**KEYNOTES**

- 6"x8" IN-GRADE SPLICE BOX WITH 'LIGHTING' COVER LOGO. COLOR TO MATCH SURROUNDING GROUND COVER-VERIFY WITH ARCHITECT. QUAZITE MODEL# FC0608BA06/PC0608CA00-29.
- 2#12 DIRECT BURY LOW VOLTAGE LIGHTING CABLE (KIM KLV427) FROM SPLICE BOX TO LIGHTS SUSPENDED IN TREES. FIELD VERIFY LIGHT LOCATIONS AND MOUNTING REQUIREMENTS WITH OWNER'S LIGHTING DESIGN CONSULTANT (CDL). PROVIDE EXTRA 20' CABLE IN EACH RUN COILED IN SPLICE BOX FOR FUTURE TREE GROWTH.
- SEE CDL DRAWINGS AND SPECIFICATIONS FOR MOUNTING DETAILS.

**SHEET NOTES**

- ALL LIGHTING AND POWER CONDUCTORS SHALL BE #10 AWC IN 3/4" CONDUIT MINIMUM, U.N.O.
- ALL LIGHTING CONTROLS FOR CIRCUITS CONNECTED TO "TLLA" & "TLLA1" ARE LOCATED NEXT TO PANELS IN ELECTRIC ROOM, BUILDING A. SEE DWG E-205.

*Robert I. Baltes*  
**APPROVED**  
 FINAL PLANS PLANNING  
 DATE: 6-12-23  
*Robert I. Baltes*  
**Approval**

**KEY MAP**

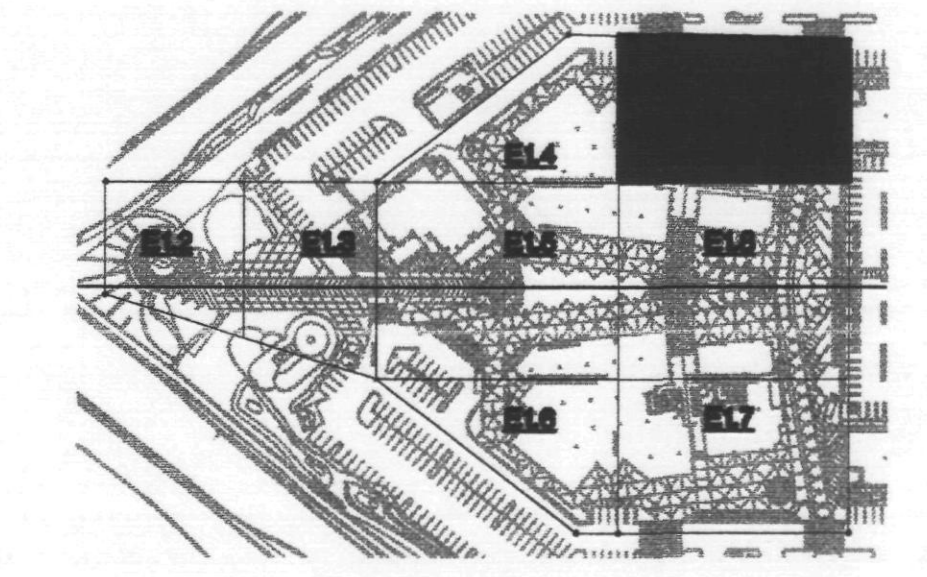

**HARDSCAPE PLAN**

ARIZONA REVISED STATUTES 32-1128.01.  
 NOTICE OF EXTENDED CERTIFICATION AND APPROVAL PERIOD PROVISION.  
 This contract allows the owner to certify and approve billings and estimates within 30 days after the billings and estimates are received from the contractor.  
 NOTICE OF EXTENDED PAYMENT PROVISION.  
 This contract allows the owner to make payments within 30 days after certification and approval of billings and estimates.

**BVA**  
 Mechanical & Electrical Consulting Engineers  
 7250 N. 19th St., #102 • Phoenix, AZ 85020 • (602) 371-1333  
 www.bvaeng.com E-Mail: cad@bvaeng.com  
 DESIGNED BY: J. YURKUS  
 DRAWN BY: TFS

THIS DRAWING IS AN INSTRUMENT OF SERVICE AND THE PROPERTY OF BATES/VALENTINO ASSOCIATES LTD. THE DRAWING MAY NOT BE REPRODUCED OR REPRODUCTION HEREOF USED, WITHOUT THEIR WRITTEN PERMISSION. © COPYRIGHT 2003 BATES/VALENTINO ASSOCIATES LTD. 7250 NORTH 19TH STREET, SUITE 102 PHOENIX, ARIZONA 85020 (602) 371-1333 FAX (602) 371-1335 E-MAIL: cad@bvaeng.com bvaeng.com

**architecture planning**  
 727 E. MARYLAND AVE  
 Phoenix, AZ 85014  
 phone: 602.266.6202  
 facsimile: 602.265.6212

THIS DRAWING IS AN INSTRUMENT OF SERVICE. IT IS THE PROPERTY OF ELLERMANN & SCHICK, INC. AND MAY NOT BE REPRODUCED WITHOUT WRITTEN PERMISSION.

**THE PROMENADE - PHASE 2A**  
 AT  
 SITE DEVELOPMENT  
 S.E.C. OF FRANK LLOYD WRIGHT & SCOTTSDALE ROAD  
 SCOTTSDALE, ARIZONA  
 FOR  
**THE PEDERSON GROUP**

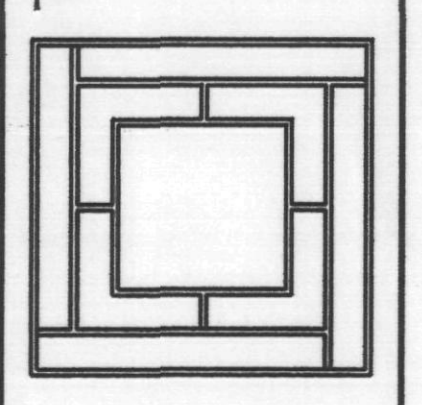

08	MAY 03	CITY COMMENTS	
09	MAY 03	COORDINATION	

- SCHEMATIC
- DESIGN DEVELOPMENT
- CONSTRUCTION DOCUMENTS
- BID/PRICING PACKAGE
- BUILDING DEPT. APPROVAL

DATE ISSUED 01.31.03  
 DRAWN BY TFS  
 CHECKED BY J. YURKUS  
 PROJECT NO. 22000  
 CADD FILE  
 SCALE: 1/8" = 1'-0"

**E1.9**  
 HARDSCAPE ELECTRICAL

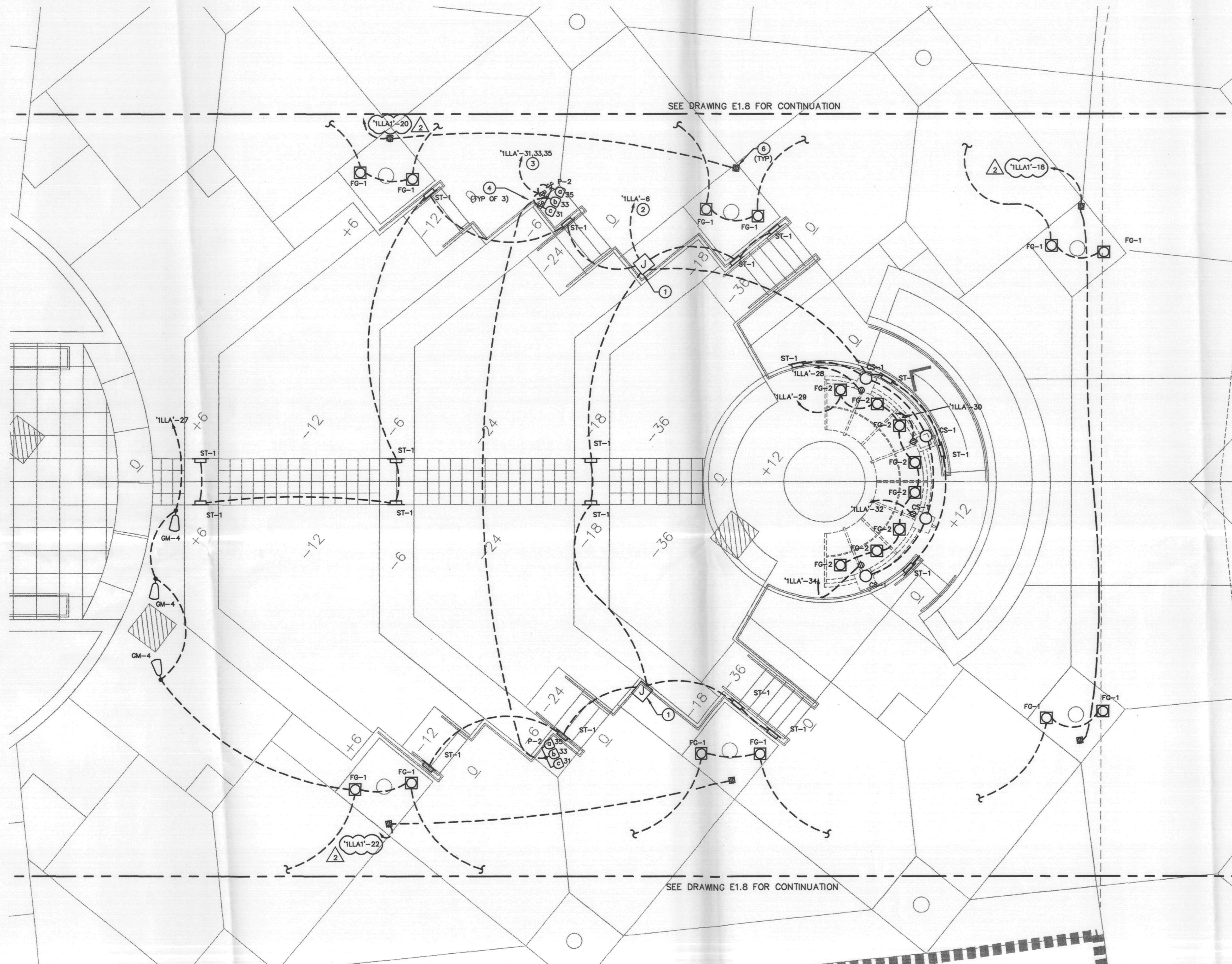

**KEYNOTES**

- 1 6" x 8" IN-GRADE SPICE BOX WITH "LIGHTING" COVER LOGO, COLOR TO MATCH SURROUNDING GROUND COVER. VERIFY WITH ARCHITECT. QUAZITE MODEL. PC0608BA06/PC0608CA00-29.
- 2 2 #12, 1 #12 GND. 3/4" C. THRU-OUT ENTIRE CIRCUIT.
- 3 4 #8, 1 #8 GND. 1" C.
- 4 30A SINGLE POLE SWITCH MOUNTED ON POLE WITH WEATHERPROOF LOCKING COVER.
- 5 4#5, 1#8 GND. 1-1/2" C.
- 6 SEE CDL DRAWINGS AND SPECIFICATIONS FOR MOUNTING DETAILS.
- 7 2#5, 1#10-1" C.

**SHEET NOTES**

1. ALL FIXTURES AND LOW VOLTAGE LIGHTING TRANSFORMERS HAVE BEEN SPECIFIED BY LIGHTING DESIGN CONSULTANT "CREATIVE DESIGNS LIGHTING" (CDL). THESE SCHEDULES PROVIDED FOR REFERENCE ONLY. CONTRACTOR TO VERIFY SPECIFIC DETAILS WITH CDL.
2. ALL LIGHTING AND POWER CONDUCTORS SHALL BE #10 AWG. IN 3/4" CONDUIT MINIMUM, U.N.O.
3. ALL LIGHTING CONTROLS FOR CIRCUITS CONNECTED TO "ILLA" & "ILLA" ARE LOCATED NEXT TO PANELS IN ELECTRIC ROOM, BUILDING A. SEE DWG E-205.

APPROVED  
FINAL PLANS PLANNING  
DATE: 01/23/03  
APPROVED BY: [Signature]

**KEY MAP**

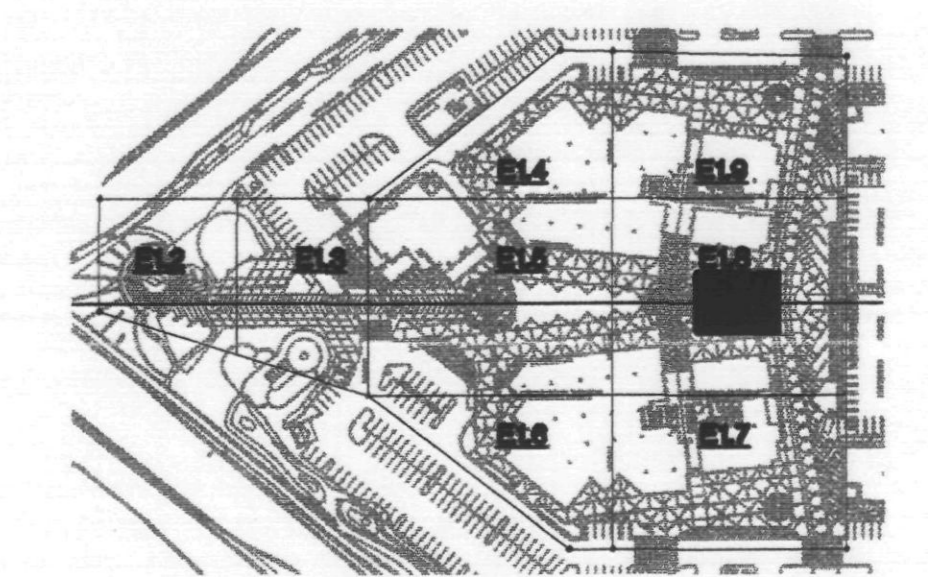

**HARDSCAPE PLAN**

ARIZONA REVISED STATUTES 32-1128.01.  
NOTICE OF EXTENDED CERTIFICATION AND APPROVAL PERIOD PROVISION.  
This contract allows the owner to certify and approve billings and estimates within 30 days after the billings and estimates are received from the contractor.  
NOTICE OF EXTENDED PAYMENT PROVISION.  
This contract allows the owner to make payments within 30 days after certification and approval of billings and estimates.

**BVA**  
Mechanical & Electrical Consulting Engineers  
7250 N. 18th St. #102 • Phoenix, AZ 85020 • (602) 371-1333  
www.bvam.com E-Mail: cad@bvam.com

DESIGNED BY: N. TIMMERMAN  
DRAWN BY: TFS

THIS DRAWING IS AN INSTRUMENT OF SERVICE AND THE PROPERTY OF BVA/VALENTINO ASSOCIATES LTD. THIS DRAWING MAY NOT BE REPRODUCED OR REPRODUCED HEREIN, USED, WITHOUT THEIR WRITTEN PERMISSION.  
© COPYRIGHT 2003 BVA/VALENTINO ASSOCIATES LTD.  
7250 NORTH 18TH STREET, SUITE 102 PHOENIX, ARIZONA 85020  
800-371-1333 FAX 602-371-0875  
E-Mail: cad@bvam.com

architecture planning

727 E. MARYLAND AVE  
Phoenix, AZ 85014  
phone: 602.266.6202  
facsimile: 602.265.6212

THIS DRAWING IS AN INSTRUMENT OF SERVICE. IT IS THE PROPERTY OF ELLERMANN & SCHICK, INC. AND MAY NOT BE REPRODUCED WITHOUT WRITTEN PERMISSION.

THE PROMENADE - PHASE 2A  
SITE DEVELOPMENT  
AT  
S.E.C. OF FRANK LLOYD WRIGHT & SCOTTSDALE ROAD  
SCOTTSDALE, ARIZONA  
THE PEDERSON GROUP

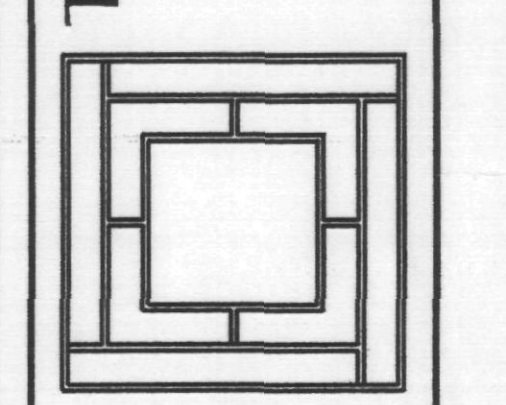

08 MAY 03 CITY COMMENTS	
09 MAY 03 COORDINATION	

- SCHEMATIC
- DESIGN DEVELOPMENT
- CONSTRUCTION DOCUMENTS
- BID/PRICING PACKAGE
- BUILDING DEPT. APPROVAL

DATE ISSUED: 01.31.03  
DRAWN BY: NT  
CHECKED BY: J. YURKUS  
PROJECT NO.: 22000  
CADD FILE:  
SCALE: 1/4" = 1'-0"

DRAWING NO.  
**E1.10**  
HARDSCAPE ELECTRICAL