

30-DE-2008#3
 1765-08-5
APPROVED
 FINAL PLANS PLANNING
 2-19-2009 *[Signature]*
 DATE APPROVED BY

sheet notes

- A. REFER TO A0. SERIES DRAWINGS FOR GENERAL PROJECT INFORMATION + SYMBOLS, REFER TO A0. SERIES DRAWINGS FOR GENERAL CODE + LIFE SAFETY INFORMATION.
- B. REQUIRED ROOF CLASSIFICATION: C
- C. ROOFING SYSTEM IS AS FOLLOWS: COATED FOAM ROOFING SYSTEM (MINIMUM 1" THICK, OR AS APPROVED BY MANUFACTURER) DIRECTLY APPLIED OVER SLOPED STRUCTURAL PLYWOOD DECK. APPLIED TOP FINISH COAT SHALL BE TAN TO MATCH ADJACENT EXISTING CAMPUS WORK.
- D. TYPICAL ROOF DECK ELEVATIONS ARE PROVIDED ON THIS SHEET. REFER TO ELEVATIONS, BUILDING AND TRUSS SECTIONS FOR ALL VERTICAL HEIGHTS. AS NOTED, TYPICAL TOP OF DECK HEIGHTS ARE BASED UPON STANDARD SLOPES AS SHOWN ON PLANS OR IN SECTIONS.
- E. FOR TYPICAL DETAIL AT PLUMBING VENT PENETRATIONS, SEE 12/A11.1. ANY ROOFTOP VENTS REQUIRED ON PROJECT SHALL BE PAINTED TO MATCH SURROUNDING ROOF SURFACES.
- F. REFER TO PLUMBING DRAWINGS FOR ROOF DRAIN SIZES AND TRIBUTARY AREAS.
- G. REFER TO A2. PLAN SERIES SHEETS FOR DIMENSIONING OR OTHER INFORMATION RELATED TO THE ROOF PLAN NOT SHOWN ON THIS SHEET.
- H. MECHANICAL EQUIPMENT SHALL BE MOUNTED ON PREMANUFACTURED INSULATED CURBS. ROOF FLASHING TERMINATION AT CURBS IS INTENDED TO BE ACCOMPLISHED IN A SIMILAR MANNER TO THAT SHOWN AT OTHER SIMILAR LOCATIONS, SUCH AS STANDARD CANT DETAILS.

keyed notes (X)

- 1. ROOF SYSTEM TERMINATION TAPER AT CMU WALL. SEE SECTIONS AND DETAIL 3/A11.1.
- 2. ROOF TO FRAME PARAPET FLASHING DETAIL AT METAL FASCIA / PARAPET. ROOFING SYSTEM TERMINATES UNDER PARAPET COPING. SEE SECTIONS AND DETAIL 18-19/A11.1.
- 3. METAL PARAPET COPING DETAIL AT FLATLOCK COR-TEN METAL FASCIA SYSTEM. SEE SECTIONS AND DETAIL 18-19/A11.1.
- 4. VERTICAL CHANGE IN ELEVATION OF ROOF PLANES ("GABLE" SIDE OF HIGHER SLOPING ROOF TURNS DOWN INTO LOWER FLAT ROOF AREA). REFER TO EDGE DETAIL, AND BASE TRANSITION DETAIL, 4-5/A11.1.
- 5. ROOF HIGH TERMINATION DETAIL AT CLERESTORY WINDOWS. STEEL EDGE (WINDOW HEAD) TO RECEIVE TOPCOATING OF FOAM ROOFING SYSTEM UNDER A CONTINUOUS PAINTED SHEET STEEL COUNTERFLASHING. PAINT COUNTERFLASHING TO MATCH WINDOW FRAME/SYSTEM [DE-3001 LRV: 17]. REFER TO DETAIL 30/A10.3 AND 23/A11.2.
- 6. ROOF HIGH TERMINATION DETAIL AT CMU ADJACENT TO CLERESTORY (3'-1" OF WALL EACH SIDE) TO RECEIVE CAP FLASHING HELD BACK FROM OUTSIDE FACE OF MASONRY. FOAM ROOFING SYSTEM TO TERMINATE UNDER FLASHING. SEE 2/A11.1 AND 22/A11.2.
- 7. TYPICAL TOP OF PARAPET DETAIL AT CMU WALL. SEE SECTIONS AND DETAIL 1/A11.1.
- 8. TYPICAL SLOPED, TAPERED ROOFING SYSTEM CRICKET WITH MINIMUM 1/4" PER 1'-0" SLOPE [AT VALLEY PORTION OF CONNECTION] TO MAIN ROOF SLOPE. ALTERNATE CRICKET CONSTRUCTION (MINIMUM THICKNESS ROOFING SYSTEM OVER PLYWOOD CONSTRUCTED CRICKETS) IS ALSO ACCEPTABLE, IF APPROVED BY ROOFING MANUFACTURER/INSTALLER.
- 9. ROOF DRAIN + OVERFLOW ROOF DRAIN INLET AND SUMP PAN LOCATION. REFER TO PLUMBING DRAWINGS AND DETAIL 9-10/A11.1.
- 10. ROOF DRAIN AND ROOF OVERFLOW DRAIN LEADER PIPING BELOW. REFER TO PLUMBING DRAWINGS. COORDINATE EXACT LOCATIONS TO AVOID ALL OTHER IN-CEILING ELEMENTS. REFER ALSO TO PLANS.
- 11. TYPICAL ROOF DRAIN + OVERFLOW DRAIN WALL OUTLETS BELOW. REFER TO DETAIL 25/A11.2. REFER ALSO TO PLANS AND TYPICAL BUILDING ELEVATION OF WALL FACE.
- 12. PLAIN STEEL [ALLOWED TO WEATHER] ROOF SCUPPER [LRV: 14]. REFER TO DETAIL 7/A11.1 [TYPICAL OF TWO].
- 13. SURFACE PROTECTED TRANSFER SCUPPER. OPENING TO HAVE ALL SURFACES PROTECTED WITH WATERPROOFING/ ROOFING SYSTEM. REFER TO DETAIL 8/A11.1. [TYPICAL OF FOUR LOCATIONS TOTAL].
- 14. LINE OF OUTSIDE FACE OF EXTERIOR WALL GLAZING BELOW
- 15. ROOF ACCESS HATCH WITH LADDER BELOW. REFER TO DETAIL 11/A11.1.
- 16. MECHANICAL EQUIPMENT ON CURB. REFER TO DETAIL 6/A11.1 AND MECHANICAL DRAWINGS.
- 17. LINE OF RIDGE
- 18. LINE OF VALLEY [BELOW CRICKET]
- 19. RELIEF HOOD ON CURB. REFER TO MECHANICAL. REFER TO 6/A11.1.
- 20. EXHAUST FAN CAP ON CURB. REFER TO MECHANICAL. REFER TO 6/A11.1.

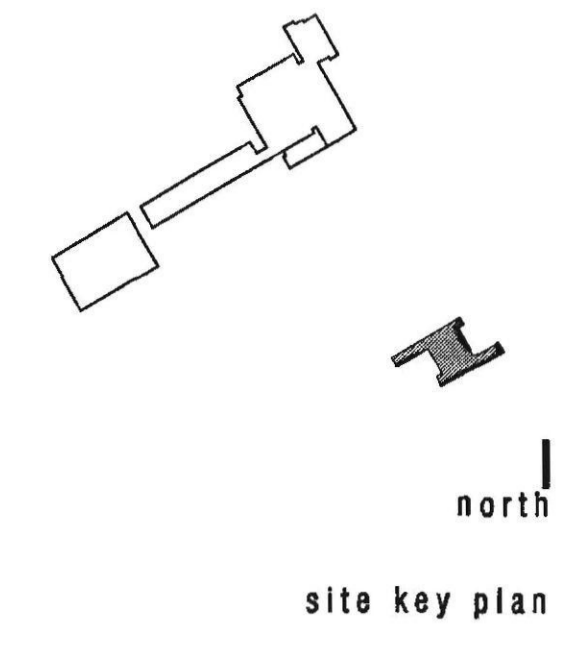

20 JANUARY 2009
 FIRST REVIEW

construction documents

A4.1

roof plan
 chapel
 building number 3

1/8" = 1'-0"



sfa
PHASE 2B CHAPEL

scottsdale first assembly
 28700 north pima road
 scottsdale, arizona 85262

december 2008
 © copyright 2009
 0891

DeBARTOLO architects
 4450 north twelfth street
 number 268
 phoenix, arizona 85014
 tel 602.264.6617
 fax 602.264.0891
 jack3@debartoloarchitects.com



1 roof plan chapel
 1/8"=1'-0"

APN: 216-70-008-A
 DRB: 36-DR-2003#3
 BLD. PL.: #1765-08-5
 IMP. PL.: #1765-08-4
 NAT. PLANT: 5-NP-2008