

90-DR-2008

APPROVED

Qui me 7/16/09
DATE

SPECIFICATION KEY NOTES

- ① Aluminum cabinet with routed graphics. Paint "Hazel Hurdle" #CL 2874D Frazee, flat #2 texture finish.
- ② 1" Clear acrylic pushed thru letters with diffuser backup and "Wrisco" brushed aluminum on the first surface. T12 fluorescent internal illumination.
- ③ Removable aluminum reverse pan tenant panel. Each tenant panel shall have a 1 1/2" return to the cabinet surface. Paint "Water Cracker" #CL 2873M frazee, flat #2 texture finish. Future tenant graphics shall be routed from the tenant panel face with 1" clear acrylic push thru letters, White diffuser backup and "Wrisco" brushed aluminum on the first surface. T12 fluorescent internal illumination.

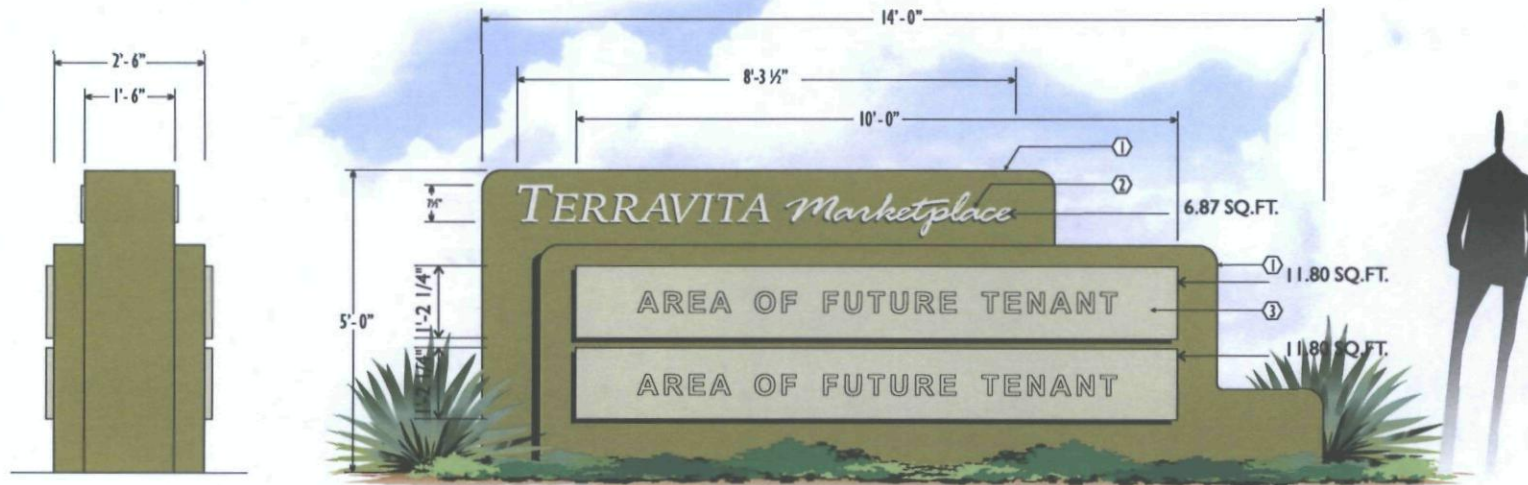

END VIEW

"Hazel Hurdle"
#CL 2874D Frazee
flat #2 texture finish.

"Water Cracker"
#CL 2873M Frazee
flat #2 texture finish.

A1 A2 ILLUMINATED DOUBLE FACE MONUMENT DISPLAY

SCALE: 1/8" = 1' - 0"

30.47 SQ.FT.

SCOPE OF WORK:

Manufacture & install (2) two internally illuminated D/F monument displays.

- △ Not noted.
- △ Modify "A".
- △ Add side view.
- △ Add second monument, add new site plan.
- △ Add page 1 notes, modify site plan.
- △ Add specific color and finish notes.
- △ Change call-out for tenant panels.
- △ Change setbacks for sign "A2".
- △ Fix site plan for sign "A1".
- △ Fix site plan for sign "A1/A2".



PHOENIX DIVISION

6725 W. Chicago Street, Chandler, Az 85226-3335 (480) 449-3726
ARIZONA CONTRACTOR LICENSE NO. #973222-001, AIRWAYS NO. #973222, ELECTRICAL NO. #993800

YESCO. YOUNG ELECTRIC SIGN COMPANY

* Illuminated displays will be wired for 120 volt power unless otherwise noted.

* Cost for providing necessary electrical wiring to sign area is not included in sign proposal.

SALES APPROVAL:

DATE:

REV. #	DATE	BY	REV. #	DATE	BY
REV. 1	10/11/07	JW	REV. 6	11/06/08	MVS
REV. 2	01/23/08	LSD	REV. 7	12/12/08	
REV. 3	02/27/08	TALL	REV. 8	07/04/09	JWW
REV. 4	10/03/08	JB	REV. 9	07/04/09	TALL
REV. 5	10/21/08	JWW	REV. 10	07/10/09	JWW

FIRM NAME / PROJECT ADDRESS	
TERRAVITA MARKETPLACE	
34402 N. SCOTTSDALE ROAD	
SCOTTSDALE, ARIZONA	
ORIGINAL DATE:	09/04/07
ORIG. DESIGNER:	L. den Dulk
SCALE:	As Noted
SALESPERSON BRIDGET FALCO	

6071188-R10

FILE DESIGN NUMBER

1 OF 4

SHEET NUMBER

90-DR-2009

APPROVED

One way 7/16/09
DATE

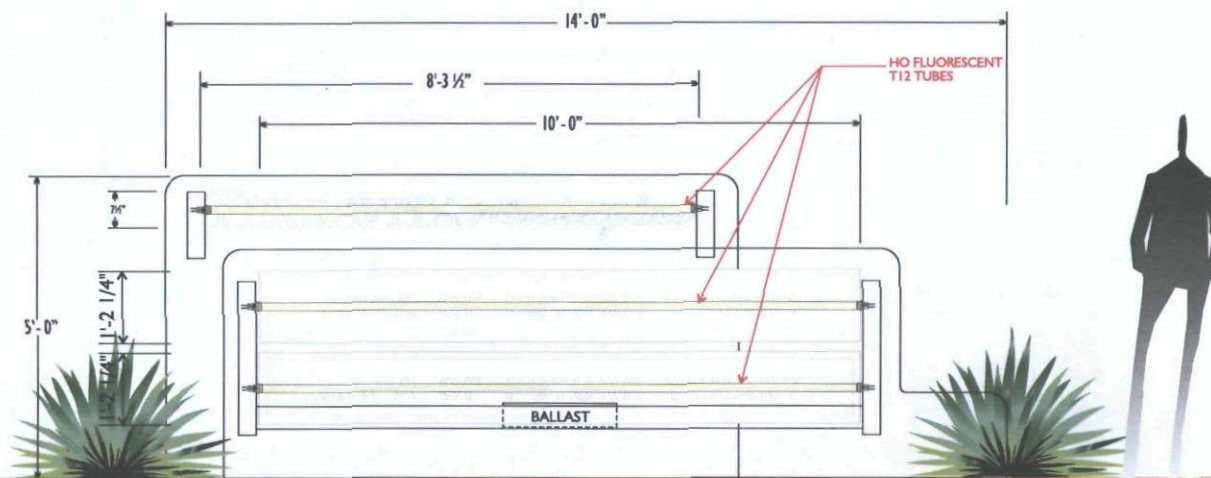

A1 A2 ILLUMINATED DOUBLE FACE: SIGN LAMP CONFIGURATION

SCALE: 1/2" = 1' - 0" 30.47 SQ.FT.

SCOPE OF WORK :

MANUFACTURE & INSTALL (2) TWO INTERNALLY ILLUMINATED D/F MONUMENT DISPLAYS. TEXTURED & PAINTED TO MATCH EXISTING. "TERRAVITA MARKETPLACE" IS 1" PUSHED THRU ACRYLIC W/ 1ST SURFACE WRISCO BRUSHED ALUMINUM. 1 1/2" RAISED TENANT PANELS, ROUTED WITH 1" PUSH-THRU ACRYLIC W/ 1ST SURFACE WRISCO BRUSHED ALUMINUM.

 PHOENIX DIVISION 6725 W. Chicago Street, Chandler, Az 85226-3335 (480) 449-3726 ARIZONA CONTRACTOR LICENSE NO. #073222-007, AIRWINGS NO. #073222, ELECTRICAL NO. #091800		* Illuminated displays will be wired for 120 volt power unless otherwise noted. * Cost for providing necessary electrical wiring to sign area is not included in sign proposal.		REV. # DATE BY REV. 1 10/11/07 JW REV. 2 01/23/08 LSO REV. 3 02/27/08 TALL REV. 4 10/03/08 JB REV. 5 10/21/08 JWW	REV. # DATE BY REV. 6 11/06/08 MVS REV. 7 12/12/08 REV. 8 07/08/09 JWW REV. 9 07/08/09 TALL REV. 10 07/10/09 JWW	FIRM NAME / PROJECT ADDRESS TERRAVITA MARKETPLACE 34402 N. SCOTTSDALE ROAD SCOTTSDALE, ARIZONA SALESPERSON BRIDGET FALCO	ORIGINAL DATE: 09/04/07 ORIG. DESIGNER: L. den Dulk SCALE: As Noted	6071188-R10 FILE DESIGN NUMBER 2 OF 4 SHEET NUMBER
YESCO. YOUNG ELECTRIC SIGN COMPANY		SALES APPROVAL: DATE:						

© This Drawing was created to assist you in visualizing our proposal. The original ideas herein are the property of Young Electric Sign Company. Permission to copy or revise this drawing can only be obtained thru a written agreement with Yesco. See your Sales Representative or call the nearest office of Young Electric Sign Co.

SITE PLAN - SIGN LOCATIONS

SCALE: 1" = 100' - 0"

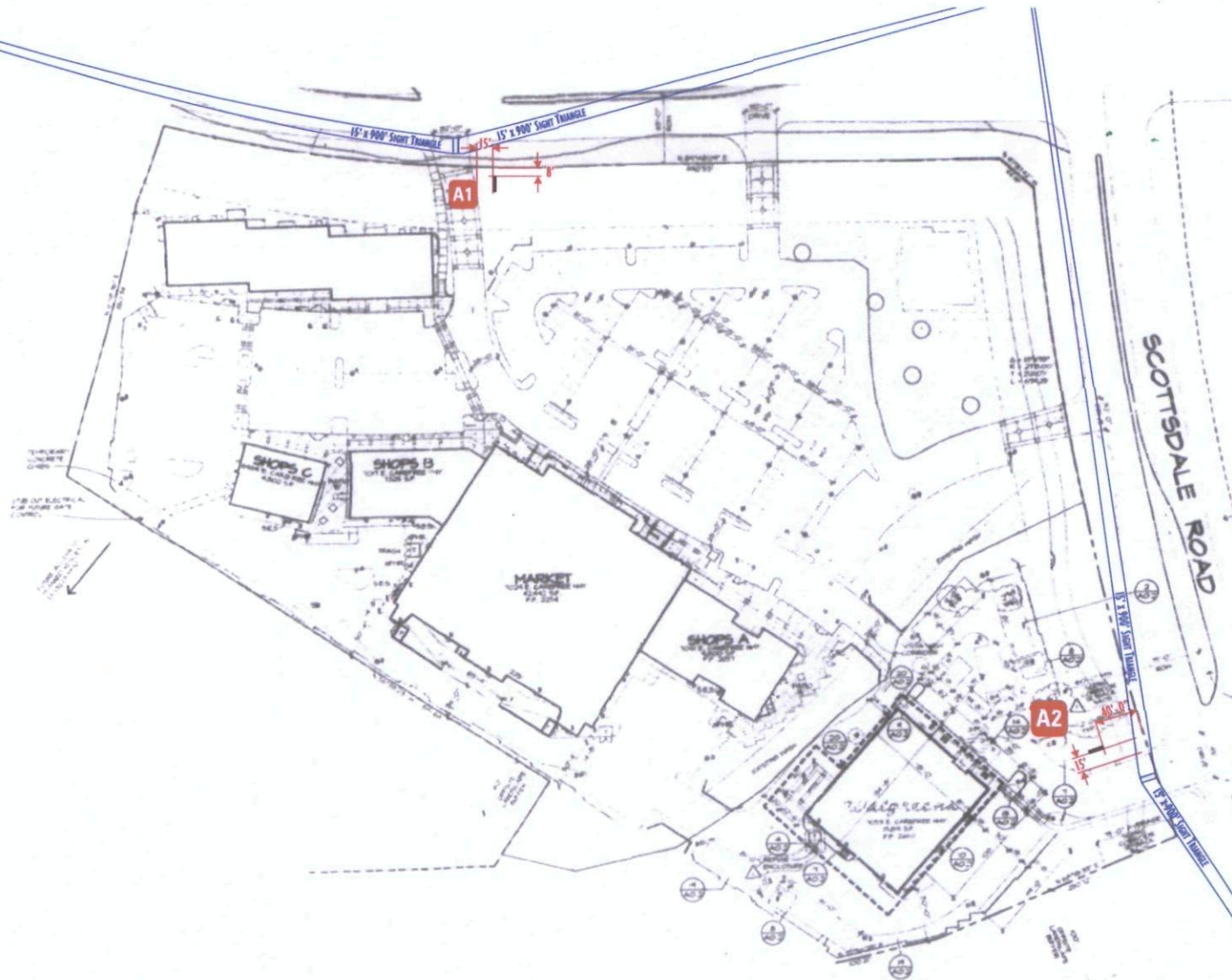

90-DK-2009

APPROVED

Chris McLaughlin 7/16/09
DATE



PHOENIX DIVISION

6725 W. Chicago Street, Chandler, Az 85226-3335 (480) 449-3728
ARIZONA CONTRACTOR LICENSE NO. P073322-007, AIRWAYS NO. P072202, ELECTRICAL NO. P092000

YESCO, YOUNG ELECTRIC SIGN COMPANY

* Illuminated displays will be wired for 120 volt power unless otherwise noted.

* Cost for providing necessary electrical wiring to sign area is not included in sign proposal.

SALES APPROVAL:

DATE:

REV. #	DATE	BY	REV. #	DATE	BY
REV. 1	10/11/07	JW	REV. 6	11/06/08	MVS
REV. 2	01/23/08	LSD	REV. 7	12/12/08	
REV. 3	02/27/08	TALL	REV. 8	07/08/09	JWW
REV. 4	10/03/08	JB	REV. 9	07/08/09	TALL
REV. 5	10/21/08	JWW	REV. 10	07/16/09	JWW

FIRM NAME / PROJECT ADDRESS

TERRAVITA MARKETPLACE
34402 N. SCOTTSDALE ROAD
SCOTTSDALE, ARIZONA

ORIGINAL DATE: 09/04/07

ORIG. DESIGNER: L. den Dulk

SCALE: As Noted

SALESPERSON BRIDGET FALCO

6071188-R10

FILE DESIGN NUMBER

3 OF 4

SHEET NUMBER

©This Drawing was created to assist you in visualizing our proposal. The original ideas herein are the property of Young Electric Sign Company. Permission to copy or revise this drawing can only be obtained thru a written agreement with Yesco. See your Sales Representative or call the nearest office of Young Electric Sign Co.