

LUMINAIRE TYPE D

SPECIFICATION SHEET

NO. _____ DATE _____
 THIS IS A TWO-PART SPECIFICATION:
 Module SPL1-MT5
 Housing

PROJECT NAME: _____ PROJECT LOCATION: _____
 PREPARED BY: _____ COMMENTS: _____

Slim Performance Linear Series - Single Lamp

Module: T5 Fluorescent

Sealed T5 fluorescent lamp and ballast module mates with any corresponding SPL1 Series Housing to create a complete fixture assembly. Available in nominal 2' x 4', and 5' units and continuous row lengths of 3', 4', and 5' increments.

FEATURES

- Sealed, silicone O-ring, dry-air charged, lamp and ballast module with two compartment construction for cooler ballast operation (below 60°C) and optimized lamp operating temperature.
- Internal reflector has 24 optical combinations, available in three distributions positioned at 45° intervals about the lamp.
- Module has tool-less entry with quick disconnects.

APPLICATIONS

Module is suitable for use in minor, transitional, and exterior locations. Modular housing system provides flexibility in mounting. Adjustable reflector angle and orientation provides 24 optical combinations for a variety of applications. The C270 reflector in position A provides the performance of a 270° reflector with 90° cut-off to maximize reflectance or light usually lost to ballast box.

SPECIFICATIONS

Materials & Finish: Extruded, optical grade, UV stable, clear acrylic body. Separate lamp and ballast compartments are air charged to -100°F (-73°C) dew point and sealed with silicone O-rings. Reflector is formed from highly specular shell aluminum. Level D3 - D4 are suitable for maintenance applications. This module has a D4 durability level.

Lamp Fluorescent, single 15w T5HO up to 80 wds maximum per lamp. 15HO or 54 wds is also available for constant light output over high and low ambient temperatures. Lamp is enclosed unless otherwise specified.

Socket: G5 miniature bi-pin, push fit style, rated 2 amps, 500 volts.

Ballast/Voltage: Integral electronic ballasts are wired with quick disconnects for easy installation and replacement.

- Standard Electronic Universal (120 - 277V, 50 - 60 Hz), for use with T5/THO/T5HO lamps.
- 10% Dimming - Lutron Eco-10, 120 or 277V, 60 Hz, for use with T5/THO lamps.
- 1% Dimming - Lutron Hi-Lume 120 or 277V, 50 Hz, for use with T5HO lamps only.

Electrical: Quick disconnect ballast provides ease of installation and maintenance. The electrical pass-through is an epoxy-encapsulated sliding barrier. Supply wiring, 18 AWG TFFN, 600V, 50°C Dry, 60°C Wet.

Distributions: Three internal reflector options are available. 270° reflector with 90° cut-off (C270), 225° reflector with 135° cut-off (C225), and 180° reflector with 180° cut-off (C180). Each reflector may be positioned at 45° intervals about the lamp, as specified by the reflector position [A-H]. Visit LITE360.com for G5 format files.

Mounting: Sealed acrylic module mates with corresponding SPL1 Series Housing for a complete fixture assembly. Refer to the SPL1 Series Housing specifications for reflective mounting options.

Hardware: Fasteners are stainless steel.

Options: Optional emergency ballast (EMB), 120 - 277V, 60 Hz, provides reduced lamp output in one lamp for a minimum of 90 minutes, available with 3 and 4 units only.

Labeling: All products to be labeled appropriately per destination, even to apartment (UL, CUL, wet location, CE, CCC).

IP Rating: Rated IP67 in conjunction with corresponding SPL1 Series Housing.

Warranty: Product is warranted for two years from date of shipment to be free from defects in parts or workmanship. Visit LITE360.com for full warranty details. Lamp and ballast are warranted by manufacturer for up to five years, consult lamp and ballast manufacturers' websites for additional warranty details.

Patents: Patent Pending.

© 2008 LITE360 SPL1MT5000212

LUMINAIRE TYPE D

SPECIFICATION SHEET

NO. _____ DATE _____
 THIS IS A TWO-PART SPECIFICATION:
 Module SPL1-MT5
 Housing

PROJECT NAME: _____ PROJECT LOCATION: _____
 PREPARED BY: _____ COMMENTS: _____

Slim Performance Linear Series - Single Lamp

Module: T5 Fluorescent

ORDERING GUIDE

MODULE	LENGTH	LAMP TYPE	COLOR TEMPERATURE	BALLAST/VOLTAGE	REFLECTOR POSITION	OPTIONS
SPL1	2'	SO	30K	UVOLT	C270	EMB
	3'	HO	35K	LE120	C225	
	4'	CO*	41K	LE277	C180	
	5'		LBO	LE277		

EXAMPLE
 SPL1-MT5-SS-SO-30K-UVOLT-C180-EMB
 is the standard catalog number for a Slim Performance Linear Single Lamp Series T5 Fluorescent Module in 5' length, with 15 lamps in 3000K color temperature, electronic standard ballast with Universal Voltage, 180° reflector in Position A, and optional Emergency Ballast.

© 2008 LITE360 SPL1MT5000212

LUMINAIRE TYPE D

SPECIFICATION SHEET

NO. _____ DATE _____
 THIS IS A TWO-PART SPECIFICATION:
 Module SPL1-MT5
 Housing

PROJECT NAME: _____ PROJECT LOCATION: _____
 PREPARED BY: _____ COMMENTS: _____

Slim Performance Linear Series - Single Lamp

Module: T5 Fluorescent

REFLECTOR CONFIGURATION

The following diagrams illustrate the light distribution of various Reflector Angle and Position combinations (accounting for ballast compartment cut-off) as viewed from the electrical input end of the module. Refer to the SPL1 Series Housing outside for module and housing orientation relative to the mounting surface and electrical input location.

© 2008 LITE360 SPL1MT5000212

LUMINAIRE TYPE E

Pole mounted downlight luminaires with high performance cutoff light distribution and shielded light source.

Type: _____ BEGA Product #: _____
 Project: _____
 Voltage: _____
 Color: _____
 Options: _____
 Modified: _____

Housing/Fitter: One piece heavy die cast aluminum construction with swivel arm and internal full semi specular anodized aluminum reflectors available in Type II and Type III distributions. Swivel arm allows for 0° to 15° aiming positions. Integral fitter slip fits 3" O.D. pole top and is secured by eight (8) socket head stainless steel set screws threaded into stainless steel inserts.

Enclosure: Door frames are die cast, hinged and latched for toolless entry. Lens is 1/4" clear tempered glass, sealed with one piece silicone gasket.

Electrical: Lampholder is medium base. Lampholder is porcelain with nickel plated copper screw shell, supplied with 200°C high temperature leads. Ballast is located in the luminaire and is available 120V or 277V - specify.

Finish: These luminaires are available in five standard BEGA colors: Black (BLK), White (WHT), Bronze (BRZ), Silver (SLV), Eurocoat® (URO). To specify, add appropriate suffix to catalog number. For complete description of BEGA finishing process, refer to technical information section at end of catalog. Custom colors supplied on special order. U.L. listed, suitable for wet locations. Protection class IP 65.

Pole top luminaires with high performance optical systems with type II or type III distributions. Specify coated lamps for optimum performance. Hinged door provided for toolless lamp and ballast removal. U.L. listed, suitable for wet locations. IP 65. Colors: Standard BEGA finishes.

Lamp	Lumen	A	B	C
8298MH*	2 100W ED-17 MH	17500	13	5/8 49/2

*Specify Type II or Type III distribution. Coated lamps required for proper optical performance.

BEGA/US 1000 BEGA Way, Carpinteria, CA 93013 [P] 805-684-0533 [F] 805-684-6682
 ©Copyright BEGA/US 2006 us0002 105

LUMINAIRE TYPE E1

Pole mounted downlight luminaires with high performance cutoff light distribution and shielded light source.

Type: _____ BEGA Product #: _____
 Project: _____
 Voltage: _____
 Color: _____
 Options: _____
 Modified: _____

Housing/Fitter: One piece heavy die cast aluminum construction with swivel arm and internal full semi specular anodized aluminum reflectors available in Type II and Type III distributions. Swivel arm allows for 0° to 15° aiming positions. Integral fitter slip fits 3" O.D. pole top and is secured by eight (8) socket head stainless steel set screws threaded into stainless steel inserts.

Enclosure: Door frames are die cast, hinged and latched for toolless entry. Lens is 1/4" clear tempered glass, sealed with one piece silicone gasket.

Electrical: Lampholder is medium base. Lampholder is porcelain with nickel plated copper screw shell, supplied with 200°C high temperature leads. Ballast is located in the luminaire and is available 120V or 277V - specify.

Finish: These luminaires are available in five standard BEGA colors: Black (BLK), White (WHT), Bronze (BRZ), Silver (SLV), Eurocoat® (URO). To specify, add appropriate suffix to catalog number. For complete description of BEGA finishing process, refer to technical information section at end of catalog. Custom colors supplied on special order. U.L. listed, suitable for wet locations. Protection class IP 65.

Pole top luminaires with high performance optical systems with type II or type III distributions. Specify coated lamps for optimum performance. Hinged door provided for toolless lamp and ballast removal. U.L. listed, suitable for wet locations. IP 65. Colors: Standard BEGA finishes.

Lamp	Lumen	A	B	C
8298MH*	2 100W ED-17 MH	17500	13	5/8 24K

*Specify Type II or Type III distribution. Coated lamps required for proper optical performance.

BEGA/US 1000 BEGA Way, Carpinteria, CA 93013 [P] 805-684-0533 [F] 805-684-6682
 ©Copyright BEGA/US 2006 us0002 105

LUMINAIRE TYPE G

Nightspot B 39/70W with mounting bracket

die cast aluminum low copper alloy housing and lens frame
 electronic metal halide ballast supplied with ceramic metal halide lamp
 UL listed wet label IP65
 powder coat finish
 bracket has tilt scale
 tempered glass lens
 silicone rubber gasket

© 2008 LITE360 SPL1MT5000212

FILE: J:\2008\081104_SkySong\NE100-1_200-2.dwg PLOTTED BY: Note PLOTTED: 05-06-2009 - 7:21pm

ARCHITTEKTON

464 S Farmer Ave., Suite 101
 Tempe AZ, 85281
 T 480.894.4637
 F 480.894.4638
 www.archittekton.com



Owners/Developers
USAA Real Estate Company
 9830 Colonnade Blvd.
 Suite 600
 San Antonio, TX 78230-2239

ASU Foundation
 Fulton Center
 300 E. University Drive
 P.O. Box 2280
 Tempe, AZ 85280-2260

HIGGINS Development Partners
 101 East Erie Street
 Suite 800
 Chicago, IL 60611

The Plaza Companies
 9401 W Thunderbird Road
 Suite 200
 Peoria, AZ 85381

SkySong 3
 North Scottsdale Road
 Scottsdale, Arizona 85257

460-PA-2004

Development Review Board Submittal
 Date: 05/08/09
SITE LIGHTING CUT SHEETS

E202

LITECONTROL

LUMINAIRE TYPE C

Type: Project

Mod² R-D-4400, RP-D-4400 Plaster, Drywall, Concealed Spine Ceilings Recessed Flanged Direct

Specifications

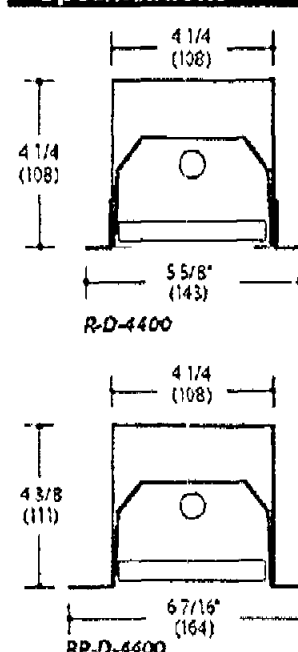

HOUSING: Die formed and welded steel with 3/8" regression at housing bottom for rigidity and appearance. Recessed with 6" long, steel spines for insertion at each side of housing at junction of fixture as in rows for precise alignment. End heads have distance holes for easy row installation and are notched under lamps for more even diffuser luminescence and uniform surface appearance. SPACKLE TRIM: (RP-D only) Continuous Spackle Trim with beaded edge welded to housing dies. Spackle trim allows plaster coat up to fixture edge for clean ceiling appearance. REFLECTOR: Die formed steel with high efficiency white finish. END CAPS: Steel flanged to match housing. Two mounting holes on each end cap allow tight attachment to ends of individual fixtures and ends of rows. BALLAST: Electronic Ballast (ELB) for T8 lamps; or Low-profile Electronic Ballast (LPELB) for T5 or T5HO lamps; or Power Factor Corrected (PFC) Standard Rated Ballast (SRB) for T8 lamps manufactured by a UL listed manufacturer, as available determined by Litecontrol Ballasts in a voltage range of 120V to 277V will be used when fixture configuration and ballast availability allow. The minimum number of ballasts will be used. LEARNING: Available in one-lamp, two-lamp and one- and two-lamp T5 or T5HO cross-section. Easy ballast removal to access replace lamps without tools. STANDARD WIRING: When selected from Ordering guide below, fixtures wired to switch in-line lamps separately, providing two (two-lamp cross-section fixtures only) levels of light. SYSTEM CONNECTORS: Lighted corners available. Die formed and welded steel with 3/8" regression at housing bottom. Diffusers or diffusers finished to match appearance of adjoining fixtures. See Field Measurement Procedures in the Litecontrol Product Guide for instructions. CERTIFICATION: Fixtures and electrical components shall be UL and/or CUL listed and shall bear the IESBEV, A.S. or UL label. Note: Litecontrol reserves the right to change specifications without notice for product development and improvement.

Ordering guide

Ordering guide table with columns for Product, Lamping, & Length; Options; and Cross-section lamping. Includes a 'Click on Quick find 44rd' button.

Questions to Ask 1. 120 or 277 volt? 2. Row information, including desired fixture lengths? 3. Diffuser type? 4. Tandem wiring? 5. Other options?

litecontrol.com

Diffusers

PBSS Semi-specular Aluminum Parabolic Baffle, 1 1/2" x 2" OC, anodized aluminum. BW Blade Baffle, White, 3/4" high x 3/4" OC, steel, recessed. SGL Soft Glow Lens, Extruded, frosted acrylic, flush to bottom of fixture housing.

Ballast options

Specify in place of ELB or LPELB, contact factory for availability/compatibility with lamping. DA/ELB Advance Mark VII Dimming Ballast. LPE/ELB Low-profile Dimming Ballast, Manufactured by a UL Listed manufacturer.

Other options

LPE/E Low-profile Emergency Fluorescent Ballast, Battery-powered ballast from a UL listed manufacturer will operate one lamp for 1 1/2 hours. Note: Show as fast below determined by Litecontrol.

Planning for installation

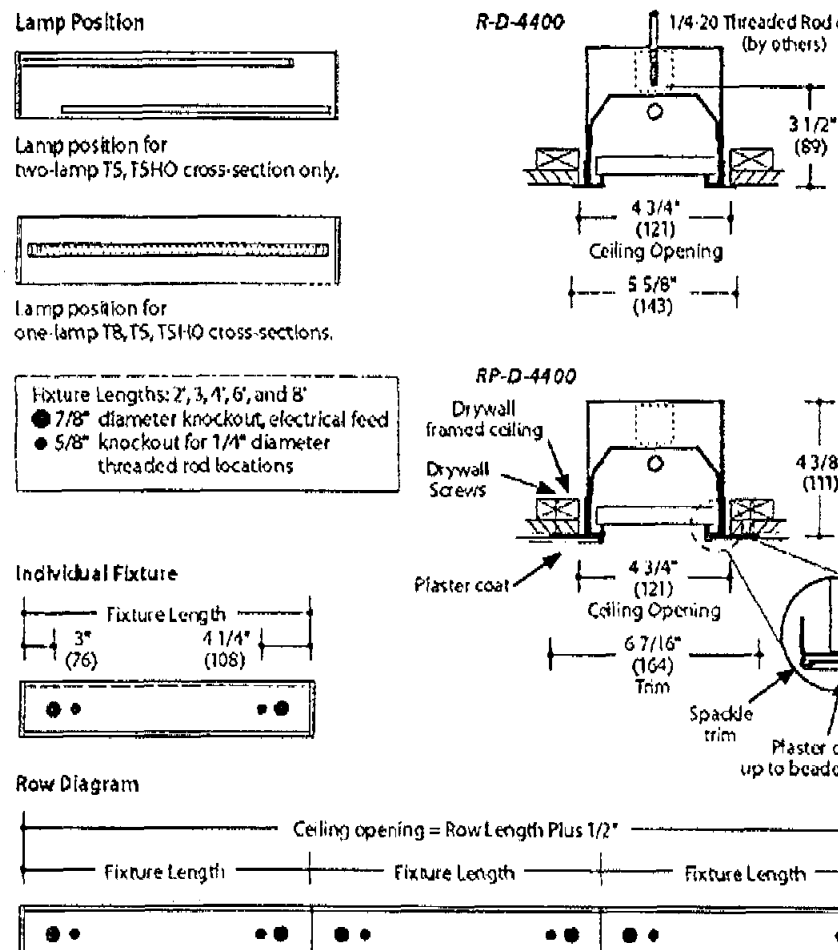

System connectors

System connectors table with columns for Product, Lamping, & Length; Options; and Diffuser. Includes a 'Click on Quick find 44rd' button.

R-D-4422-C90L-T5HO-PBSS-CWM-TW-LPELB-2CVQ-LPE/E-120 is a typical catalog number for a 2-lamp (2 lamps in cross-section), 2-foot long high-output T5 HO lighted corner connector, with semi-specular parabolic baffle, Matte White finish, tandem wired low profile electronic ballast, provided with two circuit branch wiring and quickconnects 120 volts.

LUMINAIRE TYPE C

Photometric data

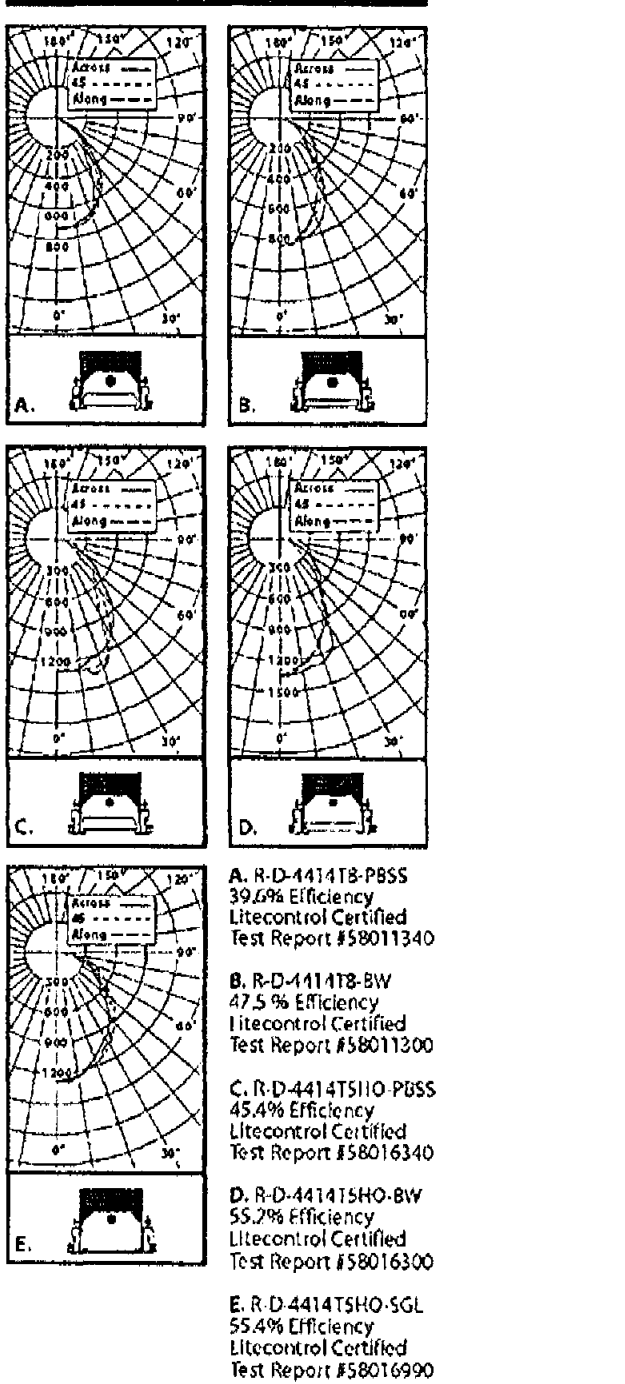

For complete photometric information, see website.

LUMINAIRE TYPE C

System connectors R-D-4400 and RP-D-4400 continued

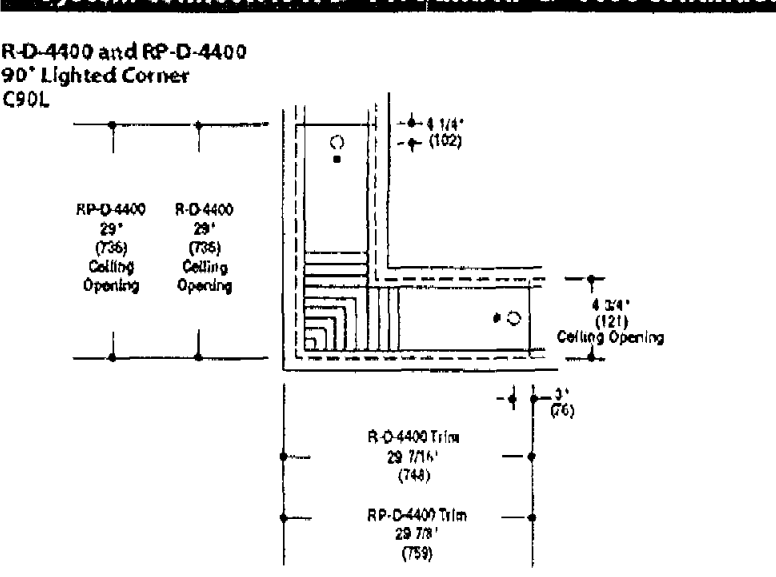

Corners are of one-piece construction, ready to install, with diffusers that match adjoining fixtures. Fixtures cannot be butted to form corners.

General notes for specifiers and contractors

- General notes for specifiers and contractors. 1. Fixtures may be mounted in plaster, drywall, or concealed spine ceilings, individually, or in rows. Each fixture is supported by two 1/4-20 threaded rods. 2. Prior to fixture installation (2) 1/4-20 threaded rods performance must be located and installed in the ceiling. Note: threaded rods must end 3" above finished ceiling. 3. Electrical and ceiling contractors should both understand that this system is not a standard tuffer construction (due to continuous light feature), so coordination between the two trades is essential. 4. Lighted corners (90° and 135°) are available. If lighted corners are part of the installation, corners should be installed before fixtures. 5. Installation instructions for this fixture and all Litecontrol fixtures are available from your Litecontrol representative or by contacting the factory. Instructions are also provided with every fixture shipment.

Photometric data - T8 lamps

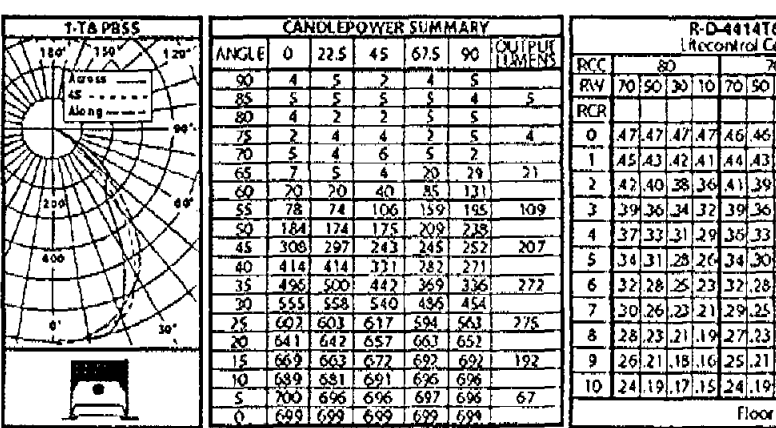

LITECONTROL... an employee owned company 100 Hawks Avenue Hanson MA 02341 781 294 0100 FAX 781 293 2849 info@litecontrol.com www.litecontrol.com

LUMINAIRE TYPE C

Photometric data - T8 lamps (continued)

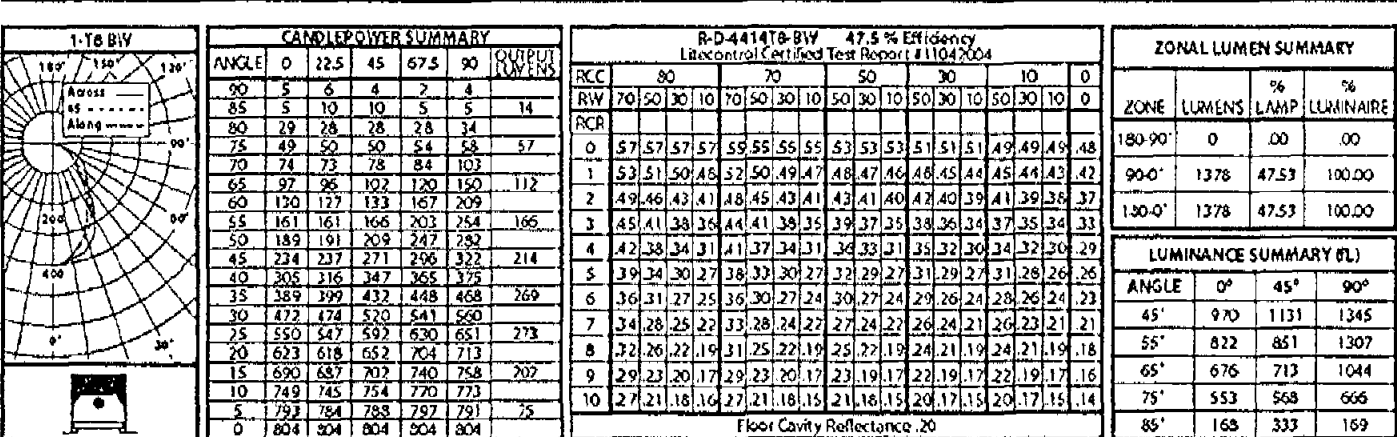

Photometric data - T5HO lamps

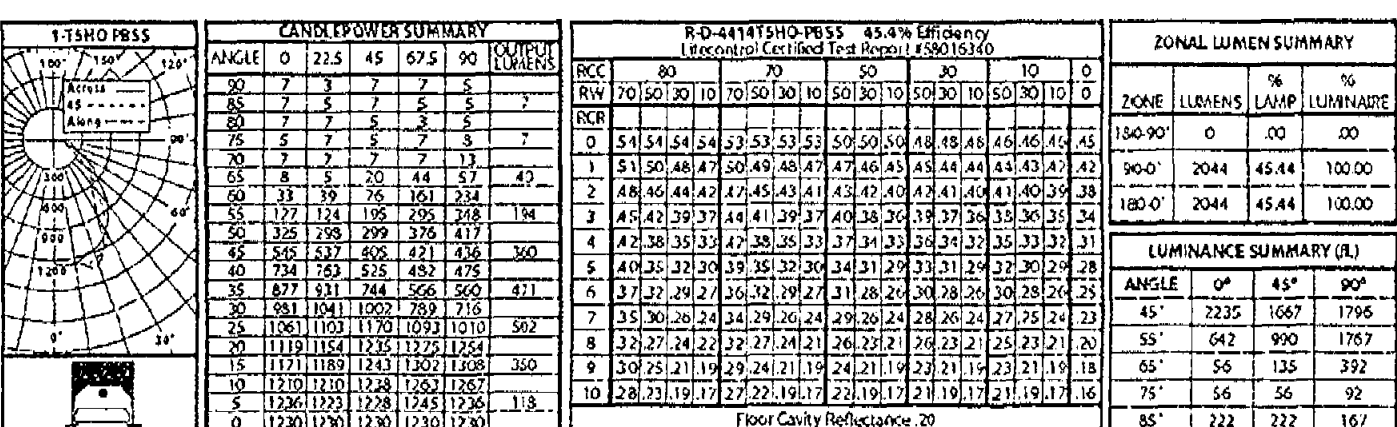

Photometric data - T5HO SGL

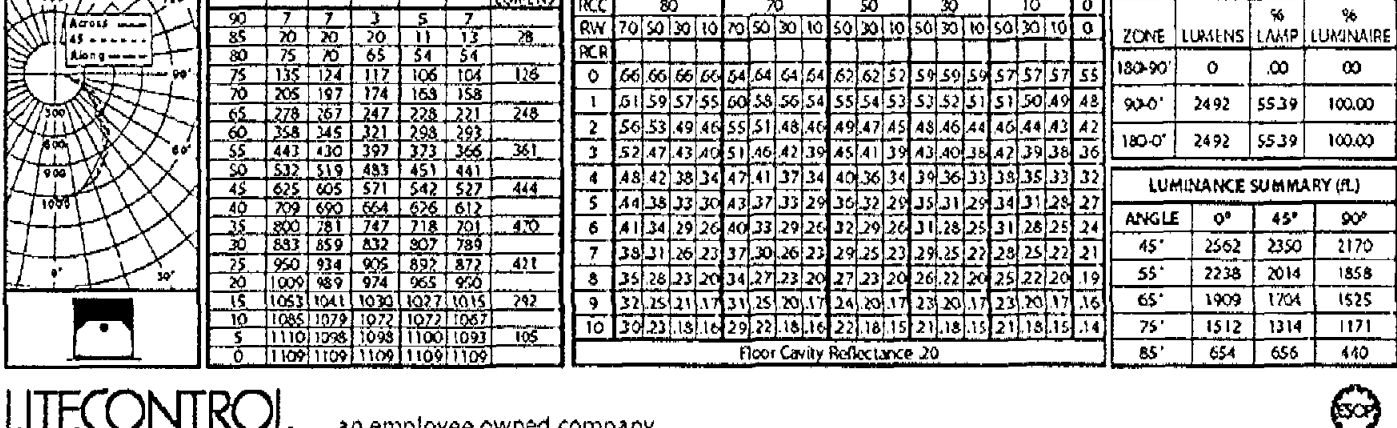
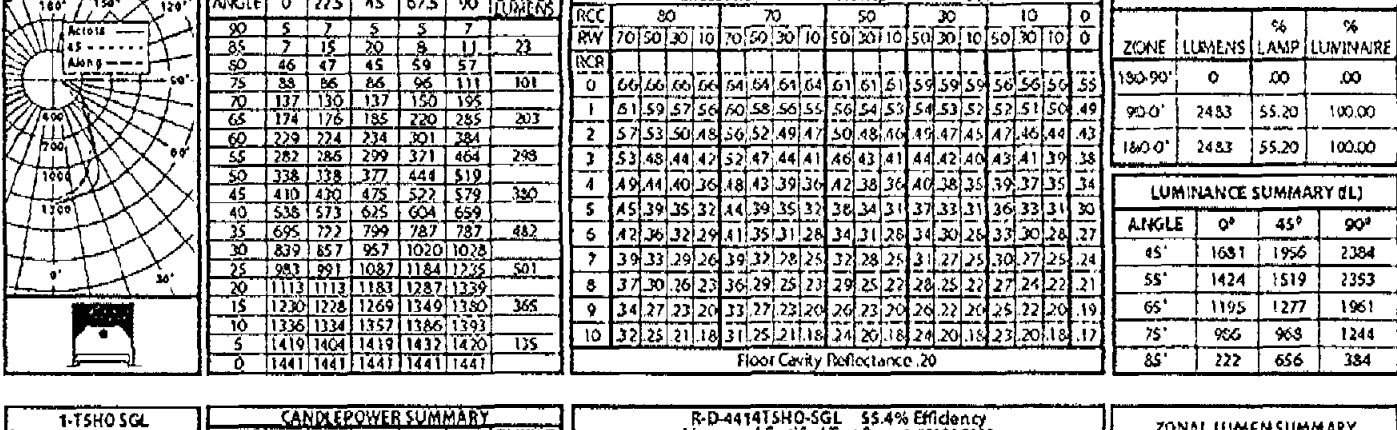

LITECONTROL... an employee owned company 100 HAWKS AVENUE HANSON MA 02341 781 294 0100 FAX 781 293 2849 info@litecontrol.com www.litecontrol.com

LUMINAIRE TYPE D

SPECIFICATION SHEET FIXTURE TYPE

Specification sheet form for Luminaire Type D, including fields for Project Name, Location, Date, and Comments.

SPL1-HSS

Slim Performance Linear Series - Single Lamp Housing: Surface Side-Mount

Surface Side Mount Housing available in all corresponding SPL1 Series Modules to create a complete fixture assembly. Available in nominal 2, 3, 4, 5, 6, 8, 10, 12, 15, 18, 24, 30, 36, 48, 60, 72, 84, 96, 108, 120, 144, 180, 216, 240, 270, 300, 360, 480, 600, 720, 840, 960, 1080, 1200, 1440, 1800, 2160, 2400, 2700, 3000, 3600, 4800, 6000, 7200, 8400, 9600, 10800, 12000, 14400, 18000, 21600, 24000, 27000, 30000, 36000, 48000, 60000, 72000, 84000, 96000, 108000, 120000, 144000, 180000, 216000, 240000, 270000, 300000, 360000, 480000, 600000, 720000, 840000, 960000, 1080000, 1200000, 1440000, 1800000, 2160000, 2400000, 2700000, 3000000, 3600000, 4800000, 6000000, 7200000, 8400000, 9600000, 10800000, 12000000, 14400000, 18000000, 21600000, 24000000, 27000000, 30000000, 36000000, 48000000, 60000000, 72000000, 84000000, 96000000, 108000000, 120000000, 144000000, 180000000, 216000000, 240000000, 270000000, 300000000, 360000000, 480000000, 600000000, 720000000, 840000000, 960000000, 1080000000, 1200000000, 1440000000, 1800000000, 2160000000, 2400000000, 2700000000, 3000000000, 3600000000, 4800000000, 6000000000, 7200000000, 8400000000, 9600000000, 10800000000, 12000000000, 14400000000, 18000000000, 21600000000, 24000000000, 27000000000, 30000000000, 36000000000, 48000000000, 60000000000, 72000000000, 84000000000, 96000000000, 108000000000, 120000000000, 144000000000, 180000000000, 216000000000, 240000000000, 270000000000, 300000000000, 360000000000, 480000000000, 600000000000, 720000000000, 840000000000, 960000000000, 1080000000000, 1200000000000, 1440000000000, 1800000000000, 2160000000000, 2400000000000, 2700000000000, 3000000000000, 3600000000000, 4800000000000, 6000000000000, 7200000000000, 8400000000000, 9600000000000, 10800000000000, 12000000000000, 14400000000000, 18000000000000, 21600000000000, 24000000000000, 27000000000000, 30000000000000, 36000000000000, 48000000000000, 60000000000000, 72000000000000, 84000000000000, 96000000000000, 108000000000000, 120000000000000, 144000000000000, 180000000000000, 216000000000000, 240000000000000, 270000000000000, 300000000000000, 360000000000000, 480000000000000, 600000000000000, 720000000000000, 840000000000000, 960000000000000, 1080000000000000, 1200000000000000, 1440000000000000, 1800000000000000, 2160000000000000, 2400000000000000, 2700000000000000, 3000000000000000, 3600000000000000, 4800000000000000, 6000000000000000, 7200000000000000, 8400000000000000, 9600000000000000, 10800000000000000, 12000000000000000, 14400000000000000, 18000000000000000, 21600000000000000, 24000000000000000, 27000000000000000, 30000000000000000, 36000000000000000, 48000000000000000, 60000000000000000, 72000000000000000, 84000000000000000, 96000000000000000, 108000000000000000, 120000000000000000, 144000000000000000, 180000000000000000, 216000000000000000, 240000000000000000, 270000000000000000, 300000000000000000, 360000000000000000, 480000000000000000, 600000000000000000, 720000000000000000, 840000000000000000, 960000000000000000, 1080000000000000000, 1200000000000000000, 1440000000000000000, 1800000000000000000, 2160000000000000000, 2400000000000000000, 2700000000000000000, 3000000000000000000, 3600000000000000000, 4800000000000000000, 6000000000000000000, 7200000000000000000, 8400000000000000000, 9600000000000000000, 10800000000000000000, 12000000000000000000, 14400000000000000000, 18000000000000000000, 21600000000000000000, 24000000000000000000, 27000000000000000000, 30000000000000000000, 36000000000000000000, 48000000000000000000, 60000000000000000000, 72000000000000000000, 84000000000000000000, 96000000000000000000, 108000000000000000000, 120000000000000000000, 144000000000000000000, 180000000000000000000, 216000000000000000000, 240000000000000000000, 270000000000000000000, 300000000000000000000, 360000000000000000000, 480000000000000000000, 600000000000000000000, 720000000000000000000, 840000000000000000000, 960000000000000000000, 1080000000000000000000, 1200000000000000000000, 1440000000000000000000, 1800000000000000000000, 2160000000000000000000, 2400000000000000000000, 2700000000000000000000, 3000000000000000000000, 3600000000000000000000, 4800000000000000000000, 6000000000000000000000, 7200000000000000000000, 8400000000000000000000, 9600000000000000000000, 10800000000000000000000, 12000000000000000000000, 14400000000000000000000, 18000000000000000000000, 21600000000000000000000, 24000000000000000000000, 27000000000000000000000, 30000000000000000000000, 36000000000000000000000, 48000000000000000000000, 60000000000000000000000, 72000000000000000000000, 84000000000000000000000, 96000000000000000000000, 108000000000000000000000, 120000000000000000000000, 144000000000000000000000, 180000000000000000000000, 216000000000000000000000, 240000000000000000000000, 270000000000000000000000, 300000000000000000000000, 360000000000000000000000, 480000000000000000000000, 600000000000000000000000, 720000000000000000000000, 840000000000000000000000, 960000000000000000000000, 1080000000000000000000000, 1200000000000000000000000, 1440000000000000000000000, 1800000000000000000000000, 2160000000000000000000000, 2400000000000000000000000, 2700000000000000000000000, 3000000000000000000000000, 3600000000000000000000000, 4800000000000000000000000, 6000000000000000000000000, 7200000000000000000000000, 8400000000000000000000000, 9600000000000000000000000, 10800000000000000000000000, 12000000000000000000000000, 14400000000000000000000000, 18000000000000000000000000, 21600000000000000000000000, 24000000000000000000000000, 27000000000000000000000000, 30000000000000000000000000, 36000000000000000000000000, 48000000000000000000000000, 60000000000000000000000000, 72000000000000000000000000, 84000000000000000000000000, 96000000000000000000000000, 108000000000000000000000000, 120000000000000000000000000, 144000000000000000000000000, 180000000000000000000000000, 216000000000000000000000000, 240000000000000000000000000, 270000000000000000000000000, 300000000000000000000000000, 360000000000000000000000000, 480000000000000000000000000, 600000000000000000000000000, 720000000000000000000000000, 840000000000000000000000000, 960000000000000000000000000, 1080000000000000000000000000, 1200000000000000000000000000, 1440000000000000000000000000, 1800000000000000000000000000, 2160000000000000000000000000, 2400000000000000000000000000, 2700000000000000000000000000, 3000000000000000000000000000, 3600000000000000000000000000, 4800000000000000000000000000, 6000000000000000000000000000, 7200000000000000000000000000, 8400000000000000000000000000, 9600000000000000000000000000, 10800000000000000000000000000, 12000000000000000000000000000, 14400000000000000000000000000, 18000000000000000000000000000, 21600000000000000000000000000, 24000000000000000000000000000, 27000000000000000000000000000, 30000000000000000000000000000, 36000000000000000000000000000, 48000000000000000000000000000, 60000000000000000000000000000, 72000000000000000000000000000, 84000000000000000000000000000, 96000000000000000000000000000, 108000000000000000000000000000, 120000000000000000000000000000, 144000000000000000000000000000, 180000000000000000000000000000, 216000000000000000000000000000, 240000000000000000000000000000, 270000000000000000000000000000, 300000000000000000000000000000, 360000000000000000000000000000, 480000000000000000000000000000, 600000000000000000000000000000, 720000000000000000000000000000, 840000000000000000000000000000, 960000000000000000000000000000, 1080000000000000000000000000000, 1200000000000000000000000000000, 1440000000000000000000000000000, 1800000000000000000000000000000, 2160000000000000000000000000000, 2400000000000000000000000000000, 2700000000000000000000000000000, 3000000000000000000000000000000, 3600000000000000000000000000000, 4800000000000000000000000000000, 6000000000000000000000000000000, 7200000000000000000000000000000, 8400000000000000000000000000000, 9600000000000000000000000000000, 10800000000000000000000000000000, 12000000000000000000000000000000, 14400000000000000000000000000000, 18000000000000000000000000000000, 21600000000000000000000000000000, 24000000000000000000000000000000, 27000000000000000000000000000000, 30000000000000000000000000000000, 36000000000000000000000000000000, 48000000000000000000000000000000, 60000000000000000000000000000000, 72000000000000000000000000000000, 84000000000000000000000000000000, 96000000000000000000000000000000, 108000000000000000000000000000000, 120000000000000000000000000000000, 144000000000000000000000000000000, 180000000000000000000000000000000, 216000000000000000000000000000000, 240000000000000000000000000000000, 270000000000000000000000000000000, 300000000000000000000000000000000, 360000000000000000000000000000000, 480000000000000000000000000000000, 600000000000000000000000000000000, 720000000000000000000000000000000, 840000000000000000000000000000000, 960000000000000000000000000000000, 1080000000000000000000000000000000, 1200000000000000000000000000000000, 1440000000000000000000000000000000, 1800000000000000000000000000000000, 2160000000000000000000000000000000, 2400000000000000000000000000000000, 2700000000000000000000000000000000, 3000000000000000000000000000000000, 360000000000000000

LUMINAIRE TYPE A3, A4, & A5



FEATURES & SPECIFICATIONS

INTENDED USE — Streets, walkways, parking lots and surrounding areas. CONSTRUCTION — Rugged, die-cast, single-piece aluminum housing with nominal wall thickness of 1/8". Die-cast door frame has impact-resistant, tempered, glass lens (3/16" thick). Door frame is fully gasketed with one-piece tubular silicone. US Patent No. D417,590, Canada Patent No. 94324. FINISH — Standard finish is dark bronze polyester powder finish. Additional architectural colors are available; see www.lithonia.com/architects.

Table with columns: Catalog Number, Notes, Type

AERIS™ Architectural Area & Roadway Luminaires

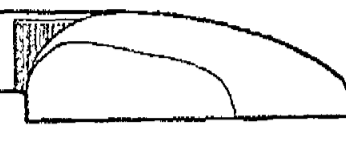

AS2

METAL HALIDE: 200W-400W HIGH PRESSURE SODIUM: 200W-400W 10" to 35" Mounting

Specifications table with columns: EPA, Length, Width, Depth, Weight

ELECTRICAL SYSTEM — Ballast Constant-voltage autotransformer ballast standard. Super CWA pulse-start ballast required 200W, 320W and 350W (SCWA option). Ballast is copper-wound and 100% factory-tested. All ballasts are mounted on a removable power tray with tool-less latch and have positive locking disconnect plugs.

ORDERING INFORMATION

Ordering information table with columns: Series, Wattage, Voltage, Mounting, Ballast, Options, Finish, Lamp

For shortest lead times, configure product using standard options (shown in bold). Example: AS2 250M SR3 TB SPA LPI

Outdoor

Sheet #: AS2-M-S AL-100

PROJECT SkySong Building 3 Architect Architekton Engineer ESD, Inc.

Table with columns: Type, Image, Manufacturer, Catalog Number, Quantity/Lamp, Finish, Remarks/Notes

2.Sep.08

PROJECT SkySong Building 3 Architect Architekton Engineer ESD, Inc.

Table with columns: Type, Image, Manufacturer, Catalog Number, Quantity/Lamp, Finish, Remarks/Notes

2.Sep.08

PROJECT SkySong Building 3 Architect Architekton Engineer ESD, Inc.

Table with columns: Type, Image, Manufacturer, Catalog Number, Quantity/Lamp, Finish, Remarks/Notes

- NOTES: 1. Verify finishes of all lighting products with Architect. 2. Verify mounting details of any atypical light fixtures with Architect. 3. Lighting product voltages and ceiling trim compatibility prior to ordering fixtures with Architect. 4. Electrical Contractor shall provide metal halide and fluorescent lamps of each type from a single manufacturer manufactured within the same time frame for lamp color consistency. 5. Electrical Engineer shall be responsible for specification of all emergency lighting, including emergency battery packs, quartz re-strike, etc. Electrical Engineer shall coordinate emergency lighting with Architect. 6. For fixtures using remote transformers, the Electrical Contractor shall provide secondary wire sized for the total load so that voltage at the last fixture is not less than 11.5 volts for a 12 volt system and 22.8 volts for a 24 volt system. 7. Electrical Contractor shall verify remote transformer/ballast mounting location and provide as necessary as required by Architect prior to rough-in. 8. Electrical Contractor shall provide labor and equipment to aim all adjustable lighting equipment for the entire project. The Electrical Contractor shall plan for some of this work to be completed after dark. 9. Upon energizing any metal halide equipment, lamps shall be burned in for 100 hours continuously.

2.Sep.08

LUMINAIRE TYPE A3, A4, & A5 AS2 Metal Halide, High Pressure Sodium Area Lighting

Definition of Utilization Initial Footcandle

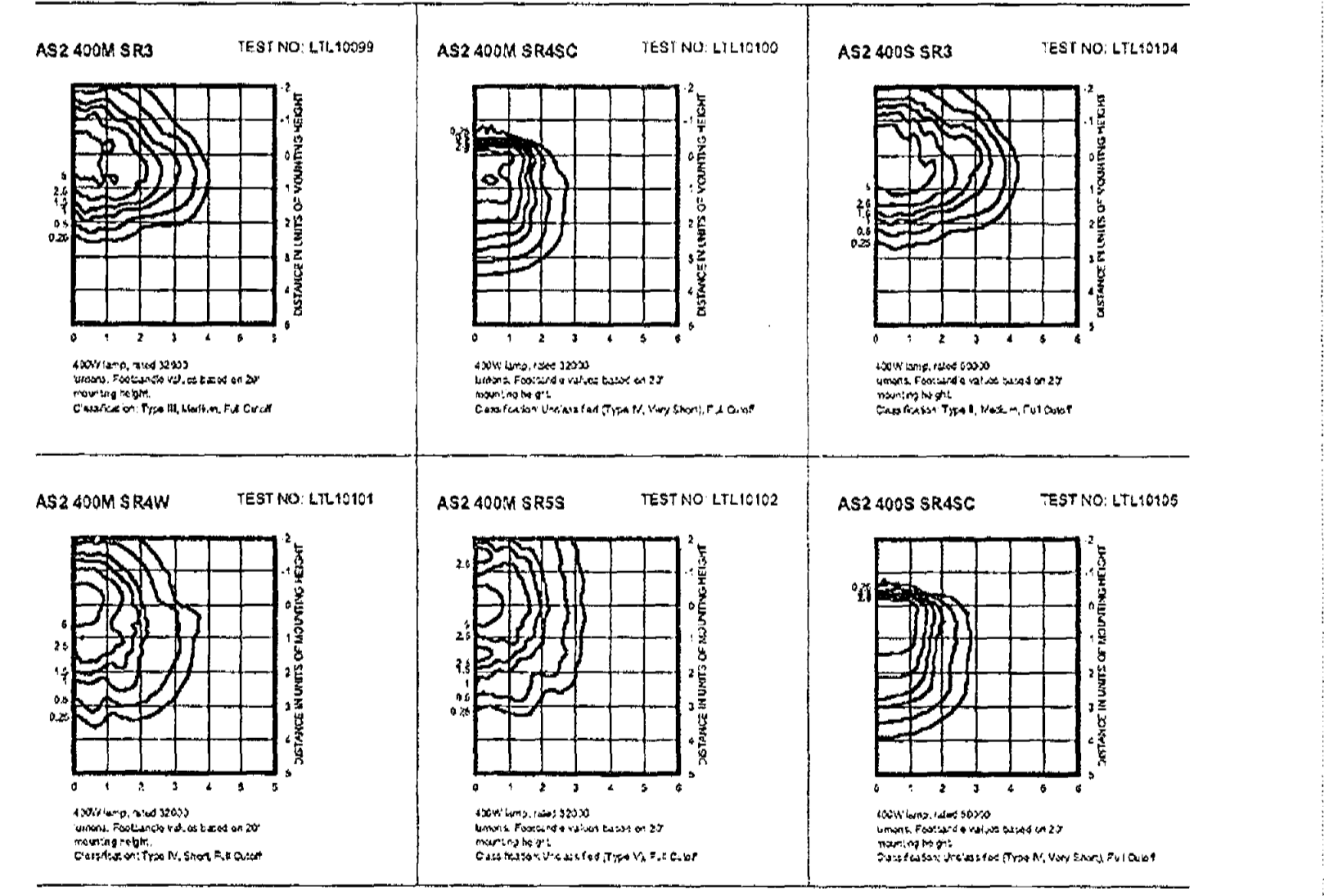

Mounting Height Correction Factor (Multiply this factor by the correction factor) 10 ft. = 1.25 15 ft. = .83 20 ft. = .67 40 ft. = .33



Sheet #: AS2-M-S ©2002 Acuity Brands Lighting, Inc. Rev. 01/08

Lithonia Lighting One Lithonia Way, Commerce, GA 30012 Phone: 770 922 9000 Fax: 770 918 1269 www.lithonia.com

ARCHITEKTON

464 S Farmer Ave., Suite 101 Tempe AZ, 85281 T 480.894.4637 F 480.894.4638 www.architekton.com



Owners/Developers

- USAA Real Estate Company 9830 Colonnade Blvd. Suite 600 San Antonio, TX 78230-2239
ASU Foundation 101 East Erie Street Suite 300 Chicago, IL 60611
The Plaza Companies 9401 W Thunderbird Road Suite 200 Peoria, AZ 85381

SkySong 3 North Scottsdale Road Scottsdale, Arizona 85257

460-PA-2004

Design Review Board Submittal Date: 05/08/09 SITE LIGHTING SCHEDULE AND CUT SHEETS

E200

SHEET NOTES

1. FOOT CANDLE VALUES WERE CALCULATED USING THE PHOTOMETRY CALCULATION PROGRAM VISUAL PROFESSIONAL EDITION V2.05.14Z.
2. CALCULATED VALUES INCLUDE DIRECT AND INTERREFLECTED COMPONENTS.
3. LUMINAIRE SELECTION BY RC LURIE. CONTACT DARRYL GREGG AT 602.799.0049 FOR ADDITIONAL REQUIREMENTS AND CLARIFICATIONS.

454 S Farmer Ave., Suite 101
Tempe AZ, 85281
T 480.894.4637
F 480.894.4638
www.architekton.com

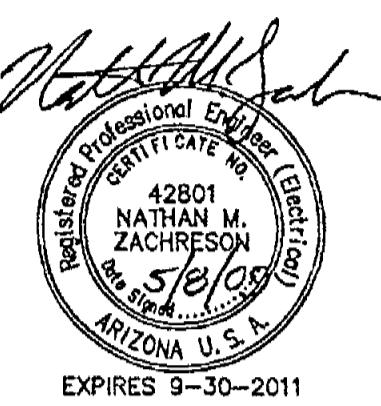

Owners/Developers

- USAA Real Estate Company**
930 Colonnade Blvd.
Suite 600
San Antonio, TX 78230-2239
- ASU Foundation**
Fulton Center
300 E. University Drive
P.O. Box 2260
Tempe, AZ 85280-2260
- HIGGINS Development Partners**
101 East Erie Street
Suite 800
Chicago, IL 60611
- The Plaza Companies**
9401 W Thunderbird Road
Suite 200
Peoria, AZ 85361

SkySong 3
North Scottsdale Road
Scottsdale, Arizona 85257

460-PA-2004

Development Review
Board Submittal
Date: 05/08/09
SITE LIGHTING PHOTOMETRY AFTER CURFEW
E101

LUMINAIRE SCHEDULE						
SYMBOL	LABEL	QTY	CATALOG NUMBER	DESCRIPTION	LAMP	FILE LUMENS LUF WATTS
□	A5	6	LITHONIA AS2 250M SR4W TB SPA DM19AS SCWA SSS 17.5' WITH 2.5' BASE	FULL CUT OFF AREA LIGHT	ONE 250-WATT PULSE START METAL HALIDE.	LTL10252.IES 23000 0.81 297
□	A4	8	LITHONIA AS2 250M SR4W HS TB SPA DM19AS SCWA SSS 17.5' WITH 2.5' BASE	FULL CUT OFF AREA LIGHT	ONE 250-WATT PULSE START METAL HALIDE.	LTL12463.IES 23000 0.81 297
□	A3	0	LITHONIA AS2 250M SR3 TB SPA DM19AS SCWA SSS 17.5' WITH 2.5' BASE	FULL CUT OFF AREA LIGHT	ONE 250-WATT PULSE START METAL HALIDE.	LTL10247.IES 23000 0.81 297
	C	89	LITECONTROL R D 44 1 4 TB SGL CWM ELB	4" RECESSED DIRECT	ONE 25 WATT TB	R-D-4414TSHO-2400 -SGL.IES 0.75 25
□	E	2	BEGA B258MH TYPE III SLV	POLE MOUNTED LUMINAIRE W/DIFFUSE RIBBED REFLECTOR W/SPECULAR SIDES CLEAR FLAT GLASS MOUNTED AT 15'	TWO 100 WATT METAL HALIDE	8295MH TYPE 8800 0.81 200
□	E1	0	BEGA B258MH TYPE III SLV	POLE MOUNTED LUMINAIRE W/DIFFUSE RIBBED REFLECTOR W/SPECULAR SIDES CLEAR FLAT GLASS MOUNTED AT 15'	(1) 100W ED-17 MH COATED	8258MH TYPE 8800 0.75 100
—	D	55	LITE360/SPL1-MT5-XR04-SO-35K-UVOLT-C180 H LAMP MODULE AND SPL1-HSS-XR04-D1-ALUM-SV HOUSING	SURFACE SIDE-MOUNT SINGLE LAMP FIXTURE EQUIPPED WITH CORE MODULE TECHNOLOGY FEATURING A SEPARATELY SEALED, IP67, T5 FLUORESCENT LAMP AND BALLAST MODULE. SPECIFIABLE REFLECTOR CUT-OFF AND POSITIONING OFFERS 24 OPTICAL COMBINATIONS. AVAILABLE IN NOMINAL 2', 3', 4', AND 5' UNITS WITH KNOCK-OUTS AND PRE-WIRED CONNECTORS FOR CONTINUOUS ROW INSTALLATION.	ONE 28-WATT PHILIPS T-5 F28T8/B35 FLUORESCENT.	46678-4'.IES 2900 0.75 30.8
○	G	12	DESIGNPLAN NN1 9 R2 B 10 D 0 T 0	SPOT LIGHT MOUNTED AT 60'	ONE 70 WATT METAL HALIDE	NW1-9R2 (M952042).IES 6600 0.72 88
□	A	0	EXISTING POLE LIGHT		ONE 250 WATT METAL HALIDE	CG600_800 20000 0.72 275
○	B	0	EXISTING POLE LIGHT		ONE 250 WATT METAL HALIDE	FH3-250MH.IES 21000 0.72 295
□	F	1	LITHONIA AS2 250M SR4W TB SPA DM19AS SCWA SSS 17.5' WITH 2.5' BASE	FULL CUT OFF AREA LIGHT	ONE 250-WATT PULSE START METAL HALIDE.	LTL10415.IES 23000 0.81 297

STATISTICS						
DESCRIPTION	SYMBOL	AVG	MAX	MIN	MAX/MIN	AVG/MIN
SOUTH DOUBLE DOORS	+	1.0 FC	1.0 FC	1.0 FC	1.0:1	1.0:1
SITE	+	0.9 FC	9.4 FC	0.0 FC	N / A	N / A
WALL GRAZING	+	11.4 FC	97.5 FC	0.3 FC	325.0:1	38.0:1

APPROVED
DATE



ENERGY SYSTEMS DESIGN
4747 N. 22ND STREET
SUITE 300
PHOENIX AZ 85016
P: 602/957-8333
F: 602/954-6383
PROJECT # 08104000
DESIGN CONTACT NATE ZACHRESON

SITE LIGHTING PHOTOMETRY AFTER CURFEW
SCALE: 1" = 40'-0"

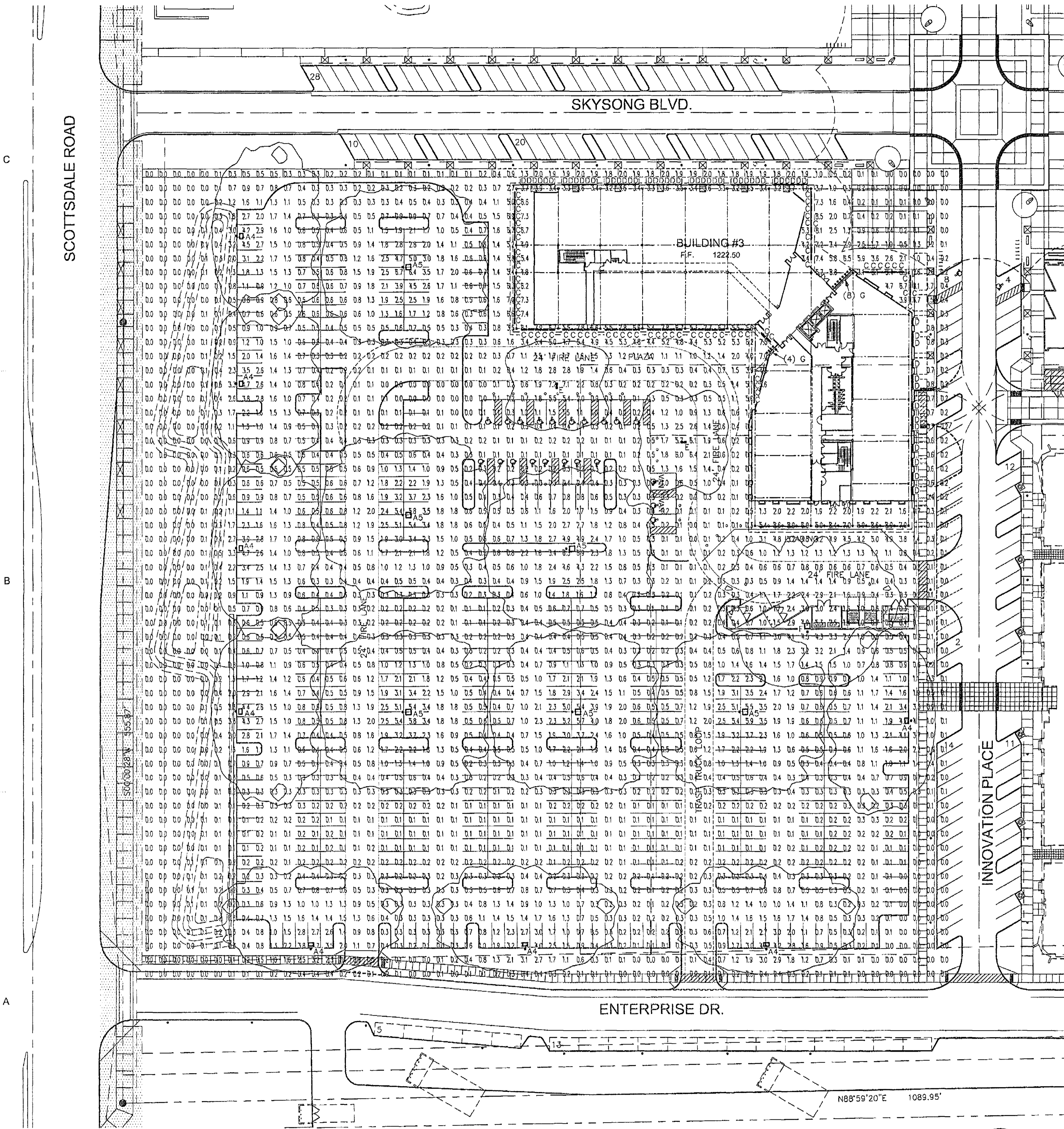

FILE: J:\2008\08104_SkySong\E100-1_200-2.dwg

PLOTTED BY: Note

PLOTTED: 05.06.2009 -- 7:15pm

1 2 3 4 5

1 2 3 4 5

SHEET NOTES

1. FOOT CANDLE VALUES WERE CALCULATED USING THE PHOTOMETRY CALCULATION PROGRAM VISUAL PROFESSIONAL EDITION V2.06.142.
2. CALCULATED VALUES INCLUDE DIRECT AND INTERREFLECTED COMPONENTS.
3. LUMINAIRE SELECTION BY RC LURIE. CONTACT DARRYL GREGG AT 602.799.0049 FOR ADDITIONAL REQUIREMENTS AND CLARIFICATIONS.

ARCHITTEKTON

464 S Farmer Ave., Suite 101
Tempe AZ, 85281
T 480.894.4637
F 480.894.4638
www.architekton.com



Owners/Developers

- ASAA Real Estate Company**
6830 Coonroad Blvd.
Suite 600
San Antonio, TX 78230-2239
- ASU Foundation**
Fulton Center
300 E. University Drive
P.O. Box 2280
Tempe, AZ 85280-2280
- HIGGINS Development Partners**
101 East Erie Street
Suite 300
Chicago, IL 60611
- The Plaza Companies**
9401 W Thunderbird Road
Suite 200
Peoria, AZ 85381

SkySong 3
North Scottsdale Road
Scottsdale, Arizona 85257

460-PA-2004

ENERGY SYSTEMS DESIGN
4747 N 22ND STREET
SUITE 300
PHOENIX AZ 85006
P: 602/957-8333
F: 602/954-6333
PROJECT # 08104.000
DESIGN CONTACT NATE ZACHRESON

Design Review Board Submittal
Date: 05/08/09
SITE LIGHTING PHOTOMETRY BEFORE CURFEW
E100

SYMBOL	LABEL	QTY	CATALOG NUMBER	DESCRIPTION	LAMP	FILE	LUMENS	LLF	WATTS
□	A4	12	LITHONIA AS2 250M SR4W HS TB SPA DM19AS SCWA 7 SSS 17.5' WITH 2.5' BASE	FULL CUT OFF AREA LIGHT	ONE 250-WATT PULSE START METAL HALIDE.	LTL12463.IES	23000	0.81	297
□	A5	20	LITHONIA AS2 250M SR5 TB SPA DM19AS SCWA SSS 17.5' WITH 2.5' BASE	FULL CUT OFF AREA LIGHT	ONE 250-WATT PULSE START METAL HALIDE.	LTL10252.IES	23000	0.81	297
	C	89	LITECONTROL R D 44 1 4 TB SGL CWM ELB	4' RECESSED DIRECT	ONE 25 WATT TB	R-D-4414TSHO-2400-SGL.IES		0.75	25
—	D	55	LITE360°SPL1-MTS-XR04-SG-35K-UVOLT-C160 H LAMP MODULE AND SPL1-HSS-XR04-D1-ALUM-SV HOUSING	SURFACE SIDE-MOUNT SINGLE LAMP FIXTURE EQUIPPED WITH 5 F28T8/835 FLUORESCENT. TECHNOLOGY FEATURING A SEPARATELY SEALED IP67 T5 FLUORESCENT LAMP AND BALLAST MODULE. SPECIFIABLE REFLECTOR CUT-OFF AND POSITIONING OFFERS 24 OPTICAL COMBINATIONS. AVAILABLE IN NOMINAL 2', 3', 4', AND 5' UNITS WITH KNOCK-OUTS AND PRE-WIRED CONNECTORS FOR CONTINUOUS ROW INSTALLATION.	ONE 28-WATT PHILIPS T-5 F28T8/835 FLUORESCENT.	46678-4.IES	2900	0.75	30.8
□	E	4	BEGA 825BMH TYPE III SLV	POLE MOUNTED LUMINAIRE W/DIFFUSE CORE MODULE W/SPECULAR SIDES CLEAR FLAT GLASS MOUNTED AT 15'	TWO 100 WATT METAL HALIDE	825MH TYPE 8800 III.IES		0.81	200
□	E1	1	BEGA 825BMH TYPE III SLV	POLE MOUNTED LUMINAIRE W/DIFFUSE CORE MODULE W/SPECULAR SIDES CLEAR FLAT GLASS MOUNTED AT 15'	(1) 100W ED-17 MH COATED	825BMH TYPE 8800 III.IES		0.75	100
○	G	12	DESIGNPLAN NN1 9 R2 B 10 0 0 T O	SPOT LIGHT MOUNTED AT 60'	ONE 70 WATT METAL HALIDE	NW1-9R2 (M952042).IES	6600	0.72	88
□	EX1	18	EXISTING POLE LIGHT	ONE 250 WATT METAL HALIDE	CC600_800 250W_MH.IES		20000	0.72	275
○	EX2	8	EXISTING POLE LIGHT	ONE 250 WATT METAL HALIDE	FH3-250MH.IES		21000	0.72	295
□	EX3	1	LITHONIA AS2 250M SR4W TB SPA DM19AS SCWA 7 SSS 17.5' WITH 2.5' BASE	FULL CUT OFF AREA LIGHT	ONE 250-WATT PULSE START METAL HALIDE.	LTL10415.IES	23000	0.81	297

DESCRIPTION	SYMBOL	AVG	MAX	MIN	MAX/MIN	AVG/MIN
SOUTH DOUBLE DOORS	+	1.0 FC	1.0 FC	1.0 FC	1.0:1	1.0:1
SITE	+	2.0 FC	9.4 FC	0.0 FC	N / A	N / A
WALL GRAZING	+	11.4 FC	97.5 FC	0.3 FC	325.0:1	38.0:1

SITE LIGHTING PHOTOMETRY BEFORE CURFEW
SCALE: 1" = 40'-0"

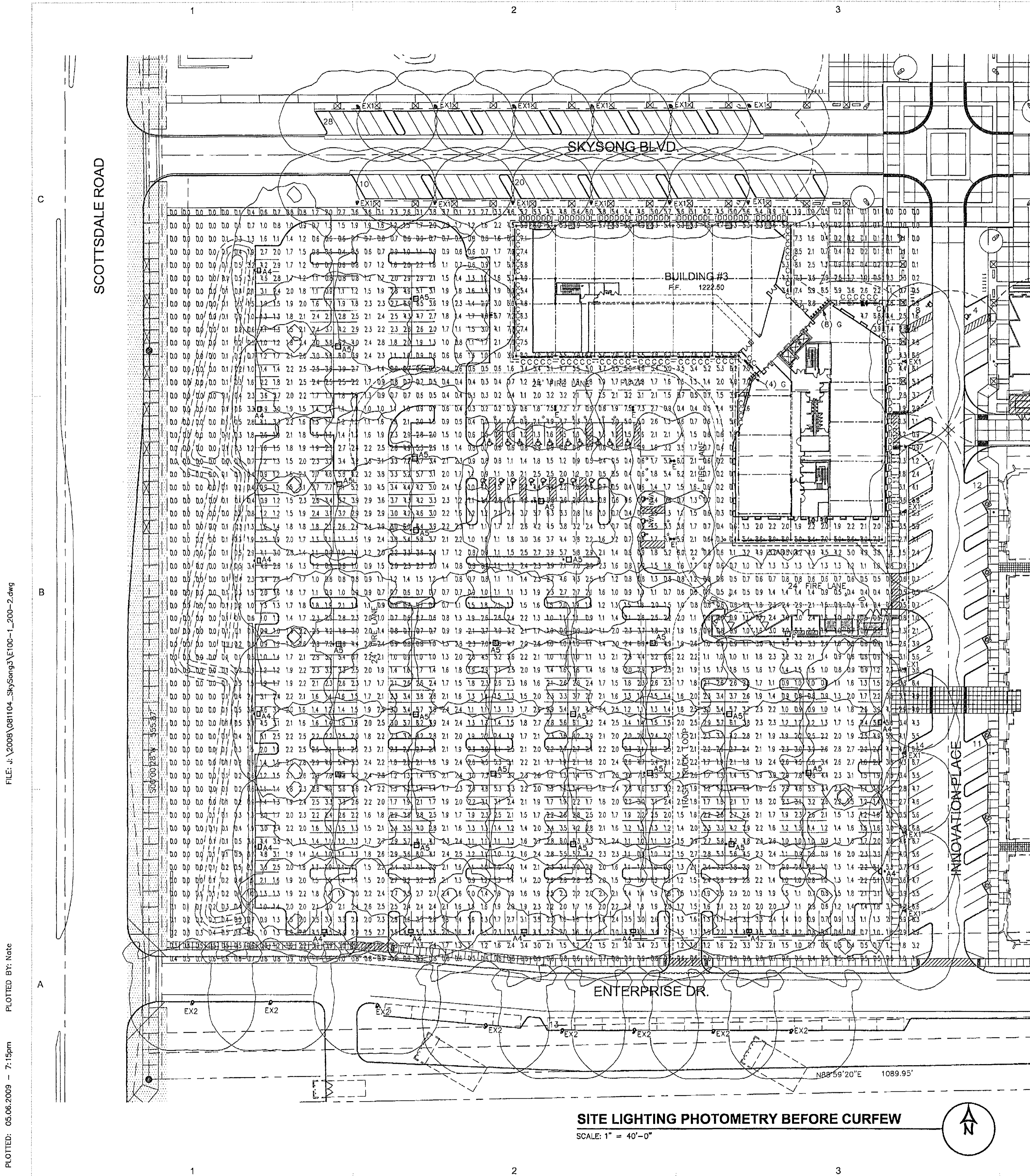
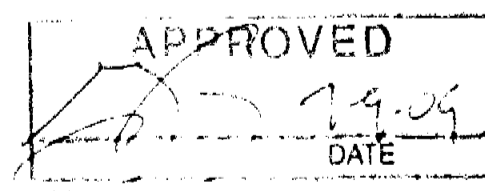

FILE: J:\2008\08104_SkySong3\ET00-1_200-2.dwg
PLOTTED BY: Nate
PLOTTED: 05.06.2009 - 7:15pm