

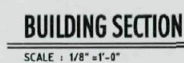

© 2009 H & S International LLC.  
THIS DOCUMENT IS THE PROPERTY OF  
H&S INTERNATIONAL LLC, AND CANNOT BE  
COPIED OR REPRODUCED WITHOUT WRITTEN  
AUTHORIZATION FROM THE PRINCIPAL OF  
H&S INTERNATIONAL.



APPROVED  
by DRB

5-6-10 HC

---

DATE INITIALS

**PRELIMINARY - NOT FOR CONSTRUCTION**

REVISION	03/16/10
DATE	12/23/09
ARCHITECT	
PROJECT MANAGER	STEVE HALL
PROJECT NUMBER	0910
SCALE	AS SHOWN
DRAWN BY	
CHECKED BY	
SHEET TITLE	

**ROOF PLAN  
SECTION**

**DR-6**

**THE SAUSA  
SCOTTSDALE, AZ**



# GENERAL LIGHTING NOTES:

1. All lighting fixture locations are conceptual, and electrical contractor shall provide opportunity for landscape architect to review and "test" and make adjustments to lamps and locations before finalizing work but after major planting has been completed. No light fixtures shall be over 8' in height.
2. Control of the lighting shall be with a photocell on and time clock off configuration.
3. Electrical contractor shall plan wiring layout based on the fixture layout to provide a wiring scheme that uses reasonable wiring routes and economical use of cable. Electrical contractor shall calculate voltage drop for all low voltage equipment and size cables properly. Wire size from remote transformers shall be determined by length of run and total load to prevent voltage drop.
4. All exterior transformers shall be weatherproof or mounted in a weather tight enclosure. All transformer locations to be mounted out of normal view from all landscape and interior areas. Locations to be approved by landscape architect.
5. Electrical contractor shall provide an as-built plan of the lighting showing the runs of wires, identification and location of all transformers, locations of all fixtures and the exact lamp installed in each fixture.
6. The lighting transformers shall also be hardwired into the main or subpanels. They shall have a dedicated 20 amp circuit. All leads shall be color coded in the ground and in the clock. The amps and wattages shall be calculated and documented for each run so the system remains balanced. The connectors at each light shall be King Connectors or equal for watertight/waterproof connections.
7. See irrigation plan for light sleeve locations.
8. All lights shall have frosted bulbs.
9. All boulders shall be softened using amber filters.
10. All saguaros, palo verdes, palms and unique green specimen plantings shall incorporate blue filters.
11. Provide 1-minute night time light view to review lighting on file as part of bid.
12. Provide record drawing as-built documentary:
  - a) quantity of lights
  - b) length of each run
  - c) amps, voltage and wattage
13. Provide and install frosted lens on all light fixtures. Also add filters to all halogen lights.
14. All exterior lighting should be low scale and directed downward, recessed or shielded so that the light source is not visible from viewpoints at the perimeter of the property.

LOT 19

LOT 21

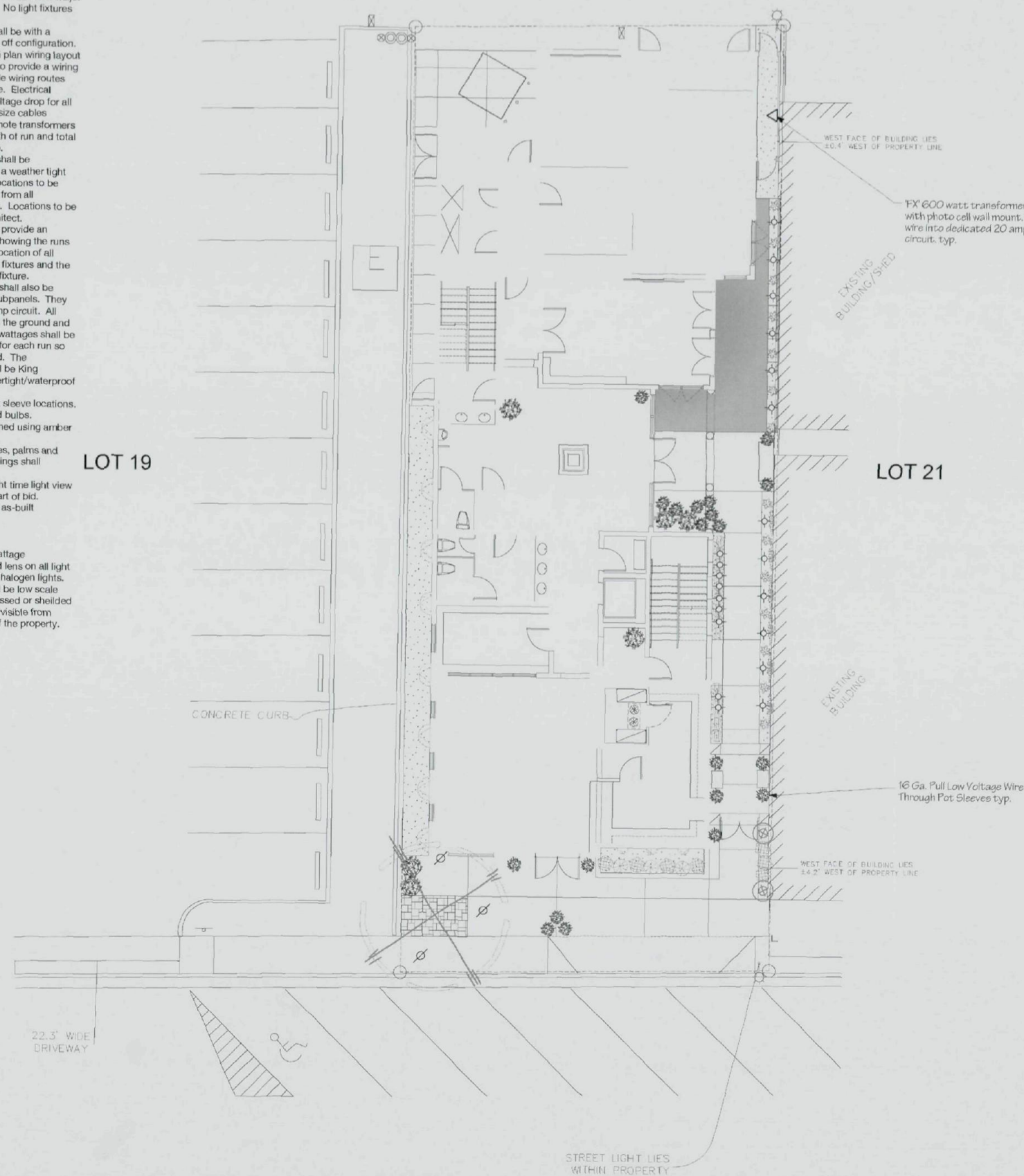

## Low-Voltage Lighting Schedule:

Symbol	Part No.	Description	Bulb Type	Wattages	Count
	FX LS-12-CU	Luna Sonora Downlight typ.	LO 1141	10	3
	FX MP-20-F-DG-HB-SS	Metallo Pesante Uplight typ.	Xenolux MR-11	20	18
	FX PX-600-TPC-SS	Wall mount transformer direct wire into dedicated 20 amp "High Magnetic" circuit.	N/A	600	1

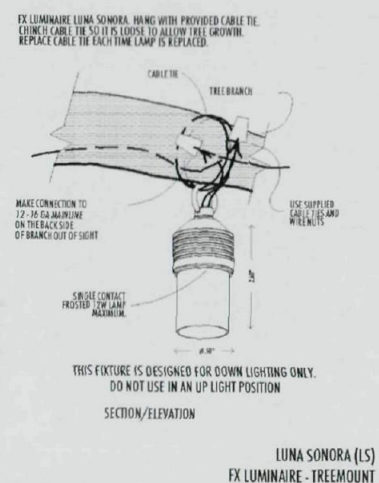
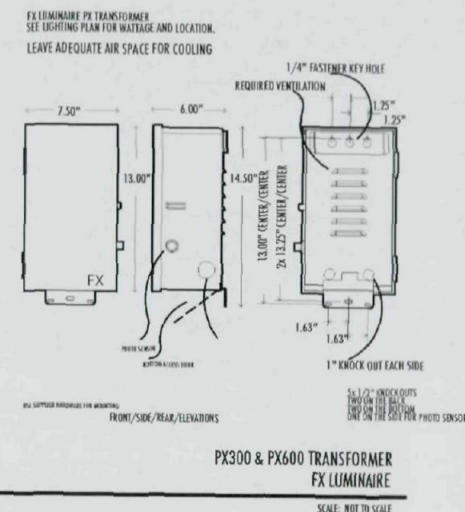

NOTE: All MP, 10% to be recessed and not visible from the perimeter of sight as shown below.

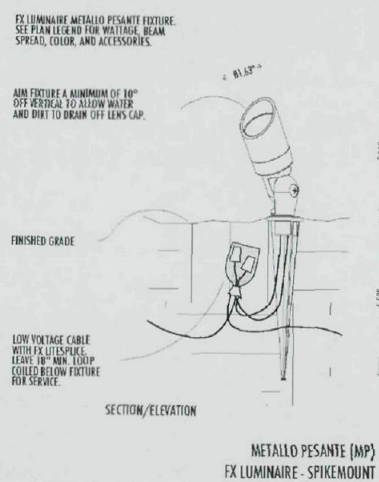

APPROVED

DATE INITIALS

4-DR-2010  
2nd: 3/23/10

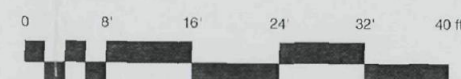
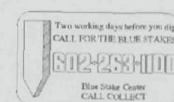

Lighting Plan  
Scale: 1/8" = 1'-0"



DATE 3-12-10

REVISION

This drawing is an instrument of service and the property of D.M. Winters Assoc., LLC. This drawing may not be reproduced or reproductions hereof used without their written permission.

**B.K. Sarsa**  
Lot 20, WEST SCOTSDALE  
7140 East 1st Avenue  
Scottsdale, Arizona, 85251

Donna M. Winters & Associates, LLC  
Landscape Architect and Planning  
10099 N. 10th St., Suite 81  
Scottsdale, AZ 85258-2608

L.5