

minibar.ber.shop

SCOTTSDALE QUARTER

Scottsdale, Arizona

Project Data:

PROJECT ADDRESS:

SCOTTSDALE QUARTER
15279 NORTH SCOTTSDALE ROAD BLDG. J, SUITE J1-170
SCOTTSDALE, ARIZONA 85254

LANDLORD

Glimcher Properties Limited Partnership
Contact: Margo D. Conley Development Project Manager
180 East Broad Street
Columbus, Ohio 43215
V: 614.887.5691 C: 614.205.5224 F: 614.621.9331
E: mconley@glimcher.com

TENANT

minibar.ber.shop
MUSIKANTOW AND ASSOCIATED LLC
7349 N. VIA PASO DEL SUR, SUITE 515
SCOTTSDALE, AZ 85258
V (480) 773-1030 F (480) 624-3339
CONTACT: EVAN MUSIKANTOW
E: evan@musikantowassoc.com

minibar Areas:

SEATING AREA:	617 SF
BACK BAR AREA:	186 SF
FOOD DISPLAY/STORAGE AREA:	48 SF
TOILETS/CORR/STOR:	302 SF

TOTAL GROSS BAR LEASED AREA:	1,153 SF

Parking Requirements

THIS TENANT

- Total Floor Area = 1,153 SF
- Code Parking Rate = 1 / 300 SF
- Parking Required = 04 SPACES
- Parking Provided = 04 SPACES

OVERALL PROJECT

- Parking Required = 2,981 Spaces
- Parking Provided = 3,200 Spaces

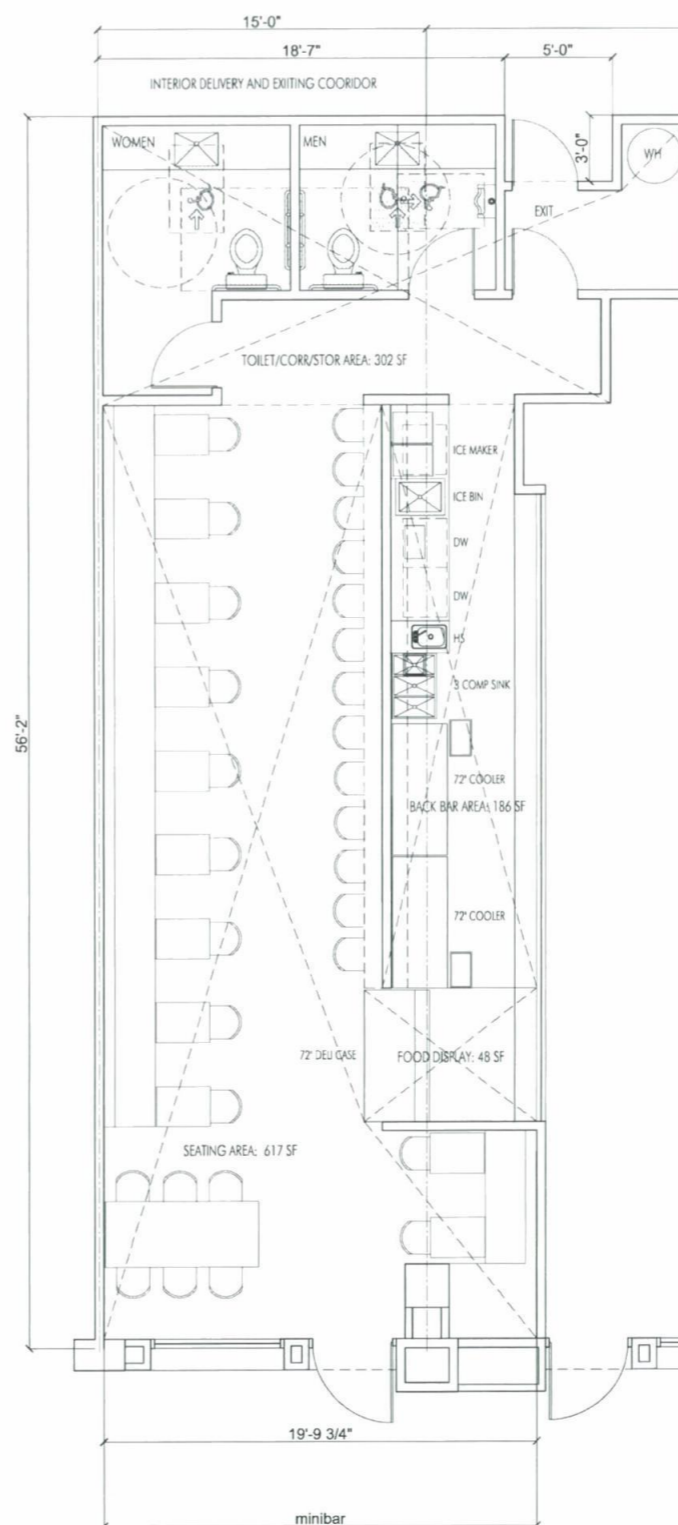

36-UP-2010
1st: 11/8/2010

IMPROVEMENT PLAN



EXPIRES 06.30.2011
THESE DRAWINGS AND SPECIFICATIONS ARE THE PROPERTY OF THE ARCHITECT. TO BE USED AS INSTRUMENTS OF SERVICE AND SHALL NOT BE USED FOR CONSTRUCTION WITHOUT THE EXPRESSED WRITTEN CONSENT OF THE ARCHITECT
© COPYRIGHT 2010
JOHN E. CHONKA, NCARB

John E. Chonka Architect 378 East Verde Lane Phoenix, Arizona 85012
V: 602.256.2345 E: office@johnchonka.com



DATE: 11.05.2010

PHASE:
USE PERMIT
SUBMITTAL
DELTA:

minibar.ber.shop SCOTTSDALE QUARTER
SCOTTSDALE, ARIZONA
JCP PROJECT NUMBER: 1009

EXHIBIT "A"

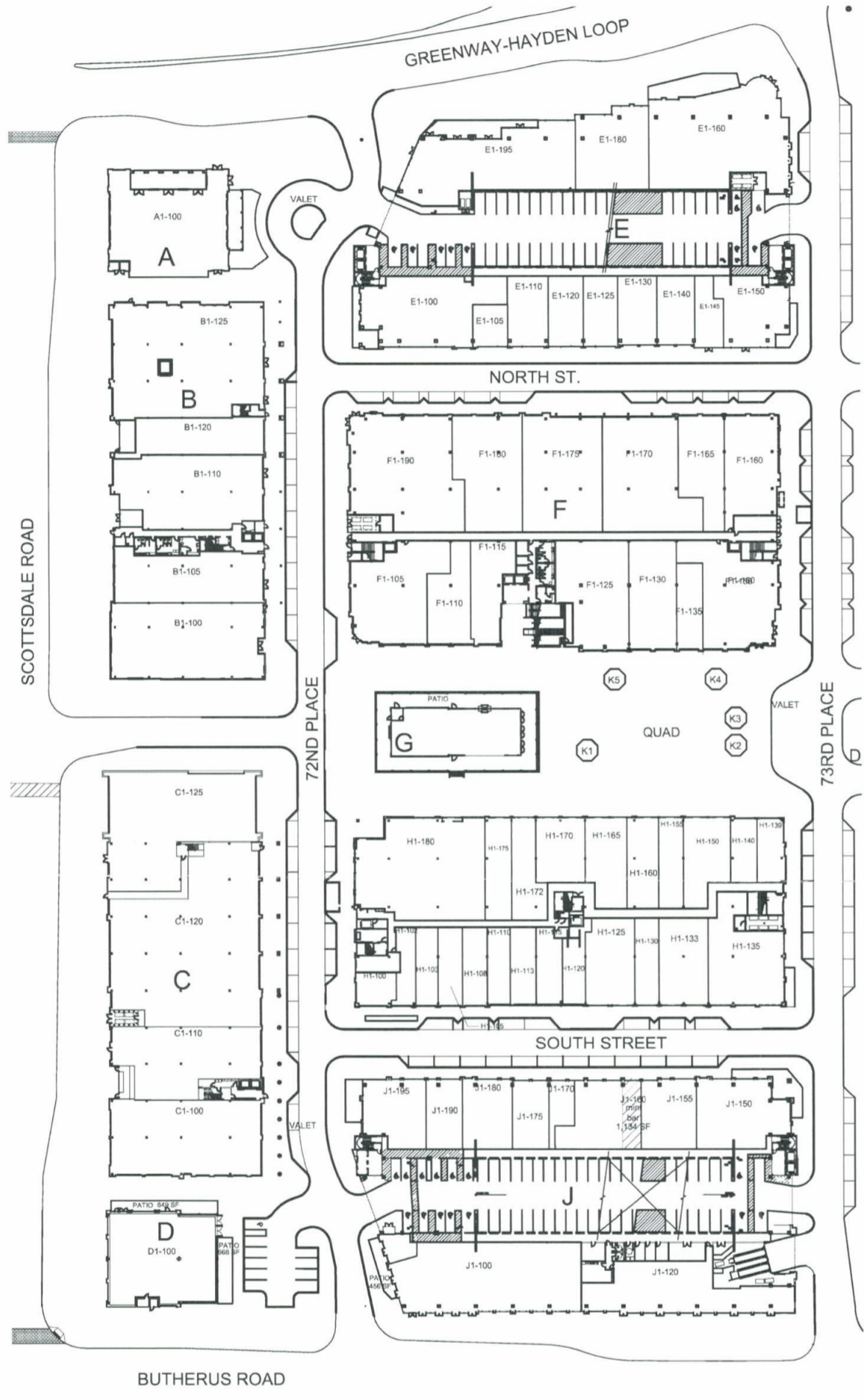

NORTH

BUTHERUS ROAD

PROPOSED BAR USE AREA FOR mini bar

01 GROUND LEVEL LEASE PLAN

Scale: NTS

REF:

GLIMCHER

GLIMCHER PROPERTIES LIMITED PARTNERSHIP
 180 East Broad Street, 21st Floor
 Columbus, OH 43215
 Phone: 614.621.9000 Fax: 614.621.9321

SCOTTSDALE QUARTER
 SITE PLAN TO SUPPORT
 MINI BAR
 BAR USE PERMIT APPLICATION
 SCOTTSDALE, ARIZONA

DATE: 11.04.10

36-UP-2010
1st: 11/8/2010

minibar.ber.shop

SCOTTSDALE QUARTER

Scottsdale, Arizona

Project Data:

PROJECT ADDRESS:

SCOTTSDALE QUARTER
15279 NORTH SCOTTSDALE ROAD BLDG. J SUITE J1-170
SCOTTSDALE, ARIZONA 85254

LANDLORD

Glimcher Properties Limited Partnership
Contact: Margo D. Conley Development Project Manager
180 East Broad Street
Columbus, Ohio 43215
V: 614.887.5691 C: 614.205.5224 F: 614.621.9331
E: mconley@glimcher.com

TENANT

minibar.ber.shop
MUSIKANTOW AND ASSOCIATED LLC
7349 N. VIA PASEO DEL SUR, SUITE 515
SCOTTSDALE, AZ 85258
V (480) 773-1030 F (480) 624-3339
CONTACT: EVAN MUSIKANTOW
E: evan@musikantowassoc.com

minibar Areas:

SEATING AREA:	617 SF
BACK BAR AREA:	186 SF
FOOD DISPLAY/STORAGE AREA:	48 SF
TOILETS/CORR/STOR:	302 SF

TOTAL GROSS BAR LEASED AREA:	1,153 SF

Parking Requirements

THIS TENANT

- Total Floor Area = 1,153 SF
- Code Parking Rate = 1 / 300 SF
- Parking Required = 04 SPACES
- Parking Provided = 04 SPACES

OVERALL PROJECT

- Parking Required = 2,981 Spaces
- Parking Provided = 3,200 Spaces

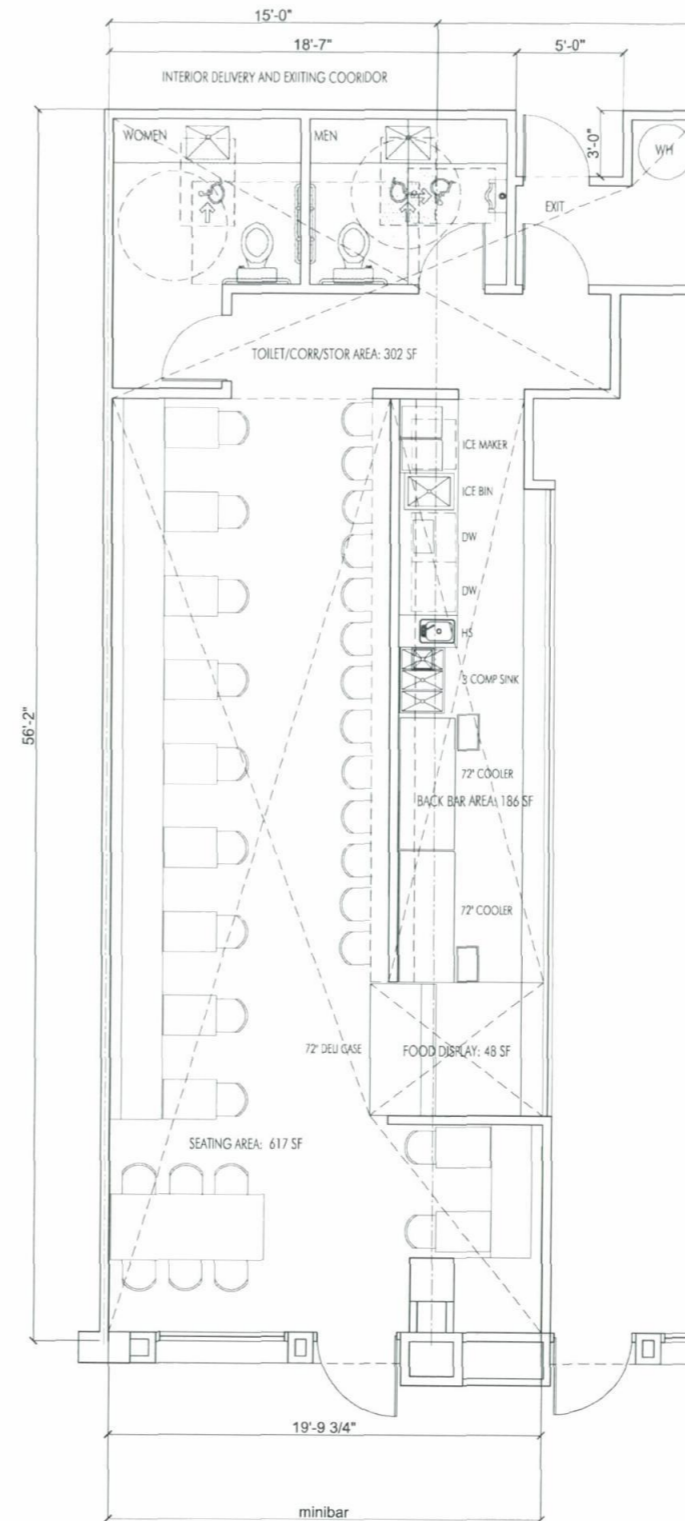

36-UP-2010
1st: 11/8/2010

IMPROVEMENT PLAN



THESE DRAWINGS AND SPECIFICATIONS ARE THE PROPERTY OF THE ARCHITECT, TO BE USED AS INSTRUMENTS OF SERVICE AND SHALL NOT BE USED FOR CONSTRUCTION WITHOUT THE EXPRESSED WRITTEN CONSENT OF THE ARCHITECT.

© COPYRIGHT 2010 JOHN E. CHONKA, NCARB

John E. Chonka Architect 378 East Verde Lane Phoenix, Arizona 85012
V: 602.256.2345 E: office@johnchonka.com



DATE: 11.05.2010

PHASE:
USE PERMIT
SUBMITTAL
DELTA:

minibar.ber.shop SCOTTSDALE QUARTER
SCOTTSDALE, ARIZONA
JCP PROJECT NUMBER: 1009

EXHIBIT "A"