

City Notifications – Mailing List Selection Map

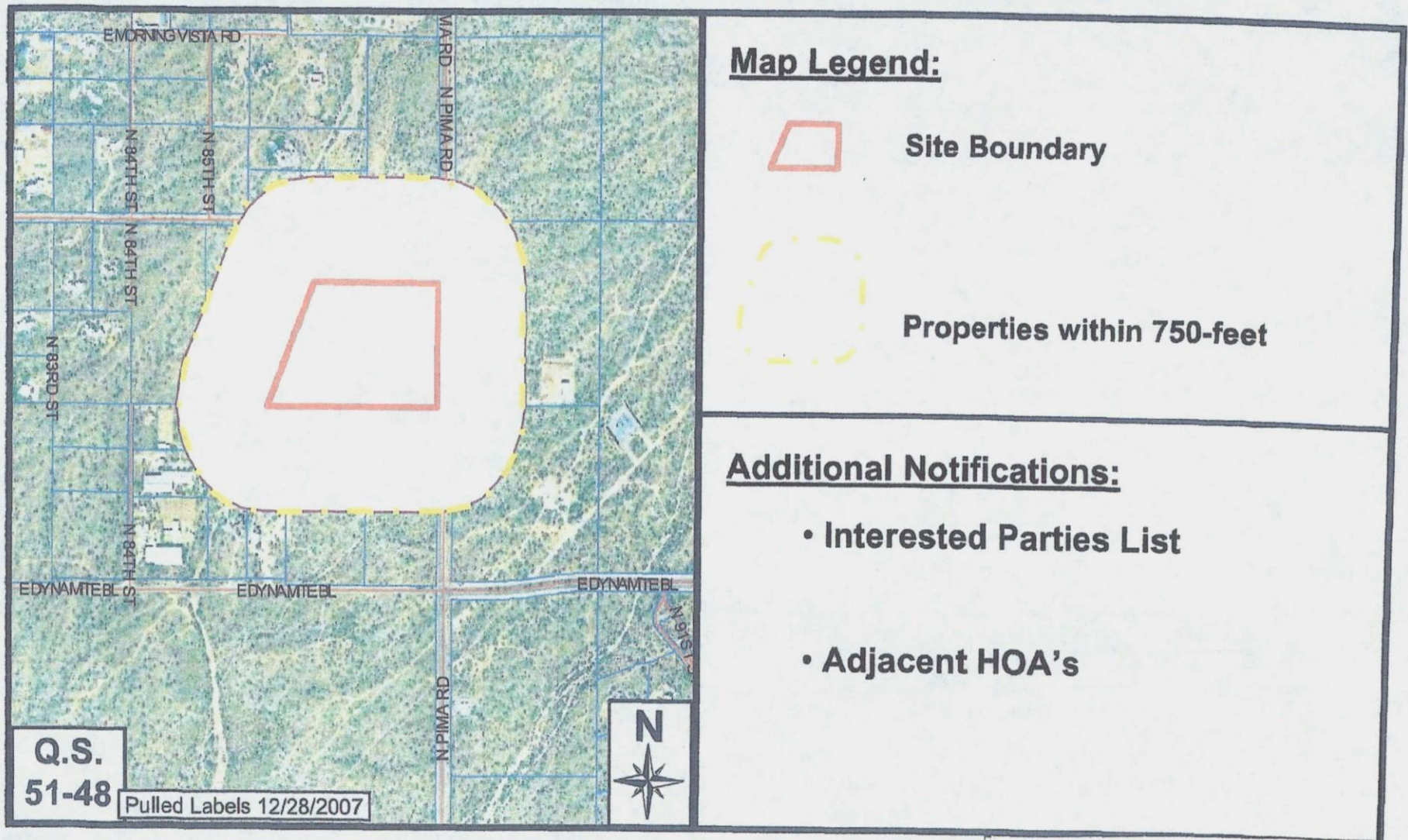

Map Legend:



Site Boundary



Properties within 750-feet

Additional Notifications:

- Interested Parties List
- Adjacent HOA's

Scottsdale First Assembly School

31-UP-2007#2
1st: 5/17/11

SCOTTSDALE FIRST ASSEMBLY
D R E A M C E N T E R

Neighbors

May 13th, 2011

Carol Albas or Resident
7060 E. Stagecoach Pass
Carefree, AZ 85377

Subject: Meeting Notification - Parcel #216-70-007-C
Modification - Current Conditional Use Permit
Scottsdale First Assembly
28700 N. Pima Road

Scottsdale First Assembly Dream Center is permitted to operate a charter school (K thru 12 grades) having a maximum school attendance of 250 enrollments. However, we are currently only operating the grades of K thru 8th.

Scottsdale First Assembly is applying to modify the current "Conditional Use Permit" to allow "Temporary Structures" (trailers) installed on the property. These additional facilities will be used to allow continued educational efforts with class rooms for grades above eight (8th grade). The maximum enrollment level (250 students) will not be changed.

This neighborhood notification letter is advising that an "Open House" meeting will be held on June 7th, 2011, from 5 PM to 7 PM at Scottsdale First Assembly lobby, located 28700 N. Pima Road, Scottsdale, AZ 85266.

The Open House meeting will be documented, providing the City of Scottsdale Planning & Development Services Department with the list of attendees; all comments and a written summary of comments, issues and concerns.

Looking forward to seeing you June 7th, - 5 PM to 7 PM

God Bless

Victor W. Grotlisch
Project Director

31-UP-2007#2
1st: 5/17/11

SCOTTSDALE FIRST ASSEMBLY
D R E A M C E N T E R

May 13th, 2011

Mastro Trust or Resident

8560 E. Via Donna Rd
Scottsdale, AZ 85262

**Subject: Meeting Notification -Parcel #216-70-006-B
Modification - Current Conditional Use Permit
Scottsdale First Assembly
28700 N. Pima Road**

Scottsdale First Assembly Dream Center is permitted to operate a charter school (K thru 12 grades) having a maximum school attendance of 250 enrollments. However, we are currently only operating the grades of K thru 8th.

Scottsdale First Assembly is applying to modify the current "Conditional Use Permit" to allow "Temporary Structures" (trailers) installed on the property. These additional facilities will be used to allow continued educational efforts with class rooms for grades above eight (8th grade). The maximum enrollment level (250students) will not be changed.

This neighborhood notification letter is advising that an "Open House" meeting will be held on June 7th, 2011, from 5 PM to 7 PM at Scottsdale First Assembly lobby, located 28700 N. Pima Road, Scottsdale, AZ 85266.

The Open House meeting will be documented, providing the City of Scottsdale Planning & Development Services Department with the list of attendees; all comments and a written summary of comments, issues and concerns.

Looking forward to seeing you June 7th, - 5 PM to 7 PM

God Bless

Victor W. Grotlisch
Project Director

31-UP-2007#2
1st: 5/17/11

SCOTTSDALE FIRST ASSEMBLY
D R E A M C E N T E R

May 13th, 2011

Bethann & Mark Lyons or Resident
10686 Laurel Ln.
Scottsdale, AZ 85259

Subject: Meeting Notification -Parcel #216-70-006-A
Modification - Current Conditional Use Permit
Scottsdale First Assembly
28700 N. Pima Road

Scottsdale First Assembly Dream Center is permitted to operate a charter school (K thru 12 grades) having a maximum school attendance of 250 enrollments. However, we are currently only operating the grades of K thru 8th.

Scottsdale First Assembly is applying to modify the current "Conditional Use Permit" to allow "Temporary Structures" (trailers) installed on the property. These additional facilities will be used to allow continued educational efforts with class rooms for grades above eight (8th grade). The maximum enrollment level (250students) will not be changed.

This neighborhood notification letter is advising that an "Open House" meeting will be held on June 7th, 2011, from 5 PM to 7 PM at Scottsdale First Assembly lobby, located 28700 N. Pima Road, Scottsdale, AZ 85266.

The Open House meeting will be documented, providing the City of Scottsdale Planning & Development Services Department with the list of attendees; all comments and a written summary of comments, issues and concerns.

Looking forward to seeing you June 7th, - 5 PM to 7 PM

God Bless

Victor W. Grotlisch
Project Director

31-UP-2007#2
1st: 5/17/11

SCOTTSDALE FIRST ASSEMBLY
D R E A M C E N T E R

May 13th, 2011

Jill Aguirre or Resident
8605 E. Via Dona Rd
Scottsdale, AZ 85266

Subject: Meeting Notification - Parcel #216-70-006-E
Modification - Current Conditional Use Permit
Scottsdale First Assembly
28700 N. Pima Road

Scottsdale First Assembly Dream Center is permitted to operate a charter school (K thru 12 grades) having a maximum school attendance of 250 enrollments. However, we are currently only operating the grades of K thru 8th.

Scottsdale First Assembly is applying to modify the current "Conditional Use Permit" to allow "Temporary Structures" (trailers) installed on the property. These additional facilities will be used to allow continued educational efforts with class rooms for grades above eight (8th grade). The maximum enrollment level (250 students) will not be changed.

This neighborhood notification letter is advising that an "Open House" meeting will be held on June 7th, 2011, from 5 PM to 7 PM at Scottsdale First Assembly lobby, located 28700 N. Pima Road, Scottsdale, AZ 85266.

The Open House meeting will be documented, providing the City of Scottsdale Planning & Development Services Department with the list of attendees; all comments and a written summary of comments, issues and concerns.

Looking forward to seeing you June 7th, - 5 PM to 7 PM

God Bless

Victor W. Grotlisch
Project Director

31-UP-2007#2
1st: 5/17/11

SCOTTSDALE FIRST ASSEMBLY
D R E A M C E N T E R

May 13th, 2011

Chalpin Family Enterprise or Resident
7428 E. Karen Dr.
Scottsdale, AZ 85260

Subject: Meeting Notification -Parcel #216-70-006-F
Modification - Current Conditional Use Permit
Scottsdale First Assembly
28700 N. Pima Road

Scottsdale First Assembly Dream Center is permitted to operate a charter school (K thru 12 grades) having a maximum school attendance of 250 enrollments. However, we are currently only operating the grades of K thru 8th.

Scottsdale First Assembly is applying to modify the current "Conditional Use Permit" to allow "Temporary Structures" (trailers) installed on the property. These additional facilities will be used to allow continued educational efforts with class rooms for grades above eight (8th grade). The maximum enrollment level (250students) will not be changed.

This neighborhood notification letter is advising that an "Open House" meeting will be held on June 7th, 2011, from 5 PM to 7 PM at Scottsdale First Assembly lobby, located 28700 N. Pima Road, Scottsdale, AZ 85266.

The Open House meeting will be documented, providing the City of Scottsdale Planning & Development Services Department with the list of attendees; all comments and a written summary of comments, issues and concerns.

Looking forward to seeing you June 7th, - 5 PM to 7 PM

God Bless

Victor W. Grotlisch
Project Director

31-UP-2007#2
1st: 5/17/11

SCOTTSDALE FIRST ASSEMBLY
D R E A M C E N T E R

May 13th, 2011

Chalpin Family Enterprise or Resident
8401 E. Via Dona Rd
Scottsdale, AZ 85266

Subject: Meeting Notification - Parcel #216-70-006-F
Modification - Current Conditional Use Permit
Scottsdale First Assembly
28700 N. Pima Road

Scottsdale First Assembly Dream Center is permitted to operate a charter school (K thru 12 grades) having a maximum school attendance of 250 enrollments. However, we are currently only operating the grades of K thru 8th.

Scottsdale First Assembly is applying to modify the current "Conditional Use Permit" to allow "Temporary Structures" (trailers) installed on the property. These additional facilities will be used to allow continued educational efforts with class rooms for grades above eight (8th grade). The maximum enrollment level (250 students) will not be changed.

This neighborhood notification letter is advising that an "Open House" meeting will be held on June 7th, 2011, from 5 PM to 7 PM at Scottsdale First Assembly lobby, located 28700 N. Pima Road, Scottsdale, AZ 85266.

The Open House meeting will be documented, providing the City of Scottsdale Planning & Development Services Department with the list of attendees; all comments and a written summary of comments, issues and concerns.

Looking forward to seeing you June 7th, - 5 PM to 7 PM

God Bless

Victor W. Grotlisch
Project Director

31-UP-2007#2
1st: 5/17/11

SCOTTSDALE FIRST ASSEMBLY
D R E A M C E N T E R

May 13th, 2011

Sandra Witter / John Lockton
8510 E. Dynamite Blvd
Scottsdale, AZ 85266

**Subject: Meeting Notification - Parcel #216-70-006-N
Modification - Current Conditional Use Permit
Scottsdale First Assembly
28700 N. Pima Road**

Scottsdale First Assembly Dream Center is permitted to operate a charter school (K thru 12 grades) having a maximum school attendance of 250 enrollments. However, we are currently only operating the grades of K thru 8th.

Scottsdale First Assembly is applying to modify the current "Conditional Use Permit" to allow "Temporary Structures" (trailers) installed on the property. These additional facilities will be used to allow continued educational efforts with class rooms for grades above eight (8th grade). The maximum enrollment level (250students) will not be changed.

This neighborhood notification letter is advising that an "Open House" meeting will be held on June 7th, 2011, from 5 PM to 7 PM at Scottsdale First Assembly lobby, located 28700 N. Pima Road, Scottsdale, AZ 85266.

The Open House meeting will be documented, providing the City of Scottsdale Planning & Development Services Department with the list of attendees; all comments and a written summary of comments, issues and concerns.

Looking forward to seeing you June 7th, - 5 PM to 7 PM

God Bless

Victor W. Grotlisch
Project Director

31-UP-2007#2
1st: 5/17/11

SCOTTSDALE FIRST ASSEMBLY
D R E A M C E N T E R

May 13th, 2011

Ruth & Gerald Mitchell or Resident
28555 N. 84th St.
Scottsdale, AZ 85266

Subject: Meeting Notification –Parcel #216-70-006-S
Modification – Current Conditional Use Permit
Scottsdale First Assembly
28700 N. Pima Road

Scottsdale First Assembly Dream Center is permitted to operate a charter school (K thru 12 grades) having a maximum school attendance of 250 enrollments. However, we are currently only operating the grades of K thru 8th.

Scottsdale First Assembly is applying to modify the current "Conditional Use Permit" to allow "Temporary Structures" (trailers) installed on the property. These additional facilities will be used to allow continued educational efforts with class rooms for grades above eight (8th grade). The maximum enrollment level (250students) will not be changed.

This neighborhood notification letter is advising that an "Open House" meeting will be held on June 7th, 2011, from 5 PM to 7 PM at Scottsdale First Assembly lobby, located 28700 N. Pima Road, Scottsdale, AZ 85266.

The Open House meeting will be documented, providing the City of Scottsdale Planning & Development Services Department with the list of attendees; all comments and a written summary of comments, issues and concerns.

Looking forward to seeing you June 7th, - 5 PM to 7 PM

God Bless

Victor W. Grotlisch
Project Director

SCOTTSDALE FIRST ASSEMBLY

D R E A M C E N T E R

May 13th, 2011

Andrew Eldrige or Resident

28345 N. 84th St.

Scottsdale, AZ 85266

**Subject: Meeting Notification -Parcel #216-70-006-T
Modification - Current Conditional Use Permit
Scottsdale First Assembly
28700 N. Pima Road**

Scottsdale First Assembly Dream Center is permitted to operate a charter school (K thru 12 grades) having a maximum school attendance of 250 enrollments. However, we are currently only operating the grades of K thru 8th.

Scottsdale First Assembly is applying to modify the current "Conditional Use Permit" to allow "Temporary Structures" (trailers) installed on the property. These additional facilities will be used to allow continued educational efforts with class rooms for grades above eight (8th grade). The maximum enrollment level (250students) will not be changed.

This neighborhood notification letter is advising that an "Open House" meeting will be held on June 7th, 2011, from 5 PM to 7 PM at Scottsdale First Assembly lobby, located 28700 N. Pima Road, Scottsdale, AZ 85266.

The Open House meeting will be documented, providing the City of Scottsdale Planning & Development Services Department with the list of attendees; all comments and a written summary of comments, issues and concerns.

Looking forward to seeing you June 7th, - 5 PM to 7 PM

God Bless

Victor W. Grotlisch
Project Director

SCOTTSDALE FIRST ASSEMBLY
D R E A M C E N T E R

May 13th, 2011

Andrew Eldrige or Resident
15111 N. Hayden Rd. #160-546
Scottsdale, AZ 85260

**Subject: Meeting Notification –Parcel #216-70-006-T
Modification – Current Conditional Use Permit
Scottsdale First Assembly
28700 N. Pima Road**

Scottsdale First Assembly Dream Center is permitted to operate a charter school (K thru 12 grades) having a maximum school attendance of 250 enrollments. However, we are currently only operating the grades of K thru 8th.

Scottsdale First Assembly is applying to modify the current "Conditional Use Permit" to allow "Temporary Structures" (trailers) installed on the property. These additional facilities will be used to allow continued educational efforts with class rooms for grades above eight (8th grade). The maximum enrollment level (250students) will not be changed.

This neighborhood notification letter is advising that an "Open House" meeting will be held on June 7th, 2011, from 5 PM to 7 PM at Scottsdale First Assembly lobby, located 28700 N. Pima Road, Scottsdale, AZ 85266.

The Open House meeting will be documented, providing the City of Scottsdale Planning & Development Services Department with the list of attendees; all comments and a written summary of comments, issues and concerns.

Looking forward to seeing you June 7th, - 5 PM to 7 PM

God Bless

Victor W. Grotlisch
Project Director

SCOTTSDALE FIRST ASSEMBLY
D R E A M C E N T E R

May 13th, 2011

Sandra Witter / John Lockton
8510 E. Dynamite Blvd
Scottsdale, AZ 85266

Subject: Meeting Notification -Parcel #216-70-006-X
Modification - Current Conditional Use Permit
Scottsdale First Assembly
28700 N. Pima Road

Scottsdale First Assembly Dream Center is permitted to operate a charter school (K thru 12 grades) having a maximum school attendance of 250 enrollments. However, we are currently only operating the grades of K thru 8th.

Scottsdale First Assembly is applying to modify the current "Conditional Use Permit" to allow "Temporary Structures" (trailers) installed on the property. These additional facilities will be used to allow continued educational efforts with class rooms for grades above eight (8th grade). The maximum enrollment level (250students) will not be changed.

This neighborhood notification letter is advising that an "Open House" meeting will be held on June 7th, 2011, from 5 PM to 7 PM at Scottsdale First Assembly lobby, located 28700 N. Pima Road, Scottsdale, AZ 85266.

The Open House meeting will be documented, providing the City of Scottsdale Planning & Development Services Department with the list of attendees; all comments and a written summary of comments, issues and concerns.

Looking forward to seeing you June 7th, - 5 PM to 7 PM

God Bless

Victor W. Grotlisch
Project Director

SCOTTSDALE FIRST ASSEMBLY
D R E A M C E N T E R

May 13th, 2011

Fellowship North
28248 N. Tatum Blvd, Ste B-1 (509)
Cave Creek, AZ 85331

**Subject: Meeting Notification –Parcel #216-70-006-Y
Modification – Current Conditional Use Permit
Scottsdale First Assembly
28700 N. Pima Road**

Scottsdale First Assembly Dream Center is permitted to operate a charter school (K thru 12 grades) having a maximum school attendance of 250 enrollments. However, we are currently only operating the grades of K thru 8th.

Scottsdale First Assembly is applying to modify the current "Conditional Use Permit" to allow "Temporary Structures" (trailers) installed on the property. These additional facilities will be used to allow continued educational efforts with class rooms for grades above eight (8th grade). The maximum enrollment level (250students) will not be changed.

This neighborhood notification letter is advising that an "Open House" meeting will be held on June 7th, 2011, from 5 PM to 7 PM at Scottsdale First Assembly lobby, located 28700 N. Pima Road, Scottsdale, AZ 85266.

The Open House meeting will be documented, providing the City of Scottsdale Planning & Development Services Department with the list of attendees; all comments and a written summary of comments, issues and concerns.

Looking forward to seeing you June 7th, - 5 PM to 7 PM

God Bless

Victor W. Grotlisch
Project Director

SCOTTSDALE FIRST ASSEMBLY
D R E A M C E N T E R

May 13th, 2011

Fellowship North or Resident
8584 Dynamite Blvd
Scottsdale, AZ 85266

**Subject: Meeting Notification –Parcel #216-70-006-Y
Modification – Current Conditional Use Permit
Scottsdale First Assembly
28700 N. Pima Road**

Scottsdale First Assembly Dream Center is permitted to operate a charter school (K thru 12 grades) having a maximum school attendance of 250 enrollments. However, we are currently only operating the grades of K thru 8th.

Scottsdale First Assembly is applying to modify the current "Conditional Use Permit" to allow "Temporary Structures" (trailers) installed on the property. These additional facilities will be used to allow continued educational efforts with class rooms for grades above eight (8th grade). The maximum enrollment level (250students) will not be changed.

This neighborhood notification letter is advising that an "Open House" meeting will be held on June 7th, 2011, from 5 PM to 7 PM at Scottsdale First Assembly lobby, located 28700 N. Pima Road, Scottsdale, AZ 85266.

The Open House meeting will be documented, providing the City of Scottsdale Planning & Development Services Department with the list of attendees; all comments and a written summary of comments, issues and concerns.

Looking forward to seeing you June 7th, - 5 PM to 7 PM

God Bless

Victor W. Grotlisch
Project Director

SCOTTSDALE FIRST ASSEMBLY
D R E A M C E N T E R

May 13th, 2011

Episcopal Diocese of Arizona
114 W. Roosevelt St.
Phoenix, AZ 85003

Subject: Meeting Notification - Parcel #216-70-006-L
Modification - Current Conditional Use Permit
Scottsdale First Assembly
28700 N. Pima Road

Scottsdale First Assembly Dream Center is permitted to operate a charter school (K thru 12 grades) having a maximum school attendance of 250 enrollments. However, we are currently only operating the grades of K thru 8th.

Scottsdale First Assembly is applying to modify the current "Conditional Use Permit" to allow "Temporary Structures" (trailers) installed on the property. These additional facilities will be used to allow continued educational efforts with class rooms for grades above eight (8th grade). The maximum enrollment level (250students) will not be changed.

This neighborhood notification letter is advising that an "Open House" meeting will be held on June 7th, 2011, from 5 PM to 7 PM at Scottsdale First Assembly lobby, located 28700 N. Pima Road, Scottsdale, AZ 85266.

The Open House meeting will be documented, providing the City of Scottsdale Planning & Development Services Department with the list of attendees; all comments and a written summary of comments, issues and concerns.

Looking forward to seeing you June 7th, - 5 PM to 7 PM

God Bless

Victor W. Grotlisch
Project Director

SCOTTSDALE FIRST ASSEMBLY
D R E A M C E N T E R

May 13th, 2011

Scottsdale & Dynamite Properties or Current Resident
8711 E. Pinnacle Peak Road
Scottsdale, AZ 85266

Subject: Meeting Notification – Parcel-216-70-006-M
Modification – Current Conditional Use Permit
Scottsdale First Assembly
28700 N. Pima Road

Scottsdale First Assembly Dream Center is permitted to operate a charter school (K thru 12 grades) having a maximum school attendance of 250 enrollments. However, we are currently only operating the grades of K thru 8th.

Scottsdale First Assembly is applying to modify the current “Conditional Use Permit” to allow “Temporary Structures” (trailers) installed on the property. These additional facilities will be used to allow continued educational efforts with class rooms for grades above eight (8th grade). The maximum enrollment level (250students) will not be changed.

This neighborhood notification letter is advising that an “Open House” meeting will be held on June 7th, 2011, from 5 PM to 7 PM at Scottsdale First Assembly lobby, located 28700 N. Pima Road, Scottsdale, AZ 85266.

The Open House meeting will be documented, providing the City of Scottsdale Planning & Development Services Department with the list of attendees; all comments and a written summary of comments, issues and concerns.

Looking forward to seeing you June 7th, - 5 PM to 7 PM

God Bless

Victor W. Grotlisch
Project Director

SCOTTSDALE FIRST ASSEMBLY
D R E A M C E N T E R

May 13th, 2011

Scottsdale & Dynamite Properties or Current Resident
12024 N. 61st Street
Scottsdale, AZ 85254

Subject: Meeting Notification – Parcel-216-70-006-M
Modification – Current Conditional Use Permit
Scottsdale First Assembly
28700 N. Pima Road

Scottsdale First Assembly Dream Center is permitted to operate a charter school (K thru 12 grades) having a maximum school attendance of 250 enrollments. However, we are currently only operating the grades of K thru 8th.

Scottsdale First Assembly is applying to modify the current "Conditional Use Permit" to allow "Temporary Structures" (trailers) installed on the property. These additional facilities will be used to allow continued educational efforts with class rooms for grades above eight (8th grade). The maximum enrollment level (250students) will not be changed.

This neighborhood notification letter is advising that an "Open House" meeting will be held on June 7th, 2011, from 5 PM to 7 PM at Scottsdale First Assembly lobby, located 28700 N. Pima Road, Scottsdale, AZ 85266.

The Open House meeting will be documented, providing the City of Scottsdale Planning & Development Services Department with the list of attendees; all comments and a written summary of comments, issues and concerns.

Looking forward to seeing you June 7th, - 5 PM to 7 PM

God Bless

Victor W. Grotlisch
Project Director

SCOTTSDALE FIRST ASSEMBLY
D R E A M C E N T E R

May 13th, 2011

Pima Realty Inc. or Current Resident
28460 N Pima Rd
Scottsdale, AZ 85266

Subject: Meeting Notification – Parcel-216-70-006-V
Modification – Current Conditional Use Permit
Scottsdale First Assembly
28700 N. Pima Road

Scottsdale First Assembly Dream Center is permitted to operate a charter school (K thru 12 grades) with a maximum school attendance of 250 enrollments. However, we are currently only operating the grades of K thru 8th.

Scottsdale First Assembly is applying to modify the current "Conditional Use Permit" to allow "Temporary Structures" (trailers) installed on the property. These additional facilities will be used to allow continued educational efforts with class rooms for grades above eight (8th grade). The maximum enrollment level (250students) will not be changed.

This neighborhood notification letter is advising that an "Open House" meeting will be held on June 7th, 2011, from 5 PM to 7 PM at Scottsdale First Assembly lobby, located 28700 N. Pima Road, Scottsdale, AZ 85266.

The Open House meeting will be documented, providing the City of Scottsdale Planning & Development Services Department with the list of attendees; all comments and a written summary of comments, issues and concerns.

Looking forward to seeing you June 7th, - 5 PM to 7 PM

God Bless

Victor W. Grotlisch
Project Director

SCOTTSDALE FIRST ASSEMBLY
D R E A M C E N T E R

May 13th, 2011

Pima Realty Inc. or Current Resident
301 N. Main Street
New city, NY 10956

Subject: Meeting Notification – Parcel-216-70-006-V
Modification – Current Conditional Use Permit
Scottsdale First Assembly
28700 N. Pima Road

Scottsdale First Assembly Dream Center is permitted to operate a charter school (K thru 12 grades) with a maximum school attendance of 250 enrollments. However, we are currently only operating the grades of K thru 8th.

Scottsdale First Assembly is applying to modify the current “Conditional Use Permit” to allow “Temporary Structures” (trailers) installed on the property. These additional facilities will be used to allow continued educational efforts with class rooms for grades above eight (8th grade). The maximum enrollment level (250students) will not be changed.

This neighborhood notification letter is advising that an “Open House” meeting will be held on June 7th, 2011, from 5 PM to 7 PM at Scottsdale First Assembly lobby, located 28700 N. Pima Road, Scottsdale, AZ 85266.

The Open House meeting will be documented, providing the City of Scottsdale Planning & Development Services Department with the list of attendees; all comments and a written summary of comments, issues and concerns.

Looking forward to seeing you June 7th, - 5 PM to 7 PM

God Bless

Victor W. Grottlisch
Project Director

SCOTTSDALE FIRST ASSEMBLY
D R E A M C E N T E R

May 13th, 2011

Pima Realty Inc. or Current Resident
28460 N Pima Rd
Scottsdale, AZ 85266

Subject: Meeting Notification - Parcel #216-70-006W
Modification - Current Conditional Use Permit
Scottsdale First Assembly
28700 N. Pima Road

Scottsdale First Assembly Dream Center is permitted to operate a charter school (K thru 12 grades) having a maximum school attendance of 250 enrollments. However, we are currently only operating the grades of K thru 8th.

Scottsdale First Assembly is applying to modify the current "Conditional Use Permit" to allow "Temporary Structures" (trailers) installed on the property. These additional facilities will be used to allow continued educational efforts with class rooms for grades above eight (8th grade). The maximum enrollment level (250students) will not be changed.

This neighborhood notification letter is advising that an "Open House" meeting will be held on June 7th, 2011, from 5 PM to 7 PM at Scottsdale First Assembly lobby, located 28700 N. Pima Road, Scottsdale, AZ 85266.

The Open House meeting will be documented, providing the City of Scottsdale Planning & Development Services Department with the list of attendees; all comments and a written summary of comments, issues and concerns.

Looking forward to seeing you June 7th, - 5 PM to 7 PM

God Bless

Victor W. Grotlisch
Project Director

SCOTTSDALE FIRST ASSEMBLY

D R E A M C E N T E R

Project Director

May 13th, 2011

Pima Realty Inc. or Current Resident
301 N. Main Street
New City, NY 10956

Subject: Meeting Notification - Parcel #216-70-006-W
Modification - Current Conditional Use Permit
Scottsdale First Assembly
28700 N. Pima Road

Scottsdale First Assembly Dream Center is permitted to operate a charter school (K thru 12 grades) having a maximum school attendance of 250 enrollments. However, we are currently only operating the grades of K thru 8th.

Scottsdale First Assembly is applying to modify the current "Conditional Use Permit" to allow "Temporary Structures" (trailers) installed on the property. These additional facilities will be used to allow continued educational efforts with class rooms for grades above eight (8th grade). The maximum enrollment level (250 students) will not be changed.

This neighborhood notification letter is advising that an "Open House" meeting will be held on June 7th, 2011, from 5 PM to 7 PM at Scottsdale First Assembly lobby, located 28700 N. Pima Road, Scottsdale, AZ 85266.

The Open House meeting will be documented, providing the City of Scottsdale Planning & Development Services Department with the list of attendees; all comments and a written summary of comments, issues and concerns.

Looking forward to seeing you June 7th, - 5 PM to 7 PM

God Bless

Victor W. Grotlisch
Project Director

Parcel 216-70-006-W

700 N. Pima Road, Scottsdale, AZ 85266

P: 480-474-9121 F: 480-474-9121

WWW.VGSCORPORATION.COM