

**CITY
COPY**

SKYSONG BLVD.

EXISTING LANDSCAPING

RAMP &
LANDINGS

STREET

74TH

**APPROVED
FINAL PLANS PLANNING**

7-30-2013

APPROVED BY

SEE SA # 202-SA-2013

FUTURE PARK
CONSTRUCTION TO BEGIN
JULY 2013
PARCEL 2

PROPOSED LEASING TRAILER

0 8 16 32



TODD & ASSOCIATES, INC.

ARCHITECTURE PLANNING LANDSCAPE ARCHITECTURE
602.952.8280p www.toddassoc.com

SKYSONG APARTMENTS • SCOTTSDALE, AZ
Project Number: 12-2005-01 • Date: 07-15-2013
Phase • For Review

J:\P\12\12-2005-01\Leasing Trailer\2643_12.dwg, 7/18/2013 11:52:05 AM, JThompson

196785

6/9/13

- 1) RAMP SHALL HAVE A RUNNING SLOPE NOT STEEPER THAN 1/12 (8% SLOPE)
- 2) THE MAXIMUM VERTICAL RISE OF RAMP RUN SHALL BE 30" MAXIMUM.
- 3) THE SLOPE PERPENDICULAR TO THE DIRECTION OF TRAVEL AND THE SLOPE ON LANDINGS SHALL NOT BE STEEPER THAN ONE UNIT VERTICAL IN 48 UNITS HORIZONTAL.
- 4) WHEN CHANGES IN DIRECTION OF TRAVEL OCCUR AT LANDINGS BETWEEN RAMP RUNS, THE LANDING SHALL BE 60"x60" MINIMUM
- 5) MANEUVERING CLEARANCE ON PULL SIDE OF DOOR SHALL BE 18" ON INTERIOR AND 24" EXTERIOR WITH 60" LANDING IN FRONT OF DOOR.
- 6) HANDRAILS SHALL BE CONTINUOUS ALONG BOTH SIDES. HANDRAILS SHALL BE PARALLEL WITH THE SURFACE AND PROJECT 12"
- 7) TOP OF HANDRAILS SHALL BE MOUNTED BETWEEN 33" AND 36" ABOVE THE SURFACE.
- 8) CLEARANCE BETWEEN RAIL AND WALL SHALL BE 11/2".
- 9) GUARD RAILS SHALL TO BE DESIGNED FOR A CONCENTRATED LOAD OF 200# APPLIED @ ANY POINT AND ANY DIRECTION ALONG THE RAIL OR A UNIFORM LOAD OF 50#/L. F. APPLIED HORIZONTALLY TO THE GUARD HEIGHT.
- 10) BALUSTERS ARE INDEPENDENTLY DESIGNED FOR A CONCENTRATE LOAD OF 200# APPLIED TO ONE SQUARE FOOT OF AREA.
- 11) HANDRAILS SHALL HAVE A CIRCULAR CROSS SECTION WITH AN OUTSIDE MAXIMUM DIAMETER OF 1 1/4" MINIMUM AND 2" MAXIMUM.
- 12) GRIPPING SURFACE SHALL BE UNINTERRUPTED BY POSTS OR OTHER CONSTRUCTION ELEMENTS OR OBSTRUCTIONS.
- 13) HANDRAILS SHALL NOT ROTATE IN THEIR FITTINGS.
- 14) ENDS OF HANDRAILS SHALL RETURN SMOOTHLY TO FLOOR, WALL OR POST.
- 15) STEPS, RAMPS AND PLATFORMS SHALL BE DESIGNED FOR 100 PSF LIVE LOAD.
- 16) RAMPS EXCEEDING 10 FT IN LENGTH AND LANDING HAVING A DROP EXCEEDING 4 IN. SHALL BE PROVIDED WITH WHEEL GUIDE 2 TO 4 IN. ABOVE THE SURFACE OF RAMP AND LANDING
- 17) SUBMIT SHOP DRAWINGS FOR APPROVAL

1 RAMP NOTES

SCALE: NTS

REFERENCE CBC 2010
 DESIGN LOADS:
 LIVE LOAD- 100 PSF
 HANDRAIL IMPACT- 200 PSF

MATERIALS

ROUND STEEL TUBE- ASTM A513 Fy= 35 KSI
 SQUARE STEEL TUB- ASTM A500 GR. B Fy= 46 KSI
 ALUMINUM SHEET- 3003-H22 Fty= 27 KSI Fcy= 21 KSI
 OR 5052-H34 Fty= 24 KSI Fcy=24 KSI

WELDS
 WELDING SHALL BE IN ACCORDANCE WITH AWS D.1.188
 USING E70XX ELECTRODES FOR STEEL

2 STRUCTURAL NOTES

SCALE: NTS

STAIR CONSTRUCTION NOTES

- 1) MANEUVERING CLEARANCE ON PULL SIDE OF DOOR SHALL BE 18" WITH 60" LANDING IN FRONT OF DOOR. ALL STEPS SHALL HAVE A UNIFORM RISER HEIGHT AND TREAD WIDTH. TREADS SHALL NOT BE LESS THAN 11" DEPTH AND 7" HIGH.
- 2) TREAD NOSING SHALL NOT BE ABRUPT. BOTTOM OF NOSING SHALL HAVE AN ANGLE NOT MORE THAN 30 DEGREES FROM HORIZONTAL PROJECTION AND SHALL NOT EXCEED 1 1/4". PER IBC 2006 SECTION 1009 STAIRS, PARAGRAPH 1009.3.3 PROFILE
- 3) THERE SHALL BE NO VARIATION EXCEEDING 3/16" DEPTH OF ADJACENT TREADS OR IN HEIGHT OF ADJACENT RISERS AND A TOLERANCE BETWEEN LARGEST AND SMALLEST TREAD SHALL NOT EXCEED 3/8" IN ANY FLIGHT.
- 4) HANDRAILS WITH CIRCULAR CROSS SECTION SHALL HAVE A MINIMUM OUTSIDE DIMENSION OF 1 1/4" AND NOT GREATER THAN 2". FOR NON CIRCULAR HANDRAILS THE MINIMUM DIMENSION IS 4" AND NOT GREATER THAN 6 1/4" WITH A MAXIMUM CROSS-SECTION DIMENSION OF 2 1/4". EDGES SHALL HAVE A MINIMUM RADIUS OF 0.01" HANDRAIL-GRIPPING SURFACES SHALL BE CONTINUOUS WITHOUT INTERRUPTION BY NEWEL POSTS OR OTHER OBSTRUCTIONS. HANDRAILS SHALL RETURN TO A WALL OR EXTEND HORIZONTALLY AT LEAST 12" BEYOND THE TOP RISER AND SHALL EXTEND 12" PLUS ONE TREAD AT BOTTOM RISERS. CLEAR SPACE BETWEEN THE WALL OR OTHER SURFACE SHALL BE A MINIMUM 1 1/2"
- 5) OPEN RISERS ARE NOT PERMITTED.
- 6) OUTDOOR STAIRS AND THEIR APPROACHES SHALL BE DESIGNED SO THAT WATER WILL NOT ACCUMULATE ON THE WALKING SURFACE.
- 7) STEPS, RAMPS AND PLATFORMS SHALL BE DESIGNED FOR 100 PSF LIVE LOAD.

3 STAIR CONSTRUCTION NOTES

SCALE: NTS

- 1) MANEUVERING CLEARANCE ON EXTERIOR PULL SIDE OF DOOR SHALL BE 24" MINIMUM WITH 60" MINIMUM LANDING IN FRONT OF DOOR.
- 2) HANDRAILS SHALL BE CONTINUOUS ALONG BOTH SIDES. HANDRAILS SHALL BE PARALLEL WITH THE SURFACE AND PROJECT 12" ON TOP OF RISER AND 12" PLUS 1 TREAD AT BOTTOM RISER. AT RAMPS WHERE HANDRAIL ARE NOT CONTINUOUS BETWEEN RUNS THE HANDRAIL SHALL EXTEND HORIZONTALLY ABOVE THE LANDING 12" MINIMUM BEYOND TOP AND BOTTOM RAMPS
- 3) TOP OF HANDRAILS SHALL BE MOUNTED BETWEEN 33" AND 36" ABOVE THE SURFACE.
- 4) CLEARANCE BETWEEN RAIL AND WALL SHALL BE A MINIMUM OF 11/2".
- 5) GUARD RAILS ARE TO BE DESIGNED FOR A CONCENTRATED LOAD OF 200# APPLIED @ ANY POINT AND ANY DIRECTION ALONG THE RAIL OR A UNIFORM LOAD OF 50#/LF APPLIED HORIZONTALLY @ GUARD HEIGHT.
- 6) BALUSTERS ARE INDEPENDENTLY DESIGNED FOR A CONCENTRATED LOAD OF 200# APPLIED TO ONE SQUARE FOOT OF AREA.
- 7) HANDRAILS SHALL HAVE A CIRCULAR CROSS SECTION WITH AN OUTSIDE DIAMETER OF 1 1/4" MINIMUM AND NOT GREATER THAN 2" MAXIMUM.
- 8) GRIPPING SURFACE SHALL BE UNINTERRUPTED BY POSTS OR OTHER CONSTRUCTION ELEMENTS OR OBSTRUCTIONS.
- 9) HANDRAILS SHALL NOT ROTATE IN THERE FITTINGS.
- 10) ENDS OF HANDRAILS SHALL RETURN SMOOTHLY TO FLOOR, WALL OR POST.

4 RAILING NOTES

SCALE: NTS



THE PLANS, IDEAS & DESIGNS SHOWN ON THESE DRAWINGS ARE THE PROPERTY OF R & S TAVARES ASSOCIATES. DEvised SOLELY FOR THIS CONTRACT. THESE PLANS SHALL NOT BE USED, IN WHOLE OR IN PART, FOR ANY PURPOSE FOR WHICH THEY WERE NOT INTENDED WITHOUT THE EXPRESS WRITTEN CONSENT OF R & S TAVARES ASSOCIATES ©

REVISION**PROFESSIONAL STAMP**

05/14/2013

PROJECT TITLE
 ADA COMPLETE
 ACCESS
 STAIRS WITH RAMP

SHEET TITLE
 NOTES

PROJECT NUMBER
 10027

DRAWN BY ST **CHECKED BY** RT

DATE
 03-05-2013

SHEET NO.
 A1.0

1 5/16" Ø x 0.065
STEEL TUBE
HANDRAIL (TYP.)



LANDING REQUIRED AT EVERY 30" CHANGE IN
ELEVATION w/ 1/12 MAX. SLOPE RAMP

5

A3.2

2x2x3/16 ALUMINUM
POST (TYP.)

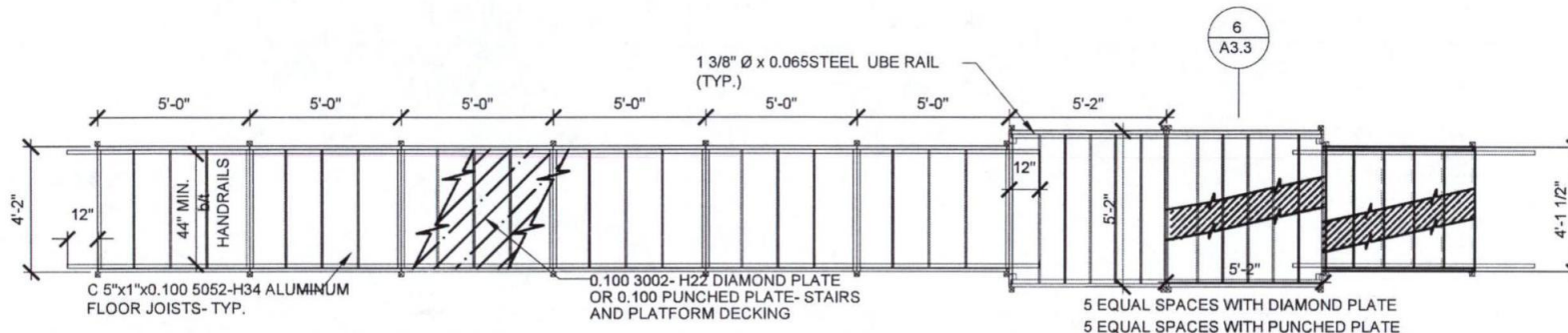

6

A3.3

1 RAMP WITH STAIRS FLOOR PLAN AND SIDE VIEW

SCALE: 1 1/2"=1'-0"

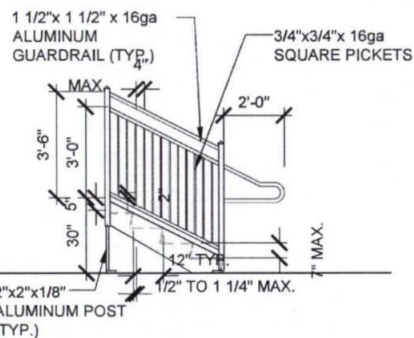

2 RAMP SIDE RAIL

SCALE: 1/4"=1'-0"

3 RAMP LANDING RAIL

SCALE: 1/4"=1'-0"

5 POST DETAIL

SCALE: 3/4"=1'-0"

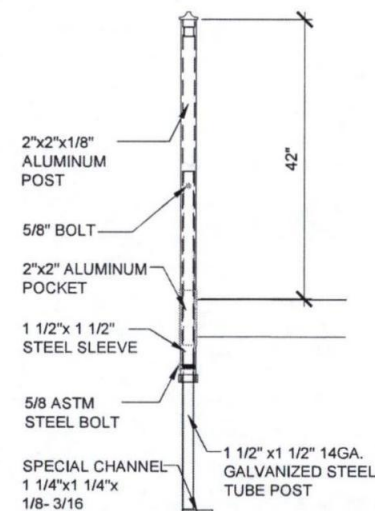

THE PLANS, IDEAS & DESIGNS SHOWN ON
THESE DRAWINGS ARE THE PROPERTY
OF R & S TAVARES ASSOCIATES. DEvised
SOLELY FOR THIS CONTRACT. THESE
PLANS SHALL NOT BE USED, IN WHOLE
OR IN PART, FOR ANY PURPOSE FOR
WHICH THEY WERE NOT INTENDED
WITHOUT THE EXPRESS WRITTEN CONSENT
OF R & S TAVARES ASSOCIATES ©

REVISION



PROFESSIONAL STAMP



PROJECT TITLE
ADA COMPLETE
ACCESS
STAIRS WITH RAMP

SHEET TITLE
FLOOR PLAN
SIDE VIEW
DETAILS

PROJECT
NUMBER
10027
DRAWN BY
ST
CHECKED BY
RT
DATE
03-05-2013
SHEET NO.

A2.0

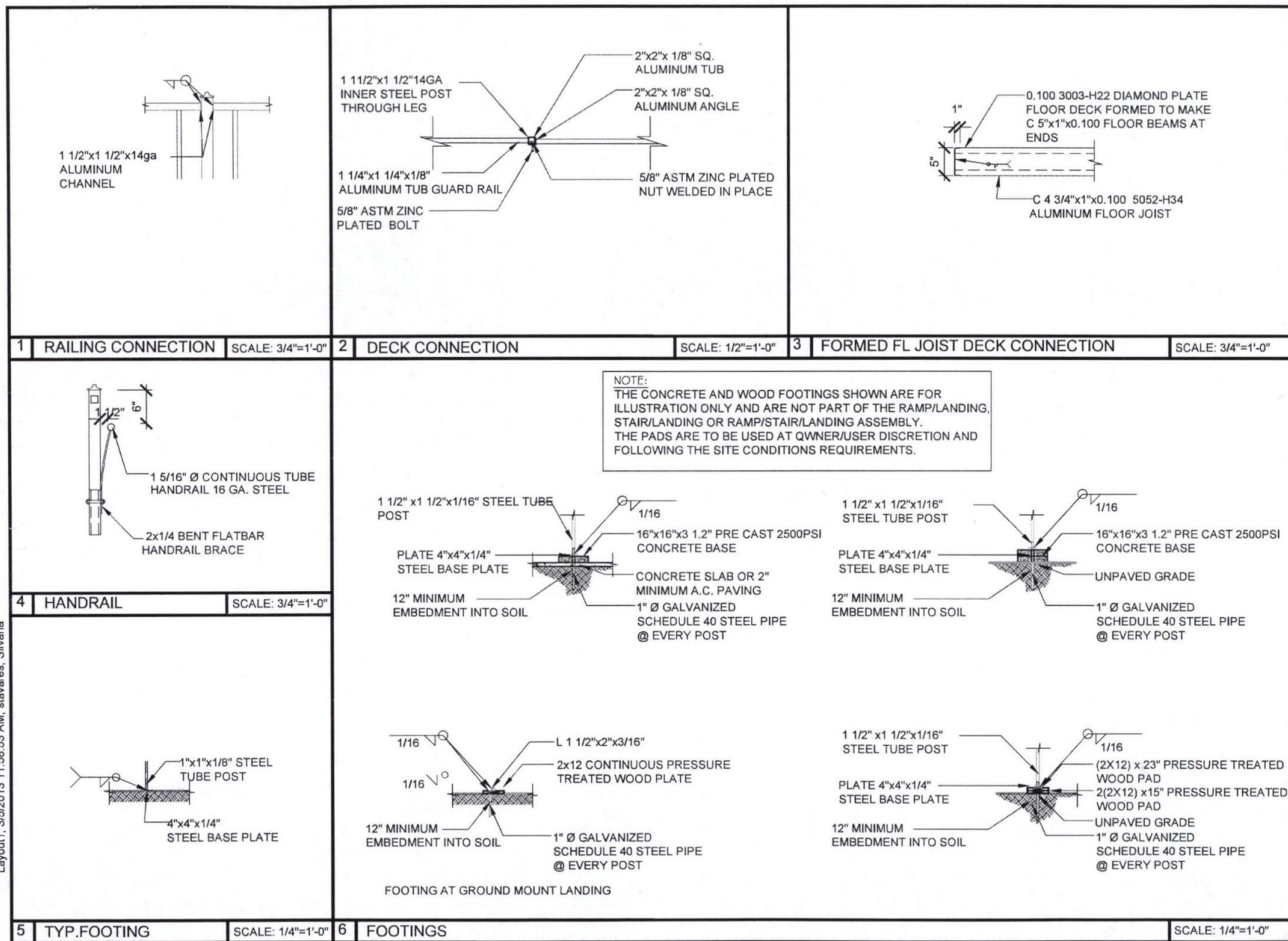

THE PLANS, IDEAS & DESIGNS SHOWN ON THESE DRAWINGS ARE THE PROPERTY OF R & S TAVARES ASSOCIATES, DEVISED SOLELY FOR THIS CONTRACT. THESE PLANS SHALL NOT BE USED, IN WHOLE OR IN PART, FOR ANY PURPOSE FOR WHICH THEY WERE NOT INTENDED WITHOUT THE EXPRESS WRITTEN CONSENT OF R & S TAVARES ASSOCIATES ©

REVISION



PROFESSIONAL STAMP



PROJECT TITLE
ADA COMPLETE
ACCESS
STAIRS WITH RAMP

SHEET TITLE
FOOTINGS
DETAILS

PROJECT
NUMBER
10027

DRAWN BY
ST

CHECKED BY
RT

DATE
03-05-2013

SHEET NO.

A3.0

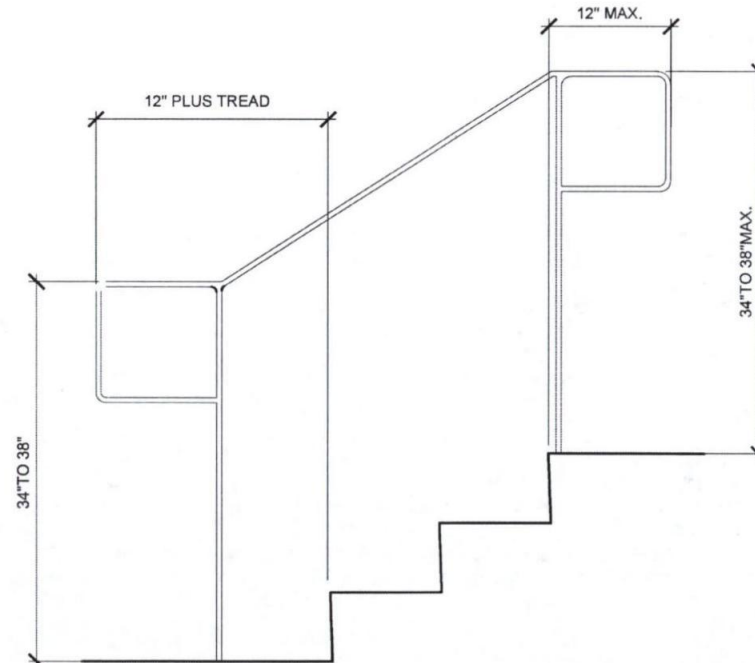
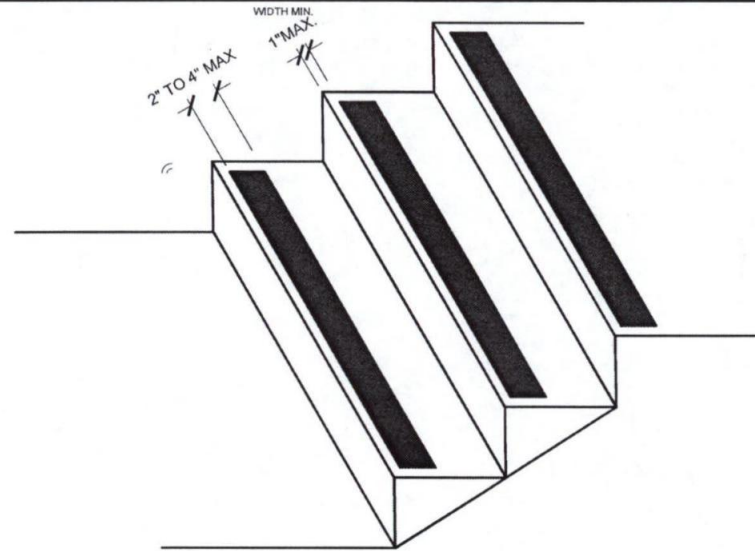
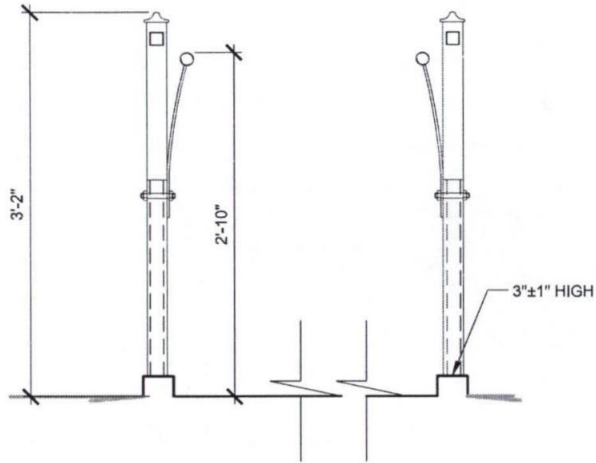

THE PLANS, IDEAS & DESIGNS SHOWN ON THESE DRAWINGS ARE THE PROPERTY OF R & S TAVARES ASSOCIATES. THESE PLANS SHALL NOT BE USED, IN WHOLE OR IN PART, FOR ANY PURPOSE FOR WHICH THEY WERE NOT INTENDED WITHOUT THE EXPRESS WRITTEN CONSENT OF R & S TAVARES ASSOCIATES ©

REVISION



PROFESSIONAL STAMP



PROJECT TITLE
ADA COMPLETE ACCESS STAIRS WITH RAMP

SHEET TITLE
RAMP & STAIRS

PROJECT NUMBER
10027

DRAWN BY
ST

CHECKED BY
RT

DATE
03-05-2013

SHEET NO.
A3.1