

**Correspondence Between
Staff and Applicant
Approval Letter**



Neighborhood Notification Checklist

AB, BA, UP, DR, HE, MUMSP

Neighborhood notification is necessary for all Conditional Use Permits, including Municipal Use Master Site Permits, Abandonments, Development Review Board, Board of Adjustment, and Hardship Exemption cases. You are required to return this form with checked items completed, and your Neighborhood notification Report with your application submittal.

If you have questions on these requirements, please contact Planning & Development Services at 480-312-2328.

This application is for a:

- Abandon of ROW/GLO
- Board of Adjustment
- Conditional Use Permit
- Development Review Board
- Hardship Exemption
- Municipal Use Master Site Plan

If you are submitting an application for Re-Zoning, Zoning Ordinance Text Amendments, Zoning Stipulation Amendments, Council Approved Amended Standards, and City Council Site Plan Approval this is not the correct checklist; please obtain a copy of the Citizen Review Checklist from your project coordinator. If you are applying for a General Plan Amendment, please obtain a copy of the Neighborhood Involvement Checklist from your project coordinator.

Complete the following marked items prior to submitting your application

Step 1: Neighborhood Notification

<p>Provide information by:</p> <ul style="list-style-type: none"> <input checked="" type="checkbox"/> 1st Class Letter or Postcard <input type="checkbox"/> In Person <input type="checkbox"/> Phone call <input type="checkbox"/> Certified Mail <input type="checkbox"/> Door Hangers/Flyers 	<p>To:</p> <ul style="list-style-type: none"> <input checked="" type="checkbox"/> Property owners and HOAs within 750' (*required for all WCF) <input type="checkbox"/> Adjacent property owners/ tenants/HOAs <input type="checkbox"/> School District(s) <input type="checkbox"/> Interested Party list (provided by Project Coordinator) <input type="checkbox"/> Tenants, employees, and students (*required for all WCF)
---	---

* WCF requirements for Notification shall be completed a minimum of 15 days prior to the application submittal.

Project Notification shall include the following information:

- Project request and description
- Location
- Size (e.g. Number of Acres of project, Square Footage of Lot)
- Zoning
- Site Plan
- Applicant and City contact names and phone numbers
- Any scheduled open house(s) - including time, date, and location

Step 2: Project Under Consideration

- Post sign 10 calendar days prior to your Open House Meeting. (See Sign posting requirements)
- Post sign 15 calendar days prior to your formal application submittal. (See WFC requirements)

2-UP-2014
4/14/2014

Planning, Neighborhood & Transportation Division

7447 E. Indian School Road, Suite 105, Scottsdale, AZ 85251 • Phone: 480-312-7000 • Fax: 480-312-7088



Community Input Certification

CASE NO: 272-PA-14

PROJECT LOCATION: 4301 N. Civic Center Plaza

COMMUNITY INPUT CERTIFICATION

In the City of Scottsdale it is important that all applicants for rezoning, use permit, and/or variances inform neighboring residents, affected school districts, and other parties that may be impacted by the proposed use, as well as invite their input. The applicant shall submit this completed certification with the application as verification that such contact has been made.

DATE	NAME (Person, Organization, Etc. and Address)	Type of Contact		
		Meeting	Phone	Letter
4-11-14	Project Name: MIXX			
(OPEN HOUSE)				
	Please see attached informational invitation that was sent to the attached contact list of property owners (see attached map) on March 27, 2014.			

Michael Steen
Signature of owner/applicant

4-12-14
Date

2-UP-2014
4/14/2014

Planning, Neighborhood & Transportation Division

7447 E Indian School Road, Suite 105, Scottsdale, AZ 85251 • Phone: 480-312-7000 • Fax: 480-312-7088

Neighborhood Notification Report

OPEN HOUSE FOR "MIXX"

Project Number: 272-PA-14

MIXX is a proposed Lounge/Event Space located at 4301 N. Civic Center Plaza in Scottsdale, Arizona.

An open house meeting occurred on April 11, 2014 from 6:30 pm to 7:30 pm at the site location of 4301 N. Civic Center Plaza in Scottsdale, AZ.

Michael Stein, the business owner, was in attendance. Michael holds a very positive attitude about the project. No one presented with any opposition to the project. No further follow up is necessary.

Enclosed with this meeting summary is the attendance sheet from the meeting, the notification checklist, and returned letters of notification that were unable to be delivered to their recipients.



Michael Stein

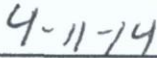

Date

ATTENDANCE SHEET

OPEN HOUSE FOR "MIXX" APRIL 11, 2014

Project Number: 272-PA-14

NAME	ISSUES OF CONCERN
Michael Stein	None

ATTENDANCE CERTIFIED AS ACCURATE BY:

Michael Stein
Michael Stein

4-11-14
Date

March 27, 2014

Re: Mixx, 4301 N. Civic Center Plaza

Dear Neighbor,

This letter is notification of a proposed project named Mixx located at 4301 N. Civic Center Plaza, Scottsdale, AZ 85251; which is on the corner of Civic Center Plaza and 6th Avenue.

Mixx is slated as a "Mixxed-use" venue. This versatile space will be transformed into a comfortable event venue, for Bar/Bat Mitzvahs, Sweet 16s, and corporate functions. On the weekends, Mixx will be available as an upscale lounge, catering to the more refined clientele of Scottsdale.

The property is currently a two story building sited on 4,942 gross square feet of lot area (0.11 acres). The property is zoned C-3/P-3/P-2/DO. The proposed project will retain the zoning. There will not be any structural changes to the building. New cosmetic work will be made to the interior and exterior, although cosmetic work to the exterior will only be improvements to the existing condition and will not change the look. Applications for a Conditional Use Permit for uses of a Bar and Live Entertainment are being applied.

An open house will be held April 11, 2014 at 6:30PM at 4301 N. Civic Center Plaza Scottsdale, AZ 85251.

Contact information should there be any questions regarding the project.

Applicant:

M1 Hospitality 1 LLC d/b/a Mixx

Michael Stein

mstein@m1hospitality.com

(602) 774-6828

City of Scottsdale:

Greg Bloemberg

gbloemberg@scottsdaleaz.gov

(480) 312-4306

Sincerely,



Michael Stein

2-UP-2014
4/14/2014

City Notifications - Mailing List Selection Map

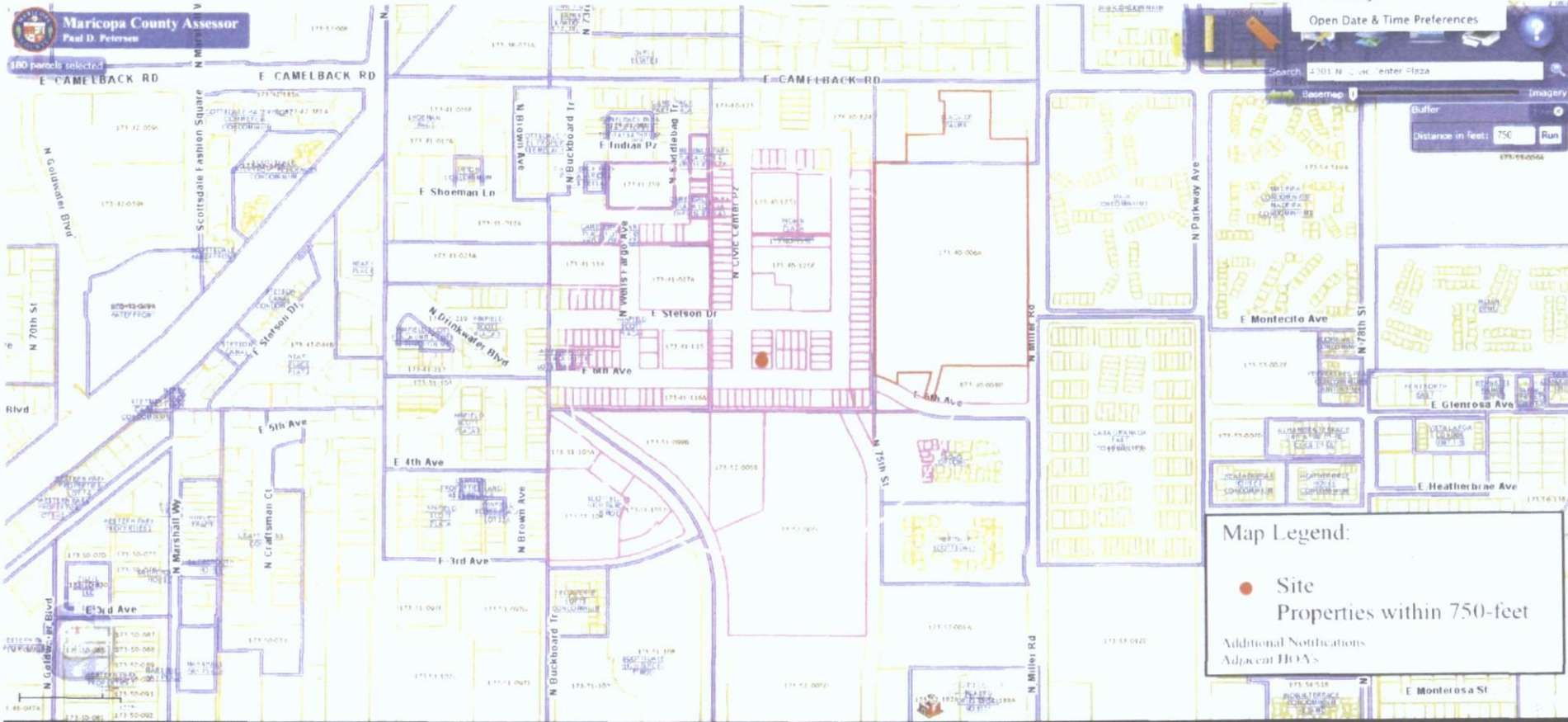

2-UP-2014
4/14/2014

Owner	MAIL_ADDR1	MAIL_ADDR2	MAIL_CITY	MAIL_STATE	MAIL_ZIP	MAIL_COUNT	FAPN
CAMEL INVE	4241 N WINFIELD	SCOTT PL	SCOTTSDALE	AZ	85251 USA		17340006A
CONVERTIBLE	6116 E CACTUS	WREN RD	PARADISE VAL	AZ	85253 USA		17340008C
VNB INVESTM	4241 N WINFIELD	SCOTT PL	SCOTTSDALE	AZ	85251 USA		17340008D
ROVER INVE	10258 E SPRING	CREEK RD	SUN LAKES	AZ	85248 USA		17340008F
P6 EVEREST	S TWO SEAPORT	LN	BOSTON	MA	22102021 USA		17340020
P6 EVEREST	S TWO SEAPORT	LN	BOSTON	MA	22102021 USA		17340021
PLANETA PROI	PO BOX 2118		SCOTTSDALE	AZ	85252 USA		17340022
PLANETA PROI	PO BOX 2118		SCOTTSDALE	AZ	85252 USA		17340023
RENKES LLC	4441 N 75TH	ST	SCOTTSDALE	AZ	85251 USA		17340024
SANDOVAL NI	5802 E WALTANN	LN	SCOTTSDALE	AZ	85254 USA		17340025A
PEBBLE RUN	L 4421 N 75TH	ST STE 101	SCOTTSDALE	AZ	85251 USA		17340027B
CP FINANCI	AL 4385 N 75TH	ST STE 201	SCOTTSDALE	AZ	85251 USA		17340028A
CP FINANCI	AL 4385 N 75TH	ST STE 201	SCOTTSDALE	AZ	85251 USA		17340030A
LARSON WHIT	4373 N 75TH	AVE	SCOTTSDALE	AZ	85251 USA		17340031
LARSON WHIT	4373 N 75TH	AVE	SCOTTSDALE	AZ	85251 USA		17340032
LARSON WHIT	4373 N 75TH	AVE	SCOTTSDALE	AZ	85251 USA		17340033
ROBERT A LEC	8689 E THOROUGH	BRED TRI	SCOTTSDALE	AZ	85258 USA		17340034
MEALMAN PR	C P O BOX 65		SCOTTSDALE	AZ	85252 USA		17340035
SOFIA L PROP	3599 CAHUENGA	BLVD 2ND	LOS ANGELES	CA	90068 USA		17340036
SOFIA L PROP	3599 CAHUENGA	BLVD 2ND	LOS ANGELES	CA	90068 USA		17340037
SOFIA L PROP	3599 CAHUENGA	BLVD 2ND	LOS ANGELES	CA	90068 USA		17340038
SOFIA L PROP	3599 CAHUENGA	BLVD 2ND	LOS ANGELES	CA	90068 USA		17340039
SOFIA L PROP	3599 CAHUENGA	BLVD 2ND	LOS ANGELES	CA	90068 USA		17340040
MAL & FLIP	LL 8502 E KRAILS	ST	SCOTTSDALE	AZ	85250 USA		17340041
MAL & FLIP	LL 8502 E KRAILS	ST	SCOTTSDALE	AZ	85250 USA		17340042
MAL & FLIP	LL 8502 E KRAILS	ST	SCOTTSDALE	AZ	85250 USA		17340043
MAL & FLIP	LL 8502 E KRAILS	ST	SCOTTSDALE	AZ	85250 USA		17340044
KALIL AYAL	TF SULAM YAAKOV	251	TEKOA		90908 ISRAEL		17340045
ISMALLOFF	BE 15756 TERRACE	LAWN CIR	DALLAS	TX	75248 USA		17340046
SMITH TERREI	9270 E THOMPSON	PEAK PK	SCOTTSDALE	AZ	85255 USA		17340047
4301 75TH	ST 4414 N CIVIC	CENTER SUITE	SCOTTSDALE	AZ	85251 USA		17340048
4301 75TH	ST 4414 N CIVIC	CENTER SUITE	SCOTTSDALE	AZ	85251 USA		17340049
4301 75TH	ST 4414 N CIVIC	CENTER SUITE	SCOTTSDALE	AZ	85251 USA		17340050
4301 75TH	ST 4414 N CIVIC	CENTER SUITE	SCOTTSDALE	AZ	85251 USA		17340051B
SCOTTSDALE	17447 E INDIAN	SCHOOL RD	SCOTTSDALE	AZ	85251 USA		17340051C

2-UP-2014
4/14/2014

SMITH DAVID 4310 N 75TH ST	SCOTTSDALE AZ	85251 USA	17340052
SMITH DAVID 4310 N 75TH ST	SCOTTSDALE AZ	85251 USA	17340053
URBAN GROUP 4326 N 75TH ST	SCOTTSDALE AZ	85251 USA	17340054
HOCHHAUS ST 4340 N 75TH ST	SCOTTSDALE AZ	85251 USA	17340055
HOCHHAUS ST 4340 N 75TH ST	SCOTTSDALE AZ	85251 USA	17340056
STETSON DR 7425 E STETSON DR	SCOTTSDALE AZ	85251 USA	17340057A
FLOYD INVEST 6939 E 5TH AVE	SCOTTSDALE AZ	85251 USA	17351051
FLOYD INVEST 6939 E 5TH AVE	SCOTTSDALE AZ	85251 USA	17351052
FLOYD INVEST 6939 E 5TH AVE	SCOTTSDALE AZ	85251 USA	17351053
STETSON DR 7425 E STETSON DR	SCOTTSDALE AZ	85251 USA	17340058A
STETSON DR 7425 E STETSON DR	SCOTTSDALE AZ	85251 USA	17340059A
STETSON DR 7425 E STETSON DR	SCOTTSDALE AZ	85251 USA	17340060A
PLAZA DE OFI 4333 N CIVIC CENTER PLAZA	SCOTTSDALE AZ	85251 USA	17340061
PLAZA DE OFI 4333 N CIVIC CENTER PLAZA	SCOTTSDALE AZ	85251 USA	17340062
MCCALL ASSO 4307 N CIVIC CENTER PLZ	SCOTTSDALE AZ	852513522 USA	17340063
CREATIVESWAR 7440 E 6TH AVE STE 200	SCOTTSDALE AZ	85251 USA	17340066A
CREATIVESWAR 7440 E 6TH AVE STE 200	SCOTTSDALE AZ	85251 USA	17340067A
CREATIVESWAR 7440 E 6TH AVE STE 200	SCOTTSDALE AZ	85251 USA	17340068A
CREATIVESWAR 7440 E 6TH AVE STE 200	SCOTTSDALE AZ	85251 USA	17340069A
POLLACK FAM 7505 E 6TH A #100	SCOTTSDALE AZ	85251 USA	17340070B
POLLACK FAM 7505 E 6TH A #100	SCOTTSDALE AZ	85251 USA	17340071B
POLLACK FAM 7505 E 6TH A #100	SCOTTSDALE AZ	85251 USA	17340072C
SCOTTSDALE 7447 E INDIAN SCHOOL RD	SCOTTSDALE AZ	85251 USA	17340072D
SCOTTSDALE 7447 E INDIAN SCHOOL RD	SCOTTSDALE AZ	85251 USA	17340073
SCOTTSDALE 7447 E INDIAN SCHOOL RD	SCOTTSDALE AZ	85251 USA	17340074A
GPW TRUST 12823 S 41ST ST	PHOENIX AZ	85044 USA	17340077A
FLOYD INVEST 6939 E 5TH AVE	SCOTTSDALE AZ	85251 USA	17351054
CARTWRIGHT 4255 N BROWN AVE	SCOTTSDALE AZ	85251 USA	17351055
SCOTTSDALE 3939 CIVIC CENTER BLVD	SCOTTSDALE AZ	852510000 USA	17351056
SCOTTSDALE 7447 E INDIAN SCHOOL RD	SCOTTSDALE AZ	85251 USA	17351056A
SCOTTSDALE 3939 CIVIC CENTER BLVD	SCOTTSDALE AZ	852510000 USA	17351057
SCOTTSDALE 3939 CIVIC CENTER BLVD	SCOTTSDALE AZ	852510000 USA	17351058
SCOTTSDALE 3939 CIVIC CENTER BLVD	SCOTTSDALE AZ	852510000 USA	17351059A
SCOTTSDALE 3939 CIVIC CENTER BLVD	SCOTTSDALE AZ	852510000 USA	17351059B
7431 E 6TH A 7135 E CAMELBACK RD NO 3	SCOTTSDALE AZ	85251 USA	17340078
RJ REAL ESTA 4414 N CIVIC CENTER PLAZA	SCOTTSDALE AZ	85251 USA	17340079

RJ REAL ESTA` 4414 N CIVIC CENTER PLAZ/ SCOTTSDALE	AZ	85251 USA	17340080
RJ REAL ESTA` 4414 N CIVIC CENTER PLAZ/ SCOTTSDALE	AZ	85251 USA	17340081
RJ REAL ESTA` 4414 N CIVIC CENTER PLAZ/ SCOTTSDALE	AZ	85251 USA	17340082
RJ REAL ESTA` 4414 N CIVIC CENTER PLAZ/ SCOTTSDALE	AZ	85251 USA	17340083
SIXTH AVENUE I 7301 E 2ND AVE STE 202	SCOTTSDALE AZ	85251 USA	17340084
SIXTH AVENUE I 7301 E 2ND AVE STE 202	SCOTTSDALE AZ	85251 USA	17340085
FRENKEL THOMAS I 7525 E CAMELBACK RD STE	SCOTTSDALE AZ	85251 USA	17340086
FRENKEL THOMAS I 7525 E CAMELBACK RD STE	SCOTTSDALE AZ	85251 USA	17340087
SINGH RANDI 5552 W PARKVIEW LN	GLENDALE AZ	85310 USA	17340088
SINGH RANDI 5552 W PARKVIEW LN	GLENDALE AZ	85310 USA	17340089
SINGH RANDI 5552 W PARKVIEW LN	GLENDALE AZ	85310 USA	17340090
ZEBRA FAMILY 4409 N 66TH ST	SCOTTSDALE AZ	85251 USA	17340091
ZEBRA FAMILY 4409 N 66TH ST	SCOTTSDALE AZ	85251 USA	17340092
ZEBRA FAMILY 4409 N 66TH ST	SCOTTSDALE AZ	85251 USA	17340093
ZEBRA FAMILY 4409 N 66TH ST	SCOTTSDALE AZ	85251 USA	17340094
ZEBRA FAMILY 4409 N 66TH ST	SCOTTSDALE AZ	85251 USA	17340095
FAST TRACK L 4330 N CIVIC CENTER PLAZ/ SCOTTSDALE	AZ	85251 USA	17340096
FAST TRACK L 4330 N CIVIC CENTER PLAZ/ SCOTTSDALE	AZ	85251 USA	17340097
FAST TRACK L 4330 N CIVIC CENTER PLAZ/ SCOTTSDALE	AZ	85251 USA	17340098
FAST TRACK L 4330 N CIVIC CENTER PLAZ/ SCOTTSDALE	AZ	85251 USA	17340099
GGB PARTNER 7381 E 6TH AVE STE 4	SCOTTSDALE AZ	85251 USA	17340100
CASSIDY DAVIS 4356 N CIVIC CENTER PLAZ/ SCOTTSDALE	AZ	85251 USA	17340101
AVISA LLC 111 WILD OAK CT	DANVILLE CA	94506 USA	17340102
CMB ENTERPR 4388 N CIVIC CENTER PLAZ/ SCOTTSDALE	AZ	85251 USA	17340103
CIVIC CENTER 4400 N CIVIC CENTER PLAZ/ SCOTTSDALE	AZ	85251 USA	17340104A
4414 CIVIC CI 4414 N CIVIC CENTER PLZ S SCOTTSDALE	AZ	85251 USA	17340105
4414 CIVIC CI 4414 N CIVIC CENTER PLZ S SCOTTSDALE	AZ	85251 USA	17340106
4414 CIVIC CI 4414 N CIVIC CENTER PLZ S SCOTTSDALE	AZ	85251 USA	17340107
4414 CIVIC CI 4414 N CIVIC CENTER PLZ S SCOTTSDALE	AZ	85251 USA	17340108
JONES 4422 L 4422 CIVIC CENTER PLAZA S SCOTTSDALE	AZ	852513523 USA	17340109
JONES 4422 L 4422 CIVIC CENTER PLAZA S SCOTTSDALE	AZ	852513523 USA	17340110
JONES 4422 L 4422 CIVIC CENTER PLAZA S SCOTTSDALE	AZ	852513523 USA	17340111
4430 CIVIC CI 4414 N CIVIC CENTER PLAZ/ SCOTTSDALE	AZ	85251 USA	17340112
4430 CIVIC CI 4414 N CIVIC CENTER PLAZ/ SCOTTSDALE	AZ	85251 USA	17340113
HHLP SCOTTSDALE 44 HERSHA DR	HARRISBURG PA	17102 USA	17351099B
SUMMIT HOSF 2701 S MINNESOTA AVE STE SIOUX FALLS	SD	57105 USA	17351104

4430 CIVIC C#4414 N CIVIC CENTER PLAZ# SCOTTSDALE	AZ	85251 USA	17340114A
4430 CIVIC C#4414 N CIVIC CENTER PLAZ# SCOTTSDALE	AZ	85251 USA	17340114B
4430 CIVIC C#4414 N CIVIC CENTER PLAZ# SCOTTSDALE	AZ	85251 USA	17340115
SARACEN LIM: 4440 N CIVIC CENTER PLAZ# SCOTTSDALE	AZ	852510000 USA	17340116
SARACEN LIM: 4440 N CIVIC CENTER PLAZ# SCOTTSDALE	AZ	852510000 USA	17340117
WEBER ERWIN 8502 E KRAIL ST	SCOTTSDALE AZ	85250 USA	17340119
WEBER ERWIN 8502 E KRAIL ST	SCOTTSDALE AZ	85250 USA	17340120
WEBER ERWIN 8502 E KRAIL ST	SCOTTSDALE AZ	85250 USA	17340121
WEBER ERWIN 8502 E KRAIL ST	SCOTTSDALE AZ	85250 USA	17340122
BROADSTONE 2415 E CAMELBACK RD STE	PHOENIX AZ	85016 USA	17340125C
BROADSTONE 2415 E CAMELBACK RD STE	PHOENIX AZ	85016 USA	17340125E
BROADSTONE 2415 E CAMELBACK RD STE	PHOENIX AZ	85016 USA	17340125F
BROADSTONE 2415 E CAMELBACK RD STE	PHOENIX AZ	85016 USA	17340125G
P6 EVEREST S TWO SEAPORT LN	BOSTON MA	22102021 USA	17340125J
HEWSON 75TH 11661 SAN VINCENTE	LOS ANGELES CA	90049 USA	17340125K
AJL PROPRTI PO BOX 9064	BREA CA	92822 USA	17351105C
THOMPSON EL 6875 UNION RD	PASO ROBLES CA	93446 USA	17351105D
4282 N DRINK 5100 POLULAR AVE SUITE 2	MEMPHIS TN	38137 USA	17351106A
REDWOOD VII 47 ALMA CT	LOS ALTOS CA	94022 USA	17351106B
7525 CAMELB, 7000 E MCDOWELL RD STE 1	SCOTTSDALE AZ	85257 USA	17340134C
BROADSTONE 2415 E CAMELBACK RD STE	PHOENIX AZ	85016 USA	17341027A
IP9 LINCOLN # 770 TOWNSHIP LINE ROAD S	YARDLEY PA	19067 USA	17351108
STOCKDALE G 10850 WILSHIRE BLVD STE :	LOS ANGELES CA	90024 USA	17341061B
STOCKDALE G 10850 WILSHIRE BLVD STE :	LOS ANGELES CA	90024 USA	17341062D
BLJ'S PROPER 2244 W MCDOWELL RD	PHOENIX AZ	85009 USA	17341063
BLJ'S PROPER 2244 W MCDOWELL RD	PHOENIX AZ	85009 USA	17341064
BLJ'S PROPER 2244 W MCDOWELL RD	PHOENIX AZ	85009 USA	17341065
BLJ'S PROPER 2244 W MCDOWELL RD	PHOENIX AZ	85009 USA	17341066
BLJ'S PROPER 2244 W MCDOWELL RD	PHOENIX AZ	85009 USA	17341067
SCOTTSDALE # BLVD	SCOTTSDALE AZ	852510000 USA	17341068
SCOTTSDALE # 3939 CIVIC CENTER BLVD	SCOTTSDALE AZ	85251 USA	17341069
SCOTTSDALE # 3939 CIVIC CENTER BLVD	SCOTTSDALE AZ	85251 USA	17341070
SCOTTSDALE # 3939 CIVIC CENTER BLVD	SCOTTSDALE AZ	852510000 USA	17341071
ROJO HOLDIN 11216 N 28TH ST	PHOENIX AZ	85028 USA	17341072
NYMAN PROPE 7321 E 6TH AVE	SCOTTSDALE AZ	85251 USA	17341073
ON SIXTH LLC 7325 E SIXTH AVE	SCOTTSDALE AZ	85251 USA	17341074

MILANO INVEST 7039 E MCDONALD DR	PARADISE VAL AZ	85253 USA	17341075
MILANO INVEST 7039 E MCDONALD DR	PARADISE VAL AZ	85253 USA	17341076
HHL P SCOTTSDALE 44 HERSHA DR	HARRISBURG PA	17102 USA	17352005B
SAN MARIN APO BOX 1368	CALRSBAD CA	92018 USA	17352005C
LAAFA LLC P.O. BOX 10	SCOTTSDALE AZ	852520010 USA	17352010
LAAFA LLC P.O. BOX 10	SCOTTSDALE AZ	852520010 USA	17352011
ZIER LARRY A, 7332 E THOMAS NO 100	SCOTTSDALE AZ	85251 USA	17341077
ROSEBUD OMI 30 BURNING TREE DR	NOVATO CA	94949 USA	17341079A
BOARD FREDE 7353 E 6TH AVE	SCOTTSDALE AZ	85251 USA	17341080
FREDERICK Z 7353 E 6TH AVE	SCOTTSDALE AZ	85251 USA	17341081
BOARD FREDE 7353 E 6TH AVE	SCOTTSDALE AZ	85251 USA	17341082
EQUITY PARTN 4501 N SCOTTSDALE RD UNI	SCOTTSDALE AZ	85251 USA	17341083A
EQUITY PARTN 4501 N SCOTTSDALE RD UNI	SCOTTSDALE AZ	85251 USA	17341086A
EQUITY PARTN 4501 N SCOTTSDALE RD UNI	SCOTTSDALE AZ	85251 USA	17341087
SCOTTSDALE 18313 E HUBBELL ST	SCOTTSDALE AZ	85257 USA	17341088
JULIA PROPER 4440 N SADDLEBAG TRL	SCOTTSDALE AZ	85251 USA	17341089
JULIA PROPER 4440 N SADDLEBAG TRL	SCOTTSDALE AZ	85251 USA	17341090
HOFFMAN LEO 3500 E LINCOLN DR	PHOENIX AZ	85018 USA	17341091
HOFFMAN LEO 3500 E LINCOLN DR	PHOENIX AZ	85018 USA	17341092
GEM REALTY APO BOX 9861	SCOTTSDALE AZ	85252 USA	17341093A
GEM REALTY APO BOX 9861	SCOTTSDALE AZ	85252 USA	17341094A
GIEK THOMAS 14548 E CALEY AVE	AURORA CO	80016 USA	17341095
STETSON EST, 7903 E VIA LINDA	SCOTTSDALE AZ	85258 USA	17341096
STETSON EST, 7903 E VIA LINDA	SCOTTSDALE AZ	85258 USA	17341097
STETSON EST, 7903 E VIA LINDA	SCOTTSDALE AZ	85258 USA	17341098
LAAFA LLC P.O. BOX 10	SCOTTSDALE AZ	852520010 USA	17352016
PCMR LLC PO BOX 10	SCOTTSDALE AZ	85252 USA	17352017
PCMR LLC PO BOX 10	SCOTTSDALE AZ	85252 USA	17352018
PCMR LLC PO BOX 10	SCOTTSDALE AZ	85252 USA	17352019
PCMR LLC PO BOX 10	SCOTTSDALE AZ	85252 USA	17352020
PCMR LLC PO BOX 10	SCOTTSDALE AZ	85252 USA	17352021
PCMR LLC PO BOX 10	SCOTTSDALE AZ	85252 USA	17352022
PCMR LLC PO BOX 10	SCOTTSDALE AZ	85252 USA	17352023
LAAFA LLC P.O. BOX 10	SCOTTSDALE AZ	852520010 USA	17352024
LAAFA LLC P.O. BOX 10	SCOTTSDALE AZ	852520010 USA	17352025
LAAFA LLC P.O. BOX 10	SCOTTSDALE AZ	852520010 USA	17352026

LAFA LLC	P.O. BOX 10	SCOTTSDALE AZ	852520010 USA	17352027
LAFA LLC	P.O. BOX 10	SCOTTSDALE AZ	852520010 USA	17352028
LAFA LLC	P.O. BOX 10	SCOTTSDALE AZ	852520010 USA	17352029
LAFA LLC	P.O. BOX 10	SCOTTSDALE AZ	852520010 USA	17352030
LAFA LLC	P.O. BOX 10	SCOTTSDALE AZ	852520010 USA	17352031
LAFA LLC	P.O. BOX 10	SCOTTSDALE AZ	852520010 USA	17352032
LAFA LLC	P.O. BOX 10	SCOTTSDALE AZ	852520010 USA	17352033
LAFA LLC	P.O. BOX 10	SCOTTSDALE AZ	852520010 USA	17352034
LAFA LLC	P.O. BOX 10	SCOTTSDALE AZ	852520010 USA	17352035
CARLI FAMILY	8431 E STELLA LN	SCOTTSDALE AZ	85253 USA	17341099
LARKIN WILLI	8415 E JOSHUA TREE LN	SCOTTSDALE AZ	85250 USA	17341100
LARKIN WILLI	8415 E JOSHUA TREE LN	SCOTTSDALE AZ	85250 USA	17341101
7329 STETSOI	7340 E MAIN ST STE 200	SCOTTSDALE AZ	85251 USA	17341102
7329 STETSOI	7340 E MAIN ST STE 200	SCOTTSDALE AZ	85251 USA	17341103
7329 STETSOI	7340 E MAIN ST STE 200	SCOTTSDALE AZ	85251 USA	17341104
LVJV LLC	7324 E 6TH AVE	SCOTTSDALE AZ	85251 USA	17341107
BARISH FAMIL	PO BOX 5364	CAREFREE AZ	85377 USA	17341108
AVB DEVELOP	6991 E CAMELBACK RD STE	SCOTTSDALE AZ	85251 USA	17341109
SCOTTSDALE	7447 E INDIAN SCHOOL RD	SCOTTSDALE AZ	85251 USA	17341115
SCOTTSDALE	7447 E INDIAN SCHOOL RD	SCOTTSDALE AZ	85251 USA	17341116A
SCOTTSDALE	7447 E INDIAN SCHOOL RD	SCOTTSDALE AZ	85251 USA	17341116B
WALK THE LIN	4295 N 75TH ST	SCOTTSDALE AZ	85251 USA	17352066
GRECO JOHN	4200 N MILLER RD NO 104	SCOTTSDALE AZ	85251 USA	17352070A
ADAMS WILLI	2937 A6TH AVE	MOLINE IL	61265 USA	17352071A
TAYLOR JOAN	4200 N MILLER RD UNIT 106	SCOTTSDALE AZ	85251 USA	17352072A
RUTH H REED	10040 E HAPPY VALLEY RD L	SCOTTSDALE AZ	85255 USA	17352073A
GREGOIRE CO	4200 N MILLER RD UNIT 108	SCOTTSDALE AZ	85251 USA	17352074A
KEVIN ELEAN	4200 N MILLER RD UNIT 109	SCOTTSDALE AZ	85251 USA	17352075A
DAVID W BAU	4200 N MILLER RD NO 110	SCOTTSDALE AZ	85251 USA	17352076A
MD CLOAREC	4849 49TH ST	CAMROSE AB	T4V 1N1 CANADA	17352077A
FISHER BURTC	4200 N MILLER RD 113	SCOTTSDALE AZ	852513625 USA	17352079A
WONG CHEUN	4417 N SADDLEBAG TR	SCOTTSDALE AZ	85251 USA	17341128
PLANETA PROI	PO BOX 2118	SCOTTSDALE AZ	85252 USA	17341129
7355 E SHOEN	1210 E NORTHSHORE DR	TEMPE AZ	85283 USA	17341133
JENNIFER L J	7345 E SHOEMAN LN	SCOTTSDALE AZ	85251 USA	17341135A
EQUITY PART	4501 N SCOTTSDALE RD STE	SCOTTSDALE AZ	85251 USA	17341136

EQUITY PARTN 4501 N SCOTTSDALE RD STE	SCOTTSDALE	AZ	85251 USA	17341137
EQUITY PARTN 4501 N SCOTT STE 201	SCOTTSDALE	AZ	85251 USA	17341138
SHOEMAN LLC 7320 E SHOEMAN LN STE 20	SCOTTSDALE	AZ	852513324 USA	17341182
SHOEMAN LLC 7320 E SHOEMAN LN STE 20	SCOTTSDALE	AZ	852513324 USA	17341183
STOCKDALE G 10850 WILSHIRE BLVD STE	LOS ANGELES CA		90024 USA	17341190A
SCOTTSDALE 7447 E INDIAN SCHOOL RD	SCOTTSDALE	AZ	85251 USA	17341209
STOCKDALE G 10850 WILSHIRE BLVD STE	LOS ANGELES CA		90024 USA	17341210
SCOTTSDALE 7447 E INDIAN SCHOOL RD	SCOTTSDALE	AZ	85251 USA	17341215
EQUITY PARTN 4501 N SCOTTSDALE RD STE	SCOTTSDALE	AZ	85251 USA	17341257
EQUITY PARTN 4501 N SCOTTSDALE RD STE	SCOTTSDALE	AZ	85251 USA	17341258
LAAFA LLC P.O. BOX 10	SCOTTSDALE	AZ	852520010 USA	17352042
LAAFA LLC P.O. BOX 10	SCOTTSDALE	AZ	852520010 USA	17352046
PCMR LLC PO BOX 10	SCOTTSDALE	AZ	85252 USA	17352047
PCMR LLC PO BOX 10	SCOTTSDALE	AZ	85252 USA	17352048
PCMR LLC PO BOX 10	SCOTTSDALE	AZ	85252 USA	17352049
PCMR LLC PO BOX 10	SCOTTSDALE	AZ	85252 USA	17352050
PCMR LLC PO BOX 10	SCOTTSDALE	AZ	85252 USA	17352051
PCMR LLC PO BOX 10	SCOTTSDALE	AZ	85252 USA	17352052
LAAFA LLC P.O. BOX 10	SCOTTSDALE	AZ	852520010 USA	17352053
LAAFA LLC P.O. BOX 10	SCOTTSDALE	AZ	852520010 USA	17352054
LAAFA LLC P.O. BOX 10	SCOTTSDALE	AZ	852520010 USA	17352055
LAAFA LLC P.O. BOX 10	SCOTTSDALE	AZ	852520010 USA	17352056
LAAFA LLC P.O. BOX 10	SCOTTSDALE	AZ	852520010 USA	17352057
LAAFA LLC P.O. BOX 10	SCOTTSDALE	AZ	852520010 USA	17352058
LAAFA LLC P.O. BOX 10	SCOTTSDALE	AZ	852520010 USA	17352059
LAAFA LLC P.O. BOX 10	SCOTTSDALE	AZ	852520010 USA	17352060
LAAFA LLC P.O. BOX 10	SCOTTSDALE	AZ	852520010 USA	17352061
LAAFA LLC P.O. BOX 10	SCOTTSDALE	AZ	852520010 USA	17352062
PERNS VINCEI 4200 N MILLER RD 204	SCOTTSDALE	AZ	85251 USA	17352096
REHFELDT RU 4200 N MILLER 205	SCOTTSDALE	AZ	85251 USA	17352097
CHIARELLA PA 42-19 209TH ST	BAYSIDE	NY	113612746 USA	17352098
ALMEIDA LAMI 65 PORT ST E UNIT 304	MISSISSAUGA ON		L5G4V3 CANADA	17352099
CHERNOV ROZ 4200 N MILLER RD NO 208	SCOTTSDALE	AZ	85251 USA	17352100
PLEIN JEFFREY 4200 N MILLER RD 209	SCOTTSDALE	AZ	85251 USA	17352101
BURTON MARC 4200 N MILLER RD NO 210	SCOTTSDALE	AZ	85251 USA	17352102
TASSO FRANC 4200 N MILLER RD UNIT 211	SCOTTSDALE	AZ	85251 USA	17352103

361371 ALBEF9132 OAKMOUNT DR S W	CALGARY	AB	T2V 4X7	CANADA	17352105
ROSE WILLIAM PO BOX 5146	INCLINE VILL	NV	89450	USA	17352118
LEE CAROLYN 4200 N MILLER RD UNIT 305	SCOTTSDALE	AZ	85251	USA	17352119
RAZA ALI 4200 N MILLER RD NO 306	SCOTTSDALE	AZ	85251	USA	17352120
SHERR MIRIAM 4200 N MILLER RD 307	SCOTTSDALE	AZ	85251	USA	17352121
STEINDORFF (4200 N MILLER RD NO 308	SCOTTSDALE	AZ	85251	USA	17352122
LUTSCH ROBE 4200 N MILLER RD UNIT 309	SCOTTSDALE	AZ	852513629	USA	17352123
MITCHELL DEL 4200 N MILLER RD NO 310	SCOTTSDALE	AZ	85251	USA	17352124
OMRANIAN AL 4200 N MILLER UNIT 311	SCOTTSDALE	AZ	85251	USA	17352125
HUNN FAMILY 4200 N MILLER RD NO 313	SCOTTSDALE	AZ	85251	USA	17352127
SHELLEY RICH 7181 E CAMELBACK RD UNIT	SCOTTSDALE	CA	85251	USA	17352162
NOVAK NORM 4200 N MILLER RD UNIT 505	SCOTTSDALE	AZ	85251	USA	17352163
KRAUS GERAL 23 MARTIN CRESCENT	REGINA	SK	S4S 6L6	CANADA	17352164
WILKINSIN AL 4200 N MILLER RD UNIT 508	SCOTTSDALE	AZ	85262	USA	17352165
VICKMARK GA 4200 N MILLER RD	SCOTTSDALE	AZ	85251	USA	17352166
SARACINI MAI 4200 N MILLER RD NO 510	SCOTTSDALE	AZ	85251	USA	17352167
SOWINSKI GE 4200 N MILLER RD 511	SCOTTSDALE	AZ	85251	USA	17352168
DOWNSIDE RI 4200 N MILLER RD NO 411	SCOTTSDALE	AZ	85251	USA	17352170
KING M PECK 4200 N MILLER RD 404	SCOTTSDALE	AZ	85251	USA	17352140
BALNER ILON 4200 NORTH MILLER RD 405	SCOTTSDALE	AZ	85251	USA	17352141
CRAIL LILLIAN 4200 N MILLER RD 406	SCOTTSDALE	AZ	85251	USA	17352142
CHAMBERLIN 4200 N MILLER RD UNIT 407	SCOTTSDALE	AZ	85251	USA	17352143
CHAMBERLIN 4200 N MILLER RD NO 408	SCOTTSDALE	AZ	85252	USA	17352144
BOGARDUS CL 14625 S 25TH ST	PHOENIX	AZ	85048	USA	17352145
BITTERMAN SI 4200 N MILLER RD NO 410	SCOTTSDALE	AZ	85250	USA	17352146
CORNELISON 4200 N MILLER RD 411	SCOTTSDALE	AZ	85251	USA	17352147
HARTZ BARBA 4200 N MILLER RD	SCOTTSDALE	AZ	852510000	USA	17352149
BERGFELDT IN 4531 N 75TH WY	SCOTTSDALE	AZ	85251	USA	17341106A
SINGH RANDI 5552 W PARKVIEW LN	GLENDALE	AZ	85310	USA	17341105A
CIVIC CENTER 10040 E HAPPY VALLEY RD N	SCOTTSDALE	AZ	85255	USA	17340064B
STOCKDALE G 10850 WILSHIRE BLVD STE	LOS ANGELES	CA	90024	USA	17341023A
AVB DEVELOPI 6991 E CAMELBACK RD STE	SCOTTSDALE	AZ	85251	USA	17341110
SMITH VICKI 7302 E SIXTH AVE	SCOTTSDALE	AZ	85251	USA	17341113
STOCKDALE G 10850 WILSHIRE BLVD STE	LOS ANGELES	CA	90024	USA	17341114
NICHOLS R D 5303 E SAN MIGUEL AVE	PARADISE VAL	AZ	85253	USA	17341187D
SCOTTSDALE 7447 E INDIAN SCHOOL RD	SCOTTSDALE	AZ	85251	USA	17341214

STOCKDALE G 10850 WILSHIRE BLVD STE : LOS ANGELES CA
EQUITY PARTN 4501 N SCOTTSDALE STE 20 SCOTTSDALE AZ
EQUITY PARTN 4501 N SCOTTSDALE STE 20 SCOTTSDALE AZ
NYSBV INVES 3232 E VAN BUREN STREET PHOENIX AZ
6TH AVENUE E 7961 E VIZ BONITA SCOTTSDALE AZ

90024 USA
85251 USA
85251 USA
85008 USA
85258 USA

17341219
17341259
17341260
17341262
17341263