

Final Approved Stamped Plans
Full Size

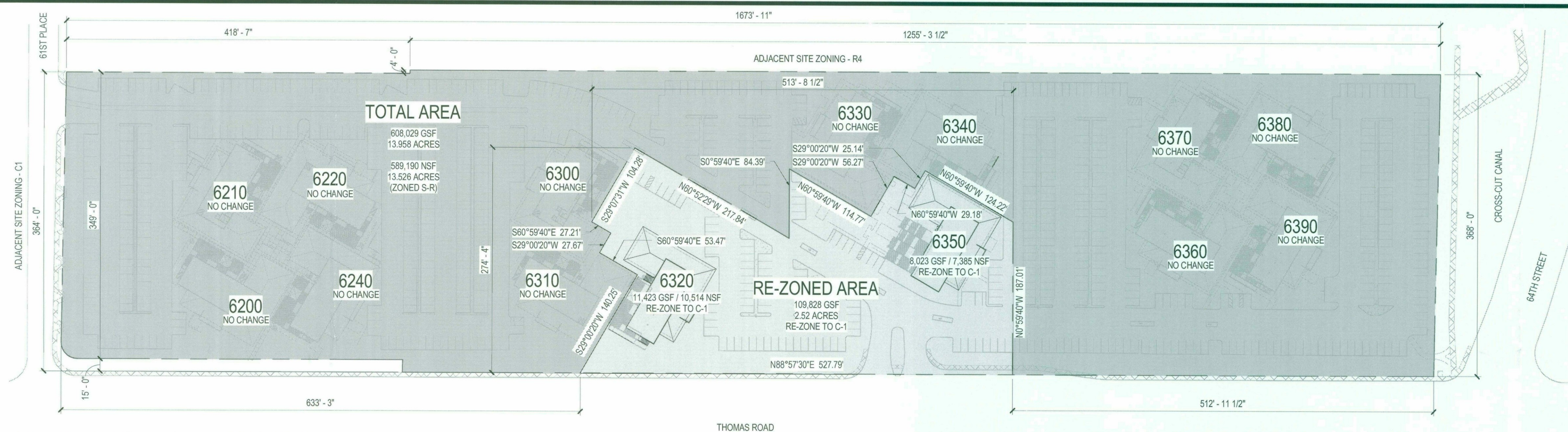

1 DIMENSIONED BOUNDARY PLAN
SCALE: 1" = 80'-0"

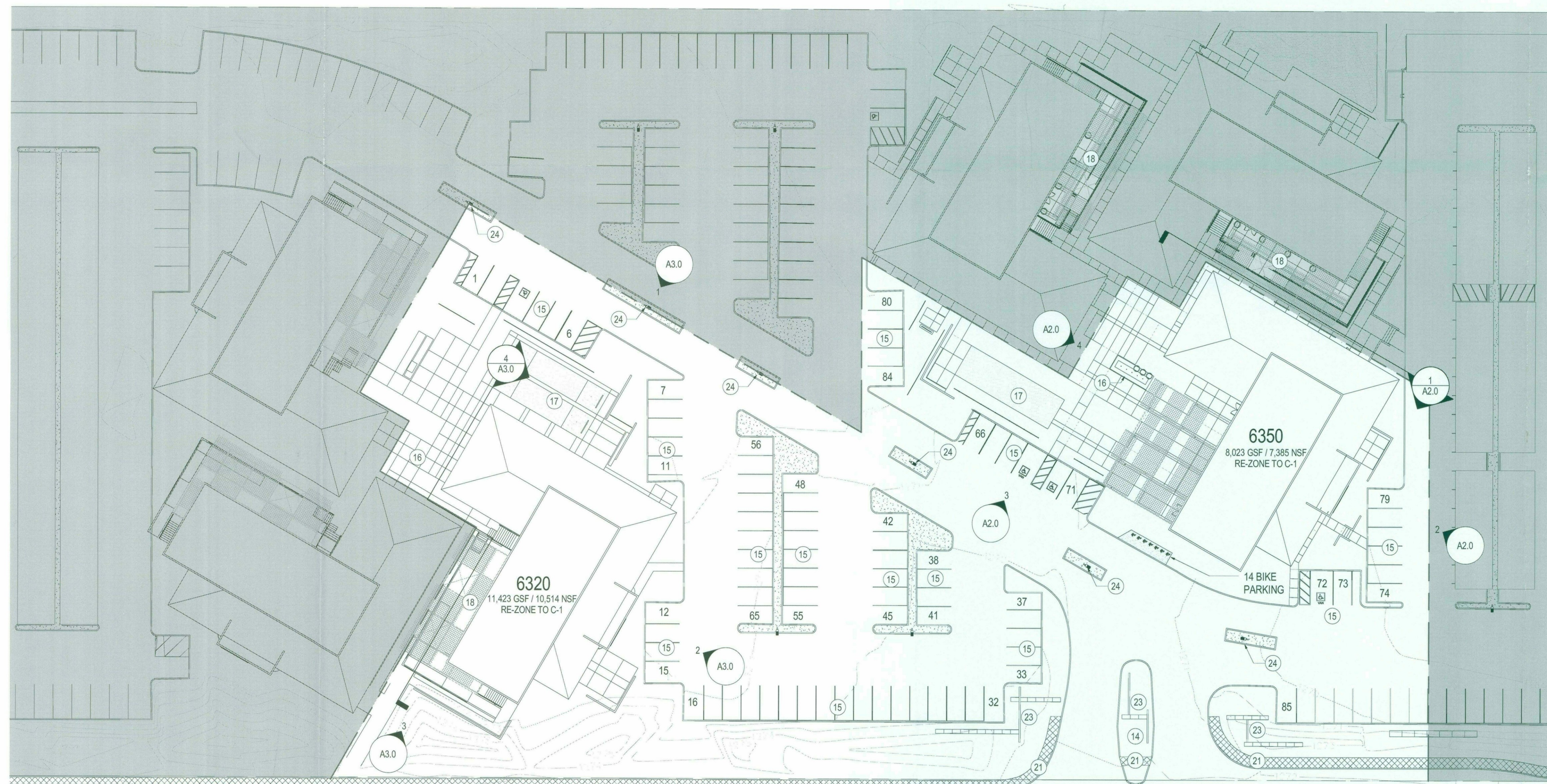

2 SITE PLAN - RE-ZONED AREA
SCALE: 1/32" = 1'-0"

GENERAL NOTES

- UNLESS OTHERWISE NOTED, PARKING AS SHOWN EXISTING AND TO REMAIN.
- ADJACENT EXISTING BUILDINGS TO REMAIN, NO CHANGE TO ZONING.
- THERE WILL BE NO CHANGES TO EXISTING OVERALL BUILDING HEIGHT OR MASS.
- NEW ARCHITECTURAL AND SITE TREATMENTS OF EXISTING BUILDINGS AND EXTERIOR IMPROVEMENTS WILL BE SUBMITTED SEPARATELY THROUGH DEVELOPMENT APPLICATION.

SHEET KEYNOTES

- EXISTING EXTERIOR WALL W/ NEW STUCCO
- NEW STOREFRONT GLAZING AND FRAMING IN EXISTING OPENING
- NEW ROOF - STANDING SEAM METAL ROOF ASSEMBLY W/ INSULATION ON EXISTING STRUCTURE
- NEW STEEL SHADE TRELLIS
- NEW GUARDRAIL SYSTEM - STEEL POST AND RAIL WITH MESH INFILL
- NEW DOOR
- EXISTING ADJACENT BUILDING, NO CHANGE TO ZONING. ARCHITECTURAL IMPROVEMENTS TO BE SUBMITTED SEPARATELY.
- EXISTING STAIR, REPAIRED AS NECESSARY
- NEW SITE WALL, FINISH TO BE DETERMINED AND APPROVED THROUGH PLANNING DEPT
- NEW DOOR SYSTEM (BASIS OF DESIGN: GARAGE DOOR)
- NEW STEEL BALCONY
- NEW STEEL STAIR
- NEW METAL ROOF TRIM
- EXISTING VEHICULAR ENTRANCE & EXISTING SIGNAGE
- PARKING TO REMAIN
- NEW WATER FEATURE
- NEW LAWN
- RECONFIGURED SUNKEN GARDEN AREA
- NEW METAL COPING TO MATCH STANDING SEAM ROOF FINISH
- EXISTING ROLLER DOOR, PAINTED TO MATCH ADJACENT STUCCO
- EXISTING SIDEWALK
- NEW WOOD ACCENT SCREEN
- NEW 30" GABION / CONCRETE SITE WALL ACCENT
- EXISTING LIGHT POLE TO BE REPLACED WITH NEW LED FIXTURE

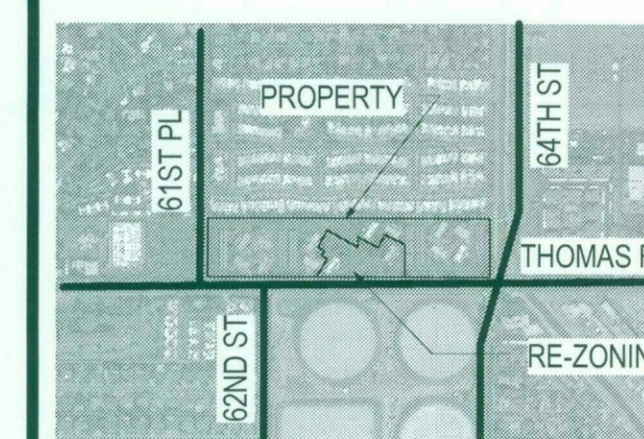

VICINITY MAP

EverWest
REAL ESTATE PARTNERS

SEV

6300 E Thomas
Scottsdale, AZ 85251

Gensler

1225 17th Street, Suite 150
Denver, CO 80202

Tel +1 303.893.7184
Fax +1 303.595.8585

Kimley Horn Associates
7740 N. 16th Street
Suite 300
Phoenix, AZ 85020
Tel 602.944.5500

PK Associates LLC
10283 Royal Eagle St.
Highlands Ranch, CO 80129
Tel 480.922.8854

Trueform Landscape
Architecture Studio
2009 North 7th Street
Phoenix, AZ 85006
Tel 480.382.4244

Energy Systems Design
7135 E. Camelback Road
Suite 275
Scottsdale, AZ 85251
Tel 480.481.4900

Date	Description
1 01.12.16	General Plan Amendment, Rezoning and Development Review
2 03.04.16	General Plan Amendment, Rezoning and Development Review Resubmittal

Seal/Signature

Project Name

SEV Scottsdale

Project Number

03.7426.000

Description

DIMENSIONED PLAN OF
BOUNDARIES AND SITE PLAN

Scale

NOT TO SCALE

A1.0

© 2015 Gensler

1-GP-2016
03/07/16