

**Simulations**  
**Records Packet**  
**Photos**  
**All Graphics (no plans)**



## Glass & Garden Community Church, The Garden Church HP Overlay Zoning

14-ZN-2012/5-HP-2012  
Planning Commission  
May 8, 2013

Coordinator: Don Meserve, AICP,  
Historic Preservation Officer

### Glass & Garden Community Church



CONTEXT AERIAL

14-ZN-2012/5-HP-2012

**Glass & Garden Community Church**  
8620 E McDonald Drive

CITY OF SCOTTSDALE

CLOSE AERIAL

14-ZN-2012/5-HP-2012

**Glass & Garden Community Church**

**CITY OF SCOTTSDALE**

**LAND USE**

**14-ZN-2012/5-HP-2012**

The map displays the proposed site for the Glass & Garden Community Church, marked with a red star and labeled "SITE". The site is located at the intersection of E Berridge Ln and N 86th St. Surrounding streets include E Rose Ln, E Keim Dr, E Valley Vista Dr, E McDonald Dr, E Palo Verde Dr, E Starlight Wy, E Solano Dr, N Granite Reef Rd, N 87th Pl, N 87th St, N 87th Ave, and N Pima Rd. The map uses various colors to indicate different land use zones: Rural (yellow), Suburban (light orange), Urban (orange), Mixed-Use (pink), and Resorts/Tourism (red). It also shows the I-17 corridor, regional use districts, commercial areas, office space, employment zones, natural open space, developed open space (parks), developed open space (golf courses), cultural/institutional or public use, McDowell Sonoran Preserve (Bas of Sonoran), recommended study boundary of the McDowell Sonoran Preserve, city boundary, and location not yet determined (star icon). A north arrow is located in the bottom right corner.



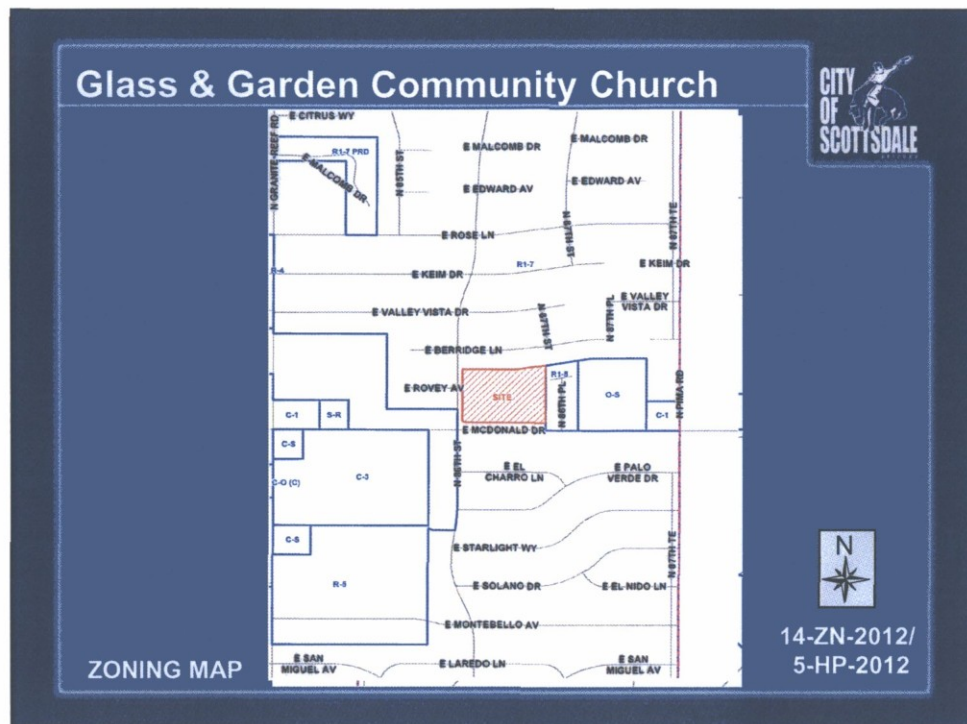

### Consistent with 2001 General Plan

#### Character and Design Element

#### Scottsdale Values...

- Protection of significant historic buildings and settings.

#### Goal 3.

- Identify Scottsdale's historic, archaeological and cultural resources, promote an awareness of them for future generations, and support their preservation and conservation.

CITY OF SCOTTSDALE



## Unique 1966 Walk-In, Drive-In Church Design



- The church was designed with a large wall of glass to the east; people could view & hear the service from their cars
- Founding Pastor Goulouze knew Rev. Schuller of Garden Grove walk-in, drive-in church

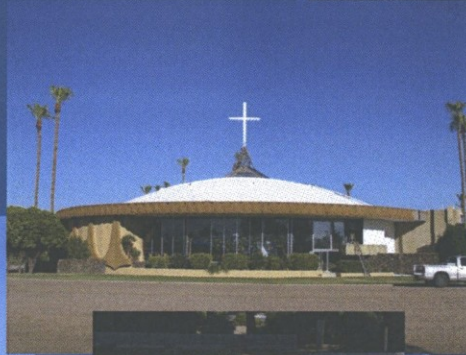

## Uncommon round plan – newer design



### International

- Felix Candela
- Oscar Niemeyer

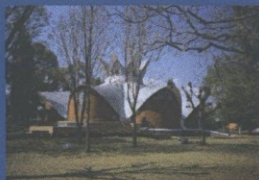

### National

- Frank Lloyd Wright  
1961 in Wisconsin



### Local

- God's Grace Church



## Large-Span Thin Shell Concrete Dome

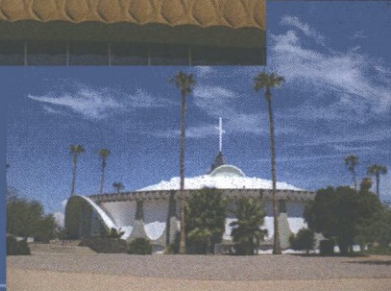
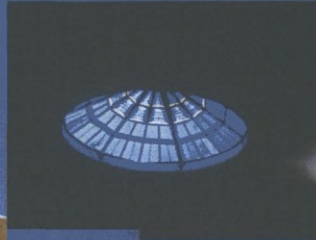
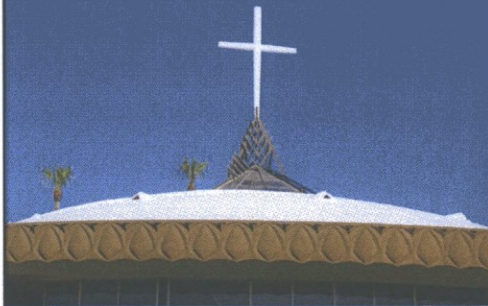

John K. Parsons,  
Engineer  
136' dome  
poured in one  
day

## Other John K. Parsons Projects



Los Arcos Methodist Church  
(Demolished in 2012)



Saint Maria Goretti  
Catholic Church



Skydome at NAU



Manzanita Hall at ASU

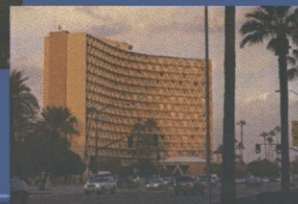



## Other architectural features



Arched entrance  
and volcanic rock  
walls

Pairs of elliptical  
columns around  
cylinder with integral  
stone aggregate;  
elliptical windows

Decorative pre-cast  
concrete trim around dome, on the  
outdoor balcony and inside

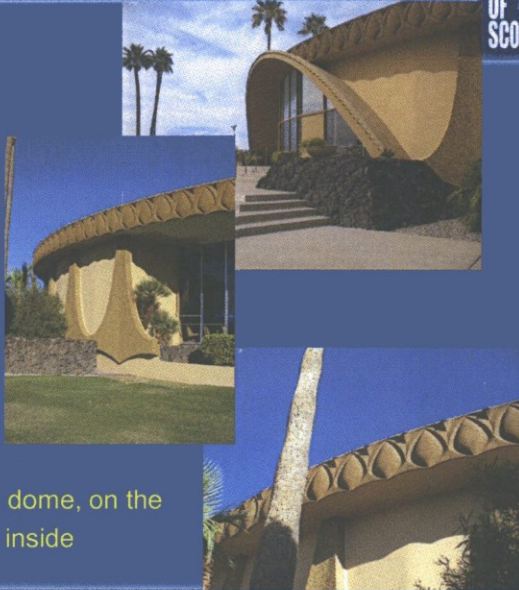

## HPC recommendation for approval



Distinctive type, period, or method of construction;  
possesses high artistic value; or work of a master  
(Criterion 6.113.A.3)

- Unique walk-in, drive-in 1966 church design and uncommon circular sanctuary layout
- Artistic design by E. Logan Campbell, Architect
- Innovative use of large-span thin shell concrete dome by John K. Parsons, Engineer
- Attractive architectural elements in stained glass skylight, metal sculpture, arched entry, decorative pre-cast concrete details and glass walls



# Zoning Map

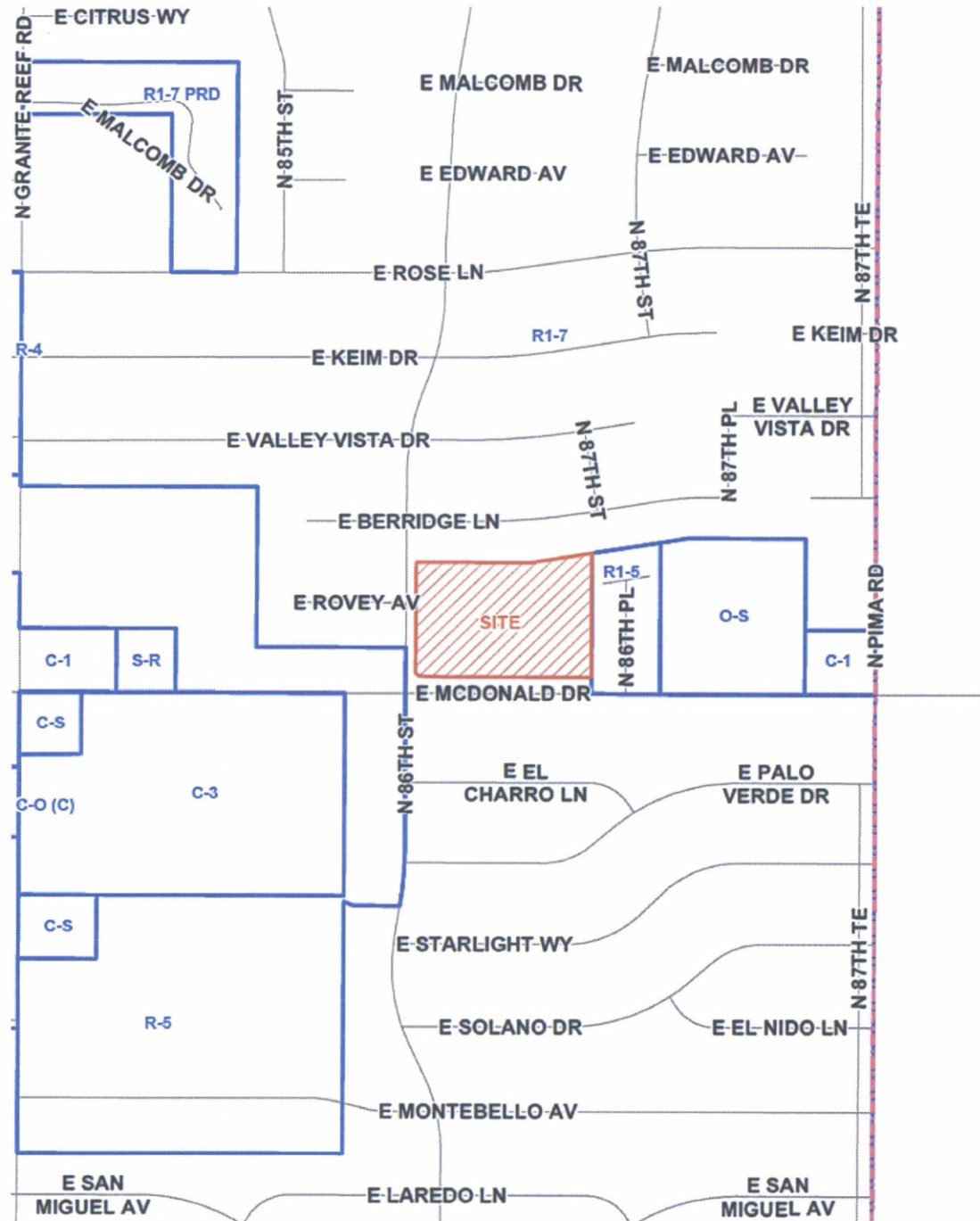

14-ZN-2012/  
5-HP-2012

ATTACHMENT #4

## Existing General Plan Land Use Map

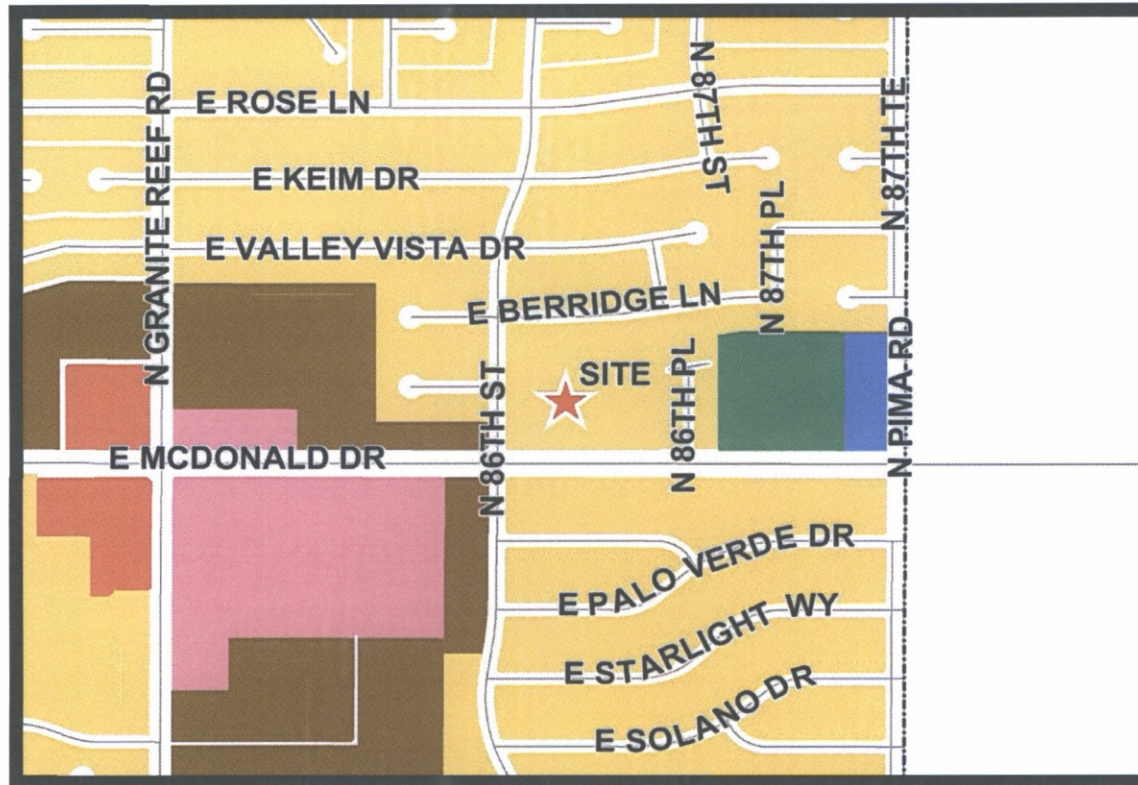

14-ZN-2012/  
5-HP-2012

ATTACHMENT #3





Glass and Garden Community Church  
Historic Preservation Overlay Zoning

14-ZN-2012/5-HP-2012

ATTACHMENT #2A



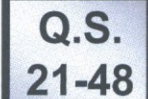

14-ZN-2012/5-HP-2012

**ATTACHMENT #2**



