

Simulations
Photos
All Graphics (no plans)

VISCONTI ON CAMELBACK

A PARCEL OF LAND LOCATED IN SECTION 23, TOWNSHIP 2 NORTH, RANGE 4 EAST OF THE GILA AND SALT RIVER MERIDIAN MARICOPA COUNTY, ARIZONA

SITE BENCHMARK INFORMATION

CITY OF SCOTTSDALE BRASS CAP FLUSH, LOCATED NEAR THE INTERSECTION OF CAMELBACK ROAD AND HAYDEN ROAD
ELEVATION = 1244.70' NAVD 88 (CITY OF SCOTTSDALE DATUM)

SCALE: 1" = 20'

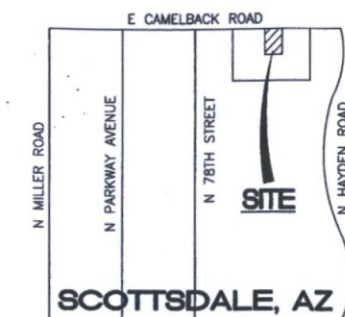

LOCATION MAP

(NOT TO SCALE)

KEYNOTES

- EXISTING PARKING LOT TO BE MODIFIED
- EXISTING SIDEWALK TO REMAIN
- EXISTING LEASING OFFICE TO REMAIN
- EXISTING 2 STORY APARTMENT BUILDING TO REMAIN
- EXISTING WALL TO REMAIN
- EXISTING CONCRETE CURB TO REMAIN
- EXISTING RETAINING WALL TO REMAIN
- EXISTING PARKING SPOTS TO REMAIN
- PROPOSED DRIVEWAY RAMP TO MEET CITY OF SCOTTSDALE STANDARDS
- PROPOSED SIGN WALL TO MEET CITY OF SCOTTSDALE STANDARDS
- PROPOSED RAISED PLANTERS
- PROPOSED CONCRETE CURB TO TIE INTO EXISTING CONCRETE CURB
- PROPOSED PROPOSED STEEL VINE SCREEN FENCE
- PROPOSED ADDITIONAL PARKING SPOTS
- PROPOSED SHADE STRUCTURE OVER PARKING SPOTS
- TURF
- TURF HEADER
- LANDSCAPE AREA

PLANT MATERIALS LEGEND			
Plant Name			
Trees			
Acacia small	36" Box	13	
Brown Acacia			
Phoenix dactyloides	20ft	4	
Date Palm	Diamond Cut		
Medium Shrubs			
Erigeron glabra spp. canosa	5 gal.	138	
Winter Blaze			
Ruellia brittaniana	5 gal.	31	
Ruellia			
Small Shrubs			
Tournefortia chamaedry	5 gal.	116	
Germanium			
Erigeron prostratus 'Outback Sunrise'	1 gal.	166	
Outback Sunrise Erigeron			
Cacti/Acacia			
Agave 'Blue Glow'	5 gal.	16	
Blue Glow Agave			
Agave striata	15 gal.	19	
Steel Agave			
Aloe barbadensis	5 Gal.	27	
Medicinal Aloe			
Bouteloua gracilis	1 gal.	117	
Bland Ambition			
Echinocereus grusoni	5 gal.	70	
Golden Bells			
Hesperaloe parviflora	5 gal.	85	
Giant Hesperaloe			
Pachycaulis marginatus	3 arm, 4' min.	3	
Mexican Fence Post			
Pedicularis microcarpa	5 gal.	42	
Slipper Plant			
Yucca pallida	5 gal.	100	
Pale Leaf Yucca			
Vines			
Bougainvillea 'San Diego Red'	5 gal.	24	
Bougainvillea			
LANDSCAPE MATERIALS			
To match existing (Size & Color)			

CIVIL ENGINEER

COLE DESIGN GROUP, INC.
2701 E. CAMELBACK ROAD, SUITE 175
PHOENIX, AZ 85016
CONTACT: TED LUTHER, P.E.
PHONE: (480) 999-4111

LANDSCAPE ARCHITECT

ANDERSONBARON
50 N. MCCLINTOCK DRIVE, SUITE 1
SAN DIEGO, CA 92101
CONTACT: BRETT ANDERSON
PHONE: (480) 699-7956

OWNER

COLORICH
444 WEST BEECH STREET SUITE 300
SAN DIEGO, CA 92101
CONTACT: MAT MOISEVE
PHONE: (858) 490-2300
EMAIL: MATM@COLORICH.COM

CITY OF SCOTTSDALE

PLANNING AND DEVELOPMENT SERVICES
7447 E. INDIAN SCHOOL ROAD, SUITE 105
CONTACT: BEN MORRIS
SCOTTSDALE, AZ 85251
PHONE: (480) 312-7000
EMAIL: BMORRIS@SCOTTSDALEAZ.GOV

SITE INFORMATION

DISTURBED AREA = 7,400 SF (0.17 ACRE)
ZONING = R-5
APN = 173-53-006A



UTILITY INFORMATION:

UTILITIES SHOWN HAVE BEEN TAKEN FROM AVAILABLE SURVEYS, UTILITY COMPANY MAPS AND PHYSICAL PROPERTY INSPECTION. THE LOCATIONS AND FACILITIES SHALL BE CONSIDERED APPROXIMATE ONLY. THERE MAY BE ADDITIONAL UTILITIES THAT HAVE NOT BEEN SHOWN ON THIS SURVEY. THE CONTRACTOR WILL BE RESPONSIBLE FOR THE LOCATIONS OF ALL UTILITIES PRIOR TO EXCAVATION OR CONSTRUCTION.

NO.	REVISION DESCRIPTION	DATE

DEVELOPER/OWNER
COLORICH
444 WEST BEECH STREET SUITE 300
SAN DIEGO, CA 92101
(858) 490-2300



VISCONTI AT CAMELBACK
DRIVEWAY IMPROVEMENTS
7879 EAST CAMELBACK ROAD
SCOTTSDALE, AZ 85251

PRELIMINARY SITE PLAN

PHOENIX
2701 E. Camelback Road
Suite 175
Phoenix, AZ 85016
602.958.4111
www.coleatl.com

COLE
CIVIL ENGINEERING / SURVEYING / PLANNING / LANDSCAPE ARCHITECTURE
Cole & Associates, Inc. is a licensed corporation of the State of Arizona. All work is performed by licensed professionals.

DESIGN/DATE BY: TBL
DRAWN BY: REM
CHECKED BY: TBL
DRAWING SCALE: 1" = 20'
DATE: 02/21/17

Job Number
16-0133

Sheet Number
C1.0