

**Simulations**  
**Photos**  
**All Graphics (no plans)**

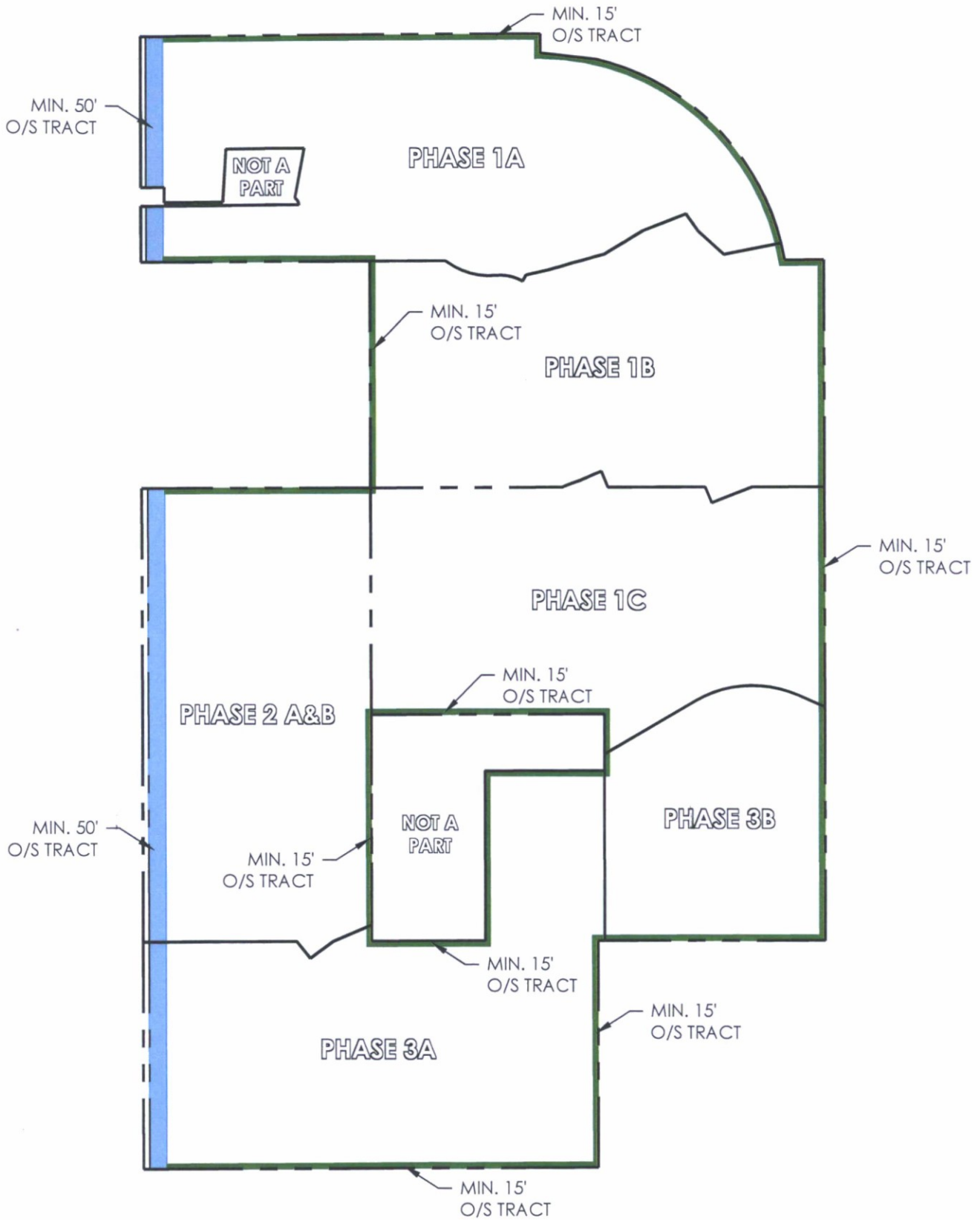

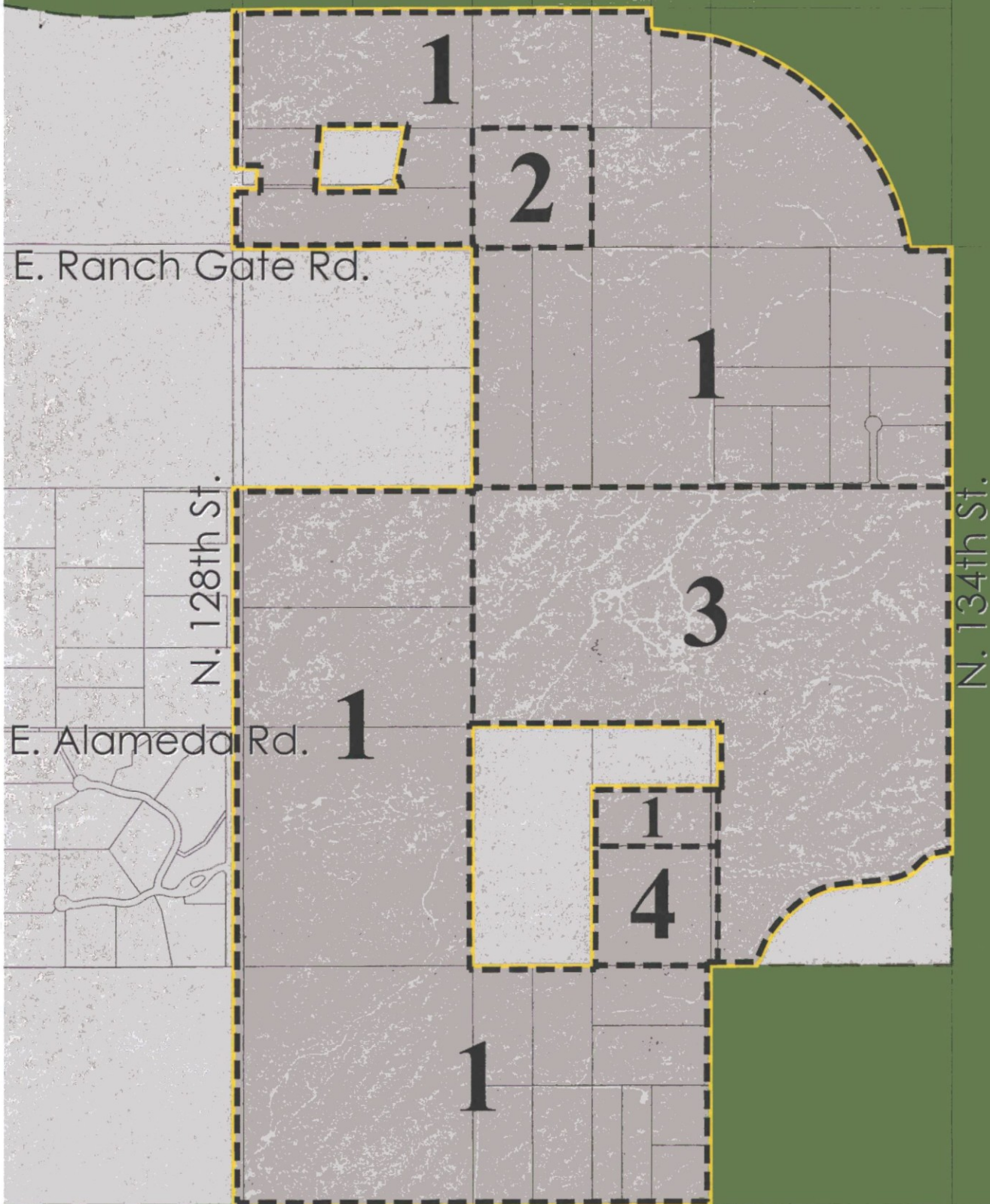

E. Ranch Gate Rd.

N. 128th St.

E. Alameda Rd.

N. 134th St.

E. Pinnacle Peak Rd. (Align.)



**STORYROCK - LAND USE/DEVELOPMENT CALCULATIONS**

| <b>1) CAV RANCH LLC</b> |                   |               |                  |               |              |            |
|-------------------------|-------------------|---------------|------------------|---------------|--------------|------------|
| Zoning                  | Approx. Sq. Ft.   |               | Total Open Space |               | % O.S.       | # of Lots  |
|                         | Sq. Ft.           | Ac.           | Sq. Ft.          | Ac.           |              |            |
| 70                      | 426,452           | 9.79          | 298,420          | 6.85          | 70%          | 2          |
| 43                      | 6,017,378         | 138.14        | 3,976,990        | 91.30         | 66.1%        | 89         |
| 35                      | 4,566,830         | 104.84        | 1,781,991        | 40.91         | 39.0%        | 105        |
| 18                      | 3,442,982         | 79.04         | 1,119,109        | 25.69         | 32.5%        | 116        |
| <b>Total</b>            | <b>14,027,191</b> | <b>331.81</b> | <b>7,176,510</b> | <b>164.75</b> | <b>49.7%</b> | <b>312</b> |

| <b>2) DITOLA</b> |                 |              |                  |             |              |           |
|------------------|-----------------|--------------|------------------|-------------|--------------|-----------|
| Zoning           | Approx. Sq. Ft. |              | Total Open Space |             | % O.S.       | # of Lots |
|                  | Sq. Ft.         | Ac.          | Sq. Ft.          | Ac.         |              |           |
| 70               | -               | -            | -                | -           | -            | -         |
| 43               | -               | -            | -                | -           | -            | -         |
| 35               | 436,471         | 10.02        | 170,755          | 3.92        | 39.1%        | 10        |
| 18               | -               | -            | -                | -           | -            | -         |
| <b>Total</b>     | <b>436,471</b>  | <b>10.02</b> | <b>170,755</b>   | <b>3.92</b> | <b>39.1%</b> | <b>10</b> |

| <b>3) CAVALLIERE FAMILY</b> |                  |               |                  |              |              |            |
|-----------------------------|------------------|---------------|------------------|--------------|--------------|------------|
| Zoning                      | Approx. Sq. Ft.  |               | Total Open Space |              | % O.S.       | # of Lots  |
|                             | Sq. Ft.          | Ac.           | Sq. Ft.          | Ac.          |              |            |
| 70                          | -                | -             | -                | -            | -            | -          |
| 43                          | 1,677,060        | 38.5          | 1,489,316        | 34.19        | 88.8%        | 25         |
| 35                          | -                | -             | -                | -            | -            | -          |
| 18                          | 3,082,474        | 70.77         | 860,310          | 19.75        | 27.9%        | 90         |
| <b>Total</b>                | <b>4,759,534</b> | <b>109.27</b> | <b>2,349,626</b> | <b>53.94</b> | <b>49.4%</b> | <b>115</b> |

| <b>4) SEWELL</b> |                 |               |                  |             |              |           |
|------------------|-----------------|---------------|------------------|-------------|--------------|-----------|
| Zoning           | Approx. Sq. Ft. |               | Total Open Space |             | % O.S.       | # of Lots |
|                  | Sq. Ft.         | Ac.           | Sq. Ft.          | Ac.         |              |           |
| 70               | -               | -             | -                | -           | -            | -         |
| 43               | 294,074         | 6.751         | 216,493          | 4.97        | 73.6%        | 4         |
| 35               | 79,366          | 1.822         | 28,750           | 0.66        | 36.2%        | 1         |
| 18               | 89,385          | 2.052         | 59,242           | 1.36        | 66.3%        | 1         |
| <b>Total</b>     | <b>462,825</b>  | <b>10.625</b> | <b>304,484</b>   | <b>6.99</b> | <b>65.8%</b> | <b>6</b>  |

| <b>STORYROCK</b> |                   |               |                   |              |              |            |
|------------------|-------------------|---------------|-------------------|--------------|--------------|------------|
| Zoning           | Approx. Sq. Ft.   |               | Total Open Space  |              | % O.S.       | # of Lots  |
|                  | Sq. Ft.           | Ac.           | Sq. Ft.           | Ac.          |              |            |
| 70               | 426,452           | 9.79          | 298,420           | 6.85         | 70%          | 2          |
| 43               | 7,988,468         | 183.39        | 5,682,800         | 130.46       | 71.1%        | 118        |
| 35               | 5,082,581         | 116.68        | 1,981,496         | 45.49        | 39.0%        | 116        |
| 18               | 6,615,457         | 151.87        | 2,038,661         | 46.80        | 30.8%        | 207        |
| <b>Total</b>     | <b>19,686,506</b> | <b>461.73</b> | <b>10,001,376</b> | <b>229.6</b> | <b>49.7%</b> | <b>443</b> |



## Native Plant Inventory

Story Rock

Phase 2A & 2B

SWC of Ranchgate Road & 128th Street

Scottsdale, AZ

12/19/2016

| Plant # | Phase | Common Name          | Caliper (in)/<br>Height (ft) | Status | Comments                        |
|---------|-------|----------------------|------------------------------|--------|---------------------------------|
| 2814    | 2A-B  | Foothills Palo Verde | 6                            | RIP    |                                 |
| 2815    | 2A-B  | Hackberry            | 24                           | NS     | Branch Dieback                  |
| 2816    | 2A-B  | Foothills Palo Verde | 20                           | RIP    | Branch Dieback / Cambium Damage |
| 2817    | 2A-B  | Foothills Palo Verde | 6                            | S      |                                 |
| 2818    | 2A-B  | Blue Palo Verde      | 7                            | NS     | Branch Dieback / Cambium Damage |
| 2819    | 2A-B  | Foothills Palo Verde | 7                            | NS     | Exposed Roots / Cambium Damage  |
| 2820    | 2A-B  | Foothills Palo Verde | 7                            | NS     | Exposed Roots / Cambium Damage  |
| 2821    | 2A-B  | Foothills Palo Verde | 5                            | S      |                                 |
| 2822    | 2A-B  | Foothills Palo Verde | 7                            | NS     | Trunk Form / Leaning            |
| 2823    | 2A-B  | Blue Palo Verde      | 7                            | NS     | Branch Dieback                  |
| 2824    | 2A-B  | Foothills Palo Verde | 8                            | S      |                                 |
| 2825    | 2A-B  | Mesquite             | 6                            | NS     | Branch Dieback                  |
| 2826    | 2A-B  | Foothills Palo Verde | 8                            | NS     | Branch Dieback                  |
| 2827    | 2A-B  | Foothills Palo Verde | 4                            | NS     | Exposed Roots / Root Growth     |
| 2828    | 2A-B  | Foothills Palo Verde | 8                            | NS     | Branch Dieback / Cambium Damage |
| 2829    | 2A-B  | Foothills Palo Verde | 10                           | S      |                                 |
| 2830    | 2A-B  | Hackberry            | 10                           | NS     | Wide Base                       |
| 2831    | 2A-B  | Foothills Palo Verde | 6                            | NS     | Trunk Form / Cambium Damage     |
| 2832    | 2A-B  | Foothills Palo Verde | 7                            | S      |                                 |
| 2833    | 2A-B  | Foothills Palo Verde | 7                            | NS     | Exposed Roots                   |
| 2834    | 2A-B  | Foothills Palo Verde | 20                           | NS     | Branch Dieback / Cambium Damage |
| 2835    | 2A-B  | Barrel               | 4                            | NS     | Damaged                         |
| 2836    | 2A-B  | Mesquite             | 8                            | NS     | Branch Dieback / Cambium Damage |
| 2837    | 2A-B  | Hackberry            | 40                           | NS     | Wide Base / Cambium Damage      |
| 2838    | 2A-B  | Mesquite             | 18                           | RIP    | Branch Dieback / Cambium Damage |
| 2839    | 2A-B  | Hackberry            | 28                           | RIP    | Wide Base / Cambium Damage      |
| 2840    | 2A-B  | Foothills Palo Verde | 12                           | NS     | Exposed Roots                   |
| 2841    | 2A-B  | Foothills Palo Verde | 18                           | NS     | Exposed Roots / Cambium Damage  |
| 2842    | 2A-B  | Foothills Palo Verde | 4                            | NS     | Diseased / Cambium Damage       |
| 2843    | 2A-B  | Foothills Palo Verde | 6                            | RIP    |                                 |
| 2844    | 2A-B  | Foothills Palo Verde | 15                           | RIP    | Branch Dieback / Cambium Damage |
| 2845    | 2A-B  | Mesquite             | 7                            | RIP    | Branch Dieback / Cambium Damage |
| 2846    | 2A-B  | Mesquite             | 9                            | RIP    | Branch Dieback / Cambium Damage |
| 2847    | 2A-B  | Mesquite             | 12                           | RIP    | Branch Dieback / Cambium Damage |
| 2848    | 2A-B  | Mesquite             | 12                           | RIP    | Branch Dieback / Cambium Damage |
| 2849    | 2A-B  | Blue Palo Verde      | 8                            | RIP    | Branch Dieback / Cambium Damage |

| Plant # | Phase | Common Name          | Caliper (in)/<br>Height (ft) | Status | Comments                        |
|---------|-------|----------------------|------------------------------|--------|---------------------------------|
| 2850    | 2A-B  | Mesquite             | 12                           | NS     | Branch Dieback / Cambium Damage |
| 2851    | 2A-B  | Mesquite             | 12                           | NS     | Branch Dieback / Cambium Damage |
| 2852    | 2A-B  | Blue Palo Verde      | 8                            | NS     | Branch Dieback / Cambium Damage |
| 2853    | 2A-B  | Foothills Palo Verde | 5                            | NS     | In Wash                         |
| 2854    | 2A-B  | Foothills Palo Verde | 5                            | RIP    |                                 |
| 2855    | 2A-B  | Blue Palo Verde      | 14                           | RIP    | Branch Dieback                  |
| 2856    | 2A-B  | Foothills Palo Verde | 20                           | NS     | Branch Dieback                  |
| 2857    | 2A-B  | Foothills Palo Verde | 7                            | NS     | Exposed Roots                   |
| 2858    | 2A-B  | Hackberry            | 60                           | NS     | Wide Base                       |
| 2859    | 2A-B  | Mesquite             | 4                            | S      |                                 |
| 2860    | 2A-B  | Hackberry            | 60                           | NS     | Wide Base                       |
| 2861    | 2A-B  | Blue Palo Verde      | 4                            | NS     | Branch Dieback / Cambium Damage |
| 2862    | 2A-B  | Mesquite             | 24                           | NS     | Branch Dieback / Cambium Damage |
| 2863    | 2A-B  | Foothills Palo Verde | 7                            | NS     | Trunk Form / Cambium Damage     |
| 2864    | 2A-B  | Foothills Palo Verde | 5                            | S      |                                 |
| 2865    | 2A-B  | Foothills Palo Verde | 10                           | RIP    | Exposed Roots / Cambium Damage  |
| 2866    | 2A-B  | Blue Palo Verde      | 8                            | RIP    |                                 |
| 2867    | 2A-B  | Foothills Palo Verde | 8                            | NS     | Trunk Form / Root Growth        |
| 2868    | 2A-B  | Foothills Palo Verde | 6                            | NS     | Exposed Roots / Root Growth     |
| 2869    | 2A-B  | Foothills Palo Verde | 4                            | NS     | Trunk Form / Root Growth        |
| 2870    | 2A-B  | Foothills Palo Verde | 12                           | NS     | In Rocks                        |
| 2871    | 2A-B  | Mesquite             | 7                            | S      |                                 |
| 2872    | 2A-B  | Foothills Palo Verde | 8                            | S      |                                 |
| 2873    | 2A-B  | Mesquite             | 4                            | NS     | Branch Dieback                  |
| 2874    | 2A-B  | Foothills Palo Verde | 4                            | S      |                                 |
| 2875    | 2A-B  | Foothills Palo Verde | 5                            | S      |                                 |
| 2876    | 2A-B  | Foothills Palo Verde | 5                            | S      |                                 |
| 2877    | 2A-B  | Blue Palo Verde      | 12                           | NS     | Trunk Form / Cambium Damage     |
| 2878    | 2A-B  | Mesquite             | 14                           | NS     | Branch Dieback / Cambium Damage |
| 2879    | 2A-B  | Mesquite             | 4                            | NS     | Branch Dieback / Cambium Damage |
| 2880    | 2A-B  | Foothills Palo Verde | 10                           | NS     | Branch Dieback / Cambium Damage |
| 2881    | 2A-B  | Mesquite             | 7                            | S      |                                 |
| 2882    | 2A-B  | Saguaro              | 16                           | S      |                                 |
| 2883    | 2A-B  | Mesquite             | 30                           | RIP    | Branch Dieback / Cambium Damage |
| 2884    | 2A-B  | Mesquite             | 12                           | RIP    | Branch Dieback / Cambium Damage |
| 2885    | 2A-B  | Barrel               | 4                            | S      |                                 |
| 2886    | 2A-B  | Foothills Palo Verde | 7                            | NS     | Exposed Roots / In Wash         |
| 2887    | 2A-B  | Foothills Palo Verde | 16                           | NS     | Branch Dieback / Cambium Damage |
| 2888    | 2A-B  | Foothills Palo Verde | 4                            | RIP    | In Wash / Leaning               |
| 2889    | 2A-B  | Foothills Palo Verde | 7                            | S      |                                 |
| 2890    | 2A-B  | Foothills Palo Verde | 4                            | S      |                                 |
| 2891    | 2A-B  | Foothills Palo Verde | 4                            | RIP    | Exposed Roots                   |
| 2892    | 2A-B  | Foothills Palo Verde | 20                           | NS     | Exposed Roots / Cambium Damage  |
| 2893    | 2A-B  | Foothills Palo Verde | 12                           | NS     | Branch Dieback / Cambium Damage |
| 2894    | 2A-B  | Foothills Palo Verde | 8                            | NS     | Trunk Form / Cambium Damage     |
| 2895    | 2A-B  | Barrel               | 3                            | S      |                                 |
| 2896    | 2A-B  | Foothills Palo Verde | 10                           | NS     | Branch Dieback / Cambium Damage |
| 2897    | 2A-B  | Foothills Palo Verde | 7                            | NS     | Exposed Roots                   |
| 2898    | 2A-B  | Hackberry            | 60                           | NS     | Wide Base                       |



| Plant # | Phase | Common Name          | Caliper (in)/<br>Height (ft) | Status | Comments                        |
|---------|-------|----------------------|------------------------------|--------|---------------------------------|
| 2899    | 2A-B  | Foothills Palo Verde | 24                           | NS     | Branch Dieback / Cambium Damage |
| 2900    | 2A-B  | Whitethorn Acacia    | 7                            | S      |                                 |
| 2901    | 2A-B  | Whitethorn Acacia    | 12                           | NS     | Branch Dieback / Cambium Damage |
| 2902    | 2A-B  | Foothills Palo Verde | 14                           | RIP    | Exposed Roots / Cambium Damage  |
| 2903    | 2A-B  | Blue Palo Verde      | 8                            | NS     | Branch Dieback / Cambium Damage |
| 2904    | 2A-B  | Whitethorn Acacia    | 8                            | NS     | Branch Dieback / Cambium Damage |
| 2905    | 2A-B  | Mesquite             | 4                            | S      |                                 |
| 2906    | 2A-B  | Foothills Palo Verde | 10                           | NS     | Branch Dieback / Cambium Damage |
| 2907    | 2A-B  | Foothills Palo Verde | 14                           | NS     | Branch Dieback / Cambium Damage |
| 2908    | 2A-B  | Foothills Palo Verde | 10                           | RIP    | Exposed Roots / Root Growth     |
| 2909    | 2A-B  | Foothills Palo Verde | 7                            | S      |                                 |
| 2910    | 2A-B  | Foothills Palo Verde | 7                            | NS     | Branch Dieback / Cambium Damage |
| 2911    | 2A-B  | Foothills Palo Verde | 10                           | RIP    | Branch Dieback / Cambium Damage |
| 2912    | 2A-B  | Foothills Palo Verde | 6                            | RIP    |                                 |
| 2913    | 2A-B  | Foothills Palo Verde | 6                            | NS     | In Rocks                        |
| 2914    | 2A-B  | Foothills Palo Verde | 4                            | NS     | Branch Dieback / Cambium Damage |
| 2915    | 2A-B  | Foothills Palo Verde | 20                           | RIP    | Branch Dieback / Cambium Damage |
| 2916    | 2A-B  | Foothills Palo Verde | 18                           | RIP    | Branch Dieback / Cambium Damage |
| 2917    | 2A-B  | Foothills Palo Verde | 14                           | RIP    |                                 |
| 2918    | 2A-B  | Foothills Palo Verde | 12                           | RIP    | Branch Dieback / Cambium Damage |
| 2919    | 2A-B  | Foothills Palo Verde | 20                           | RIP    | Branch Dieback / Cambium Damage |
| 2920    | 2A-B  | Foothills Palo Verde | 16                           | RIP    | Trunk Form / Root Growth        |
| 2921    | 2A-B  | Foothills Palo Verde | 6                            | RIP    | Trunk Form / Root Growth        |
| 2922    | 2A-B  | Foothills Palo Verde | 8                            | NS     | Trunk Form / Leaning            |
| 2923    | 2A-B  | Foothills Palo Verde | 20                           | NS     | Branch Dieback / Cambium Damage |
| 2924    | 2A-B  | Mesquite             | 12                           | NS     | Branch Dieback / Cambium Damage |
| 2925    | 2A-B  | Foothills Palo Verde | 20                           | NS     | Branch Dieback / Cambium Damage |
| 2926    | 2A-B  | Foothills Palo Verde | 12                           | NS     | Branch Dieback / Cambium Damage |
| 2927    | 2A-B  | Foothills Palo Verde | 24                           | NS     | Branch Dieback / Cambium Damage |
| 2928    | 2A-B  | Foothills Palo Verde | 24                           | NS     | Branch Dieback / Cambium Damage |
| 2929    | 2A-B  | Mesquite             | 12                           | NS     | Branch Dieback / Cambium Damage |
| 2930    | 2A-B  | Foothills Palo Verde | 8                            | NS     | Branch Dieback / Cambium Damage |
| 2931    | 2A-B  | Foothills Palo Verde | 8                            | NS     | Branch Dieback / Cambium Damage |
| 2932    | 2A-B  | Foothills Palo Verde | 30                           | NS     | Exposed Roots / Cluster         |
| 2933    | 2A-B  | Foothills Palo Verde | 16                           | NS     | Branch Dieback / Cambium Damage |
| 2934    | 2A-B  | Foothills Palo Verde | 8                            | NS     | Branch Dieback / Cambium Damage |
| 2935    | 2A-B  | Foothills Palo Verde | 8                            | NS     | Exposed Roots / Cambium Damage  |
| 2936    | 2A-B  | Foothills Palo Verde | 6                            | RIP    | Exposed Roots / Root Growth     |
| 2937    | 2A-B  | Foothills Palo Verde | 6                            | NS     | In Wash / Root Growth           |
| 2938    | 2A-B  | Mesquite             | 10                           | NS     | Branch Dieback / Cambium Damage |
| 2939    | 2A-B  | Mesquite             | 18                           | NS     | Branch Dieback / Cambium Damage |
| 2940    | 2A-B  | Foothills Palo Verde | 22                           | NS     | Branch Dieback / Cambium Damage |
| 2941    | 2A-B  | Foothills Palo Verde | 5                            | NS     | Trunk Form / Cambium Damage     |
| 2942    | 2A-B  | Foothills Palo Verde | 12                           | NS     | Branch Dieback / Cambium Damage |
| 2943    | 2A-B  | Mesquite             | 8                            | NS     | Leaning / Cambium Damage        |
| 2944    | 2A-B  | Foothills Palo Verde | 7                            | NS     | Trunk Form / Leaning            |
| 2945    | 2A-B  | Foothills Palo Verde | 20                           | NS     | Exposed Roots / Cambium Damage  |
| 2946    | 2A-B  | Foothills Palo Verde | 18                           | NS     | Branch Dieback / Cambium Damage |
| 2947    | 2A-B  | Barrel               | 6                            | NS     | Damaged                         |

| Plant # | Phase | Common Name          | Caliper (in)/<br>Height (ft) | Status | Comments                        |
|---------|-------|----------------------|------------------------------|--------|---------------------------------|
| 2948    | 2A-B  | Mesquite             | 30                           | NS     | Branch Dieback / Cambium Damage |
| 2949    | 2A-B  | Foothills Palo Verde | 14                           | RIP    | Trunk Form / Root Growth        |
| 2950    | 2A-B  | Mesquite             | 14                           | RIP    | Branch Dieback / Cambium Damage |
| 2951    | 2A-B  | Foothills Palo Verde | 6                            | NS     | Exposed Roots / Root Growth     |
| 2952    | 2A-B  | Foothills Palo Verde | 10                           | NS     | Branch Dieback / Cambium Damage |
| 2953    | 2A-B  | Foothills Palo Verde | 6                            | NS     | Branch Dieback / Cambium Damage |
| 2954    | 2A-B  | Foothills Palo Verde | 6                            | NS     | In Rocks / Cambium Damage       |
| 2955    | 2A-B  | Blue Palo Verde      | 8                            | RIP    | In Rocks / Cambium Damage       |
| 2956    | 2A-B  | Foothills Palo Verde | 8                            | NS     | Branch Dieback / Cambium Damage |
| 2957    | 2A-B  | Foothills Palo Verde | 8                            | RIP    | Trunk Form / Root Growth        |
| 2958    | 2A-B  | Foothills Palo Verde | 14                           | RIP    | Branch Dieback / Cambium Damage |
| 2959    | 2A-B  | Foothills Palo Verde | 10                           | RIP    | In Rocks / Cambium Damage       |
| 2960    | 2A-B  | Foothills Palo Verde | 5                            | RIP    | In Rocks / Root Growth          |
| 2961    | 2A-B  | Foothills Palo Verde | 5                            | RIP    | In Rocks / Cambium Damage       |
| 2962    | 2A-B  | Foothills Palo Verde | 20                           | NS     | Branch Dieback / Cambium Damage |
| 2963    | 2A-B  | Foothills Palo Verde | 8                            | RIP    | Branch Dieback / Cambium Damage |
| 2964    | 2A-B  | Foothills Palo Verde | 8                            | RIP    | Branch Dieback / Cambium Damage |
| 2965    | 2A-B  | Foothills Palo Verde | 12                           | RIP    | Branch Dieback / Cambium Damage |
| 2966    | 2A-B  | Foothills Palo Verde | 8                            | RIP    | Branch Dieback / Cambium Damage |
| 2967    | 2A-B  | Foothills Palo Verde | 10                           | RIP    | Branch Dieback / Cambium Damage |
| 2968    | 2A-B  | Barrel               | 4                            | RIP    |                                 |
| 2969    | 2A-B  | Foothills Palo Verde | 8                            | NS     | Branch Dieback / Cambium Damage |
| 2970    | 2A-B  | Foothills Palo Verde | 14                           | RIP    | Branch Dieback / Cambium Damage |
| 2971    | 2A-B  | Foothills Palo Verde | 10                           | RIP    | Branch Dieback / Cambium Damage |
| 2972    | 2A-B  | Foothills Palo Verde | 14                           | RIP    | Branch Dieback / Cambium Damage |
| 2973    | 2A-B  | Foothills Palo Verde | 7                            | RIP    | In Rocks / Cambium Damage       |
| 2974    | 2A-B  | Foothills Palo Verde | 8                            | RIP    | In Rocks / Cambium Damage       |
| 2975    | 2A-B  | Foothills Palo Verde | 6                            | RIP    | Branch Dieback / Cambium Damage |
| 2976    | 2A-B  | Foothills Palo Verde | 8                            | RIP    | Branch Dieback / Cambium Damage |
| 2977    | 2A-B  | Foothills Palo Verde | 10                           | RIP    | In Rocks / Cambium Damage       |
| 2978    | 2A-B  | Foothills Palo Verde | 7                            | RIP    | Trunk Form / Root Growth        |
| 2979    | 2A-B  | Foothills Palo Verde | 6                            | RIP    | Branch Dieback / Cambium Damage |
| 2980    | 2A-B  | Saguaro              | 24                           | RIP    | 4 arms                          |
| 2981    | 2A-B  | Foothills Palo Verde | 8                            | RIP    | Branch Dieback / Cambium Damage |
| 2982    | 2A-B  | Foothills Palo Verde | 6                            | RIP    | Branch Dieback / Cambium Damage |
| 2983    | 2A-B  | Foothills Palo Verde | 5                            | RIP    | Branch Dieback / Cambium Damage |
| 2984    | 2A-B  | Foothills Palo Verde | 5                            | RIP    | Branch Dieback / Cambium Damage |
| 2985    | 2A-B  | Foothills Palo Verde | 12                           | RIP    | Branch Dieback / Cambium Damage |
| 2986    | 2A-B  | Foothills Palo Verde | 5                            | RIP    | Branch Dieback / Cambium Damage |
| 2987    | 2A-B  | Foothills Palo Verde | 5                            | RIP    | Branch Dieback / Cambium Damage |
| 2988    | 2A-B  | Foothills Palo Verde | 6                            | RIP    | Branch Dieback / Cambium Damage |
| 2989    | 2A-B  | Foothills Palo Verde | 7                            | RIP    | Exposed Roots / Cambium Damage  |
| 2990    | 2A-B  | Foothills Palo Verde | 5                            | RIP    | Exposed Roots / Cambium Damage  |
| 2991    | 2A-B  | Foothills Palo Verde | 10                           | RIP    | Branch Dieback / Cambium Damage |
| 2992    | 2A-B  | Foothills Palo Verde | 8                            | RIP    | Exposed Roots / Cambium Damage  |
| 2993    | 2A-B  | Foothills Palo Verde | 10                           | RIP    | Exposed Roots / Cambium Damage  |
| 2994    | 2A-B  | Foothills Palo Verde | 16                           | RIP    | Branch Dieback / Cambium Damage |
| 2995    | 2A-B  | Foothills Palo Verde | 6                            | RIP    | Branch Dieback / Cambium Damage |
| 2996    | 2A-B  | Foothills Palo Verde | 5                            | RIP    | Branch Dieback / Cambium Damage |



| Plant # | Phase | Common Name          | Caliper (in)/<br>Height (ft) | Status | Comments                        |
|---------|-------|----------------------|------------------------------|--------|---------------------------------|
| 2997    | 2A-B  | Foothills Palo Verde | 8                            | RIP    | Branch Dieback / Cambium Damage |
| 2998    | 2A-B  | Foothills Palo Verde | 12                           | NS     | Branch Dieback / Cambium Damage |
| 2999    | 2A-B  | Foothills Palo Verde | 6                            | NS     | Exposed Roots / Root Growth     |
| 3000    | 2A-B  | Mesquite             | 18                           | NS     | Branch Dieback / Cambium Damage |
| 3001    | 2A-B  | Foothills Palo Verde | 14                           | NS     | Branch Dieback / Cambium Damage |
| 3002    | 2A-B  | Foothills Palo Verde | 8                            | NS     | Branch Dieback / Cambium Damage |
| 3003    | 2A-B  | Foothills Palo Verde | 14                           | NS     | Branch Dieback / Cambium Damage |
| 3004    | 2A-B  | Foothills Palo Verde | 6                            | RIP    | Trunk Form / Root Growth        |
| 3005    | 2A-B  | Foothills Palo Verde | 6                            | RIP    | Exposed Roots / Root Growth     |
| 3006    | 2A-B  | Foothills Palo Verde | 5                            | RIP    | In Wash / Root Growth           |
| 3007    | 2A-B  | Foothills Palo Verde | 6                            | NS     | In Wash / Root Growth           |
| 3008    | 2A-B  | Foothills Palo Verde | 20                           | NS     | Branch Dieback / Cambium Damage |
| 3009    | 2A-B  | Foothills Palo Verde | 6                            | NS     | Branch Dieback / Cambium Damage |
| 3010    | 2A-B  | Foothills Palo Verde | 24                           | NS     | Branch Dieback / Cambium Damage |
| 3011    | 2A-B  | Foothills Palo Verde | 5                            | S      |                                 |
| 3012    | 2A-B  | Foothills Palo Verde | 16                           | NS     | Exposed Roots / Cambium Damage  |
| 3013    | 2A-B  | Foothills Palo Verde | 6                            | NS     | Trunk Form / Root Growth        |
| 3014    | 2A-B  | Blue Palo Verde      | 12                           | NS     | In Rocks                        |
| 3015    | 2A-B  | Foothills Palo Verde | 5                            | NS     | Branch Dieback / Cambium Damage |
| 3016    | 2A-B  | Foothills Palo Verde | 6                            | RIP    | In Rocks                        |
| 3017    | 2A-B  | Mesquite             | 4                            | RIP    | In Rocks                        |
| 3018    | 2A-B  | Saguaro              | 25                           | RIP    | 2 arms / Fire Damage            |
| 3019    | 2A-B  | Foothills Palo Verde | 5                            | S      |                                 |
| 3020    | 2A-B  | Hackberry            | 40                           | NS     | Wide Base                       |
| 3021    | 2A-B  | Hackberry            | 30                           | NS     | Wide Base                       |
| 3022    | 2A-B  | Blue Palo Verde      | 8                            | NS     | Trunk Form / Leaning            |
| 3023    | 2A-B  | Foothills Palo Verde | 5                            | RIP    |                                 |
| 3024    | 2A-B  | Foothills Palo Verde | 5                            | RIP    |                                 |
| 3025    | 2A-B  | Hackberry            | 20                           | RIP    | Branch Dieback / Cambium Damage |
| 3026    | 2A-B  | Foothills Palo Verde | 30                           | NS     | Exposed Roots / Root Growth     |
| 3027    | 2A-B  | Mesquite             | 10                           | RIP    | Branch Dieback / Cambium Damage |
| 3028    | 2A-B  | Foothills Palo Verde | 8                            | RIP    | Trunk Form / Leaning            |
| 3029    | 2A-B  | Foothills Palo Verde | 18                           | RIP    | Branch Dieback / Cambium Damage |
| 3030    | 2A-B  | Blue Palo Verde      | 14                           | RIP    | Branch Dieback / Cambium Damage |
| 3031    | 2A-B  | Mesquite             | 7                            | RIP    | Branch Dieback / Cambium Damage |
| 3032    | 2A-B  | Blue Palo Verde      | 6                            | RIP    | Branch Dieback / Cambium Damage |
| 3033    | 2A-B  | Foothills Palo Verde | 5                            | RIP    | Branch Dieback / Cambium Damage |
| 3034    | 2A-B  | Foothills Palo Verde | 22                           | NS     | Branch Dieback / Cambium Damage |
| 3035    | 2A-B  | Foothills Palo Verde | 18                           | NS     | Branch Dieback / Cambium Damage |
| 3036    | 2A-B  | Foothills Palo Verde | 6                            | NS     | Trunk Form / Root Growth        |
| 3037    | 2A-B  | Foothills Palo Verde | 6                            | NS     | Trunk Form / Root Growth        |
| 3038    | 2A-B  | Foothills Palo Verde | 10                           | NS     | Branch Dieback / Cambium Damage |
| 3039    | 2A-B  | Foothills Palo Verde | 20                           | NS     | Mistletoe / Cambium Damage      |
| 3040    | 2A-B  | Foothills Palo Verde | 12                           | NS     | Branch Dieback / Cambium Damage |
| 3041    | 2A-B  | Foothills Palo Verde | 6                            | NS     | Exposed Roots / Cambium Damage  |
| 3042    | 2A-B  | Foothills Palo Verde | 18                           | NS     | Branch Dieback / Cambium Damage |
| 3043    | 2A-B  | Barrel               | 4                            | S      |                                 |
| 3044    | 2A-B  | Foothills Palo Verde | 7                            | S      |                                 |
| 3045    | 2A-B  | Foothills Palo Verde | 5                            | RIP    | Trunk Form / Cambium Damage     |

| Plant # | Phase | Common Name          | Caliper (in)/<br>Height (ft) | Status | Comments                        |
|---------|-------|----------------------|------------------------------|--------|---------------------------------|
| 3046    | 2A-B  | Foothills Palo Verde | 5                            | RIP    |                                 |
| 3047    | 2A-B  | Blue Palo Verde      | 5                            | RIP    | Branch Dieback                  |
| 3048    | 2A-B  | Blue Palo Verde      | 6                            | NS     | Branch Dieback                  |
| 3049    | 2A-B  | Blue Palo Verde      | 6                            | NS     | Branch Dieback / Cambium Damage |
| 3050    | 2A-B  | Mesquite             | 16                           | NS     | Branch Dieback / Cambium Damage |
| 3051    | 2A-B  | Foothills Palo Verde | 12                           | NS     | Branch Dieback / Cambium Damage |
| 3052    | 2A-B  | Blue Palo Verde      | 8                            | NS     | Branch Dieback / Cambium Damage |
| 3053    | 2A-B  | Foothills Palo Verde | 14                           | NS     | Branch Dieback / Cambium Damage |
| 3054    | 2A-B  | Foothills Palo Verde | 16                           | RIP    | Branch Dieback / Cambium Damage |
| 3055    | 2A-B  | Mesquite             | 20                           | NS     | Branch Dieback / Cambium Damage |
| 3056    | 2A-B  | Hackberry            | 16                           | NS     | Wide Base                       |
| 3057    | 2A-B  | Foothills Palo Verde | 5                            | NS     | Branch Dieback / Cambium Damage |
| 3058    | 2A-B  | Foothills Palo Verde | 22                           | NS     | Branch Dieback / Cambium Damage |
| 3059    | 2A-B  | Foothills Palo Verde | 16                           | RIP    | Branch Dieback / Cambium Damage |
| 3060    | 2A-B  | Foothills Palo Verde | 12                           | RIP    | Mistletoe / Cambium Damage      |
| 3061    | 2A-B  | Foothills Palo Verde | 16                           | RIP    | Branch Dieback / Cambium Damage |
| 3062    | 2A-B  | Foothills Palo Verde | 20                           | RIP    | Exposed Roots / Cambium Damage  |
| 3063    | 2A-B  | Foothills Palo Verde | 5                            | RIP    |                                 |
| 3064    | 2A-B  | Saguaro              | 8                            | RIP    |                                 |
| 3065    | 2A-B  | Foothills Palo Verde | 4                            | RIP    | In Wash / Leaning               |
| 3066    | 2A-B  | Foothills Palo Verde | 7                            | RIP    |                                 |
| 3067    | 2A-B  | Foothills Palo Verde | 7                            | RIP    | In Wash / Leaning               |
| 3068    | 2A-B  | Foothills Palo Verde | 24                           | RIP    | Branch Dieback / Cambium Damage |
| 3069    | 2A-B  | Mesquite             | 16                           | RIP    | Branch Dieback / Cambium Damage |
| 3070    | 2A-B  | Foothills Palo Verde | 16                           | NS     | Branch Dieback / Cambium Damage |
| 3071    | 2A-B  | Foothills Palo Verde | 8                            | S      |                                 |
| 3072    | 2A-B  | Foothills Palo Verde | 10                           | NS     | Branch Dieback / Cambium Damage |
| 3073    | 2A-B  | Barrel               | 5                            | RIP    | Damaged                         |
| 3074    | 2A-B  | Foothills Palo Verde | 4                            | RIP    |                                 |
| 3075    | 2A-B  | Foothills Palo Verde | 5                            | RIP    | Trunk Form / Root Growth        |
| 3076    | 2A-B  | Hackberry            | 60                           | RIP    | Wide Base                       |
| 3077    | 2A-B  | Hackberry            | 60                           | RIP    | Wide Base                       |
| 3078    | 2A-B  | Hackberry            | 40                           | RIP    | Wide Base                       |
| 3079    | 2A-B  | Foothills Palo Verde | 14                           | RIP    | Exposed Roots / Cambium Damage  |
| 3080    | 2A-B  | Foothills Palo Verde | 10                           | RIP    | Exposed Roots / Cambium Damage  |
| 3081    | 2A-B  | Foothills Palo Verde | 10                           | RIP    | Exposed Roots / Cambium Damage  |
| 3082    | 2A-B  | Barrel               | 3                            | RIP    |                                 |
| 3083    | 2A-B  | Foothills Palo Verde | 16                           | NS     | Branch Dieback / Cambium Damage |
| 3084    | 2A-B  | Foothills Palo Verde | 7                            | NS     | Exposed Roots / Cambium Damage  |
| 3085    | 2A-B  | Foothills Palo Verde | 6                            | NS     | Branch Dieback / Cambium Damage |
| 3086    | 2A-B  | Foothills Palo Verde | 10                           | RIP    | Branch Dieback / Cambium Damage |
| 3087    | 2A-B  | Foothills Palo Verde | 12                           | RIP    | Branch Dieback / Cambium Damage |
| 3088    | 2A-B  | Foothills Palo Verde | 5                            | RIP    | Trunk Form / Root Growth        |
| 3089    | 2A-B  | Foothills Palo Verde | 4                            | RIP    | Trunk Form / Root Growth        |
| 3090    | 2A-B  | Hackberry            | 40                           | RIP    | Wide Base / Cambium Damage      |
| 3091    | 2A-B  | Foothills Palo Verde | 7                            | RIP    | Branch Dieback / Cambium Damage |
| 3092    | 2A-B  | Foothills Palo Verde | 12                           | RIP    | Branch Dieback / Cambium Damage |
| 3093    | 2A-B  | Foothills Palo Verde | 14                           | RIP    | Branch Dieback / Cambium Damage |
| 3094    | 2A-B  | Foothills Palo Verde | 12                           | RIP    | Branch Dieback / Cambium Damage |

| Plant # | Phase | Common Name          | Caliper (in)/<br>Height (ft) | Status | Comments                        |
|---------|-------|----------------------|------------------------------|--------|---------------------------------|
| 3095    | 2A-B  | Hackberry            | 20                           | RIP    | Wide Base / Cambium Damage      |
| 3096    | 2A-B  | Foothills Palo Verde | 4                            | RIP    | Trunk Form / Cambium Damage     |
| 3097    | 2A-B  | Foothills Palo Verde | 10                           | RIP    | Branch Dieback / Cambium Damage |
| 3098    | 2A-B  | Foothills Palo Verde | 10                           | RIP    | Branch Dieback / Cambium Damage |
| 3099    | 2A-B  | Saguaro              | 8                            | RIP    |                                 |
| 3100    | 2A-B  | Foothills Palo Verde | 8                            | NS     | Trunk Form / Cambium Damage     |
| 3101    | 2A-B  | Foothills Palo Verde | 8                            | RIP    | In Rocks / Cambium Damage       |
| 3102    | 2A-B  | Foothills Palo Verde | 16                           | NS     | Branch Dieback / Cambium Damage |
| 3103    | 2A-B  | Foothills Palo Verde | 16                           | NS     | Branch Dieback / Cambium Damage |
| 3104    | 2A-B  | Foothills Palo Verde | 14                           | NS     | Exposed Roots / Cambium Damage  |
| 3105    | 2A-B  | Foothills Palo Verde | 6                            | S      |                                 |
| 3106    | 2A-B  | Foothills Palo Verde | 30                           | NS     | Exposed Roots / Cambium Damage  |
| 3107    | 2A-B  | Foothills Palo Verde | 5                            | RIP    |                                 |
| 3108    | 2A-B  | Foothills Palo Verde | 4                            | RIP    | In Wash / Leaning               |
| 3109    | 2A-B  | Foothills Palo Verde | 6                            | RIP    | In Wash / Leaning               |
| 3110    | 2A-B  | Foothills Palo Verde | 7                            | RIP    | Branch Dieback / Cambium Damage |
| 3111    | 2A-B  | Foothills Palo Verde | 6                            | RIP    | In Rocks / Cambium Damage       |
| 3112    | 2A-B  | Foothills Palo Verde | 7                            | RIP    | In Wash / Leaning               |
| 3113    | 2A-B  | Foothills Palo Verde | 18                           | RIP    | Branch Dieback / Cambium Damage |
| 3114    | 2A-B  | Foothills Palo Verde | 10                           | RIP    | Branch Dieback / Cambium Damage |
| 3115    | 2A-B  | Foothills Palo Verde | 20                           | RIP    | Branch Dieback / Cambium Damage |
| 3116    | 2A-B  | Foothills Palo Verde | 14                           | NS     | In Rocks / Cambium Damage       |
| 3117    | 2A-B  | Foothills Palo Verde | 20                           | NS     | Exposed Roots / Cambium Damage  |
| 3118    | 2A-B  | Foothills Palo Verde | 10                           | NS     | In Rocks / Cambium Damage       |
| 3119    | 2A-B  | Saguaro              | 17                           | S      |                                 |
| 3120    | 2A-B  | Foothills Palo Verde | 6                            | NS     | Trunk Form / Root Growth        |
| 3121    | 2A-B  | Foothills Palo Verde | 6                            | NS     | Branch Dieback                  |
| 3122    | 2A-B  | Foothills Palo Verde | 20                           | NS     | Branch Dieback / Cambium Damage |
| 3123    | 2A-B  | Foothills Palo Verde | 12                           | NS     | Branch Dieback / Cambium Damage |
| 3124    | 2A-B  | Barrel               | 3                            | S      |                                 |
| 3125    | 2A-B  | Foothills Palo Verde | 5                            | NS     | Trunk Form / Root Growth        |
| 3126    | 2A-B  | Foothills Palo Verde | 4                            | NS     | Trunk Form / Root Growth        |
| 3127    | 2A-B  | Foothills Palo Verde | 10                           | NS     | Exposed Roots / Root Growth     |
| 3128    | 2A-B  | Foothills Palo Verde | 6                            | NS     | Exposed Roots / Root Growth     |
| 3129    | 2A-B  | Foothills Palo Verde | 8                            | NS     | In Wash / Root Growth           |
| 3130    | 2A-B  | Foothills Palo Verde | 8                            | RIP    | Branch Dieback / Cambium Damage |
| 3131    | 2A-B  | Foothills Palo Verde | 6                            | RIP    | Branch Dieback / Cambium Damage |
| 3132    | 2A-B  | Foothills Palo Verde | 8                            | RIP    | Branch Dieback / Cambium Damage |
| 3133    | 2A-B  | Foothills Palo Verde | 4                            | NS     | In Rocks                        |
| 3134    | 2A-B  | Foothills Palo Verde | 16                           | RIP    | Branch Dieback                  |
| 3135    | 2A-B  | Foothills Palo Verde | 8                            | RIP    | In Rocks                        |
| 3136    | 2A-B  | Foothills Palo Verde | 5                            | RIP    | In Rocks                        |
| 3137    | 2A-B  | Foothills Palo Verde | 6                            | RIP    | In Rocks                        |
| 3138    | 2A-B  | Foothills Palo Verde | 20                           | RIP    | In Rocks                        |
| 3139    | 2A-B  | Foothills Palo Verde | 10                           | RIP    | In Rocks                        |
| 3140    | 2A-B  | Foothills Palo Verde | 10                           | RIP    | Leaning / Cambium Damage        |
| 3141    | 2A-B  | Foothills Palo Verde | 12                           | NS     | Branch Dieback / Cambium Damage |
| 3142    | 2A-B  | Foothills Palo Verde | 10                           | NS     | Branch Dieback / Cambium Damage |
| 3143    | 2A-B  | Foothills Palo Verde | 12                           | RIP    | Branch Dieback / Cambium Damage |

| Plant # | Phase | Common Name          | Caliper (in)/<br>Height (ft) | Status | Comments                        |
|---------|-------|----------------------|------------------------------|--------|---------------------------------|
| 3144    | 2A-B  | Foothills Palo Verde | 6                            | RIP    | Branch Dieback / Cambium Damage |
| 3145    | 2A-B  | Foothills Palo Verde | 7                            | NS     | In Rocks                        |
| 3146    | 2A-B  | Foothills Palo Verde | 8                            | NS     | In Rocks                        |
| 3147    | 2A-B  | Foothills Palo Verde | 10                           | NS     | In Rocks                        |
| 3148    | 2A-B  | Foothills Palo Verde | 7                            | NS     | In Rocks                        |
| 3149    | 2A-B  | Foothills Palo Verde | 8                            | NS     | In Rocks                        |
| 3150    | 2A-B  | Foothills Palo Verde | 8                            | NS     | Branch Dieback / Cambium Damage |
| 3151    | 2A-B  | Foothills Palo Verde | 14                           | NS     | Branch Dieback / Cambium Damage |
| 3152    | 2A-B  | Foothills Palo Verde | 8                            | RIP    | Branch Dieback / Cambium Damage |
| 3153    | 2A-B  | Foothills Palo Verde | 10                           | RIP    | In Rocks                        |
| 3154    | 2A-B  | Foothills Palo Verde | 7                            | RIP    | In Rocks                        |
| 3155    | 2A-B  | Foothills Palo Verde | 10                           | RIP    | In Rocks / Cambium Damage       |
| 3156    | 2A-B  | Foothills Palo Verde | 7                            | RIP    | Branch Dieback / Cambium Damage |
| 3157    | 2A-B  | Foothills Palo Verde | 16                           | RIP    | Branch Dieback / Cambium Damage |
| 3158    | 2A-B  | Foothills Palo Verde | 16                           | RIP    | Branch Dieback / Cambium Damage |
| 3159    | 2A-B  | Foothills Palo Verde | 5                            | RIP    | In Rocks                        |
| 3160    | 2A-B  | Foothills Palo Verde | 8                            | RIP    | Exposed Roots                   |
| 3161    | 2A-B  | Foothills Palo Verde | 8                            | RIP    | Declining / Branch Dieback      |
| 3162    | 2A-B  | Foothills Palo Verde | 5                            | RIP    | Declining / Branch Dieback      |
| 3163    | 2A-B  | Foothills Palo Verde | 10                           | RIP    | Branch Dieback / Cambium Damage |
| 3164    | 2A-B  | Foothills Palo Verde | 12                           | NS     | Branch Dieback / Cambium Damage |
| 3165    | 2A-B  | Foothills Palo Verde | 8                            | NS     | Branch Dieback / Cambium Damage |
| 3166    | 2A-B  | Foothills Palo Verde | 4                            | NS     | Branch Dieback / Cambium Damage |
| 3167    | 2A-B  | Foothills Palo Verde | 8                            | NS     | Branch Dieback / Cambium Damage |
| 3168    | 2A-B  | Foothills Palo Verde | 8                            | NS     | Branch Dieback / Cambium Damage |
| 3169    | 2A-B  | Foothills Palo Verde | 7                            | RIP    | Trunk Form / Root Growth        |
| 3170    | 2A-B  | Saguaro              | 3                            | S      |                                 |
| 3171    | 2A-B  | Foothills Palo Verde | 7                            | S      |                                 |
| 3172    | 2A-B  | Foothills Palo Verde | 8                            | NS     | Branch Dieback / Cambium Damage |
| 3173    | 2A-B  | Foothills Palo Verde | 8                            | RIP    | In Rocks                        |
| 3174    | 2A-B  | Foothills Palo Verde | 10                           | RIP    | Branch Dieback                  |
| 3175    | 2A-B  | Foothills Palo Verde | 8                            | NS     | Branch Dieback / Cambium Damage |
| 3176    | 2A-B  | Foothills Palo Verde | 16                           | NS     | Branch Dieback / Cambium Damage |
| 3177    | 2A-B  | Foothills Palo Verde | 8                            | RIP    | Branch Dieback / Cambium Damage |
| 3178    | 2A-B  | Foothills Palo Verde | 20                           | RIP    | Trunk Form / Root Growth        |
| 3179    | 2A-B  | Foothills Palo Verde | 7                            | RIP    | Trunk Form / Root Growth        |
| 3180    | 2A-B  | Foothills Palo Verde | 7                            | NS     | Trunk Form / Root Growth        |
| 3181    | 2A-B  | Saguaro              | 4                            | S      |                                 |
| 3182    | 2A-B  | Foothills Palo Verde | 12                           | NS     | In Rocks                        |
| 3183    | 2A-B  | Foothills Palo Verde | 10                           | RIP    | Branch Dieback                  |
| 3184    | 2A-B  | Foothills Palo Verde | 10                           | RIP    | Branch Dieback                  |
| 3185    | 2A-B  | Foothills Palo Verde | 5                            | RIP    | Branch Dieback / In Rocks       |
| 3186    | 2A-B  | Foothills Palo Verde | 8                            | RIP    | In Rocks                        |
| 3187    | 2A-B  | Foothills Palo Verde | 8                            | RIP    | In Rocks                        |
| 3188    | 2A-B  | Foothills Palo Verde | 12                           | NS     | Branch Dieback                  |
| 3189    | 2A-B  | Hackberry            | 20                           | RIP    | Wide Base                       |
| 3190    | 2A-B  | Foothills Palo Verde | 14                           | RIP    | Branch Dieback / In Rocks       |
| 3191    | 2A-B  | Barrel               | 4                            | RIP    | In Rocks                        |
| 3192    | 2A-B  | Foothills Palo Verde | 14                           | NS     | Branch Dieback / In Rocks       |

| Plant # | Phase | Common Name          | Caliper (in)/<br>Height (ft) | Status | Comments                        |
|---------|-------|----------------------|------------------------------|--------|---------------------------------|
| 3193    | 2A-B  | Foothills Palo Verde | 6                            | NS     | In Wash / Root Growth           |
| 3194    | 2A-B  | Foothills Palo Verde | 5                            | NS     | In Rocks                        |
| 3195    | 2A-B  | Foothills Palo Verde | 12                           | NS     | Branch Dieback / Cambium Damage |
| 3196    | 2A-B  | Foothills Palo Verde | 6                            | NS     | Exposed Roots                   |
| 3197    | 2A-B  | Foothills Palo Verde | 6                            | RIP    | Exposed Roots                   |
| 3198    | 2A-B  | Foothills Palo Verde | 7                            | RIP    |                                 |
| 3199    | 2A-B  | Mesquite             | 4                            | RIP    |                                 |
| 3200    | 2A-B  | Foothills Palo Verde | 12                           | RIP    | Branch Dieback                  |
| 3201    | 2A-B  | Foothills Palo Verde | 6                            | RIP    | Exposed Roots                   |
| 3202    | 2A-B  | Mesquite             | 14                           | NS     | Branch Dieback / Cambium Damage |
| 3203    | 2A-B  | Mesquite             | 4                            | NS     | Exposed Roots                   |
| 3204    | 2A-B  | Mesquite             | 8                            | RIP    |                                 |
| 3205    | 2A-B  | Foothills Palo Verde | 7                            | RIP    |                                 |
| 3206    | 2A-B  | Mesquite             | 10                           | RIP    | Branch Dieback                  |
| 3207    | 2A-B  | Mesquite             | 14                           | RIP    | Branch Dieback / Cambium Damage |
| 3208    | 2A-B  | Foothills Palo Verde | 8                            | RIP    | Exposed Roots                   |
| 3209    | 2A-B  | Foothills Palo Verde | 16                           | RIP    | Branch Dieback / Cambium Damage |
| 3210    | 2A-B  | Foothills Palo Verde | 4                            | RIP    | Proximity to Road               |
| 3211    | 2A-B  | Mesquite             | 5                            | RIP    | Diseased / Cambium Damage       |
| 3212    | 2A-B  | Foothills Palo Verde | 4                            | RIP    |                                 |
| 3213    | 2A-B  | Foothills Palo Verde | 7                            | RIP    |                                 |
| 3214    | 2A-B  | Mesquite             | 7                            | RIP    |                                 |
| 3215    | 2A-B  | Foothills Palo Verde | 7                            | S      |                                 |
| 3216    | 2A-B  | Foothills Palo Verde | 5                            | NS     | Branch Dieback / Cambium Damage |
| 3217    | 2A-B  | Foothills Palo Verde | 4                            | NS     | Trunk Form / Leaning            |
| 3218    | 2A-B  | Foothills Palo Verde | 8                            | RIP    | Trunk Form / Cambium Damage     |
| 3219    | 2A-B  | Blue Palo Verde      | 5                            | NS     | Branch Dieback / Cambium Damage |
| 3220    | 2A-B  | Foothills Palo Verde | 7                            | S      |                                 |
| 3221    | 2A-B  | Barrel               | 3                            | S      |                                 |
| 3222    | 2A-B  | Foothills Palo Verde | 6                            | S      |                                 |
| 3223    | 2A-B  | Foothills Palo Verde | 6                            | S      |                                 |
| 3224    | 2A-B  | Foothills Palo Verde | 18                           | RIP    | Branch Dieback / Cambium Damage |
| 3225    | 2A-B  | Foothills Palo Verde | 5                            | S      |                                 |
| 3226    | 2A-B  | Foothills Palo Verde | 9                            | S      |                                 |
| 3227    | 2A-B  | Foothills Palo Verde | 4                            | RIP    |                                 |
| 3228    | 2A-B  | Barrel               | 4                            | RIP    |                                 |
| 3229    | 2A-B  | Barrel               | 4                            | S      |                                 |
| 3230    | 2A-B  | Mesquite             | 22                           | NS     | Branch Dieback                  |
| 3231    | 2A-B  | Foothills Palo Verde | 10                           | S      |                                 |
| 3232    | 2A-B  | Foothills Palo Verde | 8                            | NS     | Exposed Roots                   |
| 3233    | 2A-B  | Foothills Palo Verde | 8                            | NS     | Trunk Form / Root Growth        |
| 3234    | 2A-B  | Foothills Palo Verde | 5                            | NS     | Trunk Form / Root Growth        |
| 3235    | 2A-B  | Foothills Palo Verde | 5                            | NS     | Exposed Roots / Root Growth     |
| 3236    | 2A-B  | Foothills Palo Verde | 10                           | NS     | Branch Dieback / Cambium Damage |
| 3237    | 2A-B  | Foothills Palo Verde | 8                            | NS     | Branch Dieback / Cambium Damage |
| 3238    | 2A-B  | Foothills Palo Verde | 6                            | NS     | Exposed Roots / Root Growth     |
| 3239    | 2A-B  | Foothills Palo Verde | 6                            | NS     | Branch Dieback / Cambium Damage |
| 3240    | 2A-B  | Foothills Palo Verde | 4                            | NS     | Leaning / Cambium Damage        |
| 3241    | 2A-B  | Foothills Palo Verde | 8                            | NS     | Leaning / Cambium Damage        |

| Plant # | Phase | Common Name          | Caliper (in)/<br>Height (ft) | Status | Comments                        |
|---------|-------|----------------------|------------------------------|--------|---------------------------------|
| 3242    | 2A-B  | Foothills Palo Verde | 6                            | NS     | Branch Dieback / Cambium Damage |
| 3243    | 2A-B  | Foothills Palo Verde | 14                           | NS     | Branch Dieback / Cambium Damage |
| 3244    | 2A-B  | Foothills Palo Verde | 6                            | RIP    |                                 |
| 3245    | 2A-B  | Foothills Palo Verde | 4                            | NS     | Trunk Form / Root Growth        |
| 3246    | 2A-B  | Foothills Palo Verde | 4                            | NS     | Trunk Form / Root Growth        |
| 3247    | 2A-B  | Foothills Palo Verde | 10                           | NS     | Branch Dieback / Cambium Damage |
| 3248    | 2A-B  | Foothills Palo Verde | 7                            | NS     | Exposed Roots / Root Growth     |
| 3249    | 2A-B  | Foothills Palo Verde | 16                           | NS     | Branch Dieback / Cambium Damage |
| 3250    | 2A-B  | Foothills Palo Verde | 7                            | S      |                                 |
| 3251    | 2A-B  | Foothills Palo Verde | 5                            | RIP    |                                 |
| 3252    | 2A-B  | Hackberry            | 60                           | RIP    | Wide Base                       |
| 3253    | 2A-B  | Foothills Palo Verde | 14                           | RIP    | Branch Dieback / Cambium Damage |
| 3254    | 2A-B  | Foothills Palo Verde | 6                            | RIP    |                                 |
| 3255    | 2A-B  | Foothills Palo Verde | 7                            | RIP    |                                 |
| 3256    | 2A-B  | Mesquite             | 16                           | RIP    | Branch Dieback / Cambium Damage |
| 3257    | 2A-B  | Foothills Palo Verde | 7                            | RIP    | Trunk Form / Leaning            |
| 3258    | 2A-B  | Hackberry            | 60                           | RIP    | Wide Base                       |
| 3259    | 2A-B  | Foothills Palo Verde | 8                            | RIP    |                                 |
| 3260    | 2A-B  | Foothills Palo Verde | 8                            | NS     | Branch Dieback / Cambium Damage |
| 3261    | 2A-B  | Foothills Palo Verde | 5                            | NS     | Trunk Form / Root Growth        |
| 3262    | 2A-B  | Foothills Palo Verde | 16                           | NS     | Branch Dieback                  |
| 3263    | 2A-B  | Foothills Palo Verde | 5                            | NS     | Branch Dieback / Cambium Damage |
| 3264    | 2A-B  | Foothills Palo Verde | 7                            | NS     | Branch Dieback / Cambium Damage |
| 3265    | 2A-B  | Foothills Palo Verde | 8                            | NS     | Trunk Form / Root Growth        |
| 3266    | 2A-B  | Foothills Palo Verde | 6                            | NS     | Trunk Form / Root Growth        |
| 3267    | 2A-B  | Foothills Palo Verde | 18                           | NS     | Trunk Form / Root Growth        |
| 3268    | 2A-B  | Foothills Palo Verde | 7                            | RIP    | In Wash / Leaning               |
| 3269    | 2A-B  | Foothills Palo Verde | 7                            | NS     | In Rocks / Leaning              |
| 3270    | 2A-B  | Foothills Palo Verde | 4                            | NS     | In Rocks                        |
| 3271    | 2A-B  | Foothills Palo Verde | 4                            | NS     | In Rocks                        |
| 3272    | 2A-B  | Foothills Palo Verde | 5                            | NS     | In Rocks                        |
| 3273    | 2A-B  | Foothills Palo Verde | 5                            | NS     | Branch Dieback                  |
| 3274    | 2A-B  | Foothills Palo Verde | 22                           | NS     | Branch Dieback / Cambium Damage |
| 3275    | 2A-B  | Foothills Palo Verde | 9                            | NS     | Branch Dieback / Cambium Damage |
| 3276    | 2A-B  | Foothills Palo Verde | 12                           | NS     | Branch Dieback / Cambium Damage |
| 3277    | 2A-B  | Foothills Palo Verde | 8                            | NS     | Branch Dieback / Cambium Damage |
| 3278    | 2A-B  | Foothills Palo Verde | 8                            | NS     | Branch Dieback / Cambium Damage |
| 3279    | 2A-B  | Foothills Palo Verde | 10                           | S      |                                 |
| 3280    | 2A-B  | Foothills Palo Verde | 7                            | NS     | Branch Dieback / Cambium Damage |
| 3281    | 2A-B  | Foothills Palo Verde | 16                           | S      |                                 |
| 3282    | 2A-B  | Foothills Palo Verde | 15                           | NS     | Branch Dieback                  |
| 3283    | 2A-B  | Foothills Palo Verde | 6                            | NS     | Trunk Form / Root Growth        |
| 3284    | 2A-B  | Foothills Palo Verde | 15                           | NS     | Branch Dieback / Cambium Damage |
| 3285    | 2A-B  | Foothills Palo Verde | 8                            | S      |                                 |
| 3286    | 2A-B  | Barrel               | 4                            | RIP    |                                 |
| 3287    | 2A-B  | Barrel               | 4                            | RIP    | Damaged                         |
| 3288    | 2A-B  | Barrel               | 3                            | RIP    |                                 |
| 3289    | 2A-B  | Foothills Palo Verde | 8                            | RIP    |                                 |
| 3290    | 2A-B  | Foothills Palo Verde | 4                            | NS     | Branch Dieback                  |

| Plant # | Phase | Common Name          | Caliper (in)/<br>Height (ft) | Status | Comments                        |
|---------|-------|----------------------|------------------------------|--------|---------------------------------|
| 3291    | 2A-B  | Foothills Palo Verde | 7                            | S      |                                 |
| 3292    | 2A-B  | Foothills Palo Verde | 8                            | RIP    | Exposed Roots / Root Growth     |
| 3293    | 2A-B  | Barrel               | 4                            | RIP    |                                 |
| 3294    | 2A-B  | Foothills Palo Verde | 10                           | RIP    | Branch Dieback / Cambium Damage |
| 3295    | 2A-B  | Saguaro              | 44                           | S      | 4 arms                          |
| 3296    | 2A-B  | Barrel               | 3                            | NS     | Damaged                         |
| 3297    | 2A-B  | Foothills Palo Verde | 7                            | S      |                                 |
| 3298    | 2A-B  | Foothills Palo Verde | 12                           | NS     | Branch Dieback / Cambium Damage |
| 3299    | 2A-B  | Hackberry            | 20                           | RIP    | Wide Base / Cambium Damage      |
| 3300    | 2A-B  | Foothills Palo Verde | 12                           | NS     | Branch Dieback / Cambium Damage |
| 3301    | 2A-B  | Mesquite             | 12                           | NS     | Branch Dieback / Cambium Damage |
| 3302    | 2A-B  | Barrel               | 4                            | S      |                                 |
| 3303    | 2A-B  | Foothills Palo Verde | 12                           | NS     | Branch Dieback / Cambium Damage |
| 3304    | 2A-B  | Foothills Palo Verde | 20                           | NS     | Exposed Roots / Cambium Damage  |
| 3305    | 2A-B  | Barrel               | 4                            | NS     | Fire Damage                     |
| 3306    | 2A-B  | Foothills Palo Verde | 10                           | NS     | Branch Dieback / Cambium Damage |
| 3307    | 2A-B  | Mesquite             | 8                            | NS     | Branch Dieback / Cambium Damage |
| 3308    | 2A-B  | Hackberry            | 30                           | NS     | Wide Base                       |
| 3309    | 2A-B  | Mesquite             | 12                           | NS     | Branch Dieback                  |
| 3310    | 2A-B  | Mesquite             | 12                           | NS     | Branch Dieback                  |
| 3311    | 2A-B  | Foothills Palo Verde | 15                           | NS     | Branch Dieback / Shallow Roots  |
| 3312    | 2A-B  | Foothills Palo Verde | 5                            | S      |                                 |
| 3313    | 2A-B  | Foothills Palo Verde | 6                            | S      |                                 |
| 3314    | 2A-B  | Barrel               | 8                            | S      |                                 |
| 3315    | 2A-B  | Foothills Palo Verde | 5                            | S      |                                 |
| 3316    | 2A-B  | Foothills Palo Verde | 7                            | NS     | Branch Dieback / Cambium Damage |
| 3317    | 2A-B  | Foothills Palo Verde | 14                           | NS     | Branch Dieback / Cambium Damage |
| 3318    | 2A-B  | Hackberry            | 20                           | NS     | Wide Base                       |
| 3319    | 2A-B  | Foothills Palo Verde | 18                           | NS     | Branch Dieback / Cambium Damage |
| 3320    | 2A-B  | Foothills Palo Verde | 6                            | S      |                                 |
| 3321    | 2A-B  | Foothills Palo Verde | 16                           | NS     | Branch Dieback / Cambium Damage |
| 3322    | 2A-B  | Foothills Palo Verde | 6                            | RIP    |                                 |
| 3323    | 2A-B  | Foothills Palo Verde | 4                            | RIP    | Trunk Form / Cambium Damage     |
| 3324    | 2A-B  | Hackberry            | 28                           | RIP    | Wide Base                       |
| 3325    | 2A-B  | Foothills Palo Verde | 20                           | RIP    |                                 |
| 3326    | 2A-B  | Foothills Palo Verde | 5                            | RIP    | Exposed Roots / Root Growth     |
| 3327    | 2A-B  | Foothills Palo Verde | 7                            | RIP    | Exposed Roots / Root Growth     |
| 3328    | 2A-B  | Foothills Palo Verde | 6                            | S      |                                 |
| 3329    | 2A-B  | Blue Palo Verde      | 6                            | NS     | Declining / Cambium Damage      |
| 3330    | 2A-B  | Blue Palo Verde      | 4                            | RIP    | Declining / Cambium Damage      |
| 3331    | 2A-B  | Mesquite             | 20                           | RIP    | Branch Dieback / Cambium Damage |
| 3332    | 2A-B  | Foothills Palo Verde | 7                            | RIP    | Branch Dieback / Cambium Damage |
| 3333    | 2A-B  | Foothills Palo Verde | 22                           | NS     | Branch Dieback / Cambium Damage |
| 3334    | 2A-B  | Foothills Palo Verde | 8                            | NS     | Exposed Roots                   |
| 3335    | 2A-B  | Foothills Palo Verde | 5                            | RIP    |                                 |
| 3336    | 2A-B  | Foothills Palo Verde | 5                            | RIP    |                                 |
| 3337    | 2A-B  | Foothills Palo Verde | 4                            | RIP    | In Wash                         |
| 3338    | 2A-B  | Foothills Palo Verde | 8                            | S      |                                 |
| 3340    | 2A-B  | Foothills Palo Verde | 7                            | RIP    |                                 |



| Plant # | Phase | Common Name          | Caliper (in)/<br>Height (ft) | Status | Comments                         |
|---------|-------|----------------------|------------------------------|--------|----------------------------------|
| 3341    | 2A-B  | Foothills Palo Verde | 7                            | NS     | Exposed Roots                    |
| 3342    | 2A-B  | Foothills Palo Verde | 22                           | NS     | Branch Dieback                   |
| 3343    | 2A-B  | Foothills Palo Verde | 20                           | NS     | Exposed Roots                    |
| 3344    | 2A-B  | Foothills Palo Verde | 12                           | NS     | Exposed Roots                    |
| 3345    | 2A-B  | Foothills Palo Verde | 6                            | S      |                                  |
| 3346    | 2A-B  | Foothills Palo Verde | 7                            | S      |                                  |
| 3347    | 2A-B  | Foothills Palo Verde | 7                            | S      |                                  |
| 3348    | 2A-B  | Foothills Palo Verde | 16                           | NS     | Branch Dieback                   |
| 3349    | 2A-B  | Foothills Palo Verde | 6                            | S      |                                  |
| 3350    | 2A-B  | Foothills Palo Verde | 7                            | RIP    |                                  |
| 3351    | 2A-B  | Hackberry            | 28                           | NS     | Wide Base                        |
| 3352    | 2A-B  | Foothills Palo Verde | 6                            | NS     | Trunk Form / Cambium Damage      |
| 3353    | 2A-B  | Foothills Palo Verde | 6                            | S      |                                  |
| 3354    | 2A-B  | Foothills Palo Verde | 7                            | NS     | In Rocks                         |
| 3355    | 2A-B  | Foothills Palo Verde | 12                           | NS     | In Rocks                         |
| 3356    | 2A-B  | Foothills Palo Verde | 7                            | NS     | In Rocks                         |
| 3357    | 2A-B  | Foothills Palo Verde | 7                            | NS     | Branch Dieback / Cambium Damage  |
| 3358    | 2A-B  | Foothills Palo Verde | 30                           | NS     | Branch Dieback / Cambium Damage  |
| 3359    | 2A-B  | Foothills Palo Verde | 8                            | NS     | Exposed Roots                    |
| 3360    | 2A-B  | Foothills Palo Verde | 20                           | NS     | Exposed Roots / Cambium Damage   |
| 3361    | 2A-B  | Foothills Palo Verde | 6                            | S      |                                  |
| 3362    | 2A-B  | Foothills Palo Verde | 8                            | RIP    |                                  |
| 3363    | 2A-B  | Hackberry            | 20                           | NS     | Wide Base                        |
| 3364    | 2A-B  | Foothills Palo Verde | 4                            | S      |                                  |
| 3365    | 2A-B  | Foothills Palo Verde | 6                            | S      |                                  |
| 3366    | 2A-B  | Foothills Palo Verde | 20                           | NS     | Branch Dieback / Cambium Damage  |
| 3367    | 2A-B  | Foothills Palo Verde | 4                            | S      |                                  |
| 3368    | 2A-B  | Mesquite             | 36                           | RIP    | Branch Dieback                   |
| 3369    | 2A-B  | Foothills Palo Verde | 5                            | RIP    | Trunk Form / Leaning             |
| 3370    | 2A-B  | Foothills Palo Verde | 6                            | RIP    |                                  |
| 3371    | 2A-B  | Mesquite             | 30                           | NS     | Branch Dieback                   |
| 3372    | 2A-B  | Foothills Palo Verde | 17                           | NS     | Branch Dieback / Cambium Damage  |
| 3373    | 2A-B  | Foothills Palo Verde | 12                           | NS     | Branch Dieback / Cambium Damage  |
| 3374    | 2A-B  | Foothills Palo Verde | 5                            | NS     | Branch Dieback / Cambium Damage  |
| 3375    | 2A-B  | Foothills Palo Verde | 12                           | NS     | Branch Dieback / Cambium Damage  |
| 3376    | 2A-B  | Foothills Palo Verde | 7                            | S      |                                  |
| 3377    | 2A-B  | Mesquite             | 10                           | NS     | Branch Dieback                   |
| 3378    | 2A-B  | Foothills Palo Verde | 10                           | NS     | Branch Dieback / Cambium Damage  |
| 3379    | 2A-B  | Foothills Palo Verde | 6                            | NS     | Trunk Form / Root Growth         |
| 3380    | 2A-B  | Foothills Palo Verde | 10                           | S      |                                  |
| 3381    | 2A-B  | Foothills Palo Verde | 20                           | NS     | Trunk Form / Root Growth         |
| 3382    | 2A-B  | Foothills Palo Verde | 8                            | NS     | Exposed Roots / Root Growth      |
| 3383    | 2A-B  | Foothills Palo Verde | 10                           | NS     | Exposed Roots / Root Growth      |
| 3384    | 2A-B  | Saguaro              | 11                           | S      |                                  |
| 3385    | 2A-B  | Foothills Palo Verde | 14                           | NS     | Branch Dieback / Broken Branches |
| 3386    | 2A-B  | Foothills Palo Verde | 16                           | NS     | Exposed Roots / Broken Branches  |
| 3387    | 2A-B  | Foothills Palo Verde | 7                            | NS     | Trunk Form / Root Growth         |
| 3388    | 2A-B  | Foothills Palo Verde | 10                           | NS     | Branch Dieback / Cambium Damage  |
| 3389    | 2A-B  | Foothills Palo Verde | 5                            | NS     | Trunk Form / Root Growth         |

| Plant # | Phase | Common Name          | Caliper (in)/<br>Height (ft) | Status | Comments                        |
|---------|-------|----------------------|------------------------------|--------|---------------------------------|
| 3390    | 2A-B  | Foothills Palo Verde | 14                           | NS     | Branch Dieback                  |
| 3391    | 2A-B  | Foothills Palo Verde | 20                           | NS     | Exposed Roots                   |
| 3392    | 2A-B  | Foothills Palo Verde | 8                            | S      |                                 |
| 3393    | 2A-B  | Foothills Palo Verde | 10                           | RIP    | Branch Dieback                  |
| 3394    | 2A-B  | Foothills Palo Verde | 7                            | S      |                                 |
| 3395    | 2A-B  | Foothills Palo Verde | 5                            | S      |                                 |
| 3396    | 2A-B  | Foothills Palo Verde | 5                            | NS     | Leaning / Cambium Damage        |
| 3397    | 2A-B  | Foothills Palo Verde | 6                            | NS     | Leaning / Cambium Damage        |
| 3398    | 2A-B  | Foothills Palo Verde | 5                            | S      |                                 |
| 3399    | 2A-B  | Foothills Palo Verde | 16                           | NS     | Branch Dieback / Cambium Damage |
| 3400    | 2A-B  | Hackberry            | 50                           | NS     | Wide Base / Cambium Damage      |
| 3401    | 2A-B  | Foothills Palo Verde | 8                            | RIP    | Exposed Roots                   |
| 3402    | 2A-B  | Foothills Palo Verde | 8                            | RIP    | Exposed Roots                   |
| 3403    | 2A-B  | Foothills Palo Verde | 8                            | RIP    | Exposed Roots                   |
| 3404    | 2A-B  | Foothills Palo Verde | 7                            | RIP    | Exposed Roots                   |
| 3405    | 2A-B  | Foothills Palo Verde | 17                           | RIP    | Branch Dieback / Cambium Damage |
| 3406    | 2A-B  | Foothills Palo Verde | 12                           | RIP    | Branch Dieback / Cambium Damage |
| 3407    | 2A-B  | Foothills Palo Verde | 7                            | RIP    |                                 |
| 3408    | 2A-B  | Hackberry            | 30                           | RIP    | Wide Base                       |
| 3409    | 2A-B  | Foothills Palo Verde | 10                           | S      |                                 |
| 3410    | 2A-B  | Foothills Palo Verde | 16                           | NS     | Branch Dieback                  |
| 3411    | 2A-B  | Foothills Palo Verde | 16                           | NS     | Branch Dieback / Cambium Damage |
| 3412    | 2A-B  | Foothills Palo Verde | 14                           | NS     | Declining / Cambium Damage      |
| 3413    | 2A-B  | Foothills Palo Verde | 9                            | S      |                                 |
| 3414    | 2A-B  | Foothills Palo Verde | 10                           | NS     | Branch Dieback                  |
| 3415    | 2A-B  | Hackberry            | 30                           | NS     | Wide Base                       |
| 3416    | 2A-B  | Foothills Palo Verde | 15                           | S      |                                 |
| 3417    | 2A-B  | Foothills Palo Verde | 12                           | NS     | Trunk Form / Leaning            |
| 3418    | 2A-B  | Foothills Palo Verde | 5                            | S      |                                 |
| 3419    | 2A-B  | Foothills Palo Verde | 10                           | S      |                                 |
| 3420    | 2A-B  | Foothills Palo Verde | 4                            | S      |                                 |
| 3421    | 2A-B  | Foothills Palo Verde | 7                            | S      |                                 |
| 3422    | 2A-B  | Foothills Palo Verde | 7                            | RIP    |                                 |
| 3423    | 2A-B  | Foothills Palo Verde | 7                            | S      |                                 |
| 3424    | 2A-B  | Foothills Palo Verde | 4                            | NS     | Branch Dieback                  |
| 3425    | 2A-B  | Foothills Palo Verde | 6                            | NS     | Branch Dieback                  |
| 3426    | 2A-B  | Foothills Palo Verde | 5                            | NS     | Branch Dieback                  |
| 3427    | 2A-B  | Foothills Palo Verde | 12                           | S      |                                 |
| 3428    | 2A-B  | Foothills Palo Verde | 9                            | S      |                                 |
| 3429    | 2A-B  | Foothills Palo Verde | 7                            | NS     | Trunk Form / Root Growth        |
| 3430    | 2A-B  | Foothills Palo Verde | 5                            | NS     | Trunk Form / Root Growth        |
| 3431    | 2A-B  | Foothills Palo Verde | 10                           | NS     | Branch Dieback / Cambium Damage |
| 3432    | 2A-B  | Foothills Palo Verde | 7                            | RIP    | Exposed Roots                   |
| 3433    | 2A-B  | Foothills Palo Verde | 8                            | RIP    |                                 |
| 3434    | 2A-B  | Foothills Palo Verde | 12                           | RIP    | Branch Dieback / Cambium Damage |
| 3435    | 2A-B  | Foothills Palo Verde | 4                            | RIP    | Branch Dieback / Cambium Damage |
| 3436    | 2A-B  | Foothills Palo Verde | 16                           | RIP    | Branch Dieback / Cambium Damage |
| 3437    | 2A-B  | Foothills Palo Verde | 24                           | RIP    | Branch Dieback / Cambium Damage |
| 3438    | 2A-B  | Foothills Palo Verde | 16                           | NS     | Branch Dieback / Cambium Damage |

| Plant # | Phase | Common Name          | Caliper (in)/<br>Height (ft) | Status | Comments                        |
|---------|-------|----------------------|------------------------------|--------|---------------------------------|
| 3439    | 2A-B  | Foothills Palo Verde | 4                            | NS     | Leaning / Cambium Damage        |
| 3440    | 2A-B  | Foothills Palo Verde | 6                            | RIP    | Trunk Form / Root Growth        |
| 3441    | 2A-B  | Foothills Palo Verde | 7                            | RIP    | Branch Dieback / Root Growth    |
| 3442    | 2A-B  | Foothills Palo Verde | 7                            | RIP    | Branch Dieback / Root Growth    |
| 3443    | 2A-B  | Foothills Palo Verde | 12                           | S      |                                 |
| 3444    | 2A-B  | Foothills Palo Verde | 12                           | NS     | Branch Dieback                  |
| 3445    | 2A-B  | Foothills Palo Verde | 14                           | NS     | Branch Dieback / Cambium Damage |
| 3446    | 2A-B  | Foothills Palo Verde | 12                           | S      |                                 |
| 3447    | 2A-B  | Foothills Palo Verde | 5                            | NS     | Trunk Form / Root Growth        |
| 3448    | 2A-B  | Mesquite             | 4                            | NS     | Branch Dieback                  |
| 3449    | 2A-B  | Foothills Palo Verde | 6                            | NS     | Exposed Roots                   |
| 3450    | 2A-B  | Foothills Palo Verde | 7                            | S      |                                 |
| 3451    | 2A-B  | Foothills Palo Verde | 4                            | S      |                                 |
| 3452    | 2A-B  | Foothills Palo Verde | 4                            | RIP    | Trunk Form / Leaning            |
| 3453    | 2A-B  | Foothills Palo Verde | 7                            | RIP    |                                 |
| 3454    | 2A-B  | Foothills Palo Verde | 10                           | RIP    | Branch Dieback                  |
| 3455    | 2A-B  | Foothills Palo Verde | 6                            | RIP    | Trunk Form / Leaning            |
| 3456    | 2A-B  | Foothills Palo Verde | 5                            | RIP    |                                 |
| 3457    | 2A-B  | Barrel               | 3                            | RIP    |                                 |
| 3458    | 2A-B  | Foothills Palo Verde | 8                            | RIP    | Mistletoe / Leaning             |
| 3459    | 2A-B  | Hackberry            | 6                            | NS     | Branch Dieback / Cambium Damage |
| 3460    | 2A-B  | Hackberry            | 5                            | NS     | Branch Dieback / Cambium Damage |
| 3461    | 2A-B  | Foothills Palo Verde | 9                            | S      |                                 |
| 3462    | 2A-B  | Foothills Palo Verde | 7                            | S      |                                 |
| 3463    | 2A-B  | Foothills Palo Verde | 8                            | S      |                                 |
| 3464    | 2A-B  | Saguaro              | 134                          | RIP    |                                 |
| 3465    | 2A-B  | Foothills Palo Verde | 4                            | NS     | Trunk Form / Root Growth        |
| 3466    | 2A-B  | Foothills Palo Verde | 5                            | RIP    |                                 |
| 3467    | 2A-B  | Foothills Palo Verde | 7                            | RIP    |                                 |
| 3468    | 2A-B  | Barrel               | 3                            | S      |                                 |
| 3469    | 2A-B  | Foothills Palo Verde | 16                           | S      |                                 |
| 3470    | 2A-B  | Foothills Palo Verde | 7                            | NS     | In Wash / Cambium Damage        |
| 3471    | 2A-B  | Foothills Palo Verde | 5                            | NS     | Exposed Roots / Root Growth     |
| 3472    | 2A-B  | Foothills Palo Verde | 10                           | S      |                                 |
| 3473    | 2A-B  | Barrel               | 4                            | S      |                                 |
| 3474    | 2A-B  | Barrel               | 4                            | RIP    |                                 |
| 3475    | 2A-B  | Hackberry            | 40                           | NS     | Wide Base                       |
| 3476    | 2A-B  | Foothills Palo Verde | 18                           | NS     | Branch Dieback                  |
| 3477    | 2A-B  | Barrel               | 4                            | S      |                                 |
| 3478    | 2A-B  | Foothills Palo Verde | 8                            | NS     | Exposed Roots / Root Growth     |
| 3479    | 2A-B  | Foothills Palo Verde | 8                            | S      |                                 |
| 3480    | 2A-B  | Foothills Palo Verde | 28                           | NS     | Branch Dieback                  |
| 3481    | 2A-B  | Foothills Palo Verde | 7                            | S      |                                 |
| 3482    | 2A-B  | Foothills Palo Verde | 7                            | S      |                                 |
| 3483    | 2A-B  | Foothills Palo Verde | 4                            | RIP    | Declining / Branch Dieback      |
| 3484    | 2A-B  | Foothills Palo Verde | 6                            | RIP    |                                 |
| 3485    | 2A-B  | Foothills Palo Verde | 4                            | RIP    |                                 |
| 3486    | 2A-B  | Foothills Palo Verde | 5                            | RIP    |                                 |
| 3487    | 2A-B  | Mesquite             | 10                           | NS     | Branch Dieback                  |

| Plant # | Phase | Common Name          | Caliper (in)/<br>Height (ft) | Status | Comments                        |
|---------|-------|----------------------|------------------------------|--------|---------------------------------|
| 3488    | 2A-B  | Blue Palo Verde      | 4                            | NS     | Branch Dieback / Cambium Damage |
| 3489    | 2A-B  | Foothills Palo Verde | 8                            | RIP    | Branch Dieback / Cambium Damage |
| 3490    | 2A-B  | Mesquite             | 7                            | RIP    | In Wash / Leaning               |
| 3491    | 2A-B  | Barrel               | 5                            | RIP    |                                 |
| 3492    | 2A-B  | Foothills Palo Verde | 8                            | RIP    |                                 |
| 3493    | 2A-B  | Foothills Palo Verde | 8                            | RIP    | Exposed Roots                   |
| 3494    | 2A-B  | Foothills Palo Verde | 16                           | RIP    | Branch Dieback / Cambium Damage |
| 3495    | 2A-B  | Foothills Palo Verde | 4                            | RIP    | Branch Dieback / Cambium Damage |
| 3496    | 2A-B  | Foothills Palo Verde | 4                            | RIP    |                                 |
| 3497    | 2A-B  | Barrel               | 4                            | RIP    |                                 |
| 3498    | 2A-B  | Foothills Palo Verde | 20                           | RIP    | Exposed Roots / Cambium Damage  |
| 3499    | 2A-B  | Foothills Palo Verde | 8                            | RIP    | Exposed Roots                   |
| 3500    | 2A-B  | Foothills Palo Verde | 5                            | RIP    | Exposed Roots                   |
| 3501    | 2A-B  | Foothills Palo Verde | 18                           | RIP    | Exposed Roots / Cambium Damage  |
| 3502    | 2A-B  | Foothills Palo Verde | 12                           | RIP    | Exposed Roots / Leaning         |
| 3503    | 2A-B  | Foothills Palo Verde | 4                            | RIP    |                                 |
| 3504    | 2A-B  | Foothills Palo Verde | 18                           | RIP    | Cambium Damage / Shallow Roots  |
| 3505    | 2A-B  | Foothills Palo Verde | 7                            | NS     | Exposed Roots                   |
| 3506    | 2A-B  | Foothills Palo Verde | 12                           | NS     | Exposed Roots / Cambium Damage  |
| 3507    | 2A-B  | Foothills Palo Verde | 16                           | NS     | Branch Dieback / Cambium Damage |
| 3508    | 2A-B  | Foothills Palo Verde | 6                            | S      |                                 |
| 3509    | 2A-B  | Foothills Palo Verde | 6                            | S      |                                 |
| 3510    | 2A-B  | Foothills Palo Verde | 4                            | RIP    |                                 |
| 3511    | 2A-B  | Foothills Palo Verde | 5                            | RIP    |                                 |
| 3512    | 2A-B  | Foothills Palo Verde | 5                            | RIP    |                                 |
| 3513    | 2A-B  | Foothills Palo Verde | 12                           | S      |                                 |
| 3514    | 2A-B  | Foothills Palo Verde | 10                           | S      |                                 |
| 3515    | 2A-B  | Foothills Palo Verde | 15                           | S      |                                 |
| 3516    | 2A-B  | Foothills Palo Verde | 12                           | NS     | Branch Dieback / Cambium Damage |
| 3517    | 2A-B  | Foothills Palo Verde | 12                           | NS     | Branch Dieback / Cambium Damage |
| 3518    | 2A-B  | Foothills Palo Verde | 6                            | S      |                                 |
| 3519    | 2A-B  | Foothills Palo Verde | 7                            | S      |                                 |
| 3520    | 2A-B  | Foothills Palo Verde | 7                            | S      |                                 |
| 3521    | 2A-B  | Foothills Palo Verde | 22                           | NS     | Branch Dieback / Cambium Damage |
| 3522    | 2A-B  | Foothills Palo Verde | 16                           | S      |                                 |
| 3523    | 2A-B  | Foothills Palo Verde | 5                            | S      |                                 |
| 3524    | 2A-B  | Foothills Palo Verde | 6                            | S      |                                 |
| 3525    | 2A-B  | Foothills Palo Verde | 5                            | NS     | Branch Dieback                  |
| 3526    | 2A-B  | Foothills Palo Verde | 4                            | S      |                                 |
| 3527    | 2A-B  | Foothills Palo Verde | 4                            | S      |                                 |
| 3528    | 2A-B  | Mesquite             | 5                            | NS     | Branch Dieback                  |
| 3529    | 2A-B  | Foothills Palo Verde | 14                           | NS     | Exposed Roots / Cambium Damage  |
| 3530    | 2A-B  | Foothills Palo Verde | 14                           | NS     | Exposed Roots / Cambium Damage  |
| 3531    | 2A-B  | Foothills Palo Verde | 14                           | S      |                                 |
| 3532    | 2A-B  | Foothills Palo Verde | 8                            | NS     | Leaning / Cambium Damage        |
| 3533    | 2A-B  | Hackberry            | 50                           | NS     | Wide Base                       |
| 3534    | 2A-B  | Mesquite             | 6                            | NS     | Branch Dieback                  |
| 3535    | 2A-B  | Foothills Palo Verde | 6                            | S      |                                 |
| 3536    | 2A-B  | Saguaro              | 86                           | NS     | Damaged                         |

| Plant # | Phase | Common Name          | Caliper (in)/<br>Height (ft) | Status | Comments                        |
|---------|-------|----------------------|------------------------------|--------|---------------------------------|
| 3537    | 2A-B  | Foothills Palo Verde | 16                           | NS     | Exposed Roots / Cambium Damage  |
| 3538    | 2A-B  | Foothills Palo Verde | 4                            | S      |                                 |
| 3539    | 2A-B  | Foothills Palo Verde | 7                            | S      |                                 |
| 3540    | 2A-B  | Foothills Palo Verde | 6                            | S      |                                 |
| 3541    | 2A-B  | Foothills Palo Verde | 7                            | NS     | Mistletoe                       |
| 3542    | 2A-B  | Foothills Palo Verde | 9                            | S      |                                 |
| 3543    | 2A-B  | Foothills Palo Verde | 7                            | S      |                                 |
| 3544    | 2A-B  | Foothills Palo Verde | 5                            | S      |                                 |
| 3545    | 2A-B  | Foothills Palo Verde | 6                            | NS     | Declining / Cambium Damage      |
| 3546    | 2A-B  | Barrel               | 4                            | RIP    |                                 |
| 3547    | 2A-B  | Foothills Palo Verde | 14                           | RIP    | Branch Dieback                  |
| 3548    | 2A-B  | Foothills Palo Verde | 5                            | RIP    |                                 |
| 3549    | 2A-B  | Foothills Palo Verde | 7                            | NS     | Exposed Roots / Root Growth     |
| 3550    | 2A-B  | Foothills Palo Verde | 15                           | S      |                                 |
| 3551    | 2A-B  | Foothills Palo Verde | 8                            | NS     | Exposed Roots / Root Growth     |
| 3552    | 2A-B  | Foothills Palo Verde | 8                            | NS     | Exposed Roots / Root Growth     |
| 3553    | 2A-B  | Foothills Palo Verde | 6                            | S      |                                 |
| 3554    | 2A-B  | Foothills Palo Verde | 7                            | S      |                                 |
| 3555    | 2A-B  | Hackberry            | 16                           | NS     | Wide Base                       |
| 3556    | 2A-B  | Foothills Palo Verde | 7                            | NS     | In Wash / Leaning               |
| 3557    | 2A-B  | Saguaro              | 34                           | S      | 5 arms                          |
| 3558    | 2A-B  | Foothills Palo Verde | 8                            | S      |                                 |
| 3559    | 2A-B  | Foothills Palo Verde | 16                           | RIP    | Exposed Roots                   |
| 3560    | 2A-B  | Foothills Palo Verde | 8                            | RIP    | Exposed Roots                   |
| 3561    | 2A-B  | Foothills Palo Verde | 8                            | RIP    | Exposed Roots                   |
| 3562    | 2A-B  | Foothills Palo Verde | 8                            | RIP    | Exposed Roots                   |
| 3563    | 2A-B  | Foothills Palo Verde | 16                           | RIP    | Mistletoe / Cambium Damage      |
| 3564    | 2A-B  | Foothills Palo Verde | 4                            | NS     | Trunk Form / Leaning            |
| 3565    | 2A-B  | Foothills Palo Verde | 12                           | NS     | Branch Dieback / Cambium Damage |
| 3566    | 2A-B  | Foothills Palo Verde | 18                           | NS     | Branch Dieback / Cambium Damage |
| 3567    | 2A-B  | Foothills Palo Verde | 8                            | S      |                                 |
| 3568    | 2A-B  | Foothills Palo Verde | 6                            | S      |                                 |
| 3569    | 2A-B  | Foothills Palo Verde | 6                            | S      |                                 |
| 3570    | 2A-B  | Foothills Palo Verde | 8                            | S      |                                 |
| 3571    | 2A-B  | Foothills Palo Verde | 7                            | S      |                                 |
| 3572    | 2A-B  | Barrel               | 3                            | S      |                                 |
| 3573    | 2A-B  | Foothills Palo Verde | 4                            | NS     | Trunk Form / Root Growth        |
| 3574    | 2A-B  | Foothills Palo Verde | 6                            | NS     | Trunk Form / Root Growth        |
| 3575    | 2A-B  | Foothills Palo Verde | 6                            | RIP    | Trunk Form / Root Growth        |
| 3576    | 2A-B  | Foothills Palo Verde | 10                           | RIP    | Trunk Form / Root Growth        |
| 3577    | 2A-B  | Foothills Palo Verde | 10                           | RIP    | Trunk Form / Root Growth        |
| 3578    | 2A-B  | Foothills Palo Verde | 5                            | RIP    | Declining / Cambium Damage      |
| 3579    | 2A-B  | Foothills Palo Verde | 16                           | RIP    | Exposed Roots / Cambium Damage  |
| 3580    | 2A-B  | Foothills Palo Verde | 10                           | RIP    | Branch Dieback / Cambium Damage |
| 3581    | 2A-B  | Foothills Palo Verde | 8                            | RIP    | Exposed Roots / Cambium Damage  |
| 3582    | 2A-B  | Foothills Palo Verde | 12                           | RIP    | Branch Dieback / Cambium Damage |
| 3583    | 2A-B  | Foothills Palo Verde | 18                           | RIP    | Branch Dieback / Cambium Damage |
| 3584    | 2A-B  | Foothills Palo Verde | 8                            | RIP    | Branch Dieback / Cambium Damage |
| 3585    | 2A-B  | Foothills Palo Verde | 12                           | RIP    | Branch Dieback / Cambium Damage |

| Plant # | Phase | Common Name          | Caliper (in)/<br>Height (ft) | Status | Comments                        |
|---------|-------|----------------------|------------------------------|--------|---------------------------------|
| 3586    | 2A-B  | Foothills Palo Verde | 14                           | RIP    | Branch Dieback / Cambium Damage |
| 3587    | 2A-B  | Foothills Palo Verde | 8                            | RIP    |                                 |
| 3588    | 2A-B  | Foothills Palo Verde | 8                            | NS     | In Wash / Cambium Damage        |
| 3589    | 2A-B  | Foothills Palo Verde | 12                           | RIP    |                                 |
| 3590    | 2A-B  | Foothills Palo Verde | 6                            | S      |                                 |
| 3591    | 2A-B  | Foothills Palo Verde | 14                           | NS     | Branch Dieback / Cambium Damage |
| 3592    | 2A-B  | Foothills Palo Verde | 6                            | NS     | Branch Dieback / Cambium Damage |
| 3593    | 2A-B  | Barrel               | 4                            | S      |                                 |
| 3594    | 2A-B  | Foothills Palo Verde | 12                           | NS     | Branch Dieback / Cambium Damage |
| 3595    | 2A-B  | Foothills Palo Verde | 14                           | NS     | Branch Dieback / Cambium Damage |
| 3596    | 2A-B  | Foothills Palo Verde | 6                            | S      |                                 |
| 3597    | 2A-B  | Foothills Palo Verde | 6                            | S      |                                 |
| 3598    | 2A-B  | Foothills Palo Verde | 6                            | S      |                                 |
| 3599    | 2A-B  | Foothills Palo Verde | 6                            | NS     | Branch Dieback / Cambium Damage |
| 3600    | 2A-B  | Foothills Palo Verde | 10                           | NS     | Branch Dieback / Cambium Damage |
| 3601    | 2A-B  | Foothills Palo Verde | 7                            | S      |                                 |
| 3602    | 2A-B  | Foothills Palo Verde | 12                           | S      |                                 |
| 3603    | 2A-B  | Foothills Palo Verde | 8                            | RIP    | In Wash / Root Growth           |
| 3604    | 2A-B  | Foothills Palo Verde | 12                           | RIP    | In Wash / Root Growth           |
| 3605    | 2A-B  | Foothills Palo Verde | 8                            | NS     | Exposed Roots / Root Growth     |
| 3606    | 2A-B  | Foothills Palo Verde | 20                           | NS     | Branch Dieback / Cambium Damage |
| 3607    | 2A-B  | Foothills Palo Verde | 10                           | NS     | In Wash / Root Growth           |
| 3608    | 2A-B  | Foothills Palo Verde | 6                            | NS     | Trunk Form / Root Growth        |
| 3609    | 2A-B  | Saguaro              | 19                           | S      |                                 |
| 3610    | 2A-B  | Foothills Palo Verde | 6                            | S      |                                 |
| 3611    | 2A-B  | Foothills Palo Verde | 12                           | NS     | Branch Dieback / Cambium Damage |
| 3612    | 2A-B  | Foothills Palo Verde | 8                            | NS     | Leaning / Cambium Damage        |
| 3613    | 2A-B  | Foothills Palo Verde | 10                           | NS     | Leaning / Cambium Damage        |
| 3614    | 2A-B  | Foothills Palo Verde | 10                           | NS     | Leaning / Cambium Damage        |
| 3615    | 2A-B  | Foothills Palo Verde | 5                            | S      |                                 |
| 3616    | 2A-B  | Foothills Palo Verde | 7                            | NS     | Trunk Form / Root Growth        |
| 3617    | 2A-B  | Foothills Palo Verde | 7                            | NS     | Trunk Form / Root Growth        |
| 3618    | 2A-B  | Foothills Palo Verde | 8                            | NS     | Trunk Form / Root Growth        |
| 3619    | 2A-B  | Foothills Palo Verde | 12                           | NS     | Trunk Form / Root Growth        |
| 3620    | 2A-B  | Foothills Palo Verde | 6                            | NS     | Trunk Form / Root Growth        |
| 3621    | 2A-B  | Foothills Palo Verde | 10                           | RIP    | Trunk Form / Root Growth        |
| 3622    | 2A-B  | Foothills Palo Verde | 6                            | RIP    | Declining / Cambium Damage      |
| 3623    | 2A-B  | Foothills Palo Verde | 4                            | RIP    | In Rocks                        |
| 3624    | 2A-B  | Foothills Palo Verde | 10                           | NS     | In Rocks                        |
| 3625    | 2A-B  | Foothills Palo Verde | 10                           | NS     | In Rocks                        |
| 3626    | 2A-B  | Foothills Palo Verde | 5                            | NS     | Branch Dieback / Cambium Damage |
| 3627    | 2A-B  | Foothills Palo Verde | 6                            | RIP    | Branch Dieback / Cambium Damage |
| 3628    | 2A-B  | Foothills Palo Verde | 6                            | RIP    | Branch Dieback / Cambium Damage |
| 3629    | 2A-B  | Foothills Palo Verde | 12                           | RIP    |                                 |
| 3630    | 2A-B  | Foothills Palo Verde | 16                           | NS     | Branch Dieback                  |
| 3631    | 2A-B  | Foothills Palo Verde | 5                            | RIP    | Exposed Roots                   |
| 3632    | 2A-B  | Foothills Palo Verde | 14                           | NS     | Branch Dieback / Cambium Damage |
| 3633    | 2A-B  | Foothills Palo Verde | 10                           | NS     | Branch Dieback / Cambium Damage |
| 3634    | 2A-B  | Crucifixion Thorn    | 14                           | NS     | Branch Dieback / Cambium Damage |

| Plant # | Phase | Common Name          | Caliper (in)/<br>Height (ft) | Status | Comments                        |
|---------|-------|----------------------|------------------------------|--------|---------------------------------|
| 3635    | 2A-B  | Crucifixion Thorn    | 14                           | RIP    | Branch Dieback / Cambium Damage |
| 3636    | 2A-B  | Crucifixion Thorn    | 12                           | NS     | Branch Dieback / Cambium Damage |
| 3637    | 2A-B  | Crucifixion Thorn    | 14                           | NS     | Exposed Roots / Cambium Damage  |
| 3638    | 2A-B  | Crucifixion Thorn    | 10                           | NS     | Exposed Roots / Cambium Damage  |
| 3639    | 2A-B  | Crucifixion Thorn    | 14                           | NS     | Trunk Form / Root Growth        |
| 3640    | 2A-B  | Crucifixion Thorn    | 8                            | RIP    |                                 |
| 3641    | 2A-B  | Crucifixion Thorn    | 5                            | S      |                                 |
| 3642    | 2A-B  | Crucifixion Thorn    | 6                            | S      |                                 |
| 3643    | 2A-B  | Barrel               | 5                            | S      |                                 |
| 3644    | 2A-B  | Crucifixion Thorn    | 5                            | RIP    |                                 |
| 3645    | 2A-B  | Barrel               | 4                            | S      |                                 |
| 3646    | 2A-B  | Saguaro              | 118                          | NS     | 15 arms / Damaged               |
| 3647    | 2A-B  | Foothills Palo Verde | 6                            | NS     | Mistletoe / Cambium Damage      |
| 3648    | 2A-B  | Foothills Palo Verde | 5                            | NS     | Branch Dieback / Cambium Damage |
| 3649    | 2A-B  | Foothills Palo Verde | 6                            | S      |                                 |
| 3650    | 2A-B  | Foothills Palo Verde | 6                            | S      |                                 |
| 3651    | 2A-B  | Foothills Palo Verde | 6                            | S      |                                 |
| 3652    | 2A-B  | Foothills Palo Verde | 10                           | RIP    | Exposed Roots / Cambium Damage  |
| 3653    | 2A-B  | Foothills Palo Verde | 8                            | RIP    | Exposed Roots / Cambium Damage  |
| 3654    | 2A-B  | Foothills Palo Verde | 12                           | S      |                                 |
| 3655    | 2A-B  | Foothills Palo Verde | 8                            | NS     | Branch Dieback                  |
| 3656    | 2A-B  | Foothills Palo Verde | 8                            | S      |                                 |
| 3657    | 2A-B  | Foothills Palo Verde | 9                            | S      |                                 |
| 3658    | 2A-B  | Foothills Palo Verde | 5                            | NS     | In Wash / Root Growth           |
| 3659    | 2A-B  | Foothills Palo Verde | 7                            | NS     | In Wash / Root Growth           |
| 3660    | 2A-B  | Foothills Palo Verde | 7                            | NS     | In Wash / Root Growth           |
| 3661    | 2A-B  | Foothills Palo Verde | 14                           | NS     | Branch Dieback / Cambium Damage |
| 3662    | 2A-B  | Foothills Palo Verde | 6                            | NS     | In Rocks / Cambium Damage       |
| 3663    | 2A-B  | Foothills Palo Verde | 14                           | NS     | Branch Dieback / Cambium Damage |
| 3664    | 2A-B  | Foothills Palo Verde | 14                           | S      |                                 |
| 3665    | 2A-B  | Saguaro              | 5                            | S      |                                 |
| 3666    | 2A-B  | Foothills Palo Verde | 14                           | NS     | Branch Dieback                  |
| 3667    | 2A-B  | Mesquite             | 8                            | NS     | Branch Dieback                  |
| 3668    | 2A-B  | Foothills Palo Verde | 7                            | S      |                                 |
| 3669    | 2A-B  | Foothills Palo Verde | 5                            | S      |                                 |
| 3670    | 2A-B  | Foothills Palo Verde | 6                            | NS     | Trunk Form / Leaning            |
| 3671    | 2A-B  | Foothills Palo Verde | 10                           | NS     | In Rocks                        |
| 3672    | 2A-B  | Foothills Palo Verde | 8                            | NS     | In Rocks                        |
| 3673    | 2A-B  | Foothills Palo Verde | 4                            | S      |                                 |
| 3674    | 2A-B  | Foothills Palo Verde | 8                            | S      |                                 |
| 3675    | 2A-B  | Foothills Palo Verde | 7                            | S      |                                 |
| 3676    | 2A-B  | Foothills Palo Verde | 5                            | NS     | Trunk Form / Leaning            |
| 3677    | 2A-B  | Foothills Palo Verde | 8                            | S      |                                 |
| 3678    | 2A-B  | Saguaro              | 5                            | S      |                                 |
| 3679    | 2A-B  | Foothills Palo Verde | 6                            | S      | Prune Mistletoe                 |
| 3680    | 2A-B  | Foothills Palo Verde | 7                            | NS     | In Wash / In Rocks              |
| 3681    | 2A-B  | Foothills Palo Verde | 8                            | S      |                                 |
| 3682    | 2A-B  | Foothills Palo Verde | 5                            | NS     | Branch Dieback                  |
| 3683    | 2A-B  | Foothills Palo Verde | 5                            | NS     | Branch Dieback / Cambium Damage |



| Plant # | Phase | Common Name          | Caliper (in)/<br>Height (ft) | Status | Comments                        |
|---------|-------|----------------------|------------------------------|--------|---------------------------------|
| 3684    | 2A-B  | Saguaro              | 3                            | S      |                                 |
| 3685    | 2A-B  | Foothills Palo Verde | 4                            | S      |                                 |
| 3686    | 2A-B  | Foothills Palo Verde | 7                            | NS     | Branch Dieback                  |
| 3687    | 2A-B  | Foothills Palo Verde | 7                            | NS     | Trunk Form / Leaning            |
| 3688    | 2A-B  | Foothills Palo Verde | 8                            | NS     | Declining / Branch Dieback      |
| 3689    | 2A-B  | Foothills Palo Verde | 8                            | NS     | In Wash / Branch Dieback        |
| 3690    | 2A-B  | Foothills Palo Verde | 4                            | NS     | In Wash / Cambium Damage        |
| 3691    | 2A-B  | Foothills Palo Verde | 9                            | S      |                                 |
| 3692    | 2A-B  | Foothills Palo Verde | 12                           | RIP    | Branch Dieback                  |
| 3693    | 2A-B  | Foothills Palo Verde | 12                           | NS     | Branch Dieback / Cambium Damage |
| 3694    | 2A-B  | Foothills Palo Verde | 4                            | S      |                                 |
| 3695    | 2A-B  | Barrel               | 3                            | RIP    |                                 |
| 3696    | 2A-B  | Foothills Palo Verde | 6                            | RIP    | Declining / Cambium Damage      |
| 3697    | 2A-B  | Foothills Palo Verde | 6                            | RIP    |                                 |
| 3698    | 2A-B  | Foothills Palo Verde | 6                            | RIP    |                                 |
| 3699    | 2A-B  | Foothills Palo Verde | 6                            | NS     | Trunk Form / Root Growth        |
| 3700    | 2A-B  | Foothills Palo Verde | 14                           | NS     | Branch Dieback                  |
| 3701    | 2A-B  | Hackberry            | 20                           | NS     | Wide Base                       |
| 3702    | 2A-B  | Foothills Palo Verde | 16                           | NS     | Branch Dieback / Cambium Damage |
| 3703    | 2A-B  | Foothills Palo Verde | 7                            | NS     | Exposed Roots / Cambium Damage  |
| 3704    | 2A-B  | Foothills Palo Verde | 12                           | NS     | Branch Dieback / Cambium Damage |
| 3705    | 2A-B  | Foothills Palo Verde | 8                            | NS     | Exposed Roots / Root Growth     |
| 3706    | 2A-B  | Foothills Palo Verde | 10                           | NS     | Exposed Roots / Root Growth     |
| 3707    | 2A-B  | Foothills Palo Verde | 6                            | S      |                                 |
| 3708    | 2A-B  | Foothills Palo Verde | 22                           | S      |                                 |
| 3709    | 2A-B  | Foothills Palo Verde | 5                            | S      |                                 |
| 3710    | 2A-B  | Barrel               | 3                            | NS     | Damaged                         |
| 3711    | 2A-B  | Foothills Palo Verde | 15                           | NS     | Branch Dieback                  |
| 3712    | 2A-B  | Foothills Palo Verde | 8                            | NS     | Branch Dieback / Cambium Damage |
| 3713    | 2A-B  | Foothills Palo Verde | 10                           | NS     | Branch Dieback / Cambium Damage |
| 3714    | 2A-B  | Foothills Palo Verde | 8                            | NS     | Exposed Roots / Cambium Damage  |
| 3715    | 2A-B  | Foothills Palo Verde | 9                            | NS     | Mistletoe / Cambium Damage      |
| 3716    | 2A-B  | Foothills Palo Verde | 5                            | NS     | Branch Dieback / Cambium Damage |
| 3717    | 2A-B  | Foothills Palo Verde | 10                           | RIP    | Branch Dieback / Cambium Damage |
| 3718    | 2A-B  | Foothills Palo Verde | 22                           | NS     | Branch Dieback / Cambium Damage |
| 3719    | 2A-B  | Foothills Palo Verde | 13                           | S      |                                 |
| 3720    | 2A-B  | Foothills Palo Verde | 7                            | NS     | Declining / Cambium Damage      |
| 3721    | 2A-B  | Foothills Palo Verde | 6                            | S      |                                 |
| 3722    | 2A-B  | Foothills Palo Verde | 5                            | S      |                                 |
| 3723    | 2A-B  | Barrel               | 3                            | S      |                                 |
| 3724    | 2A-B  | Foothills Palo Verde | 20                           | NS     | Branch Dieback                  |
| 3725    | 2A-B  | Foothills Palo Verde | 16                           | NS     | Exposed Roots                   |
| 3726    | 2A-B  | Foothills Palo Verde | 20                           | NS     | Exposed Roots                   |
| 3727    | 2A-B  | Foothills Palo Verde | 20                           | NS     | In Rocks / Shallow Roots        |
| 3728    | 2A-B  | Foothills Palo Verde | 4                            | S      |                                 |
| 3729    | 2A-B  | Saguaro              | 20                           | S      | 4 arms                          |
| 3730    | 2A-B  | Foothills Palo Verde | 6                            | NS     | Mistletoe / Cambium Damage      |
| 3731    | 2A-B  | Foothills Palo Verde | 8                            | S      |                                 |
| 3732    | 2A-B  | Barrel               | 3                            | NS     | Declining                       |

| Plant # | Phase | Common Name          | Caliper (in)/<br>Height (ft) | Status | Comments                        |
|---------|-------|----------------------|------------------------------|--------|---------------------------------|
| 3733    | 2A-B  | Barrel               | 4                            | S      |                                 |
| 3734    | 2A-B  | Foothills Palo Verde | 8                            | NS     | In Rocks                        |
| 3735    | 2A-B  | Foothills Palo Verde | 10                           | NS     | In Rocks                        |
| 3736    | 2A-B  | Foothills Palo Verde | 8                            | NS     | In Rocks / Leaning              |
| 3737    | 2A-B  | Foothills Palo Verde | 4                            | S      |                                 |
| 3738    | 2A-B  | Foothills Palo Verde | 8                            | S      |                                 |
| 3739    | 2A-B  | Foothills Palo Verde | 4                            | S      |                                 |
| 3740    | 2A-B  | Foothills Palo Verde | 6                            | S      |                                 |
| 3741    | 2A-B  | Hackberry            | 60                           | NS     | Wide Base                       |
| 3742    | 2A-B  | Foothills Palo Verde | 6                            | S      |                                 |
| 3743    | 2A-B  | Foothills Palo Verde | 8                            | S      |                                 |
| 3744    | 2A-B  | Foothills Palo Verde | 8                            | S      |                                 |
| 3745    | 2A-B  | Foothills Palo Verde | 5                            | S      |                                 |
| 3746    | 2A-B  | Foothills Palo Verde | 10                           | S      |                                 |
| 3747    | 2A-B  | Foothills Palo Verde | 10                           | NS     | Trunk Form / Poor Structure     |
| 3748    | 2A-B  | Foothills Palo Verde | 12                           | NS     | Branch Dieback                  |
| 3749    | 2A-B  | Foothills Palo Verde | 10                           | S      |                                 |
| 3750    | 2A-B  | Foothills Palo Verde | 6                            | S      |                                 |
| 3751    | 2A-B  | Foothills Palo Verde | 8                            | S      |                                 |
| 3752    | 2A-B  | Foothills Palo Verde | 12                           | NS     | Trunk Form / Leaning            |
| 3753    | 2A-B  | Foothills Palo Verde | 10                           | NS     | Exposed Roots / Leaning         |
| 3754    | 2A-B  | Foothills Palo Verde | 10                           | NS     | Exposed Roots                   |
| 3755    | 2A-B  | Foothills Palo Verde | 22                           | NS     | Mistletoe                       |
| 3756    | 2A-B  | Foothills Palo Verde | 24                           | NS     | Branch Dieback                  |
| 3757    | 2A-B  | Foothills Palo Verde | 10                           | S      |                                 |
| 3758    | 2A-B  | Foothills Palo Verde | 10                           | NS     | Trunk Form / Leaning            |
| 3759    | 2A-B  | Foothills Palo Verde | 30                           | NS     | Trunk Form / Poor Structure     |
| 3760    | 2A-B  | Foothills Palo Verde | 12                           | NS     | Trunk Form / Leaning            |
| 3761    | 2A-B  | Foothills Palo Verde | 8                            | S      |                                 |
| 3762    | 2A-B  | Foothills Palo Verde | 12                           | NS     | Mistletoe                       |
| 3763    | 2A-B  | Foothills Palo Verde | 8                            | NS     | Branch Dieback / Cambium Damage |
| 3764    | 2A-B  | Foothills Palo Verde | 6                            | S      |                                 |
| 3765    | 2A-B  | Foothills Palo Verde | 8                            | NS     | Declining / Branch Dieback      |
| 3766    | 2A-B  | Foothills Palo Verde | 4                            | S      |                                 |
| 3767    | 2A-B  | Hackberry            | 28                           | NS     | Wide Base                       |
| 3768    | 2A-B  | Foothills Palo Verde | 20                           | RIP    | Branch Dieback                  |
| 3769    | 2A-B  | Foothills Palo Verde | 6                            | RIP    |                                 |
| 3770    | 2A-B  | Foothills Palo Verde | 4                            | RIP    |                                 |
| 3771    | 2A-B  | Foothills Palo Verde | 20                           | S      |                                 |
| 3772    | 2A-B  | Foothills Palo Verde | 16                           | RIP    |                                 |
| 3773    | 2A-B  | Foothills Palo Verde | 8                            | S      |                                 |
| 3774    | 2A-B  | Hackberry            | 20                           | NS     | Wide Base                       |
| 3775    | 2A-B  | Foothills Palo Verde | 20                           | NS     | Mistletoe / Cambium Damage      |
| 3776    | 2A-B  | Foothills Palo Verde | 16                           | NS     | Branch Dieback / Cambium Damage |
| 3777    | 2A-B  | Foothills Palo Verde | 5                            | NS     | Branch Dieback / Cambium Damage |
| 3778    | 2A-B  | Foothills Palo Verde | 7                            | S      |                                 |
| 3779    | 2A-B  | Foothills Palo Verde | 9                            | S      |                                 |
| 3780    | 2A-B  | Foothills Palo Verde | 8                            | S      |                                 |
| 3781    | 2A-B  | Foothills Palo Verde | 7                            | S      |                                 |

| Plant # | Phase | Common Name          | Caliper (in)/<br>Height (ft) | Status | Comments                        |
|---------|-------|----------------------|------------------------------|--------|---------------------------------|
| 3782    | 2A-B  | Foothills Palo Verde | 8                            | S      |                                 |
| 3783    | 2A-B  | Foothills Palo Verde | 14                           | NS     | Branch Dieback                  |
| 3784    | 2A-B  | Foothills Palo Verde | 14                           | NS     | Branch Dieback                  |
| 3785    | 2A-B  | Foothills Palo Verde | 12                           | NS     | Branch Dieback                  |
| 3786    | 2A-B  | Foothills Palo Verde | 7                            | S      |                                 |
| 3787    | 2A-B  | Foothills Palo Verde | 8                            | S      |                                 |
| 3788    | 2A-B  | Foothills Palo Verde | 6                            | S      |                                 |
| 3789    | 2A-B  | Foothills Palo Verde | 6                            | NS     | Leaning / Cambium Damage        |
| 3790    | 2A-B  | Foothills Palo Verde | 7                            | NS     | Leaning / Cambium Damage        |
| 3791    | 2A-B  | Foothills Palo Verde | 14                           | NS     | Branch Dieback / Cambium Damage |
| 3792    | 2A-B  | Foothills Palo Verde | 4                            | NS     | Branch Dieback / Cambium Damage |
| 3793    | 2A-B  | Foothills Palo Verde | 7                            | NS     | Branch Dieback / Cambium Damage |
| 3794    | 2A-B  | Foothills Palo Verde | 12                           | NS     | Branch Dieback / Cambium Damage |
| 3795    | 2A-B  | Foothills Palo Verde | 7                            | S      |                                 |
| 3796    | 2A-B  | Foothills Palo Verde | 4                            | S      |                                 |
| 3797    | 2A-B  | Foothills Palo Verde | 5                            | S      |                                 |
| 3798    | 2A-B  | Foothills Palo Verde | 6                            | S      |                                 |
| 3799    | 2A-B  | Foothills Palo Verde | 4                            | S      |                                 |
| 3800    | 2A-B  | Foothills Palo Verde | 7                            | S      |                                 |
| 3801    | 2A-B  | Foothills Palo Verde | 14                           | S      |                                 |
| 3802    | 2A-B  | Foothills Palo Verde | 9                            | S      |                                 |
| 3803    | 2A-B  | Foothills Palo Verde | 12                           | S      |                                 |
| 3804    | 2A-B  | Foothills Palo Verde | 20                           | NS     | Branch Dieback / Cambium Damage |
| 3805    | 2A-B  | Hackberry            | 30                           | NS     | Wide Base / Cambium Damage      |
| 3806    | 2A-B  | Hackberry            | 40                           | NS     | Wide Base / Cambium Damage      |
| 3807    | 2A-B  | Foothills Palo Verde | 6                            | NS     | Branch Dieback                  |
| 3808    | 2A-B  | Foothills Palo Verde | 13                           | S      |                                 |
| 3809    | 2A-B  | Foothills Palo Verde | 8                            | S      |                                 |
| 3810    | 2A-B  | Mesquite             | 7                            | NS     | Branch Dieback                  |
| 3811    | 2A-B  | Foothills Palo Verde | 7                            | S      |                                 |
| 3812    | 2A-B  | Foothills Palo Verde | 4                            | NS     | Trunk Form / Leaning            |
| 3813    | 2A-B  | Mesquite             | 20                           | NS     | Branch Dieback                  |
| 3814    | 2A-B  | Foothills Palo Verde | 4                            | S      |                                 |
| 3815    | 2A-B  | Foothills Palo Verde | 20                           | NS     | Branch Dieback                  |
| 3816    | 2A-B  | Foothills Palo Verde | 6                            | RIP    |                                 |
| 3817    | 2A-B  | Foothills Palo Verde | 6                            | RIP    |                                 |
| 3818    | 2A-B  | Foothills Palo Verde | 8                            | RIP    | Exposed Roots                   |
| 3819    | 2A-B  | Foothills Palo Verde | 6                            | RIP    | Exposed Roots                   |
| 3820    | 2A-B  | Foothills Palo Verde | 6                            | RIP    | Exposed Roots                   |
| 3821    | 2A-B  | Foothills Palo Verde | 8                            | RIP    | Exposed Roots                   |
| 3822    | 2A-B  | Foothills Palo Verde | 6                            | RIP    | Exposed Roots                   |
| 3823    | 2A-B  | Foothills Palo Verde | 8                            | RIP    | Trunk Form / Leaning            |
| 3824    | 2A-B  | Foothills Palo Verde | 5                            | RIP    | Trunk Form / Leaning            |
| 3825    | 2A-B  | Blue Palo Verde      | 7                            | RIP    | Branch Dieback / Leaning        |
| 3826    | 2A-B  | Foothills Palo Verde | 7                            | RIP    |                                 |
| 3827    | 2A-B  | Foothills Palo Verde | 7                            | S      |                                 |
| 3828    | 2A-B  | Foothills Palo Verde | 20                           | NS     | Branch Dieback / Cambium Damage |
| 3829    | 2A-B  | Foothills Palo Verde | 8                            | S      |                                 |
| 3830    | 2A-B  | Foothills Palo Verde | 4                            | S      |                                 |

| Plant # | Phase | Common Name          | Caliper (in)/<br>Height (ft) | Status | Comments                        |
|---------|-------|----------------------|------------------------------|--------|---------------------------------|
| 3831    | 2A-B  | Mesquite             | 20                           | NS     | Branch Dieback                  |
| 3832    | 2A-B  | Foothills Palo Verde | 7                            | NS     | Branch Dieback / Cambium Damage |
| 3833    | 2A-B  | Foothills Palo Verde | 4                            | S      |                                 |
| 3834    | 2A-B  | Foothills Palo Verde | 7                            | S      |                                 |
| 3835    | 2A-B  | Foothills Palo Verde | 18                           | S      |                                 |
| 3836    | 2A-B  | Foothills Palo Verde | 22                           | S      |                                 |
| 3837    | 2A-B  | Foothills Palo Verde | 4                            | NS     | Trunk Form / Root Growth        |
| 3838    | 2A-B  | Foothills Palo Verde | 7                            | S      |                                 |
| 3839    | 2A-B  | Foothills Palo Verde | 7                            | NS     | Exposed Roots                   |
| 3840    | 2A-B  | Foothills Palo Verde | 5                            | S      |                                 |
| 3841    | 2A-B  | Hackberry            | 8                            | NS     | Branch Dieback / Cambium Damage |
| 3842    | 2A-B  | Foothills Palo Verde | 7                            | S      |                                 |
| 3843    | 2A-B  | Foothills Palo Verde | 26                           | NS     | Exposed Roots / Cambium Damage  |
| 3844    | 2A-B  | Foothills Palo Verde | 20                           | NS     | Branch Dieback / Cambium Damage |
| 3845    | 2A-B  | Foothills Palo Verde | 4                            | S      |                                 |
| 3846    | 2A-B  | Hackberry            | 18                           | RIP    | Wide Base                       |
| 3847    | 2A-B  | Foothills Palo Verde | 20                           | RIP    | Wide Base                       |
| 3848    | 2A-B  | Hackberry            | 16                           | RIP    | Wide Base                       |
| 3849    | 2A-B  | Hackberry            | 8                            | NS     | Branch Dieback                  |
| 3850    | 2A-B  | Foothills Palo Verde | 14                           | S      |                                 |
| 3851    | 2A-B  | Foothills Palo Verde | 5                            | S      |                                 |
| 3852    | 2A-B  | Barrel               | 3                            | S      |                                 |
| 3853    | 2A-B  | Foothills Palo Verde | 4                            | S      |                                 |
| 3854    | 2A-B  | Foothills Palo Verde | 18                           | NS     | Branch Dieback / Cambium Damage |
| 3855    | 2A-B  | Foothills Palo Verde | 7                            | S      |                                 |
| 3856    | 2A-B  | Foothills Palo Verde | 20                           | NS     | Mistletoe / Cambium Damage      |
| 3857    | 2A-B  | Foothills Palo Verde | 4                            | S      |                                 |
| 3858    | 2A-B  | Foothills Palo Verde | 6                            | RIP    |                                 |
| 3859    | 2A-B  | Foothills Palo Verde | 8                            | RIP    | Branch Dieback                  |
| 3860    | 2A-B  | Foothills Palo Verde | 6                            | S      |                                 |
| 3861    | 2A-B  | Hackberry            | 20                           | RIP    | Branch Dieback                  |
| 3862    | 2A-B  | Foothills Palo Verde | 14                           | RIP    |                                 |
| 3863    | 2A-B  | Foothills Palo Verde | 8                            | RIP    | Trunk Form / Leaning            |
| 3864    | 2A-B  | Foothills Palo Verde | 10                           | RIP    | Trunk Form / Leaning            |
| 3865    | 2A-B  | Foothills Palo Verde | 22                           | RIP    | Branch Dieback / Cambium Damage |
| 3866    | 2A-B  | Mesquite             | 8                            | RIP    | Branch Dieback / Cambium Damage |
| 3867    | 2A-B  | Foothills Palo Verde | 8                            | RIP    | Trunk Form / Leaning            |
| 3868    | 2A-B  | Foothills Palo Verde | 20                           | RIP    | Branch Dieback / Cambium Damage |
| 3869    | 2A-B  | Foothills Palo Verde | 14                           | RIP    | Branch Dieback / Cambium Damage |
| 3870    | 2A-B  | Foothills Palo Verde | 8                            | RIP    |                                 |
| 3871    | 2A-B  | Foothills Palo Verde | 10                           | RIP    | Branch Dieback                  |
| 3872    | 2A-B  | Foothills Palo Verde | 12                           | RIP    | Branch Dieback                  |
| 3873    | 2A-B  | Foothills Palo Verde | 12                           | RIP    | Branch Dieback / Cambium Damage |
| 3874    | 2A-B  | Foothills Palo Verde | 18                           | RIP    | Branch Dieback / Cambium Damage |
| 3875    | 2A-B  | Foothills Palo Verde | 14                           | RIP    | Branch Dieback / Cambium Damage |
| 3876    | 2A-B  | Foothills Palo Verde | 8                            | RIP    | Trunk Form / Poor Structure     |
| 3877    | 2A-B  | Foothills Palo Verde | 8                            | RIP    | Leaning / Cambium Damage        |
| 3878    | 2A-B  | Foothills Palo Verde | 4                            | RIP    | Mistletoe                       |
| 3879    | 2A-B  | Foothills Palo Verde | 8                            | S      |                                 |

| Plant # | Phase | Common Name          | Caliper (in)/<br>Height (ft) | Status | Comments                        |
|---------|-------|----------------------|------------------------------|--------|---------------------------------|
| 3880    | 2A-B  | Foothills Palo Verde | 7                            | NS     | Trunk Form / Leaning            |
| 3881    | 2A-B  | Foothills Palo Verde | 20                           | NS     | Branch Dieback                  |
| 3882    | 2A-B  | Foothills Palo Verde | 14                           | NS     | Branch Dieback                  |
| 3883    | 2A-B  | Hackberry            | 20                           | NS     | Wide Base                       |
| 3884    | 2A-B  | Foothills Palo Verde | 7                            | S      |                                 |
| 3885    | 2A-B  | Foothills Palo Verde | 6                            | S      |                                 |
| 3886    | 2A-B  | Foothills Palo Verde | 6                            | NS     | Declining                       |
| 3887    | 2A-B  | Foothills Palo Verde | 5                            | RIP    |                                 |
| 3888    | 2A-B  | Mesquite             | 8                            | RIP    | Branch Dieback                  |
| 3889    | 2A-B  | Foothills Palo Verde | 22                           | RIP    | Branch Dieback                  |
| 3890    | 2A-B  | Foothills Palo Verde | 7                            | RIP    |                                 |
| 3891    | 2A-B  | Foothills Palo Verde | 11                           | RIP    |                                 |
| 3892    | 2A-B  | Foothills Palo Verde | 12                           | NS     | Branch Dieback / Cambium Damage |
| 3893    | 2A-B  | Foothills Palo Verde | 9                            | RIP    |                                 |
| 3894    | 2A-B  | Saguaro              | 3                            | RIP    |                                 |
| 3895    | 2A-B  | Foothills Palo Verde | 4                            | RIP    | Exposed Roots / In Wash         |
| 3896    | 2A-B  | Foothills Palo Verde | 4                            | NS     | Exposed Roots                   |
| 3897    | 2A-B  | Foothills Palo Verde | 10                           | NS     | Trunk Form / Root Growth        |
| 3898    | 2A-B  | Foothills Palo Verde | 8                            | NS     | Trunk Form / Root Growth        |
| 3899    | 2A-B  | Foothills Palo Verde | 6                            | NS     | In Wash / Root Growth           |
| 3900    | 2A-B  | Foothills Palo Verde | 7                            | S      |                                 |
| 3901    | 2A-B  | Foothills Palo Verde | 8                            | RIP    | Trunk Form / Leaning            |
| 3902    | 2A-B  | Foothills Palo Verde | 8                            | RIP    | Trunk Form / Leaning            |
| 3903    | 2A-B  | Foothills Palo Verde | 8                            | NS     | Exposed Roots / Leaning         |
| 3904    | 2A-B  | Foothills Palo Verde | 20                           | NS     | Branch Dieback                  |
| 3905    | 2A-B  | Foothills Palo Verde | 16                           | NS     | Mistletoe / Cambium Damage      |
| 3906    | 2A-B  | Foothills Palo Verde | 16                           | NS     | Exposed Roots / Cambium Damage  |
| 3907    | 2A-B  | Foothills Palo Verde | 5                            | RIP    | Exposed Roots                   |
| 3908    | 2A-B  | Foothills Palo Verde | 6                            | NS     | Trunk Form / Root Growth        |
| 3909    | 2A-B  | Foothills Palo Verde | 6                            | NS     | In Wash / Declining             |
| 3910    | 2A-B  | Foothills Palo Verde | 8                            | NS     | Exposed Roots / Declining       |
| 3911    | 2A-B  | Foothills Palo Verde | 4                            | S      |                                 |
| 3912    | 2A-B  | Foothills Palo Verde | 5                            | S      |                                 |
| 3913    | 2A-B  | Foothills Palo Verde | 7                            | S      |                                 |
| 3914    | 2A-B  | Foothills Palo Verde | 7                            | NS     | Mistletoe                       |
| 3915    | 2A-B  | Foothills Palo Verde | 12                           | NS     | Branch Dieback / Cambium Damage |
| 3916    | 2A-B  | Foothills Palo Verde | 14                           | S      |                                 |
| 3917    | 2A-B  | Mesquite             | 10                           | NS     | Branch Dieback                  |
| 3918    | 2A-B  | Foothills Palo Verde | 10                           | NS     | Branch Dieback                  |
| 3919    | 2A-B  | Mesquite             | 14                           | NS     | Branch Dieback                  |
| 3920    | 2A-B  | Foothills Palo Verde | 4                            | NS     | Trunk Form / Root Growth        |
| 3921    | 2A-B  | Foothills Palo Verde | 6                            | S      |                                 |
| 3922    | 2A-B  | Foothills Palo Verde | 7                            | RIP    |                                 |
| 3923    | 2A-B  | Foothills Palo Verde | 8                            | RIP    |                                 |
| 3924    | 2A-B  | Foothills Palo Verde | 14                           | RIP    |                                 |
| 3925    | 2A-B  | Foothills Palo Verde | 8                            | RIP    | Exposed Roots                   |
| 3926    | 2A-B  | Foothills Palo Verde | 5                            | RIP    | Trunk Form / Cambium Damage     |
| 3927    | 2A-B  | Foothills Palo Verde | 10                           | NS     | Branch Dieback / Cambium Damage |
| 3928    | 2A-B  | Foothills Palo Verde | 10                           | S      |                                 |

| Plant # | Phase | Common Name          | Caliper (in)/<br>Height (ft) | Status | Comments                        |
|---------|-------|----------------------|------------------------------|--------|---------------------------------|
| 3929    | 2A-B  | Foothills Palo Verde | 28                           | NS     | Trunk Form / Poor Structure     |
| 3930    | 2A-B  | Foothills Palo Verde | 30                           | NS     | Branch Dieback                  |
| 3931    | 2A-B  | Foothills Palo Verde | 18                           | S      |                                 |
| 3932    | 2A-B  | Foothills Palo Verde | 10                           | S      |                                 |
| 3933    | 2A-B  | Foothills Palo Verde | 14                           | S      |                                 |
| 3934    | 2A-B  | Foothills Palo Verde | 16                           | NS     | Branch Dieback / Cambium Damage |
| 3935    | 2A-B  | Foothills Palo Verde | 4                            | NS     | Trunk Form / Leaning            |
| 3936    | 2A-B  | Foothills Palo Verde | 5                            | NS     | Branch Dieback                  |
| 3937    | 2A-B  | Foothills Palo Verde | 10                           | NS     | Exposed Roots                   |
| 3938    | 2A-B  | Saguaro              | 47                           | S      | 6 arms                          |
| 3939    | 2A-B  | Foothills Palo Verde | 20                           | NS     | Mistletoe                       |
| 3940    | 2A-B  | Foothills Palo Verde | 4                            | NS     | Branch Dieback                  |
| 3941    | 2A-B  | Foothills Palo Verde | 7                            | NS     | Trunk Form / Root Growth        |
| 3942    | 2A-B  | Foothills Palo Verde | 5                            | S      |                                 |
| 3943    | 2A-B  | Foothills Palo Verde | 20                           | S      |                                 |
| 3944    | 2A-B  | Foothills Palo Verde | 8                            | S      |                                 |
| 3945    | 2A-B  | Foothills Palo Verde | 8                            | NS     | Branch Dieback / Cambium Damage |
| 3946    | 2A-B  | Foothills Palo Verde | 22                           | RIP    | Form / Poor Structure           |
| 3947    | 2A-B  | Foothills Palo Verde | 24                           | RIP    | Form / Poor Structure           |
| 3948    | 2A-B  | Foothills Palo Verde | 8                            | RIP    |                                 |
| 3949    | 2A-B  | Foothills Palo Verde | 18                           | NS     | Branch Dieback                  |
| 3950    | 2A-B  | Mesquite             | 10                           | NS     | Branch Dieback                  |
| 3951    | 2A-B  | Mesquite             | 22                           | NS     | Branch Dieback                  |
| 3952    | 2A-B  | Mesquite             | 12                           | NS     | Branch Dieback                  |
| 3953    | 2A-B  | Mesquite             | 4                            | S      |                                 |
| 3954    | 2A-B  | Mesquite             | 30                           | NS     | Branch Dieback                  |
| 3955    | 2A-B  | Hackberry            | 35                           | NS     | Wide Base                       |
| 3956    | 2A-B  | Mesquite             | 28                           | NS     | Branch Dieback                  |
| 3957    | 2A-B  | Foothills Palo Verde | 10                           | NS     | Branch Dieback / Cambium Damage |
| 3958    | 2A-B  | Foothills Palo Verde | 7                            | S      |                                 |
| 3959    | 2A-B  | Mesquite             | 28                           | NS     | Exposed Roots                   |
| 3960    | 2A-B  | Foothills Palo Verde | 12                           | RIP    | Branch Dieback                  |
| 3961    | 2A-B  | Mesquite             | 14                           | NS     | Branch Dieback                  |
| 3962    | 2A-B  | Hackberry            | 6                            | NS     | Branch Dieback / Cambium Damage |
| 3963    | 2A-B  | Foothills Palo Verde | 6                            | S      |                                 |
| 3964    | 2A-B  | Foothills Palo Verde | 7                            | S      |                                 |
| 3965    | 2A-B  | Foothills Palo Verde | 9                            | S      |                                 |
| 3966    | 2A-B  | Foothills Palo Verde | 5                            | S      |                                 |
| 3967    | 2A-B  | Foothills Palo Verde | 4                            | S      |                                 |
| 3968    | 2A-B  | Foothills Palo Verde | 22                           | S      |                                 |
| 3969    | 2A-B  | Foothills Palo Verde | 6                            | S      |                                 |
| 3970    | 2A-B  | Foothills Palo Verde | 6                            | NS     | Branch Dieback / Cambium Damage |
| 3971    | 2A-B  | Foothills Palo Verde | 8                            | NS     | Exposed Roots                   |
| 3972    | 2A-B  | Mesquite             | 14                           | RIP    | Branch Dieback                  |
| 3973    | 2A-B  | Foothills Palo Verde | 15                           | RIP    |                                 |
| 3974    | 2A-B  | Foothills Palo Verde | 6                            | RIP    | Trunk Form / Leaning            |
| 3975    | 2A-B  | Foothills Palo Verde | 6                            | NS     | Branch Dieback                  |
| 3976    | 2A-B  | Foothills Palo Verde | 7                            | NS     | Declining / Cambium Damage      |
| 3977    | 2A-B  | Foothills Palo Verde | 8                            | S      |                                 |

| Plant # | Phase | Common Name          | Caliper (in)/<br>Height (ft) | Status | Comments                        |
|---------|-------|----------------------|------------------------------|--------|---------------------------------|
| 3978    | 2A-B  | Foothills Palo Verde | 4                            | S      |                                 |
| 3979    | 2A-B  | Foothills Palo Verde | 6                            | NS     | Branch Dieback / Cambium Damage |
| 3980    | 2A-B  | Foothills Palo Verde | 6                            | NS     | Branch Dieback / Cambium Damage |
| 3981    | 2A-B  | Hackberry            | 70                           | NS     | Wide Base / Cambium Damage      |
| 3982    | 2A-B  | Mesquite             | 28                           | NS     | Branch Dieback / Cambium Damage |
| 3983    | 2A-B  | Foothills Palo Verde | 7                            | S      |                                 |
| 3984    | 2A-B  | Saguaro              | 86                           | NS     | 7 arms / Damaged                |
| 3985    | 2A-B  | Mesquite             | 4                            | NS     | Branch Dieback / Cambium Damage |
| 3986    | 2A-B  | Foothills Palo Verde | 7                            | S      |                                 |
| 3987    | 2A-B  | Foothills Palo Verde | 8                            | S      |                                 |
| 3988    | 2A-B  | Foothills Palo Verde | 11                           | S      |                                 |
| 3989    | 2A-B  | Foothills Palo Verde | 10                           | NS     | Trunk Form / Leaning            |
| 3990    | 2A-B  | Foothills Palo Verde | 10                           | S      |                                 |
| 3991    | 2A-B  | Barrel               | 3                            | S      |                                 |
| 3992    | 2A-B  | Foothills Palo Verde | 15                           | NS     | Exposed Roots                   |
| 3993    | 2A-B  | Hackberry            | 10                           | NS     | Branch Dieback                  |
| 3994    | 2A-B  | Foothills Palo Verde | 8                            | S      |                                 |
| 3995    | 2A-B  | Saguaro              | 132                          | NS     | 26 arms / Damaged               |
| 3996    | 2A-B  | Foothills Palo Verde | 6                            | NS     | In Rocks                        |
| 3997    | 2A-B  | Foothills Palo Verde | 28                           | NS     | Branch Dieback / Cambium Damage |
| 3998    | 2A-B  | Foothills Palo Verde | 20                           | NS     | Branch Dieback / Cambium Damage |
| 3999    | 2A-B  | Foothills Palo Verde | 15                           | NS     | Branch Dieback / Cambium Damage |
| 4000    | 2A-B  | Mesquite             | 10                           | NS     | Branch Dieback / Cambium Damage |
| 4001    | 2A-B  | Foothills Palo Verde | 6                            | S      |                                 |
| 4002    | 2A-B  | Hackberry            | 14                           | RIP    | Branch Dieback                  |
| 4003    | 2A-B  | Hackberry            | 14                           | NS     | Wide Base                       |
| 4004    | 2A-B  | Foothills Palo Verde | 6                            | NS     | Trunk Form / Leaning            |
| 4005    | 2A-B  | Hackberry            | 20                           | RIP    | Wide Base                       |
| 4006    | 2A-B  | Foothills Palo Verde | 8                            | RIP    |                                 |
| 4007    | 2A-B  | Mesquite             | 6                            | RIP    | Branch Dieback                  |
| 4008    | 2A-B  | Hackberry            | 28                           | RIP    | Wide Base                       |
| 4009    | 2A-B  | Hackberry            | 28                           | RIP    | Wide Base                       |
| 4010    | 2A-B  | Foothills Palo Verde | 5                            | RIP    |                                 |
| 4011    | 2A-B  | Foothills Palo Verde | 6                            | S      |                                 |
| 4012    | 2A-B  | Foothills Palo Verde | 4                            | NS     | Trunk Form / Leaning            |
| 4013    | 2A-B  | Foothills Palo Verde | 8                            | S      |                                 |
| 4014    | 2A-B  | Mesquite             | 12                           | NS     | Branch Dieback                  |
| 4015    | 2A-B  | Foothills Palo Verde | 5                            | NS     | Trunk Form / Leaning            |
| 4016    | 2A-B  | Foothills Palo Verde | 9                            | S      |                                 |
| 4017    | 2A-B  | Hackberry            | 25                           | NS     | Branch Dieback                  |
| 4018    | 2A-B  | Mesquite             | 8                            | RIP    | Branch Dieback / Cambium Damage |
| 4019    | 2A-B  | Foothills Palo Verde | 12                           | RIP    |                                 |
| 4020    | 2A-B  | Foothills Palo Verde | 24                           | NS     | Branch Dieback / Cambium Damage |
| 4021    | 2A-B  | Foothills Palo Verde | 12                           | NS     | Branch Dieback / Shallow Roots  |
| 4022    | 2A-B  | Foothills Palo Verde | 14                           | NS     | Branch Dieback / Leaning        |
| 4023    | 2A-B  | Hackberry            | 20                           | NS     | Wide Base                       |
| 4024    | 2A-B  | Foothills Palo Verde | 7                            | NS     | Trunk Form / Root Growth        |
| 4025    | 2A-B  | Foothills Palo Verde | 8                            | NS     | Mistletoe                       |
| 4026    | 2A-B  | Mesquite             | 30                           | RIP    | Branch Dieback                  |



| Plant # | Phase | Common Name          | Caliper (in)/<br>Height (ft) | Status | Comments                        |
|---------|-------|----------------------|------------------------------|--------|---------------------------------|
| 4027    | 2A-B  | Foothills Palo Verde | 12                           | NS     | In Wash / Root Growth           |
| 4028    | 2A-B  | Foothills Palo Verde | 4                            | NS     | Branch Dieback                  |
| 4029    | 2A-B  | Foothills Palo Verde | 4                            | NS     | Exposed Roots                   |
| 4030    | 2A-B  | Foothills Palo Verde | 10                           | NS     | Branch Dieback / Cambium Damage |
| 4031    | 2A-B  | Foothills Palo Verde | 4                            | S      |                                 |
| 4032    | 2A-B  | Foothills Palo Verde | 6                            | S      |                                 |
| 4033    | 2A-B  | Foothills Palo Verde | 10                           | NS     | Exposed Roots                   |
| 4034    | 2A-B  | Foothills Palo Verde | 6                            | S      |                                 |
| 4035    | 2A-B  | Foothills Palo Verde | 6                            | S      |                                 |
| 4036    | 2A-B  | Foothills Palo Verde | 7                            | RIP    |                                 |
| 4037    | 2A-B  | Foothills Palo Verde | 7                            | RIP    |                                 |
| 4038    | 2A-B  | Hackberry            | 24                           | RIP    | Wide Base                       |
| 4039    | 2A-B  | Hackberry            | 36                           | NS     | Wide Base                       |
| 4040    | 2A-B  | Hackberry            | 40                           | NS     | Wide Base                       |
| 4041    | 2A-B  | Hackberry            | 24                           | NS     | Wide Base                       |
| 4042    | 2A-B  | Hackberry            | 50                           | NS     | Wide Base                       |
| 4043    | 2A-B  | Hackberry            | 34                           | NS     | Wide Base                       |
| 4044    | 2A-B  | Hackberry            | 80                           | RIP    | Wide Base                       |
| 4045    | 2A-B  | Mesquite             | 20                           | NS     | Branch Dieback                  |
| 4046    | 2A-B  | Hackberry            | 28                           | NS     | Wide Base                       |
| 4047    | 2A-B  | Hackberry            | 20                           | NS     | Wide Base                       |
| 4048    | 2A-B  | Foothills Palo Verde | 22                           | NS     | Mistletoe                       |
| 4049    | 2A-B  | Foothills Palo Verde | 8                            | NS     | Branch Dieback / Cambium Damage |
| 4050    | 2A-B  | Foothills Palo Verde | 8                            | S      |                                 |
| 4051    | 2A-B  | Foothills Palo Verde | 7                            | S      |                                 |
| 4052    | 2A-B  | Foothills Palo Verde | 6                            | S      |                                 |
| 4053    | 2A-B  | Foothills Palo Verde | 4                            | NS     | Exposed Roots                   |
| 4054    | 2A-B  | Foothills Palo Verde | 12                           | NS     | Branch Dieback                  |
| 4055    | 2A-B  | Foothills Palo Verde | 11                           | NS     | Trunk Form / Leaning            |
| 4056    | 2A-B  | Foothills Palo Verde | 6                            | S      |                                 |
| 4057    | 2A-B  | Foothills Palo Verde | 20                           | RIP    | Branch Dieback / Cambium Damage |
| 4058    | 2A-B  | Blue Palo Verde      | 7                            | RIP    | Branch Dieback / Cambium Damage |
| 4059    | 2A-B  | Foothills Palo Verde | 8                            | NS     | Branch Dieback / Cambium Damage |
| 4060    | 2A-B  | Foothills Palo Verde | 10                           | NS     | Exposed Roots / Cambium Damage  |
| 4061    | 2A-B  | Foothills Palo Verde | 14                           | NS     | Exposed Roots / Cambium Damage  |
| 4062    | 2A-B  | Mesquite             | 20                           | NS     | Branch Dieback / Cambium Damage |
| 4063    | 2A-B  | Foothills Palo Verde | 20                           | NS     | Branch Dieback / Cambium Damage |
| 4064    | 2A-B  | Mesquite             | 40                           | NS     | Branch Dieback / Cambium Damage |
| 4065    | 2A-B  | Hackberry            | 90                           | NS     | Wide Base                       |
| 4066    | 2A-B  | Foothills Palo Verde | 5                            | S      |                                 |
| 4067    | 2A-B  | Foothills Palo Verde | 20                           | NS     | Branch Dieback                  |
| 4068    | 2A-B  | Hackberry            | 60                           | NS     | Wide Base                       |
| 4069    | 2A-B  | Mesquite             | 30                           | RIP    | Branch Dieback                  |
| 4070    | 2A-B  | Foothills Palo Verde | 16                           | RIP    | Branch Dieback / Cambium Damage |
| 4071    | 2A-B  | Mesquite             | 8                            | RIP    | Branch Dieback / Cambium Damage |
| 4072    | 2A-B  | Hackberry            | 20                           | RIP    | Wide Base                       |
| 4073    | 2A-B  | Foothills Palo Verde | 8                            | RIP    |                                 |
| 4074    | 2A-B  | Foothills Palo Verde | 12                           | RIP    | Trunk Form / Leaning            |
| 4075    | 2A-B  | Foothills Palo Verde | 8                            | RIP    |                                 |

| Plant # | Phase | Common Name          | Caliper (in)/<br>Height (ft) | Status | Comments                        |
|---------|-------|----------------------|------------------------------|--------|---------------------------------|
| 4076    | 2A-B  | Foothills Palo Verde | 14                           | RIP    |                                 |
| 4077    | 2A-B  | Blue Palo Verde      | 8                            | RIP    | Branch Dieback                  |
| 4078    | 2A-B  | Foothills Palo Verde | 12                           | RIP    | Branch Dieback / Cambium Damage |
| 4079    | 2A-B  | Foothills Palo Verde | 7                            | NS     | Branch Dieback / Cambium Damage |
| 4080    | 2A-B  | Foothills Palo Verde | 7                            | NS     | Branch Dieback / Cambium Damage |
| 4081    | 2A-B  | Foothills Palo Verde | 8                            | NS     | Branch Dieback / Cambium Damage |
| 4082    | 2A-B  | Foothills Palo Verde | 16                           | S      |                                 |
| 4083    | 2A-B  | Foothills Palo Verde | 16                           | NS     | Branch Dieback                  |
| 4084    | 2A-B  | Foothills Palo Verde | 10                           | NS     | In Rocks                        |
| 4085    | 2A-B  | Foothills Palo Verde | 6                            | NS     | Branch Dieback                  |
| 4086    | 2A-B  | Foothills Palo Verde | 7                            | NS     | Trunk Form / Leaning            |
| 4087    | 2A-B  | Foothills Palo Verde | 9                            | NS     | Branch Dieback / Cambium Damage |
| 4088    | 2A-B  | Foothills Palo Verde | 7                            | NS     | Branch Dieback / Cambium Damage |
| 4089    | 2A-B  | Foothills Palo Verde | 7                            | NS     | In Rocks                        |
| 4090    | 2A-B  | Foothills Palo Verde | 8                            | S      |                                 |
| 4091    | 2A-B  | Foothills Palo Verde | 6                            | S      |                                 |
| 4092    | 2A-B  | Foothills Palo Verde | 4                            | S      |                                 |
| 4093    | 2A-B  | Foothills Palo Verde | 5                            | S      |                                 |
| 4094    | 2A-B  | Foothills Palo Verde | 7                            | NS     | Exposed Roots                   |
| 4095    | 2A-B  | Foothills Palo Verde | 8                            | NS     | Trunk Form / Leaning            |
| 4096    | 2A-B  | Foothills Palo Verde | 10                           | S      |                                 |
| 4097    | 2A-B  | Foothills Palo Verde | 4                            | NS     | Branch Dieback                  |
| 4098    | 2A-B  | Foothills Palo Verde | 8                            | S      |                                 |
| 4099    | 2A-B  | Foothills Palo Verde | 8                            | NS     | Trunk Form / Root Growth        |
| 4100    | 2A-B  | Foothills Palo Verde | 14                           | NS     | Branch Dieback / Cambium Damage |
| 4101    | 2A-B  | Foothills Palo Verde | 10                           | NS     | Trunk Form / Root Growth        |
| 4102    | 2A-B  | Foothills Palo Verde | 6                            | S      |                                 |
| 4103    | 2A-B  | Foothills Palo Verde | 10                           | NS     | Trunk Form / Cambium Damage     |
| 4104    | 2A-B  | Foothills Palo Verde | 6                            | S      |                                 |
| 4105    | 2A-B  | Foothills Palo Verde | 4                            | S      |                                 |
| 4106    | 2A-B  | Hackberry            | 20                           | NS     | Wide Base                       |
| 4107    | 2A-B  | Hackberry            | 8                            | NS     | Branch Dieback / Cambium Damage |
| 4108    | 2A-B  | Foothills Palo Verde | 12                           | NS     | Branch Dieback / Cambium Damage |
| 4109    | 2A-B  | Foothills Palo Verde | 4                            | NS     | Branch Dieback / Cambium Damage |
| 4110    | 2A-B  | Foothills Palo Verde | 4                            | NS     | Branch Dieback / Cambium Damage |
| 4111    | 2A-B  | Foothills Palo Verde | 8                            | S      |                                 |
| 4112    | 2A-B  | Foothills Palo Verde | 8                            | S      |                                 |
| 4113    | 2A-B  | Foothills Palo Verde | 4                            | S      |                                 |
| 4114    | 2A-B  | Foothills Palo Verde | 8                            | S      |                                 |
| 4115    | 2A-B  | Hackberry            | 60                           | NS     | Wide Base                       |
| 4116    | 2A-B  | Saguaro              | 18                           | NS     | 8 arms / Damaged                |
| 4117    | 2A-B  | Foothills Palo Verde | 10                           | NS     | Branch Dieback                  |
| 4118    | 2A-B  | Mesquite             | 10                           | NS     | Branch Dieback                  |
| 4119    | 2A-B  | Foothills Palo Verde | 12                           | NS     | Branch Dieback                  |
| 4120    | 2A-B  | Foothills Palo Verde | 8                            | NS     | In Rocks                        |
| 4121    | 2A-B  | Hackberry            | 12                           | NS     | Branch Dieback                  |
| 4122    | 2A-B  | Foothills Palo Verde | 5                            | NS     | Trunk Form / Root Growth        |
| 4123    | 2A-B  | Foothills Palo Verde | 14                           | NS     | Branch Dieback                  |
| 4124    | 2A-B  | Foothills Palo Verde | 10                           | NS     | Branch Dieback                  |

| Plant # | Phase | Common Name          | Caliper (in)/<br>Height (ft) | Status | Comments                        |
|---------|-------|----------------------|------------------------------|--------|---------------------------------|
| 4125    | 2A-B  | Foothills Palo Verde | 12                           | NS     | Branch Dieback                  |
| 4126    | 2A-B  | Foothills Palo Verde | 12                           | NS     | Branch Dieback                  |
| 4127    | 2A-B  | Foothills Palo Verde | 6                            | S      |                                 |
| 4128    | 2A-B  | Foothills Palo Verde | 4                            | NS     | Branch Dieback                  |
| 4129    | 2A-B  | Foothills Palo Verde | 8                            | NS     | Branch Dieback / Cambium Damage |
| 4130    | 2A-B  | Foothills Palo Verde | 8                            | S      |                                 |
| 4131    | 2A-B  | Foothills Palo Verde | 7                            | NS     | Branch Dieback / Cambium Damage |
| 4132    | 2A-B  | Foothills Palo Verde | 8                            | NS     | Branch Dieback / Cambium Damage |
| 4133    | 2A-B  | Saguaro              | 71                           | NS     | 12 arms / Damaged               |
| 4134    | 2A-B  | Hackberry            | 99                           | NS     | Wide Base                       |
| 4135    | 2A-B  | Foothills Palo Verde | 10                           | S      |                                 |
| 4136    | 2A-B  | Whitethorn Acacia    | 20                           | RIP    | Wide Base                       |
| 4137    | 2A-B  | Foothills Palo Verde | 14                           | S      | Prune Mistletoe                 |
| 4138    | 2A-B  | Foothills Palo Verde | 5                            | S      |                                 |
| 4139    | 2A-B  | Foothills Palo Verde | 4                            | RIP    |                                 |
| 4140    | 2A-B  | Foothills Palo Verde | 6                            | RIP    | Branch Dieback                  |
| 4141    | 2A-B  | Foothills Palo Verde | 6                            | RIP    |                                 |
| 4142    | 2A-B  | Barrel               | 3                            | RIP    |                                 |
| 4143    | 2A-B  | Foothills Palo Verde | 6                            | RIP    | Trunk Form / Leaning            |
| 4144    | 2A-B  | Foothills Palo Verde | 6                            | S      |                                 |
| 4145    | 2A-B  | Foothills Palo Verde | 12                           | NS     | Branch Dieback / Cambium Damage |
| 4146    | 2A-B  | Saguaro              | 3                            | S      |                                 |
| 4147    | 2A-B  | Foothills Palo Verde | 8                            | NS     | Trunk Form / Root Growth        |
| 4148    | 2A-B  | Foothills Palo Verde | 8                            | NS     | Trunk Form / Root Growth        |
| 4149    | 2A-B  | Foothills Palo Verde | 6                            | S      |                                 |
| 4150    | 2A-B  | Foothills Palo Verde | 14                           | NS     | Branch Dieback                  |
| 4151    | 2A-B  | Foothills Palo Verde | 7                            | S      |                                 |
| 4152    | 2A-B  | Foothills Palo Verde | 4                            | S      |                                 |
| 4153    | 2A-B  | Foothills Palo Verde | 5                            | RIP    | Branch Dieback                  |
| 4154    | 2A-B  | Foothills Palo Verde | 5                            | RIP    |                                 |
| 4155    | 2A-B  | Hackberry            | 10                           | RIP    | Branch Dieback                  |
| 4156    | 2A-B  | Foothills Palo Verde | 8                            | RIP    |                                 |
| 4157    | 2A-B  | Hackberry            | 48                           | RIP    | Wide Base                       |
| 4158    | 2A-B  | Foothills Palo Verde | 4                            | RIP    |                                 |
| 4159    | 2A-B  | Foothills Palo Verde | 6                            | RIP    | Branch Dieback / Cambium Damage |
| 4160    | 2A-B  | Foothills Palo Verde | 13                           | RIP    |                                 |
| 4161    | 2A-B  | Hackberry            | 38                           | RIP    | Wide Base                       |
| 4162    | 2A-B  | Hackberry            | 14                           | RIP    | Wide Base                       |
| 4163    | 2A-B  | Hackberry            | 99                           | RIP    | Wide Base                       |
| 4164    | 2A-B  | Foothills Palo Verde | 10                           | RIP    |                                 |
| 4165    | 2A-B  | Foothills Palo Verde | 6                            | RIP    | Trunk Form / Leaning            |
| 4166    | 2A-B  | Foothills Palo Verde | 14                           | RIP    | Branch Dieback / Cambium Damage |
| 4167    | 2A-B  | Foothills Palo Verde | 6                            | RIP    | Branch Dieback / Cambium Damage |
| 4168    | 2A-B  | Foothills Palo Verde | 12                           | RIP    | Branch Dieback / Cambium Damage |
| 4169    | 2A-B  | Foothills Palo Verde | 20                           | NS     | Branch Dieback / Cambium Damage |
| 4170    | 2A-B  | Foothills Palo Verde | 12                           | NS     | Trunk Form / Leaning            |
| 4171    | 2A-B  | Foothills Palo Verde | 6                            | NS     | Trunk Form / Leaning            |
| 4172    | 2A-B  | Foothills Palo Verde | 6                            | RIP    |                                 |
| 4173    | 2A-B  | Mesquite             | 9                            | RIP    | Branch Dieback                  |

| Plant # | Phase | Common Name          | Caliper (in)/<br>Height (ft) | Status | Comments                        |
|---------|-------|----------------------|------------------------------|--------|---------------------------------|
| 4174    | 2A-B  | Saguaro              | 3                            | RIP    |                                 |
| 4175    | 2A-B  | Foothills Palo Verde | 16                           | RIP    | Branch Dieback / Cambium Damage |
| 4176    | 2A-B  | Mesquite             | 7                            | RIP    |                                 |
| 4177    | 2A-B  | Whitethorn Acacia    | 10                           | RIP    |                                 |
| 4178    | 2A-B  | Foothills Palo Verde | 7                            | RIP    |                                 |
| 4179    | 2A-B  | Foothills Palo Verde | 12                           | RIP    | Exposed Roots / Cambium Damage  |
| 4180    | 2A-B  | Mesquite             | 8                            | RIP    | Branch Dieback / Cambium Damage |
| 4181    | 2A-B  | Mesquite             | 4                            | RIP    | Trunk Form / Leaning            |
| 4182    | 2A-B  | Foothills Palo Verde | 20                           | RIP    | Branch Dieback / Cambium Damage |
| 4183    | 2A-B  | Barrel               | 4                            | RIP    |                                 |
| 4184    | 2A-B  | Hackberry            | 12                           | RIP    | Wide Base                       |
| 4185    | 2A-B  | Foothills Palo Verde | 10                           | RIP    | Branch Dieback                  |
| 4186    | 2A-B  | Foothills Palo Verde | 8                            | RIP    | In Rocks                        |
| 4187    | 2A-B  | Foothills Palo Verde | 8                            | RIP    | In Rocks                        |
| 4188    | 2A-B  | Foothills Palo Verde | 8                            | NS     | Branch Dieback                  |
| 4189    | 2A-B  | Barrel               | 4                            | NS     | Damaged                         |
| 4190    | 2A-B  | Foothills Palo Verde | 8                            | NS     | Branch Dieback                  |
| 4191    | 2A-B  | Saguaro              | 15                           | RIP    |                                 |
| 4192    | 2A-B  | Foothills Palo Verde | 8                            | RIP    |                                 |
| 4193    | 2A-B  | Foothills Palo Verde | 16                           | RIP    | Branch Dieback                  |
| 4194    | 2A-B  | Foothills Palo Verde | 7                            | RIP    | Exposed Roots / Root Growth     |
| 4195    | 2A-B  | Foothills Palo Verde | 8                            | RIP    | In Rocks / Root Growth          |
| 4196    | 2A-B  | Foothills Palo Verde | 8                            | NS     | Trunk Form / Poor Structure     |
| 4197    | 2A-B  | Foothills Palo Verde | 8                            | S      |                                 |
| 4198    | 2A-B  | Foothills Palo Verde | 10                           | S      |                                 |
| 4199    | 2A-B  | Foothills Palo Verde | 5                            | S      |                                 |
| 4200    | 2A-B  | Saguaro              | 11                           | S      |                                 |
| 4201    | 2A-B  | Foothills Palo Verde | 12                           | NS     | Branch Dieback                  |
| 4202    | 2A-B  | Foothills Palo Verde | 8                            | S      |                                 |
| 4203    | 2A-B  | Foothills Palo Verde | 14                           | NS     | Mistletoe / Cambium Damage      |
| 4204    | 2A-B  | Foothills Palo Verde | 10                           | NS     | In Rocks / Cambium Damage       |
| 4205    | 2A-B  | Foothills Palo Verde | 12                           | NS     | Branch Dieback / Cambium Damage |
| 4206    | 2A-B  | Foothills Palo Verde | 14                           | NS     | Branch Dieback / Cambium Damage |
| 4207    | 2A-B  | Foothills Palo Verde | 14                           | RIP    | Branch Dieback / Cambium Damage |
| 4208    | 2A-B  | Saguaro              | 7                            | RIP    |                                 |
| 4209    | 2A-B  | Foothills Palo Verde | 12                           | RIP    | Exposed Roots / Root Growth     |
| 4210    | 2A-B  | Foothills Palo Verde | 14                           | RIP    | Branch Dieback                  |
| 4211    | 2A-B  | Hackberry            | 30                           | RIP    | Wide Base                       |
| 4212    | 2A-B  | Foothills Palo Verde | 4                            | NS     | Branch Dieback                  |
| 4213    | 2A-B  | Foothills Palo Verde | 5                            | S      |                                 |
| 4214    | 2A-B  | Foothills Palo Verde | 4                            | NS     | Branch Dieback                  |
| 4215    | 2A-B  | Foothills Palo Verde | 4                            | S      |                                 |
| 4216    | 2A-B  | Foothills Palo Verde | 8                            | RIP    | Branch Dieback / Cambium Damage |
| 4217    | 2A-B  | Foothills Palo Verde | 8                            | NS     | In Rocks / Cambium Damage       |
| 4218    | 2A-B  | Foothills Palo Verde | 14                           | NS     | In Rocks / Cambium Damage       |
| 4219    | 2A-B  | Foothills Palo Verde | 4                            | NS     | Exposed Roots                   |
| 4220    | 2A-B  | Mesquite             | 4                            | NS     | In Wash                         |
| 4221    | 2A-B  | Foothills Palo Verde | 14                           | NS     | Trunk Form / Leaning            |
| 4222    | 2A-B  | Foothills Palo Verde | 16                           | NS     | Branch Dieback / Cambium Damage |

| Plant # | Phase | Common Name          | Caliper (in)/<br>Height (ft) | Status | Comments                        |
|---------|-------|----------------------|------------------------------|--------|---------------------------------|
| 4223    | 2A-B  | Foothills Palo Verde | 22                           | NS     | Branch Dieback / Cambium Damage |
| 4224    | 2A-B  | Foothills Palo Verde | 7                            | S      |                                 |
| 4225    | 2A-B  | Foothills Palo Verde | 5                            | NS     | In Rocks                        |
| 4226    | 2A-B  | Foothills Palo Verde | 4                            | S      |                                 |
| 4227    | 2A-B  | Foothills Palo Verde | 5                            | NS     | Branch Dieback                  |
| 4228    | 2A-B  | Foothills Palo Verde | 8                            | NS     | In Rocks                        |
| 4229    | 2A-B  | Hackberry            | 30                           | RIP    | In Rocks                        |
| 4230    | 2A-B  | Hackberry            | 14                           | NS     | Wide Base                       |
| 4231    | 2A-B  | Hackberry            | 19                           | NS     | Wide Base                       |
| 4232    | 2A-B  | Hackberry            | 24                           | NS     | Wide Base                       |
| 4233    | 2A-B  | Foothills Palo Verde | 5                            | RIP    | Branch Dieback                  |
| 4234    | 2A-B  | Foothills Palo Verde | 8                            | NS     | Branch Dieback                  |
| 4235    | 2A-B  | Hackberry            | 30                           | RIP    | Wide Base                       |
| 4236    | 2A-B  | Hackberry            | 12                           | RIP    | Branch Dieback                  |
| 4237    | 2A-B  | Hackberry            | 30                           | RIP    | Branch Dieback / Cluster        |
| 4238    | 2A-B  | Hackberry            | 40                           | NS     | Branch Dieback / Cluster        |
| 4239    | 2A-B  | Foothills Palo Verde | 6                            | RIP    | Branch Dieback                  |
| 4240    | 2A-B  | Foothills Palo Verde | 8                            | RIP    | Trunk Form / Leaning            |
| 4241    | 2A-B  | Hackberry            | 8                            | RIP    | Branch Dieback                  |
| 4242    | 2A-B  | Foothills Palo Verde | 15                           | RIP    |                                 |
| 4243    | 2A-B  | Foothills Palo Verde | 5                            | RIP    |                                 |
| 4244    | 2A-B  | Hackberry            | 36                           | RIP    | Wide Base                       |
| 4245    | 2A-B  | Foothills Palo Verde | 6                            | NS     | Trunk Form / Leaning            |
| 4246    | 2A-B  | Foothills Palo Verde | 6                            | NS     | Leaning / Cambium Damage        |
| 4247    | 2A-B  | Foothills Palo Verde | 10                           | S      |                                 |
| 4248    | 2A-B  | Hackberry            | 24                           | NS     | Wide Base                       |
| 4249    | 2A-B  | Foothills Palo Verde | 12                           | NS     | Exposed Roots                   |
| 4250    | 2A-B  | Foothills Palo Verde | 10                           | NS     | Branch Dieback                  |
| 4251    | 2A-B  | Foothills Palo Verde | 7                            | S      |                                 |
| 4252    | 2A-B  | Foothills Palo Verde | 14                           | S      |                                 |
| 4253    | 2A-B  | Foothills Palo Verde | 4                            | NS     | Trunk Form / Leaning            |
| 4254    | 2A-B  | Foothills Palo Verde | 4                            | NS     | Trunk Form / Leaning            |
| 4255    | 2A-B  | Hackberry            | 16                           | NS     | Branch Dieback / Cambium Damage |
| 4256    | 2A-B  | Hackberry            | 40                           | RIP    | Wide Base / Cambium Damage      |
| 4257    | 2A-B  | Hackberry            | 16                           | RIP    | Wide Base / Cambium Damage      |
| 4258    | 2A-B  | Foothills Palo Verde | 8                            | RIP    | Trunk Form / Leaning            |
| 4259    | 2A-B  | Foothills Palo Verde | 20                           | RIP    | Exposed Roots                   |
| 4260    | 2A-B  | Mesquite             | 20                           | NS     | Exposed Roots / Cambium Damage  |
| 4261    | 2A-B  | Foothills Palo Verde | 8                            | NS     | Trunk Form / Leaning            |
| 4262    | 2A-B  | Foothills Palo Verde | 8                            | NS     | Trunk Form / Leaning            |
| 4263    | 2A-B  | Foothills Palo Verde | 12                           | NS     | Branch Dieback                  |
| 4264    | 2A-B  | Foothills Palo Verde | 8                            | S      |                                 |
| 4265    | 2A-B  | Foothills Palo Verde | 14                           | NS     | Branch Dieback                  |
| 4266    | 2A-B  | Foothills Palo Verde | 5                            | NS     | Branch Dieback                  |
| 4267    | 2A-B  | Foothills Palo Verde | 4                            | NS     | Branch Dieback                  |
| 4268    | 2A-B  | Foothills Palo Verde | 5                            | NS     | Branch Dieback                  |
| 4269    | 2A-B  | Foothills Palo Verde | 8                            | NS     | Declining / Branch Dieback      |
| 4270    | 2A-B  | Foothills Palo Verde | 5                            | NS     | Declining / Branch Dieback      |
| 4271    | 2A-B  | Foothills Palo Verde | 7                            | S      |                                 |

| Plant # | Phase | Common Name          | Caliper (in)/<br>Height (ft) | Status | Comments                        |
|---------|-------|----------------------|------------------------------|--------|---------------------------------|
| 4272    | 2A-B  | Foothills Palo Verde | 9                            | NS     | In Rocks                        |
| 4273    | 2A-B  | Foothills Palo Verde | 7                            | NS     | In Rocks                        |
| 4274    | 2A-B  | Foothills Palo Verde | 7                            | NS     | Branch Dieback / Cambium Damage |
| 4275    | 2A-B  | Foothills Palo Verde | 4                            | NS     | In Rocks / Cambium Damage       |
| 4276    | 2A-B  | Foothills Palo Verde | 7                            | NS     | Branch Dieback / Cambium Damage |
| 4277    | 2A-B  | Foothills Palo Verde | 7                            | NS     | Exposed Roots / Root Growth     |
| 4278    | 2A-B  | Foothills Palo Verde | 7                            | NS     | Exposed Roots / Root Growth     |
| 4279    | 2A-B  | Foothills Palo Verde | 8                            | NS     | Exposed Roots / Root Growth     |
| 4280    | 2A-B  | Foothills Palo Verde | 10                           | NS     | Branch Dieback                  |
| 4281    | 2A-B  | Barrel               | 4                            | S      |                                 |
| 4282    | 2A-B  | Barrel               | 5                            | S      |                                 |
| 4283    | 2A-B  | Barrel               | 3                            | S      |                                 |
| 4284    | 2A-B  | Foothills Palo Verde | 7                            | NS     | In Rocks                        |
| 4285    | 2A-B  | Hackberry            | 40                           | NS     | Wide Base                       |
| 4286    | 2A-B  | Hackberry            | 30                           | NS     | Wide Base                       |
| 4287    | 2A-B  | Foothills Palo Verde | 16                           | S      |                                 |
| 4288    | 2A-B  | Foothills Palo Verde | 4                            | NS     | Branch Dieback                  |
| 4289    | 2A-B  | Foothills Palo Verde | 7                            | S      |                                 |
| 4290    | 2A-B  | Hackberry            | 12                           | NS     | Branch Dieback                  |
| 4291    | 2A-B  | Crucifixion Thorn    | 14                           | NS     | Branch Dieback                  |
| 4292    | 2A-B  | Mesquite             | 8                            | NS     | Branch Dieback                  |
| 4293    | 2A-B  | Foothills Palo Verde | 7                            | NS     | Trunk Form / Leaning            |
| 4294    | 2A-B  | Foothills Palo Verde | 7                            | NS     | Declining / Cambium Damage      |
| 4295    | 2A-B  | Foothills Palo Verde | 8                            | NS     | Trunk Form / Leaning            |
| 4296    | 2A-B  | Foothills Palo Verde | 14                           | NS     | Branch Dieback / Cambium Damage |
| 4297    | 2A-B  | Foothills Palo Verde | 14                           | RIP    | Branch Dieback / Cambium Damage |
| 4298    | 2A-B  | Barrel               | 6                            | RIP    | 3 heads                         |
| 4299    | 2A-B  | Barrel               | 4                            | RIP    |                                 |
| 4300    | 2A-B  | Foothills Palo Verde | 9                            | RIP    | In Rocks                        |
| 4301    | 2A-B  | Foothills Palo Verde | 6                            | RIP    | In Rocks                        |
| 4302    | 2A-B  | Hackberry            | 16                           | NS     | Wide Base                       |
| 4303    | 2A-B  | Foothills Palo Verde | 5                            | RIP    |                                 |
| 4304    | 2A-B  | Foothills Palo Verde | 7                            | RIP    |                                 |
| 4305    | 2A-B  | Hackberry            | 16                           | RIP    | Branch Dieback                  |
| 4306    | 2A-B  | Hackberry            | 14                           | NS     | In Rocks                        |
| 4307    | 2A-B  | Foothills Palo Verde | 4                            | RIP    | In Rocks                        |
| 4308    | 2A-B  | Foothills Palo Verde | 12                           | RIP    | Branch Dieback                  |
| 4309    | 2A-B  | Foothills Palo Verde | 6                            | RIP    |                                 |
| 4310    | 2A-B  | Hackberry            | 20                           | NS     | Wide Base                       |
| 4311    | 2A-B  | Foothills Palo Verde | 5                            | S      |                                 |
| 4312    | 2A-B  | Foothills Palo Verde | 8                            | NS     | Branch Dieback / Cambium Damage |
| 4313    | 2A-B  | Hackberry            | 20                           | NS     | Wide Base / Cambium Damage      |
| 4314    | 2A-B  | Foothills Palo Verde | 8                            | NS     | Trunk Form / Leaning            |
| 4315    | 2A-B  | Foothills Palo Verde | 16                           | RIP    | Branch Dieback / Cambium Damage |
| 4316    | 2A-B  | Foothills Palo Verde | 8                            | S      |                                 |
| 4317    | 2A-B  | Foothills Palo Verde | 8                            | S      |                                 |
| 4318    | 2A-B  | Foothills Palo Verde | 5                            | S      |                                 |
| 4319    | 2A-B  | Foothills Palo Verde | 7                            | NS     | Trunk Form / Root Growth        |
| 4320    | 2A-B  | Foothills Palo Verde | 20                           | NS     | Branch Dieback / Cambium Damage |

| Plant # | Phase | Common Name          | Caliper (in)/<br>Height (ft) | Status | Comments                        |
|---------|-------|----------------------|------------------------------|--------|---------------------------------|
| 4321    | 2A-B  | Foothills Palo Verde | 6                            | S      |                                 |
| 4322    | 2A-B  | Foothills Palo Verde | 8                            | NS     | Branch Dieback                  |
| 4323    | 2A-B  | Crucifixion Thorn    | 8                            | NS     | Branch Dieback                  |
| 4324    | 2A-B  | Foothills Palo Verde | 7                            | NS     | Exposed Roots                   |
| 4325    | 2A-B  | Foothills Palo Verde | 12                           | NS     | Exposed Roots                   |
| 4326    | 2A-B  | Foothills Palo Verde | 16                           | NS     | Mistletoe / Cambium Damage      |
| 4327    | 2A-B  | Foothills Palo Verde | 5                            | S      |                                 |
| 4328    | 2A-B  | Foothills Palo Verde | 4                            | RIP    | Trunk Form / Leaning            |
| 4329    | 2A-B  | Foothills Palo Verde | 6                            | RIP    |                                 |
| 4330    | 2A-B  | Foothills Palo Verde | 6                            | RIP    |                                 |
| 4331    | 2A-B  | Foothills Palo Verde | 4                            | S      |                                 |
| 4332    | 2A-B  | Foothills Palo Verde | 4                            | S      |                                 |
| 4333    | 2A-B  | Foothills Palo Verde | 6                            | NS     | Trunk Form / Leaning            |
| 4334    | 2A-B  | Barrel               | 4                            | S      |                                 |
| 4335    | 2A-B  | Foothills Palo Verde | 7                            | S      |                                 |
| 4336    | 2A-B  | Hackberry            | 40                           | NS     | Wide Base                       |
| 4337    | 2A-B  | Hackberry            | 12                           | NS     | Branch Dieback / Cambium Damage |
| 4338    | 2A-B  | Foothills Palo Verde | 7                            | S      |                                 |
| 4339    | 2A-B  | Foothills Palo Verde | 14                           | NS     | Branch Dieback                  |
| 4340    | 2A-B  | Foothills Palo Verde | 14                           | NS     | In Rocks                        |
| 4341    | 2A-B  | Foothills Palo Verde | 8                            | NS     | In Rocks                        |
| 4342    | 2A-B  | Barrel               | 3                            | S      |                                 |
| 4343    | 2A-B  | Foothills Palo Verde | 5                            | NS     | Branch Dieback                  |
| 4344    | 2A-B  | Foothills Palo Verde | 8                            | NS     | In Rocks                        |
| 4345    | 2A-B  | Foothills Palo Verde | 10                           | NS     | In Rocks                        |
| 4346    | 2A-B  | Foothills Palo Verde | 8                            | NS     | In Rocks                        |
| 4347    | 2A-B  | Foothills Palo Verde | 16                           | NS     | Branch Dieback                  |
| 4348    | 2A-B  | Foothills Palo Verde | 6                            | S      |                                 |
| 4349    | 2A-B  | Barrel               | 4                            | S      |                                 |
| 4350    | 2A-B  | Foothills Palo Verde | 9                            | NS     | Branch Dieback / Cambium Damage |
| 4351    | 2A-B  | Barrel               | 3                            | S      |                                 |
| 4352    | 2A-B  | Barrel               | 8                            | S      | 2 heads                         |
| 4353    | 2A-B  | Foothills Palo Verde | 8                            | NS     | In Wash                         |
| 4354    | 2A-B  | Foothills Palo Verde | 8                            | S      |                                 |
| 4355    | 2A-B  | Foothills Palo Verde | 4                            | NS     | Trunk Form / Leaning            |
| 4356    | 2A-B  | Foothills Palo Verde | 9                            | NS     | In Rocks                        |
| 4357    | 2A-B  | Foothills Palo Verde | 9                            | NS     | In Rocks                        |
| 4358    | 2A-B  | Foothills Palo Verde | 6                            | NS     | In Rocks                        |
| 4359    | 2A-B  | Hackberry            | 36                           | NS     | Wide Base                       |
| 4360    | 2A-B  | Hackberry            | 12                           | NS     | Branch Dieback                  |
| 4361    | 2A-B  | Foothills Palo Verde | 22                           | NS     | Branch Dieback / Cambium Damage |
| 4362    | 2A-B  | Foothills Palo Verde | 8                            | NS     | In Rocks / Cambium Damage       |
| 4363    | 2A-B  | Foothills Palo Verde | 4                            | NS     | In Rocks / Cambium Damage       |
| 4364    | 2A-B  | Foothills Palo Verde | 8                            | NS     | Mistletoe / Cambium Damage      |
| 4365    | 2A-B  | Foothills Palo Verde | 4                            | NS     | In Rocks                        |
| 4366    | 2A-B  | Foothills Palo Verde | 14                           | S      |                                 |
| 4367    | 2A-B  | Foothills Palo Verde | 16                           | S      |                                 |
| 4368    | 2A-B  | Foothills Palo Verde | 7                            | S      |                                 |
| 4369    | 2A-B  | Foothills Palo Verde | 4                            | S      |                                 |



| Plant # | Phase | Common Name          | Caliper (in)/<br>Height (ft) | Status | Comments                        |
|---------|-------|----------------------|------------------------------|--------|---------------------------------|
| 4370    | 2A-B  | Foothills Palo Verde | 5                            | S      |                                 |
| 4371    | 2A-B  | Foothills Palo Verde | 5                            | NS     | Trunk Form / Leaning            |
| 4372    | 2A-B  | Foothills Palo Verde | 12                           | NS     | Branch Dieback / Cambium Damage |
| 4373    | 2A-B  | Foothills Palo Verde | 8                            | NS     | Branch Dieback / Root Growth    |
| 4374    | 2A-B  | Foothills Palo Verde | 5                            | S      |                                 |
| 4375    | 2A-B  | Mesquite             | 5                            | NS     | Branch Dieback                  |
| 4376    | 2A-B  | Foothills Palo Verde | 12                           | S      |                                 |
| 4377    | 2A-B  | Foothills Palo Verde | 8                            | S      |                                 |
| 4378    | 2A-B  | Foothills Palo Verde | 5                            | S      |                                 |
| 4379    | 2A-B  | Foothills Palo Verde | 6                            | NS     | Trunk Form / Leaning            |
| 4380    | 2A-B  | Foothills Palo Verde | 6                            | S      |                                 |
| 4381    | 2A-B  | Foothills Palo Verde | 5                            | S      |                                 |
| 4382    | 2A-B  | Foothills Palo Verde | 7                            | S      |                                 |
| 4383    | 2A-B  | Saguaro              | 5                            | S      | 2 heads                         |
| 4384    | 2A-B  | Hackberry            | 10                           | NS     | In Rocks                        |
| 4385    | 2A-B  | Foothills Palo Verde | 4                            | NS     | Trunk Form / Root Growth        |
| 4386    | 2A-B  | Foothills Palo Verde | 7                            | NS     | Trunk Form / Root Growth        |
| 4387    | 2A-B  | Foothills Palo Verde | 9                            | NS     | Trunk Form / Root Growth        |
| 4388    | 2A-B  | Foothills Palo Verde | 9                            | NS     | Trunk Form / Root Growth        |
| 4389    | 2A-B  | Foothills Palo Verde | 8                            | NS     | Trunk Form / Root Growth        |
| 4390    | 2A-B  | Foothills Palo Verde | 10                           | NS     | Trunk Form / Root Growth        |
| 4391    | 2A-B  | Foothills Palo Verde | 7                            | NS     | Trunk Form / Root Growth        |
| 4392    | 2A-B  | Foothills Palo Verde | 8                            | RIP    |                                 |
| 4393    | 2A-B  | Foothills Palo Verde | 4                            | RIP    | Trunk Form / Leaning            |
| 4394    | 2A-B  | Hackberry            | 40                           | NS     | Wide Base / Cambium Damage      |
| 4395    | 2A-B  | Foothills Palo Verde | 5                            | S      |                                 |
| 4396    | 2A-B  | Foothills Palo Verde | 20                           | NS     | Branch Dieback / Cambium Damage |
| 4397    | 2A-B  | Foothills Palo Verde | 22                           | NS     | Branch Dieback / Cambium Damage |
| 4398    | 2A-B  | Foothills Palo Verde | 8                            | NS     | Trunk Form / Root Growth        |
| 4399    | 2A-B  | Hackberry            | 16                           | NS     | Branch Dieback                  |
| 4400    | 2A-B  | Foothills Palo Verde | 8                            | NS     | Branch Dieback / Cambium Damage |
| 4401    | 2A-B  | Foothills Palo Verde | 12                           | NS     | Branch Dieback / Cambium Damage |
| 4402    | 2A-B  | Foothills Palo Verde | 8                            | NS     | Trunk Form / Root Growth        |
| 4403    | 2A-B  | Foothills Palo Verde | 8                            | NS     | Trunk Form / Root Growth        |
| 4404    | 2A-B  | Foothills Palo Verde | 4                            | S      |                                 |
| 4405    | 2A-B  | Foothills Palo Verde | 5                            | S      |                                 |
| 4406    | 2A-B  | Foothills Palo Verde | 8                            | S      |                                 |
| 4407    | 2A-B  | Foothills Palo Verde | 4                            | NS     | Leaning / Cambium Damage        |
| 4408    | 2A-B  | Foothills Palo Verde | 16                           | NS     | Exposed Roots / Cambium Damage  |
| 4409    | 2A-B  | Foothills Palo Verde | 5                            | NS     | Declining / Cambium Damage      |
| 4410    | 2A-B  | Foothills Palo Verde | 6                            | NS     | Declining / Cambium Damage      |
| 4411    | 2A-B  | Foothills Palo Verde | 4                            | S      |                                 |
| 4412    | 2A-B  | Foothills Palo Verde | 5                            | S      |                                 |
| 4413    | 2A-B  | Hackberry            | 10                           | NS     | Branch Dieback                  |
| 4414    | 2A-B  | Foothills Palo Verde | 8                            | S      |                                 |
| 4415    | 2A-B  | Foothills Palo Verde | 5                            | S      |                                 |
| 4416    | 2A-B  | Foothills Palo Verde | 7                            | NS     | Trunk Form / Root Growth        |
| 4417    | 2A-B  | Foothills Palo Verde | 7                            | NS     | In Rocks / Root Growth          |
| 4418    | 2A-B  | Foothills Palo Verde | 16                           | NS     | Mistletoe / Cambium Damage      |

| Plant # | Phase | Common Name          | Caliper (in)/<br>Height (ft) | Status | Comments                        |
|---------|-------|----------------------|------------------------------|--------|---------------------------------|
| 4419    | 2A-B  | Foothills Palo Verde | 4                            | NS     | Branch Dieback / Cambium Damage |
| 4420    | 2A-B  | Foothills Palo Verde | 6                            | NS     | Branch Dieback / Cambium Damage |
| 4421    | 2A-B  | Foothills Palo Verde | 12                           | NS     | Branch Dieback / Cambium Damage |
| 4422    | 2A-B  | Foothills Palo Verde | 4                            | NS     | Branch Dieback / Cambium Damage |
| 4423    | 2A-B  | Foothills Palo Verde | 20                           | NS     | In Rocks / Cambium Damage       |
| 4424    | 2A-B  | Foothills Palo Verde | 10                           | NS     | Exposed Roots / Cambium Damage  |
| 4425    | 2A-B  | Barrel               | 4                            | S      | 2 heads                         |
| 4426    | 2A-B  | Foothills Palo Verde | 5                            | NS     | Branch Dieback / Cambium Damage |
| 4427    | 2A-B  | Foothills Palo Verde | 10                           | NS     | Branch Dieback / Cambium Damage |
| 4428    | 2A-B  | Foothills Palo Verde | 7                            | NS     | Branch Dieback / Cambium Damage |
| 4429    | 2A-B  | Foothills Palo Verde | 7                            | NS     | Branch Dieback / Cambium Damage |
| 4430    | 2A-B  | Foothills Palo Verde | 7                            | S      |                                 |
| 4431    | 2A-B  | Foothills Palo Verde | 10                           | S      |                                 |
| 4432    | 2A-B  | Foothills Palo Verde | 7                            | S      |                                 |
| 4433    | 2A-B  | Mesquite             | 14                           | NS     | Branch Dieback                  |
| 4434    | 2A-B  | Foothills Palo Verde | 14                           | NS     | Trunk Form / Root Growth        |
| 4435    | 2A-B  | Foothills Palo Verde | 6                            | NS     | Trunk Form / Root Growth        |
| 4436    | 2A-B  | Foothills Palo Verde | 16                           | NS     | Branch Dieback / Cambium Damage |
| 4437    | 2A-B  | Foothills Palo Verde | 5                            | S      |                                 |
| 4438    | 2A-B  | Foothills Palo Verde | 7                            | NS     | Mistletoe                       |
| 4439    | 2A-B  | Foothills Palo Verde | 8                            | NS     | Trunk Form / Leaning            |
| 4440    | 2A-B  | Foothills Palo Verde | 5                            | S      |                                 |
| 4441    | 2A-B  | Mesquite             | 7                            | RIP    | Branch Dieback                  |
| 4442    | 2A-B  | Foothills Palo Verde | 6                            | NS     | Branch Dieback / Cambium Damage |
| 4443    | 2A-B  | Foothills Palo Verde | 4                            | NS     | Branch Dieback / Cambium Damage |
| 4444    | 2A-B  | Foothills Palo Verde | 12                           | NS     | Branch Dieback / Cambium Damage |
| 4445    | 2A-B  | Foothills Palo Verde | 5                            | NS     | Branch Dieback / Cambium Damage |
| 4446    | 2A-B  | Foothills Palo Verde | 16                           | NS     | Branch Dieback / Cambium Damage |
| 4447    | 2A-B  | Foothills Palo Verde | 16                           | NS     | Branch Dieback / Cambium Damage |
| 4448    | 2A-B  | Foothills Palo Verde | 20                           | NS     | Branch Dieback / Cambium Damage |
| 4449    | 2A-B  | Foothills Palo Verde | 12                           | NS     | Branch Dieback / Cambium Damage |
| 4450    | 2A-B  | Foothills Palo Verde | 15                           | NS     | Branch Dieback / Cambium Damage |
| 4451    | 2A-B  | Foothills Palo Verde | 14                           | NS     | Branch Dieback / Cambium Damage |
| 4452    | 2A-B  | Foothills Palo Verde | 8                            | S      |                                 |
| 4453    | 2A-B  | Foothills Palo Verde | 10                           | NS     | Mistletoe / Cambium Damage      |
| 4454    | 2A-B  | Foothills Palo Verde | 16                           | NS     | Trunk Form / Root Growth        |
| 4455    | 2A-B  | Foothills Palo Verde | 20                           | NS     | Trunk Form / Root Growth        |
| 4456    | 2A-B  | Foothills Palo Verde | 20                           | RIP    | Branch Dieback / Cambium Damage |
| 4457    | 2A-B  | Mesquite             | 8                            | RIP    | Branch Dieback / Cambium Damage |
| 4458    | 2A-B  | Foothills Palo Verde | 8                            | RIP    | Branch Dieback / Cambium Damage |
| 4459    | 2A-B  | Foothills Palo Verde | 8                            | NS     | Leaning / Cambium Damage        |
| 4460    | 2A-B  | Foothills Palo Verde | 8                            | NS     | Leaning / Cambium Damage        |
| 4461    | 2A-B  | Foothills Palo Verde | 7                            | NS     | Diseased / Cambium Damage       |
| 4462    | 2A-B  | Foothills Palo Verde | 5                            | NS     | Diseased / Cambium Damage       |
| 4463    | 2A-B  | Foothills Palo Verde | 6                            | S      |                                 |
| 4464    | 2A-B  | Foothills Palo Verde | 10                           | NS     | Branch Dieback                  |
| 4465    | 2A-B  | Foothills Palo Verde | 6                            | NS     | Trunk Form / Leaning            |
| 4466    | 2A-B  | Hackberry            | 10                           | NS     | Branch Dieback                  |
| 4467    | 2A-B  | Hackberry            | 10                           | NS     | Branch Dieback                  |

| Plant # | Phase | Common Name          | Caliper (in)/<br>Height (ft) | Status | Comments                        |
|---------|-------|----------------------|------------------------------|--------|---------------------------------|
| 4468    | 2A-B  | Foothills Palo Verde | 6                            | NS     | Branch Dieback / Leaning        |
| 4469    | 2A-B  | Foothills Palo Verde | 20                           | NS     | Exposed Roots / Cambium Damage  |
| 4470    | 2A-B  | Foothills Palo Verde | 16                           | NS     | Exposed Roots / Cambium Damage  |
| 4471    | 2A-B  | Foothills Palo Verde | 6                            | RIP    | Branch Dieback / Cambium Damage |
| 4472    | 2A-B  | Foothills Palo Verde | 8                            | RIP    | Branch Dieback / Cambium Damage |
| 4473    | 2A-B  | Foothills Palo Verde | 14                           | RIP    | Branch Dieback / Cambium Damage |
| 4474    | 2A-B  | Barrel               | 3                            | RIP    |                                 |
| 4475    | 2A-B  | Foothills Palo Verde | 10                           | RIP    | Branch Dieback / Cambium Damage |
| 4476    | 2A-B  | Foothills Palo Verde | 7                            | RIP    | Branch Dieback / Cambium Damage |
| 4477    | 2A-B  | Foothills Palo Verde | 7                            | RIP    | Leaning / Cambium Damage        |
| 4478    | 2A-B  | Foothills Palo Verde | 10                           | RIP    | Leaning / Cambium Damage        |
| 4479    | 2A-B  | Foothills Palo Verde | 10                           | RIP    | In Rocks / Cambium Damage       |
| 4480    | 2A-B  | Foothills Palo Verde | 8                            | NS     | Branch Dieback / Cambium Damage |
| 4481    | 2A-B  | Hackberry            | 80                           | NS     | Wide Base / Cambium Damage      |
| 4482    | 2A-B  | Hackberry            | 60                           | NS     | Wide Base / Cambium Damage      |
| 4483    | 2A-B  | Hackberry            | 40                           | NS     | Wide Base / Cambium Damage      |
| 4484    | 2A-B  | Foothills Palo Verde | 6                            | NS     | Declining / Cambium Damage      |
| 4485    | 2A-B  | Foothills Palo Verde | 8                            | NS     | Declining / Cambium Damage      |
| 4486    | 2A-B  | Foothills Palo Verde | 6                            | NS     | Branch Dieback / Cambium Damage |
| 4487    | 2A-B  | Foothills Palo Verde | 7                            | NS     | Exposed Roots / Root Growth     |
| 4488    | 2A-B  | Foothills Palo Verde | 8                            | NS     | Trunk Form / Root Growth        |
| 4489    | 2A-B  | Foothills Palo Verde | 8                            | S      |                                 |
| 4490    | 2A-B  | Foothills Palo Verde | 18                           | NS     | Branch Dieback / Cambium Damage |
| 4491    | 2A-B  | Foothills Palo Verde | 14                           | NS     | Trunk Form / Root Growth        |
| 4492    | 2A-B  | Foothills Palo Verde | 7                            | NS     | Trunk Form / Root Growth        |
| 4493    | 2A-B  | Foothills Palo Verde | 12                           | NS     | Branch Dieback / Cambium Damage |
| 4494    | 2A-B  | Foothills Palo Verde | 8                            | S      |                                 |
| 4495    | 2A-B  | Foothills Palo Verde | 12                           | S      |                                 |
| 4496    | 2A-B  | Foothills Palo Verde | 6                            | S      |                                 |
| 4497    | 2A-B  | Foothills Palo Verde | 8                            | S      |                                 |
| 4498    | 2A-B  | Foothills Palo Verde | 8                            | NS     | Branch Dieback                  |
| 4499    | 2A-B  | Foothills Palo Verde | 12                           | NS     | Branch Dieback / Cambium Damage |
| 4500    | 2A-B  | Foothills Palo Verde | 6                            | NS     | Exposed Roots                   |
| 4501    | 2A-B  | Foothills Palo Verde | 22                           | NS     | Branch Dieback / Cambium Damage |
| 4502    | 2A-B  | Barrel               | 4                            | S      |                                 |
| 4503    | 2A-B  | Foothills Palo Verde | 4                            | S      |                                 |
| 4504    | 2A-B  | Foothills Palo Verde | 5                            | S      |                                 |
| 4505    | 2A-B  | Foothills Palo Verde | 6                            | S      |                                 |
| 4506    | 2A-B  | Foothills Palo Verde | 6                            | NS     | Trunk Form / Cambium Damage     |
| 4507    | 2A-B  | Foothills Palo Verde | 8                            | S      |                                 |
| 4508    | 2A-B  | Mesquite             | 6                            | RIP    | Branch Dieback                  |
| 4509    | 2A-B  | Foothills Palo Verde | 6                            | NS     | Trunk Form / Root Growth        |
| 4510    | 2A-B  | Foothills Palo Verde | 6                            | NS     | Trunk Form / Root Growth        |
| 4511    | 2A-B  | Foothills Palo Verde | 5                            | S      |                                 |
| 4512    | 2A-B  | Foothills Palo Verde | 8                            | S      |                                 |
| 4513    | 2A-B  | Hackberry            | 99                           | NS     | Wide Base                       |
| 4514    | 2A-B  | Hackberry            | 20                           | NS     | Wide Base                       |
| 4515    | 2A-B  | Foothills Palo Verde | 6                            | NS     | Branch Dieback                  |
| 4516    | 2A-B  | Foothills Palo Verde | 10                           | NS     | Mistletoe                       |

| Plant # | Phase | Common Name          | Caliper (in)/<br>Height (ft) | Status | Comments                        |
|---------|-------|----------------------|------------------------------|--------|---------------------------------|
| 4517    | 2A-B  | Foothills Palo Verde | 6                            | NS     | Trunk Form / Poor Structure     |
| 4518    | 2A-B  | Foothills Palo Verde | 12                           | NS     | Branch Dieback / Cambium Damage |
| 4519    | 2A-B  | Foothills Palo Verde | 10                           | NS     | Exposed Roots / Cambium Damage  |
| 4520    | 2A-B  | Foothills Palo Verde | 24                           | NS     | Mistletoe / Cambium Damage      |
| 4521    | 2A-B  | Foothills Palo Verde | 14                           | NS     | Exposed Roots / Cambium Damage  |
| 4522    | 2A-B  | Foothills Palo Verde | 8                            | NS     | Exposed Roots / Cambium Damage  |
| 4523    | 2A-B  | Foothills Palo Verde | 6                            | NS     | Leaning / Cambium Damage        |
| 4524    | 2A-B  | Foothills Palo Verde | 20                           | NS     | In Rocks / Cambium Damage       |
| 4525    | 2A-B  | Hackberry            | 40                           | NS     | Wide Base                       |
| 4526    | 2A-B  | Hackberry            | 24                           | NS     | Wide Base                       |
| 4527    | 2A-B  | Hackberry            | 12                           | NS     | Branch Dieback / Cambium Damage |
| 4528    | 2A-B  | Foothills Palo Verde | 6                            | NS     | Trunk Form / Leaning            |
| 4529    | 2A-B  | Mesquite             | 6                            | S      |                                 |
| 4530    | 2A-B  | Foothills Palo Verde | 8                            | NS     | Trunk Form / Leaning            |
| 4531    | 2A-B  | Foothills Palo Verde | 18                           | NS     | Branch Dieback / Cambium Damage |
| 4532    | 2A-B  | Foothills Palo Verde | 14                           | NS     | Branch Dieback / Cambium Damage |
| 4533    | 2A-B  | Foothills Palo Verde | 16                           | NS     | Branch Dieback / Cambium Damage |
| 4534    | 2A-B  | Foothills Palo Verde | 5                            | NS     | Declining / Cambium Damage      |
| 4535    | 2A-B  | Foothills Palo Verde | 5                            | NS     | Trunk Form / Cambium Damage     |
| 4536    | 2A-B  | Foothills Palo Verde | 9                            | S      |                                 |
| 4537    | 2A-B  | Foothills Palo Verde | 20                           | NS     | Branch Dieback                  |
| 4538    | 2A-B  | Foothills Palo Verde | 4                            | NS     | Branch Dieback / Cambium Damage |
| 4539    | 2A-B  | Foothills Palo Verde | 6                            | NS     | Trunk Form / Cambium Damage     |
| 4540    | 2A-B  | Foothills Palo Verde | 8                            | NS     | Leaning / Cambium Damage        |
| 4541    | 2A-B  | Foothills Palo Verde | 4                            | NS     | Declining / Cambium Damage      |
| 4542    | 2A-B  | Hackberry            | 20                           | NS     | Wide Base / Cambium Damage      |
| 4543    | 2A-B  | Foothills Palo Verde | 6                            | S      |                                 |
| 4544    | 2A-B  | Foothills Palo Verde | 6                            | S      |                                 |
| 4545    | 2A-B  | Foothills Palo Verde | 5                            | NS     | Trunk Form / Cambium Damage     |
| 4546    | 2A-B  | Foothills Palo Verde | 6                            | NS     | Trunk Form / Root Growth        |
| 4547    | 2A-B  | Foothills Palo Verde | 8                            | NS     | Trunk Form / Root Growth        |
| 4548    | 2A-B  | Foothills Palo Verde | 7                            | NS     | Trunk Form / Root Growth        |
| 4549    | 2A-B  | Mesquite             | 7                            | NS     | Branch Dieback                  |
| 4550    | 2A-B  | Foothills Palo Verde | 6                            | NS     | Trunk Form / Leaning            |
| 4551    | 2A-B  | Foothills Palo Verde | 4                            | NS     | Branch Dieback / Cambium Damage |
| 4552    | 2A-B  | Hackberry            | 7                            | RIP    | Cambium Damage                  |
| 4553    | 2A-B  | Foothills Palo Verde | 6                            | S      |                                 |
| 4554    | 2A-B  | Mesquite             | 5                            | NS     | Branch Dieback / Cambium Damage |
| 4555    | 2A-B  | Foothills Palo Verde | 6                            | S      |                                 |
| 4556    | 2A-B  | Hackberry            | 8                            | NS     | Branch Dieback / Cambium Damage |
| 4557    | 2A-B  | Hackberry            | 18                           | NS     | Wide Base / Cambium Damage      |
| 4558    | 2A-B  | Foothills Palo Verde | 6                            | NS     | Trunk Form / Leaning            |
| 4559    | 2A-B  | Foothills Palo Verde | 8                            | S      |                                 |
| 4560    | 2A-B  | Hackberry            | 30                           | NS     | Wide Base                       |
| 4561    | 2A-B  | Hackberry            | 8                            | RIP    |                                 |
| 4562    | 2A-B  | Mesquite             | 7                            | RIP    | Branch Dieback                  |
| 4563    | 2A-B  | Foothills Palo Verde | 8                            | RIP    |                                 |
| 4564    | 2A-B  | Hackberry            | 5                            | RIP    |                                 |
| 4565    | 2A-B  | Hackberry            | 30                           | RIP    | Wide Base                       |

| Plant # | Phase | Common Name          | Caliper (in)/<br>Height (ft) | Status | Comments                        |
|---------|-------|----------------------|------------------------------|--------|---------------------------------|
| 4566    | 2A-B  | Hackberry            | 14                           | RIP    | Branch Dieback / Cambium Damage |
| 4567    | 2A-B  | Foothills Palo Verde | 20                           | NS     | Branch Dieback / Cambium Damage |
| 4568    | 2A-B  | Foothills Palo Verde | 10                           | RIP    |                                 |
| 4569    | 2A-B  | Mesquite             | 8                            | RIP    |                                 |
| 4572    | 2A-B  | Foothills Palo Verde | 24                           | RIP    | Mistletoe / Cambium Damage      |
| 4573    | 2A-B  | Foothills Palo Verde | 10                           | RIP    | Trunk Form / Leaning            |
| 4574    | 2A-B  | Mesquite             | 6                            | RIP    | Insect Damage / Cambium Damage  |
| 4575    | 2A-B  | Hackberry            | 99                           | RIP    | Wide Base / Cambium Damage      |
| 4576    | 2A-B  | Foothills Palo Verde | 18                           | RIP    | Trunk Form / Leaning            |
| 4577    | 2A-B  | Mesquite             | 22                           | RIP    | Branch Dieback / Cambium Damage |
| 5147    | 2A-B  | Hackberry            | 60                           | RIP    | Wide Base                       |
| 5148    | 2A-B  | Foothills Palo Verde | 12                           | RIP    |                                 |
| 5149    | 2A-B  | Hackberry            | 8                            | RIP    | Trunk Form / Leaning            |
| 5150    | 2A-B  | Hackberry            | 99                           | RIP    | Wide Base                       |
| 5151    | 2A-B  | Foothills Palo Verde | 8                            | S      |                                 |
| 5152    | 2A-B  | Hackberry            | 10                           | RIP    | Branch Dieback                  |

| <b>Summary</b>  | Trees       | Cacti     |
|-----------------|-------------|-----------|
| Salvageable     | 344         | 45        |
| Non-Salvageable | 835         | 13        |
| Remain-In-Place | 501         | 29        |
| <b>Total</b>    | <b>1680</b> | <b>87</b> |

**Legend**  
S = Salvageable  
NS = Non-Salvageable  
RIP = Remain-In-Place