

Neighborhood Notification
Open House Information
Citizen Comments
Affidavit of Posting
Site Sign
Legal Protest



Affidavit of Posting

Office of the City Clerk

STATE OF ARIZONA)
)
COUNTY OF MARICOPA)

ss

I, Alex Acevedo, being first duly sworn, depose and say:

That on January 8, 2018, I posted notification poster(s) for the properties indicated below.

Site(s) must be posted on or before: January 8, 2018

Case No.	Description and Location of Project	No. of Signs	Date Posted
8-AB-2017	Wilshire Place Abandonment, 7121 E Wilshire Dr	1	1-8-18

Date of City Council Public Meeting: January 23, 2018, AT 5:00 P.M. IN THE CITY HALL KIVA, SCOTTSDALE, ARIZONA.

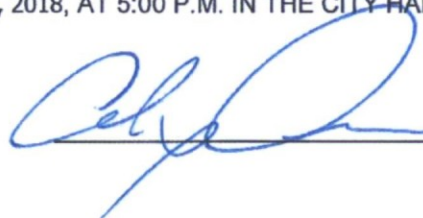
(Signature)

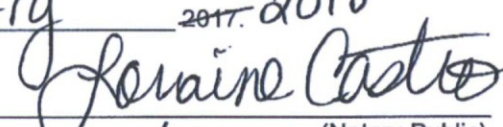
Acknowledged this 8th day of JANUARY 2017 2018

(Notary Public)
My commission expires 11/15/2020



Planning and Development Services

7447 E. Indian School Road, Suite 105, Scottsdale, AZ 85251 ♦ Phone: 480-312-7000 ♦ Fax: 480-312-7088



Neighborhood Notification

E Project, LLC

Architecture - Planning

DATE: JULY 23, 2017

917 W. Kathleen Rd, Phoenix, AZ 85023
Phone 602.481.9282 Fax 480.359.4407
E-mail: edmir@e-projectinternational.com

RE: Case No. 391-PA-2016

Description of Request:

Alley and Right-of-Way Abandonment and Alley Dedication

Dear Property Owner or Neighborhood Association President,

The purpose of this letter is to inform you about alley and right-of-way abandonments and dedications request recently filed in City of Scottsdale.

The project is located at the 7121 E Wilshire and consists of a 0.4 acre site. The proposed development will consist of new multi-family development with 5 townhome units. This project is in full compliance with current zoning R-3.

Our West property line is not perpendicular to Wilshire Drive and existing alley has less than 24 feet of clear width. Public Works department approved method of solid waste collection on this project with two large common bins to be located at West side of our west property line.

In order to accommodate that waste collection system we have to create 24 feet wide alley, and that would require ROW dedication on South side and also alley abandonment on North side. We are also applying for ROW abandonment at SEC of Wilshire at the curve. Proposed ROW line will follow Wilshire Drive curvature. You will receive additional mailing from the City of Scottsdale Planning Department to notify you about public hearing related to this case.

If you have questions regarding this meeting, please contact our office:

City Planner:

Brad Carr
480-312-7713
bcarr@scottsdaleaz.gov

Architect:

Edmir Dzudza, AIA
For 7121 E Wilshire, LLC
Phone : 602-481-9282
Fax : 480-359-4407
E-mail : edmir@e-projectinternational.com

Attachments:

- Neighborhood notification (this document)

cc: City of Scottsdale Current Planning Department

End of Document

Map

391-PA-2017

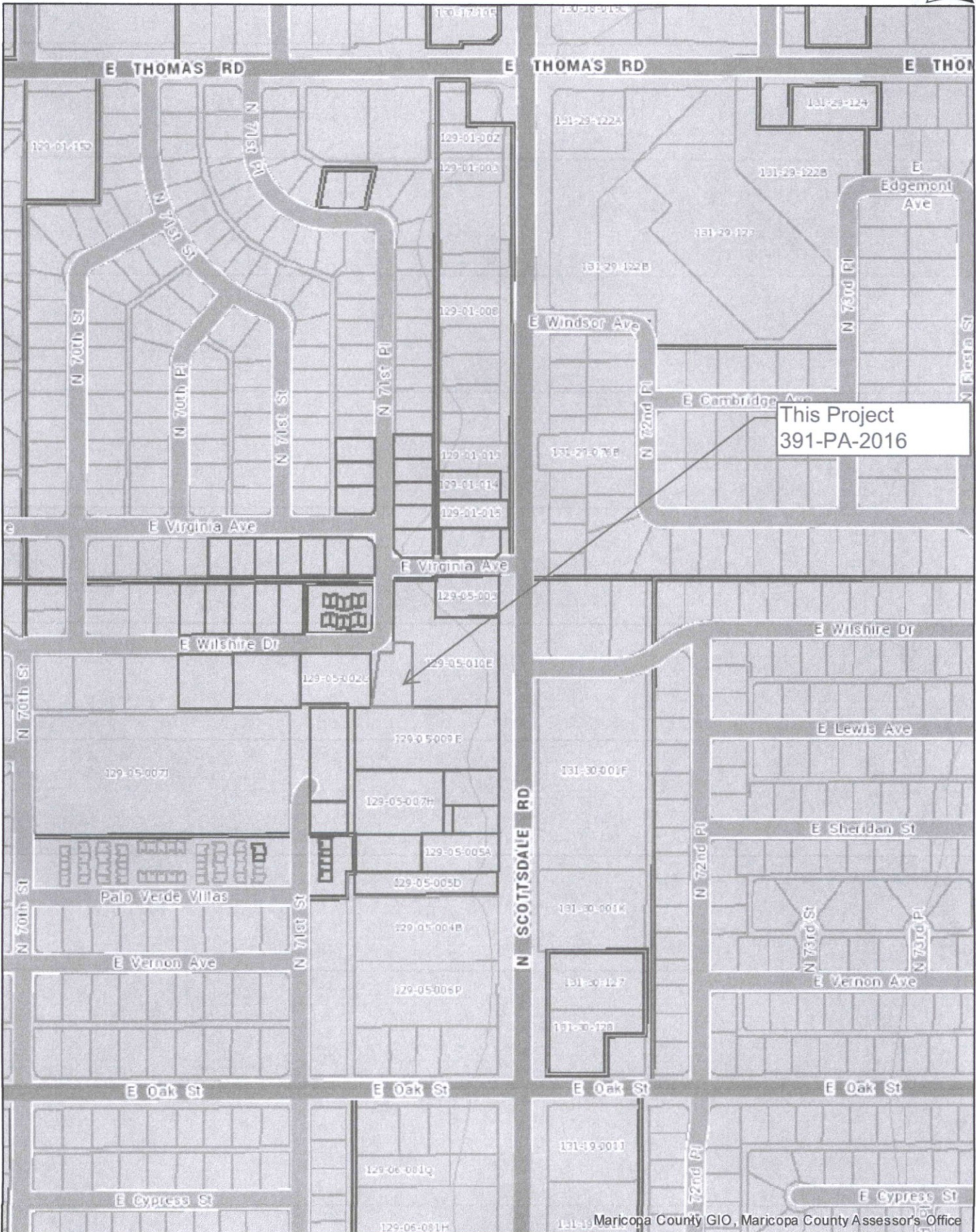

Jim Getty
Coronado Heights
2647 N 73rd Pl
Scottsdale, AZ 85257

Jim Bourassa
Cranbrooke Manor Neighborhood
Watch
2642 N 70th St
Scottsdale, AZ 85257

Curtis Ekmark
Scottsdale Council of HOAs
(SCOHA)
6720 N Scottsdale Rd
Scottsdale, AZ 85253

Andrea Moscarello
Scottsdale Council of HOAs
(SCOHA)
6720 N Scottsdale Rd
Scottsdale, AZ 85253

Nancy Cantor
Scottsdale Coalition
3408 N Pauite Wy
Scottsdale, AZ 85251

Dadra Hunt
Cranbrooke Manor Neighborhood
Watch
2809 N 70th St
Scottsdale, AZ 85257

Bobbie Patterson
Villa Doce HOA
7120 E Wilshire Dr
Scottsdale, AZ 85257

Keith Elson
Villa Doce HOA
6906 S 21st Dr
Phoenix, AZ 85041

Mary Sampietro
Cranbrooke Manor Neighborhood
Watch
2627 N 70th St
Scottsdale, AZ 85257

Irene Mayer
Villa Doce HOA
PO Box 2257
Scottsdale, AZ 85252-2257

NEW LIFE COMMUNITY CHURCH
OF SCOTTSDALE
2500 N SCOTTSDALE RD
SCOTTSDALE, AZ 85257

NEW LIFE COMMUNITY CHURCH
OF SCOTTSDALE
2500 N SCOTTSDALE RD
SCOTTSDALE, AZ 85257

PEP PROPERTIES INC
32ND ST & ALLEGHENY AVE
PHILADELPHIA, PA 19132

MARITAL TRUST OF THE
HOOGSTRA FAMILY TRUST
6419 E GARY RD
SCOTTSDALE, AZ 85254

FULLER JEREMY L & TARYN M
MOSLEY
7024 E WILSHIRE DR
SCOTTSDALE, AZ 85257

MEDRANO LIVING TRUST
7028 E WILSHIRE DR
SCOTTSDALE, AZ 85257

SAMAYOA HELEN
PAMELA/PLAGEMAN KEVIN JAY
2252 VIA APRILIA
DEL MAR, CA 92014

BAUM MICHAEL B
7040 E WILSHIRE DR
SCOTTSDALE, AZ 85257

HOWELL ROBERT L
7046 E WILSHIRE DR
SCOTTSDALE, AZ 85257

ARNOLD PAUL R
6817 E GELDING DR
SCOTTSDALE, AZ 85254

HALBACH JAMES R TR
PO BOX 771
SCOTTSDALE, AZ 85251

STEWART LIVING TRUST
3601 E LAUREL LN
PHOENIX, AZ 85028

KLINE KRYSTEN
1410 W VILLA RITA DR
PHOENIX, AZ 85023

THOMAS JOCHEMS AND MICHELE
MARCELLO REV TRUST
725 S SANTA ANA DR
TUCSON, AZ 85710

JM DOUGHTY LLC
5055 S ROOSEVELT
TEMPE, AZ 85282

CURLEY ADRIANNE
1418 N SCOTTSDALE RD # 333
SCOTTSDALE, AZ 85257

CASAREZ YOLANDA M
7120 E WILSHIRE #1
SCOTTSDALE, AZ 85251

CASREZ YOLANDA M
3616 E CROSSROADS
ROSWELL, NM 88203

LOEWEN JASON R
8708 E PLAZA AVE
SCOTTSDALE, AZ 85250

STEINKE GREG
7120 E WILSHIRE DR 4
SCOTTSDALE, AZ 85257

GUTHRIE WILLIAM HARVEY JR
2237 GROVE
DENVER, CO 80211

PATTERSON BOBBIE C
7120 E WILSHIRE LOT 8
SCOTTSDALE, AZ 85257

VIULA CHRISTINA L/JELF JUSTIN
7120 E WILSHIRE DRIVE APT 9
SCOTTSDALE, AZ 85257

SPENCE TRUST
1937 E BETHANY HOME RD
PHOENIX, AZ 85016

STERLING HOPSON CLAUDIA
7120 E WILSHIRE DR 11
SCOTTSDALE, AZ 85257

SOARES PHILIPPE
7743 E ROVEY AVE
SCOTTSDALE, AZ 85250

KULIK STEPHEN/RAMONA TR
2391 E LOCKWOOD ST
MESA, AZ 85213

KULIK STEPHEN/RAMONA TR
2391 E LOCKWOOD ST
MESA, AZ 85213

THE ZIYA HASANOFF & KIM A
HASANOFF FAMILY REV
6390 E MONTERRA WY
SCOTTSDALE, AZ 85262

HAMILTON SANDRA S TR
8655 E SAN MIGUEL
SCOTTSDALE, AZ 85253

MILLIGAN DANIEL J
7119 E VIRGINIA
SCOTTSDALE, AZ 85257

FERGUESON GEORGE W
7113 E VIRGINIA AVE
SCOTTSDALE, AZ 85257

SCHWEMM ESTRELLITA
ELIZABETH
921 E CONCORDA DR
TEMPE, AZ 85282

LONG ROBERT/ANN
1511 W 28TH ST
MINNEAPOLIS, MN 55408

SULLIVAN JAMES ARTHUR
7039 E VIRGINIA AVE
SCOTTSDALE, AZ 85257

GRIFFIN KEVIN
378 SANTANA ROW APT 323
SAN JOSE, CA 95128

QUINTANA ENRIQUE/MARIA
7029 E VIRGINIA
SCOTTSDALE, AZ 85257

FRASER RICHARD R
2602 N 71ST PL
SCOTTSDALE, AZ 85257

GERLACH MARY ANN
2608 N 71ST PL
SCOTTSDALE, AZ 85257

HOWARD WILLIAM DAVID
2612 N 71ST PL
SCOTTSDALE, AZ 85257

FIVE JAYS INC
PO BOX 369
CAMP VERDE, AZ 86322

MARY HOLMES FAMILY LIVING
TRUST
2607 N 71ST PL
SCOTTSDALE, AZ 85257

MULLINS DANIELLE R
2601 N 71ST PL
SCOTTSDALE, AZ 85297

LORENZ BONNIE KAY
2545 N 71ST PL
SCOTTSDALE, AZ 85257

MAYSKY LLC
11114 E ONYX CT
SCOTTSDALE, AZ 85259

BHRAC-PHX REAL PROPERTIES
LLC
9220 S SEPULVEDA BLVD
LOS ANGELES, CA 90045

GATES PAUL DAVID
7045 E WILSHIRE DR
SCOTTSDALE, AZ 85257

LUCAYAN PROPERTIES LLC
24 W CAMELBACK RD A633
PHOENIX, AZ 85013

HOYER SCOTT
800 BRAZOS ST
AUSTIN, TX 78701

DAK PROPERTIES LLC
PO BOX 41448
MESA, AZ 85274

OAK PLAZA INVESTMENTS
2334 N SCOTTSDALE RD
SCOTTSDALE, AZ 85257

OAK PLAZA INVESTMENTS
2334 N SCOTTSDALE RD
SCOTTSDALE, AZ 85257

SCOTTSDALE BAPTIST CHURCH
OF AZ
2500 N SCOTTSDALE RD
SCOTTSDALE, AZ 85257

MJR HOLDINGS ARIZONA LLC
5350 E CALLE DEL MEDIO
PHOENIX, AZ 85018

NEW LIFE COMMUNITY CHURCH
OF SCOTTSDALE
2500 N SCOTTSDALE RD
SCOTTSDALE, AZ 85257

BHRAC-PHX REAL PROPERTIES
LLC
9220 S SEPULVEDA BLVD
LOS ANGELES, CA 90045

Request for Site Visits and/or Inspections

Development Application (Case Submittals)



This request concerns all property identified in the development application.

Pre-application No: 391 -PA- 2016

Project Name: Wilshire Place

Project Address: 7121 N Wilshire Scottsdale AZ

STATEMENT OF AUTHORITY:

1. I am the owner of the property, or I am the duly and lawfully appointed agent of the property and have the authority from the owner to sign this request on the owner's behalf. If the land has more than one owner, then I am the agent for all owners, and the word "owner" refer to them all.
2. I have the authority from the owner to act for the owner before the City of Scottsdale regarding any and all development application regulatory or related matter of every description involving all property identified in the development application.

STATEMENT OF REQUEST FOR SITE VISITS AND/OR INSPECTIONS

1. I hereby request that the City of Scottsdale's staff conduct site visits and/or inspections of the property identified in the development application in order to efficiently process the application.
2. I understand that even though I have requested the City of Scottsdale's staff conduct site visits and/or inspections, city staff may determine that a site visit and/or an inspection is not necessary, and may opt not to perform the site visit and/or an inspection.

Property owner/Property owner's agent: Edmir Dzudza

Print Name

Signature

City Use Only:

Submittal Date: _____ Case number: _____

Planning and Development Services

7447 E Indian School Road, Suite 105, Scottsdale, AZ 85251 ♦ Phone: 480-312-7000 ♦ Fax: 480-312-7088

Request for Neighborhood Group/ Homeowners Association



For Staff Use Only

Time/Date Received _____

Time/Date Completed _____

REQUESTOR'S INFORMATION

Requestor's Name: Edmir Dzudza

Date of request: 07-17-2017 Requestor's Phone #: (602) 481 - 9282

Method to receive Group/Homeowner information (select one)

E-mail edmir@e-projectinternational.com

Mail Address: 917 W Kathleen rd, Phoenix, AZ, 85023

SITE LOCATION/PROJECT INFORMATION

Project Name: Wilshire Place

Project Address: 7121 E Wilshire Dr Scottsdale, AZ

Project Parcel Number(s): 129-05-010D

Radius around parcel(s) requested: ☐ 300' ☒ 750'

City Pre-application/Case#: 391-PA-2016 City Project Coordinator: Brad Carr

Notification Type? ☐ Citizen Review Plan ☐ Neighborhood Involvement

Any additional information that may be helpful to collect data: _____

Alley Abandonment and ROW Dedication

Please note:

This list is provided as a one-time use only for preparing a City Planning and Development Service Department application. Currently there is no charge for this service, however, this may change based on demand. Results provided are based only on registered neighborhood groups or associations with the City. All requests will be processed and returned to your attention as soon as possible; in most cases within two business days.

To Submit your request, or for additional information, please contact:

Current Planning Services
7447 E. Indian School Rd Suite 105
Scottsdale, AZ 85251

Phone: (480) 312-7000
e-mail: planninginfo@scottsdaleaz.gov