

**Exterior Building Color & Material Samples**

**Color Drawdowns**

**Archaeological Resources**

**Airport Vicinity Development Checklist**

**Parking Study**

**Trip Generation Comparison**

**Parking Master Plan**



# CERTIFICATE OF NO EFFECT ARCHAEOLOGICAL RESOURCES

18-DR-2018

Palmeraie

## APPLICATION INFORMATION

LOCATION	6990 North Scottsdale Road	APPLICANT	George Pasquel III
PARCEL	174-56-001D, 174-56-002A	COMPANY	Withey Morris, PLC
Q S	22-44	ADDRESS	2525 East Arizona Biltmore Circle, Ste A-212 Phoenix, AZ 85016
		PHONE	602-230-0600

Request Request approval of the site plan, landscape plan, and building elevations for a new mixed-use development, including approximately 223,500 square feet of building area, one level of below-grade parking, and a 150-foot-tall spire, all on a 12.4-acre site

### Certificate of No Effect-Archaeological Resources Criteria:

In accordance with Chapter 46, Article VI, of the Scottsdale Revised City Code, the City Archaeologist finds that

- No archaeological resources are located on the property according to the archaeological survey and report and based upon review of the report by the City Archaeologist

## STIPULATIONS

- 1 Any development on the property is subject to the requirements of Scottsdale Revised Code, Chapter 46, Article VI, Protection of Archaeological Resources, Section 46-134 - Discoveries of archaeological resources during construction

SIGNATURE

*Steve Venker*  
Steve Venker, City Archaeologist,  
480-312-2831

DATE

*10/23/18*

### Planning and Development Services

7447 E Indian School Road Suite 105, Scottsdale, AZ 85251 Phone 480-312-7000 Fax 480-312-7088

City of Scottsdale's Website [www.scottsdaleaz.gov](http://www.scottsdaleaz.gov)

Page 1 of 1

Revision Date 12/16/2014



A Class III Cultural Resources Survey of 20 acres for the  
Palmeraie Project near the Intersection of Scottsdale  
and Indian Bend Roads in Scottsdale, Maricopa County,  
Arizona

Submitted to:

Coe & Van Loo Consultants, Inc.  
4550 N. 12<sup>th</sup> Street  
Phoenix, AZ 85014

Technical Report 16-23  
July 6, 2018

**18-DR-2018**  
**10/04/18**

## **1. REPORT TITLE**

**1a Report Title:** A Class III Cultural Resources Survey of 20 acres for the Palmeraie Project near the Intersection of Scottsdale and Indian Bend Roads in Scottsdale, Maricopa County, Arizona

**1b. Report Author(s):** Emily Elizabeth Graff, M A , RPA

**1c. Date** July 6, 2018

**1d. Report No..** 16-23

## **2. PROJECT REGISTRATION/PERMITS**

**2a. ASM Accession Number:** N/A

**2b. AAA Permit No..** N/A

**2c. ASLD Lease Application No.:** N/A

**2d. Other Permit Number(s):** N/A

## **3. ORGANIZATION/CONSULTING FIRM**

**3a. Name:** PaleoWest Archaeology

**3b. Internal Project Number.** 16-015

**3c. Internal Project Name:** Palmeraie Scottsdale Survey

**3d. Contact Name.** Chris North, M A , RPA

**3e. Contact Address.** 319 E Palm Lane, Phoenix AZ 85004

**3f Contact Phone:** (602) 261-7253

**3g. Contact Email** cnorth@paleowest.com

## **4. SPONSOR/LEAD AGENCY**

**4a Sponsor.** Coe & Van Loo Consultants, Inc

**4b. Lead Agency:** City of Scottsdale (COS)

**4c. Agency Project Number(s):** City of Scottsdale Case Number 18-DR-2018

**4d. Agency Project Name:** N/A

**4e. Funding Source(s):** Private

**4f. Other Involved Agencies:** N/A

**4g Applicable Regulations:** Scottsdale Revised Code Chapter 46  
Article VI Protection of Archaeological Resources

## 5. DESCRIPTION OF PROJECT OR UNDERTAKING:

This project area is proposed for resort development PaleoWest conducted a cultural resources survey in compliance with the City of Scottsdale (COS) Ordinance 3243 of 20 acres in Scottsdale, Maricopa County, Arizona to identify any cultural resources that might be present and to evaluate their significance

## 6. PROJECT AREA/AREA OF POTENTIAL EFFECTS:

The project area resides within a 20-acre rectangular-shaped-parcel at the southwest intersection of Scottsdale and Indian Bend roads

## 7. PROJECT AREA INFORMATION:

**7a. Address:** Assessor Parcel No 174-56-001D

**7b. Route:** N/A

**7c. Mileposts**N/A  
**Limits:**

**7d. Nearest City/Town:** Scottsdale, Arizona

**7e. County:**Maricopa

**7f. Project Locator UTM's:** 414052mE 3711200 mN **7g. NAD83** **7h. Zone: 12**

**7i. Baseline &** **7j. USGS**Paradise Valley, Arizona

**Meridian:** G&SRB&M **Quadrangle(s):**(1982)

**7k. Legal** E½, NE¼, NE ¼ of Section 10, T2N, R4E

**Description(s):**

## 8. SURVEY AREA

**8a Total Acres:** 20

**8b. Survey Area**

1. Land Jurisdiction	2. Total Acres Surveyed	3. Total Acres Not Surveyed	4. Justification for Areas Not Surveyed
PVT	20	0	

## 9. ENVIRONMENTAL CONTEXTS

**9a. Landform.** Gradual east-facing slope on the bajada of the Phoenix Mountains

**9b Elevation·** 1,299 ft above mean sea level (amsl)

**9c Surrounding Topographic Features.** Camelback Mountain is southwest of the project area, Mummy Mountain is to the west

**9d. Nearest Drainage** (Distance and Direction)\*

Indian Bend Wash is approximately 0.5-mile to the east of the project area. Minor drainages oriented east-west cross the project area.

**9e. Local Geology:** Valley fill

**9f. Vegetation.** Creosote, mesquite, palo verde, desert broom, shrubs, and grasses

**9g. Soils/Deposition.** Residual, light-to-medium brown clay silt with medium compaction

**9h. Buried Deposits:** Not likely

**9i. Justification:** The ground surface is stable and shallow drainages cross the parcel. Active deposition that may bury cultural resources is not occurring within the project area.

**10. BUILT ENVIRONMENT** There are residential properties to the west of the project area, office buildings are south of the project area, Scottsdale Road and the McCormick-Stillman Railroad Park (including the historic Roald Amundsen Pullman Private Railroad Car) are east of the project area, and Indian Bend Road and the Scottsdale Plaza Resort are north of the project area.

## 11. INVENTORY CLASS COMPLETED

**11a. Class I Inventory:** ☒

**11b. Researcher(s):** Emily Elizabeth Graff

**11c. Class II Survey:**

**11d. Sampling Strategy:**

**11e. Class III Inventory:** ☒

## 12. BACKGROUND RESEARCH SOURCES

**12a. AZSITE** ☒

**12b. ASM Archaeological Records Office:** ☐

**12c. SHPO Inventories and/or SHPO Library:** ☐

**12d. National Register of Historic Places (NRHP) Database:** ☒

**12e. ADOT Portal:** ☐

**12f GLO Maps:** Plat 00076, filed 12/2/1870, Plat 00075, filed 12/4/1890, Plat 00074, filed 2/15/1905

**12g Land-Managing Agency** N/A

**Files:**

**12h. Tribal Cultural Resources** N/A

**Files:**

**12i. Local Government Websites.** City of Scottsdale Historic Register (Scottsdale City Council 2013)

**12j. Other:** N/A

### 13. BACKGROUND RESEARCH RESULTS

#### 13a. Previous Projects Within 1-Mile Study Area.

1 Project Reference Number	2 Project Name	3 Author(s)	4 Year
2000-426 ASM	LVA II Arch Survey	Shaw	2000
2003-650 ASM	Starpointe 8 Acre Survey	Lange and Hohmann	2001
2003-1274 ASM	Paradise Valley Pump Station	Rogers	2003
2004-1753 ASM	Lincoln Drive Sidewalks	Bild	2004
2004 1835 ASM	McDonald Drive and Miller Road Survey	Shaw	2004
2006-26 ASM	Scottsdale Road Conduit	Lonardo	2006
2006-776 ASM	Indian Bend Road Improvements	Erickson and Rogge	2007
2013-179 ASM	Scottsdale DAS 29 Towers	Luchetta and Moses	2013
2014 26 ASM	Public Cell Towers	Luchetta and Moses	2014
SHPO 2004-0487	Site # PH54XC125F "Mummy" MACTEC # 4974-04-1201 522 Sprint PCS proposed	Slawson	2004
SHPO-2000-3440	Proposed Communication Antenna Installation - Cricket - APS Nasser / PHX-094C Tower Site - 6500 N	Solometo	2000

#### 13b. Previously Recorded Cultural Resources Within 1-Mile Study Area.

1 Site No / Name	2 Affiliation	3 Site Type	4 Eligibility Status	5 Associated Reference(s)
N/A	N/A	N/A	N/A	N/A

#### 13c. Historic Buildings/Districts/Neighborhoods.

1 Property Name or Address	2 Year	3 Eligibility Status
Roald Amundsen Pullman Private Railroad Car	1928	NRHP listed
Louise Lincoln Kerr House and Studio	1959	NRHP listed
George Ellis House	1937	NRHP listed

## 14. CULTURAL CONTEXTS

**14a. Prehistoric Culture:** Hohokam (A D 1-1450)

**14b. Protohistoric Culture:** Piman, Yavapai (A D 1450-1800s)

**14c. Indigenous Historic Culture:** Pima, Yavapai

**14d. Euro-American Culture:** Spanish (post A D 1540), Euro-American (A D 1800s-1900s)

## 15. FIELD SURVEY PERSONNEL

**15a. Principal Investigator:** Chris North, M A , RPA

**15b. Field Supervisor:** Scott Courtright, B A

**15c. Crew:** Emily Elizabeth Graff, M A , RPA

**15d. Fieldwork Date(s).** February 18, 2016

## 16. SURVEY METHODS

**16a. Transect Intervals:** 20 m apart

**16b. Coverage (%):** 100

**16c. Site Recording Criteria:** ASM (Fish 1995)

**16d. Ground Surface Visibility:** 90%

**16e. Observed Disturbances:** The undeveloped parcel is in good condition (Figure 1) and has scattered modern trash deposits and a few bladed two-track roads. A ditch borders the east, north, and south sides of the parcel and prohibits vehicles from entering the parcel. The deteriorated remains of a paved gravel parking lot are located at the northeast-portion of the parcel (Figure 2)

## 17. FIELD SURVEY RESULTS

**17a. No Cultural Resources Identified:** ☐

**17b. Isolated Occurrences (IOs) Only:** ☒

**17c. Number of IOs Recorded.** 3



**17d. Table of IOs**

1. IO Number	2. Description	3. Date Range	4. UTM's	
			Easting	Northing
1	5 Gila Plain, Salt variety sherds within a 10-m-diameter area	Hohokam, A D 1–1450		
2	1 tested basalt cobble	Prehistoric, unknown		
3	1 tested rhyolite cobble	Prehistoric, unknown		

**18. COMMENTS:**

No historic features are located within the project area on the GLO plats referenced above. The NRHP- and Scottsdale Historic Register-listed Roald Amundsen Pullman Car is located at 7301 East Indian Bend Road but is nearly 800 ft east of the project area. The railroad car is not visible from the project area. The two other NRHP-listed properties within the records search area—the Louise Lincoln Kerr House and Studio (1959) and the George Ellis House (1937)—are located more than one-half mile south and southeast of the project area, respectively, and are not visible from the project area. The proposed project will not have an adverse effect on the NRHP or Scottsdale Historic Register eligible qualities of these three historic properties.

The Class III cultural resources survey of 20 acres resulted in the identification of three IOs. These are not eligible for the Arizona Register of Historic Places (ARHP), the NRHP, or the Scottsdale Historic Register, and no additional research or avoidance is required.

The proposed project will have no effect on historic properties because none are located in or immediately adjacent to the project area. However, if previously unrecorded cultural resources are encountered during ground-disturbing activities, these activities must be discontinued in the immediate vicinity of the discovery (per Scottsdale Revised Code Sec 46-134 Discovery Clause), and work should not resume until City of Scottsdale Historic Preservation Department and the State Historic Preservation Office (SHPO) has been notified and allowed time to properly address the nature and significance of the discovery.

**SECTION 19. ATTACHMENTS**

**19a. Project Location Map.** ☒ (Figure 3, Figure 4 depicts results of survey)

**19b. Land Jurisdiction Map:** ☒ (Figure 3)

**19c. Background Research Map.** ☒ (Figure 5)

**19d. GLO Map(s):** ☐ There are no historic features displayed on the GLO maps within one mile of the project area

**19e. References:** ☒

## 20. CONSULTANT CERTIFICATION

I certify the information provided herein has been reviewed for content and accuracy and all work meets applicable agency standards



Date 2/25/2016

Signature

Principal Investigator/Senior Project Manager

Title

## 21. Discovery Clause

In the event that previously unreported cultural resources are encountered during ground disturbing activities, all work must immediately cease within 30 meters (100 feet) of those activities until a qualified archaeologist has documented the discovery and evaluated its eligibility for the Arizona or National Register of Historic Places in consultation with the lead agency, the SHPO, and Tribes, as appropriate (Scottsdale Revised Code Sec 46-134 Discovery Clause) Work must not resume in this area without approval of the lead agency

If human remains are encountered during ground-disturbing activities, all work must immediately cease within 30 meters (100 feet) of the discovery and the area must be secured The Arizona State Museum, lead agency, SHPO, and appropriate Tribes must be notified of the discovery All discoveries will be treated in accordance with NAGPRA (Public Law 101-601, 25 U S C 3001-3013) or Arizona Revised Statutes (A R S § 41-844 and A R S § 41-865), as appropriate, and work must not resume in this area without authorization from ASM and the lead agency

STATE HISTORIC PRESERVATION OFFICE  
SURVEY REPORT SUMMARY FORM



**Figure 1.** Overview of project area with Camelback Mountain in background, facing southwest.



**Figure 2.** Overview of project area with deteriorated gravel-paved parking area, facing northwest.



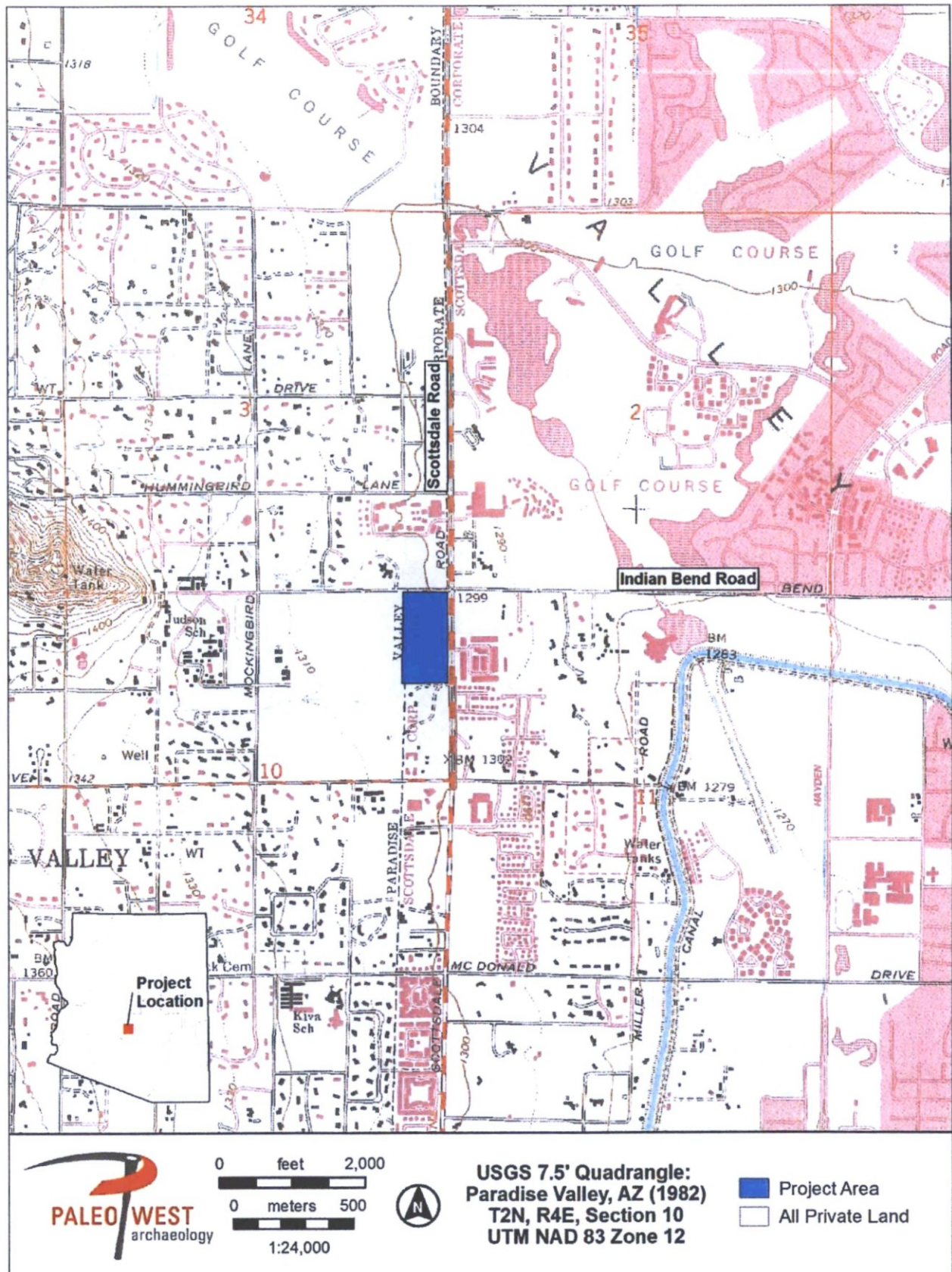

Figure 3. Project location map showing land jurisdiction.

## REFERENCES

Bild, D A

2004 *A Cultural Resources Survey of Approximately 10 acres for the Lincoln Drive Multiuse Path between 32nd Street and Invergordon Road, Paradise Valley, Maricopa County, Arizona* Technical Report No 035206 Logan Simpson Design Inc , Tempe

Erickson, K and A E Rogge

2007 *Cultural Resource Survey for Indian Bend Road Hayden Road to Scottsdale Road Improvements, Scottsdale, Maricopa County, Arizona* Cultural Resource Report 2007-6(AZ) URS Corporation, Phoenix

Fish, P R

1995 Revised Site Definition Policy Arizona State Museum, Tucson

Lange, F W , and J W Hohmann

2001 *A Phase I (Class III) Archaeological Survey of 8 Acres for Starpointe Indian Bend Ventures Project, Scottsdale, Maricopa County, Arizona* The Louis Berger Group, Inc Cultural Resource Division Clearance Report No 264 Phoenix

Lonardo, C

2006 *A Cultural Resources Survey of 9.85 Miles of Scottsdale Road Right-of-Way between Indian School Road and Frank Lloyd Wright Boulevard, Scottsdale, Maricopa County, Arizona* Technical Report No 065009 Logan Simpson Design Inc , Tempe

Luchetta, S and J Moses

2013 *Cultural Resources Assessment Survey of 29 Proposed Verizon Wireless Telecommunication Facilities Known as the Scottsdale DAS Towers, Maricopa County, Arizona* Antigua Archaeology, LLC, Prescott

2014 *Cultural Resources Assessment Survey of 62 Proposed Telecommunication Facilities Located on Public Lands across Arizona* Antigua Archaeology, LLC, Prescott

Rogers, J

2003 *A Cultural Resource Survey of 2.06 Acres at 14 Paradise Valley Booster Pump Stations, Maricopa County, Arizona* Technical Report No 025325 Logan Simpson Design, Inc Tempe

Scottsdale City Council

2013 Scottsdale Historic Register City of Scottsdale, Arizona

Shaw, C W

2000 *A Cultural Resources Survey of 2.11 Acres Located at the Southwest Corner of 76th Street and Edward Lane, Scottsdale, Maricopa County, Arizona* Logan Simpson Design Inc , Tempe

2004 *A Cultural Resources Survey of 3 Acres at the Southeast Corner of McDonald Drive and Miller Road, City of Scottsdale, Maricopa County, Arizona* Technical Report No 04-56  
Northland Research, Inc , Tempe

Slawson, L

2004 *A Cultural Resources Inventory for a Proposed Telecommunications Site (PH03XC142, Mummy) at 7609 East Indian Bend Road in Scottsdale, Arizona* Aztlan Archaeology Inc,  
Tucson

Solometo, Julie

2000 *Archaeological Survey of the PHX-094C APS Nasser Tower Site, Maricopa County, Arizona* SWCA Environmental Consultants, Phoenix

**CONFIDENTIAL APPENDIX**

# Confidential Information



Figure 4. Project location map showing results of survey



# Confidential Information



**Figure 5.** Project location map showing previous projects and NRHP-listed properties.