



Marked Agendas

Approved Minutes

Approved Reports

**The March 5, 2020
Development Review
Board Meeting Agenda and
Minutes can be found at**

<http://www.scottsdaleaz.gov/boards/development-review-board>

DEVELOPMENT REVIEW BOARD REPORT



Meeting Date: February 20, 2020
General Plan Element: *Character and Design*
General Plan Goal: *Foster quality design that enhances Scottsdale as a unique southwestern desert community.*

ACTION

7034 E. Osborn Road Mural 1-DR-2020

Location: 7034 E. Osborn Rd.

Request: Request to display a 320 square foot mural, measuring approximately 40 feet long by 8 feet tall, displaying saguaro cacti and cactus wren birds against a pink-colored background, located on the east wall of an existing single-story 1,341 square foot commercial building.

OWNER

William Kopcheck
602-540-3334

ARTIST

Lauren Lee Fine Art

APPLICANT CONTACT

Alexandra Wienberg
Arizona Party Bike
602-529-1463

BACKGROUND

Zoning

The site is zoned Highway Commercial, Downtown Overlay (C-3 DO).

Context

The property is located in Old Town Scottsdale, on the north side of E. Osborn Road, midway between N. 70th Street and N. Bishop Lane, with surrounding developments featuring one-story and two-story commercial office buildings, a church, and a four-story apartment complex.

Adjacent Uses and Zoning

- North Existing one-story buildings with office and service uses, zoned Highway Commercial, Downtown Overlay (C-3 DO)
- South Existing place of worship (church), zoned Multiple-family Residential (R-5)
- East Existing one-story buildings with office and service uses zoned Highway Commercial, Downtown Overlay (C-3 DO)
- West Existing two-story building with office use, zoned Highway Commercial, Downtown Overlay (C-3 DO)

Key Items for Consideration

- Downtown Urban Design & Architectural Guidelines
- Zoning Ordinance Section 1.904 – Development Review Board Criteria

DEVELOPMENT PROPOSAL

Goal/Purpose of Request

The applicant is requesting approval of a 320 square foot painted mural, sized at 40 feet long by 8 feet tall, featuring multiple rows of saguaro cacti in varying heights with cactus wren birds, all against a pink-colored background, located on the eastern façade of an existing 1,341 square foot one-story commercial building in Old Town Scottsdale (Attachment #7). At the top right corner of the mural will be a small set of painted words in white cursive that reads “Welcome to Old Town Scottsdale!” No lighting is proposed to illuminate the mural.

Neighborhood Communication

City Staff mailed postcard notifications to property owners within 750 feet of the site. A public hearing notification sign is posted on the subject site. As part of the applicant’s neighborhood notification outreach requirement, the applicant mailed a letter outlining the mural proposal to property owners within 750 feet of the subject site. The applicant’s Project Notification and Public Participation Report is attached (Attachment #10 & Attachment #11). As of the date of this report, City Staff has received two (2) emails opposing the proposed mural (Attachment #12).

DEVELOPMENT REVIEW BOARD CRITERIA ANALYSIS

The subject site is a 1,341 square foot building constructed sometime in the late 1940’s, based on historical aerial photographs. The building does not have any historic designation since the building’s exterior has been modified on multiple occasions over the past several decades, including a recent remodel and repaint (Attachment #5). The subject site is within the Garden District of Old Town Scottsdale (Attachment #3). The proposed mural’s theme, size and design is to be guided by the Old Town Scottsdale Urban Design & Architectural Guidelines, and by the Development Review Board Criteria in accordance with Zoning Ordinance Section 1.904.

The City does not have a mural-specific guideline or policy to regulate the size, location and construction of proposed murals. Previous Development Review Board mural applications has generated a public discussion on whether the City should implement a mural-specific policy in-addition to complying with applicable design guidelines and the Zoning Ordinance. For now, the design, size and application of murals will continue to abide by the underlying design guideline and Development Review Board Criteria of Zoning Ordinance Section 1.904.

Old Town Scottsdale Urban Design & Architectural Guidelines (UDAG)

Incorporation into the Built Environment

Guideline #7: The site plan, building arrangement, and orientation of uses should coordinate with neighboring properties.

- Plan for temporary and permanent public art in site and streetscape design.

Staff Analysis:

The proposed mural is a permanent private art piece that is incorporated into the design of the existing one-story building, adding to the overall streetscape design and enhancing the pedestrian experience. The mural is accessible from a private driveway that traverses the site, creating an informal exhibition space for pedestrians to access and view a piece of art drawn by a local artist.

Site & Surrounding Context

Guideline #11: Utilize signage that supports Old Town character and function.

- Signage should provide clear, concise and useful information, without becoming a focal point of the aesthetic environment.

Staff Analysis:

The proposed mural has a set of white cursive letters on the top right corner of the display stating, "Welcome to Old Town Scottsdale!" The height of the letters is approximately eight (8) to ten (10) inches tall. Because the sign is tucked away at the far side of the mural, it will not be easily seen from E. Osborn Road. The use of small signage therefore complies with the Old Town Scottsdale Urban Design and Architectural Guideline because it is not a focal point of the mural due to its limited size and positioning.

Building Design – Materials

Guideline #18: Use context-appropriate materials, colors and textures in Old Town development.

- Materials should be of high-quality, durable, easily maintained, and able to withstand the climatic conditions of the desert southwest. Materials should help tie buildings into the composition of the neighborhood. Use of local materials helps to further define sense of place.

Staff Analysis:

The proposed mural will cover the entire eastern façade of the one-story building, which will be visible from westbound travelers along E. Osborn Road. The proposed mural will utilize several colors using professional grade acrylic paint from paint manufacturer Nova Paints (Attachment #8) to portray a Sonoran Desert and southwestern theme:

- Green and Teal for the saguaro cacti ('Striking' P480-7 and 'Rushing Stream' P480-4)
- Orange and Yellow for the cacti thorns ('Tart Orange' HDC-MD-27 and 'Little Sun Dress' P280-5)
- Browns and Greys for the cactus wren birds ('Creamy Mushroom' PPU5-13 and 'Espresso Beans' PPU5-01)
- Pink for the background ('Pink Wink' M120-3)

The use of the vivid colors diverges with the architecture and design of other buildings within the neighborhood, since most buildings in the vicinity utilize pastel and warm neutral colors, with vivid colors only used on building accents. However, the mural complements the artistic history of the Garden District. In the 1950's and 1960's, art had a significant contribution to buildings in the Garden District, especially on the mid-century apartment buildings northwest of the subject site in the area centered on E. 2nd Street and N. 69th Street. In that area, metal caricatures and etchings such as feathers and buffalos were incorporated into the design of the mid-century apartment buildings.

The Development Review Board shall determine whether the mural's Sonoran Desert and southwestern theme along with the use of vivid colors is appropriate within the context and artistic history of the Garden District. In addition, the Development Review Board shall determine whether the size and location of the proposed mural on the building façade is context appropriate.

Zoning Ordinance Section 1.904 – Development Review Board Criteria

Criteria #2: The architectural character, landscaping and site design of the proposed development shall recognize the unique climatic and other environmental factors of this region to respond to the Sonoran Desert environment, as specified in the Sensitive Design Principles.

Sensitive Design Principle #9

The design of the built environment should respond to the desert environment:

- Materials with colors and coarse textures associated with the Sonoran Desert should be utilized.
- A variety of textures and natural materials should be used to provide visual interest and richness, particularly at the pedestrian level. Materials should be used honestly and reflect their inherent qualities.

Staff Analysis:

The proposed mural utilizes multiple vivid colors to portray a Sonoran Desert and southwestern theme of saguaro cacti, cactus wrens, and the Arizona sunset; using colors such as green, teal, orange, yellow, brown, grey, and pink. The colors are more vivid than the actual real-world appearance of a saguaro and cactus wren, and do not reflect a muted earth tone that Sensitive Design Principle #9 requires. However, the use of pink as the background color represent an Arizona sunset and is commonly associated with the Sonoran Desert. It is the purview of the Development Review Board to consider the use of the colors and decide whether the colors are appropriate within the context of Sensitive Design Principle #9.

Criteria #5: Within the Downtown Area, building and site design shall demonstrate conformance with the Old Town Scottsdale Urban Design & Architectural Guidelines, and incorporate urban and architectural design that address human scale and incorporate pedestrian-oriented environment at the street level.

Staff Analysis:

The proposed mural partially conforms to the Old Town Scottsdale Urban Design and Architectural Guidelines. It conforms to the guidelines by proposing a Sonoran Desert and southwestern theme portraying saguaro cacti, cactus wrens, and an Arizona sunset. It does not conform to the color guidelines since the proposed mural is using vivid and saturated colors versus the recommended use of pastel colors and warm neutrals for the design and appearance of buildings.

The proposed mural adds to the artistic history of the Garden District and is a piece of art will be visible to pedestrians and vehicular traffic traveling westbound on E. Osborn Road. Its location along the eastern elevation of the existing one-story building will attract pedestrians to view the artwork, thus achieving a human-scale quality and enhancing the pedestrian environment at the street level.

STAFF RECOMMENDATION

Recommended Approach:

Staff recommends that the Development Review Board approve the 7034 E. Osborn Road Mural, per attached stipulations, finding that the provisions of the Old Town Scottsdale Urban Design & Architectural Guidelines and the Development Review Criteria have been met.

RESPONSIBLE DEPARTMENT

Planning and Development Services

Current Planning Services

STAFF CONTACT

Andrew Chi

Planner

Phone: 480-312-7828

E-mail: achi@ScottsdaleAZ.gov

APPROVED BY



Andrew Chi, Planner, Report Author

1/31/2020

Date



Tim Curtis, AICP, Current Planning Director

Phone: 480-312-4210 E-mail: tcurtis@scottsdaleaz.gov

2/4/2020

Date



Randy Grant, Director
Planning and Development Services

Phone: 480-312-2664 E-mail: rgrant@scottsdaleaz.gov

2/10/20

Date

ATTACHMENTS

- A. Stipulations/Zoning Ordinance Requirements
 - 1. Context Aerial
 - 1A. Close-Up Aerial
 - 2. Zoning Map
 - 3. Old Town Scottsdale Districts Map
 - 4. Aerial Photo
 - 5. Existing Conditions
 - 6. Applicant's Narrative
 - 7. Mural Rendering
 - 8. Paint Color Samples
 - 9. Artist Information
 - 10. Public Participation Report
 - 11. Notification Mailing List
 - 12. Citizen Comments

**Stipulations for the
Development Review Board Application:
7034 E. Osborn Road Mural
Case Number: 1-DR-2020**

These stipulations are intended to protect the public health, safety, welfare, and the City of Scottsdale.

APPLICABLE DOCUMENTS AND PLANS:

Except as required by the Scottsdale Revised Code (SRC), the Design Standards and Policies Manual (DSPM), and the other stipulations herein, the site design and construction shall substantially conform to the following documents:

1. Architectural elements, including dimensions, materials, form, color, and texture shall be constructed to be consistent with the building elevations submitted by Alexandra Wienberg, with a City Staff date of January 31, 2020.

EXTRIOR LIGHTING:

DRB Stipulations

2. No lighting is approved with this mural.

ADDITIONAL ITEMS:

DRB Stipulations

3. The owner or designee shall maintain the mural in good condition, and shall fix or repaint any damage, fading or peeling to the mural.



Q.S.
16-44

Google Earth Pro Imagery

Context Aerial

1-DR-2020



Q.S.
16-44

Google Earth Pro Imagery

E. Osborn Rd.



1-DR-2020

Close-up Aerial

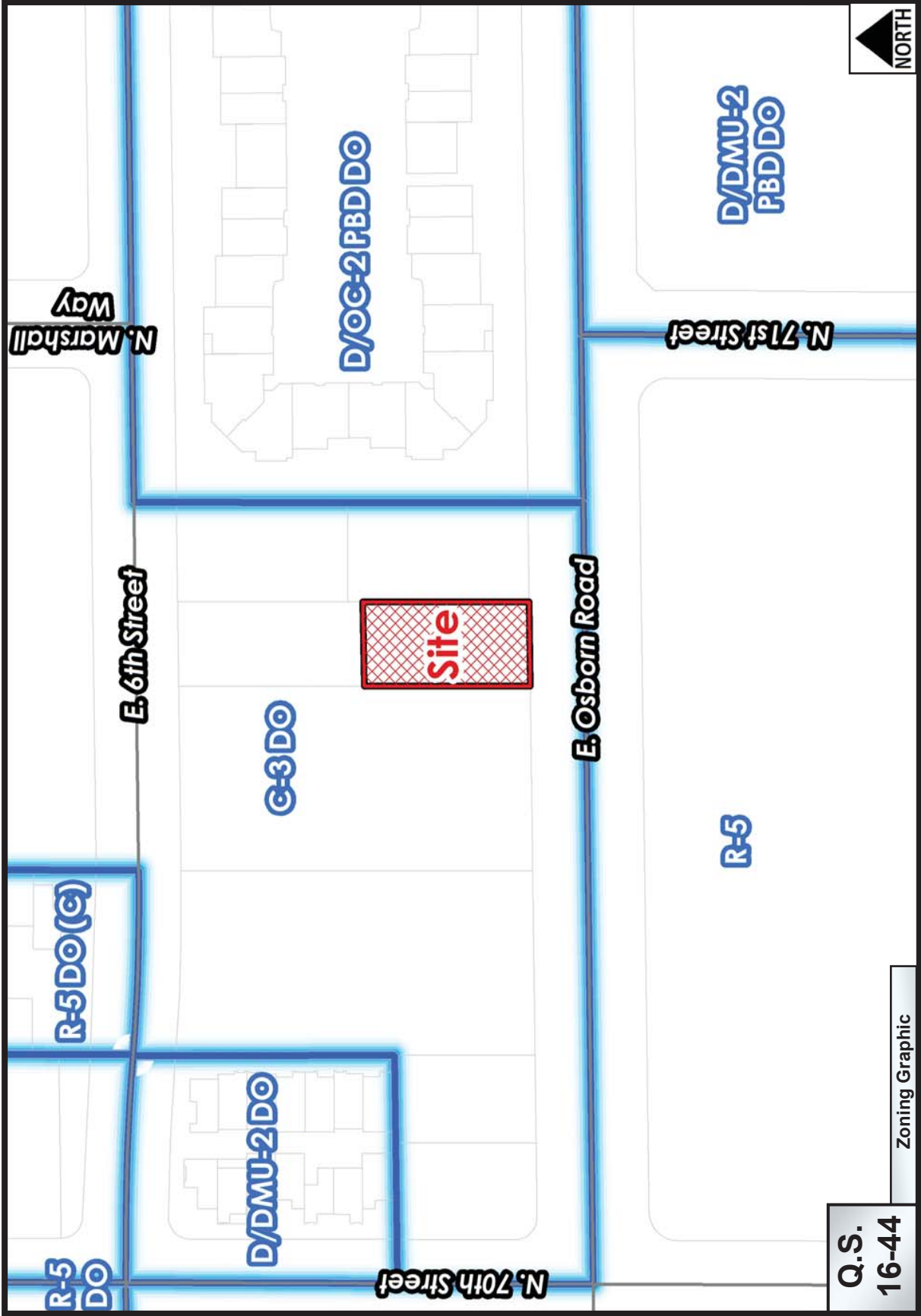

Q.S.
16-44

Zoning Graphic

Existing Zoning

1-DR-2020

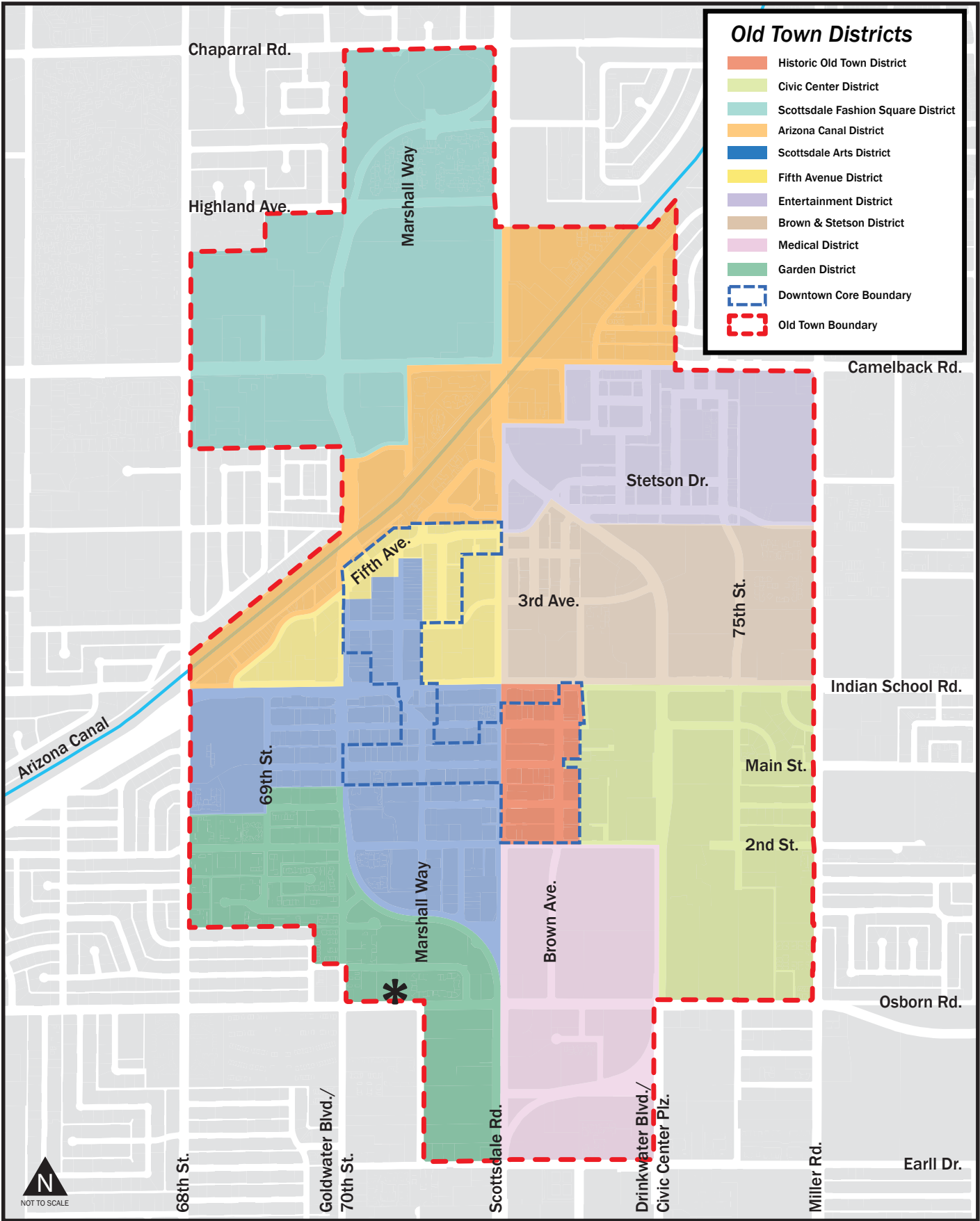

Notice: This document is provided for general information purposes only. The City of Scottsdale does not warrant its accuracy, completeness, or suitability for any particular purpose. It should not be relied upon without field verification. Map not to scale.

Map 2 - Old Town Districts

*** = SUBJECT SITE**

Aerial & Site Photo Locations



Site Photo 1: Facing Northwest from Osborn Road



Site Photo 2: Facing Northwest from Property Entrance



Site Photo 3: Facing West from Driveway



Application Narrative

December 31, 2019

Property Owner

Case Number: 1-DR-2020

Pre-Application Number: 903-PA-2019

Address: 7034 E Osborn Rd Scottsdale, AZ 85251

Project Narrative:

I am writing to you today to discuss our proposed mural on the East facing wall of 7034 E Osborn Rd Scottsdale, AZ 85251. The mural is titled "7034 E Osborn Mural" and will be approximately 40 ft long and 8 ft tall, which equates to about 320 sq ft. This beautiful desert depiction will be painted by Lauren Lee who is an incredible and renowned artist. She has many pieces of work in Scottsdale, and all over Arizona!

Our mural will blend in seamlessly with the architectural characteristics of our building, surrounding areas, the landscape of Arizona, and our overall site design. Lauren has designed this art piece to fit the modern theme of many of the area buildings. Her art will depict a beautiful Sonoran Desert theme representative of the saguaro cacti and cactus wren. Painted in pastel colors with a light pink background, it will inspire the thought of Arizona's incredible sunrises and sunsets. The images will be strategically oversized to ensure the scene is not too busy, pleasant to look at, and depict the details of iconic Arizona cacti.

We look forward to the opportunity to create an eye-catching work of art in Old Town Scottsdale that shows off the beauty of our unique desert plants and birds.

Proposed Mural



East Elevation

Color Cards or Paint Color Drawdowns

Nova Paints, which are professional grade high UV acrylic paints will be used.

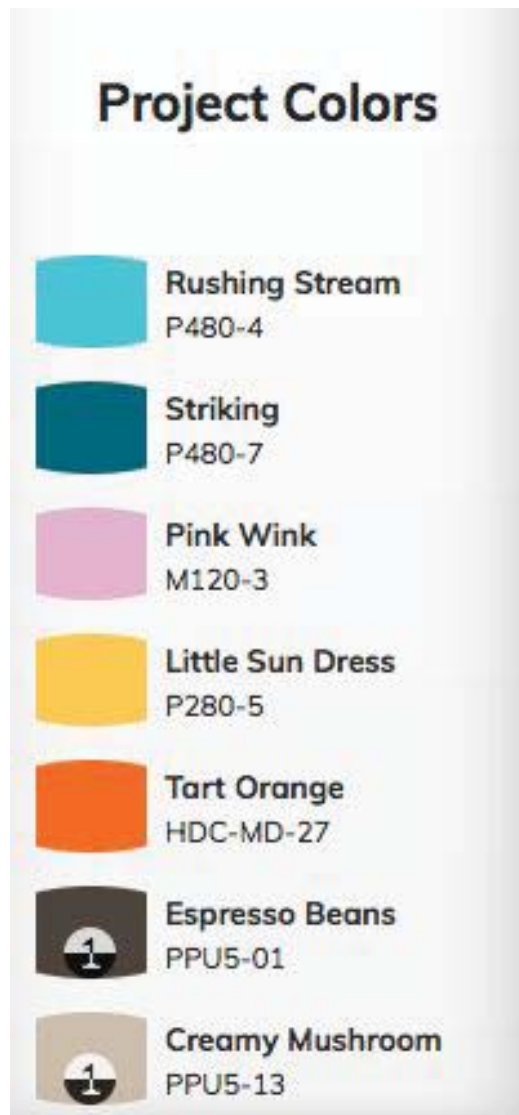



LAUREN LEE

PUBLIC ARTIST

CONTACT INFO: 480.384.0321
 LAURENLEE222@GMAIL.COM
 LAURENLEEFINEART.COM

EDUCATION: ARIZONA STATE UNIVERSITY, GRADUATED WITH A BACHELORS OF ARTS, 2007
HONORS: NATIONAL HONOR SOCIETY, NATIONAL COLLEGIATE SOCIETY, DEANS LIST 2001-2005, 2007

PUBLIC ART

- DOWNTOWN PHOENIX INC, CITY OF PHOENIX: FIVE C'S INTERIOR MURAL, 2018
- EXPERIENCE SCOTTSDALE, CITY OF SCOTTSDALE: "ITS THAT HOT" SUMMER MURAL CAMPAIGN 2018
- CLEAN ELECTIONS COMMISSION: 18IN2018 ANIMATED MURAL, 2018
- GREATER PHOENIX ECONOMIC COUNCIL, INTERIOR MURAL 2017
- SCOTTSDALE PUBLIC ART: SOHO LIVE WORK TOWNHOMES, 153X24' HANDPAINTED MURAL 2017
- PHOENIX PUBLIC ART, KROGER-FRYS MURAL, 2016
- TEMPE PUBLIC ART: "DON'T WAKE THE DREAMER" MURAL, 150 X 16' HANDPAINTED MURAL 2015
- VALLEY METRO: ROTATING ARTIST MURAL AT ROOSEVELT/CENTRAL LIGHTRAIL STOP 2017
- THREE BIRDS IN FLIGHT MURAL, DOWNTOWN PHOENIX 2015
- CITY OF MESA: DOWNTOWN MESA MURAL, 24'X24' 2015
- CITY OF CHANDLER: "FLOW" MURAL, INFLUX GRANT 2013
- CITY OF MESA: MESA PUBLIC LIBRARY, CHILDRENS SECTION MURALS 2013

SOLO GALLERY EXHIBITIONS

- WAHEGURU, MEGAPHONE GALLERY, PHOENIX AZ, 2018
- FIRESKY, {9} THE GALLERY, PHOENIX AZ, 2016
- SISTERS OF THE MOON, {9} THE GALLERY, PHOENIX AZ, 2015
- OIL AND INK, GREENHAUS ART GALLERY, PHOENIX AZ, 2014
- DREAMS, {9} THE GALLERY, PHOENIX AZ, 2014
- FAWN, GREENHAUS ART GALLERY, PHOENIX AZ, 2013
- DIVINITY, GREENHAUS ART GALLERY, PHOENIX AZ, 2012
- ANIMISM, FAIR TRADE GALLERY, PHOENIX AZ, 2012
- WE CAN ALL BE FREE, FAIR TRADE GALLERY, PHOENIX AZ 2011

LOCATIONS OF MURALS COMPLETED FOR BUSINESSES:

REPUBLICA EMPANADA, FAIR TRADE CAFE, FLOATING LOTUS STUDIOS, OASIS ON GRAND, 909APT
 BETHANY TERRACE APTS, SPRING APTS, STREET COFFEE, MESA URBAN GARDEN, ORGANIC LIVING

Artist: Lauren Lee

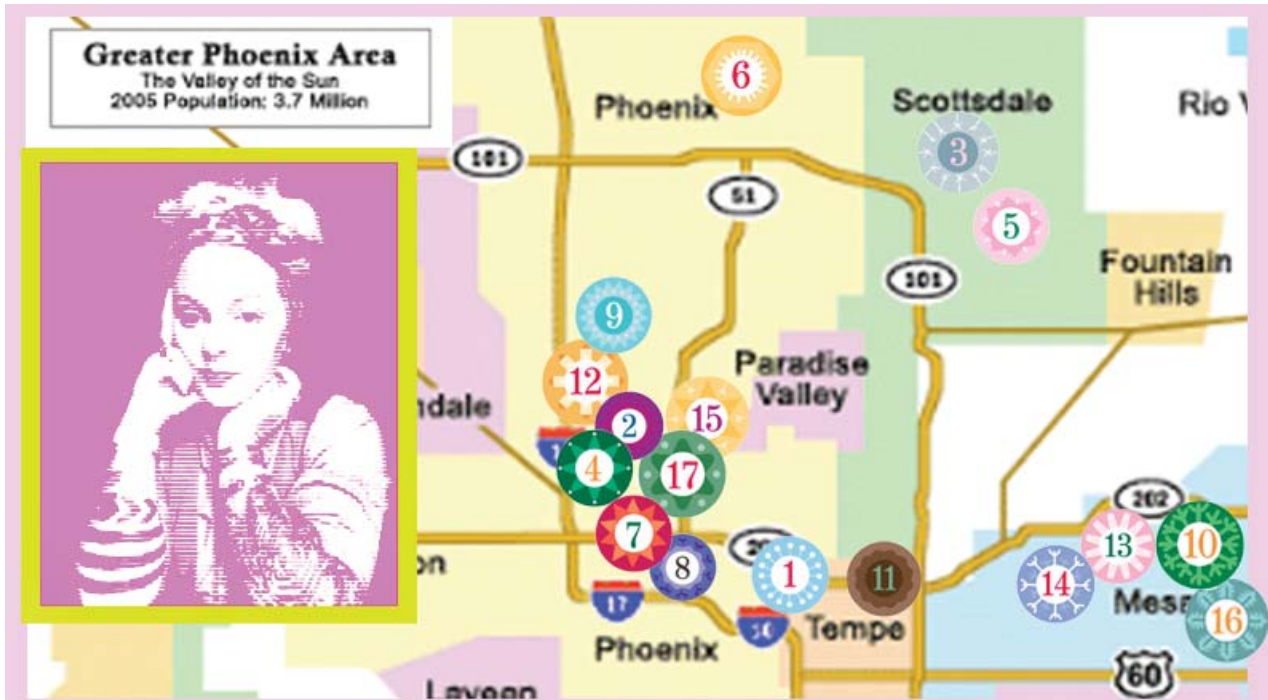

MURAL ADDRESSES: IN ORDER OF MOST RECENT

1. TEMPE: VALLEY FAIR SHOPPING COMPLEX, EXTERIOR, 63 E. Southern Ave (Southern and Mill Ave)
2. PHOENIX: FIVE C'S MURAL, INTERIOR, DOWNTOWN PHOENIX INC 1 E Washington St #230, Phoenix, AZ 85004
3. SCOTTSDALE: GEISHA A GO GO , EXTERIOR, 7150 E 6th Ave, Scottsdale, AZ 85251
4. PHOENIX: TAKE FLIGHT INTERACTIVE MURAL, EXTERIOR, 214 E Roosevelt St, Phoenix, AZ 85004
5. SCOTTSDALE: SOHO SCOTTSDALE, EXTERIOR, 16510 N 92nd St, Scottsdale, AZ 85260
6. PHOENIX: SPRING APARTMENTS, EXTERIOR, 2015 W Cactus Rd, Phoenix, AZ 85029
7. PHOENIX: THREE BIRDS IN FLIGHT, EXTERIOR, 290 E Roosevelt St, Phoenix, AZ 85004
8. PHOENIX: STREET COFFEE, EXTERIOR, 625 N 7th St, Phoenix, AZ 85006
9. PHOENIX: ORGANIC LIVING, EXTERIOR, 8342 N 7th St, Phoenix, AZ 85020
10. MESA: DOWNTOWN MESA, EXTERIOR, 63 W Main St, Mesa, AZ 85201
11. TEMPE: DON'T WAKE THE DREAMER, EXTERIOR, 5th St and Hardy, Tempe AZ
12. PHOENIX: OASIS ON GRAND, EXTERIOR, 1501 Grand Ave, Phoenix, AZ 85007
13. MESA: FLOATING LOTUS, INTERIOR, 202 W Main St, Mesa, AZ 85201
14. MESA: MESA PUBLIC LIBRARY, INTERIOR, CHILDRENS SECTION 64 E 1st St, Mesa, AZ 85201
15. PHOENIX: BETHANY TERRACE APARTMENTS, EXTERIOR, 525 E Bethany Home Rd, Phoenix, AZ 85012
16. MESA: REPUBLICA EMPANADA, INTERIOR, 204 E 1st Ave, Mesa, AZ 85210 (AND GREAT FOOD!)
17. PHOENIX: FAIR TRADE, INTERIOR, 1020 N 1st Ave, Phoenix, AZ 85003



Other Works By Lauren Lee



Public Participation Report

Below is a copy of the letter sent out to all properties within 750' of our property at 7034 E Osborn Rd. Every property was sent a letter on December 31, 2019. I have attached the list of addresses and a receipt of our 1st class mailing method used to send out the letters. We have not been contacted by anyone regarding the mural project.

December 31, 2019

Property Owner

Pre-Application Number: 903-PA-2019

Address: 7034 E Osborn Rd Scottsdale, AZ 85251

To Whom It May Concern:

I am writing to you today to discuss our proposed mural on the East facing wall of 7034 E Osborn Rd Scottsdale, AZ 85251. The mural is titled "7034 E Osborn Mural" and will be approximately 40 ft long and 8 ft tall, which equates to about 320 sq ft. This beautiful desert depiction will be painted by Lauren Lee who is an incredible and renowned artist. She has many pieces of work in Scottsdale, and all over Arizona!

Our mural will blend in seamlessly with the architectural characteristics of our building, surrounding areas, the landscape of Arizona, and our overall site design. Lauren has designed this art piece to fit the modern theme of many of the area buildings. Her art will depict a beautiful Sonoran Desert theme representative of the saguaro cacti and cactus wren. Painted in pastel colors with a light pink background, it will inspire the thought of Arizona's incredible sunrises and sunsets. The images will be strategically oversized to ensure the scene is not too busy, pleasant to look at, and depict the details of iconic Arizona cacti.

We look forward to the opportunity to create an eye-catching work of art in Old Town Scottsdale that shows off the beauty of our unique desert plants and birds.

Robert Mayer

robert@arizonapartybike.com

844-654-5544

City contact is Andrew Chi

achi@scottsdaleaz.gov

480-312-7828



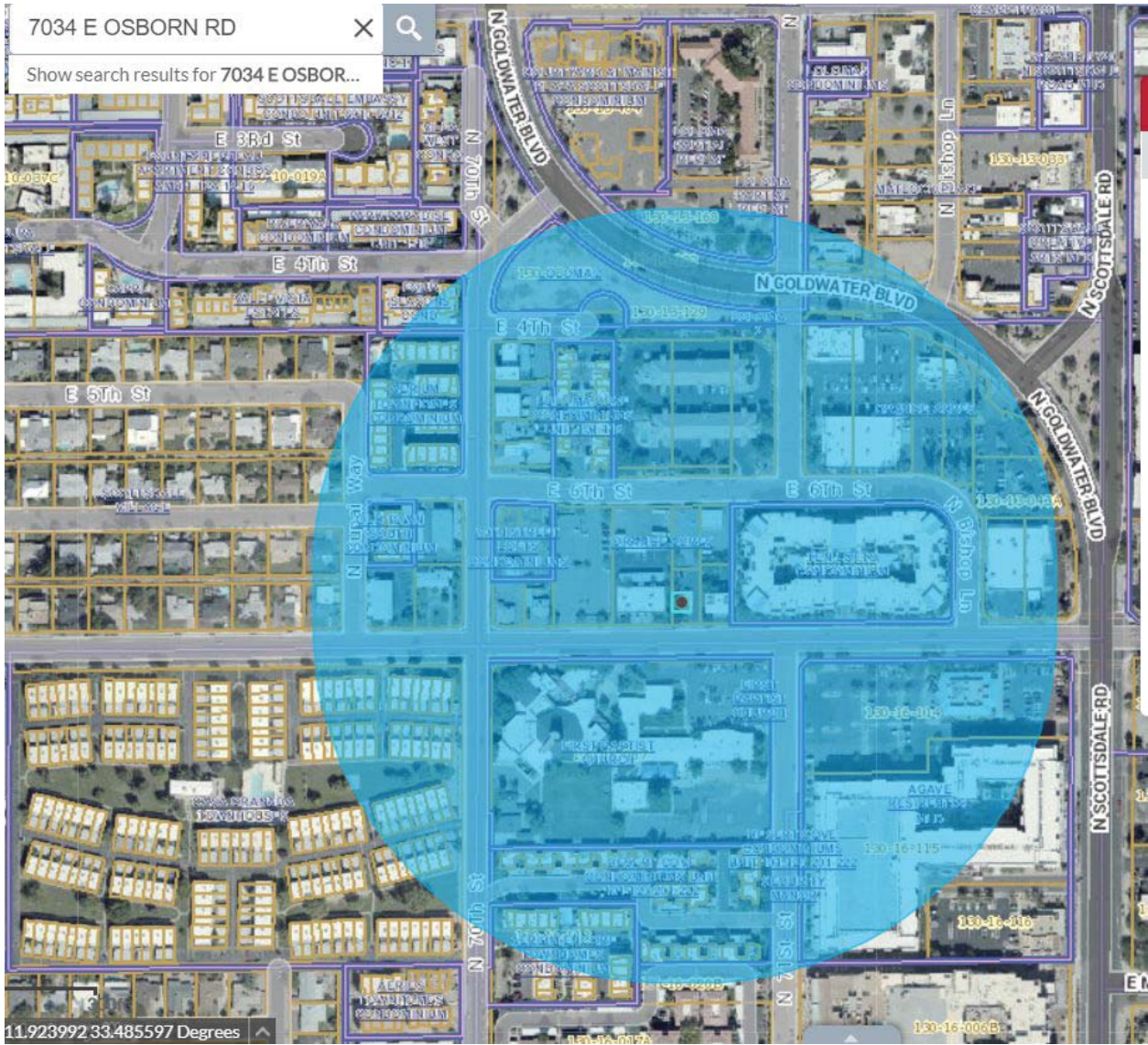

Project Notification Mailing List

Owner

1005 SCOTTSDALE EAST 6TH 17 LLC/ETAL
2008 CONDO PROPERTIES LLC
4TH ST 4TH PO LLC
6925 OSBORN LLC
6941 E 4TH ST UNIT 3 LLC
6941 REAL ESTATE ENTERPRISES LLC/SCHLEMMER R
ACPTS PHX LLC
AERIUM ENCORE LLC
AERIUM LLC
ALBERS DANIEL J
ALCAZAREN PATRICK
ALFAREEDOZ LLC
ALLISON JARED
ANGUS PLAZA LLC
ATTIANESE RYAN/BETH
AZ KERN PROPERTIES LLC
BAHMAN TRUST
BAILEY STEVEN J
BAJPAI AKSHAY
BENNETT CHARLA DILL
BERGMAN JANICE C/GAYTON FORDYCE
BLACK NANCY J
BLACKLEDGE PAMELA L
BLAU ELLIOT
BOSEL MAX/ADRIENNE
BRE/HV PROPERTIES LLC
BRIAN V THINNES TRUS
BUCHLI KEITH R
BURNS BRADLEY
BUTTRUM LAVONA/PREPEJCHAL GARY/BEVERLY J
CAREY FAMILY LIVING TRUST
CASA GRANADA TOWNHOUSES CORP
CHAMBERLIN GERALD A/KARLA M

Mailing Address

5690 DTC BLVD SUITE 515 GREENWOOD VILLAGE CO 80111
40 CYPRESS CREEK PARKWAY UNIT 132 HOUSTON TX 77090
3523 N 70TH ST SCOTTSDALE AZ 85251
4808 E CALLE TUBERIA PHOENIX AZ 85018
7122 N VIA NUEVA SCOTTSDALE AZ 85258
7425 E GAINNEY RANCH RD UNIT 15 SCOTTSDALE AZ 85258
20403 W CRESCENT DR BUCKEYE AZ 85396
301 1103-95 ST SW EDMONTON AB CANADA T6X0P8
8901 E PIMA CENTER PARKWAY SUITE 100 SCOTTSDALE AZ 85258
12637 OHERN ST OMAHA NE 68137
3309 N 70TH ST UNIT 114 SCOTTSDALE AZ 85251
3425 N 70TH ST SCOTTSDALE AZ 85251
3233 N 70TH ST UNIT 1007 SCOTTSDALE AZ 85251
3238 N SCOTTSDALE RD SCOTTSDALE AZ 85251
6953 E OSBORN RD UNIT D SCOTTSDALE AZ 85251
PO BOX 391360 MOUNTAIN VEIN CA 94039
4008 N 65TH PL SCOTTSDALE AZ 85251
3307 N 70TH ST #208 SCOTTSDALE AZ 85251
6990 E 6TH ST UNIT 1013 SCOTTSDALE AZ 85251
7023 E 4TH ST 103 SCOTTSDALE AZ 85251
2693 HEADWATER DR FT COLLINS CO 80521
6925 E OSBORN RD NO B SCOTTSDALE AZ 85251
3210 N 81ST ST SCOTTSDALE AZ 85251
7002 E OSBORN SCOTTSDALE AZ 85251
PO BOX 391360 MOUNTAIN VIEW CA 94039
P O BOX 49550 CHARLOTTE NC 28277
6990 E 6TH ST UNIT 1021 SCOTTSDALE AZ 85251
3309 N 70TH ST UNIT 107 SCOTTSDALE AZ 85251
6990 E 6TH ST UNIT 1023 SCOTTSDALE AZ 85251
3313 SW WASHINGTON ST PEORIA IL 61602
4203 E DUBOIS AVE GILBERT AZ 85298
4645 E COTTON GIN LOOP PHOENIX AZ 85285
3233 N 70TH ST UNIT 1024 SCOTTSDALE AZ 85251

CHRIS N MILLER LIVING TRUST	1948 S ADOBE POINT YUMA AZ 85365
CHURCHPLACE INC	3625 N MARSHALL WAY SCOTTSDALE AZ 85251
COHEN DAVID C	6990 E 6TH ST UNIT 1005 SCOTTSDALE AZ 85251
COHEN JUSTIN A	6937 E OSBORN RD UNIT C SCOTTSDALE AZ 85251
COLONIAL REALTY LIMITED PARTNERSHIP	6815 POPLAR AVENUE SUITE 500 GERMANTOWN TN 38138
CONNELL WINE LOFTS	200 CONNELL DR BERKELEY HEIGHTS NJ 07922
COTTINGHAM JASON	3309 N 70TH ST UNIT 112 UNIT 122 SCOTTSDALE AZ 85251
CUSTER CRAIG	5023 S CONVENT LN APT I PHILADELPHIA PA 19114
DANIEL WARREN H/VENNE NANCY	3233 N 70TH ST UNIT 1022 SCOTTSDALE AZ 85251
DEMERIS THEODORE J/PAMELA S	3233 N 70TH ST UNIT 1008 SCOTTSDALE AZ 85251
DESERT IRONWOOD LLC	5217 E WHITTON AVE PHOENIX AZ 85018
DOERING ERIC/EVE	5362 BOLSA AVE NO B HUNTINGTON BEACH CA 92649
DONNELLY KENNEDY	3309 N 70TH ST UNIT 218 SCOTTSDALE AZ 85251
DOS PERROS INVESTMENTS LLC	1707 E WEBER DR NO 10 TEMPE AZ 85281
DUECK AMYLOU C	6945 E OSBORN RD UNIT C SCOTTSDALE AZ 85251
ECKSTEIN CAMERON J	330 J ST UNIT 511 SAN DIEGO CA 92101
EGELAND RUBY MORA-	3307 N 70TH ST #216 SCOTTSDALE AZ 85251
ERIC SHANE AND WENDY ALLISON HASSETT TRUST	21575 CABROSA MISSION VIEJO CA 92691
ES ROYALE LLC	UNIT 3190 BOX 143 DPO AA 34024
EXPRESS COMPANIES XIII LLC	3100 S RURAL RD 1 TEMPE AZ 85282
FIRST BAPTIST CHURCH OF SCOTTSDALE	7025 E OSBORN RD SCOTTSDALE AZ 85251
FIRST BAPTIST CHURCH OF SCOTTSDALE	7025 E OSBORN RD SCOTTSDALE AZ 85251
FISHER ROBERT P/GINGER L/THEODORE G	PO BOX 2950 SCOTTSDALE AZ 85252
FRANE THOMAS J/CAROL L	7904 DELCON DR FORT WAYNE IN 46809
FULLER ROBERTA A	5630 SW RIVERSIDE LN UNIT 5 PORTLAND OR 97239
FUNKE BENJAMIN M	810 W HOWE ST TEMPE AZ 85281
GANAJIAN ARMAND CHARLES	20811 N 62ND DR GLENDALE AZ 85308
GILL-BACHAND FAMILY LIVING TRUST	13796 N 93RD PL SCOTTSDALE AZ 85260
GO DIVING PROPERTIES LLC	218 W VINEDO LN TEMPE AZ 85284
GOLDEN SAPPHIRE LLC	4916 N 73RD ST APT 5 SCOTTSDALE AZ 85251
GRAHAM JACQUE LYNNETTE/FITZMAURICE LARRY	22 FOOTHILL ASH LITTLETON CO 80127-3541
HAMMOND THOMAS G TR	1835 MIDLAND RD SAGINAW MI 48603
HANSON JAMES/TRACY	313 NORTH MAIN STREET VIROQUA WI 54665
HAVRANEK MATTHEW	6953 E OSBORN RD UNIT F SCOTTSDALE AZ 85251

HEINRICH GRANT R/MELISSA S	3233 N 70TH ST UNIT 1012 SCOTTSDALE AZ 85251
HELIOTI CATHERINE	922 W RIDGE RD ROCHESTER NY 14615
HERENDEEN ANGELINE	3309 NORTH 70TH STREET UNIT 110 SCOTTSDALE AZ 85251
HIGH MATTHEW	6990 E 6TH ST UNIT 1022 SCOTTSDALE AZ 85251
HOLVECK THELMA L TR	6944 E OSBORN RD SCOTTSDALE AZ 85251
HOOD BRETT R/ANN M/SEWELL CHRISTINA M	8608 ASHWORTH RD SE CALGARY AB CANADA T2H1R2
HOUSTON STEVEN H/LESLIE K TR	266 ZENITH ST CHULA VISTA CA 91942-5848
JACOB P WESTERHOF REVOCABLE TRUST	6208 INDIAN MOUND DE MCFARLAND WI 53558
JEFFREY R LIPSON AND MAUREEN D LIPSON REVOCAB	8303 N EL MARO CIR PARADISE VALLEY AZ 85253
JEHLING MATTHEW	6990 E 6TH ST UNIT 1010 SCOTTSDALE AZ 85251
JOHNSON BRIAN WAYNE	7024 E 6TH ST UNIT 204 SCOTTSDALE AZ 85251
JUDITH BRUZZA REVOCABLE TRUST	3233 N 70TH ST UNIT 1023 SCOTTSDALE AZ 85251
KEHM KELLY NICOLE/KATHERINE	6925 E OSBORN RD G SCOTTSDALE AZ 85251
KERNS LINDSAY	6945 E OSBORN RD UNIT A SCOTTSDALE AZ 85251
KLOBASSA CHARLES E II/GREENLAND PAULETTE D	6925 E OSBORN RD #C SCOTTSDALE AZ 85251
KONDO NATHAN A/CATHERINE C	6990 E 6TH ST UNIT 1025 SCOTTSDALE AZ 85251
LAFOREST FAMILY LIVING TRUST	6990 E 6TH ST UNIT 1026 SCOTTSDALE AZ 85251
LAKE DONALD R/JUDITH N	18 MEREDITH DR SANTA FE NM 87506
LAKE SCOTTSDALE PROPERTIES LLC	104 WILMOT RD MS NO 1435 DEERFIELD IL 60015
LANE SUSAN	205 S SENATE ST CHANDLER AZ 85225
LANGA PROPERTIES V LLC	6019 N 80TH PL SCOTTSDALE AZ 85250
LANGE JEFFREY A	6933 E OSBORNE RD #C SCOTTSDALE AZ 85251
LINDQUIST DERON S	25671 LE PARC UNIT 13 LAKE FOREST CA 92630
LOIS FAGAN FAMILY TRUST	6953 E OSBORN RD UNIT E SCOTTSDALE AZ 85251
LOW STEPHANIE DANICA	7024 E 6TH ST UNIT 205 SCOTTSDALE AZ 85251
LUCHT AUSTIN R	6990 E 6TH ST UNIT 1006 SCOTTSDALE AZ 85251-5548
LUNA BEAR LLC	20403 W CRESCENT DR BUCKEYE AZ 85396
MADISON MARIE ROSE SEPARATE PROPERTY TRUST	3233 N 70TH ST UNIT 1005 SCOTTSDALE AZ 85251
MAGUIRE ALLAN/MAYO S	6004 E PHELPS RD SCOTTSDALE AZ 85254
MALLETT ANDREW ALAN/MATTETT DONNAMAE TUASON	829 FAIRCHILD CT FOLSOM CA 95630
MALLORY BRENDA D/CURTIS W	6937 E OSBORN RD SCOTTSDALE AZ 85251
MCCARTHY PAUL R/JAIME L	178 LOCHSA CT LEWISTON ID 83501
MDM818 HOLDINGS LLC	11068 E WHITE FEATHER LN SCOTTSDALE AZ 85262
MICHALOVE SAMUEL	3309 N 70TH ST UNIT 206 SCOTTSDALE AZ 85251

MNAZ INVESTMENT PROPERTIES LLC	11811 N TATUM BLVD SUITE 1060 PHOENIX AZ 85028
MONTI LIVING TRUST	947 W KAIBAB DR CHANDLER AZ 85248
MONTOYA FABIENE	6990 E 6TH ST UNIT 1003 SCOTTSDALE AZ 85258
MOSES DAYLE A	1125 N YORK CIR MESA AZ 85203
MUNE CHELSEA JEAN	3309 N 70TH ST UNIT 212 SCOTTSDALE AZ 85251
MWM VICSDALE FOREVER LLC	7349 N VIA PASEO DEL SUR SUITE 515-414 SCOTTSDALE AZ 85258
MWM VICSDALE MAGIC LLC	7349 N VIA PASEO DEL SUR STE 515 PMB 414 SCOTTSDALE AZ 85258
N AND D RESTAURANTS INC	PO BOX 695019 ORLANDO FL 32869-9901
NALEPA BRYCE DAVID	3309 N 70TH ST UNIT 100 SCOTTSDALE AZ 85251
NANGLE CONOR	6990 E 6TH ST UNIT 1009 SCOTTSDALE AZ 85251-5548
NESLUND NICHOLAS/GERALD	6937 E OSBORN RD UNIT F SCOTTSDALE AZ 85251
NIKKHAH MEHDI	6929 E OSBORN RD UNIT F SCOTTSDALE AZ 85251
NORTHSHORE ASSOCIATES LLC	3333 E BAYAUD AVE NO 409 DENVER CO 80209
OBRIEN TAMMIE J/PATRICK J	21037 E NICHOLS PKWY AURORA CO 80016
ONTIVEROS JORDAN/JOHN/STACY	6990 E 6TH ST UNIT 1007 SCOTTSDALE AZ 85251
ONTIVEROS STEVEN/LUCINDA LEE	7023 E 4TH ST UNIT 105 SCOTTSDALE AZ 85251
ORZE JONATHAN J	3233 N 70TH ST UNIT 1006 SCOTTSDALE AZ 85251
OSBORN 6932 LLC	11259 E VIA LINDA STE 100 SCOTTSDALE AZ 85259
OSGOOD STEWART GEORGE	6929 E 6TH ST SCOTTSDALE AZ 85251
OT DOMINO ONE LLC	3523 N 70TH ST SCOTTSDALE AZ 85251
OT DOMINO THREE LLC	3523 N 70TH ST SCOTTSDALE AZ 85251
PALMER ALEXANDER	7024 E 6TH ST UNIT 102 SCOTTSDALE AZ 85251
PARNAMI MOHIT	3309 N 70TH ST NO 220 SCOTTSDALE AZ 85251
PATRICIA L WILCOX REVOCABLE LIVING TRUST	5613 WOODFOREST DR SACRAMENTO CA 95842
PAUL LEMAJEUR LIVING TRUST	7221 W EVERELL AVE CHICAGO IL 60631
PAYNE CLAIRE E	6945 E OSBORN RD SCOTTSDALE AZ 85251
PENINGER JAMES/MICHELLE	5939 E INCA ST MESA AZ 85205
PJE INVESTMENTS LLC	PO BOX 2055 EUGENE OR 97402
POLLIFRONE FAMILY TRUST	5301 E YUCCA ST SCOTTSDALE AZ 85254
POWERS HEIDI/RICHARD PATRICK	2416 EASTRIDGE LOOP CHULA VISTA CA 91915
PRESCOD ANGELICA	4110 N SCOTTSDALE RD SUITE 145 SCOTTSDALE AZ 85251
PRICE APRIL	7024 E 6TH ST UNIT 106 SCOTTSDALE AZ 85251
PRP PROBERTIES L L C	3307 N 70TH ST NO 211 SCOTTSDALE AZ 85251
RAMOS JUAN MARTINEZ	6937 E OSBORN RD B SCOTTSDALE AZ 85251

RAUFMANN FAMILY TRUST
RBSM PROPERTIES LLC
RCBH LLC
REDLINGER TROY
RENOVATE AZ LLC
RENOVATEAZ LLC
ROBERTS BARBARA
ROOM FOR INTERPRETATION LLC
ROYER DONALD E/DEBORAH L
S R BECKWITH TRUST
SACKS FAMILY TRUST
SANDNER HOLLY M
SCHAIRER DEREK
SCHENK BARRY E/JUDY A
SCHINDLER MATT
SCHMIESTER MARY L
SCHULTZ FAMILY TRUST
SCOTT CATHERINE/KENNETH
SCOTT CODUTE LIVING TRUST
SCOTTSDALE APTS JV LLC
SCOTTSDALE CITY OF
SENTNER RICHARD P/SUSAN
SHIPP LTD
SMITH BLAIR/GRACE
SMITH MICHELLE
SMITH SHELBY C
SNOWFLAKE INVESTMENTS LLC
SNOWFLAKE INVESTMENTS LLC
SREIT GRIFFIN SCOTTSDALE LLC
STALWICK HOWIE/JENNIFER
STEINBICKER SUSAN P
STOCKERT LAVONNE A
STORBECK FAMILY TRUST
SUPAI CLOUD LLC

6953 E OSBORN RD UNIT G SCOTTSDALE AZ 85251
16010 N 114TH WAY SCOTTSDALE AZ 85255
PO BOX 51 CAVE CREEK AZ 85327
3309 N 70TH ST NO 120 SCOTTSDALE AZ 85251
8110 E WILSHIRE DR SCOTTSDALE AZ 85257
8110 E WILSHIRE DR SCOTTSDALE AZ 85257
3309 N 70TH ST NO 113 SCOTTSDALE AZ 85251
7038 E OSBORN RD SCOTTSDALE AZ 85251
183 MONARCH BAY DANA POINT CA 92629
6929 E OSBORN RD UNIT B SCOTTSDALE AZ 85251
3233 N 70TH ST NO 1013 SCOTTSDALE AZ 85251
6941 E 4TH ST SCOTTSDALE AZ 85251
6945 E OSBORN RD UNIT E SCOTTSDALE AZ 85251
3248 CARRIAGE WY STOW OH 44224
3309 N 70TH ST UNIT 101 SCOTTSDALE AZ 85251
6929 E OSBORN RD UNIT D SCOTTSDALE AZ 85251
6121 E FOREST ST APACHE JUNCTION AZ 85119-9509
14-53049 RANGE RD UNIT 220 ARDROSSAN AB CANADA T8E2C8
3233 N 70TH ST UNIT 1004 SCOTTSDALE AZ 85251-6960
1 E WACKER DR STE 1600 CHICAGO IL 60601-1901
7447 E INDIAN SCHOOL RD STE 205 SCOTTSDALE AZ 85251
11549 BLUE HERON RD BOW WA 98232
PO BOX 356 SCOTTSDALE AZ 85252
6953 E OSBORN C SCOTTSDALE AZ 85251
6937 E OSBORN RD UNIT E SCOTTSDALE AZ 85251-6216
4209 N 33RD ST PHOENIX AZ 85018
PO BOX 12752 SCOTTSDALE AZ 85267
13325 N 83RD PL SCOTTSDALE AZ 85260
591 W PUTNAM AVE GREENWICH CT 06830
315 W RIVERSIDE STE 301 SPOKANE WA 99201
4421 E WILLOW AVE PHOENIX AZ 85032
3309 N 70TH ST NO 123 SCOTTSDALE AZ 85251
15536 58TH RD UNION GROVE WI 53182
18225 E CLOUD RD GILBERT AZ 85298

SUPPES BRINLEY	6945 E OSBORN RD UNIT D SCOTTSDALE AZ 85251
SWENSON LEANNE RAE	6990 E 6TH ST UNIT 1016 SCOTTSDALE AZ 85251
THOMAS F & DEBORAH L SOUTHGATE TRUST	6990 E 6TH ST UNIT 1012 SCOTTSDALE AZ 85251
THOMAS M AND ELIZABETH E PALMER FAMILY TRUST	7023 E 4TH ST NO 101 SCOTTSDALE AZ 85251
TONG ROBERT/STELLA S	6990 E 6TH ST UNIT 1008 SCOTTSDALE AZ 85251
TOPPS ANDREW L	3309 N 70TH ST UNIT 115 SCOTTSDALE AZ 85251
TRAVIS PALUCK TRUST	8779 E QUARTERHORSE TRL SCOTTSDALE AZ 85258
UCCELLI ANDREW A/ALI	575 ALAMEDA SAN CARLOS CA 94070-2906
VANTAGE RETIREMENT PLANS LLC	920 E CARVER RD TEMPE AZ 85284
WANDERSON PROPERTIES LLC	505 S MADISON DR TEMPE AZ 85281
WARRAICH SHERAZ A/SARAH	7917 S 28TH WAY PHOENIX AZ 85042
WEISHAR EVAN	6929 E ORBORN RD UNIT C SCOTTSDALE AZ 85251
WENDY CASHABACK PLLC	6941 E 4TH ST UNIT 10 SCOTTSDALE AZ 85251
WIDDEN RICHARD J JR	6990 E 6TH ST UNIT 1018 SCOTTSDALE AZ 85251
WILLERT KEVIN B	6927 E 5TH ST SCOTTSDALE AZ 85251
WOLFE CLAYTON B	6990 E 6TH ST UNIT 1024 SCOTTSDALE AZ 85251
WRIGHT BRIAN ALLEN	3309 N 70TH ST #118 SCOTTSDALE AZ 85251
YOUNG ROBERT K	3233 N 70TH ST UNIT 1014 SCOTTSDALE AZ 85251
YOUNG TAYLOR C	1093 LUND TER SUNNYVALE CA 94089
ZIMA CAPITAL LLC	17012 N 57TH ST SCOTTSDALE AZ 85254
ZIMBRO NANCY C/WILLIAM J	6929 E OSBORN RD NO E SCOTTSDALE AZ 85251
ZINDA GLADYS H	3309 N 70TH STREET # 119 SCOTTSDALE AZ 85251
ZOUKIS JOHN G	3309 N 70TH ST #204 SCOTTSDALE AZ 85251

Chi, Andrew

From: Susan Steinbicker <susanaz@rwc.org>
Sent: Tuesday, January 07, 2020 8:24 AM
To: Chi, Andrew
Subject: AGAINST 7034 E OSBORN MURAL (1-DR-2020)

Good morning,

I own a townhouse located at 6925 E. Osborn Road Unit F, Casa Granada Townhomes.

I would like to make my objection of the proposed mural, Pre-Application #: 903-PA-2019 be known.

This is a residential area and I believe this will be a major visual distraction.

Thank you,
Susan Steinbicker
Cell-480-225-0524



Susan Steinbicker
Direct Tile Sales Manager
RWC Building Products
1918 W. Grant Street
Phoenix, AZ 85009
W 602-252-1684, ext 1224
F 602-794-3919

Chi, Andrew

From: Ruenger, Jeffrey
Sent: Monday, January 27, 2020 12:56 PM
To: Chi, Andrew
Subject: 7034 E Osborn Rd - Mural (1-DR-2020)

From: Andrew Mallett <andrewmallett@sbcglobal.net>
Sent: Sunday, January 26, 2020 1:25 PM
To: Projectinput <Projectinput@Scottsdaleaz.gov>
Subject: 7034 E Osborn Rd-Mural

I do not support the painting of a mural at 7034 E Osborn Rd. The painting will open up the door to making Scottsdale a canvass of potentially offensive and disturbing artwork. I understand it starts with oversight and approvals but just like in Atlanta and Sacramento; who now have over 60+ murals, they have turned into disturbing and offensive pieces of art all over the city. The best cities and neighborhoods I have lived in, enforce a policy of "keep your property looking nice" position. Keep areas from looking like a blight and paint it nicely and at least every 15 years and you will have no issues.

Thank you for taking this under consideration.

Andrew Mallett
7024 E 6th Street #104
Scottsdale, AZ 85252
andrewmallett@sbcglobal.net

DEVELOPMENT REVIEW BOARD REPORT



Meeting Date: March 5, 2020
General Plan Element: *Character and Design*
General Plan Goal: *Foster quality design that enhances Scottsdale as a unique southwestern desert community.*

ACTION

7034 E. Osborn Road Mural 1-DR-2020

Location: 7034 E. Osborn Rd.

Request: Request to display a 320 square foot mural, measuring approximately 40 feet long by 8 feet tall, displaying saguaro cacti and cactus wren birds against a pink-colored background, located on the east wall of an existing single-story 1,341 square foot commercial building.

OWNER

William Kopcheck
602-540-3334

ARTIST

Lauren Lee Fine Art

APPLICANT CONTACT

Alexandra Wienberg
Arizona Party Bike
602-529-1463

BACKGROUND

Zoning

The site is zoned Highway Commercial, Downtown Overlay (C-3 DO).

Context

The property is located in Old Town Scottsdale, on the north side of E. Osborn Road, midway between N. 70th Street and N. Bishop Lane, with surrounding developments featuring one-story and two-story commercial office buildings, a church, and a four-story apartment complex.

Adjacent Uses and Zoning

- North Existing one-story buildings with office and service uses, zoned Highway Commercial, Downtown Overlay (C-3 DO)
- South Existing place of worship (church), zoned Multiple-family Residential (R-5)
- East Existing one-story buildings with office and service uses zoned Highway Commercial, Downtown Overlay (C-3 DO)
- West Existing two-story building with office use, zoned Highway Commercial, Downtown Overlay (C-3 DO)

Key Items for Consideration

- Downtown Urban Design & Architectural Guidelines
- Zoning Ordinance Section 1.904 – Development Review Board Criteria

DEVELOPMENT PROPOSAL

Goal/Purpose of Request

The applicant is requesting approval of a 320 square foot painted mural, sized at 40 feet long by 8 feet tall, featuring multiple rows of saguaro cacti in varying heights with cactus wren birds, all against a pink-colored background, located on the eastern façade of an existing 1,341 square foot one-story commercial building in Old Town Scottsdale (Attachment #7). At the top right corner of the mural will be a small set of painted words in white cursive that reads “Welcome to Old Town Scottsdale!” No lighting is proposed to illuminate the mural.

Neighborhood Communication

City Staff mailed postcard notifications to property owners within 750 feet of the site. A public hearing notification sign is posted on the subject site. As part of the applicant’s neighborhood notification outreach requirement, the applicant mailed a letter outlining the mural proposal to property owners within 750 feet of the subject site. The applicant’s Project Notification and Public Participation Report is attached (Attachment #10 & Attachment #11). As of the date of this report, City Staff has received two (2) emails opposing the proposed mural (Attachment #12).

DEVELOPMENT REVIEW BOARD CRITERIA ANALYSIS

The subject site is a 1,341 square foot building constructed sometime in the late 1940’s, based on historical aerial photographs. The building does not have any historic designation since the building’s exterior has been modified on multiple occasions over the past several decades, including a recent remodel and repaint (Attachment #5). The subject site is within the Garden District of Old Town Scottsdale (Attachment #3). The proposed mural’s theme, size and design is to be guided by the Old Town Scottsdale Urban Design & Architectural Guidelines, and by the Development Review Board Criteria in accordance with Zoning Ordinance Section 1.904.

The City does not have a mural-specific guideline or policy to regulate the size, location and construction of proposed murals. Previous Development Review Board mural applications has generated a public discussion on whether the City should implement a mural-specific policy in-addition to complying with applicable design guidelines and the Zoning Ordinance. For now, the design, size and application of murals will continue to abide by the underlying design guideline and Development Review Board Criteria of Zoning Ordinance Section 1.904.

Old Town Scottsdale Urban Design & Architectural Guidelines (UDAG)

Incorporation into the Built Environment

Guideline #7: The site plan, building arrangement, and orientation of uses should coordinate with neighboring properties.

- Plan for temporary and permanent public art in site and streetscape design.

Staff Analysis:

The proposed mural is a permanent private art piece that is incorporated into the design of the existing one-story building, adding to the overall streetscape design and enhancing the pedestrian experience. The mural is accessible from a private driveway that traverses the site, creating an informal exhibition space for pedestrians to access and view a piece of art drawn by a local artist.

Site & Surrounding Context

Guideline #11: Utilize signage that supports Old Town character and function.

- Signage should provide clear, concise and useful information, without becoming a focal point of the aesthetic environment.

Staff Analysis:

The proposed mural has a set of white cursive letters on the top right corner of the display stating, "Welcome to Old Town Scottsdale!" The height of the letters is approximately eight (8) to ten (10) inches tall. Because the sign is tucked away at the far side of the mural, it will not be easily seen from E. Osborn Road. The use of small signage therefore complies with the Old Town Scottsdale Urban Design and Architectural Guideline because it is not a focal point of the mural due to its limited size and positioning.

Building Design – Materials

Guideline #18: Use context-appropriate materials, colors and textures in Old Town development.

- Materials should be of high-quality, durable, easily maintained, and able to withstand the climatic conditions of the desert southwest. Materials should help tie buildings into the composition of the neighborhood. Use of local materials helps to further define sense of place.

Staff Analysis:

The proposed mural will cover the entire eastern façade of the one-story building, which will be visible from westbound travelers along E. Osborn Road. The proposed mural will portray a Sonoran Desert and southwestern theme, and will use several custom paint colors using professional grade acrylic paint from Nova Color Artists Paints, however, the color samples provided are identical matching samples from Behr Paint Company (Attachment #8), and the colors are:

- Green and Teal for the saguaro cacti (Behr 'Striking' P480-7 and Behr 'Rushing Stream' P480-4)
- Orange and Yellow for the cacti thorns (Behr 'Tart Orange' HDC-MD-27 and Behr 'Little Sun Dress' P280-5)
- Browns and Greys for the cactus wren birds (Behr 'Creamy Mushroom' PPU5-13 and Behr 'Espresso Beans' PPU5-01)
- Pink for the background (Behr 'Pink Wink' M120-3)

The use of the vivid colors diverges with the architecture and design of other buildings within the neighborhood, since most buildings in the vicinity utilize pastel and warm neutral colors, with vivid colors only used on building accents. However, the mural complements the artistic history of the Garden District. In the 1950's and 1960's, art had a significant contribution to buildings in the Garden District, especially on the mid-century apartment buildings northwest of the subject site in the area centered on E. 2nd Street and N. 69th Street. In that area, metal caricatures and etchings such as feathers and buffalos were incorporated into the design of the mid-century apartment buildings.

The Development Review Board shall determine whether the mural's Sonoran Desert and southwestern theme along with the use of vivid colors is appropriate within the context and artistic history of the Garden District. In addition, the Development Review Board shall determine whether the size and location of the proposed mural on the building façade is context appropriate.

Zoning Ordinance Section 1.904 – Development Review Board Criteria

Criteria #2: The architectural character, landscaping and site design of the proposed development shall recognize the unique climatic and other environmental factors of this region to respond to the Sonoran Desert environment, as specified in the Sensitive Design Principles.

Sensitive Design Principle #9

The design of the built environment should respond to the desert environment:

- Materials with colors and coarse textures associated with the Sonoran Desert should be utilized.
- A variety of textures and natural materials should be used to provide visual interest and richness, particularly at the pedestrian level. Materials should be used honestly and reflect their inherent qualities.

Staff Analysis:

The proposed mural utilizes multiple vivid colors to portray a Sonoran Desert and southwestern theme of saguaro cacti, cactus wrens, and the Arizona sunset; using colors such as green, teal, orange, yellow, brown, grey, and pink. The colors are more vivid than the actual real-world appearance of a saguaro and cactus wren, and do not reflect a muted earth tone that Sensitive Design Principle #9 requires. However, the use of pink as the background color represent an Arizona sunset and is commonly associated with the Sonoran Desert. It is the purview of the Development Review Board to consider the use of the colors and decide whether the colors are appropriate within the context of Sensitive Design Principle #9.

Criteria #5: Within the Downtown Area, building and site design shall demonstrate conformance with the Old Town Scottsdale Urban Design & Architectural Guidelines, and incorporate urban and architectural design that address human scale and incorporate pedestrian-oriented environment at the street level.

Staff Analysis:

The proposed mural partially conforms to the Old Town Scottsdale Urban Design and Architectural Guidelines. It conforms to the guidelines by proposing a Sonoran Desert and southwestern theme portraying saguaro cacti, cactus wrens, and an Arizona sunset. It does not conform to the color guidelines since the proposed mural is using vivid and saturated colors versus the recommended use of pastel colors and warm neutrals for the design and appearance of buildings.

The proposed mural adds to the artistic history of the Garden District and is a piece of art will be visible to pedestrians and vehicular traffic traveling westbound on E. Osborn Road. Its location along the eastern elevation of the existing one-story building will attract pedestrians to view the artwork, thus achieving a human-scale quality and enhancing the pedestrian environment at the street level.

PREVIOUS DEVELOPMENT REVIEW BOARD HEARING

At the February 20, 2020 Development Review Board (DRB) hearing, Board members asked questions related to the proposed colors of the mural. In the initial application submittal, the applicant provided a digital paint sample of the proposed mural colors, but DRB members at the hearing commented that the digital samples did not match the color rendering of the mural, and requested paint drawdowns, which the applicant was not able to provide. Board members also asked staff what the Board’s purview is over the mural – staff responded that the DRB can comment on the size, placement and color of the mural as it relates to architecture and design, but the DRB cannot comment on the content of the mural. The Development Review Board voted 7-0 to continue the case to the next hearing date on March 5, 2020, to allow the applicant time to provide paint drawdowns of the proposed mural from the artist. The applicant will provide paint drawdowns for review by the Board for the Development Review Board March 5, 2020 hearing.

STAFF RECOMMENDATION

Recommended Approach:

Staff recommends that the Development Review Board approve the 7034 E. Osborn Road Mural, per attached stipulations, finding that the provisions of the Old Town Scottsdale Urban Design & Architectural Guidelines and the Development Review Criteria have been met.

RESPONSIBLE DEPARTMENT

Planning and Development Services

Current Planning Services

STAFF CONTACT

Andrew Chi

Planner

Phone: 480-312-7828

E-mail: achi@ScottsdaleAZ.gov

APPROVED BY



Andrew Chi, Planner, Report Author

2/25/2020

Date



Tim Curtis, AICP, Current Planning Director

Phone: 480-312-4210 E-mail: tcurtis@scottsdaleaz.gov

2/25/2020

Date



Randy Grant, Director

Planning and Development Services

Phone: 480-312-2664 E-mail: rgrant@scottsdaleaz.gov

2/26/20

Date

ATTACHMENTS

- A. Stipulations/Zoning Ordinance Requirements
 - 1. Context Aerial
 - 1A. Close-Up Aerial
 - 2. Zoning Map
 - 3. Old Town Scottsdale Districts Map
 - 4. Aerial Photo
 - 5. Existing Conditions
 - 6. Applicant's Narrative
 - 7. Mural Rendering
 - 8. Paint Color Samples
 - 9. Artist Information
 - 10. Public Participation Report
 - 11. Notification Mailing List
 - 12. Citizen Comments

**Stipulations for the
Development Review Board Application:
7034 E. Osborn Road Mural
Case Number: 1-DR-2020**

These stipulations are intended to protect the public health, safety, welfare, and the City of Scottsdale.

APPLICABLE DOCUMENTS AND PLANS:

Except as required by the Scottsdale Revised Code (SRC), the Design Standards and Policies Manual (DSPM), and the other stipulations herein, the site design and construction shall substantially conform to the following documents:

1. Architectural elements, including dimensions, materials, form, color, and texture shall be constructed to be consistent with the building elevations submitted by Alexandra Wienberg, with a City Staff date of February 25, 2020.

EXTRIOR LIGHTING:

DRB Stipulations

2. No lighting is approved with this mural.

ADDITIONAL ITEMS:

DRB Stipulations

3. The owner or designee shall maintain the mural in good condition and shall fix or repaint any damage, fading or peeling to the mural.



Context Aerial

1-DR-2020



Close-up Aerial

1-DR-2020

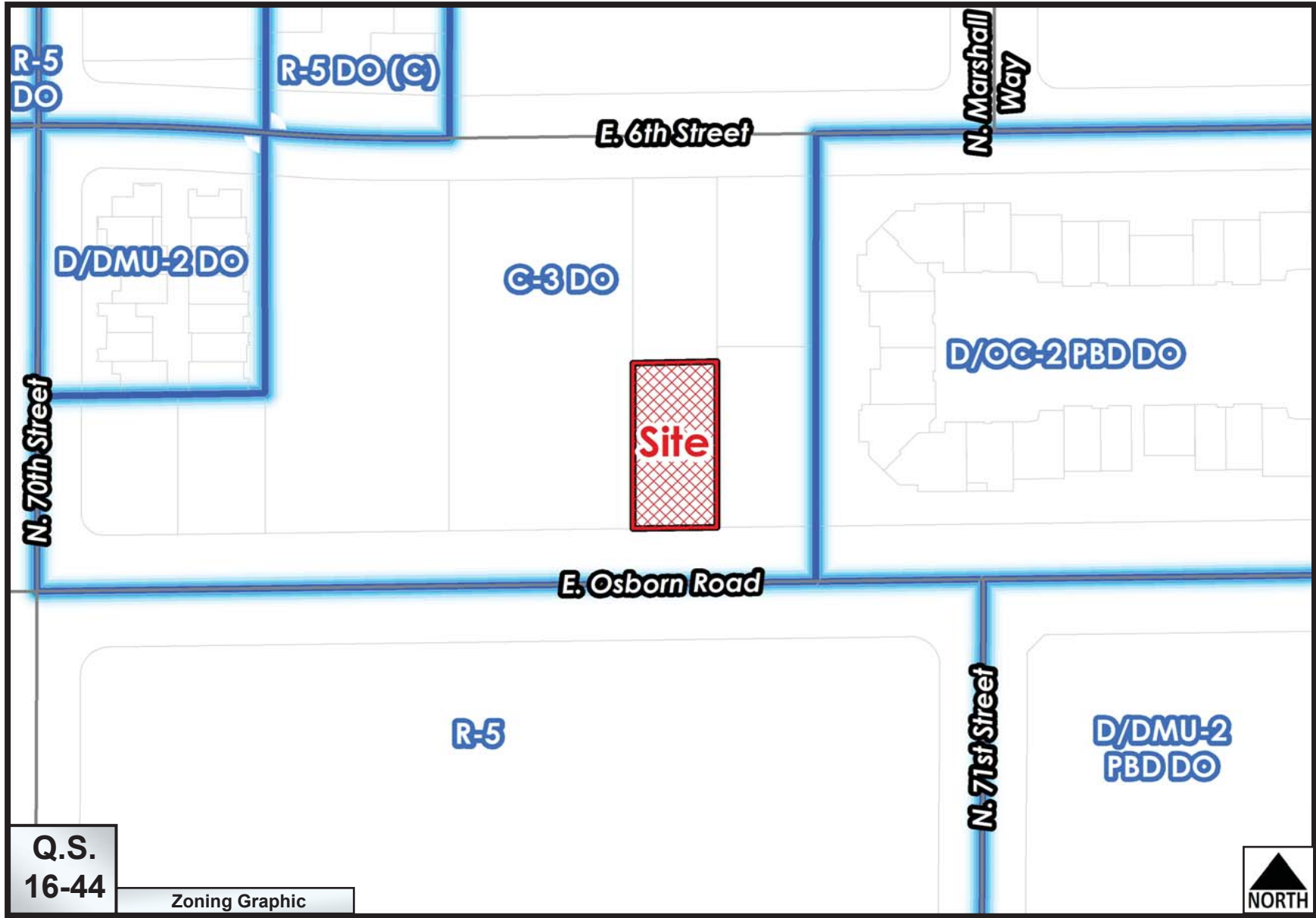

Existing Zoning

1-DR-2020

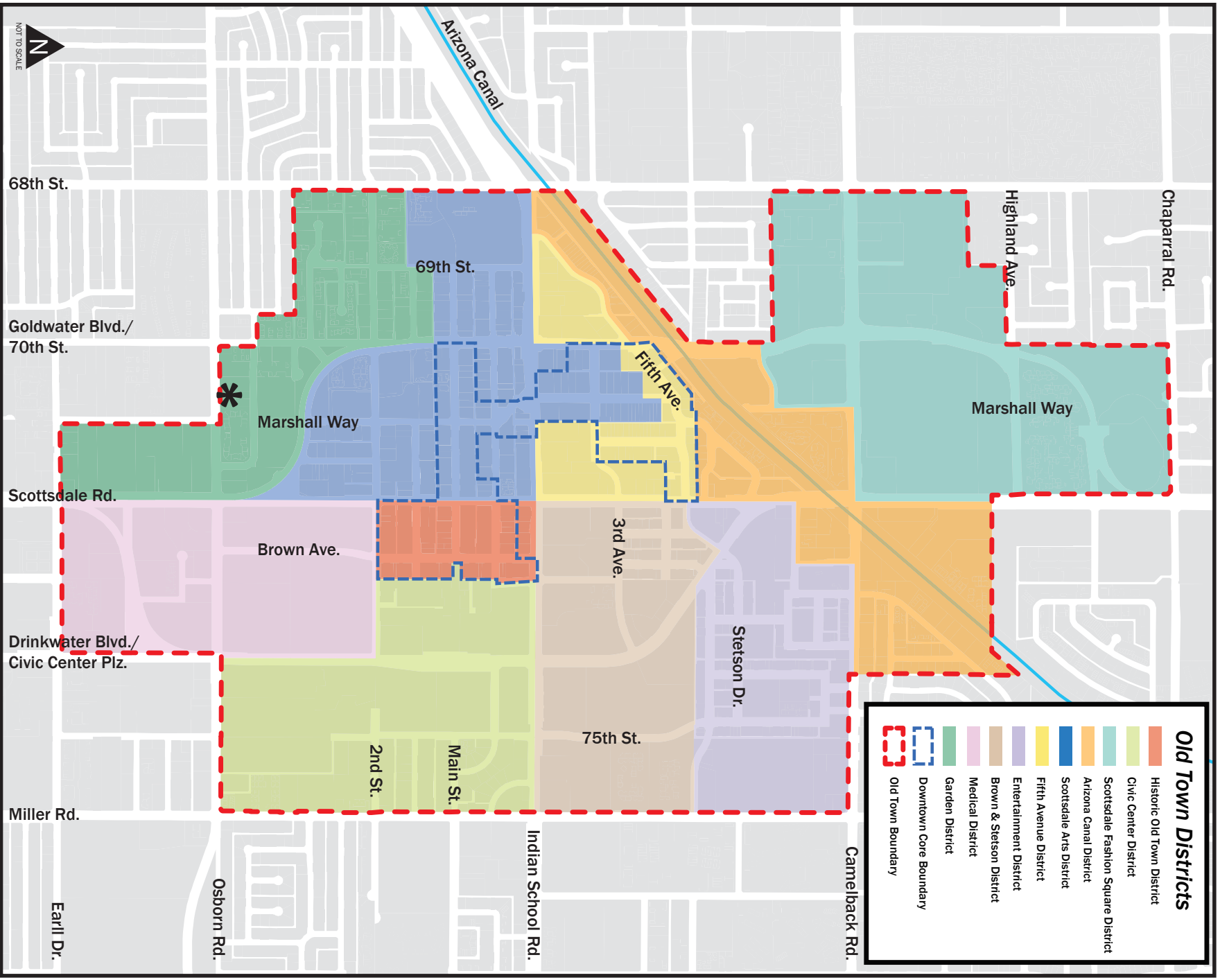

Notice: This document is provided for general information purposes only. The City of Scottsdale does not warrant its accuracy, completeness, or suitability for any particular purpose. It should not be relied upon without field verification. Map not to scale.

Map 2 - Old Town Districts

*** = SUBJECT SITE**

Aerial & Site Photo Locations



Site Photo 1: Facing Northwest from Osborn Road



Site Photo 2: Facing Northwest from Property Entrance



Site Photo 3: Facing West from Driveway



Application Narrative

December 31, 2019

Property Owner

Case Number: 1-DR-2020

Pre-Application Number: 903-PA-2019

Address: 7034 E Osborn Rd Scottsdale, AZ 85251

Project Narrative:

I am writing to you today to discuss our proposed mural on the East facing wall of 7034 E Osborn Rd Scottsdale, AZ 85251. The mural is titled "7034 E Osborn Mural" and will be approximately 40 ft long and 8 ft tall, which equates to about 320 sq ft. This beautiful desert depiction will be painted by Lauren Lee who is an incredible and renowned artist. She has many pieces of work in Scottsdale, and all over Arizona!

Our mural will blend in seamlessly with the architectural characteristics of our building, surrounding areas, the landscape of Arizona, and our overall site design. Lauren has designed this art piece to fit the modern theme of many of the area buildings. Her art will depict a beautiful Sonoran Desert theme representative of the saguaro cacti and cactus wren. Painted in pastel colors with a light pink background, it will inspire the thought of Arizona's incredible sunrises and sunsets. The images will be strategically oversized to ensure the scene is not too busy, pleasant to look at, and depict the details of iconic Arizona cacti.

We look forward to the opportunity to create an eye-catching work of art in Old Town Scottsdale that shows off the beauty of our unique desert plants and birds.

Proposed Mural

ATTACHMENT 7



East Elevation

Paint Samples

Nova Paints, which are professional grade high UV acrylic paints will be used. Because the proposed mural colors are custom colors, the sample shown below are from Behr Paint Company, and they are identical to the colors that will be used to paint the mural.



Project Colors

 **Rushing Stream**
P480-4

 **Striking**
P480-7

 **Pink Wink**
M120-3

 **Little Sun Dress**
P280-5

 **Tart Orange**
HDC-MD-27

 **Espresso Beans**
PPU5-01

 **Creamy Mushroom**
PPU5-13



LAUREN LEE

PUBLIC ARTIST

CONTACT INFO: 480.384.0321
 LAURENLEE222@GMAIL.COM
 LAURENLEEFINEART.COM

EDUCATION: ARIZONA STATE UNIVERSITY, GRADUATED WITH A BACHELORS OF ARTS, 2007
HONORS: NATIONAL HONOR SOCIETY, NATIONAL COLLEGIATE SOCIETY, DEANS LIST 2001-2005, 2007

PUBLIC ART

- DOWNTOWN PHOENIX INC, CITY OF PHOENIX: FIVE C'S INTERIOR MURAL, 2018
- EXPERIENCE SCOTTSDALE, CITY OF SCOTTSDALE: "ITS THAT HOT" SUMMER MURAL CAMPAIGN 2018
- CLEAN ELECTIONS COMMISSION: 18IN2018 ANIMATED MURAL, 2018
- GREATER PHOENIX ECONOMIC COUNCIL, INTERIOR MURAL 2017
- SCOTTSDALE PUBLIC ART: SOHO LIVE WORK TOWNHOMES, 153X24' HANDPAINTED MURAL 2017
- PHOENIX PUBLIC ART, KROGER-FRYS MURAL, 2016
- TEMPE PUBLIC ART: "DON'T WAKE THE DREAMER" MURAL, 150 X 16' HANDPAINTED MURAL 2015
- VALLEY METRO: ROTATING ARTIST MURAL AT ROOSEVELT/CENTRAL LIGHTRAIL STOP 2017
- THREE BIRDS IN FLIGHT MURAL, DOWNTOWN PHOENIX 2015
- CITY OF MESA: DOWNTOWN MESA MURAL, 24'X24' 2015
- CITY OF CHANDLER: "FLOW" MURAL, INFLUX GRANT 2013
- CITY OF MESA: MESA PUBLIC LIBRARY, CHILDRENS SECTION MURALS 2013

SOLO GALLERY EXHIBITIONS

- WAHEGURU, MEGAPHONE GALLERY, PHOENIX AZ, 2018
- FIRESKY, {9} THE GALLERY, PHOENIX AZ, 2016
- SISTERS OF THE MOON, {9} THE GALLERY, PHOENIX AZ, 2015
- OIL AND INK, GREENHAUS ART GALLERY, PHOENIX AZ, 2014
- DREAMS, {9} THE GALLERY, PHOENIX AZ, 2014
- FAWN, GREENHAUS ART GALLERY, PHOENIX AZ, 2013
- DIVINITY, GREENHAUS ART GALLERY, PHOENIX AZ, 2012
- ANIMISM, FAIR TRADE GALLERY, PHOENIX AZ, 2012
- WE CAN ALL BE FREE, FAIR TRADE GALLERY, PHOENIX AZ 2011

LOCATIONS OF MURALS COMPLETED FOR BUSINESSES:

REPUBLICA EMPANADA, FAIR TRADE CAFE, FLOATING LOTUS STUDIOS, OASIS ON GRAND, 909APT
 BETHANY TERRACE APTS, SPRING APTS, STREET COFFEE, MESA URBAN GARDEN, ORGANIC LIVING

Artist: Lauren Lee

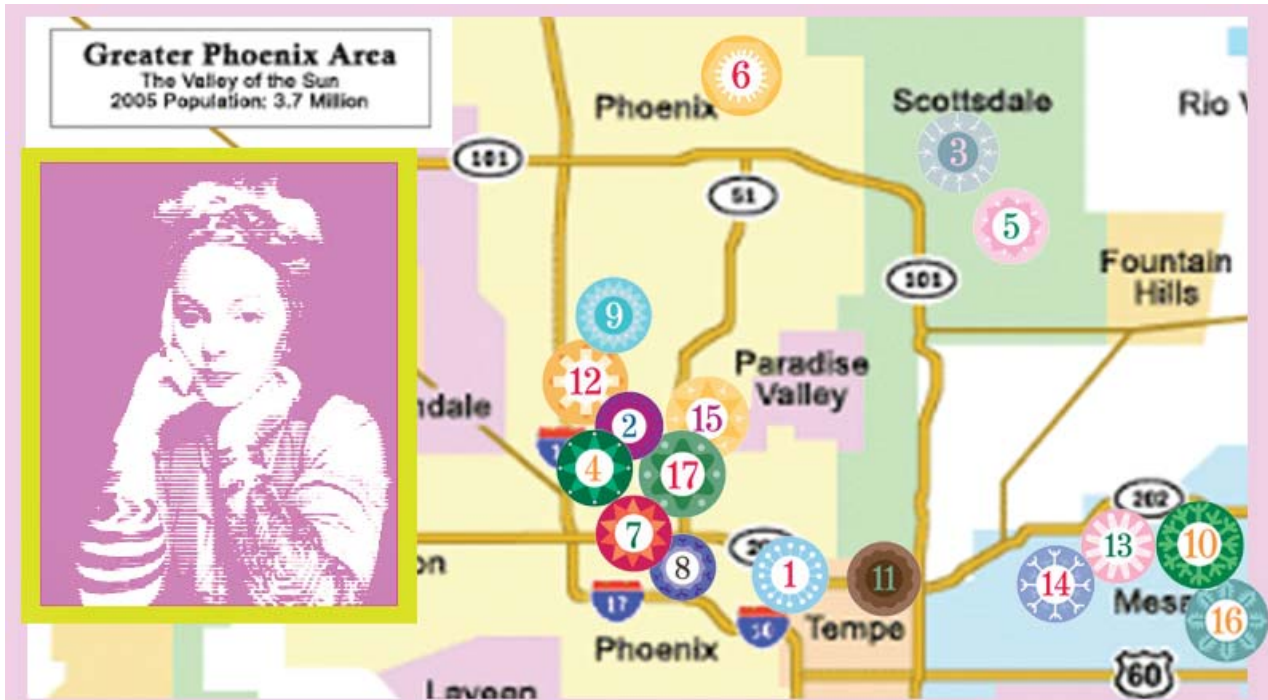

MURAL ADDRESSES: IN ORDER OF MOST RECENT

1. TEMPE: VALLEY FAIR SHOPPING COMPLEX, EXTERIOR, 63 E. Southern Ave (Southern and Mill Ave)
2. PHOENIX: FIVE C'S MURAL, INTERIOR, DOWNTOWN PHOENIX INC 1 E Washington St #230, Phoenix, AZ 85004
3. SCOTTSDALE: GEISHA A GO GO , EXTERIOR, 7150 E 6th Ave, Scottsdale, AZ 85251
4. PHOENIX: TAKE FLIGHT INTERACTIVE MURAL, EXTERIOR, 214 E Roosevelt St, Phoenix, AZ 85004
5. SCOTTSDALE: SOHO SCOTTSDALE, EXTERIOR, 16510 N 92nd St, Scottsdale, AZ 85260
6. PHOENIX: SPRING APARTMENTS, EXTERIOR, 2015 W Cactus Rd, Phoenix, AZ 85029
7. PHOENIX: THREE BIRDS IN FLIGHT, EXTERIOR, 290 E Roosevelt St, Phoenix, AZ 85004
8. PHOENIX: STREET COFFEE, EXTERIOR, 625 N 7th St, Phoenix, AZ 85006
9. PHOENIX: ORGANIC LIVING, EXTERIOR, 8342 N 7th St, Phoenix, AZ 85020
10. MESA: DOWNTOWN MESA, EXTERIOR, 63 W Main St, Mesa, AZ 85201
11. TEMPE: DON'T WAKE THE DREAMER, EXTERIOR, 5th St and Hardy, Tempe AZ
12. PHOENIX: OASIS ON GRAND, EXTERIOR, 1501 Grand Ave, Phoenix, AZ 85007
13. MESA: FLOATING LOTUS, INTERIOR, 202 W Main St, Mesa, AZ 85201
14. MESA: MESA PUBLIC LIBRARY, INTERIOR, CHILDRENS SECTION 64 E 1st St, Mesa, AZ 85201
15. PHOENIX: BETHANY TERRACE APARTMENTS, EXTERIOR, 525 E Bethany Home Rd, Phoenix, AZ 85012
16. MESA: REPUBLICA EMPANADA, INTERIOR, 204 E 1st Ave, Mesa, AZ 85210 (AND GREAT FOOD!)
17. PHOENIX: FAIR TRADE, INTERIOR, 1020 N 1st Ave, Phoenix, AZ 85003



Other Works By Lauren Lee



Public Participation Report

Below is a copy of the letter sent out to all properties within 750' of our property at 7034 E Osborn Rd. Every property was sent a letter on December 31, 2019. I have attached the list of addresses and a receipt of our 1st class mailing method used to send out the letters. We have not been contacted by anyone regarding the mural project.

December 31, 2019

Property Owner

Pre-Application Number: 903-PA-2019

Address: 7034 E Osborn Rd Scottsdale, AZ 85251

To Whom It May Concern:

I am writing to you today to discuss our proposed mural on the East facing wall of 7034 E Osborn Rd Scottsdale, AZ 85251. The mural is titled "7034 E Osborn Mural" and will be approximately 40 ft long and 8 ft tall, which equates to about 320 sq ft. This beautiful desert depiction will be painted by Lauren Lee who is an incredible and renowned artist. She has many pieces of work in Scottsdale, and all over Arizona!

Our mural will blend in seamlessly with the architectural characteristics of our building, surrounding areas, the landscape of Arizona, and our overall site design. Lauren has designed this art piece to fit the modern theme of many of the area buildings. Her art will depict a beautiful Sonoran Desert theme representative of the saguaro cacti and cactus wren. Painted in pastel colors with a light pink background, it will inspire the thought of Arizona's incredible sunrises and sunsets. The images will be strategically oversized to ensure the scene is not too busy, pleasant to look at, and depict the details of iconic Arizona cacti.

We look forward to the opportunity to create an eye-catching work of art in Old Town Scottsdale that shows off the beauty of our unique desert plants and birds.

Robert Mayer

robert@arizonapartybike.com

844-654-5544

City contact is Andrew Chi

achi@scottsdaleaz.gov

480-312-7828



ATTACHMENT 10

1-DR-2020
01/14/20

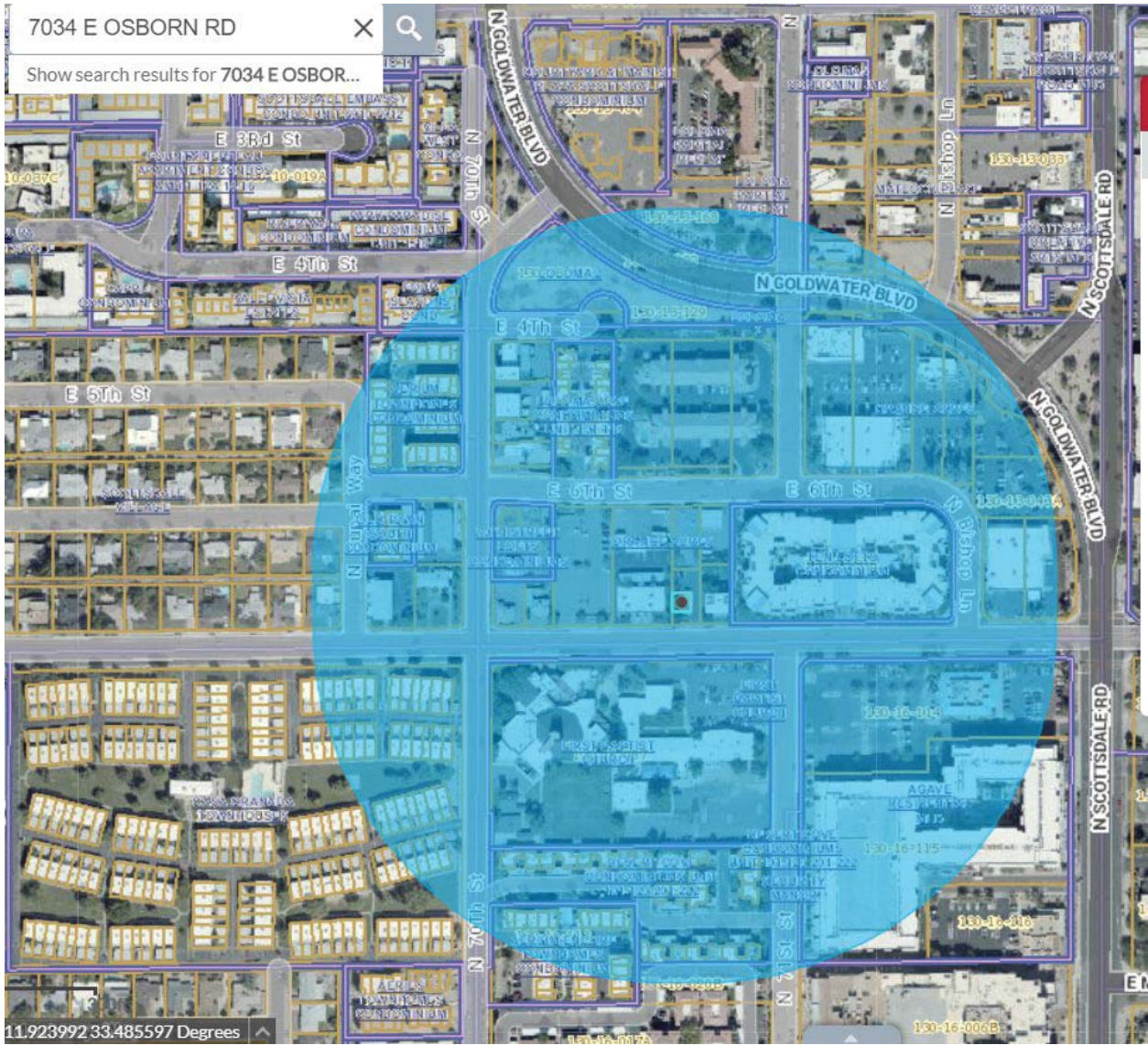

Project Notification Mailing List

Owner

1005 SCOTTSDALE EAST 6TH 17 LLC/ETAL
2008 CONDO PROPERTIES LLC
4TH ST 4TH PO LLC
6925 OSBORN LLC
6941 E 4TH ST UNIT 3 LLC
6941 REAL ESTATE ENTERPRISES LLC/SCHLEMMER R
ACPTS PHX LLC
AERIUM ENCORE LLC
AERIUM LLC
ALBERS DANIEL J
ALCAZAREN PATRICK
ALFAREEDOZ LLC
ALLISON JARED
ANGUS PLAZA LLC
ATTIANESE RYAN/BETH
AZ KERN PROPERTIES LLC
BAHMAN TRUST
BAILEY STEVEN J
BAJPAI AKSHAY
BENNETT CHARLA DILL
BERGMAN JANICE C/GAYTON FORDYCE
BLACK NANCY J
BLACKLEDGE PAMELA L
BLAU ELLIOT
BOSEL MAX/ADRIENNE
BRE/HV PROPERTIES LLC
BRIAN V THINNES TRUS
BUCHLI KEITH R
BURNS BRADLEY
BUTTRUM LAVONA/PREPEJCHAL GARY/BEVERLY J
CAREY FAMILY LIVING TRUST
CASA GRANADA TOWNHOUSES CORP
CHAMBERLIN GERALD A/KARLA M

Mailing Address

5690 DTC BLVD SUITE 515 GREENWOOD VILLAGE CO 80111
40 CYPRESS CREEK PARKWAY UNIT 132 HOUSTON TX 77090
3523 N 70TH ST SCOTTSDALE AZ 85251
4808 E CALLE TUBERIA PHOENIX AZ 85018
7122 N VIA NUEVA SCOTTSDALE AZ 85258
7425 E GAINEY RANCH RD UNIT 15 SCOTTSDALE AZ 85258
20403 W CRESCENT DR BUCKEYE AZ 85396
301 1103-95 ST SW EDMONTON AB CANADA T6X0P8
8901 E PIMA CENTER PARKWAY SUITE 100 SCOTTSDALE AZ 85258
12637 OHERN ST OMAHA NE 68137
3309 N 70TH ST UNIT 114 SCOTTSDALE AZ 85251
3425 N 70TH ST SCOTTSDALE AZ 85251
3233 N 70TH ST UNIT 1007 SCOTTSDALE AZ 85251
3238 N SCOTTSDALE RD SCOTTSDALE AZ 85251
6953 E OSBORN RD UNIT D SCOTTSDALE AZ 85251
PO BOX 391360 MOUNTAIN VEIN CA 94039
4008 N 65TH PL SCOTTSDALE AZ 85251
3307 N 70TH ST #208 SCOTTSDALE AZ 85251
6990 E 6TH ST UNIT 1013 SCOTTSDALE AZ 85251
7023 E 4TH ST 103 SCOTTSDALE AZ 85251
2693 HEADWATER DR FT COLLINS CO 80521
6925 E OSBORN RD NO B SCOTTSDALE AZ 85251
3210 N 81ST ST SCOTTSDALE AZ 85251
7002 E OSBORN SCOTTSDALE AZ 85251
PO BOX 391360 MOUNTAIN VIEW CA 94039
P O BOX 49550 CHARLOTTE NC 28277
6990 E 6TH ST UNIT 1021 SCOTTSDALE AZ 85251
3309 N 70TH ST UNIT 107 SCOTTSDALE AZ 85251
6990 E 6TH ST UNIT 1023 SCOTTSDALE AZ 85251
3313 SW WASHINGTON ST PEORIA IL 61602
4203 E DUBOIS AVE GILBERT AZ 85298
4645 E COTTON GIN LOOP PHOENIX AZ 85285
3233 N 70TH ST UNIT 1024 SCOTTSDALE AZ 85251

CHRIS N MILLER LIVING TRUST
CHURCHPLACE INC
COHEN DAVID C
COHEN JUSTIN A
COLONIAL REALTY LIMITED PARTNERSHIP
CONNELL WINE LOFTS
COTTINGHAM JASON
CUSTER CRAIG
DANIEL WARREN H/VENNE NANCY
DEMERIS THEODORE J/PAMELA S
DESERT IRONWOOD LLC
DOERING ERIC/EVE
DONNELLY KENNEDY
DOS PERROS INVESTMENTS LLC
DUECK AMYLOU C
ECKSTEIN CAMERON J
EGELAND RUBY MORA-
ERIC SHANE AND WENDY ALLISON HASSETT TRUST
ES ROYALE LLC
EXPRESS COMPANIES XIII LLC
FIRST BAPTIST CHURCH OF SCOTTSDALE
FIRST BAPTIST CHURCH OF SCOTTSDALE
FISHER ROBERT P/GINGER L/THEODORE G
FRANE THOMAS J/CAROL L
FULLER ROBERTA A
FUNKE BENJAMIN M
GANAJIAN ARMAND CHARLES
GILL-BACHAND FAMILY LIVING TRUST
GO DIVING PROPERTIES LLC
GOLDEN SAPPHIRE LLC
GRAHAM JACQUE LYNNETTE/FITZMAURICE LARRY
HAMMOND THOMAS G TR
HANSON JAMES/TRACY
HAVRANEK MATTHEW

1948 S ADOBE POINT YUMA AZ 85365
3625 N MARSHALL WAY SCOTTSDALE AZ 85251
6990 E 6TH ST UNIT 1005 SCOTTSDALE AZ 85251
6937 E OSBORN RD UNIT C SCOTTSDALE AZ 85251
6815 POPLAR AVENUE SUITE 500 GERMANTOWN TN 38138
200 CONNELL DR BERKELEY HEIGHTS NJ 07922
3309 N 70TH ST UNIT 112 UNIT 122 SCOTTSDALE AZ 85251
5023 S CONVENT LN APT I PHILADELPHIA PA 19114
3233 N 70TH ST UNIT 1022 SCOTTSDALE AZ 85251
3233 N 70TH ST UNIT 1008 SCOTTSDALE AZ 85251
5217 E WHITTON AVE PHOENIX AZ 85018
5362 BOLSA AVE NO B HUNTINGTON BEACH CA 92649
3309 N 70TH ST UNIT 218 SCOTTSDALE AZ 85251
1707 E WEBER DR NO 10 TEMPE AZ 85281
6945 E OSBORN RD UNIT C SCOTTSDALE AZ 85251
330 J ST UNIT 511 SAN DIEGO CA 92101
3307 N 70TH ST #216 SCOTTSDALE AZ 85251
21575 CABROSA MISSION VIEJO CA 92691
UNIT 3190 BOX 143 DPO AA 34024
3100 S RURAL RD 1 TEMPE AZ 85282
7025 E OSBORN RD SCOTTSDALE AZ 85251
7025 E OSBORN RD SCOTTSDALE AZ 85251
PO BOX 2950 SCOTTSDALE AZ 85252
7904 DELCON DR FORT WAYNE IN 46809
5630 SW RIVERSIDE LN UNIT 5 PORTLAND OR 97239
810 W HOWE ST TEMPE AZ 85281
20811 N 62ND DR GLENDALE AZ 85308
13796 N 93RD PL SCOTTSDALE AZ 85260
218 W VINEDO LN TEMPE AZ 85284
4916 N 73RD ST APT 5 SCOTTSDALE AZ 85251
22 FOOTHILL ASH LITTLETON CO 80127-3541
1835 MIDLAND RD SAGINAW MI 48603
313 NORTH MAIN STREET VIROQUA WI 54665
6953 E OSBORN RD UNIT F SCOTTSDALE AZ 85251

HEINRICH GRANT R/MELISSA S
HELIOTI CATHERINE
HERENDEEN ANGELINE
HIGH MATTHEW
HOLVECK THELMA L TR
HOOD BRETT R/ANN M/SEWELL CHRISTINA M
HOUSTON STEVEN H/LESLIE K TR
JACOB P WESTERHOF REVOCABLE TRUST
JEFFREY R LIPSON AND MAUREEN D LIPSON REVOCAB
JEHLING MATTHEW
JOHNSON BRIAN WAYNE
JUDITH BRUZZA REVOCABLE TRUST
KEHM KELLY NICOLE/KATHERINE
KERNS LINDSAY
KLOBASSA CHARLES E II/GREENLAND PAULETTE D
KONDO NATHAN A/CATHERINE C
LAFOREST FAMILY LIVING TRUST
LAKE DONALD R/JUDITH N
LAKE SCOTTSDALE PROPERTIES LLC
LANE SUSAN
LANGA PROPERTIES V LLC
LANGE JEFFREY A
LINDQUIST DERON S
LOIS FAGAN FAMILY TRUST
LOW STEPHANIE DANICA
LUCHT AUSTIN R
LUNA BEAR LLC
MADISON MARIE ROSE SEPARATE PROPERTY TRUST
MAGUIRE ALLAN/MAYO S
MALLETT ANDREW ALAN/MATTETT DONNAMAE TUASON
MALLORY BRENDA D/CURTIS W
MCCARTHY PAUL R/JAIME L
MDM818 HOLDINGS LLC
MICHALOVE SAMUEL

3233 N 70TH ST UNIT 1012 SCOTTSDALE AZ 85251
922 W RIDGE RD ROCHESTER NY 14615
3309 NORTH 70TH STREET UNIT 110 SCOTTSDALE AZ 85251
6990 E 6TH ST UNIT 1022 SCOTTSDALE AZ 85251
6944 E OSBORN RD SCOTTSDALE AZ 85251
8608 ASHWORTH RD SE CALGARY AB CANADA T2H1R2
266 ZENITH ST CHULA VISTA CA 91942-5848
6208 INDIAN MOUND DE MCFARLAND WI 53558
8303 N EL MARO CIR PARADISE VALLEY AZ 85253
6990 E 6TH ST UNIT 1010 SCOTTSDALE AZ 85251
7024 E 6TH ST UNIT 204 SCOTTSDALE AZ 85251
3233 N 70TH ST UNIT 1023 SCOTTSDALE AZ 85251
6925 E OSBORN RD G SCOTTSDALE AZ 85251
6945 E OSBORN RD UNIT A SCOTTSDALE AZ 85251
6925 E OSBORN RD #C SCOTTSDALE AZ 85251
6990 E 6TH ST UNIT 1025 SCOTTSDALE AZ 85251
6990 E 6TH ST UNIT 1026 SCOTTSDALE AZ 85251
18 MEREDITH DR SANTA FE NM 87506
104 WILMOT RD MS NO 1435 DEERFIELD IL 60015
205 S SENATE ST CHANDLER AZ 85225
6019 N 80TH PL SCOTTSDALE AZ 85250
6933 E OSBORNE RD #C SCOTTSDALE AZ 85251
25671 LE PARC UNIT 13 LAKE FOREST CA 92630
6953 E OSBORN RD UNIT E SCOTTSDALE AZ 85251
7024 E 6TH ST UNIT 205 SCOTTSDALE AZ 85251
6990 E 6TH ST UNIT 1006 SCOTTSDALE AZ 85251-5548
20403 W CRESCENT DR BUCKEYE AZ 85396
3233 N 70TH ST UNIT 1005 SCOTTSDALE AZ 85251
6004 E PHELPS RD SCOTTSDALE AZ 85254
829 FAIRCHILD CT FOLSOM CA 95630
6937 E OSBORN RD SCOTTSDALE AZ 85251
178 LOCHSA CT LEWISTON ID 83501
11068 E WHITE FEATHER LN SCOTTSDALE AZ 85262
3309 N 70TH ST UNIT 206 SCOTTSDALE AZ 85251

MNAZ INVESTMENT PROPERTIES LLC
MONTI LIVING TRUST
MONTOYA FABIENE
MOSES DAYLE A
MUNE CHELSEA JEAN
MWM VICSDALE FOREVER LLC
MWM VICSDALE MAGIC LLC
N AND D RESTAURANTS INC
NALEPA BRYCE DAVID
NANGLE CONOR
NESLUND NICHOLAS/GERALD
NIKKHAH MEHDI
NORTHSHORE ASSOCIATES LLC
OBRIEN TAMMIE J/PATRICK J
ONTIVEROS JORDAN/JOHN/STACY
ONTIVEROS STEVEN/LUCINDA LEE
ORZE JONATHAN J
OSBORN 6932 LLC
OSGOOD STEWART GEORGE
OT DOMINO ONE LLC
OT DOMINO THREE LLC
PALMER ALEXANDER
PARNAMI MOHIT
PATRICIA L WILCOX REVOCABLE LIVING TRUST
PAUL LEMAJEUR LIVING TRUST
PAYNE CLAIRE E
PENINGER JAMES/MICHELLE
PJE INVESTMENTS LLC
POLLIFRONE FAMILY TRUST
POWERS HEIDI/RICHARD PATRICK
PRESCOD ANGELICA
PRICE APRIL
PRP PROBERTIES L L C
RAMOS JUAN MARTINEZ

11811 N TATUM BLVD SUITE 1060 PHOENIX AZ 85028
947 W KAIBAB DR CHANDLER AZ 85248
6990 E 6TH ST UNIT 1003 SCOTTSDALE AZ 85258
1125 N YORK CIR MESA AZ 85203
3309 N 70TH ST UNIT 212 SCOTTSDALE AZ 85251
7349 N VIA PASEO DEL SUR SUITE 515-414 SCOTTSDALE AZ 85258
7349 N VIA PASEO DEL SUR STE 515 PMB 414 SCOTTSDALE AZ 85258
PO BOX 695019 ORLANDO FL 32869-9901
3309 N 70TH ST UNIT 100 SCOTTSDALE AZ 85251
6990 E 6TH ST UNIT 1009 SCOTTSDALE AZ 85251-5548
6937 E OSBORN RD UNIT F SCOTTSDALE AZ 85251
6929 E OSBORN RD UNIT F SCOTTSDALE AZ 85251
3333 E BAYAUD AVE NO 409 DENVER CO 80209
21037 E NICHOLS PKWY AURORA CO 80016
6990 E 6TH ST UNIT 1007 SCOTTSDALE AZ 85251
7023 E 4TH ST UNIT 105 SCOTTSDALE AZ 85251
3233 N 70TH ST UNIT 1006 SCOTTSDALE AZ 85251
11259 E VIA LINDA STE 100 SCOTTSDALE AZ 85259
6929 E 6TH ST SCOTTSDALE AZ 85251
3523 N 70TH ST SCOTTSDALE AZ 85251
3523 N 70TH ST SCOTTSDALE AZ 85251
7024 E 6TH ST UNIT 102 SCOTTSDALE AZ 85251
3309 N 70TH ST NO 220 SCOTTSDALE AZ 85251
5613 WOODFOREST DR SACRAMENTO CA 95842
7221 W EVERELL AVE CHICAGO IL 60631
6945 E OSBORN RD SCOTTSDALE AZ 85251
5939 E INCA ST MESA AZ 85205
PO BOX 2055 EUGENE OR 97402
5301 E YUCCA ST SCOTTSDALE AZ 85254
2416 EASTRIDGE LOOP CHULA VISTA CA 91915
4110 N SCOTTSDALE RD SUITE 145 SCOTTSDALE AZ 85251
7024 E 6TH ST UNIT 106 SCOTTSDALE AZ 85251
3307 N 70TH ST NO 211 SCOTTSDALE AZ 85251
6937 E OSBORN RD B SCOTTSDALE AZ 85251

RAUFMANN FAMILY TRUST	6953 E OSBORN RD UNIT G SCOTTSDALE AZ 85251
RBSM PROPERTIES LLC	16010 N 114TH WAY SCOTTSDALE AZ 85255
RCBH LLC	PO BOX 51 CAVE CREEK AZ 85327
REDLINGER TROY	3309 N 70TH ST NO 120 SCOTTSDALE AZ 85251
RENOVATE AZ LLC	8110 E WILSHIRE DR SCOTTSDALE AZ 85257
RENOVATEAZ LLC	8110 E WILSHIRE DR SCOTTSDALE AZ 85257
ROBERTS BARBARA	3309 N 70TH ST NO 113 SCOTTSDALE AZ 85251
ROOM FOR INTERPRETATION LLC	7038 E OSBORN RD SCOTTSDALE AZ 85251
ROYER DONALD E/DEBORAH L	183 MONARCH BAY DANA POINT CA 92629
S R BECKWITH TRUST	6929 E OSBORN RD UNIT B SCOTTSDALE AZ 85251
SACKS FAMILY TRUST	3233 N 70TH ST NO 1013 SCOTTSDALE AZ 85251
SANDNER HOLLY M	6941 E 4TH ST SCOTTSDALE AZ 85251
SCHAIRER DEREK	6945 E OSBORN RD UNIT E SCOTTSDALE AZ 85251
SCHENK BARRY E/JUDY A	3248 CARRIAGE WY STOW OH 44224
SCHINDLER MATT	3309 N 70TH ST UNIT 101 SCOTTSDALE AZ 85251
SCHMIESTER MARY L	6929 E OSBORN RD UNIT D SCOTTSDALE AZ 85251
SCHULTZ FAMILY TRUST	6121 E FOREST ST APACHE JUNCTION AZ 85119-9509
SCOTT CATHERINE/KENNETH	14-53049 RANGE RD UNIT 220 ARDROSSAN AB CANADA T8E2C8
SCOTT CODUTE LIVING TRUST	3233 N 70TH ST UNIT 1004 SCOTTSDALE AZ 85251-6960
SCOTTSDALE APTS JV LLC	1 E WACKER DR STE 1600 CHICAGO IL 60601-1901
SCOTTSDALE CITY OF	7447 E INDIAN SCHOOL RD STE 205 SCOTTSDALE AZ 85251
SENTNER RICHARD P/SUSAN	11549 BLUE HERON RD BOW WA 98232
SHIPP LTD	PO BOX 356 SCOTTSDALE AZ 85252
SMITH BLAIR/GRACE	6953 E OSBORN C SCOTTSDALE AZ 85251
SMITH MICHELLE	6937 E OSBORN RD UNIT E SCOTTSDALE AZ 85251-6216
SMITH SHELBY C	4209 N 33RD ST PHOENIX AZ 85018
SNOWFLAKE INVESTMENTS LLC	PO BOX 12752 SCOTTSDALE AZ 85267
SNOWFLAKE INVESTMENTS LLC	13325 N 83RD PL SCOTTSDALE AZ 85260
SREIT GRIFFIN SCOTTSDALE LLC	591 W PUTNAM AVE GREENWICH CT 06830
STALWICK HOWIE/JENNIFER	315 W RIVERSIDE STE 301 SPOKANE WA 99201
STEINBICKER SUSAN P	4421 E WILLOW AVE PHOENIX AZ 85032
STOCKERT LAVONNE A	3309 N 70TH ST NO 123 SCOTTSDALE AZ 85251
STORBECK FAMILY TRUST	15536 58TH RD UNION GROVE WI 53182
SUPAI CLOUD LLC	18225 E CLOUD RD GILBERT AZ 85298

SUPPES BRINLEY
SWENSON LEANNE RAE
THOMAS F & DEBORAH L SOUTHGATE TRUST
THOMAS M AND ELIZABETH E PALMER FAMILY TRUST
TONG ROBERT/STELLA S
TOPPS ANDREW L
TRAVIS PALUCK TRUST
UCCELLI ANDREW A/ALI
VANTAGE RETIREMENT PLANS LLC
WANDERSON PROPERTIES LLC
WARRAICH SHERAZ A/SARAH
WEISHAR EVAN
WENDY CASHABACK PLLC
WIDDEN RICHARD J JR
WILLERT KEVIN B
WOLFE CLAYTON B
WRIGHT BRIAN ALLEN
YOUNG ROBERT K
YOUNG TAYLOR C
ZIMA CAPITAL LLC
ZIMBRO NANCY C/WILLIAM J
ZINDA GLADYS H
ZOUKIS JOHN G

6945 E OSBORN RD UNIT D SCOTTSDALE AZ 85251
6990 E 6TH ST UNIT 1016 SCOTTSDALE AZ 85251
6990 E 6TH ST UNIT 1012 SCOTTSDALE AZ 85251
7023 E 4TH ST NO 101 SCOTTSDALE AZ 85251
6990 E 6TH ST UNIT 1008 SCOTTSDALE AZ 85251
3309 N 70TH ST UNIT 115 SCOTTSDALE AZ 85251
8779 E QUARTERHORSE TRL SCOTTSDALE AZ 85258
575 ALAMEDA SAN CARLOS CA 94070-2906
920 E CARVER RD TEMPE AZ 85284
505 S MADISON DR TEMPE AZ 85281
7917 S 28TH WAY PHOENIX AZ 85042
6929 E ORBORN RD UNIT C SCOTTSDALE AZ 85251
6941 E 4TH ST UNIT 10 SCOTTSDALE AZ 85251
6990 E 6TH ST UNIT 1018 SCOTTSDALE AZ 85251
6927 E 5TH ST SCOTTSDALE AZ 85251
6990 E 6TH ST UNIT 1024 SCOTTSDALE AZ 85251
3309 N 70TH ST #118 SCOTTSDALE AZ 85251
3233 N 70TH ST UNIT 1014 SCOTTSDALE AZ 85251
1093 LUND TER SUNNYVALE CA 94089
17012 N 57TH ST SCOTTSDALE AZ 85254
6929 E OSBORN RD NO E SCOTTSDALE AZ 85251
3309 N 70TH STREET # 119 SCOTTSDALE AZ 85251
3309 N 70TH ST #204 SCOTTSDALE AZ 85251

Chi, Andrew

From: Susan Steinbicker <susanaz@rwc.org>
Sent: Tuesday, January 07, 2020 8:24 AM
To: Chi, Andrew
Subject: AGAINST 7034 E OSBORN MURAL (1-DR-2020)

Good morning,

I own a townhouse located at 6925 E. Osborn Road Unit F, Casa Granada Townhomes.

I would like to make my objection of the proposed mural, Pre-Application #: 903-PA-2019 be known.

This is a residential area and I believe this will be a major visual distraction.

Thank you,
Susan Steinbicker
Cell-480-225-0524



Susan Steinbicker
Direct Tile Sales Manager
RWC Building Products
1918 W. Grant Street
Phoenix, AZ 85009
W 602-252-1684, ext 1224
F 602-794-3919

Chi, Andrew

From: Ruenger, Jeffrey
Sent: Monday, January 27, 2020 12:56 PM
To: Chi, Andrew
Subject: 7034 E Osborn Rd - Mural (1-DR-2020)

From: Andrew Mallett <andrewmallett@sbcglobal.net>
Sent: Sunday, January 26, 2020 1:25 PM
To: Projectinput <Projectinput@Scottsdaleaz.gov>
Subject: 7034 E Osborn Rd-Mural

I do not support the painting of a mural at 7034 E Osborn Rd. The painting will open up the door to making Scottsdale a canvass of potentially offensive and disturbing artwork. I understand it starts with oversight and approvals but just like in Atlanta and Sacramento; who now have over 60+ murals, they have turned into disturbing and offensive pieces of art all over the city. The best cities and neighborhoods I have lived in, enforce a policy of "keep your property looking nice" position. Keep areas from looking like a blight and paint it nicely and at least every 15 years and you will have no issues.

Thank you for taking this under consideration.

Andrew Mallett
7024 E 6th Street #104
Scottsdale, AZ 85252
andrewmallett@sbcglobal.net

**Stipulations for the
Development Review Board Application:
7034 E. Osborn Road Mural
Case Number: 1-DR-2020**

These stipulations are intended to protect the public health, safety, welfare, and the City of Scottsdale.

APPLICABLE DOCUMENTS AND PLANS:

Except as required by the Scottsdale Revised Code (SRC), the Design Standards and Policies Manual (DSPM), and the other stipulations herein, the site design and construction shall substantially conform to the following documents:

1. Architectural elements, including dimensions, materials, form, color, and texture shall be constructed to be consistent with the building elevations submitted by Alexandra Wienberg, with a City Staff date of February 25, 2020.

EXTRIOR LIGHTING:

DRB Stipulations

2. No lighting is approved with this mural.

ADDITIONAL ITEMS:

DRB Stipulations

3. The owner or designee shall maintain the mural in good condition, and shall fix or repaint any damage, fading or peeling to the mural.