



Neighborhood Notification

Open House Information

Citizen Comments

Affidavit of Posting

Site Sign

Legal Protest

February 28th, 2020

To: Doris McClay

From: Sandra Price, President, Sands North HOA

Re: Case #ZA-2018-#2, **Open House Report**

The large public sign for the Open House was posted along Scottsdale Road south of the entrance to Sands North on Friday, February 14th, 2020.

The affidavit from Sign-A-Rama was sent to your office.

The Open House neighborhood invitation was mailed by the office of architect Bob Graham on February 14th, 2020. A copy of the notice was sent to your office. Bob mailed the invitation using the list of neighbors in the file your office provided.

The Open House was held on Thursday, February 27th, 2020, from 5:00-^;00 PM, at the Sands North clubhouse. I was in attendance.

There were no neighbors in attendance.

Sands North Historic District Overlay Zoning Citizen Review Open House

You are invited to attend an OPEN HOUSE: To be held at 5 PM Thursday, February 27th, 2020 at the Sands North Clubhouse, 7233 E. Joshua Tree Lane, Scottsdale, Arizona 85250

Applicant/Contact:	Karen Benson	City Contact:	Doris McClay
Phone Number:	(623) 748-7595	Phone Number:	(480) 312-4214
Email Address:	KBenson@Integrityfirstpm.com	Email Address:	dmccclay@scottsdaleaz.gov

Pre-Application # 64 - PA - 2020 **Available at City of Scottsdale:**
480-312-7000

Project information may be researched at:
<https://eservices.scottsdaleaz.gov/bldgresources/PreApp/Search>

APPLICATION TYPE: Rezoning (Historic Preservation Zoning Overlay)

EXISTING ZONING: R-4R **PROPOSED ZONING:** R-4R-HP

PROJECT LOCATION: Sands North Townhouses, 7233 E. Joshua Tree Lane, Scottsdale AZ 85250

SUBJECT PROPERTY/BACKGROUND INFORMATION:

The Sands North Townhouses community was built in 1972 by noted Phoenix builder E. T. Wright. Architecturally and historically, this subdivision is significant as a unique community of mid-century modern townhomes of understated architectural elegance. The Sands North homeowners association desires to preserve the unique architecture and original design elements that contribute to their neighborhood character. Much of the community was rezoned with an historic preservation overlay in 2019. In this current re-zoning, six additional properties will have the historic preservation overlay added.

PROJECT DESCRIPTION:

The rezoning of 6 Sands North townhome properties currently zoned Resort/Townhouse Residential (R-4R) to Resort/Townhouse Residential Historic Property (4R-R HP) on +/- ten acre site located on the east side of N. Scottsdale Road approx 660 feet south of the intersection of E. Indian Bend and N. Scottsdale Road.

PROJECT LOCATION MAP:

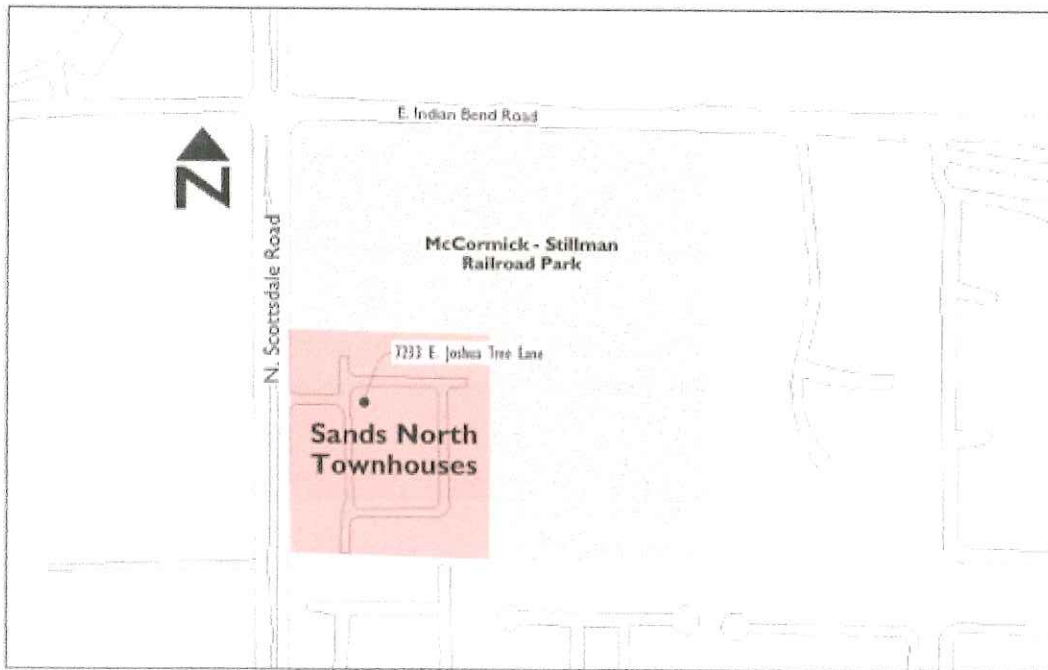

FOOD FROM PAGE 25

option of delivery.

Because third-party delivery services, like Postmates, Grubhub and Uber Eats, don't deliver alcohol, customers must pick up their alcohol orders in person.

These third-party delivery services also charge the restaurants up to 30 percent commission per order.

With the federal relief funding they received the week of April 6, Stark said they will not just use that loan to hire the rest of their staff back.

They also hope to launch their own delivery service of both alcohol and food to those customers uncomfortable or unable to leave their home.

"We think that we can better ensure the quality of the product if we're delivering it, as opposed to a third party," Stark said. "We're going to treat everything like we're delivering food: Hot food's going to go out hot; cold food's going to go out cold. The same is true of alcohol, and we're going to ensure that it gets delivered quickly."

In addition to offering special takeout deals for their customers, both PHX Beer Co. and Sorso Wine Room have also given back to the community in other ways.

Sorso Wine Room started selling grocery kits for those who want to avoid busy grocery stores.

Teahen said that over the last three weeks, they've sold close to 300 kits priced at \$75 each.

"Our guests have been really supportive of the kits and also very generous with their tips which is helping us support our staff," he said.

Sorso has since shifted from selling kits to selling grocery items a la carte on their website.

Grocery items include a variety of fruits, vegetables, bread, poultry, sliced meats, dairy products, and spreads and dips.

"People have been so grateful that we are able to offer them fresh goods that are delivered right to their cars," Teahen said.

Teahen added: "In a time of such uncertainty, it's been really nice to see our community rally around us and do all they can to support the business and our staff."

"We've been able to connect with guests on levels we never imagined possible. With this being such a scary time, people are providing a sense of comfort and community – and that's a great feeling."

Information: phxbeerco.com, sorsowinerom.com. 🍷

Life Events

Obituaries

John Bittner

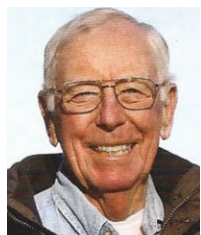

John Bittner passed away in his home in Prescott, AZ on April 6 at the age of 79. John Frances Bittner was born in Rochester, NY on December 21, 1940 to Helen Welch Bittner and John Bittner. He attended primary school and high school in Rochester (where he rode the same bus as his future wife) and attended Ricker College in Houlton, Maine. He married Joyce Smith Bittner in 1965 and after their children, Craig, Danielle, Erin and Sean were born, John and Joyce made the pilgrimage to Scottsdale, where they would begin a wonderful life and story in the great state of Arizona.

John worked for McCulloch Properties in Fountain Hills in the early 1970's, and then was an executive for Sun Valley Waterbeds for the better part of two decades. He "retired" early, but was active in Joyce's Arizona Insights company, consulting for companies, and busy with a real estate license and business. His life's calling would come to fruition in the town of Strawberry, where he and Joyce bought property, built a home, and a farm with llamas and milk goats. The Ranch at Fossil Creek and Fossil Creek Creamery would become an outstanding fixture in Rim Country over the course of 20 years. People from literally all over the world experienced John's beloved goats (all with special names), his kindness in teaching and connecting children to nature and farm culture, and his prowess in creating delicious cheeses and fudge. He supported Rim Country causes, employed many local students and residents, and touched the lives of many more. He was always willing to stop what he was doing to share the significance of farmwork, the animals, and the quality of his craft.

John was sensitive and loving. Honest and kind. He was present, and involved, a positive force who always looked at the bright side. And though he left way too soon, while he was with us, he devoted his life to his family. He is survived by his wife Joyce; his son Craig and wife Kristi and twin grandchildren Parker and Jordyn (age 19) in Santa Barbara, CA; his daughter Danielle and husband Barry and children Jeremy (age 18) and Madison (age 14) in Pleasanton, CA; his son Erin and wife Cherryl and children Jack (age 15), Kate (age 13), and Ethan (age 12) in Frisco, TX; and his son Sean and wife Jennifer and children Adam (age 16), Brianna (age 13), and Luke (age 12) in Dana Point, CA. He is also survived by many nieces and nephews, and his two brothers Joseph and George in upstate NY, and their families. He was preceded in death by his younger sister, Mary. He loved his big family.

The family kindly requests no flowers, cards are welcome. The Juvenile Diabetes Research Foundation was near and dear to John's heart since his grandson Jeremy was diagnosed as a 13 year old. Memorial donations can be made at JDRF.org/donate. A memorial service is planned for a future date, yet to be determined.

Public Notices



NOTICE OF HISTORIC PRESERVATION COMMISSION HEARING

NOTICE IS HEREBY GIVEN that the Historic Preservation Commission of the City of Scottsdale, Arizona, will hold a public hearing on May 7, 2020, at 6:00 P.M. in Scottsdale, Arizona: Until further notice, Historic Preservation Commission meetings will be held electronically. While physical facilities are not open to the public. Historic Preservation meetings are televised on Cox Cable Channel 11 and streamed online at ScottsdaleAZ.gov (search "live stream") to allow the public to listen/view the meeting in progress.

Only written comments submitted electronically at least one hour prior to the meeting are being accepted. A written Public Comment may be submitted electronically to HistoricPreservationCommission@ScottsdaleAZ.gov.

9-ZN-2018#2 (Sands North Historic District Phase 2) Request by owner for a Zoning District Map Amendment from Resort/Townhouse Residential (R-4R) to Resort/Townhouse Residential Historic Property (R-4R HP) zoning on four (4) properties located at 6850 N 72nd Place (174-19-014), 7238 E Joshua Tree Lane (174-19-011), 7241 E Joshua Tree Lane (174-19-045) and 6824 N. 73rd Street (174-19-047) totaling +/- .6 acre in the Sands North Townhouse subdivision located on the east side of N. Scottsdale Road approximately 660 feet south of the intersection of E. Indian Bend Road and N. Scottsdale Road. Staff contact person is Doris McClay, 480-312-4214. Applicant contact person is Sandra Price, (480) 262-3039.

For additional information visit our web site at www.scottsdaleaz.gov search "Scottsdale Planning Case Files" or in your URL search bar you can type in <https://eservices.scottsdaleaz.gov/bldgresources/Cases/>.

A COPY OF A FULL AGENDA, INCLUDING ITEMS CONTINUED FROM PREVIOUS MEETINGS IS AVAILABLE AT LEAST 24 HOURS PRIOR TO THE MEETING AT THE FOLLOWING

Online at: <https://www.scottsdaleaz.gov/boards/historic-preservation-commission>

ALL INTERESTED PARTIES ARE INVITED TO LISTEN/VIEW THIS MEETING.

CHAIRMAN

Attest

Karen Hemby

For additional information visit our web site at www.scottsdaleaz.gov



Persons with a disability may request a reasonable accommodation such as a sign language interpreter, by contacting Staff at 480-312-7767. Requests should be made as early as possible to allow time to arrange accommodations. For TTY users, the Arizona relay service (1-800-367-8939) may contact Staff at 480-312-7767.

Published: Scottsdale Progress, Apr 19, 2020 / 30115

Need help writing an obituary?

We have articles that will help guide you through the process.

Deadline for obituaries is Wednesday at 5pm for Sunday.
All obituaries will be approved by our staff prior to being activated. Be aware there may be early deadlines around holidays.

Call 480-898-6465 Mon-Fri 8:30-5
if you have questions.

Visit: obituaries.EastValleyTribune.com



SCOTTSDALE
PROGRESS

LEGAL NOTICES

Deadline for Sunday's
Edition is the Wednesday prior at 5pm.

Please call Elaine at 480-898-7926 to inquire or email your notice to: legals@evtrib.com and request a quote.

Name

SANDRA D MILLS LIVING TRUST
GRUNTLER AUDREY R
LINEHAN JOHN H/JULIE A TR
MARGO S POPOVICH INDIVIDUAL PROPERTY TRUST
HELEN JANE MORRISON TRUST
PHYLLIS H WINTER TRUST
FALCONE SONIA M
ROE TIMOTHY M
SAVAGE FAMILY PARTNERSHIP LTD/SAVAGE JACK W
SAVAGE FAMILY PARTNERSHIP LTD/SAVAGE JACK W
WHITESTONE SEVILLE LLC
CACTUS RUN LLC
LEVY LINCOLN PLACE LLC
SANDQUIST PAUL R TR/SANDQUIST KATHLEEN M TR
SHOTEY MARCUS
LINCOLN PLACE COMMUNITY ASSOCIATION
SANDS NORTH TOWNHOUSES
HRA LINCOLN SCOTTSDALE LP
CUCCURULLO REVOCABLE LIVING TRUST
CLS TRUST
CASABELLA ASSOCIATION
NARNIA II LLC
BRIAN A WEINBERGER LIVING TRUST
SANDERS FAMILY REVOCABLE TRUST
PARKER SURVIVORS TRUST
FORD MICHAEL/MARSHA K TR
JJG TRUST
CALAMITO LUCETTE G
WIDNEY JONATHAN G/WOLFE CYNTHIA J
BROWN SHERRIL S
M T OFFICE BUILDINGS LLC
CYNTHIA E GIBSON TRUST
TAYLOR CALEB
SIEVERS AMANDA/LINGER ALEXA
KEILTY THOMAS
DOVE DAVID R TR
TEHRANI LEILA K
MANN KENNETH L/JANET H
KATZ NATALIE/LAWRENCE E TR
LINCOLN PLACE COMMUNITY ASSOCIATION
PATRICIA Y HACK REVOCABLE TRUST
MARSH REVOCABLE TRUST
TIBSHRAENY FAMILY TRUST
DODDS GIANNA TR
MURPHY EDWARD G/ELIZABETH B
WOLFF JUDITH JOY TR

KOE BETTY
SCHUKERT WILLIAM/WOODARD WENDY S
8800 FAMILY TRUST
PAMELA J SHIPP LIVING TRUST
NIELSON DONALD L/VINI E TR
MOWRY DEAN/NANCY
RICHARD C STRAND REVOCABLE TRUST/STRAND NAOMI
IBRAHIM WILLIAM/CARIE
BISSELL CAROLINE VIRGINIA TR
NASHIF DOUGLAS M/DIANA/DOUGLAS M/DIANE S
6617 INVESTORS LLC
LINCOLN SCOTTSDALE BUILDING LLC
SGH TRUST
PRICE SANDRA
NORRIS DEBORAH KOBE
SANTUCCI FAMILY REVOCABLE TRUST
RANUCCI ROBERT J
KALISH KRISTA
JONES FAMILY REVOCABLE TRUST
DONAHUE GREGORY S/LYNN S
MCMILLEN RONALD J/KERNS REBECCA J
SURVIVOR TRUST UNDER THE HESS REVOCABLE TRUST
JL FAMILY TRUST
JUDITH B ROSS REVOCABLE TRUST
SONDRA C WEISS REVOCABLE TRUST
VON HELLENS SUSAN TR
KHAMOOSHIPOUR FARZAD
SMF REVOCABLE TRUST
BOWER LEONARD G/MARCIA
WALKER HOMESTEAD LLC
KAUP HOLDING TRUST
BUTLER BLAKE/ROCITSA
SIMMONS FAMILY TRUST
MICHAEL AND KATHLEEN DEGROFF FAMILY TRUST
PNEUM INVESTMENTS LLC
OCONNOR SALLY ANN
JANE BARTON REVOCABLE TRUST
DKM REVOCABLE TRUST
SO MABEL/RONALD
RIVIERE M ELLIOT/MARGARET W
KUWAHARA RENEE F
ELAINE A ROSENTHAL FAMILY LIVING TRUST
WESTBROOK STEPHANIE
STALEY LARRY P/THERESA K
FIREMAN JILL
OMEARA FAMILY TRUST
DELANA JEAN LEWIS REVOCABLE TRUST

KOGI HAUSER TRUST
STAEHLE VIRGINIA C/ATKINS SHARON S TR
WESTREICH DOROTHY
MCLEES ROBERT E/NANCY R
TIM AND LORI WALKER REVOCABLE TRUST
MARK AND GLORIA CHANEY JOINT LIVING TRUST
GREENBERG KAREN M
ASCHERL GEORGE F JR/GEORGE F III
SALAH MOUSA/RHONDA
HILER ROBERT J/TAMARA S
HASHEMI KAMRAN
WHEELER MARGARET J
CATHERINE P JACKSON TRUST
CHRISTINE H SODERQUIST LIVING TRUST
KHAMOOSHI FARZAD
HOULE LIVING TRUST
HALL CHARLES W III
RIDDELL JOHN CAMERON/WENDY RECTOR
BARR ALBERT
SIDLES FAMILY REVOCABLE TRUST
WEST ROBIN J
AF AND JC TRUST
DOUGLAS ALAN COLE TRUST
BARKER CURTISS F II/SUSAN C TR
KAREN MARIE LIERSCH LIVING TRUST
FAUSTER III FAMILY TRUST
SEXTON JAMES F/PAULA M
RAUPP-SMITH FAMILY REVOCABLE TRUST
MARSHALL BETTY F/EDWARD A III TR
SCOTTSDALE CITY OF
BRODKIN TERRY B
MARTIN DANA
VERNON RICHARD W TR
SCOTTSDALE SPECTRUM LLC
HILL WALTER PAUL & SHIRLEY J
WILLIAMS JEANNE
AZADEH HAFEZ
ERIVIN BARBARA C TR
SUNLIGHT PROPERTIES LLC
FIVE STAR LAND OWNER LLC
GIGLIO GARY/PATRICIA
SYLVIA F LITTLE LIVING TRUST
DEVRIES CHRISTOPHER JOHN/JAMIE C DONNELL TR
MARTIN DANA
6701 SCOTTSDALE LLC
MELA LLC
BRUNACINI JEANNETTE L TR

SANDS RESIDENTIAL LLC
RISI JOSEPH S/HELENA
FUREY JAMES H/VICKI H
LYKOURGOS 3 LLC
SPRANDO PATRICIA L
BEAMER RICHARD S/PATRICIA A
TAYLOR DONALD/SUSAN
DICIANO JULIEN D
VIENNA TONI
HAZZI ADRIAN J
SANDRA PRICE HOA PRESIDENT
Ali Fakih
Annette Petrillo
Audry Villaverde
Bob Griffith
Carla
Chris Schaffner
Christian C. Serena
Community Development Director
Constance Laub
Dan Sommer
David G. Gulino
Solange Whitehead
Dr. Sonnie Kirtley
Ed Toschik, President
Edwin Bull
Eric Gold
Guy Phillips
Guy Phillips
Howard Myers
Jim Funk
Jim Haxby
John Berry/Michele Hammond
John Washington
Kathy Littlefield
Kevin D. Bollinger
Kirste Kowalsky
Larry S. Kush
Leon Spiro
Linda Milhaven
Linda Whitehead
Lori Haye
Maricopa County Superintendent of Schools
Michael Leary
Mike McNeal, Supervisor

Mike Ratzken
Patti Badenoch
Paul Alessio - Chair
Planning & Development Department
Planning & Development Director
Planning & Engineering Section Manager
Planning and Zoning
Planning Department
Planning Department
Prescott Smith
Project Management
Randall P. Brown
Marissa Moore, AICP
Sherry Wagner/Right-of-Way Technician, SR.
Steve Tyrrell
Superintendent
Superintendent
Susan McGarry
Suzanne Klapp
Vickie Falen
Virginia Korte
W.J. Jim Lane - Mayor
Wade Tinant

Maggie Keasler
Renee J. Higgs
Susan Kauffman
Patricia Van Cleave
Andrea Keck
Steve Perone
Kurt Jones

COMPANY

City of Scottsdale Planning Commission
--

Withey Morris, PLC

City of Scottsdale Planning Commission
--

Town of Paradise Valley

City of Scottsdale City Council

COGS

Burch & Cracchiolo PA

City of Scottsdale City Council

--

Gainey Ranch Community Association

Berry Riddell, LLC
City of Scottsdale City Council

City of Scottsdale Planning Commission
Withey Morris, PLC

City of Scottsdale Planning Commission

City of Scottsdale City Council

Commercial Land Development Consulting
AT&T

City of Scottsdale Planning Commission
Maricopa County Planning & Development
City of Phoenix
Arizona State Land Department
Town of Carefree
Town of Cave Creek
SRP-MIC
City of Scottsdale Planning Commission
Arizona Department of Transportation
Spring Creek Development
Town of Fountain Hills
Mail Station PAB348

Cave Creek Unified School District
Scottsdale Unified School District

City of Scottsdale City Council

City of Scottsdale City Council
City of Scottsdale City Council

Granite Reef Neighborhood Resource Center
Gammage & Burnham, PLC
Southwest Gas Corporation

Withey Morris, PLC
Paradise Valley Unified School District
Earl, Curley & Lagarde, P.C.
Arizona Commerce Authority

City of Scottsdale Planning Commission
--

Tiffany & Bosco P.A.

Address	City	State	Zip	COUNTRY
13661 MARSH HARBOR DR N	JACKSONVILLE	FL	32225	
8648 CRICKET TREE LN	INDIANAPOLIS	IN	46260	
10243 N WESTPORT CIR	MEQUON	WI	53092	
6386 SPRUCE MEADOWS LN	LAND O LAKES	WI	54540	
809 SUNSET PL	MORRIS	MN	56267-1726	
30 TAMARISK LANE	DEERFIELD	IL	60015	
120 N LASALLE ST 38TH FL	CHICAGO	IL	60602	
2308 RIVERSIDE DR	GRAND ISLAND	NE	68801	
4037 COTSWOLD CT	DALLAS	TX	75220	
4037 COTSWOLD CT	DALLAS	TX	75220	
2600 S GESSNER RD SUITE 500	HOUSTON	TX	77063	
5500 S FRANKLIN ST	GREENWOOD VILLAGE	CO	80121-1319	
8562 E ILIFF DR	DENVER	CO	80231	
3263 ELK VIEW DR	EVERGREEN	CO	80439	
1006 W ADAMS ST	PHOENIX	AZ	85007	
532 E MARYLAND AVE #F	PHOENIX	AZ	85012	
1450 E INDIAN SCHOOL RD STE C	PHOENIX	AZ	85014-0000	
2999 N 44TH ST STE 400	PHOENIX	AZ	85018	
3219 E CAMELBACK RD SUITE 501	PHOENIX	AZ	85018	
PO BOX 45515	PHOENIX	AZ	85064-5515	
7255 E HAMPTON AVE STE 101	MESA	AZ	85209	
6621 N SCOTTSDALE RD	SCOTTSDALE	AZ	85250	
7249 E JOSHUA TREE LN	SCOTTSDALE	AZ	85250	
7328 E TUCKEY LN	SCOTTSDALE	AZ	85250	
7322 E TUCKEY LANE	SCOTTSDALE	AZ	85250	
7334 E KRALL ST	SCOTTSDALE	AZ	85250	
7315 E KRALL ST	SCOTTSDALE	AZ	85250	
6829 N 72ND PL	SCOTTSDALE	AZ	85250	
7321 E TUCKEY LN	SCOTTSDALE	AZ	85250	
7245 E JOSHUA TREE LN	SCOTTSDALE	AZ	85250	
6623 N SCOTTSDALE RD	SCOTTSDALE	AZ	85250	
6835 N 73RD ST	SCOTTSDALE	AZ	85250	
6802 N 72ND PL	SCOTTSDALE	AZ	85250	
7310 E JOSHUA TREE LN	SCOTTSDALE	AZ	85250	
6831 N 73RD ST	SCOTTSDALE	AZ	85250	
6815 N 73RD ST	SCOTTSDALE	AZ	85250	
6820 N 73RD ST	SCOTTSDALE	AZ	85250	
6822 N 72ND PL	SCOTTSDALE	AZ	85250	
6828 N 73RD ST	SCOTTSDALE	AZ	85250	
7904 E CHAPARRAL RD STE S110 #214	SCOTTSDALE	AZ	85250	
7370 E KRALL ST	SCOTTSDALE	AZ	85250	
7316 E MCLELLAN BLVD	SCOTTSDALE	AZ	85250	
7315 E MCLELLAN BLVD	SCOTTSDALE	AZ	85250	
6701 N SCOTTSDALE RD #13	SCOTTSDALE	AZ	85250	
7322 E MCLELLAN BLVD	SCOTTSDALE	AZ	85250	
6701 N SCOTTDALE RD NO 37	SCOTTSDALE	AZ	85250	

6701 N SCOTTSDALE RD UNIT 29	SCOTTSDALE	AZ	85250
6806 N ROCKING ROAD	SCOTTSDALE	AZ	85250
7334 E TUCKEY LN	SCOTTSDALE	AZ	85250
7370 E TUCKEY LN	SCOTTSDALE	AZ	85250
7235 E CACTUS WREN RD	SCOTTSDALE	AZ	85250
6812 N 73RD ST	SCOTTSDALE	AZ	85250
7358 E MCLELLAN BLVD	SCOTTSDALE	AZ	85250
6823 N 73RD ST	SCOTTSDALE	AZ	85250
7231 E CACTUS WREN RD	SCOTTSDALE	AZ	85250
6825 NORTH 72ND PLACE	SCOTTSDALE	AZ	85250
6617 N SCOTTSDALE RD STE 1-1	SCOTTSDALE	AZ	85250
6607 N SCOTTSDALE RD STE H100	SCOTTSDALE	AZ	85250
7322 E KRALL	SCOTTSDALE	AZ	85250
7250 E JOSHUA TREE LN	SCOTTSDALE	AZ	85250
7456 E MCLELLAN LN	SCOTTSDALE	AZ	85250
6701 N SCOTTSDALE RD LOT 26	SCOTTSDALE	AZ	85250
6701 N SCOTTSDALE RD 39	SCOTTSDALE	AZ	85250
6701 N SCOTTSDALE RD 35	SCOTTSDALE	AZ	85250
6701 N SCOTTSDALE RD NO 20	SCOTTSDALE	AZ	85250
7364 E KRALL ST	SCOTTSDALE	AZ	85250
7316 E KRALL ST	SCOTTSDALE	AZ	85250
7346 E KRALL ST	SCOTTSDALE	AZ	85250
7358 E KRALL ST	SCOTTSDALE	AZ	85250
7369 E KRALL	SCOTTSDALE	AZ	85250
7316 E TUCKEY LN	SCOTTSDALE	AZ	85250
7358 E TUCKEY LN	SCOTTSDALE	AZ	85250
6830 N 72ND PL	SCOTTSDALE	AZ	85250
6701 N SCOTTSDALE RD NO 40	SCOTTSDALE	AZ	85250
7414 E CACTUS WREN RD	SCOTTSDALE	AZ	85250
7364 E TUCKEY LN	SCOTTSDALE	AZ	85250
7357 E KRALL ST	SCOTTSDALE	AZ	85250
6846 N 72ND PL	SCOTTSDALE	AZ	85250
6701 N SCOTTSDALE RD UNIT 5	SCOTTSDALE	AZ	85250
6701 N SCOTTSDALE RD LOT 28	SCOTTSDALE	AZ	85250
6619 N SCOTTSDALE RD	SCOTTSDALE	AZ	85250
7328 E MCLELLAN BLVD	SCOTTSDALE	AZ	85250
7333 E KRALL ST	SCOTTSDALE	AZ	85250
7327 E KRALL ST	SCOTTSDALE	AZ	85250
6701 N SCOTTSDALE RD NO 25	SCOTTSDALE	AZ	85250
6701 N SCOTTSDALE ROAD	SCOTTSDALE	AZ	85250
7305 E CACTUS WREN ROAD	SCOTTSDALE	AZ	85250
6839 N 73RD ST	SCOTTSDALE	AZ	85250
6850 N 72ND PL	SCOTTSDALE	AZ	85250
7411 E CACTUS WREN RD	SCOTTSDALE	AZ	85250
7369 E TUCKEY LN	SCOTTSDALE	AZ	85250
6701 N SCOTTSDALE RD UNIT 3	SCOTTSDALE	AZ	85250
6701 N SCOTTSDALE RD NO 24	SCOTTSDALE	AZ	85250

6701 N SCOTTSDALE RD UNIT 19	SCOTTSDALE	AZ	85250
7230 E JOSHUA TREE	SCOTTSDALE	AZ	85250
6701 N SCOTTSDALE RD UNIT 27	SCOTTSDALE	AZ	85250
6701 N SCOTTSDALE RD - LOT 12	SCOTTSDALE	AZ	85250
7420 E TUCKEY LN	SCOTTSDALE	AZ	85250
6701 E SCOTTSDALE RD LOT 38	SCOTTSDALE	AZ	85250
7351 E TUCKEY LN	SCOTTSDALE	AZ	85250
7238 E JOSHUA TREE LN	SCOTTSDALE	AZ	85250
6726 N ROCKING RD	SCOTTSDALE	AZ	85250
6701 N SCOTTSDALE RD UNIT 30	SCOTTSDALE	AZ	85250
6701 N SCOTTSDALE RD LOT 7	SCOTTSDALE	AZ	85250
6811 N 73RD ST	SCOTTSDALE	AZ	85250
7352 E MCLELLAN BLVD	SCOTTSDALE	AZ	85250
7302 E JOSHUA TREE LN	SCOTTSDALE	AZ	85250
6826 N 72ND PL	SCOTTSDALE	AZ	85250
7352 E TUCKEY LN	SCOTTSDALE	AZ	85250
7241 E JOSHUA TREE LN	SCOTTSDALE	AZ	85250
3712 N ROCKING RD	SCOTTSDALE	AZ	85250
7321 E KRALL ST	SCOTTSDALE	AZ	85250
7363 E KRALL ST	SCOTTSDALE	AZ	85250
6701 N SCOTTSDALE RD NO 8	SCOTTSDALE	AZ	85250
6701 N SCOTTSDALE RD NO 15	SCOTTSDALE	AZ	85250
6929 N HAYDEN RD SUITE C4-508	SCOTTSDALE	AZ	85250
6701 N SCOTTSDALE RD NO 16	SCOTTSDALE	AZ	85250
6701 N SCOTTSDALE RD UNIT 11	SCOTTSDALE	AZ	85250
6701 N SCOTTSDALE RD LOT 9	SCOTTSDALE	AZ	85250-4403
6701 N SCOTTSDALE RD LOT 32	SCOTTSDALE	AZ	85250-4405
7251 E CACTUS WREN RD	SCOTTSDALE	AZ	85250-4507
7352 E KRALL ST	SCOTTSDALE	AZ	85250-4518
7447 E INDIAN SCHOOL RD STE 205	SCOTTSDALE	AZ	85251
7320 E SHOEMAN LN	SCOTTSDALE	AZ	85251
6901 E 1ST ST APT 1007	SCOTTSDALE	AZ	85251-5360
6821 N 72ND PL	SCOTTSDALE	AZ	85253
6730 N SCOTTSDALE RD	SCOTTSDALE	AZ	85253
6827 N 73RD ST	SCOTTSDALE	AZ	85253
6810 N 72ND PL	SCOTTSDALE	AZ	85253
9116 N FOOTHILLS MANOR DR	PARADISE VALLEY	AZ	85253
6701 N SCOTTSDALE RD 14	SCOTTSDALE	AZ	85253
6319 N MOCKINGBIRD LN	PARADISE VALLEY	AZ	85253
6720 N SCOTTSDALE RD STE 130	SCOTTSDALE	AZ	85253
6701 N SCOTTSDALE ROAD 21	SCOTTSDALE	AZ	85253-0000
10632 N SCOTTSDALE RD STE B-195	SCOTTSDALE	AZ	85254
6501 E GREENWAY PKWY SUITE 103 PMB 218	SCOTTSDALE	AZ	85254-2070
7710 E GAINNEY RAND RD UNIT 131	SCOTTSDALE	AZ	85258
27757 N 67TH WAY	SCOTTSDALE	AZ	85266
11885 N SUNSET VISTA DR	FOUNTAIN HILLS	AZ	85268
1261 BONA TERRA LOOP NW	ALBUQUERQUE	NM	87114-1984

8605 SANTA MONICA BLVD SUITE 7838	LOS ANGELES	CA	90069	
PO BOX 8653	NEWPORT BEACH	CA	92658	
1221 SANTA BARBARA DR	NEWPORT BEACH	CA	92660-6371	
20731 ST CHARLES ST	SARATOGA	CA	95070	
7257 SW ETON CT	PORTLAND	OR	97225	
4821 LAKE WASHINGTON BLVD S	SEATTLE	WA	98118-1550	
PO BOX 2740	CHELAN	WA	98816	
101-200 RONSON DR	ETOBICOKE	ON	M9W 5Z9	CANADA
UNIT 403 318-26TH AVE SW	CALGARY	AB	T2S2T9	CANADA
1133 PARKLOSS LN	BRITISH COLUMBIA	BC	V1V 2Y3	CANADA
7233 E. Joshua Tree Lane	SCOTTSDALE	AZ	85250	
8280 E. Gelding Drive, Suite 101	Scottsdale	AZ	85260	
1169 E. Clovefield Street	Gilbert	AZ	85298	
2525 E. Arizona Biltmore Circle; Suite A-212	Phoenix	AZ	85016	
7127 E. Rancho Vista Dr. #4002	Scottsdale	AZ	85251	
3420 N. 78th Street	Scottsdale	AZ	85251	
7346 E. Sunnyside Dr.	Scottsdale	AZ	85260	
6929 North Hayden Road, Ste. C4194	Scottsdale	AZ	85250	
6401 E Lincoln Drive	Paradise Valley	AZ	85253	
10105 E. Via Linda Suite 345	Scottsdale	AZ	85258	
12005 N 84th Street	Scottsdale	AZ	85260	
5235 N. Woodmere Fairway	Scottsdale	AZ	85250	
3939 N. Drinkwater Blvd.	Scottsdale	AZ	85251	
8507 East Highland Avenue	Scottsdale	AZ	85251-1822	
7657 E Mariposa Grande Dr	Scottsdale	AZ	85255	
P.O. Box 16882	Phoenix	AZ	85011	
25499 N. 104th Way	Scottsdale	AZ	85255	
7131 E. Cholla St.	Scottsdale	AZ	85254	
3939 N. Drinkwater Blvd.	Scottsdale	AZ	85251	
6631 E Horned Owl Trail	Scottsdale	AZ	85266	
7720 Gainey Ranch Road	Scottsdale	AZ	85258	
7336 E. Sunnyside Dr.	Scottsdale	AZ	85260	
6750 E Camelback Rd, Ste 100	Scottsdale	AZ	85251	
3518 N. Chambers Court	Scottsdale	AZ	85251	
3939 N. Drinkwater Blvd.	Scottsdale	AZ	85251	
8031 E. Sutton Drive	Scottsdale	AZ	85260	
2525 E. Arizona Biltmore Circle, Suite A-212	Phoenix	AZ	85016	
7127 E. Rancho Vista Dr. #1001	Scottsdale	AZ	85251	
7814 E Oberlin Way	Scottsdale	AZ	85266	
3939 N. Drinkwater Blvd.	Scottsdale	AZ	85251	
9681 E Chuckwagon Lane	Scottsdale	AZ	85262	
P.O. Box 426	Cave Creek	AZ	85327	
4041 N. Central Avenue Suite 1200	Phoenix	AZ	85012	
10278 East Hillery Drive	Scottsdale	AZ	85255	
1231 W. University Drive	Mesa	AZ	85201	

8725 E. Palo Verde Dr	Scottsdale	AZ	85250
5027 N. 71st Pl	Scottsdale	AZ	85253
7527 E. Tailspin Lane	Scottsdale	AZ	85255
501 N. 44th Street, Suite 200	Phoenix	AZ	85008
200 West Washington Street, 2nd Floor	Phoenix	AZ	85003
1616 W. Adams Street	Phoenix	AZ	85007
8 Sundial Circle P.O. Box 740	Carefree	AZ	85377
37622 N Cave Creek Road	Cave Creek	AZ	85331
10005 E Osborn Road	Scottsdale	AZ	85256
4350 E. Camelback Rd., Suite G-200	Phoenix	AZ	85018
205 S. 17th Avenue MD 6012E	Phoenix	AZ	85007
7144 E. Stetson Dr. #425	Scottsdale	AZ	85251
16705 E. Avenue of the Fountains	Fountain Hills	AZ	85268
P.O. Box 52025	Phoenix	AZ	85072-2025
7753 E. Catalina Drive	Scottsdale	AZ	85251
P.O. Box 426	Cave Creek	AZ	85327
8500 E. Jackrabbit Rd	Scottsdale	AZ	85250
8074 E. Theresa Drive	Scottsdale	AZ	85255
3939 N. Drinkwater Blvd.	Scottsdale	AZ	85251
10520 N 117th Pl	Scottsdale	AZ	85259
3939 N. Drinkwater Blvd.	Scottsdale	AZ	85251
3939 N. Drinkwater Blvd.	Scottsdale	AZ	85251
4614 E. Running Deer Trail	Cave Creek	AZ	85331
1700 N Granite Reef Road	Scottsdale	AZ	85257
2 N. Central Avenue, 15th Floor	Phoenix	AZ	85004
2200 N. Central Avenue Ste 101	Phoenix	AZ	85004
2525 E. Arizona Biltmore Circle; Suite A-212	Phoenix	AZ	85016
15002 N. 32nd Street	Phoenix	AZ	85032
3101 N. Central Avenue, Ste. 1000	Phoenix	AZ	85012
333 N. Central Avenue, Suite 1900	Phoenix	AZ	85004
7127 E. 6th Ave.	Scottsdale	AZ	85251
15192 N. 104th Way	Scottsdale	AZ	85255
11334 E. Desert Vista Rd.	Scottsdale	AZ	85255
11378 E. Cavedale Drive	Scottsdale	AZ	85262
9719 E. West View Drive	Scottsdale	AZ	85255
7474 E. Earll Dr. #108	Scottsdale	AZ	85251
2525 E. Camelback Road	Phoenix	AZ	85016



Affidavit of Posting

Office of the City Clerk

STATE OF ARIZONA)
)
COUNTY OF MARICOPA)

ss

I, Karen Hemby, being first duly sworn, depose and say:

That on April 20, 2020, I posted notification poster(s) for the properties indicated below.

Site(s) must be posted on or before: April 22, 2020

Case No.	Description and Location of Project	No. of Signs	Date Posted
9-ZN-2018#2	Sands North Historic District Phase 2, 7233 E Joshua Tree Ln	1	4/20/20

Date of Historic Preservation Commission Public Meeting: May 7, 2020, AT 6:00 P.M. Meeting to be held remote electronically.

(Signature)

Acknowledged this 22nd day of April, 2020.

Lorraine Castro
(Notary Public)

My commission expires 11/15/2020

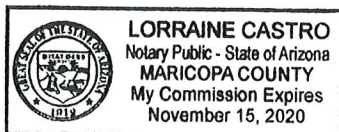

Planning and Development Services

7447 E. Indian School Road, Suite 105, Scottsdale, AZ 85251 ♦ Phone: 480-312-7000 ♦ Fax: 480-312-7088



Affidavit of Posting

Office of the City Clerk

STATE OF ARIZONA)
)
COUNTY OF MARICOPA) SS

I, Karen Hemby, being first duly sworn, depose and say:

That on March 16, 2020, I posted notification poster(s) for the properties indicated below.

Site(s) must be posted on or before: March 18, 2020

Case No.	Description and Location of Project	No. of Signs	Date Posted
59-HP-2019	Coronado Remodel, 6708 E Coronado Rd	1	3/16/2020
9-ZN-2018#2	Sands North Historic District Phase 2, 7233 E Joshua Tree Ln	1	3/16/2020

Date of Historic Preservation Commission Public Meeting: APRIL 2, 2020, AT 6:00 P.M. AT CITY HALL KIVA, 3939 N. DRINKWATER BLVD., SCOTTSDALE, AZ

Karen Hemby
(Signature)

Acknowledged this 16th day of MARCH, 2020.

Lorraine Castro
(Notary Public)

My commission expires 11/15/2020

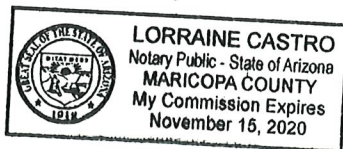

Planning and Development Services

7447 E. Indian School Road, Suite 105, Scottsdale, AZ 85251 ♦ Phone: 480-312-7000 ♦ Fax: 480-312-7088



Affidavit of Posting

Office of the City Clerk

STATE OF ARIZONA)
)
COUNTY OF MARICOPA)

SS

I, Karen Hemby, being first duly sworn, depose and say:

That on March 23, 2020, I posted notification poster(s) for the properties indicated below.

Site(s) must be posted on or before: April 22, 2020

Case No.	Description and Location of Project	No. of Signs	Date Posted
9-ZN-2018#2	Sands North Historic District Phase 2, 7233 E Joshua Tree Ln	1	3/23/20

Date of Historic Preservation Commission Public Meeting: May 7, 2020, AT 6:00 P.M. CITY HALL KIVA AT 3939 N DRINKWATER BOULEVARD SCOTTSDALE, ARIZONA.

Karen Hemby

(Signature)

Acknowledged this 24 day of March 2020.

Melissa Berry

(Notary Public)

My commission expires

11-11-23



Planning and Development Services

7447 E. Indian School Road, Suite 105, Scottsdale, AZ 85251 ♦ Phone: 480-312-7000 ♦ Fax: 480-312-7088



Affidavit of Posting

Office of the City Clerk

STATE OF ARIZONA)
)
COUNTY OF MARICOPA) ss

I, Karen Hemby, being first duly sworn, depose and say:

That on April 20, 2020, I posted notification poster(s) for the properties indicated below.

Site(s) must be posted on or before: April 28, 2020

Case No.	Description and Location of Project	No. of Signs	Date Posted
9-ZN-2018#2	Sands North Historic District Phase 2, 7233 E Joshua Tree Ln	1	4/20/20

Date of Planning Commission Public Meeting: May 13, 2020, AT 5:00 P.M. Meeting to be held remote electronically.

Karen Hemby
(Signature)

Acknowledged this 22nd day of April 2020.
Lorraine Castro
(Notary Public)
My commission expires 11/15/2020

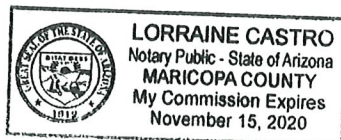

Planning and Development Services

7447 E. Indian School Road, Suite 105, Scottsdale, AZ 85251 ♦ Phone: 480-312-7000 ♦ Fax: 480-312-7088

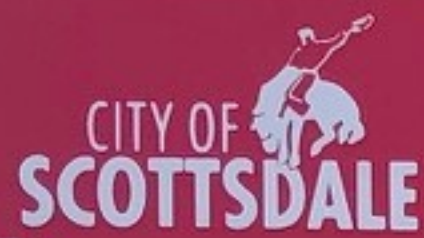

City of Scottsdale
Public Notice

Scan,
Snap,
Save



ZONING/PUBLIC HEARINGS

CITY HALL: 3939 NORTH DRINKWATER BOULEVARD

HISTORIC PRESERVATION: 6:00 P.M.,

May 7, 2020

PLANNING COMMISSION: 5:00 P.M.,

TBD

CITY COUNCIL: 5:00 P.M., TBD

REQUEST: by owner for a Zoning District Map Amendment from Resort/Townhouse Residential (R-4R) to Resort/Townhouse Residential Historic Property (R-4R HP) zoning on the Sands North Townhouse subdivision plat (MCR 137-46) on four (4) properties located at 6850 N 72nd Place (174-19-014), 7238 E Joshua Tree Lane (174-19-011), 7241 E Joshua Tree Lane (174-19-045) and 6824 N. 73rd Street (174-19-047) +/- .6 acre in the Sands North Townhouse subdivision located on the east side of N. Scottsdale Road approximately 660 feet south of the intersection of E. Indian Bend Road and N. Scottsdale Road).

LOCATION: 7233 E Joshua Tree Ln

Case Number: 9-ZN-2018#2

Applicant/Contact: Sands North HOA

City Contact: Doris McClay

Phone: 623-748-7595

Phone: 480-312-4214

Email: kbenson@Integrityfirstpm.com

Email: dmcclay@ScottsdaleAZ.gov

Case File Available at City of Scottsdale 480-312-7000

Project information may be researched at: <https://eservices.scottsdaleaz.gov/bldgresources/Cases>

Penalty for removing or defacing sign prior to date of last hearing

Posting Date: 3/23/2020

All public hearings will be held electronically. While physical facilities are not open to the public, City Council meetings are televised on Cox Cable Channel 11 and streamed online at ScottsdaleAZ.gov (search "live stream")

City of Scottsdale Public Notice

Scan,
Snap,
Save



ZONING/PUBLIC HEARINGS

CITY HALL: ~~3939 NORTH DRINKWATER BOULEVARD~~

HISTORIC PRESERVATION: 6:00 P.M., **5-7-20**

PLANNING COMMISSION: 5:00 P.M., **5-13-20**

CITY COUNCIL: 5:00 P.M., TBD

REQUEST: by owner for a Zoning District Map Amendment from Resort/Townhouse Residential (R-4R) to Resort/Townhouse Residential Historic Property (R-4R HP) zoning on the Sands North Townhouse subdivision plat (MCR 137-46) on four (4) properties located at 6850 N 72nd Place (174-19-014), 7238 E Joshua Tree Lane (174-19-011), 7241 E Joshua Tree Lane (174-19-045) and 6824 N. 73rd Street (174-19-047) +/- .6 acre in the Sands North Townhouse subdivision located on the east side of N. Scottsdale Road approximately 660 feet south of the intersection of E. Indian Bend Road and N. Scottsdale Road).

LOCATION: 7233 E Joshua Tree Ln

Case Number: 9-ZN-2018#2

Applicant/Contact: Sands North HOA

Phone: 623-748-7595

Email: kbenson@Integrityfirstpm.com

City Contact: Doris McClay

Phone: 480-312-4214

Email: dmcclay@ScottsdaleAZ.gov

Case File Available at City of Scottsdale 480-312-7000

Project information may be researched at: <https://eservices.scottsdaleaz.gov/bldgresources/Cases>

Penalty for removing or defacing sign prior to date of last hearing

Posting Date: **4/20/2020**



City of Scottsdale
Public Notice

Scan,
Snap,
Save



ZONING/PUBLIC HEARINGS

CITY HALL: 3939 NORTH DRINKWATER BOULEVARD

HISTORIC PRESERVATION: 6:00 P.M.,

May 7, 2020

PLANNING COMMISSION: 5:00 P.M.,

5/13/2020

CITY COUNCIL: 5:00 P.M., TBD

REQUEST: by owner for a Zoning District Map Amendment from Resort/Townhouse Residential (R-4R) to Resort/Townhouse Residential Historic Property (R-4R HP) zoning on the Sands North Townhouse subdivision plat (MCR 137-46) on four (4) properties located at 6850 N 72nd Place (174-19-014), 7238 E Joshua Tree Lane (174-19-011), 7241 E Joshua Tree Lane (174-19-045) and 6824 N. 73rd Street (174-19-047) +/- .6 acre in the Sands North Townhouse subdivision located on the east side of N. Scottsdale Road approximately 660 feet south of the intersection of E. Indian Bend Road and N. Scottsdale Road).

LOCATION: 7233 E Joshua Tree Ln

Case Number: 9-ZN-2018#2

Applicant/Contact: Sands North HOA

Phone: 623-748-7595

Email: kbenson@Integrityfirstpm.com

City Contact: Doris McClay

Phone: 480-312-4214

Email: dmcclay@ScottsdaleAZ.gov

Case File Available at City of Scottsdale 480-312-7000

Project information may be researched at: <https://eservices.scottsdaleaz.gov/bldgresources/Cases>

Penalty for removing or defacing sign prior to date of last hearing

Posting Date 4/20/2020

PUBLIC HEARING NOTICE

REQUEST: for a Zoning District Map Amendment
from Resort/Townhouse Residential (R-4R) to Resort/Townhouse
Residential Historic Property (R-4R HP) zoning on four (4) properties
located in the Sands North Townhouse subdivision



Scan, snap, save, and share

CASE#: 9-ZN-2018#2

DATE: May 7, 2020

**UNLESS OTHERWISE NOTIFIED, ALL
PUBLIC HEARINGS ARE HELD AT:**

Meeting to be held remote electronically.
Please call 480-312-7767 with questions.

**HEARING DATE SUBJECT TO CHANGE
PLEASE CHECK OUR WEBSITE FOR LATEST INFORMATION**

**YOUR COMMENTS ABOUT THIS REQUEST CAN
BE MADE PRIOR TO OR AT THE ABOVE PUBLIC
HEARING
IF YOU WISH TO SPEAK AT THIS MEETING
PLEASE ALLOW ENOUGH TIME TO FILL OUT A
COMMENT CARD.**



480-312-7767

6:00 P.M.

HISTORIC PRESERVATION COMMISSION

POSTING DATE:

4/20/2020

<https://eservices.scottsdaleaz.gov/bldgresources/Cases>



PUBLIC HEARING NOTICE

REQUEST: For a 2018-2019 City Ordinance
to amend the City of Phoenix's Ordinance 15-0001
to amend the City of Phoenix's Ordinance 15-0001
to amend the City of Phoenix's Ordinance 15-0001
to amend the City of Phoenix's Ordinance 15-0001

CASE#: 9-24-2018-02

DATE: April 2, 2020

480-312-7767 6:00 P.M.