

MASTER WATER SYSTEM PLANS FOR SCOTTSDALE ENTRADA

A PORTION OF LAND LOCATED IN THE SOUTHWEST QUARTER OF SECTION 34, TOWNSHIP 2 NORTH, RANGE 4 EAST, OF THE GILA AND SALT RIVER BASE AND MERIDIAN, MARICOPA COUNTY, ARIZONA

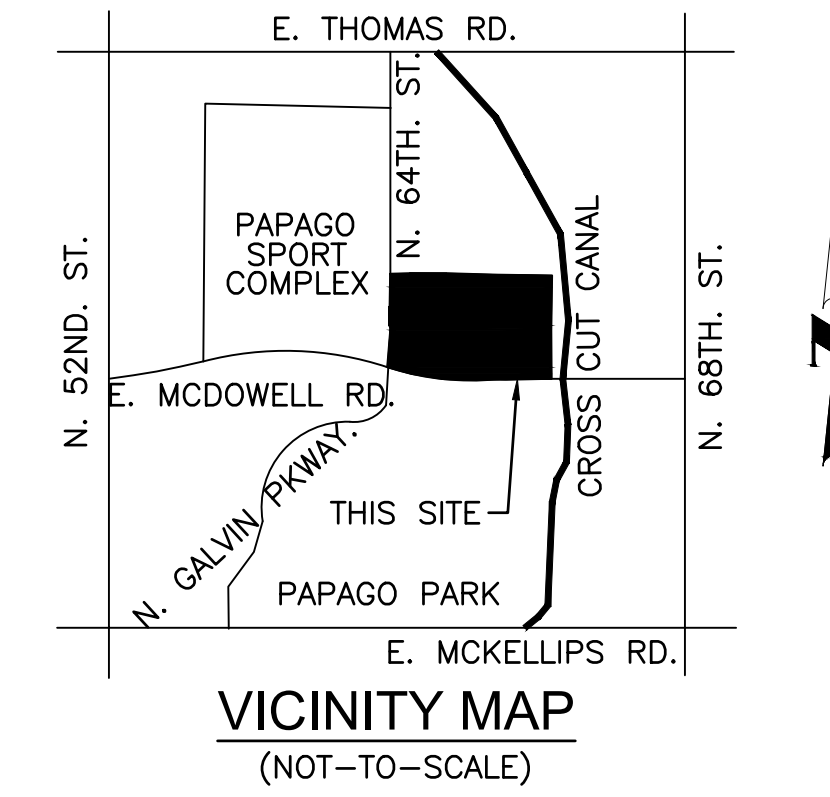

SHEET INDEX

1.....	COVER SHEET
2.....	GENERAL NOTES
3-4.....	WATER SYSTEMS PLANS

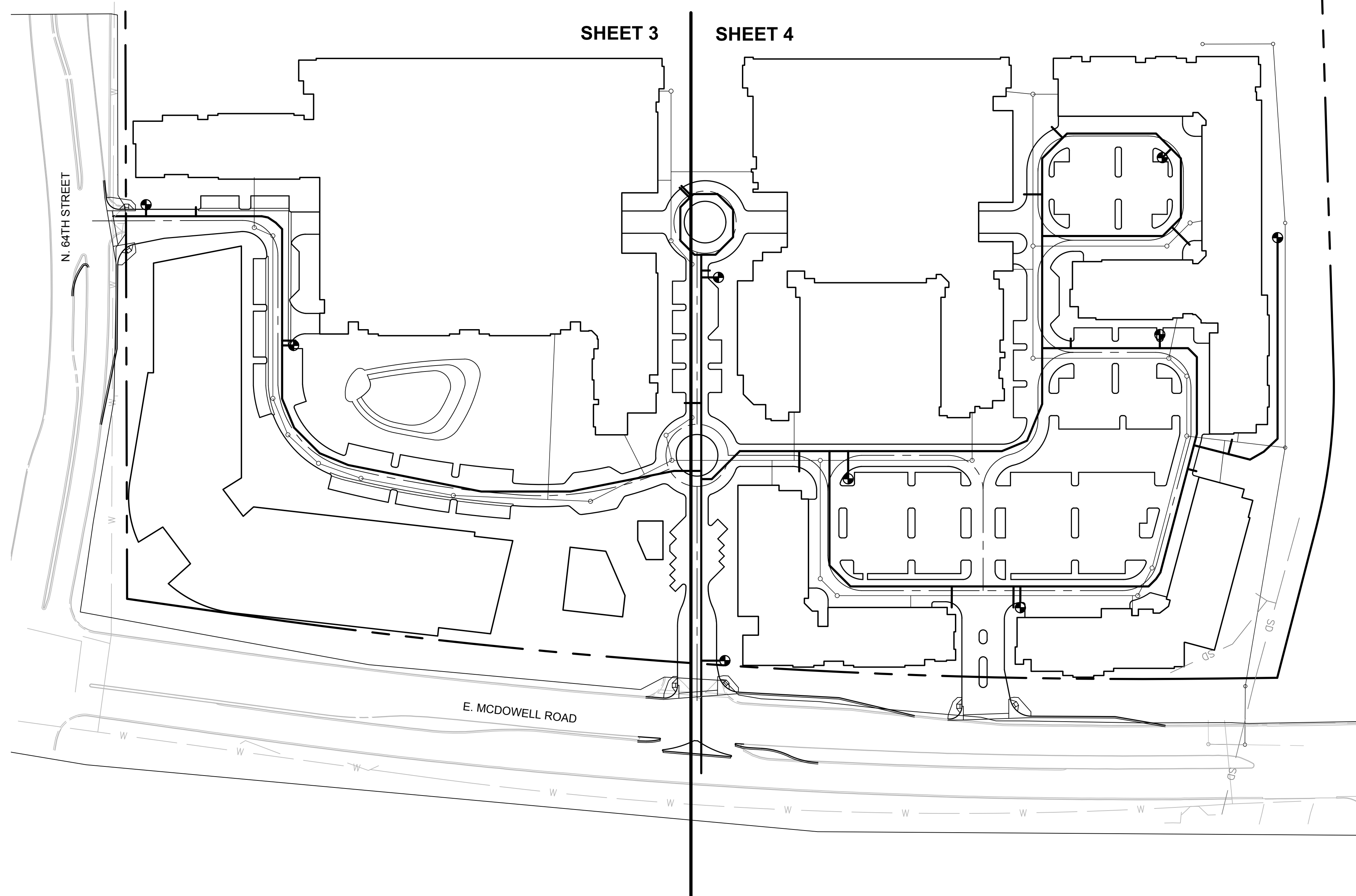

OWNERS

McDOWELL 64 LLC
8601 N. SCOTTSDALE RD.
SCOTTSDALE, AZ 85253

CAR COLLECTION LLC
5665 N. SCOTTSDALE RD.,
SUITE 135
SCOTTSDALE, AZ 85253

McDOWELL 6620 LLC
5665 N. SCOTTSDALE RD.,
SUITE 135
SCOTTSDALE, AZ 85250

McDOWELL 6500 LLC
5665 N. SCOTTSDALE RD.,
SUITE 135
SCOTTSDALE, AZ 85250

ENGINEER

COE & VAN LOO CONSULTANTS, INC.
4550 NORTH 12TH STREET
PHOENIX, ARIZONA 85014
PHONE: (602) 264-6831
FAX: (602) 264-0928
CONTACT: HEIDI TILSON
EMAIL: HTILSON@CVLCI.COM

DEVELOOPER

BRIDGE BANYAN
QUALIFIED OPPORTUNITY
ZONE BUSINESS I, LLC
2411 3RD STREET, UNIT E
SANTA MONICA, CA 90405

BASIS OF BEARING

THE BASIS OF BEARINGS IS GRID NORTH, ACCORDING TO DIRECT OBSERVATION ON THE ARIZONA STATE PLANE COORDINATE SYSTEM, PROJECTION OF THE CENTRAL ZONE, NAD-83.

BENCHMARK

THE SOUTH WEST 1/4 CORNER SECTION 34,
TOWNSHIP 2 NORTH, RANGE 4 EAST
ELEVATION 1284.45



NO.	REVISION	DATE

MASTER WATER SYSTEM PLANS
SCOTTSDALE ENTRADA
SCOTTSDALE, ARIZONA



01 SHEET OF 04
CVL Contact: HEIDI TILSON
CVL Project #: 1140254309
© 2019 Coe & Van Loo II L.L.C.
All rights reserved to reproduction in any format

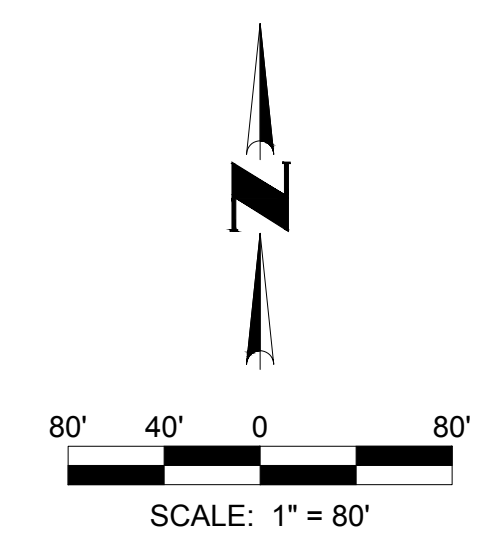

ENGINEER'S GENERAL NOTES (3/9/2018)

- THESE PLANS ARE NOT TO BE USED FOR CONSTRUCTION PURPOSES UNLESS THE APPROVAL BLOCK HAS BEEN SIGNED BY THE APPROPRIATE AGENCIES. ALL MATERIALS AND WORKMANSHIP SHALL COMPLY WITH THE CURRENT MARICOPA ASSOCIATION OF GOVERNMENTS (M.A.G.) SPECIFICATIONS AND STANDARD DETAILS TOGETHER WITH ANY SUPPLEMENTS OF THE REVIEWING AGENCY AND WITH GENERALLY ACCEPTED CONSTRUCTION PRACTICES.
- PRIOR TO CONSTRUCTION, THE ENGINEER AND APPLICABLE AGENCY MUST APPROVE ANY ALTERATION OR VARIANCE FROM THESE PLANS. ANY VARIATIONS FROM THESE PLANS SHALL BE PROPOSED ON CONSTRUCTION FIELD PRINTS AND TRANSMITTED TO THE ENGINEER.
- IT IS THE RESPONSIBILITY OF THE CONTRACTOR TO OBTAIN ALL REQUIRED PERMITS AT HIS OWN EXPENSE.
- ANY INSPECTION BY THE CITY, COUNTY, ENGINEER, OR OTHER JURISDICTIONAL AGENCY SHALL NOT IN ANY WAY RELIEVE THE CONTRACTOR FROM ANY OBLIGATION TO PERFORM THE WORK IN STRICT COMPLIANCE WITH APPLICABLE CODES AND AGENCY REQUIREMENTS.
- THE CONTRACTOR SHALL MAKE NO CLAIM AGAINST THE OWNER OR THE SURVEYOR REGARDING ALLEGED INACCURACY OF CONSTRUCTION STAKES SET BY THE SURVEYOR UNLESS ALL SURVEY STAKES SET BY THE SURVEYOR ARE MAINTAINED INTACT AND CAN BE VERIFIED AS TO THEIR ORIGIN. IF, IN THE OPINION OF THE SURVEYOR, THE STAKES ARE NOT MAINTAINED INTACT AND CANNOT BE VERIFIED AS TO THEIR ORIGIN, ANY REMEDIAL WORK REQUIRED SHALL BE PERFORMED AT THE SOLE EXPENSE OF THE RESPONSIBLE CONTRACTOR OR SUBCONTRACTOR.
- THE CONTRACTOR SHALL NOTIFY THE DEVELOPER AT LEAST 48 HOURS IN ADVANCE FOR ANY STAKING OR RESTAKING REQUIRED.
- THE CONTRACTOR SHALL NOTIFY THE ENGINEER AT LEAST 48 HOURS IN ADVANCE FOR ANY INSPECTIONS AND/OR TESTING FOR ENGINEER OF RECORD SERVICES.
- THE CONTRACTOR SHALL BE RESPONSIBLE FOR PRESERVING ALL STAKES AND CONTROL SET BY THE DEVELOPERS SURVEYOR, AND SHALL TAKE STEPS NECESSARY TO INSURE THAT THE STAKES AND CONTROL ARE NOT DISTURBED OR TAMPERED WITH. IF STAKES SET BY THE DEVELOPERS SURVEYOR ARE DISTURBED, THE CONTRACTOR SHALL BE RESPONSIBLE FOR THE COST INCURRED TO RESTAKE.
- NOTHING CONTAINED IN THE CONTRACT DOCUMENTS SHALL CREATE, NOR SHALL BE CONSTRUED TO CREATE, ANY CONTRACTUAL RELATIONSHIP BETWEEN THE ENGINEER AND THE CONTRACTOR OR ANY SUBCONTRACTOR.
- CONTRACTOR MUST CONTACT THE DESIGN ENGINEER FOR ANY NOTED DISCREPANCIES IN THE DESIGN PRIOR TO THE ITEM BEING CONSTRUCTED. FAILURE OF CONTRACTOR TO NOTIFY THE ENGINEER AND APPROVING AGENCY IN ADVANCE FOR ALTERNATIVE DESIGN SHALL RESULT IN CONTRACTOR ACCEPTANCE OF ALL COSTS RELATED TO POTENTIAL REMOVAL AND REWORK OF SAID ITEMS.
- THE ENGINEER SHALL NOT BE RESPONSIBLE FOR COORDINATING THE RELOCATION OF UTILITIES, POWER POLES, ETC.
- THE ENGINEER SHALL NOT BE RESPONSIBLE FOR CONSTRUCTION MEANS, METHODS, TECHNIQUES, SEQUENCES OR PROCEDURES, OR FOR SAFETY PRECAUTIONS OR PROGRAMS UTILIZED IN CONNECTION WITH THE WORK. THE ENGINEER IS NOT RESPONSIBLE FOR THE CONTRACTOR'S FAILURE TO CARRY OUT THE WORK IN ACCORDANCE WITH THE CONTRACT DOCUMENTS NOR ANY COSTS INCURRED, WHETHER INITIAL OR ADDITIONAL TO CORRECT, MODIFY, OR ALTER ANY CONSTRUCTION COMPLETED CONTRARY TO THE CONTRACT DOCUMENTS.
- A THOROUGH ATTEMPT HAS BEEN MADE TO SHOW THE LOCATIONS OF ALL OVERHEAD AND UNDERGROUND UTILITY LINES IN THE WORK AREA ACCORDING TO INFORMATION PROVIDED BY THE AGENCY OPERATING EACH FACILITY. LOCATIONS SHOWN ARE APPROXIMATE ONLY, AND ARE NOT RELIABLE FOR CONSTRUCTION PURPOSES. CALL AZ811 AT 811 OR 602-263-1100 TO HAVE LOCATIONS MARKED PRIOR TO CONSTRUCTION. THE CONTRACTOR SHALL PROTECT AND MAINTAIN ALL EXISTING UTILITIES ON THE SITE. ANY DAMAGE TO EXISTING UTILITIES, WHETHER SHOWN ON THE PLANS OR NOT, SHALL BE REPAIRED/REPLACED AT THE CONTRACTOR'S EXPENSE. EXISTING SURFACE FEATURES AND FENCING NOT SCHEDULED FOR DEMOLITION OR REMOVAL SHALL BE REPLACED IN KIND.
- IT IS THE CONTRACTOR'S SOLE RESPONSIBILITY TO VERIFY THE PRESENCE AND LOCATION OF ANY AND ALL EXISTING OVERHEAD AND/OR UNDERGROUND UTILITIES THAT MAY INTERFERE WITH THIS CONSTRUCTION, WHETHER OR NOT SAID UTILITIES ARE SHOWN ON THE CONSTRUCTION PLANS FOR THIS PROJECT. THE CONTRACTOR SHALL MAKE EXPLORATORY EXCAVATIONS (POTHOLING) AND LOCATE EXISTING UNDERGROUND FACILITIES SUFFICIENTLY IN ADVANCE OF CONSTRUCTION TO PERMIT THE OWNER TO DIRECT THE ENGINEER TO MAKE REVISIONS OF THESE PLANS, IF NECESSARY, DUE TO CONFLICT BETWEEN PROPOSED FACILITIES AND EXISTING FACILITIES.
- OWNER/CONTRACTOR IS RESPONSIBLE FOR SURVEY VERIFICATION OF EXISTING HORIZONTAL AND VERTICAL CONDITIONS PRIOR TO START OF CONSTRUCTION. A DEVIATION IN EXISTING CONDITIONS MUST BE BROUGHT TO THE ATTENTION OF THE ENGINEER BEFORE CONSTRUCTION STARTS. THE ENGINEER WILL NOT BE RESPONSIBLE FOR REMOVAL, REPLACEMENT, OR OTHER MODIFICATIONS THAT MAY BE REQUIRED AS A RESULT OF EXISTING CONDITIONS NOT PROPERLY VERIFIED AND CONFIRMED. SHOULD AN ERROR BE FOUND IN THE HORIZONTAL AND VERTICAL CONDITIONS, THE ENGINEER SHALL BE NOTIFIED AND CONSTRUCTION WILL NOT PROCEED UNTIL REVISIONS/MODIFICATIONS HAVE BEEN PREPARED AND SUBMITTED BY THE ENGINEER.
- THE CONTRACTOR SHALL VERIFY THE LOCATION, ELEVATION, CONDITION, AND PAVEMENT CROSS-SLOPE OF ALL EXISTING SURFACES AT POINTS OF TIE-IN AND MATCHING, PRIOR TO COMMENCEMENT OF GRADING, PAVING, CURB AND GUTTER, OR OTHER SURFACE CONSTRUCTION. SHOULD EXISTING LOCATIONS, ELEVATIONS, CONDITIONS, OR PAVEMENT CROSS-SLOPES DIFFER FROM THAT WHICH IS SHOWN ON THESE PLANS, THE CONTRACTOR SHALL NOTIFY THE ENGINEER ACCORDINGLY. THE CONTRACTOR ACCEPTS RESPONSIBILITY FOR ALL COSTS ASSOCIATED WITH CORRECTIVE ACTION IF THESE PROCEDURES ARE NOT FOLLOWED.
- APPROVAL OF THESE PLANS SHALL NOT PREVENT THE REVIEWING AGENCY FROM REQUIRING THE CORRECTION OF ERRORS IN THE PLANS WHERE SUCH ERRORS ARE SUBSEQUENTLY FOUND TO BE IN VIOLATION OF ANY LAW, ORDINANCE, OR OTHER HEALTH/SAFETY ISSUE.
- THE CONTRACTOR IS RESPONSIBLE FOR PROTECTING ALL STORM DRAIN PIPES, STORM WATER RETENTION PIPES AND DRAINAGE FACILITIES DURING ALL STAGES OF CONSTRUCTION. THE DEPTH OF COVER ON THE STORM DRAIN PIPE IS DESIGNED FOR FINAL GRADE. THEREFORE, EXTRA CARE SUCH AS BERMING OVER PIPES, FLAGGING, OR SIGNAGE SHOULD BE USED DURING CONSTRUCTION IN ORDER TO MAINTAIN COVER OR PROTECT THE PIPES.

ENGINEER'S GENERAL NOTES (CONT.)

- ALL CONDUITS (BOX CULVERT, REINFORCED CONCRETE PIPE, CAST-IN-PLACE PIPE, AND/OR CORRUGATED METAL PIPE) SHOWN ON THESE PLANS ARE DESIGNED FOR STANDARD HIGHWAY LOADINGS. THE STANDARD SATISFACTORY MINIMUM COVER REQUIREMENTS AS ESTABLISHED BY THE CONDUIT MANUFACTURER MAY NOT ALWAYS BE ADEQUATE DURING CONSTRUCTION. WHEN CONSTRUCTION EQUIPMENT, FREQUENTLY HEAVIER THAN TRAFFIC LOADS FOR WHICH THE CONDUIT HAS BEEN DESIGNED, IS TO BE DRIVEN OVER OR CLOSE TO THE BURIED CONDUIT, IT SHALL BE THE RESPONSIBILITY OF THE CONTRACTOR TO PROVIDE THE ADDITIONAL COVER REQUIRED TO AVOID DAMAGE TO THE CONDUIT. THE ADEQUACY OF THE COVER REQUIREMENTS FOR CONDUITS SHALL BE ANALYZED AND CHECKED BY THE CONTRACTOR TO ADDRESS LOADING CONDITIONS IMPOSED BY THE CONSTRUCTION ACTIVITY. ANY CONDUIT DAMAGED BY CONSTRUCTION ACTIVITY SHALL BE REPLACED AT THE CONTRACTOR'S EXPENSE.
- THE ESTIMATED QUANTITIES SHOWN ARE FOR INFORMATIONAL PURPOSES ONLY. THE CONTRACTOR SHALL BE RESPONSIBLE FOR THE COMPLETENESS AND ACCURACY OF A DETAILED ESTIMATE BASE ON THESE PLANS, CURRENT CODES, AND SITE VISITATION.
- ALL EARTHWORK CONSTRUCTION SHALL CONFORM TO THE LATEST MARICOPA ASSOCIATION OF GOVERNMENTS (M.A.G.) STANDARD DETAILS AND SPECIFICATIONS, INCLUDING ANY SUPPLEMENTS THERETO AND THE SOILS REPORT PREPARED BY:

COMPANY: WESTERN TECHNOLOGIES INC.
PROJECT NO.: 2125J062
DATED: 05-21-2015

DATA FOR EARTHWORK CALCULATIONS IS PROVIDED IN THE SOILS REPORT AND (IF APPLICABLE) ANY SUPPLEMENTS THERETO.

22. THIS PLAN IS APPROVED SUBJECT TO COMPLETION OF THOSE LINES LABELED "EXISTING" WHICH HAVE BEEN PROPOSED AS A PART OF ANOTHER DEVELOPMENT. THE DEVELOPER OF THIS PROJECT MAY BE REQUIRED TO CONSTRUCT THOSE LINES PER THE REVIEWING AGENCY'S REQUIREMENTS PRIOR TO RECEIVING SERVICE FOR THIS PROJECT.

ENGINEER'S UTILITY NOTES (3/9/2018)

- THE CONTRACTOR SHALL IN ALL CASES BEGIN SEWER LINE CONSTRUCTION FROM THE DOWNSTREAM MANHOLE OR SEWER STUB, WHETHER EXISTING OR PROPOSED. PRIOR TO INSTALLATION OF ANY SEWER LINE, THE CONTRACTOR SHALL EXCAVATE AND EXPOSE THE POINT OF CONNECTION OF THE NEW SEWER LINE TO THE EXISTING STUB OR MANHOLE AND VERIFY THE ELEVATION AND LOCATION. SHOULD THE EXISTING CONDITIONS VARY FROM THE DESIGN, THE CONTRACTOR SHALL NOTIFY THE ENGINEER PRIOR TO CONTINUING WORK.
- THE SURVEYOR SHALL MAKE FIELD RECORD DRAWING MEASUREMENTS OF THE WORK UPON NOTIFICATION BY THE WATER/SEWER CONTRACTOR THAT THE PIPE WORK IS COMPLETE AND READY FOR RECORD DRAWING SURVEY. IF THE CONTRACTOR DOES NOT LEAVE THE TRENCHES OPEN TO THE ACTUAL PIPELINE AND SERVICES CAN BE OBSERVED, THE RECORD DRAWING MEASUREMENTS WILL REFLECT THE TRENCH LOCATION ONLY. IF THE MEASUREMENTS CANNOT BE PERFORMED, THE CONTRACTOR SHALL BE RESPONSIBLE FOR PROVIDING ACCURATE RECORD DRAWING MEASUREMENTS AND SECURING THE ACCEPTANCE OF THE RECORD DRAWING BY THE APPROVING AGENCY.
- THE CONTRACTOR SHALL NOTIFY THE ENGINEER BEFORE THE FITTINGS ARE COVERED SO RECORD DRAWING MEASUREMENTS MAY BE TAKEN. FITTINGS SHALL NOT BE COVERED UNTIL SURVEY HAS BEEN COMPLETED.
- A WATER PRESSURE TEST IS REQUIRED OF ALL WATER LINES AND A HYDROSTATIC OR AIR TEST IS REQUIRED OF ALL SEWER LINES AND MANHOLES. TESTING SHALL BE IN ACCORDANCE WITH M.A.G. SECTIONS 610, 611, AND 615. CONTRACTOR SHALL NOTIFY THE ENGINEER AT LEAST 48 HOURS IN ADVANCE TO ARRANGE CONSTRUCTION OBSERVATION SERVICES OF TESTING.

CITY OF SCOTTSDALE GENERAL NOTES FOR PUBLIC WORKS CONSTRUCTION

- ALL CONSTRUCTION IN THE PUBLIC RIGHTS-OF-WAY OR IN EASEMENTS GRANTED FOR PUBLIC USE MUST CONFORM TO THE LATEST MARICOPA ASSOCIATION OF GOVERNMENTS (MAG) UNIFORM STANDARD SPECIFICATIONS AND UNIFORM STANDARD DETAILS FOR PUBLIC WORKS CONSTRUCTION AS AMENDED BY THE LATEST VERSION OF THE CITY OF SCOTTSDALE STANDARD SPECIFICATIONS AND SUPPLEMENTAL STANDARD DETAILS. IF THERE IS A CONFLICT, THE CITY'S SUPPLEMENTAL STANDARD DETAILS WILL GOVERN.
- THE CITY ONLY APPROVES THE SCOPE, NOT THE DETAIL OF ENGINEERING DESIGNS; THEREFORE, IF CONSTRUCTION QUANTITIES ARE SHOWN ON THESE PLANS, THEY ARE NOT VERIFIED BY THE CITY.
- THE APPROVAL OF PLANS IS VALID FOR SIX (6) MONTHS. IF ASSOCIATED PERMIT HAS NOT BEEN ISSUED WITHIN THIS TIME FRAME, THE PLANS MUST BE RESUBMITTED TO THE CITY FOR RE-APPROVAL.
- A CITY INSPECTOR WILL INSPECT ALL WORKS WITHIN THE CITY OF SCOTTSDALE. NOTIFY INSPECTION SERVICES 72 HOURS BEFORE BEGINNING WORK.
- WHENEVER EXCAVATION IS NECESSARY, CALL THE BLUE STAKE CENTER, 811, TWO WORKING DAYS BEFORE EXCAVATION BEGINS.
- PERMISSION TO WORK IN THE RIGHT-OF-WAY (PWR) PERMITS ARE REQUIRED FOR ALL WORKS WITHIN THE RIGHTS-OF-WAY AND EASEMENTS GRANTED FOR PUBLIC PURPOSES. COPIES OF ALL PERMITS MUST BE RETAINED ON-SITE AND BE AVAILABLE FOR INSPECTION AT ALL TIMES. FAILURE TO PRODUCE THE REQUIRED PERMITS WILL RESULT IN IMMEDIATE SUSPENSION OF ALL WORK UNTIL THE PROPER PERMIT DOCUMENTATION IS OBTAINED.

CITY OF SCOTTSDALE GENERAL NOTES

- MARICOPA ASSOCIATION OF GOVERNMENTS (M.A.G.) UNIFORM STANDARD SPECIFICATIONS AND DETAILS FOR PUBLIC WORKS CONSTRUCTION (LATEST EDITION INCLUDING LATEST REVISION AND CURRENT SUPPLEMENTALS THEREOF PER THE LOCAL TOWN OR CITY) ARE INCORPORATED INTO THIS PLAN IN THEIR ENTIRETY.
- ALL WORK REQUIRED TO COMPLETE THE CONSTRUCTION COVERED BY THIS PLAN SHALL BE IN ACCORDANCE WITH THE M.A.G. STANDARD SPECIFICATIONS AND DETAILS AND CURRENT SUPPLEMENTS THEREOF PER THE LOCAL CITY OR TOWN UNLESS SPECIFIED OTHERWISE IN THESE PLANS OR ELSEWHERE IN THE CONTRACT DOCUMENTS. CONTRACTORS SHALL FAMILIARIZE THEMSELVES WITH ALL REQUIRED STANDARD SPECIFICATIONS, DETAILS AND SUPPLEMENTS PRIOR TO BIDDING THE WORK FOR THE CONSTRUCTION COVERED BY THIS PLAN.
- THE CONTRACTOR IS RESPONSIBLE FOR ALL METHODS, SEQUENCING, AND SAFETY CONCERNS ASSOCIATED WITH THIS PROJECT DURING CONSTRUCTION, UNLESS SPECIFICALLY ADDRESSED OTHERWISE IN THIS PLAN OR ELSEWHERE IN THE CONTRACT.
- THE CONTRACTOR IS TO COMPLY WITH ALL LOCAL, STATE, AND FEDERAL LAWS AND REGULATIONS APPLICABLE TO THE CONSTRUCTION COVERED BY THIS PLAN.
- THE CONTRACTOR IS RESPONSIBLE FOR OBTAINING AND COMPLYING WITH ALL PERMITS REQUIRED TO COMPLETE ALL WORK COVERED BY THIS PLAN.
- THE QUANTITIES AND SITE CONDITIONS DEPICTED IN THESE PLANS ARE FOR INFORMATIONAL PURPOSES ONLY AND ARE SUBJECT TO ERROR AND OMISSION. CONTRACTORS SHALL SATISFY THEMSELVES AS TO ACTUAL QUANTITIES AND SITE CONDITIONS PRIOR TO BIDDING THE WORK FOR THE CONSTRUCTION COVERED BY THIS PLAN.
- A REASONABLE EFFORT HAS BEEN MADE TO SHOW THE LOCATIONS OF EXISTING UNDERGROUND FACILITIES AND UTILITIES IN THE CONSTRUCTION AREA. THE CONTRACTOR IS RESPONSIBLE FOR ANY DAMAGE TO UTILITIES AND/OR FACILITIES CAUSED DURING THEIR CONSTRUCTION OPERATIONS. THE CONTRACTOR SHALL CALL 48 HOURS IN ADVANCE FOR BLUE STAKE (1-800-STAKE-IT) PRIOR TO ANY EXCAVATION.
- THE CONTRACTOR IS RESPONSIBLE FOR ALL COORDINATION OF CONSTRUCTION AFFECTING UTILITIES AND THE COORDINATION OF ANY NECESSARY UTILITY RELOCATION WORK.
- ALL PAVING, GRADING, EXCAVATION, TRENCHING, PIPE BEDDING, CUT FILL AND BACKFILL SHALL COMPLY WITH THE RECOMMENDATIONS SET FORTH IN THE SOILS (GEOTECHNICAL) REPORT FOR THIS PROJECT IN ADDITION TO THE REFERENCED REQUIRED SPECIFICATIONS AND DETAILS. THE CONTRACTOR SHALL BE AWARE THAT CERTAIN UTILITIES REQUIRE PROPER ATTENTION AND CAREFUL PLANNING DURING SITE CONSTRUCTION. PLEASE NOTE THAT UTILITIES ON THESE PLANS MAY NOT EXHIBIT THE FULL PROTECTIVE COVER REQUIRED DURING THE SUBGRADE PREPARATION PHASE OF THE CONSTRUCTION. IN SUCH INSTANCES, THE CONTRACTOR SHALL PROVIDE ADDITIONAL PROTECTION (SUCH AS RAMPING) OR INCREASED PIPE STRENGTH TO PROVIDE THE NECESSARY PROTECTION REQUIRED TO PREVENT DAMAGE DURING THE CONSTRUCTION OF THIS PROJECT. THE CONTRACTOR SHALL HOLD THE ENGINEER HARMLESS IN ALL CASES FOR DAMAGES TO UTILITIES WHERE INADEQUATE PROTECTIVE MEASURES OCCUR.
- THE CONTRACTOR IS TO VERIFY THE LOCATION AND THE ELEVATIONS OF ALL EXISTING UTILITIES AT POINTS OF TIE-IN PRIOR TO COMMENCING ANY NEW CONSTRUCTION. SHOULD ANY LOCATION OR ELEVATION DIFFER FROM THAT SHOWN ON THESE PLANS, THE CONTRACTOR SHALL CONTACT THE OWNER'S AGENT.
- CONTRACTOR TO VERIFY AND COORDINATE ALL DIMENSIONS AND SITE LAYOUT WITH ARCHITECT'S FINAL SITE PLAN AND FINAL BUILDING DIMENSIONS BEFORE STARTING WORK. REPORT DISCREPANCIES TO OWNER'S AGENT.
- COORDINATION BETWEEN ALL PARTIES IS ESSENTIAL PART OF CONTRACT.
- CONTRACTOR IS RESPONSIBLE FOR PROJECT AND SITE CONDITIONS, AND TO WORK WITH WEATHER CONDITIONS AS THE PROJECT SITE MAY BE LOCATED IN A FLOOD PRONE AREA AND SUBJECT TO FLOODING AND ITS HAZARDS.
- PAVEMENT CROSS-SLOPE OF ALL EXISTING SURFACES AT POINTS OF TIE-IN AND MATCHING, PRIOR TO COMMENCEMENT OF GRADING, PAVING, CURB AND GUTTER, OR OTHER SURFACE CONSTRUCTION. SHOULD EXISTING LOCATIONS, ELEVATIONS, CONDITION, OR PAVEMENT CROSS-SLOPE DIFFER FROM THAT SHOWN ON THESE PLANS, RESULTING IN THE DESIGN INTENT REFLECTED ON THESE PLANS NOT ABLE TO BE CONSTRUCTED, THE CONTRACTOR SHALL NOTIFY THE OWNER'S AGENT IMMEDIATELY FOR DIRECTION ON HOW TO PROCEED PRIOR TO COMMENCEMENT OF CONSTRUCTION. THE CONTRACTOR ACCEPTS RESPONSIBILITY FOR ALL COSTS ASSOCIATED WITH CORRECTIVE ACTION IF THESE PROCEDURES ARE NOT FOLLOWED.
- CONTRACTOR IS RESPONSIBLE TO COORDINATE UTILITY CROSSINGS AT CULVERT CROSSINGS BEFORE STARTING WORK ON CULVERT. COORDINATE WITH OWNER REPRESENTATIVE. VERIFY UTILITY LINES AND/OR CONDUITS ARE IN PLACE BEFORE STARTING CULVERT WORK.
- CONSTRUCT RETENTION BASIN AS SHOWN. CONTRACTOR TO SCARIFY BOTTOM OF BASIN TWO FEET DEEP AND NOT ALLOW COMPACTION OVER 80%.
- THIS PROJECT REQUIRES A REGULAR ONGOING MAINTENANCE PROGRAM FOR THE DESIGNED DRAINAGE SYSTEM(S) TO PRESERVE THE DESIGN INTEGRITY AND THE ABILITY TO PERFORM ITS OPERATIONAL INTENT. FAILURE TO PROVIDE MAINTENANCE WILL JEOPARDIZE THE DRAINAGE SYSTEM(S)' PERFORMANCE AND MAY LEAD TO IT'S INABILITY TO PERFORM PROPERLY AND/OR CAUSE DAMAGE ELSEWHERE IN THE PROJECT.
- SEWER LINES DESIGNED IN PROFILE AND PUBLIC WATER LINES ARE REQUIRED TO BE ASBUILT AND THE INSTALLATION AND TESTING WITNESSED BY A PROFESSIONAL ENGINEER IN ACCORDANCE WITH ARIZONA ADMINISTRATIVE CODES R18-9-E301 "4.01 GENERAL PERMIT: SEWAGE COLLECTIONS SYSTEMS" AND R18-5-507 AND 508 "APPROVAL OF CONSTRUCTION" AND "RECORD DRAWINGS", RESPECTIVELY. IT IS THE CONTRACTOR'S RESPONSIBILITY TO NOTIFY OWNER 72 HOURS IN ADVANCE WHEN THOSE SYSTEMS ARE READY TO BE WITNESSED.
- THE WORK PRODUCT PRESENTED IS BELIEVED TO BE COMPLIANT WITH THE INTENT OF THE CURRENT AMERICANS DISABILITIES ACT (ADA) REQUIREMENTS AS INTERPRETED BY THE REVIEWING AGENCY(S). IF CONSTRUCTION OF THE PROJECT IS DELAYED, THIS WORK PRODUCT SHOULD BE UPDATED TO ACCOUNT FOR ANY RELEVANT ADA UPDATES BEFORE CONSTRUCTION BEGINS.

CITY OF SCOTTSDALE GENERAL NOTES (CONT.)

20. LOWEST FLOOR (LF) REFERS TO EITHER FLOOR/SLAB ELEVATION OR TOP OF BASEMENT SLAB. LF ELEVATIONS ON THE GRADING AND DRAINAGE PLANS FOR RESIDENTIAL UNITS REFLECT SLAB ON GRADE CONDITIONS AND CANNOT BE LOWERED WITHOUT AGENCY APPROVAL IN LOCATIONS WHERE 'SPECIAL FLOOD HAZARD AREAS' EXIST. IN NON-FLOOD HAZARD LOCATIONS, TO ENSURE THAT ADEQUATE RESIDENTIAL LOT DRAINAGE CAN BE ACHIEVED, A PROFESSIONAL ENGINEER SHOULD BE CONSULTED IF THE LF FOR THE SLAB IS PROPOSED TO BE LOWERED, OR IF A BASEMENT IS TO BE CONSTRUCTED.



DATE	
REVISION	
NO.	

MASTER WATER SYSTEM PLANS
SCOTTSDALE ENTRADA
 SCOTTSDALE, ARIZONA
Coe & Van Loo Consultants, Inc.



02 SHEET OF 04
 CVL Contact: HEIDI TILSON
 CVL Project #: 1140254309



PROJECT NO. XXXXXX

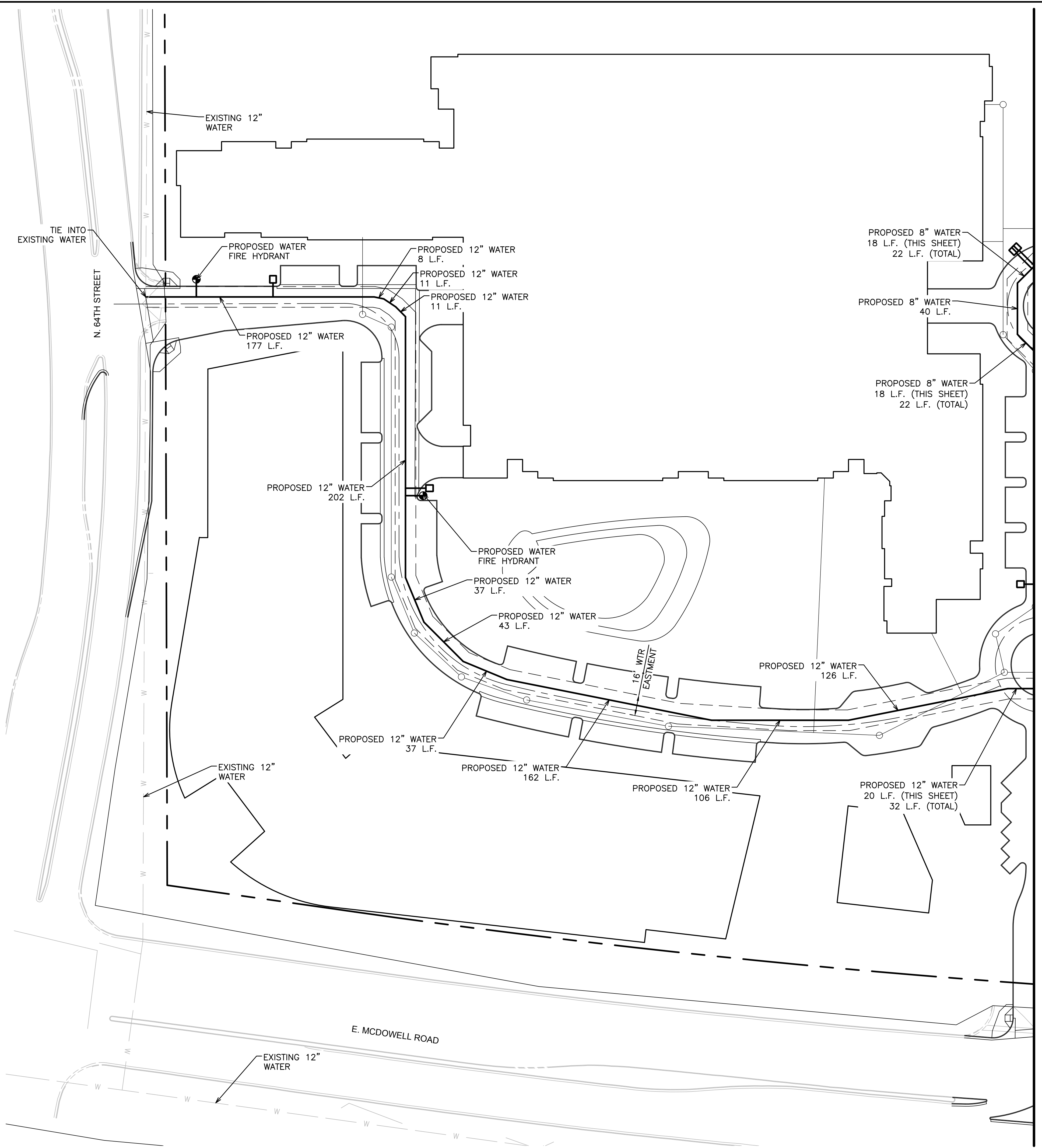

SEE SHEET 4

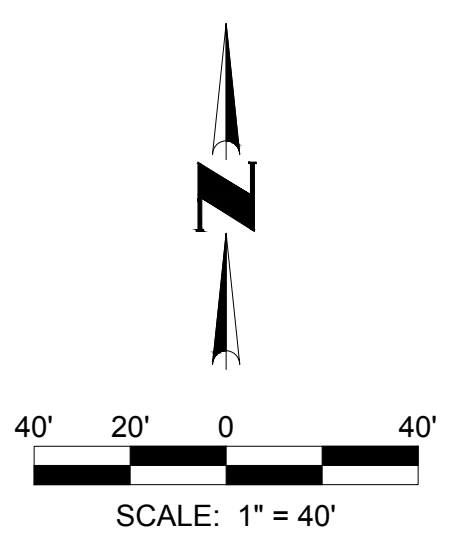

03 SHEET OF 04
 CVL Contact: HEIDI TILSON
 CVL Project #: 1140254309
 © 2019 Coe & Van Loo II L.L.C.
 All rights reserved to reproduction in any format.

NO.	REVISION	DATE

MASTER WATER SYSTEM PLANS
SCOTTSDALE ENTRADA
 SCOTTSDALE, ARIZONA

Coe & Van Loo Consultants, Inc.



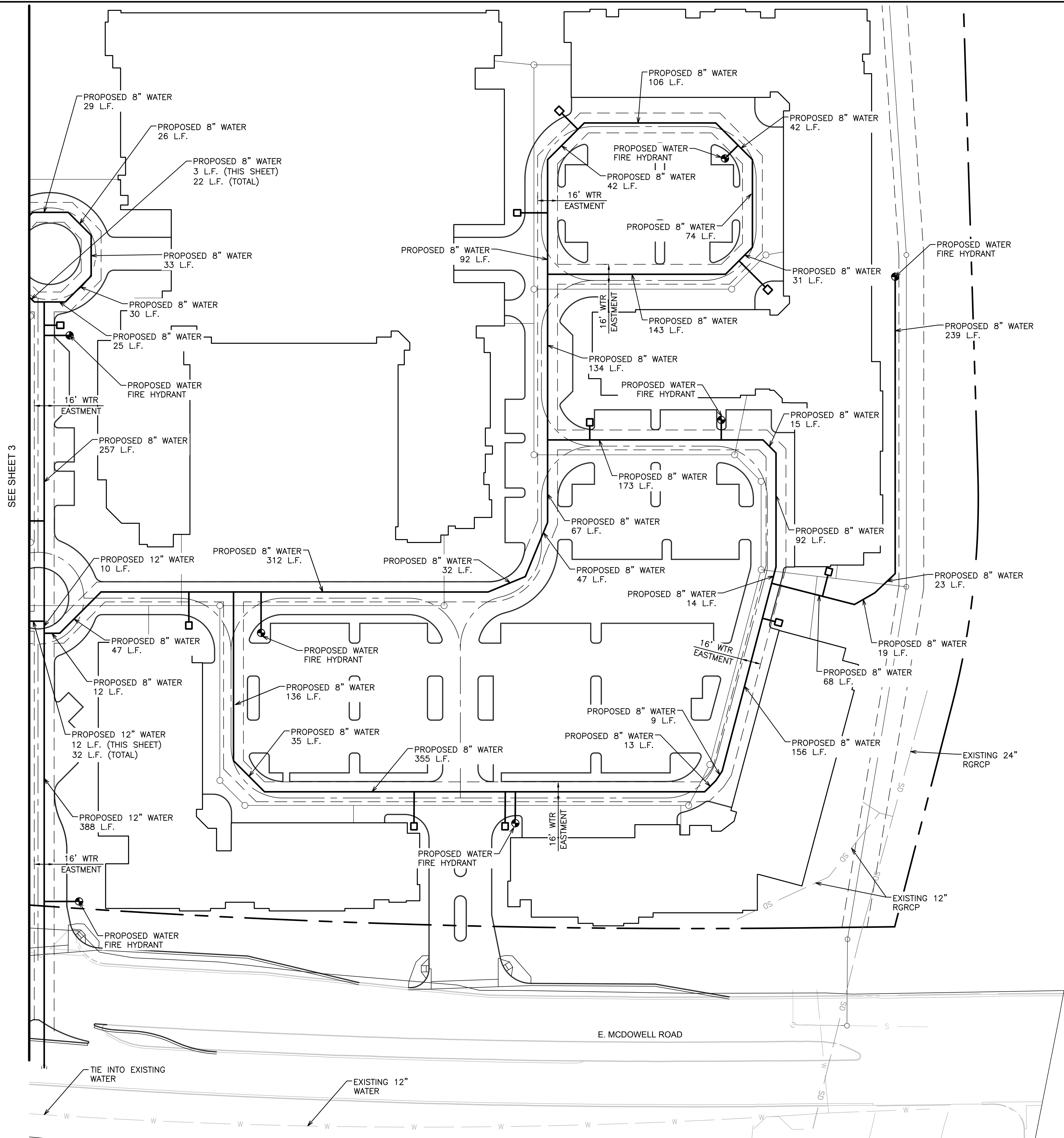

SEE SHEET 3

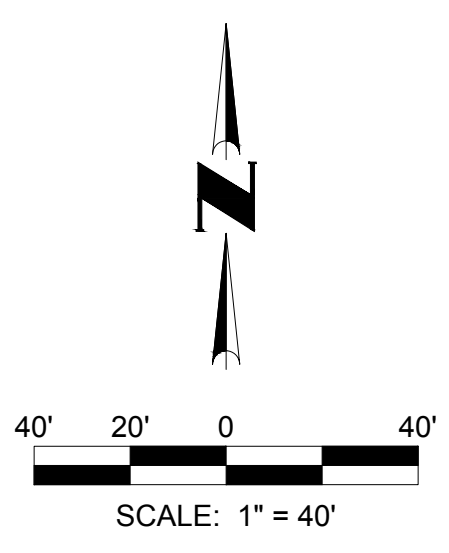

NO.	REVISION	DATE

MASTER WATER SYSTEM PLANS
SCOTTSDALE ENTRADA
SCOTTSDALE, ARIZONA

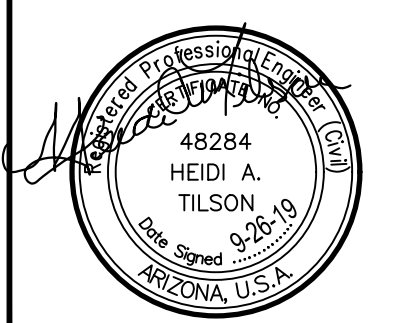

04 SHEET OF 04
CVL Contact: HEIDI TILSON
CVL Project #: 1140254309
© 2019 Coe & Van Loo II L.L.C.
All rights reserved to reproduction in any format

PROJECT NO. XXXXXXXX