

Exterior Building Color & Material Samples
Color Drawdowns
Archaeological Resources
Airport Vicinity Development Checklist
Parking Study
Trip Generation Comparison
Parking Master Plan



CERTIFICATE OF NO EFFECT- ARCHAEOLOGICAL RESOURCES

Case 2-MD-2019

Ronan's Desert Jewel
Minor Subdivision

APPLICATION INFORMATION

LOCATION: 10000 North 126 th Street	APPLICANT: Wayne Rosendahl
PARCEL: 217-32-046A	COMPANY: Rosendahl Engineering
Q.S.: 28-58	ADDRESS: 857 North Barkley Street Mesa, AZ 85203
	PHONE: 480-599-1263

Request: Request by owner for approval to split one 100,667 sq. ft. lot into two 50,333.5 sq. ft. lots with Single-family Residential, Environmentally Sensitive Lands Overlay zoning (R1-43 ESL), located at the northwest corner of North 126th Street and East Turquoise Lane, on APN 217-32-046A.

Certificate of No Effect-Archaeological Resources Criteria:

In accordance with Chapter 46, Article VI, of the Scottsdale Revised City Code, the City Archaeologist finds that:

- No archaeological resources are located on the property according to the archaeological survey and report and based upon review of the report by the City Archaeologist.

STIPULATIONS

1. Any development on the property is subject to the requirements of Scottsdale Revised Code, Chapter 46, Article VI, Protection of Archaeological Resources, Section 46-134 - Discoveries of archaeological resources during construction.

SIGNATURE: <u>Steve Venker</u>	DATE: <u>April 18, 2019</u>
City Archaeologist	

**Class III Cultural Resources Survey of the
2.3-acre Angela Ronan Family Trust
Property in Scottsdale, Maricopa County,
Arizona**

Connie A. Darby

Reviewed by

T. Kathleen Henderson
Desert Archaeology, Inc.
509 S. 48th Street, Suite 104
Tempe, Arizona 85281

Submitted to

Angela Ronan Family Trust
Bridget Hahn (Trustee)
P.O. Box 2372
Prescott, Arizona 86302



Project Report No. 19-102.SRSF

Desert Archaeology, Inc.

Project No. 19-102

3975 N. Tucson Boulevard, Tucson, Arizona 85716 • April 18, 2019

2-MD-2019
4/18/19

STATE HISTORIC PRESERVATION OFFICE
SURVEY REPORT SUMMARY FORM

1. REPORT TITLE

1a. Report Title: Class III Cultural Resources Survey of the 2.3-acre Angela Ronan Family Trust Property in Scottsdale, Maricopa County, Arizona

1b. Report Author(s): Connie A. Darby

1c. Date: April 18, 2019

1d. Report No.: pr19-102.SRSF

2. PROJECT REGISTRATION/PERMITS

2a. ASM Accession Number: Not applicable

2b. AAA Permit Number: Not applicable

2c. ASLD Lease Application Number(s): Not applicable

2d. Other Permit Number(s): Not applicable

3. ORGANIZATION/CONSULTING FIRM

3a. Name: Desert Archaeology, Inc.

3b. Internal Project Number: 19-102

3c. Internal Project Name: Angela Ronan Family Trust Survey

3d. Contact Name: Patricia Castalia

3e. Contact Address: 3975 N. Tucson Boulevard, Tucson, Arizona 85716

3f. Contact Phone: (520) 881-2244

3g. Contact Email: pcastalia@desert.com

4. SPONSOR/LEAD AGENCY

4a. Sponsor: Bridget Hahn (Trustee)

4b. Lead Agency: City of Scottsdale Historic Preservation Office

4c. Agency Project Number(s): Not applicable

4d. Agency Project Name: Angela Ronan Family Trust Property

4e. Funding Source(s): Private

4f. Other Involved Agencies: Not applicable

4g. Applicable Regulations: City of Scottsdale Revised Code, Chapter 46, Article VI

STATE HISTORIC PRESERVATION OFFICE
SURVEY REPORT SUMMARY FORM

5. DESCRIPTION OF PROJECT OR UNDERTAKING: The Angela Ronan Family Trust has applied to the City of Scottsdale to divide a parcel of privately owned land. The parcel is currently undeveloped in a residential neighborhood. Survey of the parcel is required to comply with provisions codified in Chapter 46, Article VI of the Scottsdale Revised Code.

6. PROJECT AREA/AREA OF POTENTIAL EFFECTS: The entirety of APN 217-32-046A, a 2.3-acre parcel located west of N. 126th Street and south of E. Gold Dust Avenue

7. PROJECT LOCATION

7a. Address: APN 217-32-046A, located west of N. 126th Street, south of E. Gold Dust Avenue

7b. Route: **7c. Mileposts Limits:**

7d. Nearest City/Town: Scottsdale **7e. County:** Maricopa

7f. Project Locator UTM: 424911 Easting 3715645 Northing **7g. NAD83** **7h. Zone:** 12

7i. Baseline & Meridian: GSRBM **7j. USGS Quadrangle(s):** Sawik Mountain, AZ (U:5:[SE])

7k. Legal Description(s): Township 3 North, Range 5 East, NE ¼ of Section 26

8. SURVEY AREA

8a. Total Acres: 2.3

8b. Survey Area:

1. Land Jurisdiction	2. Total Acres Surveyed	3. Total Acres Not Surveyed	4. Justification for Areas Not Surveyed
Private	2.3	Not applicable	Not applicable

9. ENVIRONMENTAL CONTEXTS

9a. Landform: Valley flat, cut by washes

9b. Elevation: 1,520 ft amsl

9c. Surrounding Topographic Features: Colluvial plains south of the McDowell Mountains

9d. Nearest Drainage: An unnamed drainage intersects the northwestern corner of the parcel. The southern slopes of the McDowell Mountains drain toward the Salt River, more than 6 miles to the south.

9e. Local Geology: Rocky sediments are predominately composed of schist and quartz colluvium from the local McDowell Mountains.

9f. Vegetation: Creosotebush-white bursage series of the Lower Colorado Valley subdivision transitioning to the Paloverde-cacti series of the Arizona Upland subdivision of the Sonoran Desertscrub biotic community (Brown 1994)

STATE HISTORIC PRESERVATION OFFICE
SURVEY REPORT SUMMARY FORM

9g. Soils/Deposition: The surface is variably a gravelly sand and silt punctuated with areas of rocky pavement. The context is typical of colluvial erosion and deposition.

9h. Buried Deposits: Not likely

9i. Justification: Erosional contexts dominate the local geology and the surface has been disturbed by use and local development in the modern era; erosion and disturbance are likely to have exposed buried cultural materials in the project area, if they existed.

10. BUILT ENVIRONMENT: Vacant undeveloped parcel surrounded by recent development, including the Central Arizona Project canal; developments in the vicinity may have resulted in modifications to the drainage that crosses the northwest corner of the parcel (for example, grading).

11. INVENTORY CLASS COMPLETED

11a. Class I Inventory:

11b. Researcher(s):

11c. Class II Survey:

11d Sampling Strategy:

11e. Class III Inventory:

12. BACKGROUND RESEARCH SOURCES

12a. AZSITE: January 8, 2019

12b. ASM Archaeological Records Office: January 15, 2019

12c. SHPO Inventories and/or SHPO Library:

12d. NRHP Database: No listings within 1 mile

12e. ADOT Portal: January 8, 2019

12f. GLO Maps: Township 3 North, Range 5 East (1915), no built environment is depicted in the project vicinity. The 1952 Dependent Resurvey and Subdivision of Sections 25 and 26 shows direction of drainage, but no built environment (for example, roads).

12g. Land- Managing Agency Files:

12h. Tribal Cultural Resources Files: Class 1 inventory of the cultural resources on the Salt River Pima-Maricopa Indian Community (Diehl et al. 2009) indicates no cultural resources sites within the portion of the 1-mile-radius research area that extends onto the community.

12i. Local Government Websites: City of Scottsdale Historic Register, no listings within 1 mile; Maricopa County Assessor, Maricopa County Flood Control District historic aerials; photographs suggest a northeast-southwest trail crossing the parcel is part of a network of recreational trails that appear in the 1950s, fading in the 1960s as houses were built.

**STATE HISTORIC PRESERVATION OFFICE
SURVEY REPORT SUMMARY FORM**

12j. Other: 7.5-minute USGS, Ariz. (1964); map depicts a northeast-southwest running, undeveloped road parallel to the wash that intersects the project area. The area where this road would occur, east of the wash, has been graded.

13. BACKGROUND RESEARCH RESULTS

13a. Previous Projects Within Study Area (1 mile buffer):

1. Project Reference Number	2. Project Name	3. Report Authors (Publication Date)
1972-005.ASM	Granite Reef Aqueduct	Kemrer et al. 1972
1979-123.ASM*	Reach 12 Granite Reef Aqueduct	Stone 1979
1985-164.ASM 7.2865.SHPO	Salt River Indian Reservation Farm Expansion Project and CAP Distribution System, Salt River Indian Community Development Survey	Quillian 1987
1992-274.ASM	Barr-Holben 80 Acre Archaeological Survey	Schroeder 1992
1996-063.ASM	38-Acre Survey at 120th Street and Via Linda	Moreno 1996
1998-216.ASM	Crossings Archeological Survey	Stubing and Mitchell 1998
1998-224.ASM	Scottsdale Survey/Stonegate Parcel	Stubing 1998
1998-586.ASM	Sierra Foothills Survey	Ellis 1998
1999-061.ASM	Sonora Vista	Stubing 1999
1999-359.ASM	121st Street and Shea	Shepard 1999
1999-366.ASM	MVS Development	Schaafsma 1999
2000-237.ASM	ICNEV Corporation Survey	Webb 2000
2000-297.ASM	Shea Boulevard and 130th Street	Jones 2000
2000-530.ASM	Villa Montessori Survey	Lindly 2000
2002-215.ASM	132nd and Gold Dust Ave. Survey	Marshall 2002
2002-216.ASM	7-Acre Survey at 124th and Via Linda	Marmaduke 2002
SHPO-2002-200	Voicestream Wireless proposed Telecommunications Site, PH10909N "Congregational Church"	Slawson 2002
2003-1523.ASM	Day Spring Development	Santos 2003
2004-788.ASM	5-Acre Survey at 128th Street and Cochise Drive	Schmidt and Lindly 2004
2006-406.ASM	Shea Boulevard and 130th Street Survey	Marshall 2005
2006-687.ASM	Cellular Communications Survey at 124th Street and Via Linda	Rainey 2006
2006-992.ASM	Shea Village Archaeological Survey	Schroeder 1994
2011-289.ASM	Desert Mountain High; Sprint Facility PH80XC106-A	Moses and Luchetta 2011
2011-636.ASM	K-H Mayo Clinic Survey	Breternitz and Robinson 2005
2013-179.ASM	Scottsdale DAS Towers; 29 proposed locations	Luchetta and Moses 2013

*The 1979-123.ASM survey corridor (now the Central Arizona Project canal) overlapped a small portion of the current project area, just at its southwestern corner; this project recorded no findings within the current project area.

13b. Previously Recorded Cultural Resources Within Study Area (1 Mile Radius).

1. Site Number/Name	2. Affiliation	3. Site Type	4. NRHP Eligibility Status	5. Associated Reference(s)
AZ U:5:143(ASM), McDowell Mountains GSM Quarry	Hohokam (circa AD 200- 1500)	Basalt quarry and habitation; historic/modern use or disturbance noted	Considered eligible, Criterion D (Recorder)	Crownover et al. 1994; Marshall 2002

**STATE HISTORIC PRESERVATION OFFICE
SURVEY REPORT SUMMARY FORM**

AZ U:5:144(ASM), Little Saddle Mountain Ground Stone Quarry Site	Hohokam (circa AD 200- 1500)	Basalt quarry; extensive waste debris with unfinished manos and trough-type metates	Considered eligible, Criterion D (Recorder)	Marshall 2002; Schroeder 1994
AZ U:5:145(ASM)	Protohistoric (AD 1500- 1950)	Rock ring "sleeping circle" with no associated artifacts	Considered eligible, Criterion D (Recorder)	Schroeder 1994
AZ U:5:222(ASM)	Indeterminate prehistoric/ protohistoric	Small lithic scatter centered around a few quartzite boulders	Considered not eligible (Recorder)	Ellis 1998
AZ U:5:223(ASM)	Euro- American (AD 1500--1950)	Short trail/ road segment	Considered not eligible (Recorder)	Ellis 1998
AZ U:5:353(ASM)	Not available	Recently recorded site; only location (UTMs) is on file with ASM	Not available	PaleoWest Project No. 14-03; no reference available

Note: No previous sites were found to overlap the current project area.

13c. Historic Buildings/Districts/Neighborhoods.

1. Property Name or Address	2. Year	3. Eligibility Status
None		

14. CULTURAL CONTEXTS

14a. Prehistoric Culture: Hohokam

14b. Protohistoric Culture: Yavapai, Apache, Onk Akimel O'odham (Pima)

14c. Indigenous Historic Culture: Onk Akimel O'odham (Pima), Xalychidom Piipaash (Maricopa), Yavapai, Apache

14d. Euro-American Culture: Euroamerican (1856--present)

15. FIELD SURVEY PERSONNEL

15a. Principal Investigator: T. Kathleen Henderson, Ph.D.

15b. Project Director: Connie A. Darby

15c. Field Crew: Connie A. Darby

15d. Fieldwork Date(s): January 9, 2019

16. SURVEY METHODS

16a. Transect Intervals: 10 m (33 ft) apart

16b. Coverage (%): 100

16c. Site Recording Criteria: ASM

16d. Ground Surface Visibility: 95 percent

STATE HISTORIC PRESERVATION OFFICE
SURVEY REPORT SUMMARY FORM

16e. Observed Disturbances: The entire natural surface landscape of the project area has been variably disturbed; the vacant parcel occurs among developed residential parcels and is proximate to the Central Arizona Project (CAP) canal. The parcel is also proximate to a wash that appears to have been somewhat modified (channelized/deepened?), possibly to facilitate drainage around local development and the CAP canal. The banks of the wash also appear to have been mechanically graded. The area where this grading has taken place coincides with the location of a 1950s–1960s road that once crossed the parcel; aerial photographs suggest this road was part of an extensive network of roads and trails that faded as the area was developed, likely part of a recreational (off-roading trail) system. Wash-side grading may have been used to erase this road/trail to mitigate any erosion associated with it. More generally, the surface of the parcel appears to have been extensively driven on in the past, vegetation is well established, but ridges formed by vehicles turning sharply are present; additionally, there is a light scatter of modern refuse across the parcel—beer and soda bottle glass, PVC conduit, small dump piles of concrete and brick chips, and timber cut-offs. The area may have been subject to dumping in the past, although it has been cleaned up as the neighborhood developed; the parcel may also have been used as a staging area during construction of neighboring houses.

17. FIELD SURVEY RESULTS

17a. No Cultural Resources Identified:

17b. Isolated Occurrences (IOs) Only: Only modern detritus was noted

17c. Number of IOs Recorded: 0

17d. Table of IOs:

1. IO Number	2. Description	3. Date Range	4. UTM's
None			

18. COMMENTS: The field survey revealed much of the surface of the project area to be previously disturbed, and no evidence of prehistoric or historical cultural materials was indicated. Any noted late historical features (road/trails) that may have crossed the project area were not observed. The numerous cultural resources surveys conducted around the project area suggest that unsurveyed areas in the vicinity are unlikely to contain large prehistoric habitation sites with undiscovered outlying loci. Additionally, while smaller sites are more likely, the colluvial nature of the local environs—that is, heavily dissected by washes and subject to water, soil, and rock movement off the McDowell Mountains—reduce the likelihood of their occurrence in such a setting. However, the erosive nature of the setting makes it more likely that significant deposits, if present, would be in some way exposed or redistributed more widely. Based on the absence of archaeological cultural material on the surface of the project area and its immediate surroundings, the potential for undiscovered prehistoric cultural resources in the project area appears highly unlikely. Survey of the parcel was required to comply with provisions codified in Chapter 46, Article VI of the Scottsdale Revised Code; Desert Archaeology finds that the project will have no effect on significant cultural resources. A certificate of No Effect is recommended for this project.

STATE HISTORIC PRESERVATION OFFICE
SURVEY REPORT SUMMARY FORM

SECTION 19. ATTACHMENTS

- 19a. Project Location Map:
- 19b. Land Jurisdiction Map: Shown on 19a
- 19c. Background Research Map(s):
- 19d. GLO Map(s): None included
- 19e. References:
- 19f. Project Overview Images:

SECTION 20. CONSULTANT CERTIFICATION

I certify the information provided herein has been reviewed for content and accuracy and all work meets applicable agency standards.

T. Kathleen Henderson

Signature

Principal Investigator

Title

SECTION 21. DISCOVERY CLAUSE

If previously unreported cultural resources are identified during project activities, all ground disturbing activities in the vicinity of the discovery shall cease until the City of Scottsdale Historic Preservation Office is notified and the nature and significance of the discovery is evaluated (Scottsdale Revised Code Section 46-134).

If human remains, funerary objects, sacred ceremonial objects, or objects of national or tribal patrimony are discovered, the state laws established for this purpose will be followed (Scottsdale Revised Code Section 46-135).

STATE HISTORIC PRESERVATION OFFICE
SURVEY REPORT SUMMARY FORM

19a. Project area location and land jurisdiction.

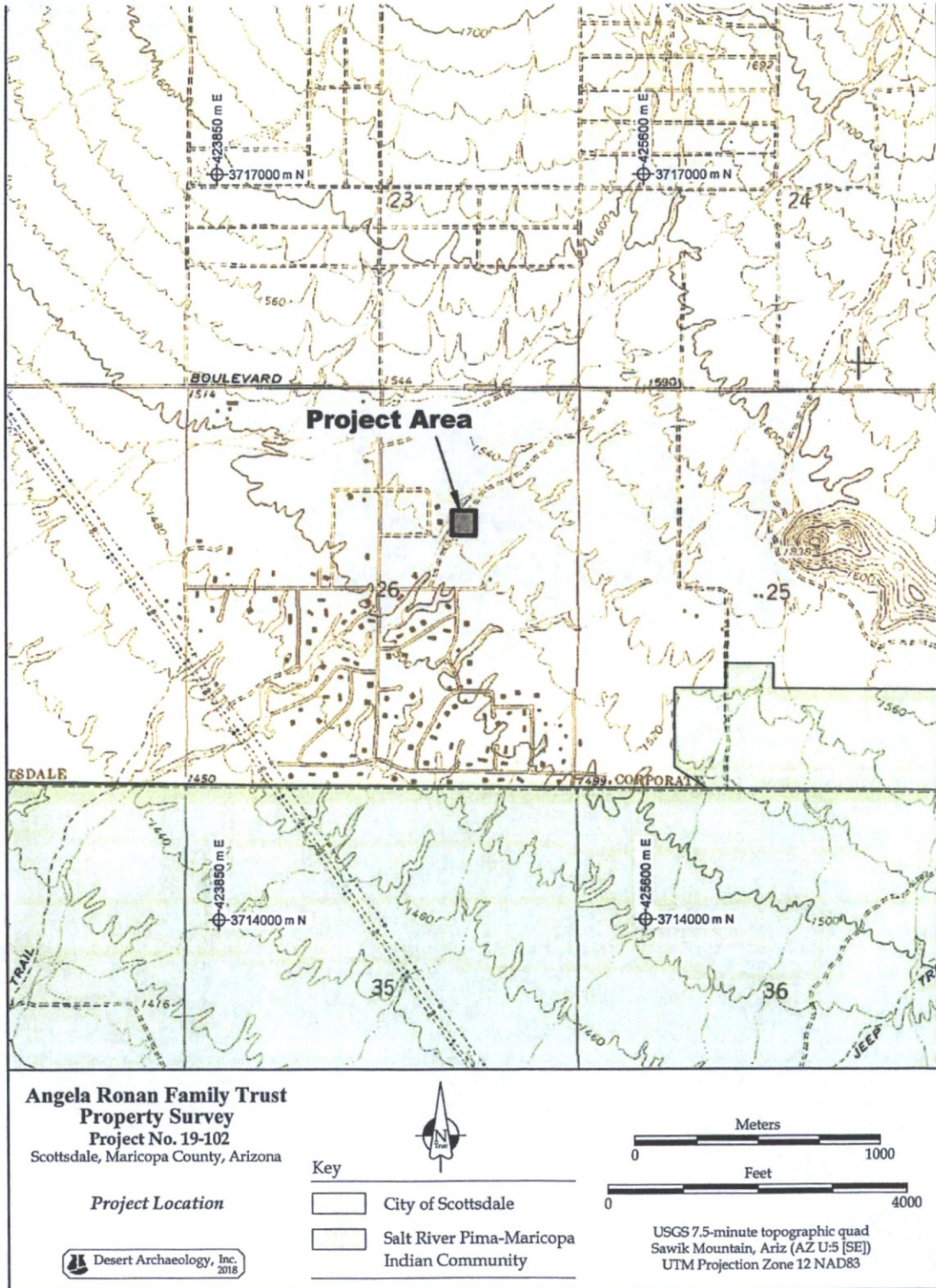

STATE HISTORIC PRESERVATION OFFICE
SURVEY REPORT SUMMARY FORM

19c. Previous cultural resources surveys conducted within 1 mile of the project area. Discrepancy between the Central Arizona Project canal and 1979-123.ASM survey area presumably reflects digitizing and processing errors embedded in the project's GIS shapefile.

Confidential
Information

**Angela Ronan Family Trust
Property Survey**
Project No. 19-102
Scottsdale, Maricopa County, Arizona

Previously Conducted Projects

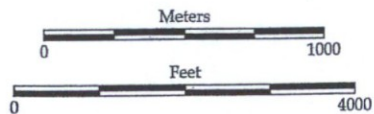

USGS 7.5-minute topographic quad
Sawik Mountain, Ariz (AZ U:5 [SE])
UTM Projection Zone 12 NAD83

STATE HISTORIC PRESERVATION OFFICE
SURVEY REPORT SUMMARY FORM

19c. Known archaeological sites within 1 mile of the project area.

Confidential
Information

Angela Ronan Family Trust
Property Survey
Project No. 19-102
Scottsdale, Maricopa County, Arizona

Previously Recorded Sites

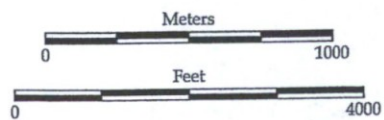

USGS 7.5-minute topographic quad
Sawik Mountain, Ariz (AZ U:5 [SE])
UTM Projection Zone 12 NAD83

STATE HISTORIC PRESERVATION OFFICE
SURVEY REPORT SUMMARY FORM

19e. REFERENCES CITED

Breternitz, Cory Dale, and Christine K. Robinson

- 2005 *A Cultural Resources Survey of Approximately 120 Acres of the Mayo Clinic Property in Scottsdale, Maricopa County, Arizona*. Technical Report No. 05-30. Soil Systems, Inc., Phoenix.

Brown, David E. (editor)

- 1994 *Biotic Communities: Southwestern United States and Northwestern Mexico*. University of Utah Press, Salt Lake City.

Crownover, C. Scott, John Rapp, and Barbara S. Macnider

- 1994 *Archaeological Investigations of AZ U:5:143(ASM), the McDowell Mountains Ground Stone Manufacturing Quarry, Scottsdale, Maricopa County*. Archaeological Consulting Services, Ltd., Tempe, Arizona.

Diehl, Allison Cohen, Connie A. Darby, and T. Kathleen Henderson

- 2009 *Class 1 Inventory of Cultural Resources on the Salt River Pima-Maricopa Indian Community, Maricopa County, Arizona*. Project Report No. 08-103. Desert Archaeology, Inc., Tucson.

Ellis, J. Grace

- 1998 *A Cultural Resources Survey of 55 Acres of Land on the Sierra Foothills Development in North Scottsdale, Maricopa County, Arizona*. Technical Report No. 98-12. Soil Systems, Inc., Phoenix.

Jones, Thomas E.

- 2000 *A Cultural Resources Survey for a Proposed Lot Split at Shea Boulevard and 130th Street, North Scottsdale, Maricopa County Arizona*. Archaeological Consulting Services, Ltd., Tempe, Arizona

Kemrer, Sandra, Sandra Schultz, and William Dodge (preparers)

- 1972 *An Archaeological Survey of the Granite-Reef Aqueduct*. Archaeological Series No. 12. Arizona State Museum, University of Arizona, Tucson.

Lindly, John M.

- 2000 *Archaeological Survey for 5 Acres at 124th Street and Shea Boulevard, Scottsdale, Arizona*. Report No. 00-101. SWCA, Inc., Phoenix.

STATE HISTORIC PRESERVATION OFFICE
SURVEY REPORT SUMMARY FORM

Luchetta, Sarah, and Jim (James) Moses

- 2013 *Cultural Resources Assessment Survey of 29 Proposed Verizon Wireless Telecommunication Facilities Known as the Scottsdale DAS Towers, Maricopa County, Arizona.* Antigua Archaeology, LLC, Prescott, Arizona.

Marmaduke, William S.

- 2002 *Cultural Resources Survey of 7 Acres Located on the Northeast Corner of 124th Street and East Via Linda, Scottsdale, Maricopa County, Arizona.* Northland Research, Inc., Tempe, Arizona.

Marshall, John T.

- 2002 *An Archaeological Survey of 5 Acres at 132nd Street and Gold Dust Avenue, Scottsdale, Maricopa County, Arizona.* Technical Report No. 02-33. Northland Research, Inc., Tempe, Arizona.

- 2005 *A Cultural Resources Survey of 4.5 Acres for the Baha'I Center and Education Complex Located Southeast of the Intersection of Shea Boulevard and 130th Street, Scottsdale, Maricopa County, Arizona.* Technical Report No. 05-104. Northland Research, Inc., Tempe, Arizona.

Moreno, Jerryll L.

- 1996 *Cultural Resource Assessment of 38 Acres Located at 120th Street and Via Linda, Scottsdale, Maricopa County, Arizona.* Archaeological Consulting Services, Ltd., Tucson.

Moses, James, and Sarah Luchetta

- 2011 *A Class I and Class III Cultural Resources Assessment Survey of the Proposed Wireless Telecommunications Facility Sprint SUSD Desert Mountain High School (PH80XC106-A) Located at 12575 East Via Linda in Scottsdale, Maricopa County, Arizona.* Antigua Archaeology, LLC, Prescott, Arizona.

Rainey, Pamela J.

- 2006 *A Cultural Resources Survey of Approximately 0.01 Acres of Municipal Land for A Cellular Communications Facility Located at 124th Street and Via Linda, Scottsdale, Maricopa County, Arizona.* Project Report No. 2006:128. Archaeological Research Services, Inc., Tempe, Arizona.

Santos, Brad

- 2003 *A Class III Cultural Resources Survey of a 10-acre Block at the Northwest Corner of Shea Boulevard and 124th Street for the Day Spring Development, City of Scottsdale, Maricopa County, Arizona.* Technical Report No. 035266. Logan Simpson Design, Inc., Tempe, Arizona.

STATE HISTORIC PRESERVATION OFFICE
SURVEY REPORT SUMMARY FORM

Schaafsma, Hoski S.

- 1999 *A Cultural Resources Survey of Approximately 10 Acres for MVS Development Company, L.L.C. North Scottsdale, Maricopa County, Arizona.* Logan Simpson Design Inc., Tempe, Arizona.

Schmidt, Cara, and John M. Lindly

- 2004 *Archaeological Survey of a 5 Acre Parcel near 124th Street and Cochise Drive in North Scottsdale, Maricopa County, Arizona.* Cultural Resources Report No. 04-159. SWCA Environmental Consultants, Phoenix.

Schroeder, Kelly J.

- 1992 *The Barr-Holben 80 Acre Archaeological Survey Located in the Southern McDowell Mountains, Scottsdale, Arizona.* Roadrunner Archaeology, Scottsdale, Arizona.

Schroeder, K. J.

- 1994 *Shea Village Archaeological Survey in Scottsdale, Arizona.* Roadrunner Archaeology & Consulting, Tempe, Arizona.

Shepard, Kristopher S.

- 1999 *Cultural Resources Survey of 7.3 Acres for the Proposed Zone 2 Reservoir Southwest of the Intersection of the Central Arizona Project Canal and Shea Boulevard, Scottsdale, Maricopa County.* Archaeological Research Services, Inc., Tempe, Arizona.

Slawson, Laurie V.

- 2002 *A Cultural Resources Inventory for a Proposed Telecommunications Site (PH10909N, Congregational Church) at 12001 East Shea Boulevard in Scottsdale, Arizona.* AZTLAN Archaeology, Inc., Tucson.

Stone, Connie L.

- 1979 *A Cultural Resource Survey of Reach 12 of the Granite Reef Aqueduct, Central Arizona Project.* Arizona State University, Tempe.

Stubing, Michael

- 1998 *Archaeological Survey of the Proposed 24 Acre Stonegate Park in Northeast Scottsdale, Maricopa County, Arizona.* Report No. 98-114. SWCA Environmental Consultants, Phoenix.
- 1999 *An Archaeological Survey of a 59 Acre Parcel for the Sonora Vista Development in Scottsdale, Maricopa County, Arizona.* Report No. 99-048. SWCA Environmental Consultants, Phoenix.

Stubing, Michael, and Douglas R. Mitchell

- 1998 *An Archaeological Survey of 6 Acres in Scottsdale, Maricopa County, Arizona.* Report No. 98-46. SWCA Environmental Consultants, Phoenix.

STATE HISTORIC PRESERVATION OFFICE
SURVEY REPORT SUMMARY FORM

Quillian, Patricia M.

1987 *An Archaeological Survey of Proposed Development Lands on the Salt River Indian Community Central Arizona Project Distribution Division.* Northland Research, Inc., Flagstaff, Arizona.

Webb, David

2000 *A Cultural Resources Survey of Two Lots Totaling 6.5 Acres, Located at the Corner of Via Linda and 122nd Street, Scottsdale, Arizona.* Technical Report No. 005241. Logan Simpson Design, Inc., Tempe, Arizona.

19f. Overview of the project area showing current surface conditions; view is to the southwest.



STATE HISTORIC PRESERVATION OFFICE
SURVEY REPORT SUMMARY FORM

19f. Overview of the project area showing current surface conditions; note the rock ridge left by grading with a bladed machine; view is to the north-northwest.

