



February 19, 2020

**Re: 7117 E. Indian School Rd. Scottsdale, AZ – Case Number: 63-PA-2020**

Dear Property Owner or Scottsdale Community Member,

Withey Morris, PLC represents PEG Companies (“PEG”) with regards to approximately 3.12 acres at or around 7117 East Indian School Road, which is located between 3rd Avenue and Indian School Road, near Marshall Way (the “Property”). See attached aerial map for your reference. The proposed mixed-use development for this site is a hotel and residential community, which will include ground level retail/restaurant space.

The site of this future development currently consists of three parcels and contains a Howard Johnson hotel, a 2-story office building, and an event center. The Property is currently zoned Central Business, Downtown Overlay (C-2, DO). PEG anticipates rezoning the Property to Downtown / Downtown Multiple Use Type-2, Planned Block Development, Downtown Overlay (D/DMU-2, PBD, DO). The proposed development is anticipated to consist of a 168-key AC Hotel by Marriott, which is expected to be 63 feet in height, a multi-family development, which is expected to be between 63 feet and 74 feet in height, and associated ground floor retail and restaurant uses. Attached is a preliminary site plan for reference.

In order to discuss this application and any questions you might have, we have scheduled an open house for Monday, March 2, 2020 from 5:30 to 6:30pm, at the Hotel Valley Ho – Dunes Room, 6850 East Main Street, Scottsdale, AZ 85251. If this date and time are not convenient, we would be happy to speak with you individually. Please feel free to contact me at 602.230.0600 or [George@WitheyMorris.com](mailto:George@WitheyMorris.com). Additionally, any questions and or comments can be directed to the city’s Project Coordinator Bryan Cluff at 480.312.2258 or [BCluff@ScottsdaleAZ.gov](mailto:BCluff@ScottsdaleAZ.gov).

We would also love to hear your preliminary feedback on this proposal and what you may consider most important when redeveloping this site. You can provide feedback by going to the following link and completing the survey: <https://www.surveymonkey.com/r/RT7PZNW> **Your input is greatly appreciated!**

In the future, you may receive notification postcards from the City regarding this case and its schedule for public hearings by the Planning Commission and City Council. Information can also be found on the City’s website at <https://www.scottsdaleaz.gov/planning-development/projects-in-process>. Thank you for your courtesy and consideration.

Regards,

WITHEY MORRIS, P.L.C.

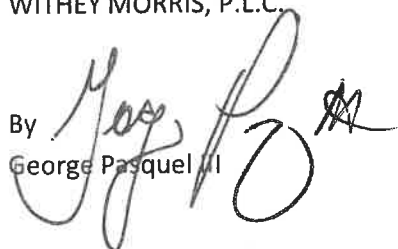
By   
George Pasquel III

Enclosure: aerial, preliminary site plan

# Aerial Map



7110 E. Indian School





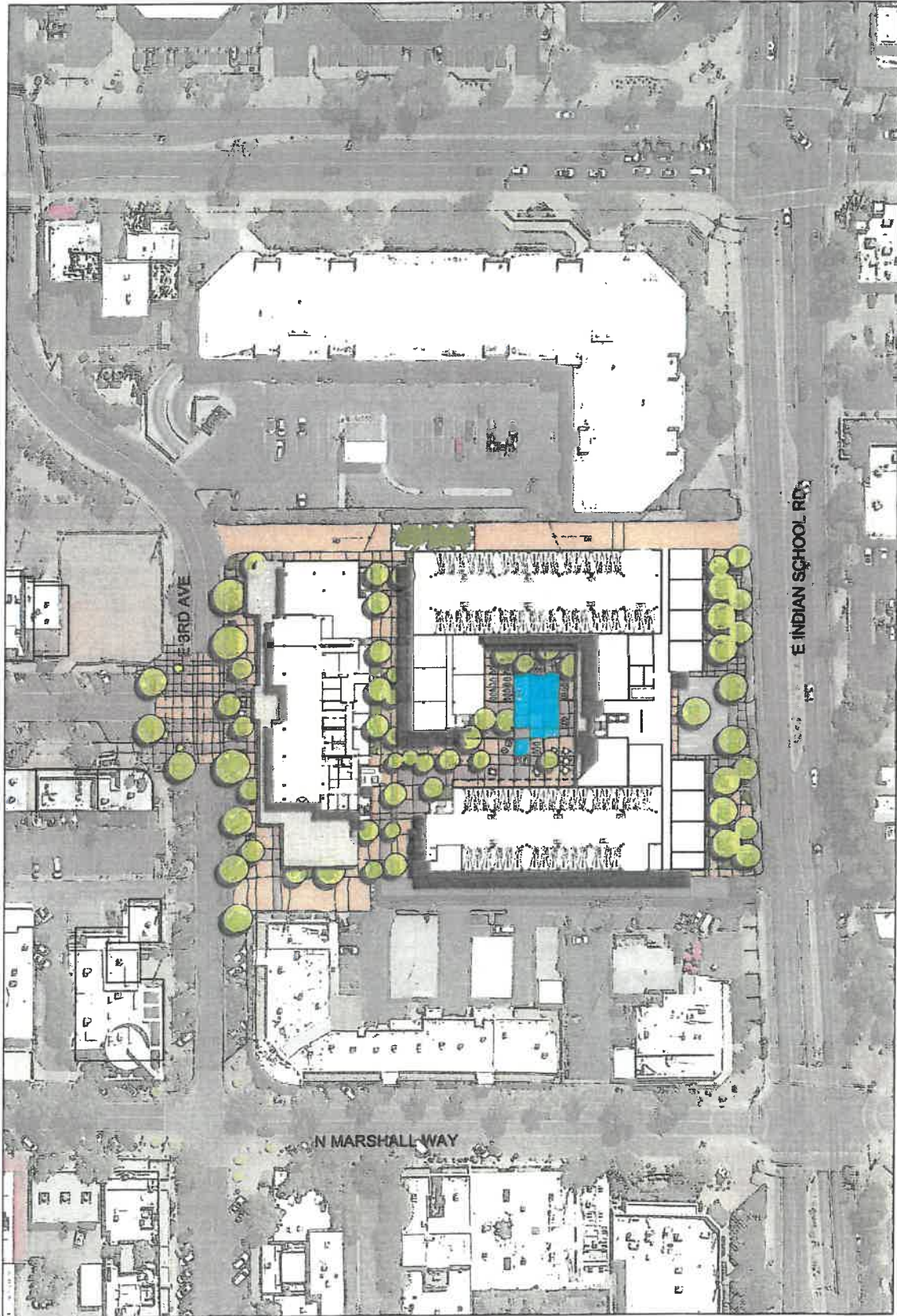

**Old Town Scottsdale - AC Hotel Mixed-Use Development**

**FFKR** | LANDSCAPE & PLANNING



Ali Fakih  
 City of Scottsdale Planning Commission  
 8280 E. Gelding Drive, Suite 101  
 Scottsdale, AZ 85260

Annette Petrillo  
 1169 E. Clovefield Street  
 Gilbert, AZ 85298

Bob Griffith  
 7127 E. Rancho Vista Dr. #4002  
 Scottsdale, AZ 85251

Carla  
 3420 N. 78th Street  
 Scottsdale, AZ 85251

Chris Schaffner  
 7346 E. Sunnyside Dr.  
 Scottsdale, AZ 85260

Christian C. Serena  
 City of Scottsdale Planning Commission  
 6929 North Hayden Road, Ste. C4194  
 Scottsdale, AZ 85250

Community Development Director  
 Town of Paradise Valley  
 6401 E Lincoln Drive  
 Paradise Valley, AZ 85253

Constance Laub  
 10105 E. Via Linda Suite 345  
 Scottsdale, AZ 85258

Dan Sommer  
 12005 N 84th Street  
 Scottsdale, AZ 85260

David G. Gulino  
 5235 N. Woodmere Fairway  
 Scottsdale, AZ 85250

Solange Whitehead  
 City of Scottsdale City Council  
 3939 N. Drinkwater Blvd.  
 Scottsdale, AZ 85251

Dr. Sonnie Kirtley  
 COGS  
 8507 East Highland Avenue  
 Scottsdale, AZ 85251

Ed Toschik, President  
 7657 E Mariposa Grande Dr  
 Scottsdale, AZ 85255

Edwin Bull  
 Burch & Cracchiolo PA  
 P.O. Box 16882  
 Phoenix, AZ 85011

Eric Gold  
 25499 N. 104th Way  
 Scottsdale, AZ 85255

Guy Phillips  
 7131 E. Cholla St.  
 Scottsdale, AZ 85254

Guy Phillips  
 City of Scottsdale City Council  
 3939 N. Drinkwater Blvd.  
 Scottsdale, AZ 85251

Howard Myers  
 6631 E Horned Owl Trail  
 Scottsdale, AZ 85266

Jim Funk  
 Gainey Ranch Community Association  
 7720 Gainey Ranch Road  
 Scottsdale, AZ 85258

Jim Haxby  
 7336 E. Sunnyside Dr.  
 Scottsdale, AZ 85260

John Berry/Michele Hammond  
 Berry Riddell, LLC  
 6750 E Camelback Rd, Ste 100  
 Scottsdale, AZ 85251

John Washington  
 3518 N. Chambers Court  
 Scottsdale, AZ 85251

Kathy Littlefield  
 City of Scottsdale City Council  
 3939 N. Drinkwater Blvd.  
 Scottsdale, AZ 85251

Kevin D. Bollinger  
 City of Scottsdale Planning Commission  
 8031 E. Sutton Drive  
 Scottsdale, AZ 85260

Larry S. Kush  
 City of Scottsdale Planning Commission  
 7127 E. Rancho Vista Dr. #1001  
 Scottsdale, AZ 85251

Leon Spiro  
 7814 E Oberlin Way  
 Scottsdale, AZ 85266

Linda Milhaven  
 City of Scottsdale City Council  
 3939 N. Drinkwater Blvd.  
 Scottsdale, AZ 85251

Linda Whitehead  
 9681 E Chuckwagon Lane  
 Scottsdale, AZ 85262

Lori Hays  
 P.O. Box 426  
 Cave Creek, AZ 85327

Maricopa County Superintendent of  
 Schools  
 4041 N. Central Avenue Suite 1200  
 Phoenix, AZ 85012



Michael Leary  
Commercial Land Development  
Consulting  
10278 East Hillery Drive  
Scottsdale, AZ 85255

Patti Badenoch  
5027 N. 71st Pl  
Scottsdale, AZ 85253

Planning & Development Director  
City of Phoenix  
200 West Washington Street, 2nd Floor  
Phoenix, AZ 85003

Planning Department  
Town of Cave Creek  
37622 N Cave Creek Road  
Cave Creek, AZ 85331

Project Management  
Arizona Department of Transportation  
205 S. 17th Avenue MD 6012E  
Phoenix, AZ 85007

Sherry Wagner/Right-of-Way  
Technician, SR.  
Mail Station PAB348  
P.O. Box 52025  
Phoenix, AZ 85072

Superintendent  
Scottsdale Unified School District  
8500 E. Jackrabbit Rd  
Scottsdale, AZ 85250

Vickie Falen  
10520 N 117th Pl  
Scottsdale, AZ 85259

Wade Tinant  
4614 E. Running Deer Trail  
Cave Creek, AZ 85331



Mike McNeal, Supervisor  
AT&T  
1231 W. University Drive  
Mesa, AZ 85201

Paul Alessio - Chair  
City of Scottsdale Planning Commission  
7527 E. Tailspin Lane  
Scottsdale, AZ 85255

Planning & Engineering Section  
Manager  
Arizona State Land Department  
1616 W. Adams Street  
Phoenix, AZ 85007

Planning Department  
SRP-MIC  
10005 E Osborn Road  
Scottsdale, AZ 85256

Randall P. Brown  
Spring Creek Development  
7144 E. Stetson Dr. #425  
Scottsdale, AZ 85251

Steve Tyrrell  
7753 E. Catalina Drive  
Scottsdale, AZ 85251

Susan McGarry  
8074 E. Theresa Drive  
Scottsdale, AZ 85255

Virginia Korte  
City of Scottsdale City Council  
3939 N. Drinkwater Blvd.  
Scottsdale, AZ 85251

Granite Reef Neighborhood Resource  
Center  
1700 N Granite Reef Road  
Scottsdale, AZ 85257



Mike Ratzken  
8725 E. Palo Verde Dr  
Scottsdale, AZ 85250

Planning & Development Department  
Maricopa County Planning &  
Development  
501 N. 44th Street, Suite 200  
Phoenix, AZ 85008

Planning and Zoning  
Town of Carefree  
8 Sundial Circle P.O. Box 740  
Carefree, AZ 85377

Prescott Smith  
City of Scottsdale Planning Commission  
4350 E. Camelback Rd., Suite G-200  
Phoenix, AZ 85018

Marissa Moore, AICP  
Town of Fountain Hills  
16705 E. Avenue of the Fountains  
Fountain Hills, AZ 85268

Superintendent  
Cave Creek Unified School District  
P.O. Box 426  
Cave Creek, AZ 85327

Suzanne Klapp  
City of Scottsdale City Council  
3939 N. Drinkwater Blvd.  
Scottsdale, AZ 85251

W.J. Jim Lane - Mayor  
City of Scottsdale City Council  
3939 N. Drinkwater Blvd.  
Scottsdale, AZ 85251

Gammage & Burnham, PLC  
2 N. Central Avenue, 15th Floor  
Phoenix, AZ 85004



Earl, Curley & Lagarde, P.C.  
3101 N. Central Avenue, Ste. 1000  
Phoenix, AZ 85012

Arizona Commerce Authority  
333 N. Central Avenue, Suite 1900  
Phoenix, AZ 85004

Maggie Keasler  
7127 E. 6th Ave.  
Scottsdale, AZ 85251

Renee J. Higgs  
City of Scottsdale Planning Commission  
15192 N. 104th Way  
Scottsdale, AZ 85255

Susan Kauffman  
11334 E. Desert Vista Rd.  
Scottsdale, AZ 85255

Patricia Van Cleave  
11378 E. Cavedale Drive  
Scottsdale, AZ 85262

Andrea Keck  
9719 E. West View Drive  
Scottsdale, AZ 85255

Steve Perone  
7474 E. Earll Dr. #108  
Scottsdale, AZ 85251

Paradise Valley Unified School District  
15002 N. 32nd Street  
Phoenix, AZ 85032

Southwest Gas Corporation  
2200 N. Central Avenue Ste 101  
Phoenix, AZ 85004



1ST AVE SCOTTSDALE LLC  
1234 E 17TH ST  
SANTA ANA, CA 92701

1ST BAPTIST CHURCH OF SCOTTSDALE  
7025 E OSBORN  
SCOTTSDALE, AZ 85251

20 PIMA PLAZA LLC  
7220 E FIRST AVE  
SCOTTSDALE, AZ 85251

4020 N SCOTTSDALE LLC  
15844 N 51ST PL  
SCOTTSDALE, AZ 85254

4141 NORTH SCOTTSDALE LLC  
1437 7TH ST  
SANTA MONICA, CA 90401

4161 CRAFTSMAN LLC  
1830 E ELLIOT RD STE 104  
TEMPE, AZ 85284

4200 MARSHALL WAY LLC  
7240 N BROOKVIEW WY  
SCOTTSDALE, AZ 85253

4211 MARSHALL LLC  
PO BOX 16438  
SEATTLE, WA 98116

4215 N WINFIELD SCOTT LLC  
206 E PORTLAND ST  
PHOENIX, AZ 85004

4221 - ASSOCIATES AZ LLC  
PO BOX 546  
OKOBOJI, IA 51355

4221-ASSOCIATES AZ LLC  
11 S CENTRAL AVE UNIT 1408  
PHOENIX, AZ 85004

4222 N MARSHALL WAY LLC  
4167 N MARSHALL WAY  
SCOTTSDALE, AZ 85251

4223 MARSHALL WAY LLC  
3219 E CAMELBACK RD STE 838  
PHOENIX, AZ 85018

4225 MARSHALL WAY LLC  
3219 E CAMELBACK RD STE 838  
PHOENIX, AZ 85018

4228 CRAFTSMAN COURT LLC  
3219 E CAMELBACK RD STE 838  
PHOENIX, AZ 85018

4234 CRAFTSMAN COURT LLC  
3219 E CAMELBACK RD STE 838  
PHOENIX, AZ 85018

4234 CRAFTSMAN COURT LLC  
3219 E CAMELBACK RD STE 838  
PHOENIX, AZ 85018

5TH & MARSHALL LLC  
6831 E 5TH AVE  
SCOTTSDALE, AZ 85251

7007 AND 7015 E 1ST AVE LLC  
6831 E 5TH AVE  
SCOTTSDALE, AZ 85251

7033 FIRST AVENUE LLC  
7022 E MAIN ST  
SCOTTSDALE, AZ 85251

7103 E MAIN LLC  
7340 E MAIN ST SUITE 200  
SCOTTSDALE, AZ 85251

7116 E FIRST AVE LLC  
7116 E 1ST AVE STE 101  
SCOTTSDALE, AZ 85251

7119 LLC  
2201 E CAMELBACK RED STE 650  
PHOENIX, AZ 85016

7150 HOLDINGS LLC  
7150 E MAIN ST  
SCOTTSDALE, AZ 85251

7165 MAIN LLC  
7169 E MAIN ST  
SCOTTSDALE, AZ 85251

ACT NINE LLC  
10575 N 99TH PL  
SCOTTSDALE, AZ 85258

ADAM'S RIB L L C  
22228 CALLE ROYALE  
SCOTTSDALE, AZ 85255

AGNESE UDINOTTI LIVING TRUST THE  
4215 N MARSHALL WAY  
SCOTTSDALE, AZ 85251

ANTHONY F SAVARESE REVOCABLE  
TRUST  
4949 E LINCOLN DR UNIT 6  
PARADISE VALLEY, AZ 85253

ANTIAGING AND WELLNESS INSTITUTE  
PLLC  
945 PLAYA DEL NORTE UNIT 5012  
TEMPE, AZ 85281

ANTIGUA INVESTMENTS INC  
 7056 E MAIN ST  
 SCOTTSDALE, AZ 85251

ARAGON-ZAGEBAYLO ROSEMARY ETAL  
 108 SOUTH RALEIGH AVE  
 ATLANTIC CITY, NJ 08401

ARCADIA FARMS LTD  
 7014 E FIRST AVE  
 SCOTTSDALE, AZ 85251

ARCERI JEFFREY/DEBRA  
 620 THOMAS ST APT 289  
 KEY WEST, FL 33040

ARTS IN OLD TOWNE LLC  
 1420 E MISSOURI AVE  
 PHOENIX, AZ 85014

BANK OF SCOTTSDALE THE  
 P O BOX 1510  
 SCOTTSDALE, AZ 85252

BATHINA MURALI N/JORI  
 1240 CANDLERIDGE DR  
 BOISE, ID 83712

BBCH LLC  
 3861 N JAKAKE DR  
 SCOTTSDALE, AZ 85251

BENJAMIN M FUNKE BENEFICIARY  
 TRUST  
 810 W HOWE ST  
 TEMPE, AZ 85281

BISHOP ON MAIN HOLDINGS LLC  
 3523 N 70TH ST  
 SCOTTSDALE, AZ 85251

BRIDGE FINANCE LLC  
 8242 E DEL CADENA DR  
 SCOTTSDALE, AZ 85258

BROOKS BUILDING INC  
 2323 W UNIVERSITY DR  
 TEMPE, AZ 85281

BROWER JAMES G TR  
 3902 N 87TH ST  
 SCOTTSDALE, AZ 85251

C & S 7070 LLC  
 11215 N 74TH ST  
 SCOTTSDALE, AZ 85260

CAMELVIEW ADVENTURES INC  
 7121 E MAIN ST  
 SCOTTSDALE, AZ 85251

CARAZ PROPERTIES/THAJA  
 GLOBA/SCHUBERTH JEAN E  
 P O BOX 8271  
 SCOTTSDALE, AZ 85252

CBOT BUILDING LLC  
 7600 E CAMELBACK RD NO 1  
 SCOTTSDALE, AZ 85251

CHAPMAN TYLER S/MARY K  
 4064 COVENT GARDEN LN  
 FRISCO, TX 75034

CITY OF SCOTTSDALE  
 3939 CIVIC CENTER PLAZA  
 SCOTTSDALE, AZ 85251

COP PROPERTIES LLC  
 7022 E MAIN ST  
 SCOTTSDALE, AZ 85251

CORLEY RICHARD/BARBARA  
 107 FOX RUN RD  
 BOLTON, MA 01740

CRAFTSMAN COURT LLC  
 9416 N 80TH PL  
 SCOTTSDALE, AZ 85258

CRAFTSMANS TABLE LLC  
 3523 N 70TH ST  
 SCOTTSDALE, AZ 85251

CRYSTAL PALACE ON MAIN LLC  
 3523 N 70TH ST  
 SCOTTSDALE, AZ 85251

CYPRESS OFFICE LLC  
 2415 E CAMELBACK RD STE 600  
 PHOENIX, AZ 85016

DAVID MICHAEL MILLER PROPERTIES  
 LLC  
 7034 E 1ST AVE  
 SCOTTSDALE, AZ 85251

DAVIS RICHARD JAMES/JEVENS  
 THOMAS J/HEATHER A  
 737 OLIVE WY UNIT 2004  
 SEATTLE, WA 98101

DSV PROPERTIES LLC  
 5635 E LINCOLN DR 22  
 PARADISE VALLEY, AZ 85320

EAST MAIN STREET PROPERTIES LLC  
 4300 N MILLER RD SUITE 104  
 SCOTTSDALE, AZ 85251

ECKMANN JULI A  
 4020 N SCOTTSDALE RD UNIT 2007  
 SCOTTSDALE, AZ 85251



EDEN ROCK REALTY LLC  
P O BOX 9787  
SCOTTSDALE, AZ 85252

EDGCOMB CONNER/JOHN L  
4020 N SCOTTSDALE RD NO 2005  
SCOTTSDALE, AZ 85251

EG AND LARA SCOTT HOUSE LLC  
3523 N 70TH ST  
SCOTTSDALE, AZ 85251

EMPEROR FUNDING 92 LLC  
5346 E CALLE DEL NORTE  
PHOENIX, AZ 85018

ERIKSSON JIMMY D  
7041 E 1ST AVE  
SCOTTSDALE, AZ 85251

FANATEL PROPERTIES INC  
4555 E MAYO BLVD UNIT 3331  
PHOENIX, AZ 85050

FARBOD GOLDWATER LLC  
4501 N SCOTTSDALE RD STE 201  
SCOTTSDALE, AZ 85251

FLOYD BUILDING L L C  
6939 FIFTH AVE  
SCOTTSDALE, AZ 85251

FLOYD INVESTMENTS LIMITED  
PARTNERSHIP  
6939 E 5TH AVE  
SCOTTSDALE, AZ 85251

FOX FARM INVESTMENTS LLC  
4400 N SCOTTSDALE RD STE 9-743  
SCOTTSDALE, AZ 85251

GDO LIMITED PARTNERSHIP LLLP  
3925 N SCOTTSDALE RD  
SCOTTSDALE, AZ 85251

GE VENTURES LLC  
1401 N CLIFFSIDE DR  
GILBERT, AZ 85234

GIDDYUP PROPERTIES LLC  
PO BOX 2055  
EUGENE, OR 97402

GILLIGAN BYPASS TRUST UNDER  
GILLIGAN FAMILY T  
PO BOX 4280  
SCOTTSDALE, AZ 85261

GOLDMAN MORRIS B/SHEILA M  
CALVANO LIVING TR  
3233 W PEORIA AVE STE 118  
PHOENIX, AZ 85029

GOLDWATER PROPERTIES LLC  
PO BOX 2055  
EUGENE, OR 97402

GREGORY DEAN TR  
PO BOX 1664  
MESA, AZ 85211

H&B AZ PROPERTIES LLC  
7130 E MAIN ST  
SCOTTSDALE, AZ 85251

HARD CORNER LLC  
5641 N 6TH ST  
PHOENIX, AZ 85012

HAYSTACK HOLDINGS LLC  
P O BOX 9787  
SCOTTSDALE, AZ 85252

HMC SUITES LIMITED PARTNERSHIP  
591 WEST PUTNAM  
GREENWICH, CT 06830

IDALEE PLAZA LLC  
3523 N 70TH ST  
SCOTTSDALE, AZ 85251

IMPECCABLE ROCKING HORSE LLC  
3523 N 70TH ST  
SCOTTSDALE, AZ 85251

ISAAC SOFFER AND DOLORES SOFFER  
FAMILY LIVING TRUST  
850 S ROBERTSON BLVD  
LOS ANGELES, CA 90035

JACLYN H KRAWCZYK DECEDENTS  
TRUST/ETAL  
6223 E CALLE REDONDA  
SCOTTSDALE, AZ 85251

JE SOUTHWEST GROUP REAL ESTATE  
LLC  
3004 N CIVIC CENTER PLZ  
SCOTTSDALE, AZ 85251

JFRCO LLC  
2000 S COLORADO BLVD SUITE 2-750  
DENVER, AZ 80222

JLB INVESTMENTS LIMITED  
PARTNERSHIP  
33 W LINGER LN  
PHOENIX, AZ 85021

JLB INVESTMENTS LTD PARTNERSHIP  
2398 E CAMELBACK RD 1100  
PHOENIX, AZ 85016

JOY TASH FAMILY REVOCABLE TRUST  
27621 VISTA DE DONS  
CAPISTRANO BEACH, CA 92624

JPMORGAN CHASE BANK NATIONAL ASSOCIATION  
1111 POLARIS PARKWAY SUITE 1E  
COLUMBUS, OH 43240

KHALIFE FAMILY TRUST  
15215 N KIERLAND BLVD UNIT 308  
SCOTTSDALE, AZ 85254

KIMSEY PROPERTIES LLLP  
P O BOX 7682  
CAVE CREEK, AZ 85327

KINGTOWN PROPERTIES LLC  
8776 E SHEA BLVD SUITE 106-310  
SCOTTSDALE, AZ 85260

KT MARSHALL WAY LLC  
7340 E MAIN ST SUITE 200  
SCOTTSDALE, AZ 85251

LAGUNA HOLDINGS L L C  
7000 E 1ST AVE  
SCOTTSDALE, AZ 85251

LARRY THOMAS HAIR LLC  
PO BOX 5344  
CAREFREE, AZ 85377

LATISA L L C  
708 CANYON RD STE 3  
SANTA FE, NM 87501

LIMMER JAMES R/KAREN E  
P O BOX 4280  
SCOTTSDALE, AZ 85261

LPW LLC  
PO BOX 39  
MAJOR, SK SOL2HO  
CANADA

MAIN STREET GALLERIES LLC  
P O BOX 14567  
SCOTTSDALE, AZ 85267

MAIN STREET PROPERTIES 7149 LLC  
4300 N MILLER RD STE 104  
SCOTTSDALE, AZ 85251

MARGE AND MAVIS LLC  
11609 N 84TH ST  
SCOTTSDALE, AZ 85260

MARSHALL MERIDIAN PROPERTIES LLC  
PO BOX 2055  
EUGENE, OR 97402

MARSHALL WAY MANAGEMENT LLC  
4015 N MARSHALL WAY  
SCOTTSDALE, AZ 85251

MCCAMPBELL WILLIAM R/SUSAN J  
2749 NW SHIELDS DR  
BEND, OR 97703

MENCONI ALEC/PIERCE COLE  
1133 W MANOR ST  
CHANDLER, AZ 85224

MILENA LLC  
8712 E VIA DE COMMERCIO  
SCOTTSDALE, AZ 85258

NELSON BARNUM INTERIORS LTD  
7135 E 1ST AVE  
SCOTTSDALE, AZ 85251

NUOVO ENTERPRISES LLC  
15900 N 78TH ST SUITE 155  
SCOTTSDALE, AZ 85251

OLD TOWN 7228 LLC  
7228 E 1ST AVE  
SCOTTSDALE, AZ 85251

OLD TOWN RETAIL LLC  
7660 FAY AVE 845  
LA JOLLA, CA 92037

PARK FIFTH AVENUE LLC  
7240 N BROOKVIEW WY  
SCOTTSDALE, AZ 85253

PCL LLC  
127 MINNIE ST STE 200  
FAIRBANKS, AK 99701

YGY PAVAROTTI LLC/YGY DOMINGO LLC  
1846 E INNOVATION PARK DR STE 100  
ORO VALLEY, AZ 85755

PINK PLAZA L.L.C.  
447 OCEAN POINT RD  
EAST BOOTHBAY, ME 04544

PMC ENTERPRISES LLC  
4414 N CIVIC CENTER PLZ STE 100  
SCOTTSDALE, AZ 85251

PONDER LEVY PROPERTIES  
7236 E 1ST AVE  
SCOTTSDALE, AZ 85251

PONSONNET HUGO D/LAURA T  
7175 E CAMELBACK RD UNIT 102-2  
SCOTTSDALE, AZ 85251

PRAIRIE SKY LLC  
1619 OVERLOOK DR  
SALINA, KS 67401

PRANTCO LLC  
130 W NORTHERN AVE  
PHOENIX, AZ 85021

RICHARD E GARCIA REVOCABLE TRUST  
9427 N 115TH PL  
SCOTTSDALE, AZ 85251

RIETZ THOMAS  
4020 N SCOTTSDALE RD NO 2008  
SCOTTSDALE, AZ 85251

ROSS FASANO REVOCABLE TRUST  
551 S HIGLEY RD  
MESA, AZ 85206

RUNDLE CENTER LLC  
4160 N SCOTTSDALE RD  
SCOTTSDALE, AZ 85251

RUPAL INVESTMENT LLC  
1890 E FLORENCE BLVD NO 6  
CASA GRANDE, AZ 85130

SAVAGE FAMILY PARTNERSHIP LTD  
7 PARLIAMENT PLACE  
DALLAS, TX 75225

SCOTTI BRIAN T  
4020 N SCOTTSDALE RD UNIT 2003  
SCOTTSDALE, AZ 85251

SCOTTSDALE CANAL PROJECT LLC  
7144 E STETSON DR UNIT 425  
SCOTTSDALE, AZ 85251

SCOTTSDALE CITY OF  
3939 CIVIC CENTER BLVD  
SCOTTSDALE, AZ 85251

SCOTTSDALE CITY OF  
7447 E INDIAN SCHOOL RD STE 100  
SCOTTSDALE, AZ 85251

SCOTTSDALE CITY OF  
7447 E INDIAN SCHOOL RD STE 205  
SCOTTSDALE, AZ 85251

SCOTTSDALE FINANCIAL CENTER  
OWNER LLC  
2001 ROSS AVE STE 2800  
DALLAS, TX 75201

SCOTTSDALE INN LLC  
PO BOX 4372  
SCOTTSDALE, AZ 85261

SCOTTSDALE TOWN OF  
3939 CIVIC CENTER BLVD  
SCOTTSDALE, AZ 85251

SEARLES WARREN L/MARY L TR  
14555 N SCOTTSDALE RD STE 140  
SCOTTSDALE, AZ 85254

SFC I OWNER LLC  
2001 ROSS AVE STE 2800  
DALLAS, TX 75201

SILVER ROBERT E/HENDRICKS BETSY  
SILVER/ROB TR  
6302 E MONTEROSA  
SCOTTSDALE, AZ 85251

SIMONSON BUILDINGS INC  
3402 N 36TH ST  
PHOENIX, AZ 85018

SLADER LLC  
7101 E INDIAN SCHOOL RD  
SCOTTSDALE, AZ 85251

SMJ PROPERTIES LLC  
4242 B CRAFTSMAN CT  
SCOTTSDALE, AZ 85251

SNOWY OWL INVESTMENTS LLC  
PO BOX 5532  
SCOTTSDALE, AZ 85261

SUNBRELLA PROPERTIES LTD  
3402 N 36TH ST  
PHOENIX, AZ 85018

TELEKEY II INVESTMENTS LLC  
1155 W RIO SALADO PKWY  
TEMPE, AZ 85281

THOSE GUYS LLC  
8161 N 51ST PL  
PARADISE VALLEY, AZ 85253

TRI-ZONE PROPERTIES LLC  
4414 N CIVIC CENTER PLAZA STE 100  
SCOTTSDALE, AZ 85251

VALLEY OF THE SUN ENTERTAINMENT  
LLC  
1345 S LEWIS ST  
ANAHEIM, CA 92805

WHITE HOUSE ON 1ST LLC  
3523 N 70TH ST  
SCOTTSDALE, AZ 85251

WILLERT LAURA T  
4020 N SCOTTSDALE RD UNIT 2011  
SCOTTSDALE, AZ 85251

WILLIAMS CADEN/BUSH JENNIFER  
4020 N SCOTTSDALE RD STE 3010  
SCOTTSDALE, AZ 85251



www.avery.com  
1-800-GO-AVERY

WINFIELD PROPERTY HOLDINGS LLC  
10230 N 64TH PLAC  
SCOTTSDALE, AZ 85253

Repliez à la hauteur afin de  
révéler le rebord Pop-up<sup>MC</sup>

Y G Y PAVAROTTI LLC  
1846E INNOVATION PARK DR STE 100  
ORO VALLEY, AZ 85755

Sens de  
chargement

Étiquettes faciles à peeler  
Utilisez le gabarit AVERY® 5160®

YGY DOMINGO LLC  
1846 E INNOVATION PARK DR STE 100  
ORO VALLEY, AZ 85755

