



February 19, 2020

Re: 7117 E. Indian School Rd. Scottsdale, AZ – Case Number: 63-PA-2020

Dear Property Owner or Scottsdale Community Member,

Withey Morris, PLC represents PEG Companies (“PEG”) with regards to approximately 3.12 acres at or around 7117 East Indian School Road, which is located between 3rd Avenue and Indian School Road, near Marshall Way (the “Property”). See attached aerial map for your reference. The proposed mixed-use development for this site is a hotel and residential community, which will include ground level retail/restaurant space.

The site of this future development currently consists of three parcels and contains a Howard Johnson hotel, a 2-story office building, and an event center. The Property is currently zoned Central Business, Downtown Overlay (C-2, DO). PEG anticipates rezoning the Property to Downtown / Downtown Multiple Use Type-2, Planned Block Development, Downtown Overlay (D/DMU-2, PBD, DO). The proposed development is anticipated to consist of a 168-key AC Hotel by Marriott, which is expected to be 63 feet in height, a multi-family development, which is expected to be between 63 feet and 74 feet in height, and associated ground floor retail and restaurant uses. Attached is a preliminary site plan for reference.

In order to discuss this application and any questions you might have, we have scheduled an open house for Monday, March 2, 2020 from 5:30 to 6:30pm, at the Hotel Valley Ho – Dunes Room, 6850 East Main Street, Scottsdale, AZ 85251. If this date and time are not convenient, we would be happy to speak with you individually. Please feel free to contact me at 602.230.0600 or George@WitheyMorris.com. Additionally, any questions and or comments can be directed to the city’s Project Coordinator Bryan Cluff at 480.312.2258 or BCluff@ScottsdaleAZ.gov.

We would also love to hear your preliminary feedback on this proposal and what you may consider most important when redeveloping this site. You can provide feedback by going to the following link and completing the survey: <https://www.surveymonkey.com/r/RT7PZNW> **Your input is greatly appreciated!**

In the future, you may receive notification postcards from the City regarding this case and its schedule for public hearings by the Planning Commission and City Council. Information can also be found on the City’s website at <https://www.scottsdaleaz.gov/planning-development/projects-in-process>. Thank you for your courtesy and consideration.

Regards,

WITHEY MORRIS, P.L.C.

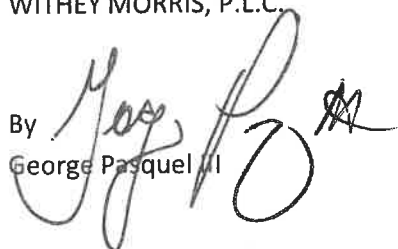
By 
George Pasquel III

Enclosure: aerial, preliminary site plan

Aerial Map



7110 E. Indian School



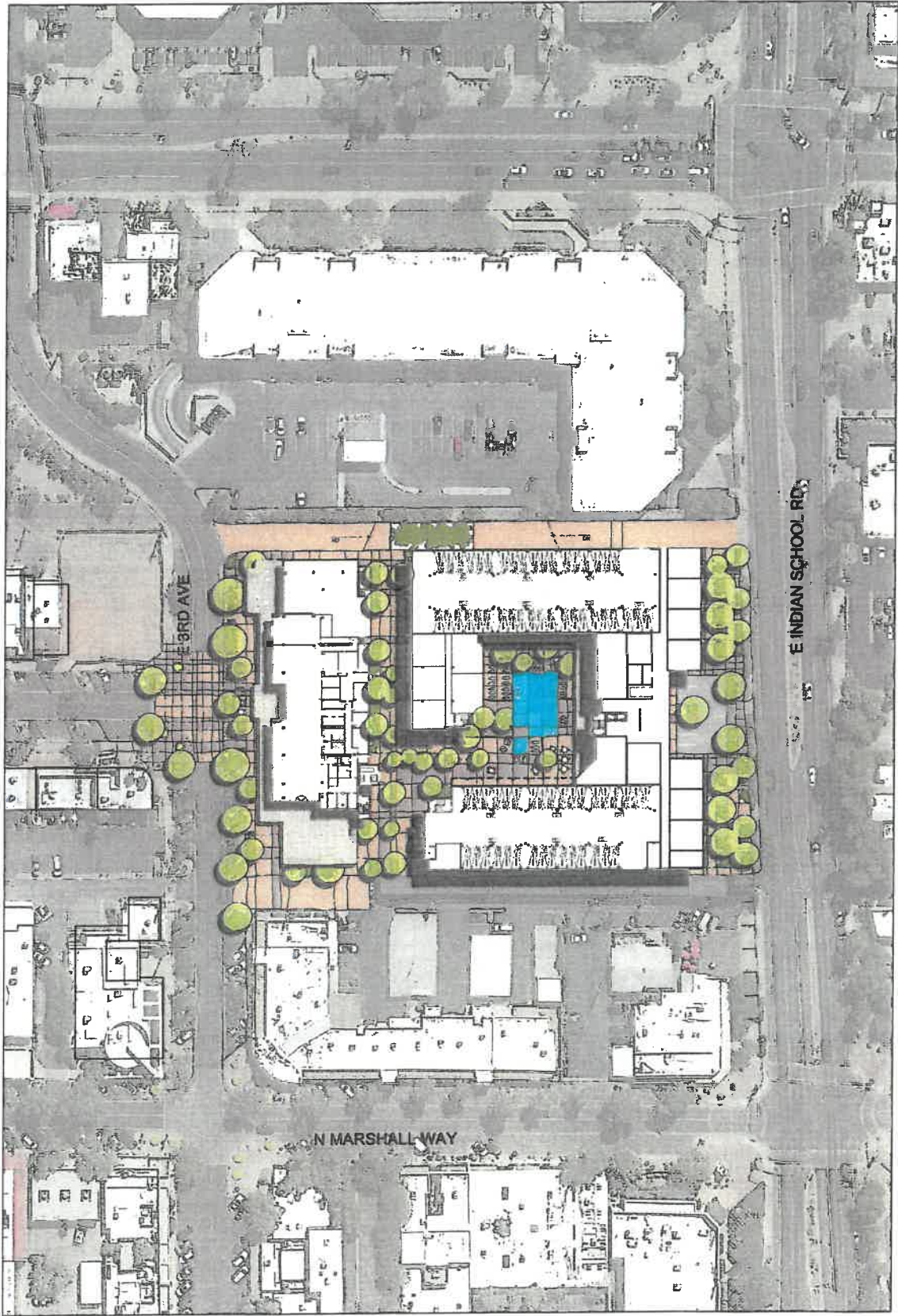

Old Town Scottsdale - AC Hotel Mixed-Use Development

FFKR | LANDSCAPE & PLANNING



Ali Fakih
City of Scottsdale Planning Commission
8280 E. Gelding Drive, Suite 101
Scottsdale, AZ 85260

Annette Petrillo
1169 E. Clovefield Street
Gilbert, AZ 85298

Bob Griffith
7127 E. Rancho Vista Dr. #4002
Scottsdale, AZ 85251

Carla
3420 N. 78th Street
Scottsdale, AZ 85251

Chris Schaffner
7346 E. Sunnyside Dr.
Scottsdale, AZ 85260

Christian C. Serena
City of Scottsdale Planning Commission
6929 North Hayden Road, Ste. C4194
Scottsdale, AZ 85250

Community Development Director
Town of Paradise Valley
6401 E Lincoln Drive
Paradise Valley, AZ 85253

Constance Laub
10105 E. Via Linda Suite 345
Scottsdale, AZ 85258

Dan Sommer
12005 N 84th Street
Scottsdale, AZ 85260

David G. Gulino
5235 N. Woodmere Fairway
Scottsdale, AZ 85250

Solange Whitehead
City of Scottsdale City Council
3939 N. Drinkwater Blvd.
Scottsdale, AZ 85251

Dr. Sonnie Kirtley
COGS
8507 East Highland Avenue
Scottsdale, AZ 85251

Ed Toschik, President
7657 E Mariposa Grande Dr
Scottsdale, AZ 85255

Edwin Bull
Burch & Cracchiolo PA
P.O. Box 16882
Phoenix, AZ 85011

Eric Gold
25499 N. 104th Way
Scottsdale, AZ 85255

Guy Phillips
7131 E. Cholla St.
Scottsdale, AZ 85254

Guy Phillips
City of Scottsdale City Council
3939 N. Drinkwater Blvd.
Scottsdale, AZ 85251

Howard Myers
6631 E Horned Owl Trail
Scottsdale, AZ 85266

Jim Funk
Gainey Ranch Community Association
7720 Gainey Ranch Road
Scottsdale, AZ 85258

Jim Haxby
7336 E. Sunnyside Dr.
Scottsdale, AZ 85260

John Berry/Michele Hammond
Berry Riddell, LLC
6750 E Camelback Rd, Ste 100
Scottsdale, AZ 85251

John Washington
3518 N. Chambers Court
Scottsdale, AZ 85251

Kathy Littlefield
City of Scottsdale City Council
3939 N. Drinkwater Blvd.
Scottsdale, AZ 85251

Kevin D. Bollinger
City of Scottsdale Planning Commission
8031 E. Sutton Drive
Scottsdale, AZ 85260

Larry S. Kush
City of Scottsdale Planning Commission
7127 E. Rancho Vista Dr. #1001
Scottsdale, AZ 85251

Leon Spiro
7814 E Oberlin Way
Scottsdale, AZ 85266

Linda Milhaven
City of Scottsdale City Council
3939 N. Drinkwater Blvd.
Scottsdale, AZ 85251

Linda Whitehead
9681 E Chuckwagon Lane
Scottsdale, AZ 85262

Lori Hays
P.O. Box 426
Cave Creek, AZ 85327

Maricopa County Superintendent of
Schools
4041 N. Central Avenue Suite 1200
Phoenix, AZ 85012



Michael Leary
Commercial Land Development
Consulting
10278 East Hillery Drive
Scottsdale, AZ 85255

Patti Badenoch
5027 N. 71st Pl
Scottsdale, AZ 85253

Planning & Development Director
City of Phoenix
200 West Washington Street, 2nd Floor
Phoenix, AZ 85003

Planning Department
Town of Cave Creek
37622 N Cave Creek Road
Cave Creek, AZ 85331

Project Management
Arizona Department of Transportation
205 S. 17th Avenue MD 6012E
Phoenix, AZ 85007

Sherry Wagner/Right-of-Way
Technician, SR.
Mail Station PAB348
P.O. Box 52025
Phoenix, AZ 85072

Superintendent
Scottsdale Unified School District
8500 E. Jackrabbit Rd
Scottsdale, AZ 85250

Vickie Falen
10520 N 117th Pl
Scottsdale, AZ 85259

Wade Tinant
4614 E. Running Deer Trail
Cave Creek, AZ 85331



Mike McNeal, Supervisor
AT&T
1231 W. University Drive
Mesa, AZ 85201

Paul Alessio - Chair
City of Scottsdale Planning Commission
7527 E. Tailspin Lane
Scottsdale, AZ 85255

Planning & Engineering Section
Manager
Arizona State Land Department
1616 W. Adams Street
Phoenix, AZ 85007

Planning Department
SRP-MIC
10005 E Osborn Road
Scottsdale, AZ 85256

Randall P. Brown
Spring Creek Development
7144 E. Stetson Dr. #425
Scottsdale, AZ 85251

Steve Tyrrell
7753 E. Catalina Drive
Scottsdale, AZ 85251

Susan McGarry
8074 E. Theresa Drive
Scottsdale, AZ 85255

Virginia Korte
City of Scottsdale City Council
3939 N. Drinkwater Blvd.
Scottsdale, AZ 85251

Granite Reef Neighborhood Resource
Center
1700 N Granite Reef Road
Scottsdale, AZ 85257

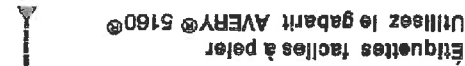

Mike Ratzken
8725 E. Palo Verde Dr
Scottsdale, AZ 85250

Planning & Development Department
Maricopa County Planning &
Development
501 N. 44th Street, Suite 200
Phoenix, AZ 85008

Planning and Zoning
Town of Carefree
8 Sundial Circle P.O. Box 740
Carefree, AZ 85377

Prescott Smith
City of Scottsdale Planning Commission
4350 E. Camelback Rd., Suite G-200
Phoenix, AZ 85018

Marissa Moore, AICP
Town of Fountain Hills
16705 E. Avenue of the Fountains
Fountain Hills, AZ 85268

Superintendent
Cave Creek Unified School District
P.O. Box 426
Cave Creek, AZ 85327

Suzanne Klapp
City of Scottsdale City Council
3939 N. Drinkwater Blvd.
Scottsdale, AZ 85251

W.J. Jim Lane - Mayor
City of Scottsdale City Council
3939 N. Drinkwater Blvd.
Scottsdale, AZ 85251

Gammage & Burnham, PLC
2 N. Central Avenue, 15th Floor
Phoenix, AZ 85004



10-ZN-2020
7/2/2020

Earl, Curley & Lagarde, P.C.
3101 N. Central Avenue, Ste. 1000
Phoenix, AZ 85012

Arizona Commerce Authority
333 N. Central Avenue, Suite 1900
Phoenix, AZ 85004

Maggie Keasler
7127 E. 6th Ave.
Scottsdale, AZ 85251

Renee J. Higgs
City of Scottsdale Planning Commission
15192 N. 104th Way
Scottsdale, AZ 85255

Susan Kauffman
11334 E. Desert Vista Rd.
Scottsdale, AZ 85255

Patricia Van Cleave
11378 E. Cavedale Drive
Scottsdale, AZ 85262

Andrea Keck
9719 E. West View Drive
Scottsdale, AZ 85255

Steve Perone
7474 E. Earll Dr. #108
Scottsdale, AZ 85251

Paradise Valley Unified School District
15002 N. 32nd Street
Phoenix, AZ 85032

Southwest Gas Corporation
2200 N. Central Avenue Ste 101
Phoenix, AZ 85004

1ST AVE SCOTTSDALE LLC
1234 E 17TH ST
SANTA ANA, CA 92701

1ST BAPTIST CHURCH OF SCOTTSDALE
7025 E OSBORN
SCOTTSDALE, AZ 85251

20 PIMA PLAZA LLC
7220 E FIRST AVE
SCOTTSDALE, AZ 85251

4020 N SCOTTSDALE LLC
15844 N 51ST PL
SCOTTSDALE, AZ 85254

4141 NORTH SCOTTSDALE LLC
1437 7TH ST
SANTA MONICA, CA 90401

4161 CRAFTSMAN LLC
1830 E ELLIOT RD STE 104
TEMPE, AZ 85284

4200 MARSHALL WAY LLC
7240 N BROOKVIEW WY
SCOTTSDALE, AZ 85253

4211 MARSHALL LLC
PO BOX 16438
SEATTLE, WA 98116

4215 N WINFIELD SCOTT LLC
206 E PORTLAND ST
PHOENIX, AZ 85004

4221 - ASSOCIATES AZ LLC
PO BOX 546
OKOBOJI, IA 51355

4221-ASSOCIATES AZ LLC
11 S CENTRAL AVE UNIT 1408
PHOENIX, AZ 85004

4222 N MARSHALL WAY LLC
4167 N MARSHALL WAY
SCOTTSDALE, AZ 85251

4223 MARSHALL WAY LLC
3219 E CAMELBACK RD STE 838
PHOENIX, AZ 85018

4225 MARSHALL WAY LLC
3219 E CAMELBACK RD STE 838
PHOENIX, AZ 85018

4228 CRAFTSMAN COURT LLC
3219 E CAMELBACK RD STE 838
PHOENIX, AZ 85018

4234 CRAFTSMAN COURT LLC
3219 E CAMELBACK RD STE 838
PHOENIX, AZ 85018

4234 CRAFTSMAN COURT LLC
3219 E CAMELBACK RD STE 838
PHOENIX, AZ 85018

5TH & MARSHALL LLC
6831 E 5TH AVE
SCOTTSDALE, AZ 85251

7007 AND 7015 E 1ST AVE LLC
6831 E 5TH AVE
SCOTTSDALE, AZ 85251

7033 FIRST AVENUE LLC
7022 E MAIN ST
SCOTTSDALE, AZ 85251

7103 E MAIN LLC
7340 E MAIN ST SUITE 200
SCOTTSDALE, AZ 85251

7116 E FIRST AVE LLC
7116 E 1ST AVE STE 101
SCOTTSDALE, AZ 85251

7119 LLC
2201 E CAMELBACK RED STE 650
PHOENIX, AZ 85016

7150 HOLDINGS LLC
7150 E MAIN ST
SCOTTSDALE, AZ 85251

7165 MAIN LLC
7169 E MAIN ST
SCOTTSDALE, AZ 85251

ACT NINE LLC
10575 N 99TH PL
SCOTTSDALE, AZ 85258

ADAM'S RIB L L C
22228 CALLE ROYALE
SCOTTSDALE, AZ 85255

AGNESE UDINOTTI LIVING TRUST THE
4215 N MARSHALL WAY
SCOTTSDALE, AZ 85251

ANTHONY F SAVARESE REVOCABLE
TRUST
4949 E LINCOLN DR UNIT 6
PARADISE VALLEY, AZ 85253

ANTIAGING AND WELLNESS INSTITUTE
PLLC
945 PLAYA DEL NORTE UNIT 5012
TEMPE, AZ 85281

ANTIGUA INVESTMENTS INC
7056 E MAIN ST
SCOTTSDALE, AZ 85251

ARAGON-ZAGEBAYLO ROSEMARY ETAL
108 SOUTH RALEIGH AVE
ATLANTIC CITY, NJ 08401

ARCADIA FARMS LTD
7014 E FIRST AVE
SCOTTSDALE, AZ 85251

ARCERI JEFFREY/DEBRA
620 THOMAS ST APT 289
KEY WEST, FL 33040

ARTS IN OLD TOWNE LLC
1420 E MISSOURI AVE
PHOENIX, AZ 85014

BANK OF SCOTTSDALE THE
P O BOX 1510
SCOTTSDALE, AZ 85252

BATHINA MURALI N/JORI
1240 CANDLERIDGE DR
BOISE, ID 83712

BBCH LLC
3861 N JAKAKE DR
SCOTTSDALE, AZ 85251

BENJAMIN M FUNKE BENEFICIARY
TRUST
810 W HOWE ST
TEMPE, AZ 85281

BISHOP ON MAIN HOLDINGS LLC
3523 N 70TH ST
SCOTTSDALE, AZ 85251

BRIDGE FINANCE LLC
8242 E DEL CADENA DR
SCOTTSDALE, AZ 85258

BROOKS BUILDING INC
2323 W UNIVERSITY DR
TEMPE, AZ 85281

BROWER JAMES G TR
3902 N 87TH ST
SCOTTSDALE, AZ 85251

C & S 7070 LLC
11215 N 74TH ST
SCOTTSDALE, AZ 85260

CAMELVIEW ADVENTURES INC
7121 E MAIN ST
SCOTTSDALE, AZ 85251

CARAZ PROPERTIES/THAJA
GLOBA/SCHUBERTH JEAN E
P O BOX 8271
SCOTTSDALE, AZ 85252

CBOT BUILDING LLC
7600 E CAMELBACK RD NO 1
SCOTTSDALE, AZ 85251

CHAPMAN TYLER S/MARY K
4064 COVENT GARDEN LN
FRISCO, TX 75034

CITY OF SCOTTSDALE
3939 CIVIC CENTER PLAZA
SCOTTSDALE, AZ 85251

COP PROPERTIES LLC
7022 E MAIN ST
SCOTTSDALE, AZ 85251

CORLEY RICHARD/BARBARA
107 FOX RUN RD
BOLTON, MA 01740

CRAFTSMAN COURT LLC
9416 N 80TH PL
SCOTTSDALE, AZ 85258

CRAFTSMANS TABLE LLC
3523 N 70TH ST
SCOTTSDALE, AZ 85251

CRYSTAL PALACE ON MAIN LLC
3523 N 70TH ST
SCOTTSDALE, AZ 85251

CYPRESS OFFICE LLC
2415 E CAMELBACK RD STE 600
PHOENIX, AZ 85016

DAVID MICHAEL MILLER PROPERTIES
LLC
7034 E 1ST AVE
SCOTTSDALE, AZ 85251

DAVIS RICHARD JAMES/JEVENS
THOMAS J/HEATHER A
737 OLIVE WY UNIT 2004
SEATTLE, WA 98101

DSV PROPERTIES LLC
5635 E LINCOLN DR 22
PARADISE VALLEY, AZ 85320

EAST MAIN STREET PROPERTIES LLC
4300 N MILLER RD SUITE 104
SCOTTSDALE, AZ 85251

ECKMANN JULI A
4020 N SCOTTSDALE RD UNIT 2007
SCOTTSDALE, AZ 85251

EDEN ROCK REALTY LLC
P O BOX 9787
SCOTTSDALE, AZ 85252

EDGCOMB CONNER/JOHN L
4020 N SCOTTSDALE RD NO 2005
SCOTTSDALE, AZ 85251

EG AND LARA SCOTT HOUSE LLC
3523 N 70TH ST
SCOTTSDALE, AZ 85251

EMPEROR FUNDING 92 LLC
5346 E CALLE DEL NORTE
PHOENIX, AZ 85018

ERIKSSON JIMMY D
7041 E 1ST AVE
SCOTTSDALE, AZ 85251

FANATEL PROPERTIES INC
4555 E MAYO BLVD UNIT 3331
PHOENIX, AZ 85050

FARBOD GOLDWATER LLC
4501 N SCOTTSDALE RD STE 201
SCOTTSDALE, AZ 85251

FLOYD BUILDING L L C
6939 FIFTH AVE
SCOTTSDALE, AZ 85251

FLOYD INVESTMENTS LIMITED
PARTNERSHIP
6939 E 5TH AVE
SCOTTSDALE, AZ 85251

FOX FARM INVESTMENTS LLC
4400 N SCOTTSDALE RD STE 9-743
SCOTTSDALE, AZ 85251

GDO LIMITED PARTNERSHIP LLLP
3925 N SCOTTSDALE RD
SCOTTSDALE, AZ 85251

GE VENTURES LLC
1401 N CLIFFSIDE DR
GILBERT, AZ 85234

GIDDYUP PROPERTIES LLC
PO BOX 2055
EUGENE, OR 97402

GILLIGAN BYPASS TRUST UNDER
GILLIGAN FAMILY T
PO BOX 4280
SCOTTSDALE, AZ 85261

GOLDMAN MORRIS B/SHEILA M
CALVANO LIVING TR
3233 W PEORIA AVE STE 118
PHOENIX, AZ 85029

GOLDWATER PROPERTIES LLC
PO BOX 2055
EUGENE, OR 97402

GREGORY DEAN TR
PO BOX 1664
MESA, AZ 85211

H&B AZ PROPERTIES LLC
7130 E MAIN ST
SCOTTSDALE, AZ 85251

HARD CORNER LLC
5641 N 6TH ST
PHOENIX, AZ 85012

HAYSTACK HOLDINGS LLC
P O BOX 9787
SCOTTSDALE, AZ 85252

HMC SUITES LIMITED PARTNERSHIP
591 WEST PUTNAM
GREENWICH, CT 06830

IDALEE PLAZA LLC
3523 N 70TH ST
SCOTTSDALE, AZ 85251

IMPECCABLE ROCKING HORSE LLC
3523 N 70TH ST
SCOTTSDALE, AZ 85251

ISAAC SOFFER AND DOLORES SOFFER
FAMILY LIVING TRUST
850 S ROBERTSON BLVD
LOS ANGELES, CA 90035

JACLYN H KRAWCZYK DECEDENTS
TRUST/ETAL
6223 E CALLE REDONDA
SCOTTSDALE, AZ 85251

JE SOUTHWEST GROUP REAL ESTATE
LLC
3004 N CIVIC CENTER PLZ
SCOTTSDALE, AZ 85251

JFRCO LLC
2000 S COLORADO BLVD SUITE 2-750
DENVER, AZ 80222

JLB INVESTMENTS LIMITED
PARTNERSHIP
33 W LINGER LN
PHOENIX, AZ 85021

JLB INVESTMENTS LTD PARTNERSHIP
2398 E CAMELBACK RD 1100
PHOENIX, AZ 85016

JOY TASH FAMILY REVOCABLE TRUST
27621 VISTA DE DONS
CAPISTRANO BEACH, CA 92624

JPMORGAN CHASE BANK NATIONAL
ASSOCIATION
1111 POLARIS PARKWAY SUITE 1E
COLUMBUS, OH 43240

KHALIFE FAMILY TRUST
15215 N KIERLAND BLVD UNIT 308
SCOTTSDALE, AZ 85254

KIMSEY PROPERTIES LLLP
P O BOX 7682
CAVE CREEK, AZ 85327

KINGTOWN PROPERTIES LLC
8776 E SHEA BLVD SUITE 106-310
SCOTTSDALE, AZ 85260

KT MARSHALL WAY LLC
7340 E MAIN ST SUITE 200
SCOTTSDALE, AZ 85251

LAGUNA HOLDINGS L L C
7000 E 1ST AVE
SCOTTSDALE, AZ 85251

LARRY THOMAS HAIR LLC
PO BOX 5344
CAREFREE, AZ 85377

LATISA L L C
708 CANYON RD STE 3
SANTA FE, NM 87501

LIMMER JAMES R/KAREN E
P O BOX 4280
SCOTTSDALE, AZ 85261

LPW LLC
PO BOX 39
MAJOR, SK S0L2H0
CANADA

MAIN STREET GALLERIES LLC
P O BOX 14567
SCOTTSDALE, AZ 85267

MAIN STREET PROPERTIES 7149 LLC
4300 N MILLER RD STE 104
SCOTTSDALE, AZ 85251

MARGE AND MAVIS LLC
11609 N 84TH ST
SCOTTSDALE, AZ 85260

MARSHALL MERIDIAN PROPERTIES LLC
PO BOX 2055
EUGENE, OR 97402

MARSHALL WAY MANAGEMENT LLC
4015 N MARSHALL WAY
SCOTTSDALE, AZ 85251

MCCAMPBELL WILLIAM R/SUSAN J
2749 NW SHIELDS DR
BEND, OR 97703

MENCONI ALEC/PIERCE COLE
1133 W MANOR ST
CHANDLER, AZ 85224

MILENA LLC
8712 E VIA DE COMMERCIO
SCOTTSDALE, AZ 85258

NELSON BARNUM INTERIORS LTD
7135 E 1ST AVE
SCOTTSDALE, AZ 85251

NUOVO ENTERPRISES LLC
15900 N 78TH ST SUITE 155
SCOTTSDALE, AZ 85251

OLD TOWN 7228 LLC
7228 E 1ST AVE
SCOTTSDALE, AZ 85251

OLD TOWN RETAIL LLC
7660 FAY AVE 845
LA JOLLA, CA 92037

PARK FIFTH AVENUE LLC
7240 N BROOKVIEW WY
SCOTTSDALE, AZ 85253

PCL LLC
127 MINNIE ST STE 200
FAIRBANKS, AK 99701

YGY PAVAROTTI LLC/YGY DOMINGO
LLC
1846 E INNOVATION PARK DR STE 100
ORO VALLEY, AZ 85755

PINK PLAZA L.L.C.
447 OCEAN POINT RD
EAST BOOTHBAY, ME 04544

PMC ENTERPRISES LLC
4414 N CIVIC CENTER PLZ STE 100
SCOTTSDALE, AZ 85251

PONDER LEVY PROPERTIES
7236 E 1ST AVE
SCOTTSDALE, AZ 85251

PONSONNET HUGO D/LAURA T
7175 E CAMELBACK RD UNIT 102-2
SCOTTSDALE, AZ 85251

PRAIRIE SKY LLC
1619 OVERLOOK DR
SALINA, KS 67401

PRANTCO LLC
130 W NORTHERN AVE
PHOENIX, AZ 85021

RICHARD E GARCIA REVOCABLE TRUST
9427 N 115TH PL
SCOTTSDALE, AZ 85251

RIETZ THOMAS
4020 N SCOTTSDALE RD NO 2008
SCOTTSDALE, AZ 85251

ROSS FASANO REVOCABLE TRUST
551 S HIGLEY RD
MESA, AZ 85206

RUNDLE CENTER LLC
4160 N SCOTTSDALE RD
SCOTTSDALE, AZ 85251

RUPAL INVESTMENT LLC
1890 E FLORENCE BLVD NO 6
CASA GRANDE, AZ 85130

SAVAGE FAMILY PARTNERSHIP LTD
7 PARLIAMENT PLACE
DALLAS, TX 75225

SCOTTI BRIAN T
4020 N SCOTTSDALE RD UNIT 2003
SCOTTSDALE, AZ 85251

SCOTTSDALE CANAL PROJECT LLC
7144 E STETSON DR UNIT 425
SCOTTSDALE, AZ 85251

SCOTTSDALE CITY OF
3939 CIVIC CENTER BLVD
SCOTTSDALE, AZ 85251

SCOTTSDALE CITY OF
7447 E INDIAN SCHOOL RD STE 100
SCOTTSDALE, AZ 85251

SCOTTSDALE CITY OF
7447 E INDIAN SCHOOL RD STE 205
SCOTTSDALE, AZ 85251

SCOTTSDALE FINANCIAL CENTER
OWNER LLC
2001 ROSS AVE STE 2800
DALLAS, TX 75201

SCOTTSDALE INN LLC
PO BOX 4372
SCOTTSDALE, AZ 85261

SCOTTSDALE TOWN OF
3939 CIVIC CENTER BLVD
SCOTTSDALE, AZ 85251

SEARLES WARREN L/MARY L TR
14555 N SCOTTSDALE RD STE 140
SCOTTSDALE, AZ 85254

SFC I OWNER LLC
2001 ROSS AVE STE 2800
DALLAS, TX 75201

SILVER ROBERT E/HENDRICKS BETSY
SILVER/ROB TR
6302 E MONTEROSA
SCOTTSDALE, AZ 85251

SIMONSON BUILDINGS INC
3402 N 36TH ST
PHOENIX, AZ 85018

SLADER LLC
7101 E INDIAN SCHOOL RD
SCOTTSDALE, AZ 85251

SMJ PROPERTIES LLC
4242 B CRAFTSMAN CT
SCOTTSDALE, AZ 85251

SNOWY OWL INVESTMENTS LLC
PO BOX 5532
SCOTTSDALE, AZ 85261

SUNBRELLA PROPERTIES LTD
3402 N 36TH ST
PHOENIX, AZ 85018

TELEKEY II INVESTMENTS LLC
1155 W RIO SALADO PKWY
TEMPE, AZ 85281

THOSE GUYS LLC
8161 N 51ST PL
PARADISE VALLEY, AZ 85253

TRI-ZONE PROPERTIES LLC
4414 N CIVIC CENTER PLAZA STE 100
SCOTTSDALE, AZ 85251

VALLEY OF THE SUN ENTERTAINMENT
LLC
1345 S LEWIS ST
ANAHEIM, CA 92805

WHITE HOUSE ON 1ST LLC
3523 N 70TH ST
SCOTTSDALE, AZ 85251

WILLERT LAURA T
4020 N SCOTTSDALE RD UNIT 2011
SCOTTSDALE, AZ 85251

WILLIAMS CADEN/BUSH JENNIFER
4020 N SCOTTSDALE RD STE 3010
SCOTTSDALE, AZ 85251

www.avery.com
1-800-GO-AVERY

WINFIELD PROPERTY HOLDINGS LLC
10230 N 64TH PLAC
SCOTTSDALE, AZ 85253

Repliez à la hauteur afin de
révéler le rebord Pop-up^{MC}

Y G Y PAVAROTTI LLC
1846E INNOVATION PARK DR STE 100
ORO VALLEY, AZ 85755

Sens de
chargement

Étiquettes faciles à peeler
Utilisez le gabarit AVERY® 5160®

YGY DOMINGO LLC
1846 E INNOVATION PARK DR STE 100
ORO VALLEY, AZ 85755

AVERY® 5160®

Bend along line to
expose Pop-up EdgemTM

Feed Paper

Use Avery® Template 5160®

10-ZN-2020

7/2/2020