



VALLEY LIGHT GALLERY
NEIGHBORHOOD NOTIFICATION

PROJECT DESCRIPTION

This is a notification regarding our upcoming filing for the Design Review Board (Pre-app number: 1006-PA-2018) for a new ground up building at the property address below. The building will be a two-story business use and will include updates to the landscaping and additional parking.

SITE INFORMATION

Location: 7120 E. Mercer Lane
Scottsdale, AZ 85254

Zoning: C-3/P-3 and P-2

Lot Area: 9,600 s.f.

Building Area: 5,126 s.f. (first floor)

4,295 s.f. (second floor)

9,421 s.f. (total)

CONTACT INFORMATION

Chris Unthank (Applicant)

Valley Light Gallery

7125 E. Mercer Lane

Scottsdale, Arizona 85254

P: 602-432-2104

E: VLGchris@valleylights.com

Bryan Cluff, Planner

City of Scottsdale

7447 E. Indian School Road

Scottsdale, Arizona 85251

P: 480.312.2258

E: bcluff@scottsdaleaz.gov

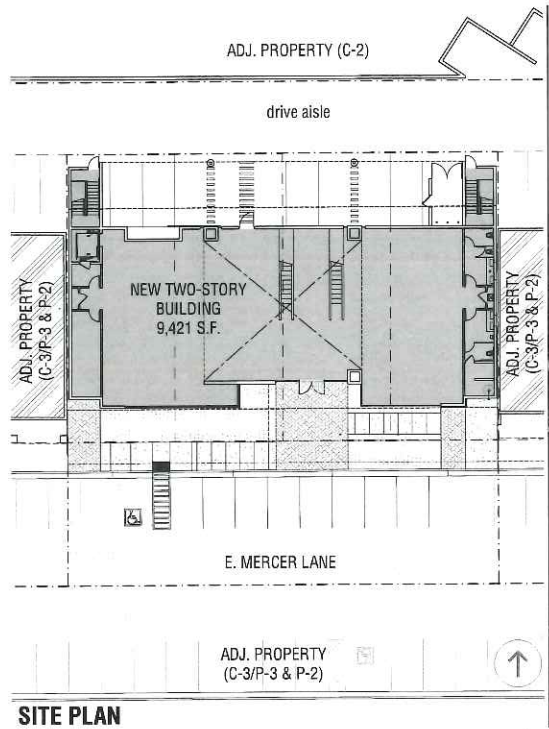

Brian Krob
 Aline Architecture . Concepts
 7340 East Main Street, #210
 Scottsdale, Arizona 85251



BRYAN CLUFF

7447 E. INDIAN SCHOOL RD., SUITE 105
 SCOTTSDALE, AZ 85251