

**BISHOP LANE**  
 2ND STREET AND BISHOP LANE  
 SCOTTSDALE, ARIZONA

OWNER:  
 THE MORGAN GROUP INC.  
 5606 S. RICE AVENUE  
 HOUSTON, TEXAS  
 77081  
 713.361.7200



NOT FOR  
 CONSTRUCTION

DATE:  
 05.20.19 REZONING  
 09.18.19 REZONING  
 RESUBMITTAL

SHEET TITLE:  
 ROOFTOP  
 LANDSCAPE PLAN

L-202

**PLANT SCHEDULE - ROOFTOP**

SYMBOLS	BOTANICAL NAME COMMON NAME	SIZE	CALIPER HT & W	QTY
<b>TREES</b>				
	<i>Parkinsonia 'Desert Museum'</i> Desert Museum Palo Verde		10'-14' HT. 8'-10' W. 4" CAL.	6
<b>ACCENTS</b>				
	<i>Agave angustifolia 'Marginata'</i> Variegated Century Plant	5 GAL.		22
	<i>Agave victoriae-reginae</i> Queen Victoria Agve	5 GAL.		9
	<i>Aloe barbadensis</i> Aloe Vera	5 GAL.		55
	<i>Echinocactus grusonii</i> Golden Barrel Cactus	5 GAL.		23
	<i>Muhlenbergia rigens</i> Deer Grass	5 GAL.		69
	<i>Pachycereus marginatus</i> Totem Pole Cactus	5 GAL.		10
	<i>Ruellia brittoniana</i> Ruellia	5 GAL.		6
<b>GROUNDCOVERS AND VINES</b>				
	<i>Setcreasea pallida</i> Purple Heart	1 GAL.		26

2 N D S T R E E T  
 ( B E L O W )

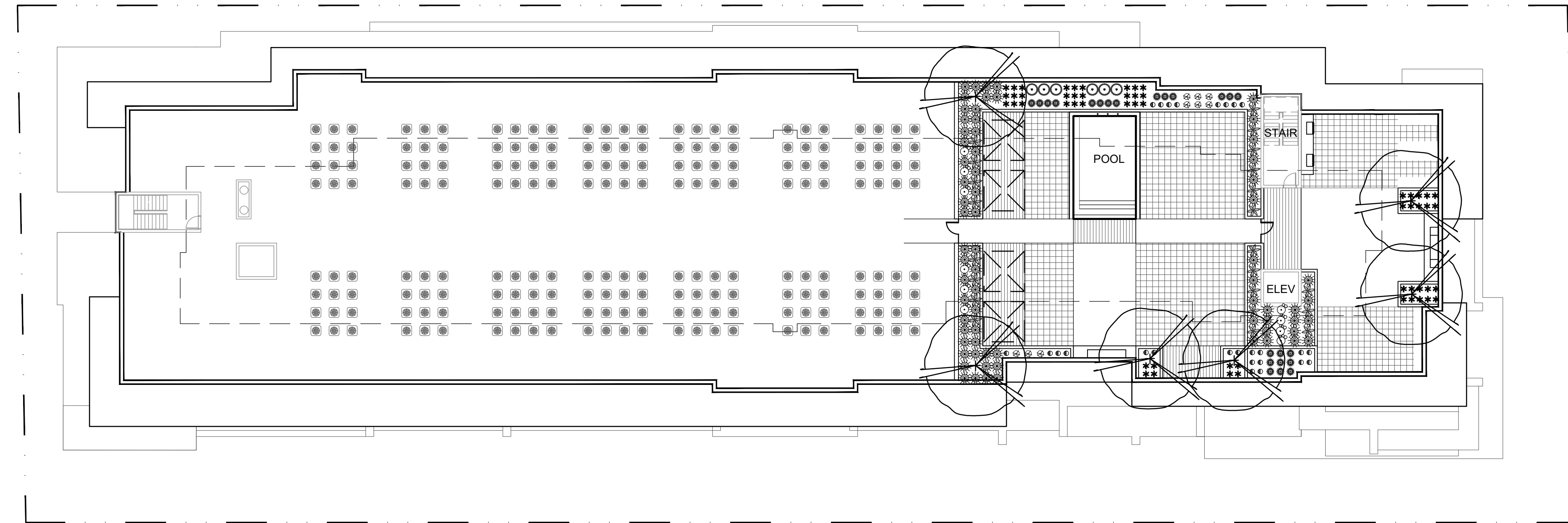

B I S H O P L A N E  
 ( B E L O W )

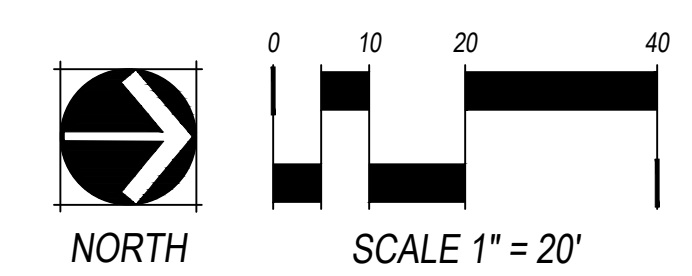

CHECKED BY: JT  
 DRAWN BY: MG/CR  
 P:\Bishop Lane - 0553-02-2033\Drawings\Construction Documents\BL\_LA-302\_LANDSCAPE.dwg  
 Sep 17, 2019 - 3:09pm