

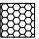

PROJECT DATA ZONING: I-1  
 NET LOT AREA: 83,680 S.F.  
 BUILDING HEIGHT: 33'

-  DENOTES FRONT OPEN SPACE 6,126 S.F. TOTAL
-  DENOTES OPEN SPACE OTHER THAN FRONTAL OPEN SPACE 10,632 S.F. TOTAL
-  DENOTES PARKING LOT LANDSCAPING 10,605 S.F. TOTAL

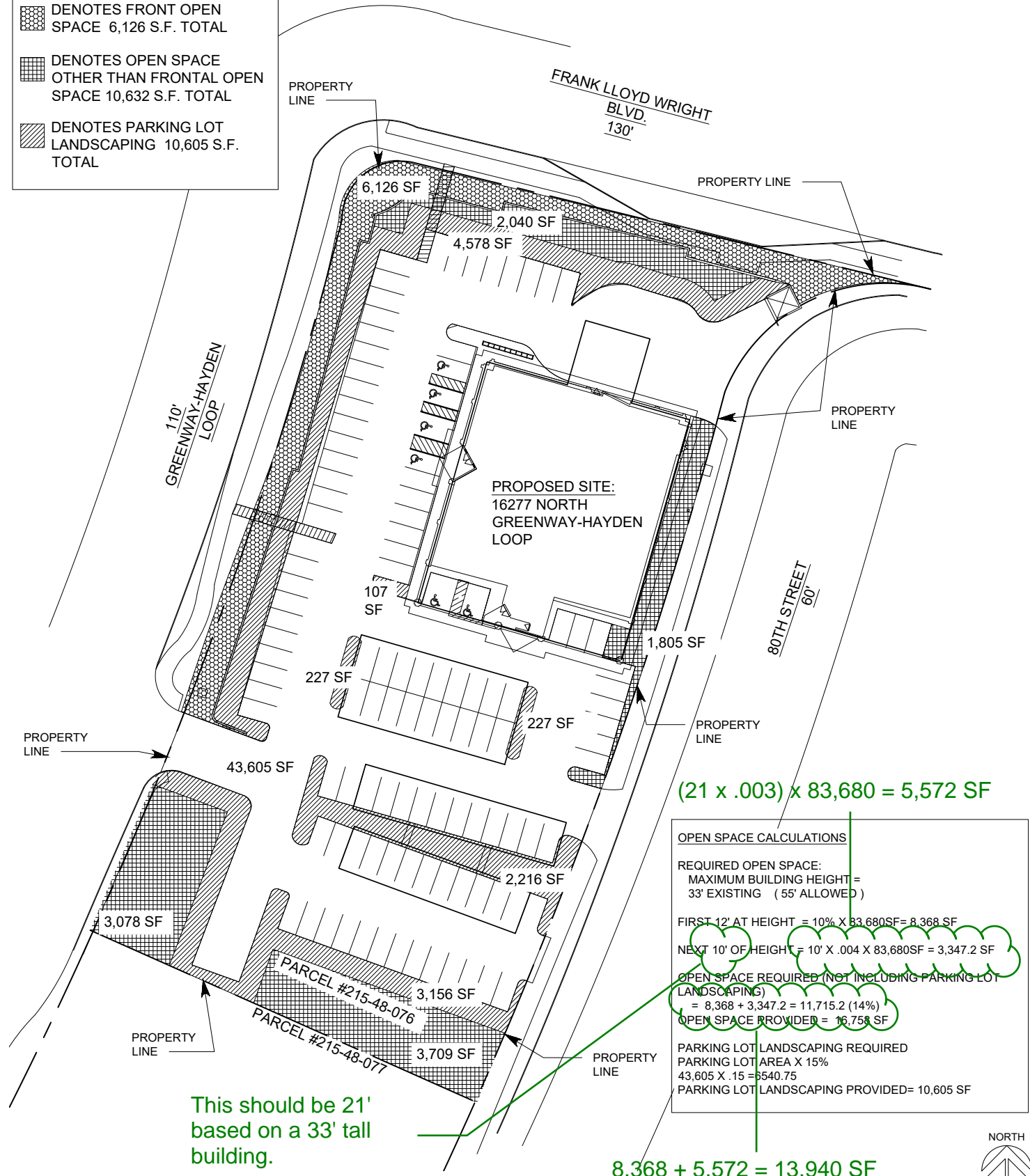

$(21 \times .003) \times 83,680 = 5,572 \text{ SF}$

**OPEN SPACE CALCULATIONS**

REQUIRED OPEN SPACE:  
 MAXIMUM BUILDING HEIGHT = 33' EXISTING (55' ALLOWED)

FIRST 12' AT HEIGHT =  $10\% \times 83,680 \text{ SF} = 8,368 \text{ SF}$

NEXT 10' OF HEIGHT =  $10' \times .004 \times 83,680 \text{ SF} = 3,347.2 \text{ SF}$

OPEN SPACE REQUIRED (NOT INCLUDING PARKING LOT LANDSCAPING)  
 =  $8,368 + 3,347.2 = 11,715.2 (14\%)$

OPEN SPACE PROVIDED = 16,758 SF

PARKING LOT LANDSCAPING REQUIRED  
 PARKING LOT AREA X 15%  
 $43,605 \times .15 = 6,540.75$   
 PARKING LOT LANDSCAPING PROVIDED = 10,605 SF

$8,368 + 5,572 = 13,940 \text{ SF}$

SCALE: 1/64" = 1'-0" (8 1/2" x 11")

