

SETBACKS: (E) TO REMAIN (NO CHANGE TO BUILDING LOCATION)

TRAFFIC GENERATION IMPACT ANALYSIS: (E) CONDITIONS TO REMAIN

PARKING: NUMBER OF PARKING SPACES PROVIDED - 112 (EXISTING TO REMAIN) 6 OF THE 112 ARE ACCESSIBLE PARKING. 3 OF THOSE 6 ARE VAN ACCESSIBLE.

BICYCLE PARKING:
2 BICYCLE SPACE FOR EVERY 10 REGULAR VEHICULAR PARKING SPACES.
112 VEHICULAR SPACES
 $112 \div 10 = 11.2$
 $12 \times 2 = (23)$ BICYCLE SPACES ARE REQUIRED)

ACTUAL BICYCLE SPACES= 20
(4) BICYCLE SPACES WILL BE ADDED

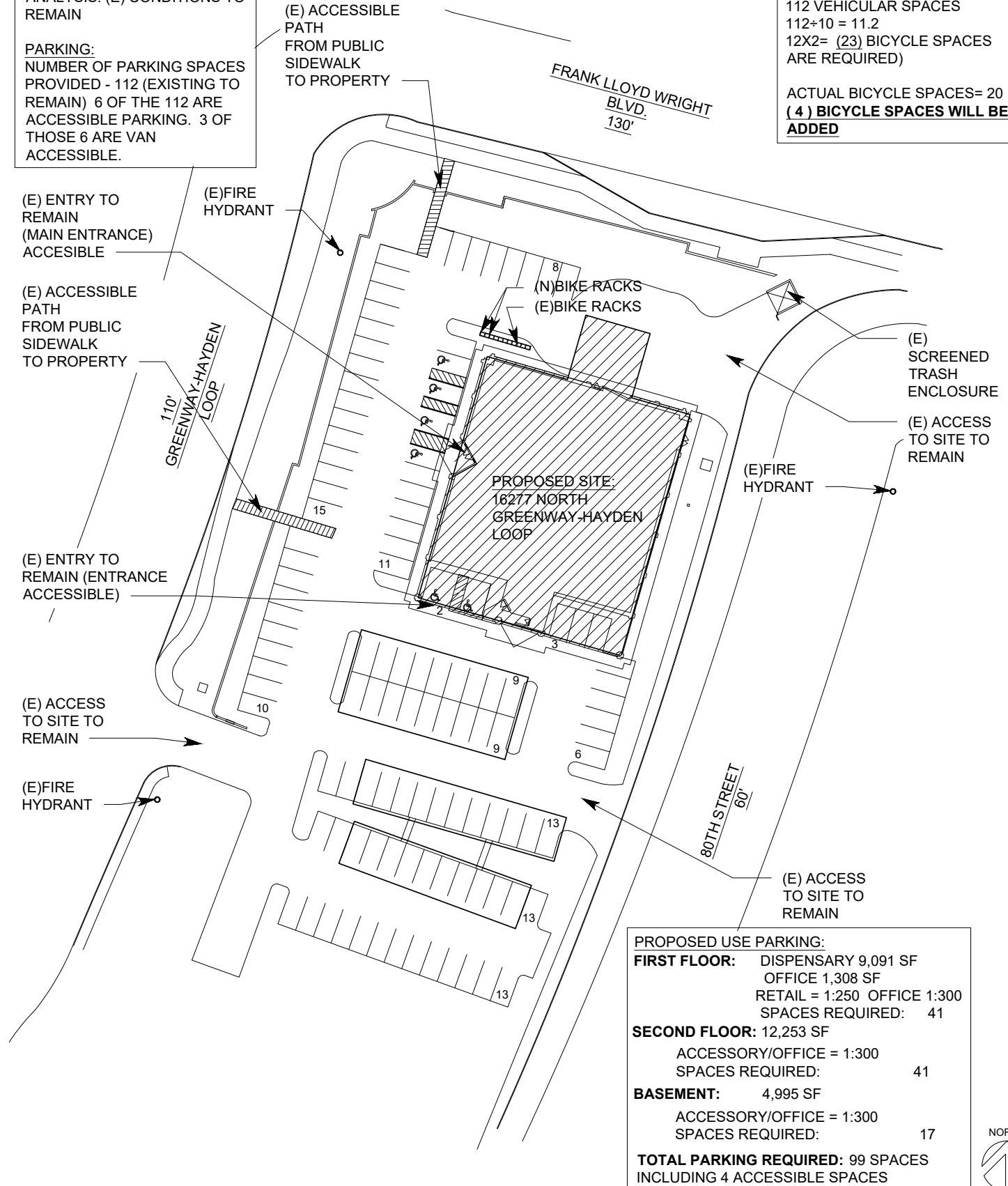

(E) ENTRY TO REMAIN (MAIN ENTRANCE) ACCESSIBLE

(E) FIRE HYDRANT

(E) ACCESSIBLE PATH FROM PUBLIC SIDEWALK TO PROPERTY

110'
GREENWAY-HAYDEN LOOP

(E) ENTRY TO REMAIN (ENTRANCE ACCESSIBLE)

(E) ACCESS TO SITE TO REMAIN

(E) FIRE HYDRANT

FRANK LLOYD WRIGHT BLVD.
130'

(N) BIKE RACKS
(E) BIKE RACKS

PROPOSED SITE:
16277 NORTH GREENWAY-HAYDEN LOOP

(E) SCREENED TRASH ENCLOSURE

(E) ACCESS TO SITE TO REMAIN

(E) FIRE HYDRANT

80TH STREET
60'

(E) ACCESS TO SITE TO REMAIN

PROPOSED USE PARKING:

FIRST FLOOR:	DISPENSARY 9,091 SF	
	OFFICE 1,308 SF	
	RETAIL = 1:250 OFFICE 1:300	
	SPACES REQUIRED:	41
SECOND FLOOR:	12,253 SF	
	ACCESSORY/OFFICE = 1:300	
	SPACES REQUIRED:	41
BASEMENT:	4,995 SF	
	ACCESSORY/OFFICE = 1:300	
	SPACES REQUIRED:	17
TOTAL PARKING REQUIRED:	99 SPACES	
	INCLUDING 4 ACCESSIBLE SPACES	

SCALE: 1/64" = 1'-0" (8 1/2" x 11")

