

DEVELOPMENT REVIEW BOARD REPORT



Meeting Date: October 21, 2021
General Plan Element: *Character and Design*
General Plan Goal: *Foster quality design that enhances Scottsdale as a unique southwestern desert community.*

ACTION

**Water Resources
North/Keep Scottsdale
Beautiful Public Art
Project
2-DR-2021**

Request for approval of the proposed location of public art enhancements, including structural monoliths, pavers, sandblasted pavement, metal attachments to bridge railing, and mural on the face of the Water Resources building.

SUMMARY

Staff Recommendation

Approve, subject to the attached stipulations (Attachment #5)

Key Issues

- None

Items for Consideration

- Conformance with Development Review Board Criteria – staff confirms
- Final Concept Design was approved by the Public Art Advisory Board on 6-10-2020
- No community input received as of the date of this report

BACKGROUND

Location: 16800 N Greenway-Hayden Loop

Zoning: The site is zoned Open Space (OS). The site primarily operates as TPC Scottsdale golf courses, but also houses a City Public Works (water facility) building.

Adjacent Uses

North: R1-5 PCD, Crown Point II residential
East: Open Space, TPC golf Course
South: C-4 & I-1, Auto Dealer and Bank
West: Open Space, TPC golf Course

Property Owner

City of Scottsdale, Central Arizona Project
(Bureau of Reclamation)

Applicant

Kim Boganey
(480) 874-4670

Architect/Designer

Flying Carpet

Engineer

KMO Engineering

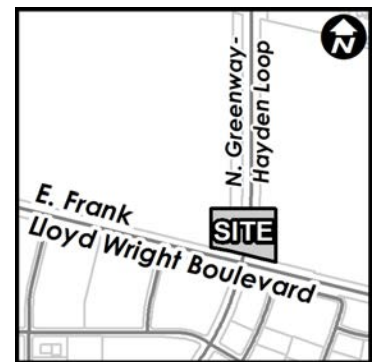

DEVELOPMENT PROPOSAL

The applicant seeks Development Review Board approval for location of the public artwork and associated hardscape, landscaping, and lighting improvements.

Development Review Board Criteria

Staff confirms that the development proposal generally meets the applicable Development Review Board Criteria. For a detailed analysis of the Criteria, please see Attachment #4.

STAFF RECOMMENDED ACTION

Staff recommends that the Development Review Board approve the Water Resources North/KSB Public Art development proposal per the attached stipulations, finding that the Development Review Criteria have been met.

RESPONSIBLE DEPARTMENTS

Planning and Development Services
Current Planning Services

STAFF CONTACTS

Casey Steinke
Planner
480-312-2611 csteinke@ScottsdaleAZ.gov

APPROVED BY



Casey Steinke, Report Author

10/7/21

Date



Brad Carr, AICP, LEED-AP, Planning & Development Area Manager
Development Review Board Liaison
Phone: 480-312-7713 Email: bcarr@scottsdaleaz.gov

10/7/2021

Date



Randy Grant, Executive Director
Planning, Economic Development, and Tourism
Phone: 480-312-2664 Email: rgrant@scottsdaleaz.gov

10/13/2021

Date

ATTACHMENTS

1. Context Aerial
2. Close-up Aerial
3. Applicant's Narrative
4. Development Review Board Criteria Analysis
5. Stipulations / Zoning Ordinance Requirements
6. Site Plan
7. Landscape Plan
8. Hardscape Plan
9. Artwork Renderings
10. Zoning Map
11. Community Involvement

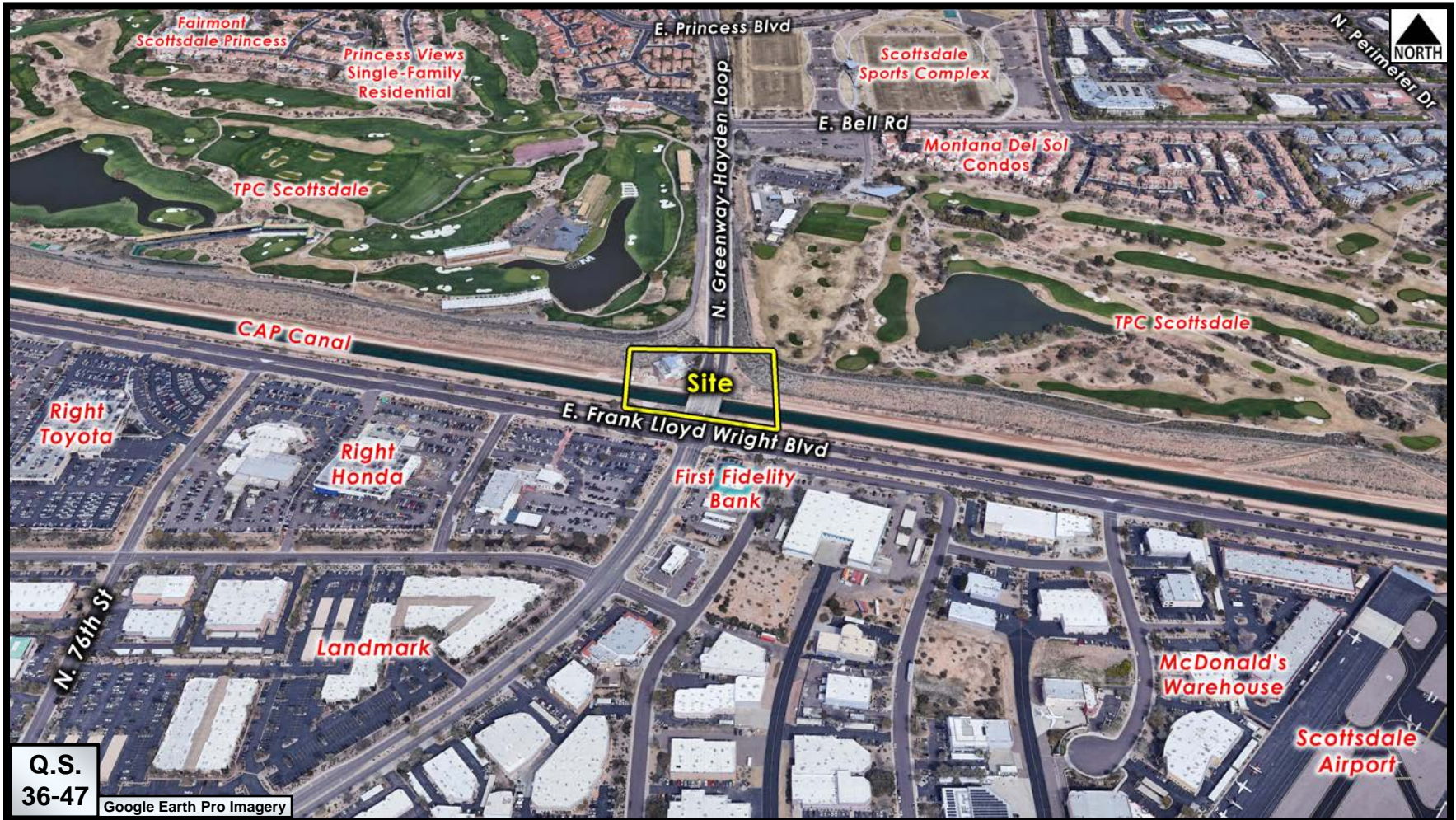

Context Aerial

2-DR-2021



Close-up Aerial

2-DR-2021

Narrative

Intersection Beautification Public Art Project

Background Information:

Scottsdale Public Art (SPA) and Keep Scottsdale Beautiful (KSB) have joined together to spearhead a Public Art project with an educational component at the prestigious north intersection of Frank Lloyd Wright Boulevard and Greenway-Hayden Loop (north Hayden Road). The goal is to turn a destitute-looking intersection into a point-of-pride for Scottsdale.

The high-traffic, northern section of this intersection is an eyesore. It is clearly visible to 65,000 drivers that traverse Frank Lloyd Wright or Hayden Road every day. Each of the pilots and passengers of the 165,000+ planes that fly in and out of the Scottsdale airport look down on this barren intersection. Many of the people who attend the Waste Management Phoenix Open Golf Tournament are exposed to it.

The project will pair public artists, Patrick Renner & Kelly O'Brien of Flying Carpet Creative Studio out of Houston, with a local team of university students to include Jessica Arnold (NAU Interior Design), Rigoberto Berber-Arias and Alan Estrada Sanchez (both ASU School of Architecture). All were selected through a public competition.

Flying Carpet Creative will produce public art for the site and collaborate with the Student Team who will add to the art project by intertwining with the theme, materials, shapes, and colors to create a cohesive look for the intersection. The students will greatly enhance their experience by working jointly with the artists and participating in the art project from start to finish.

The design team's objective is for the project to add visual interest to augment the intersection with enhancements that mesh with and highlight the unique character of the natural and urban elements that make up Scottsdale. As such, the design guidelines will be followed in terms of the city's Design Standards and Policies Manual and Sensitive Design Guidelines, as well as the MAG Supplements.

For almost four years, KSB and SPA have been working behind the scenes to bring on the partners needed to ensure the project's approval and success. Collaboration has occurred and will continue to occur with The Bureau of Reclamation, Central Arizona Project, City of Scottsdale, and the Arizona Chapter of American Society of Landscape Architects.

The project will positively impact Scottsdale residents and visitors for generations to come.

Site Details:

The site includes land from curb to canal berm on both the northeast and northwest sides of the intersection. In addition, the site has many unique uses and constraints to include:

- The water facility walls, walkways and pedestrian bridges offer opportunities for art
- The area is in a highly visible area, so the art should require minimal maintenance
- Ingress/egress areas must be maintained for equipment used during canal maintenance
- Many utility boxes are on the site
- Terrain varies greatly to include several drop-offs

Design Concept:

The Central Arizona Canal runs through the middle of the site. This unique waterway inspired the artists and students. Their design concept is – ***Water is essential for life. In the desert, this is magnified. The cholla cactus skeleton is a perfect indicator of the dichotomy between the presence and absence of water.***

The design incorporates many facets to include sculptural monoliths, a mural, pavers and sidewalk etching, bridge design and landscaping. Each reiterates the theme of water, fluidity and the cholla skeleton.

Monoliths:

The Flying Carpet Creative have designed Monoliths that are inspired by the cholla skeleton. The 5 Monolith sculptures vary in heights from one another, with max height of 16'-0". The sculpture's fabrication will consist of reinforced concrete with aggregate no more than weight 1" width. Green glass will be imbedded into one side of the monoliths, tying into the color theme used throughout. Up-lighting will be used to illuminate each structure at an angle to not cause light pollution, color temperature range 2700K-3000K. The illumination and size of the Monoliths will not interfere with air traffic regulations.

Mural:

The Mural Design will be placed on the southwest and southeast sides of both levels of Water Facility building, facing the canal. The design reflects the cholla skeleton flowing in a diagonal direction. Greens and blues have been specified as the color scheme. The building will be primed and will include a protective coat to ensure longevity of the Mural, with recommended touch-ups per muralist recommendations. Mural design reached approximately 29' in height just 1'-6" lower than roof of building. walls

Pavers, Pedestrian Bridge and Sidewalk:

The Paver, Bridge and Sidewalk design also reflect the voids of the cholla skeleton which is presented within both the Monoliths and the Mural. The fabrication of the Pavers will consist of concrete aggregate. Pavers vary in size with maximum length not to exceed 4'-6". Finish of Pavers will include finely crushed recycled green glass. The land under each Paver will be reinforced and consist of appropriate gravel for soil support. The Pavers will be fabricated using molds for shape and size consistency.

The flow continues across the Pedestrian Bridge which is a mix of sandblasted etching on the lower portion and stainless steel panels on the upper. The cholla voids drop onto the Sidewalks and allow for a continued flow of the art and also providing vehicle access onto the site. The Sidewalk design is sandblasted etchings. The depth of the etching will not exceed 1/8" per safety regulations and has been used successfully in other Scottsdale Public Art projects.

Landscape:

The Landscape Design uses minimal native vegetation with placement based on CAP requirements. The total of 4 CAP drives and other space that will be required for parking restricts the number of plants that can be located throughout the site. The southeast and southwest corners of Frank Lloyd Wright allow for additional Landscaping. Smaller groupings of plants will be placed per Planting Plan with

required 5'-0" spacing of thorny plants from sidewalk edge. The Landscaping will significantly alter the feel of the site and bring the site design a holistic feel while remaining small scale.

DEVELOPMENT REVIEW BOARD CRITERIA ANALYSIS

Per Section 1.904. of the Zoning Ordinance, in considering any application for development, the Development Review Board shall be guided by the following criteria:

Artwork Location

The location of artwork provided in accordance with the Cultural Improvement Program or Public Art Program shall address the following criteria:

- a. Accessibility to the public;
 - The proposed location of the artwork and ground improvements are accessible to the public on a pedestrian and vehicular level. The artwork will be primarily seen from north and west-bound traffic along Frank Lloyd Wright Blvd and N. Greenway-Harden Loop.
- b. Location near pedestrian circulation routes consistent with existing or future development or natural features;
 - The mural will be visible along the southern water facility façade, with landscape and hardscape improvements along existing sidewalks along the CAP Canal.
- c. Location near the primary pedestrian or vehicular entrance of a development;
 - The artwork will be located along the southern water facility façade near the Frank Lloyd Wright and N. Greenway-Hayden Loop intersection which functions as the main entrance into the TPC and water facility site.
- d. Location in conformance with the Design Standards and Policies Manual for locations affecting existing utilities, public utility easements, and vehicular sight distance requirements;
 - City staff have reviewed the artwork location and have verified that the location complies with the Design Standards and Policies Manual.
 - Site improvements vis-à-vis PUEs and SDE protections have been reviewed to the satisfaction of staff.
- e. Location in conformance to standards for public safety;
 - Staff has reviewed the site improvement areas which appear to comply with the applicable public safety requirements. The hardscape, landscape, and guard rail modifications will also undergo a final plan review by city departments prior to permitting.

Associated Improvements

The site includes land from the curb to the canal berms northeast and northwest of the site's intersection. Aside from the headline mural, the project includes five monolith structures inspired by the cholla cactus skeleton. Those influences can also be seen in the new sandblasted pavers which transcend from the sidewalk up to the bridge guardrail along the canal. There will also be associated uplighting of the monoliths. There will also be landscaping touchups based on City and CAP requirements.

**Stipulations for the
Development Review Board Application:
Water Resources North/Keep Scottsdale Beautiful Public Art
Project
Case Number: 2-DR-2021**

These stipulations are intended to protect the public health, safety, welfare, and the City of Scottsdale.

APPLICABLE DOCUMENTS AND PLANS:

1. Except as required by the Scottsdale Revised Code (SRC), the Design Standards and Policies Manual (DSPM), and the other stipulations herein, the site design and construction shall substantially conform to the following documents:
 - a. Architectural elements, including dimensions, materials, form, color, and texture shall be constructed to be consistent with the building elevations submitted by the KSB and SPA mural design team, with a city staff date of 8/6/21.
 - b. The location and configuration of all site improvements shall be consistent with the site plan submitted by KSB, with a city staff date of 8/6/21.
 - c. Landscape improvements, including quantity, size, and location shall be installed to be consistent with the preliminary landscape plan submitted by KSB, with a city staff date of 8/6/21.

SITE DESIGN:

DRB Stipulations

2. Prior to issuance of any building permit for the development project, the property owner shall submit documentation authorizing project infrastructure's location on Bureau of Reclamation land, as applicable.

LANDSCAPE DESIGN:

Ordinance

- A. If applicable, the property owner shall obtain approval of a Salvage/Native Plant Plan Application, and obtain a permit to remove any Native plants.

EXTRIOR LIGHTING:

Ordinance

- B. No exterior luminaire shall have a total initial lumen output of greater than 3050 lumens.
- C. All exterior up-lit luminaires shall be directed towards the monolith structures to mitigate light pollution.

STREET INFRASTRUCTURE:

Ordinance

- D. All street infrastructure improvements shall be constructed in accordance with this City of Scottsdale (COS) Supplement to MAG Specifications and Details, and the Design Standards and Policies Manual.
- E. Prior to the issuance of any building permit for the development project, the property owner shall submit and obtain approval of civil construction documents to construct the project.

DRB Stipulations

- 3. All curb ramps for public and pedestrian sidewalks that intersect public and private streets, or driveways that intersect public and private streets, shall have truncated domes that are colored to match Frazee Western Reserve (8617N) color, or Sherman Williams (SW7055) Enduring Bronze (246-C7).

STRUCTURAL DESIGN CRITERIA:

DESIGN CODE: 2015 INTERNATIONAL BUILDING CODE

GEOTECHNICAL REPORT IS NOT AVAILABLE. ASSUMED ALLOWABLE BEARING CAPACITY = 1,500PSF. ASSUMED FRICTION COEFFICIENT = 0.25". SITE SOIL SHALL BE COMPACTED TO A BEARING CAPACITY OF 1,500PSF.

WIND: ULTIMATE WIND SPEED, VULT = 115 MPH
NOMINAL WIND SPEED, VASD = 89.1 MPH
RISK CATEGORY "II"
WIND EXPOSURE "C"
FREESTANDING WALL PRESSURE: 38PSF

CONCRETE & REINFORCEMENT NOTES:

MATERIAL STANDARDS:

CONCRETE:
NORMAL WEIGHT AGGREGATE – ASTM C33
F'C = 4,500 PSI
MAX W/CM RATIO = 0.45

AIR CONTENT FOR EXPOSURES F1-F3 MUST MEET THE REQUIREMENTS OF TABLE 4.4.1 OF ACI 318-11. AIR-ENTRAINING ADMIXTURES SHALL CONFORM TO ASTM C260

THE CEMENT TYPE FOR EXPOSURES S1-S3 MUST MEET THE REQUIREMENTS OF TABLE 4.3.1 OF ACI 318-11. CEMENT SHALL CONFORM TO ASTM C150

CALCIUM CHLORIDE ADMIXTURE SHALL NOT BE USED

PROPER INSTALLATION OF CONCRETE IS IMPORTANT TO MINIMIZE CRACKS AND OBTAIN DESIRED CONCRETE STRENGTH.

CURING:
A MINIMUM AMOUNT OF CURING IS RECOMMENDED TO OBTAIN A DURABLE HARD CONCRETE. THIS CAN BE OBTAINED BY COVERING THE SURFACE WITH "VISQUEEN" PLASTIC IMMEDIATELY AFTER THE CONCRETE HAS HARDENED. LEAVE PLASTIC IN PLACE FOR A MINIMUM OF 7 DAYS.

COLD WEATHER:
DO NOT ALLOW SURFACE TO DRY BEFORE APPLYING "VISQUEEN" PLASTIC OR OTHER CURING MEDIUM. FOLLOW RECOMMENDATION OF ACI DOCUMENT 306 TITLED "COLD WEATHER CONCRETING". DO NOT ALLOW CONCRETE TO FREEZE FOR AT LEAST 7 DAYS.

HOT WEATHER:
AFTER CONCRETE HAS SET. FOLLOW RECOMMENDATIONS OF ACI DOCUMENT 305 TITLED "HOT WEATHER CONCRETING".

WATER SHALL NOT BE ADDED AT THE JOB SITE. IT IS THE RESPONSIBILITY OF THE CONTRACTOR TO ENSURE THAT THE MIX SUPPLIED IS WORKABLE WITHOUT ADDING WATER AT THE SITE.

CONCRETE MIX DESIGN SHALL BE COMPLETED BY A QUALIFIED LAB AND REGISTERED ENGINEER.

REINFORCING:
REBAR – ASTM A615, GRADE 60 (FY = 60 KSI MIN.)
WELDED WIRE – ASTM A1064 (FY = 65 KSI MIN.)

DETAILED REINFORCING TO COMPLY WITH ACI 315 "MANUAL OF STANDARD PRACTICE FOR DETAILING REINFORCING CONCRETE STRUCTURES" AND THE CONCRETE REINFORCING STEEL INSTITUTE (CRSI) RECOMMENDATIONS.

MINIMUM CLEAR CONCRETE COVER FOR REINFORCEMENT SHALL BE AS FOLLOWS UNLESS NOTED OTHERWISE:
CONCRETE CAST DIRECTLY AGAINST AND PERMANENTLY EXPOSED TO EARTH – 3"
CONCRETE EXPOSED TO WEATHER OR EARTH:
#5 BARS OR SMALLER – 1 ½"
#6 BARS OR LARGER – 2"

LAP SPLICE LENGTHS (UNLESS OTHERWISE NOTED) SHALL BE 54X BAR DIAMETERS FOR #6 BARS AND SMALLER. 67X BAR DIAMETERS FOR #7 BARS AND GREATER.

USE CHAIRS OR OTHER SUPPORT DEVICES AS REQUIRED FOR PROPER CLEARANCE

WELDING OF REBAR IS NOT ALLOWED. ALL EMBEDMENTS, REINFORCING, AND DOWELS SHALL BE SECURELY TIED TO FRAMEWORK OR TO ADJACENT REINFORCING PRIOR TO PLACEMENT OF THE CONCRETE. TACK WELDING OF REBAR IS NOT ALLOWED.

GROUT TUBE SHALL BE SIZED TO ACCOMMODATE INSTALLATION TOLERANCES WHILE MAINTAINING PROPER CONCRETE CLEARANCES. 5,000PSI NON-SHRINK, NON-METALLIC GROUT SHALL BE USED IN GROUT TUBES AND GROUT BED BELOW WALL. DRY PACK GROUT UNDER WALL AFTER ERECTION.

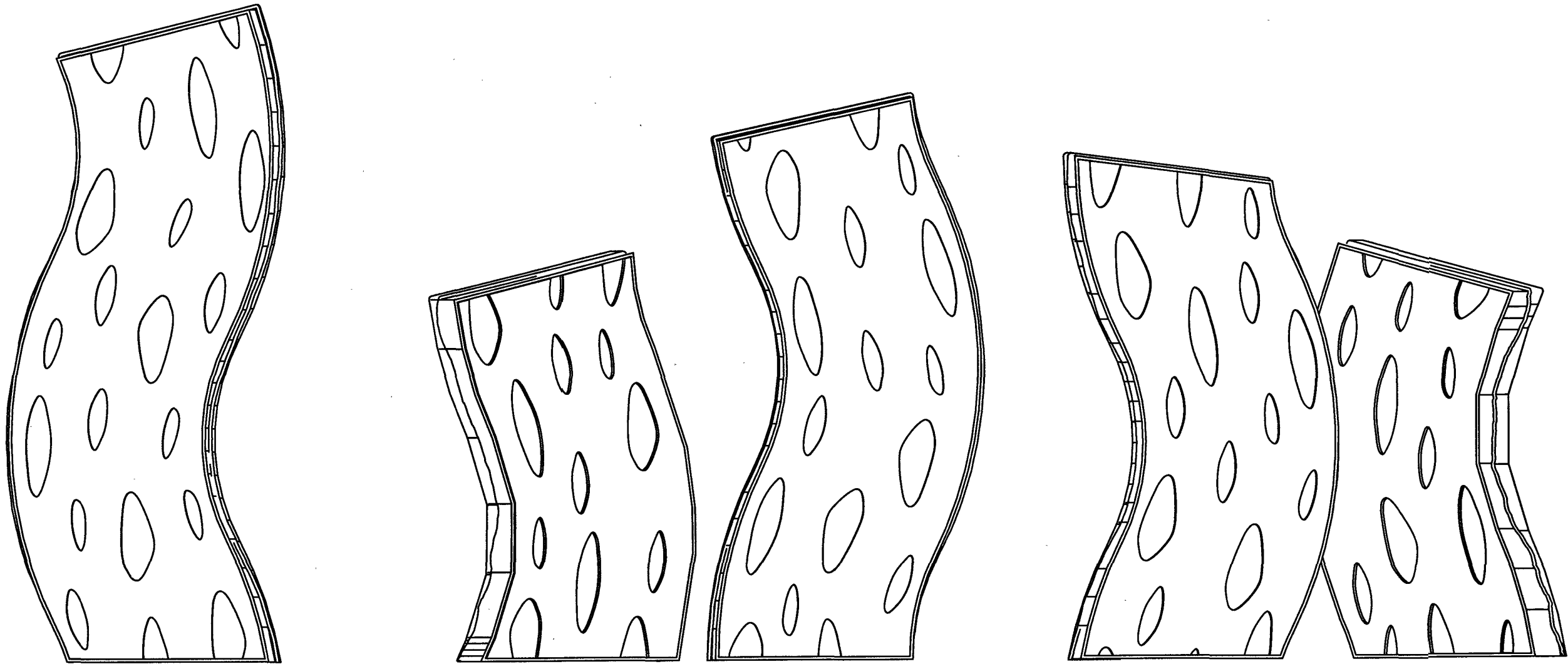

ISO - MONOLITHS
Scale 1/4" = 1'-0"

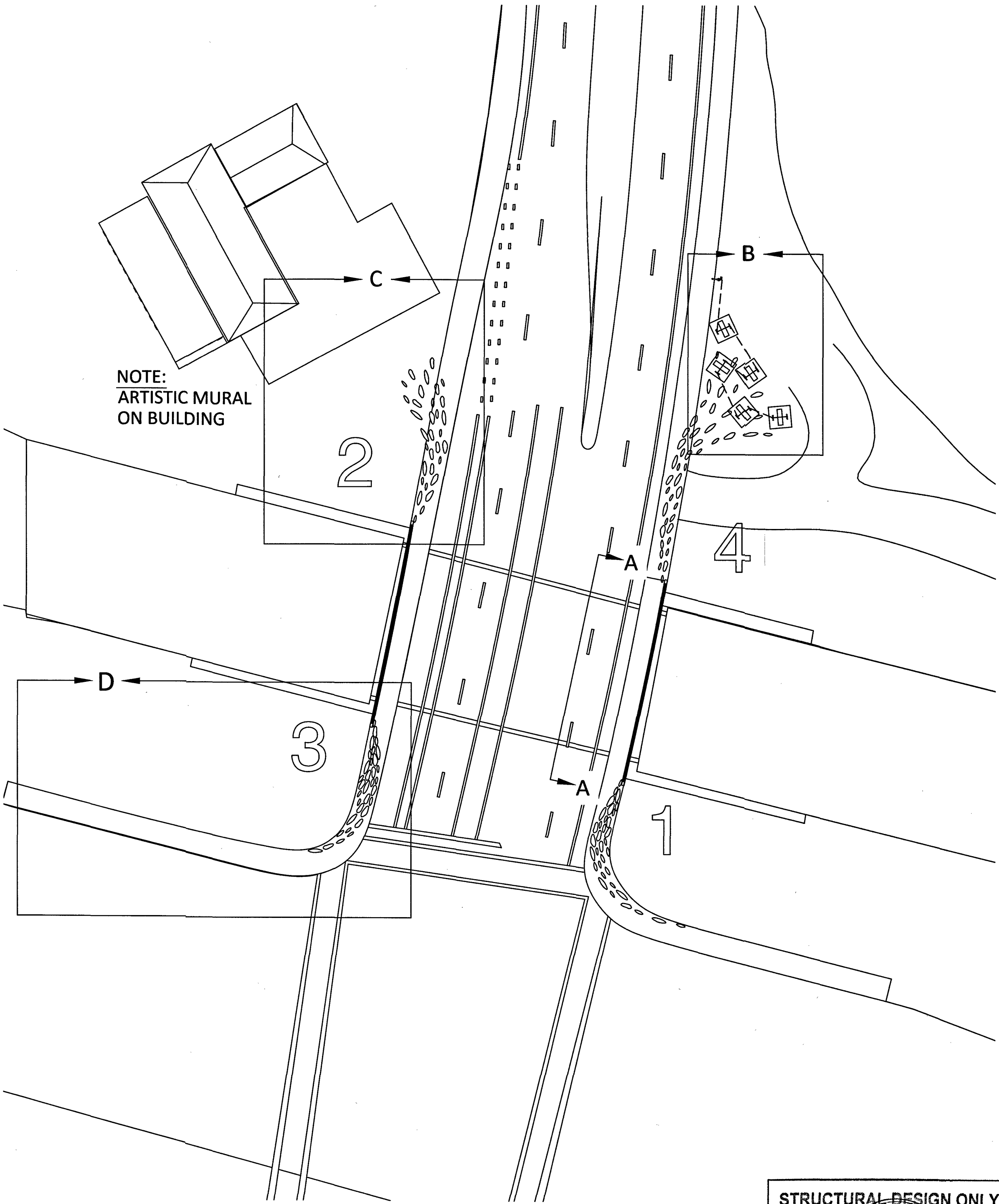

PLAN
Scale 1/32" = 1'-0"

STRUCTURAL DESIGN ONLY



DESIGN OF CONCRETE WALL AND FOOTING STRUCTURE ONLY

Gary K. Munkelt & Associates, LLC
Structural Consulting Engineers
1180 Walsh Rd, Suite 190
North Wales, PA 19454
Phone 215-855-8713 Fax 215-855-8714

SCOTTSDALE SLABS
DIKE FRONT
NORTHEAST OF N GREENWAY HAYDEN LOOP
AND E FRANKY LLOYD WRIGHT BLVD
SCOTTSDALE, AZ

ISSUE DATE:
12-06-19

REV 1	12-06-19
REV 2	03-26-20
REV 3	10-04-20
REV 4	10-21-20
REV 5	11-15-20
REV 6	05-18-21

PROJECT # 019-FC1

DRAWING NAME:
FOUNDATION
AND FORM

DRAWING NO.
019-FC1-100-01
SHT 1

Flying Carpet, LLC
3302 Polk St
Houston, TX 77003
email: Kelly@FlyingCarpetCreative.com

KWO Engineering
2020 Commerce St
Houston, TX 77002
email: kel.m.obrien@gmail.com



PLANTING PLAN

PLANT MATERIAL LEGEND	SIZE	QTY
AA Artichoke Agave (Parryi var. Truncata)	1 Gallon	15
CP Mexican Bird of Paradise (Caesalpinia Pulcherrim)	5 Gallon	5
EG Golden Barrel Cactus (Echinocactus Grusonii)	5 Gallon	8
FS Ocotillo (Fouquieria Splendens)	10 Cane	8
FW Compass Barrel Cactus (Ferocactus Wislizeni)	1 Gallon	8
ST Purple Prickly Pear (Stenocereus Thurberi)	5 Gallon	9
1-4 4 Corners of Various Landscaping		
Irrigation will be brought from lateral lines from nearest existing flush valves. On-site Walk through to confirm irrigation accessibility completed on 4.7.2021.		
4 Corners have irrigation access with permissions from City of Scottsdale & CAP.		
*All Measurements must be verified On Site by Landscape Architect prior to final permitting & installation. Landscape Design Firm will correct grading of landscape as needed.		

MODERN SOUTHWEST - TEAM 333
16800 N. GREENWAY HAYDEN LOOP
SCOTTSDALE, AZ 85255
JA2889@NAU.EDU

PROJECT CONTACTS
JESSICA ARNOLD - 949.395.5842 - JA2889@NAU.EDU
RIGO BERBER-ARIAS - RBERBERA@ASU.EDU
ALAN ESTRADA - AESTRA38@ASU.EDU
CHRISTINE IRISH - CHRISTINE.IRISH@CRANCHINC.COM
KEVIN VAUGHAN-BRUBAKER - KEVINV@SCOTTSDALEARTS.ORG

SCOTTSDALE SLABS - FLYING CARPET CREATIVE
KEEP SCOTTSDALE BEAUTIFUL PROJECT
SITE/ CANAL INTERSECTION BEAUTIFICATION
FRANK LLOYD WRIGHT @ GREENWAY HAYDEN LOOP

ISSUE DATE:
04/07/2021
REV: 3
LANDSCAPING
PLANTING PLAN
SCOTTSDALE
SLABS
SCALE: 1/32"=1'-0"

Flying Carpet, LLC
3302 Polk St
Houston, TX 77003
email: Kelly@FlyingCarpetCreative.com

KMO Engineering
2020 Commerce, Ste B
Houston, TX 77002
email: kel.m.obrien@gmail.com

SCOTTSDALE SLABS
DIKE FRONT
NORTHEAST OF N GREENWAY HAYDEN LOOP
AND E FRANK LLOYD WRIGHT BLVD
SCOTTSDALE, AZ

ISSUE DATE:
12-20-19

REV 1 12-20-19
REV 2 03-29-20
REV 3 10-04-20
REV 4 10-21-20
REV 5 11-15-20
REV 6 05-18-21

PROJECT # 019-FC1

DRAWING NAME:
LANDSCAPING
PLANTING PLAN

DRAWING NO.
019-FC1-100-01
SHT 7

Sandblast Treatment Concrete Sidewalks & Bridge

Locations

Locations

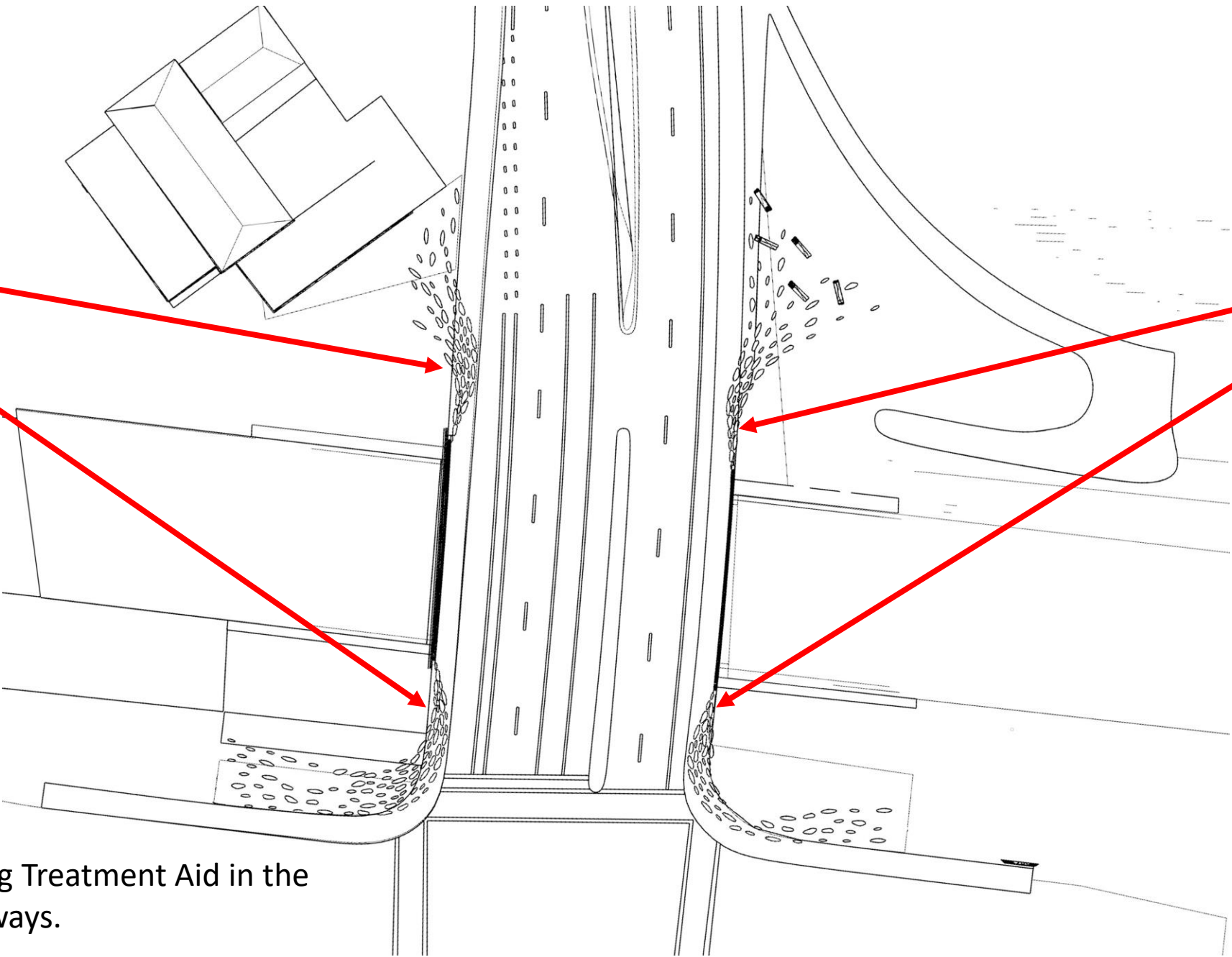

Placement of Sandblasting Treatment Aid in the functioning of CAP Driveways.

Sandblast Etching not to exceed 1/8" Depth.

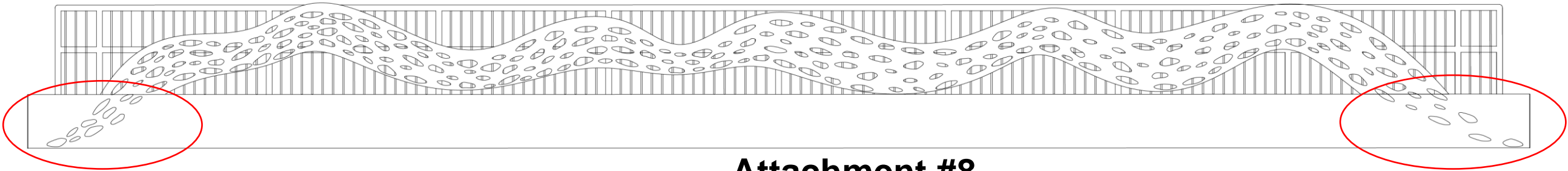

Flying Carpet, LLC
3302 Polk St
Houston, TX 77003
email: Kelly@FlyingCarpetCreative.com

KMO Engineering
2020 Commerce, Ste B
Houston, TX 77002
email: kel.m.dorland@gmail.com

SCOTTSDALE SLABS
DIKE FRONT
NORTHEAST OF N GREENWAY HAYDEN LOOP
AND E FRANKY LLOYD WRIGHT BLVD
SCOTTSDALE, AZ

ISSUE DATE:
12-20-19

REV 1	12-20-19
REV 2	03-29-20
REV 3	10-04-20

PROJECT # 019-FC1

DRAWING NAME:

DRAWING NAME:

2-DR-2021
2/4/2021

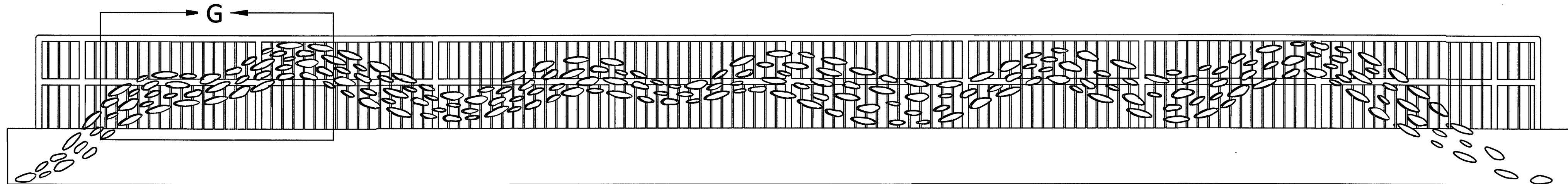

SECTION A-A
Scale 1/4" = 1'-0"

AESTHETIC BRIDGE PANELS WILL BE COMPOSED BY THE ARTIST ON SITE DURING INSTALLATION.

11 GA STAINLESS STEEL SHEET PEBBLES ATTACHED TO PANELS. EACH PANEL WILL BE WELDED TO GUARDRAIL AT TWO LOCATIONS WITH A 0.75" MIN STITCH WELD

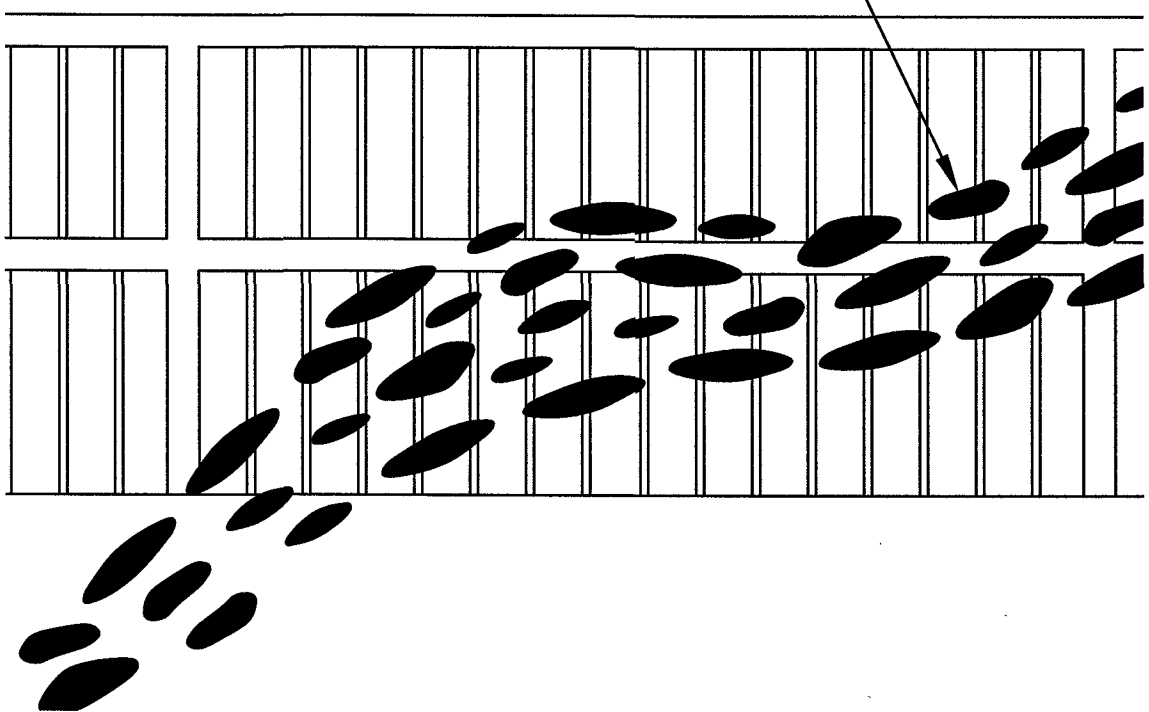

DETAIL G
Scale 1/2" = 1'-0"

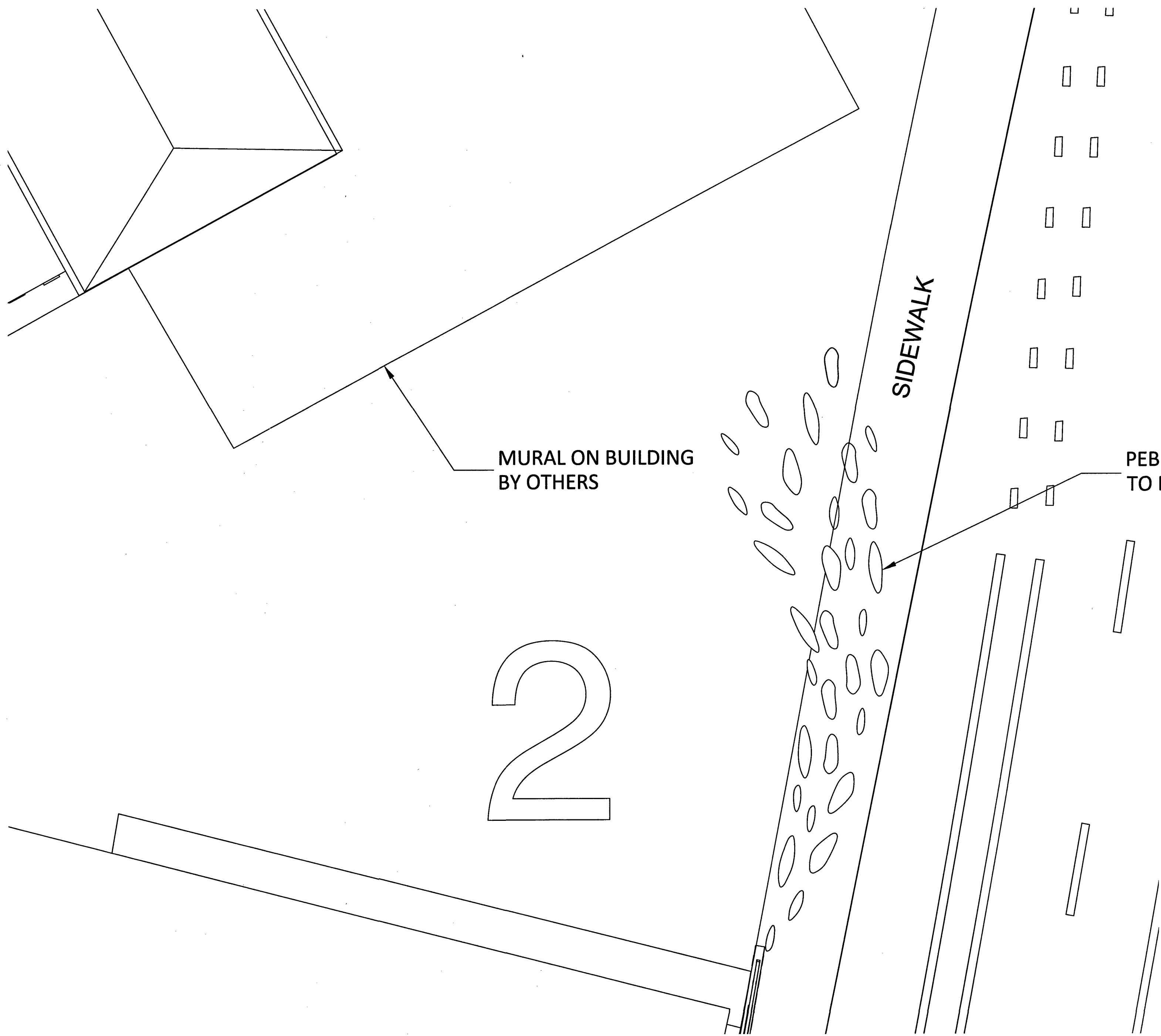

DETAIL C
Scale 1/8" = 1'-0"

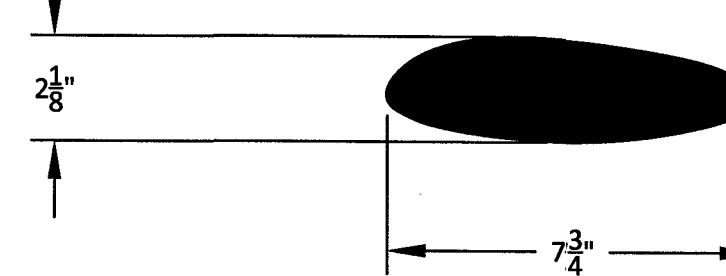
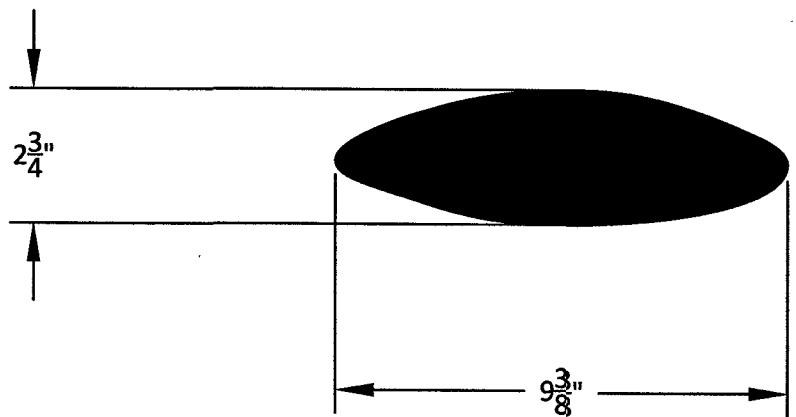
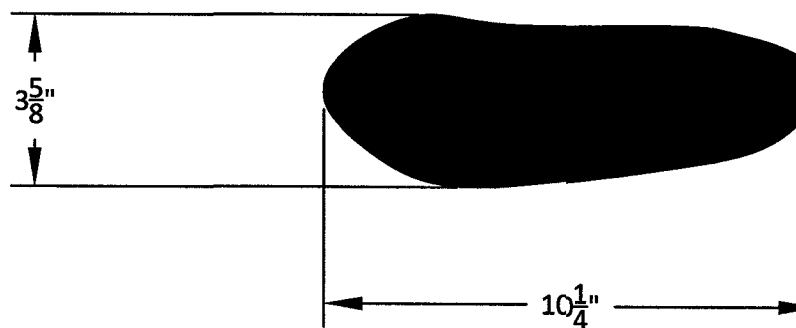
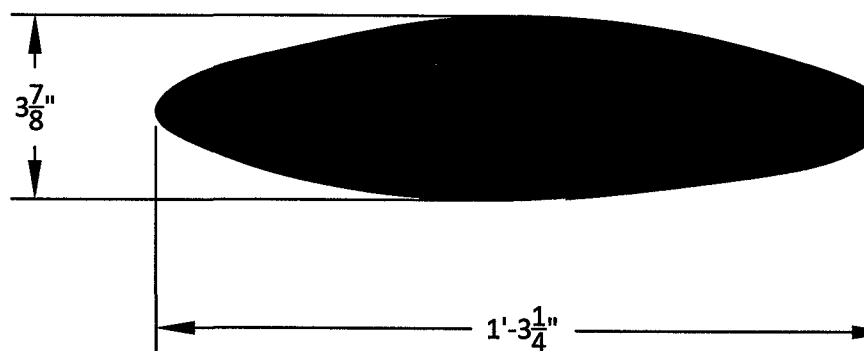
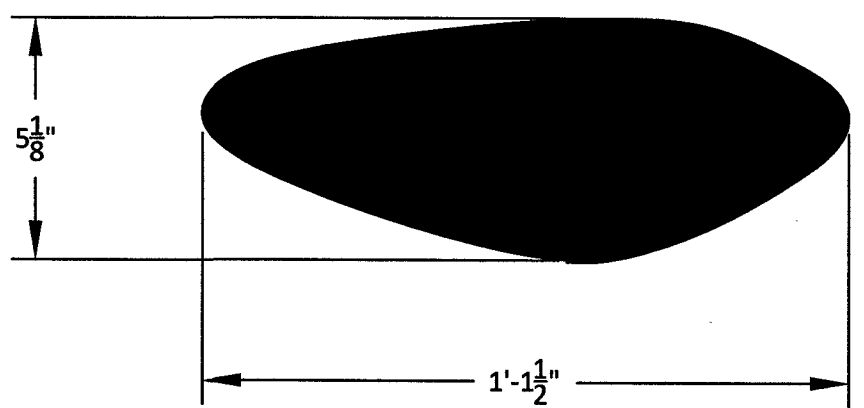

FIVE BRIDGE PEBBLES (TYPICAL)
Scale 3" = 1'-0"

STRUCTURAL DESIGN ONLY

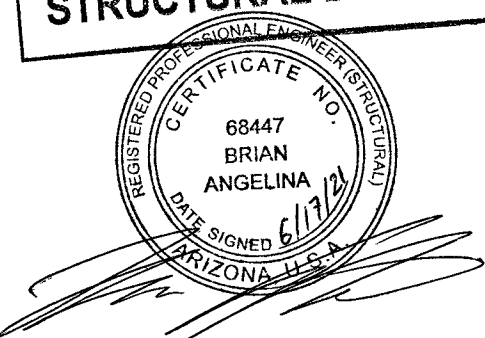

DESIGN OF CONCRETE WALL AND FOOTING STRUCTURE ONLY
Gary K. Munkelt & Associates, LLC
Structural Consulting Engineers
1180 Welsh Rd, Suite 190
North Wales, PA 19454
Phone 215-855-8713 Fax 215-855-8714

Flying Carpet, LLC
3502 Folk St
Houston, TX 77003
email: Kelly@FlyingCarpetCreative.com

KWO Engineering
2020 Commerce Ste B
Houston, TX 77002
email: kel.m.oblier@gmail.com

SCOTTSDALE SLABS
DIKE FRONT
NORTHEAST OF N GREENWAY HAYDEN LOOP
AND E FRANKY LLOYD WRIGHT BLVD
SCOTTSDALE, AZ

ISSUE DATE:
12-20-19

REV 1	12-20-19
REV 2	03-29-20
REV 3	10-04-20
REV 4	10-21-20
REV 5	11-15-20
REV 6	05-18-21

PROJECT # 019-FC1

DRAWING NAME:
BRIDGE AND SIDEWALK

DRAWING NO.
019-FC1-100-01
SHT 4

260 GROUND PEBBLES COMBINED AT ALL 4
QUADRANTS, TOTAL AREA OF 994 SQFT.
TBD, QTY TO BE FINALIZED

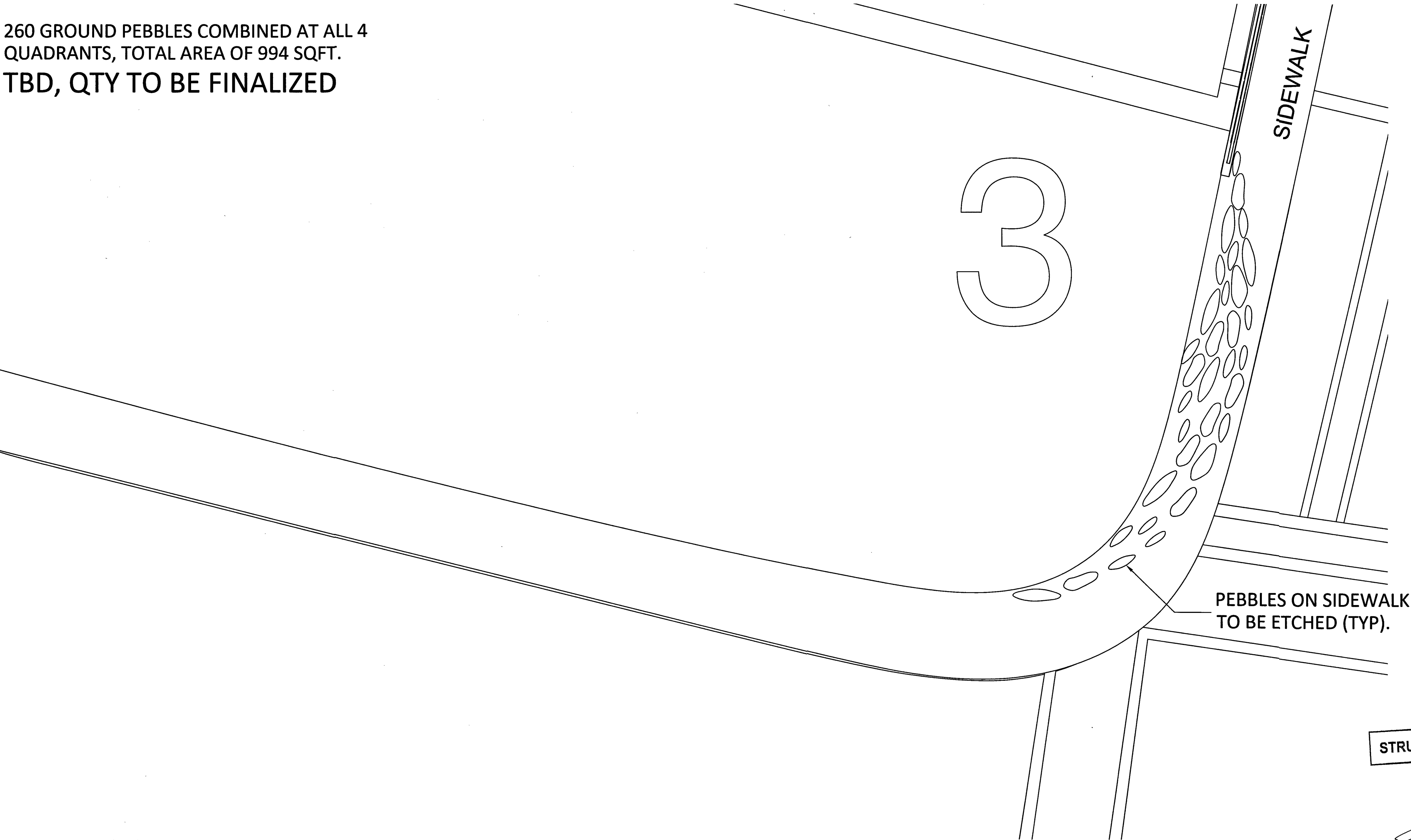

DETAIL D
Scale 1/8" = 1'-0"

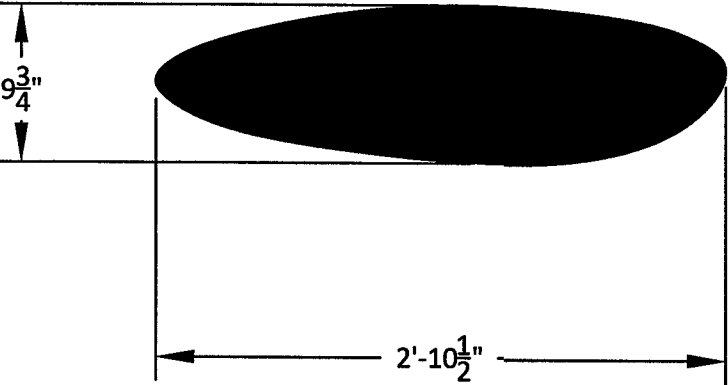
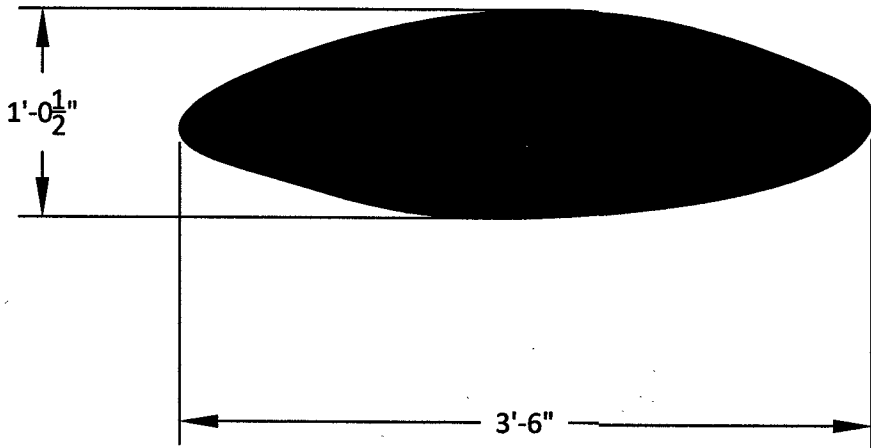
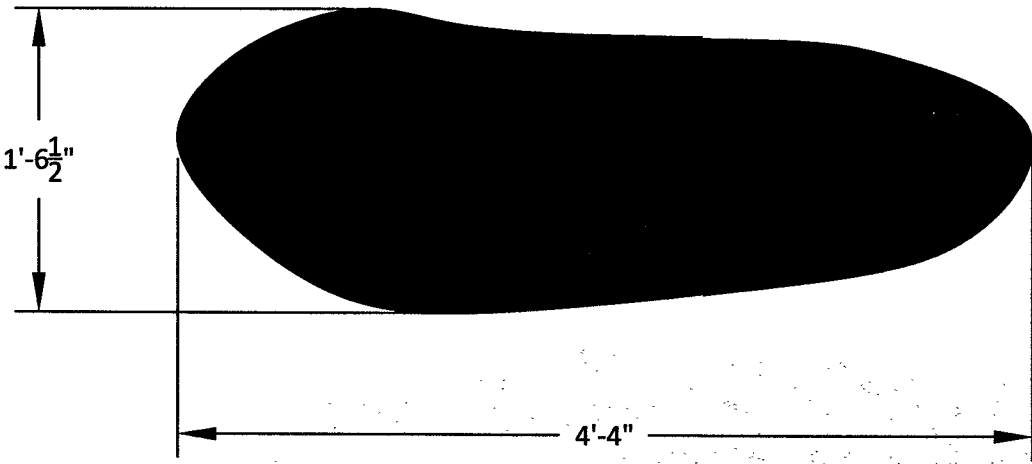
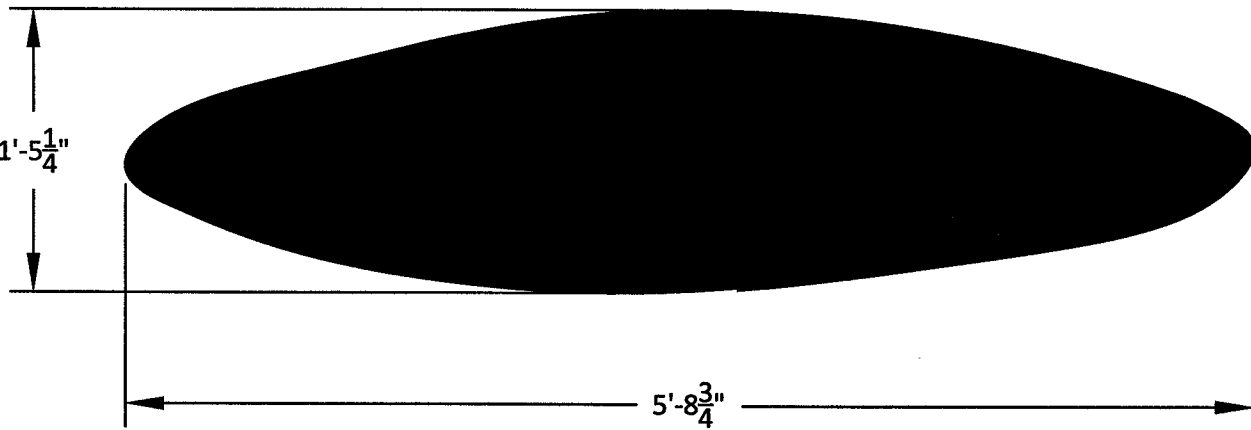
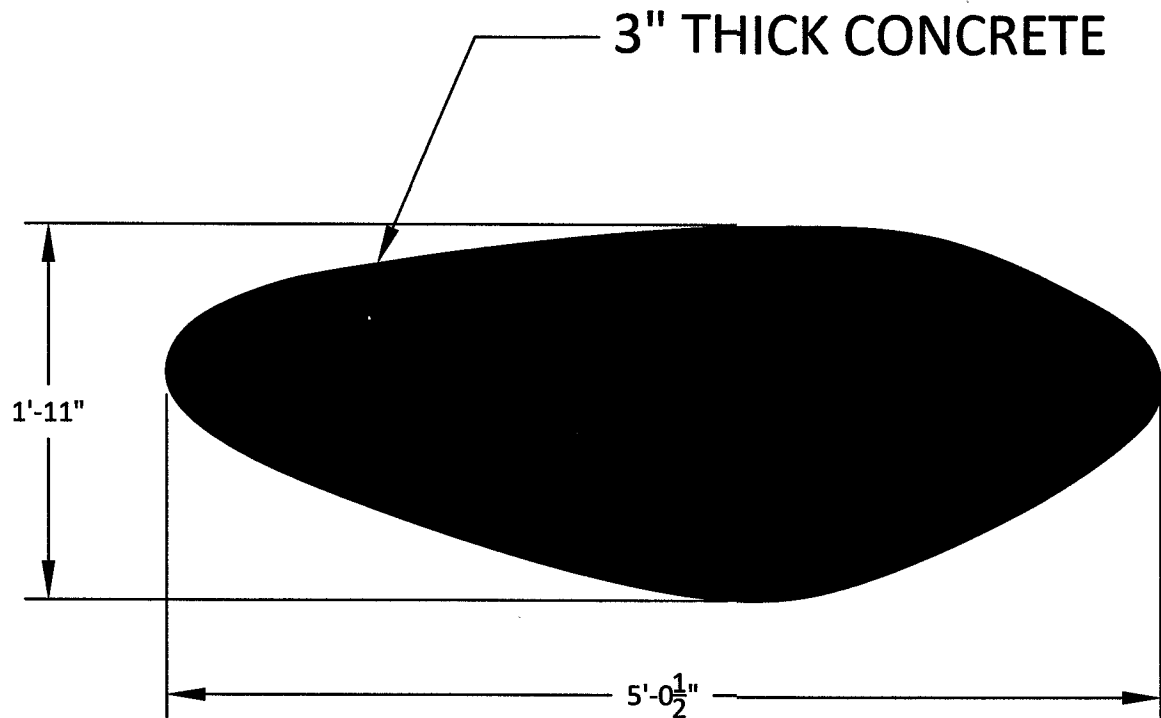

NOTE: EXACT PEBBLE SIZE TBD.

FIVE GROUND PEBBLES (TYPICAL)
Scale 1" = 1'-0"

STRUCTURAL DESIGN ONLY



DESIGN OF CONCRETE WALL
AND FOOTING STRUCTURE ONLY
Gary K. Munkelt &
Associates, LLC
Structural Consulting Engineers
1180 Welsh Rd, Suite 190
North Wales, PA 19454
Phone 215-855-8713 Fax 215-855-8714

Flying Carpet, LLC
3302 Park St
Houston, TX 77003
email: Kelly@FlyingCarpetCreative.com
KMO Engineering
2020 Commerce, Ste B
Houston, TX 77002
email: kel.m.obrien@gmail.com

SCOTTSDALE SLABS
DIKE FRONT
NORTHEAST OF N GREENWAY HAYDEN LOOP
AND E FRANKY LLOYD WRIGHT BLVD
SCOTTSDALE, AZ

ISSUE DATE:
12-20-19

REV 1	12-20-19
REV 2	03-29-20
REV 3	10-04-20
REV 4	10-21-20
REV 5	11-15-20
REV 6	05-18-21

PROJECT # 019-FC1

DRAWING NAME:
MONOLITHS AND
GROUND PEBBLES

DRAWING NO.
019-FC1-100-01
SHT 5

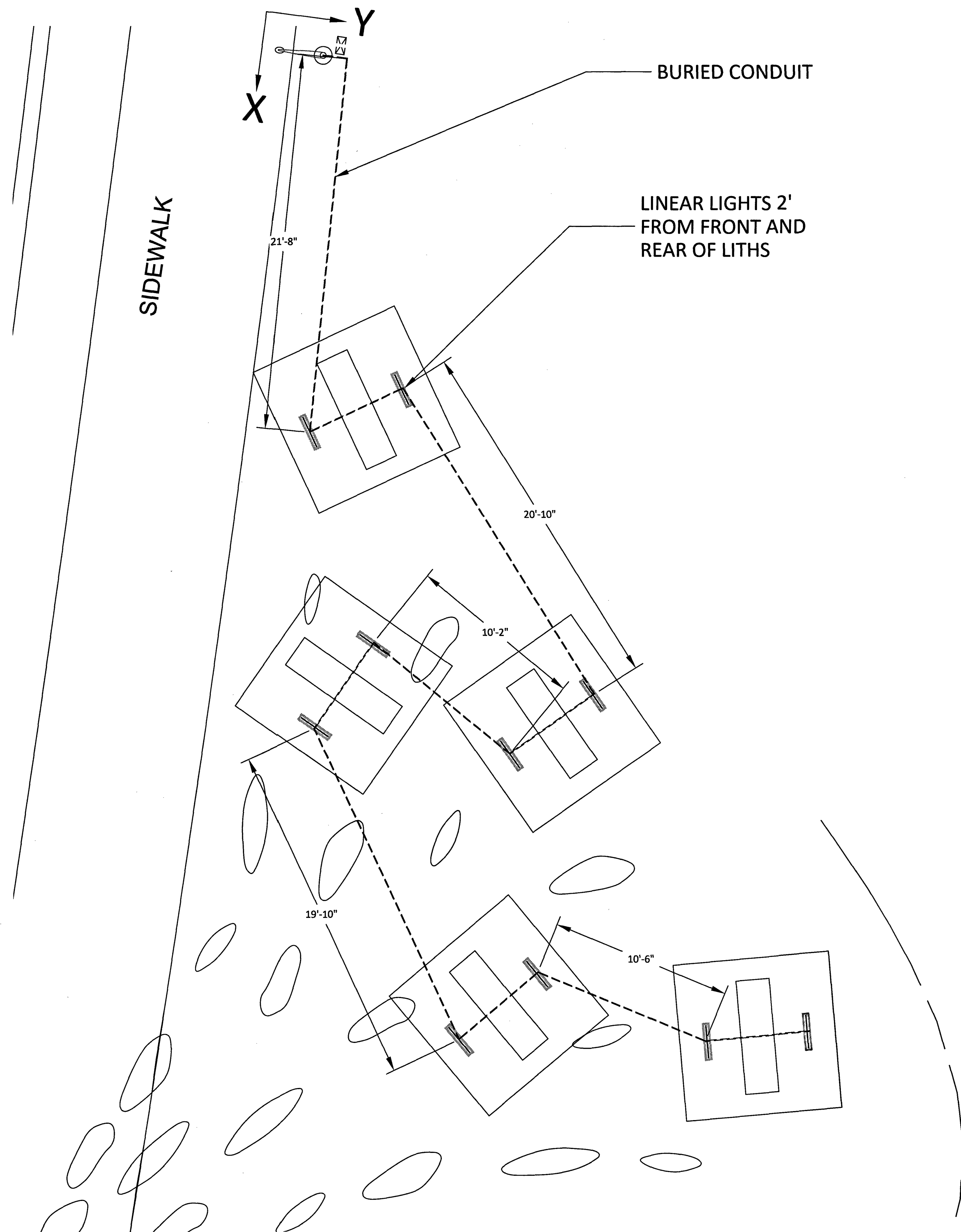

PLAN VIEW
Scale 1/8" = 1'-0"

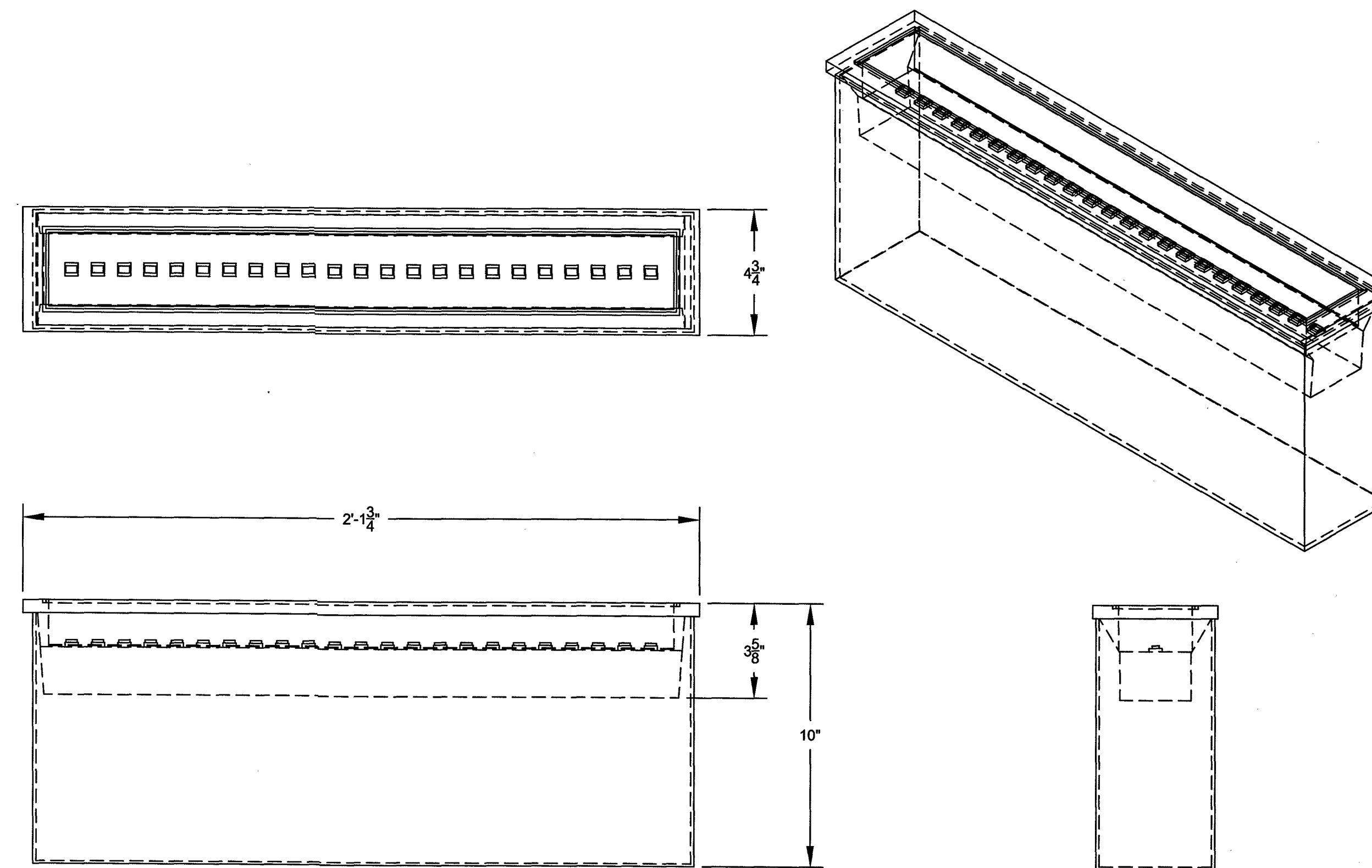

PERFORMANCE: 1200 LM (20W)
POWER INPUT: 120V - 277V
PROTECTION: IP67 - RATED
EXTERIOR WET LOCATIONS

FCD7000 LINEAR
FLOOD LIGHT
Scale 3" = 1'-0"

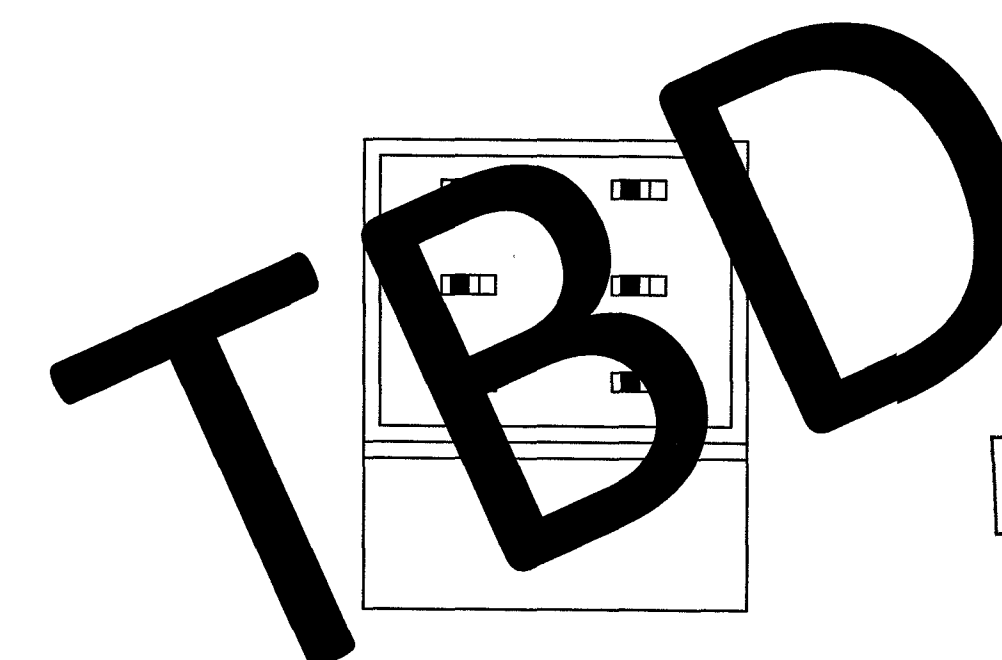

CONTROL PANEL
Scale 1/4" = 1'-0"

STRUCTURAL DESIGN ONLY

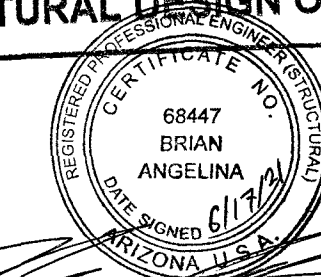

DESIGN OF CONCRETE WALL
AND FOOTING STRUCTURE ONLY

Gary K. Munkelt &
Associates, LLC
Structural Consulting Engineers
1180 Welsh Rd, Suite 190
North Wales, PA 19454
Phone 215-855-8713 Fax 215-855-8714

SCOTTSDALE SLABS

DIKE FRONT
NORTHEAST OF N GREENWAY HAYDEN LOOP
AND E FRANKY LLOYD WRIGHT BLVD
SCOTTSDALE, AZ

ISSUE DATE:
12-20-19

REV 1	12-20-19
REV 2	03-29-20
REV 3	10-04-20
REV 4	10-21-20
REV 5	11-15-20
REV 6	05-18-21

PROJECT # 019-FC1

DRAWING NAME:
ELECTRICAL AND
LIGHTING DETAILS

DRAWING NO.
019-FC1-100-01
SHT 6

Flying Carpet, LLC
3302 Polk St
Houston, TX 77003
email: Kelly@FlyingCarpetCreative.com

KMO Engineering
2020 Commerce, Ste B
Houston, TX 77002
email: kel.m.obrien@gmail.com

MONOLITH POSITIONS				
MONOLITH	LEFT FRONT X POS	LEFT FRONT Y POS	RIGHT FRONT X POS	RIGHT FRONT Y POS
1	17'-7"	3'-10"	23'-4"	7'-6"
2	35'	4'-4"	38'-2"	10'-6"
3	34'-8"	17'-2"	39'-4"	21'-7"
4	51'-4"	16'-2"	55'-9"	21'
5	49'-7"	32'-7"	56'	34'-1"

Flying Carpet, LLC
3302 Polk St
Houston, TX 77003
email: Kelly@FlyingCarpetCreative.com

KMO Engineering
2020 Commerce, Ste B
Houston, TX 77002
email: kel.m.obrien@gmail.com

NOTE: ELEVATION OF TOP OF ANY
FOOTING SHALL NOT BE LOWER THAN
BOTTOM OF ANY ADJACENT FOOTING.

SCOTTSDALE SLABS
DIKE FRONT
NORTHEAST OF N GREENWAY HAYDEN LOOP
AND E FRANKY LLOYD WRIGHT BLVD
SCOTTSDALE, AZ

ISSUE DATE:
12-20-19

REV 1	12-20-19
REV 2	03-29-20
REV 3	10-04-20
REV 4	10-21-20
REV 5	11-15-20
REV 6	05-18-21

PROJECT # 019-FC1

DRAWING NAME:
MONOLITH
POSITIONS

DRAWING NO.
019-FC1-100-01
SHT 3

STRUCTURAL DESIGN ONLY



DESIGN OF CONCRETE WALL
AND FOOTING STRUCTURE ONLY

Gary K. Munkelt &
Associates, LLC
Structural Consulting Engineers
1180 Welsh Rd, Suite 190
North Wales, PA 19454
Phone 215-855-8713 Fax 215-855-8714

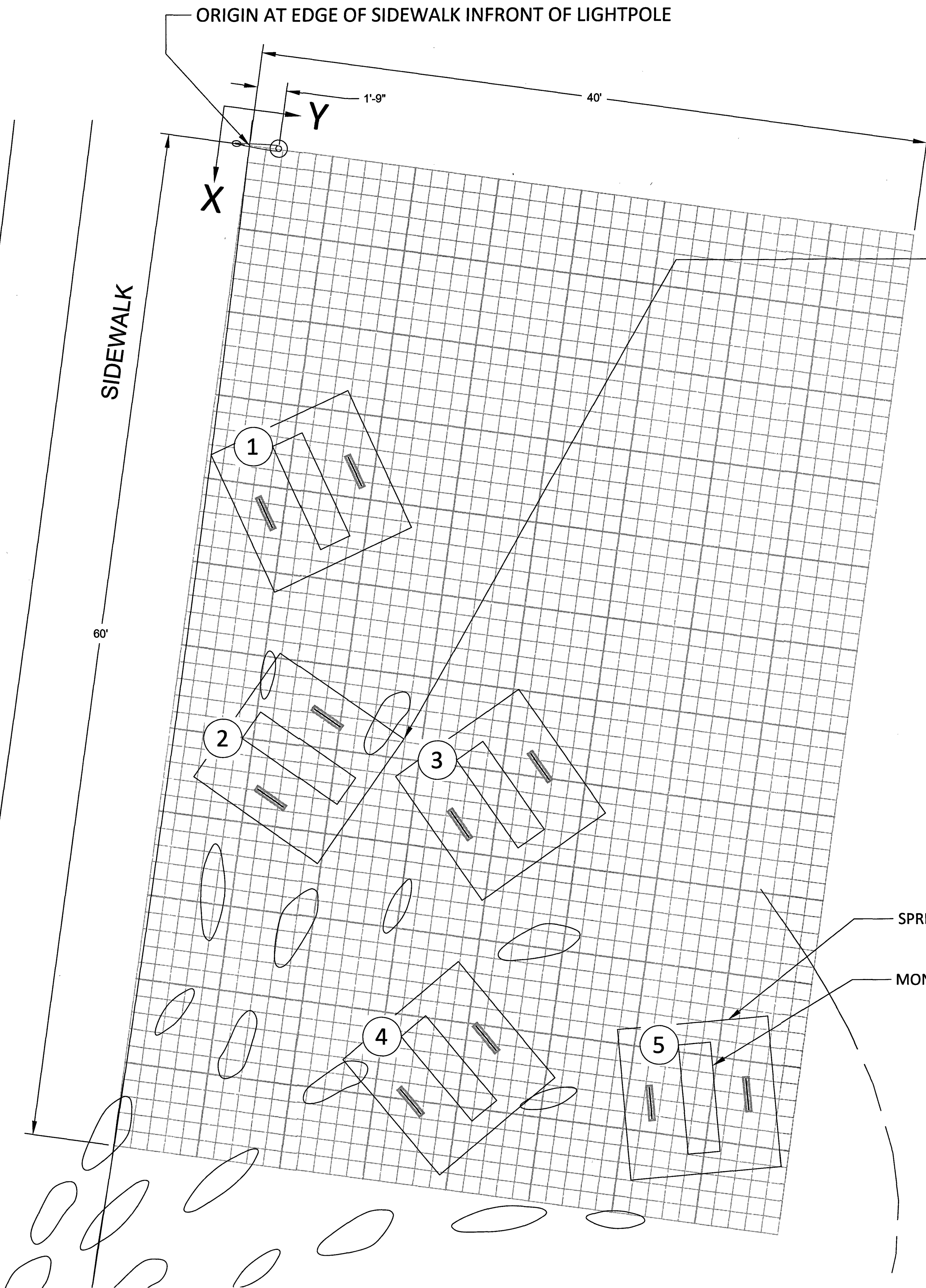

DETAIL B
Scale 1/4" = 1'-0"

Mural Location

- Southwest Wall Face of Core Building
- Southeast Wall Face of Core Building
- Southwest Wall Face of Lower Level
- Southeast Wall Face of Lower Level

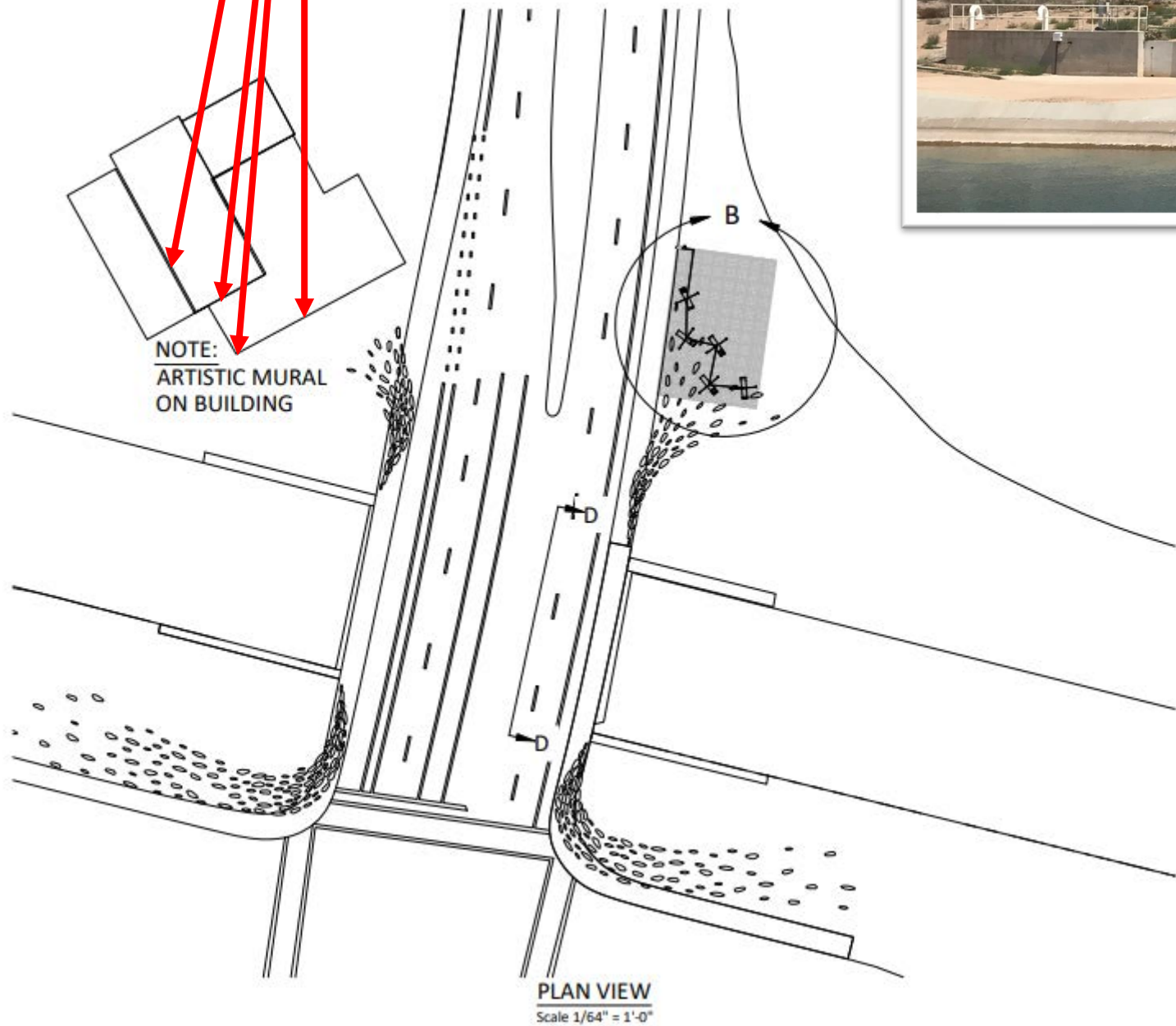

Mural Design

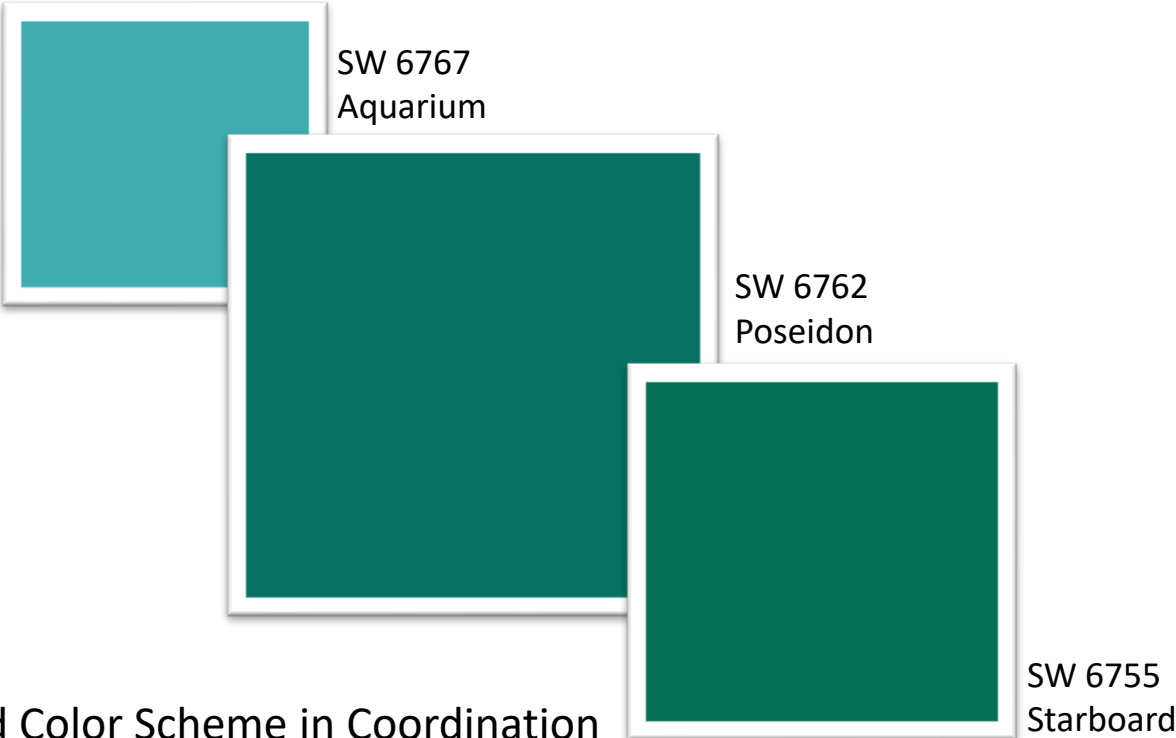
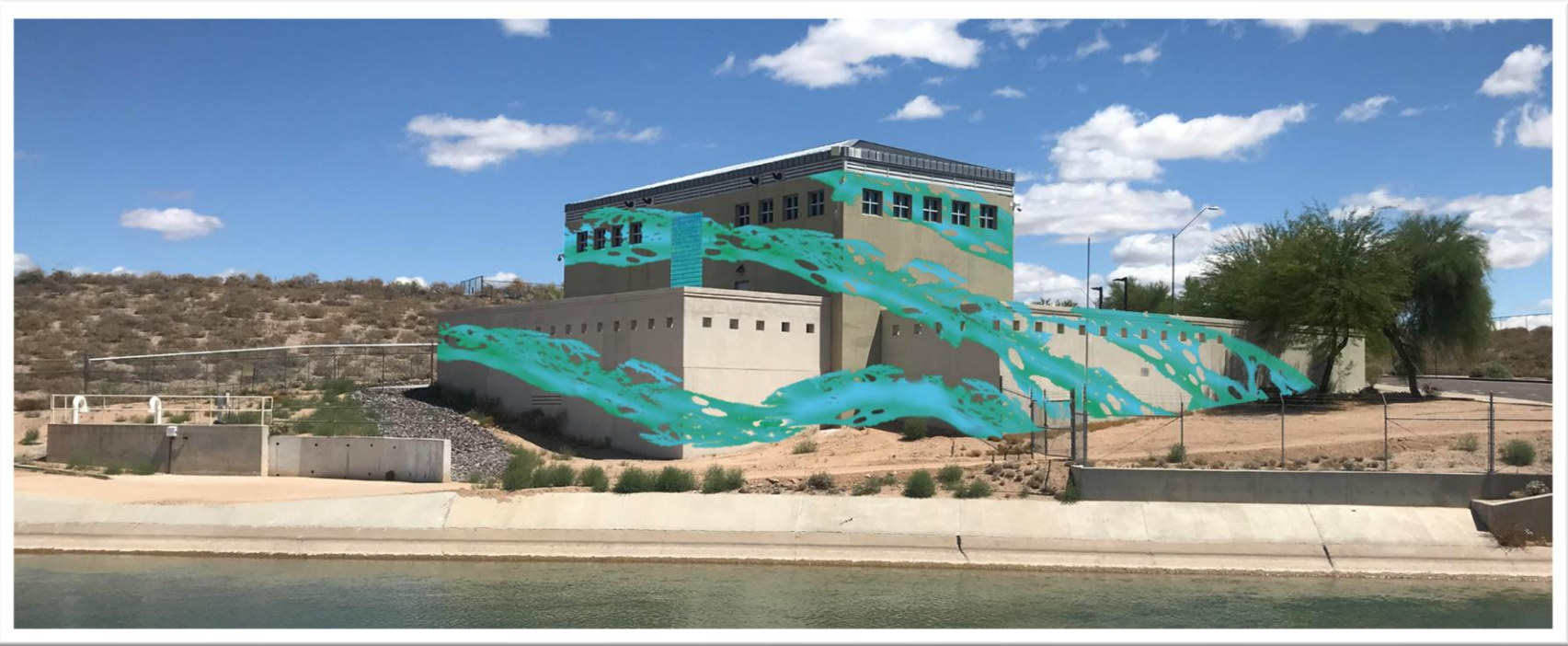

Proposed Color Scheme in Coordination
with Color use within Monolith and Paver Design

Flying Carpet, LLC
3302 Polk St
Houston, TX 77003
email: Kelly@FlyingCarpetCreative.com

KHO Engineering
2020 Commerce, Ste B
Houston, TX 77002
email: kel.m.dorland@gmail.com

SCOTTSDALE SLABS
DIKE FRONT
NORTHEAST OF N GREENWAY HAYDEN LOOP
AND E FRANKY LLOYD WRIGHT BLVD
SCOTTSDALE, AZ

ISSUE DATE:
12-20-19

REV 1 12-20-19
REV 2 03-29-20
REV 3 10-04-20

PROJECT # 019-FC1

DRAWING NAME:

DRAWING NAME:

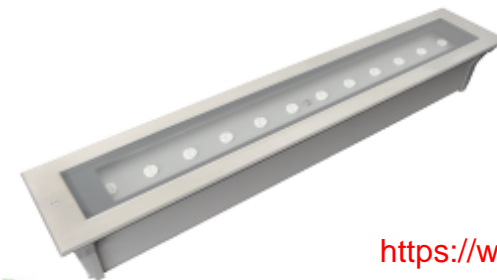
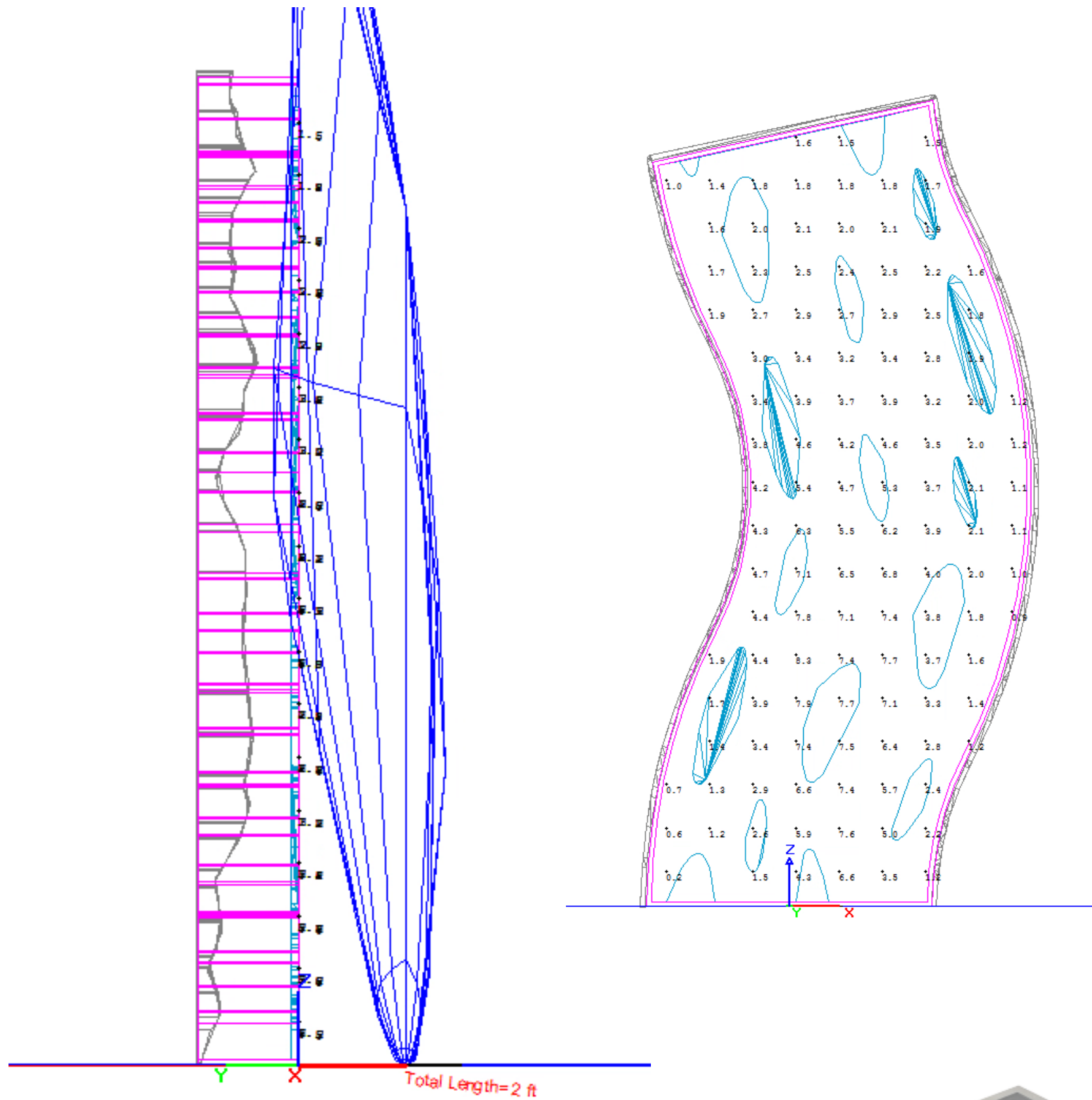

<https://www.fcighting.com/wp-content/uploads/2016/03/FCD7000.pdf>

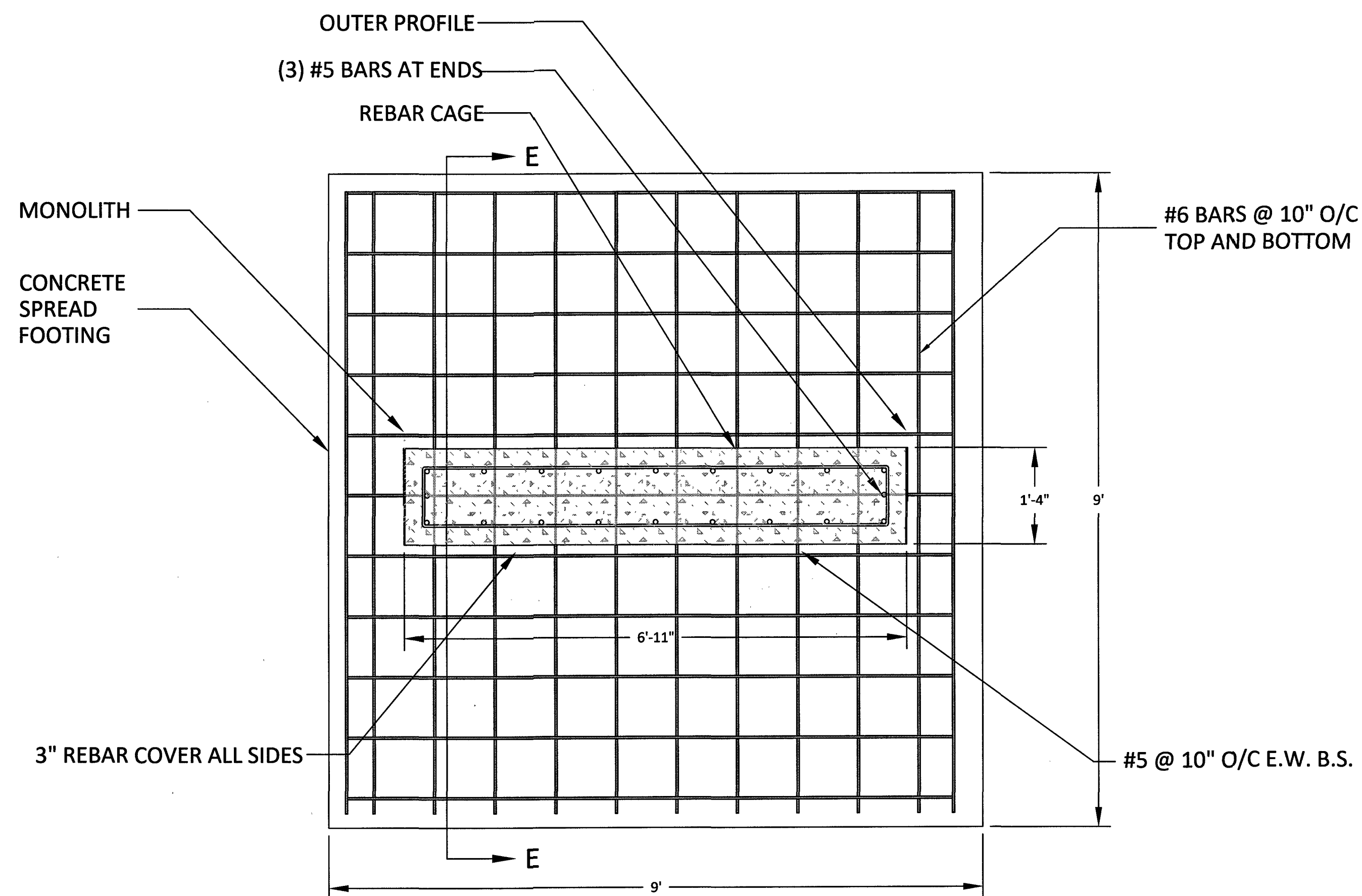

PLAN
Scale 3/4" = 1'-0"

NOTE: BASED ON MINIMUM 1500psf
PRESSUMPTIVE SOIL BEARING PRESSURE.

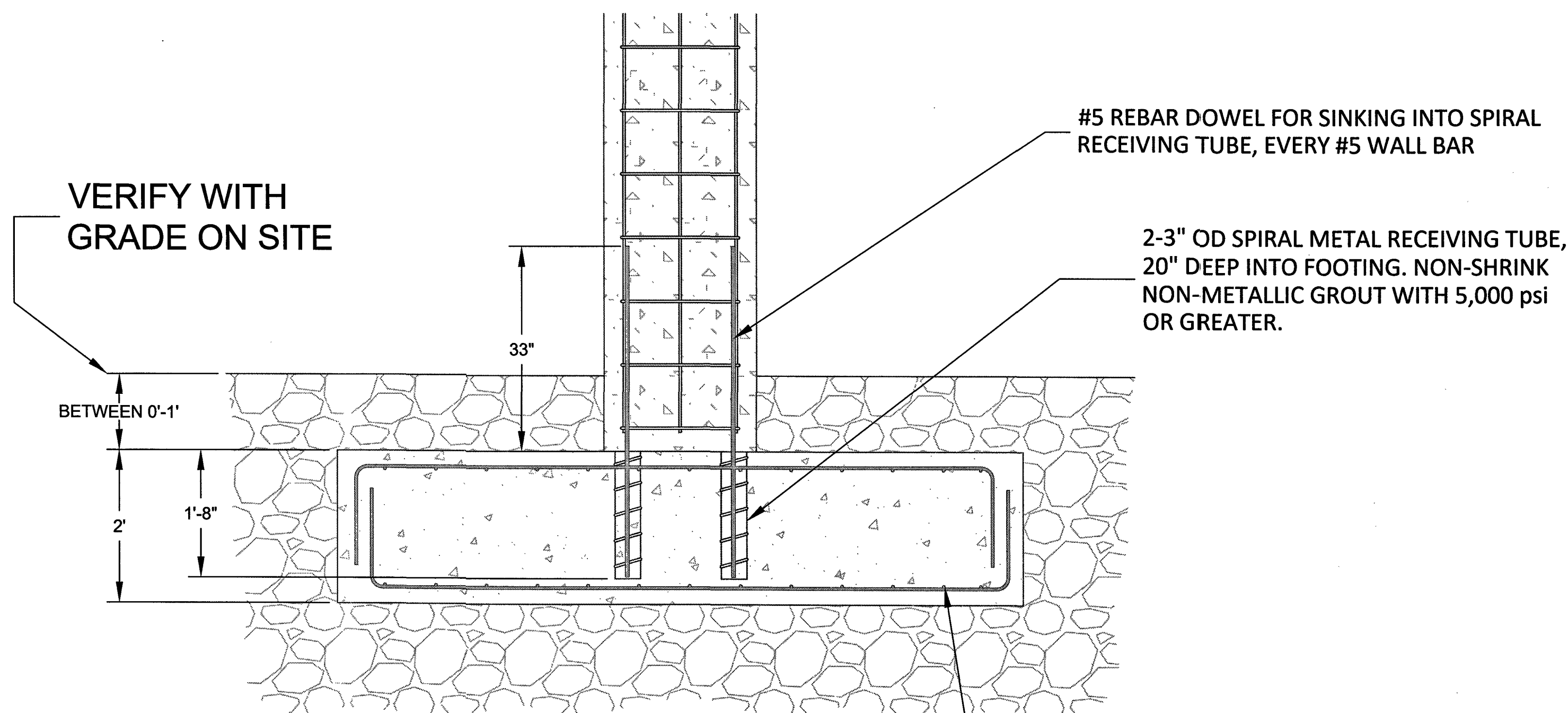

SECTION E-E
Scale 3/4" = 1'-0"

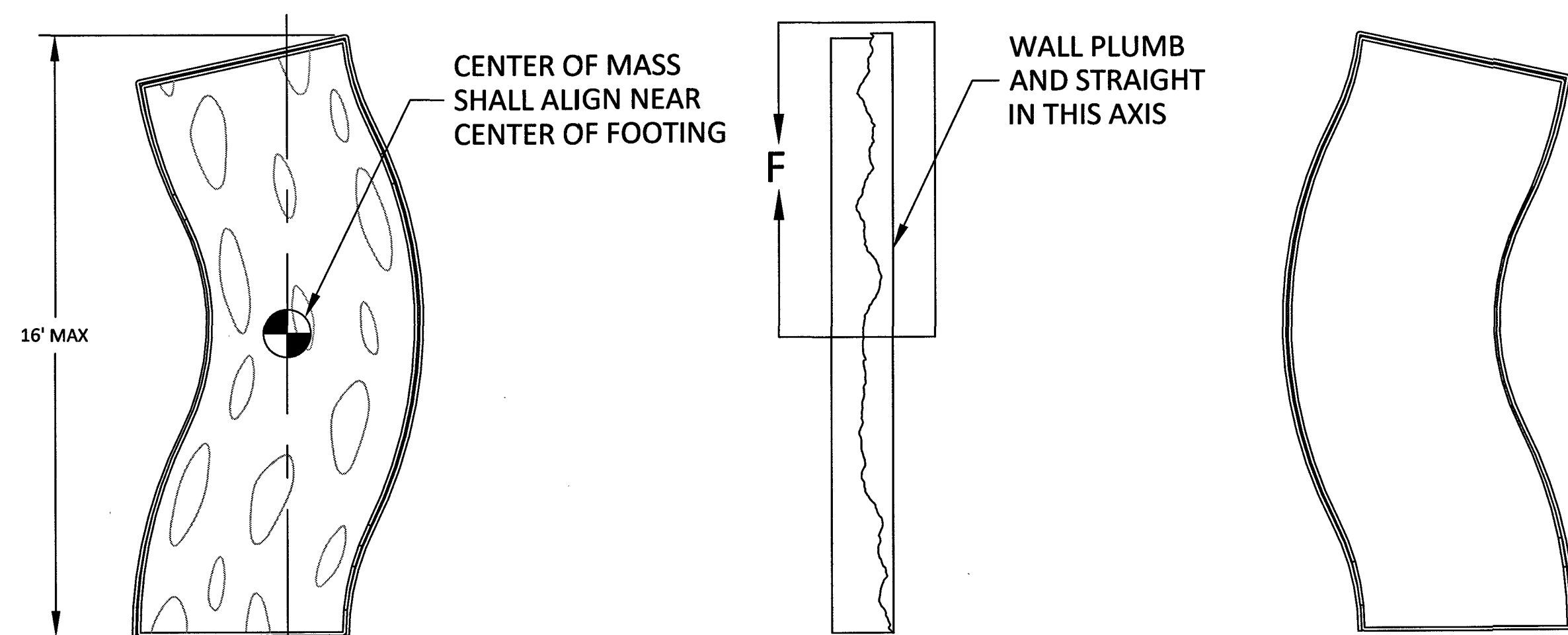

FRONT
Scale 1/8" = 1'-0"

SIDE
Scale 1/8" = 1'-0"

BACK
Scale 1/8" = 1'-0"

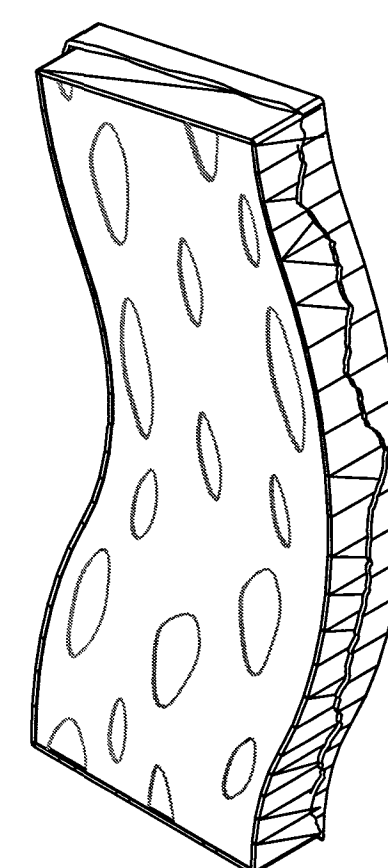

ISO
Scale 1/8" = 1'-0"

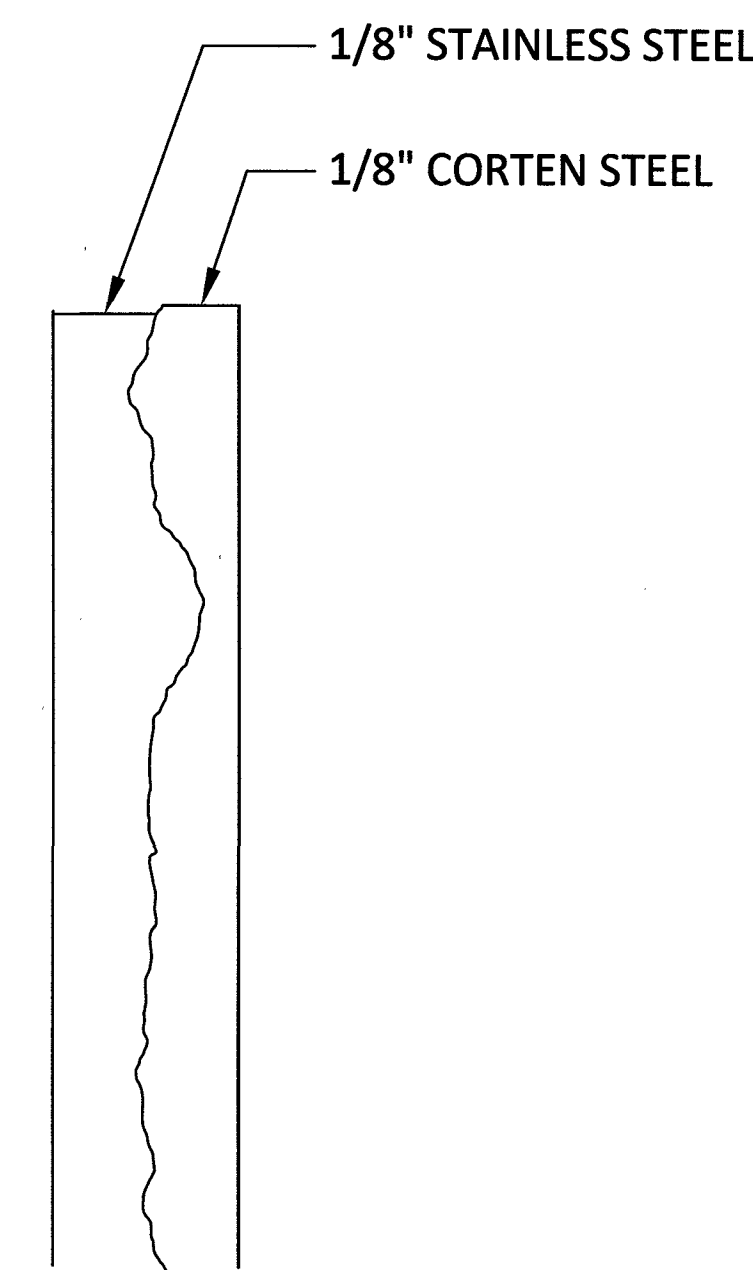

DETAIL F
Scale 1/4" = 1'-0"

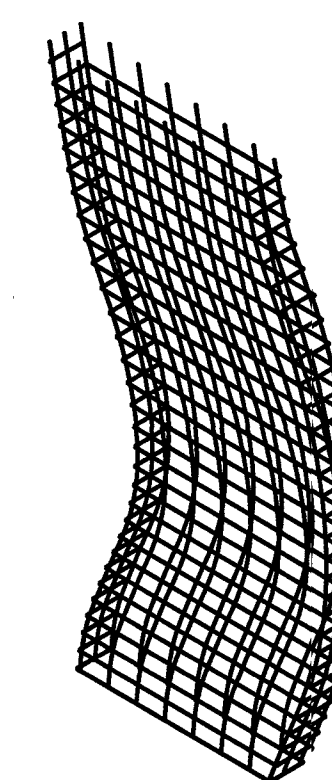

REBAR CAGE
Scale 1/4" = 1'-0"

STRUCTURAL DESIGN ONLY

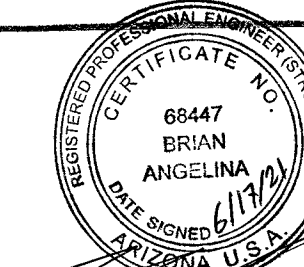

DESIGN OF CONCRETE WALL AND FOOTING STRUCTURE ONLY

Gary K. Munkelt & Associates, LLC
Structural Consulting Engineers
1180 Welsh Rd, Suite 190
North Wales, PA 19454
Phone 215-855-8713 Fax 215-855-8714

SCOTTSDALE SLABS

DIKE FRONT
NORTHEAST OF N GREENWAY HAYDEN LOOP
AND E FRANKY LLOYD WRIGHT BLVD
SCOTTSDALE, AZ

ISSUE DATE:
12-20-19

REV 1	12-20-19
REV 2	03-29-20
REV 3	10-04-20
REV 4	10-21-20
REV 5	11-15-20
REV 6	05-18-21

PROJECT # 019-FC1

DRAWING NAME:
MONOLITHS AND FOOTINGS

DRAWING NO.
019-FC1-100-01
SHT 2

Flying Carpet, LLC
3302 Pok St
Houston, TX 77003
email: kelly@FlyingCarpetCreative.com

KMO Engineering
2030 Commerce, Ste B
Houston, TX 77002
email: kel.moore@kmo.com



Zoning Aerial

2-DR-2021

City Notifications – Mailing List Selection Map Shoeman Lane



Additional Notifications:

Interested Parties List
Adjacent HOA's
P&Z E-Newsletter
Facebook
Nextdoor.com
City Website-Projects in the hearing process

Pulled Labels
February 8, 2021

Map Legend:



Site Boundary

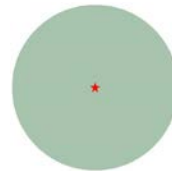

Properties within 750-feet

Postcards: 72

2-DR-2021