

# WESTERN TECH - 1395 N HAYDEN RD

## project consultants

### landscape architecture:

DESIGN ETHIC, LLC  
7525 EAST 6TH AVENUE  
SCOTTSDALE, ARIZONA 85251  
PROJECT CONTACT: BRANDON PAUL  
PHONE: 480.225.7077

### architecture:

JAMMON STUDIOS  
7465 EAST OSBORN ROAD  
SCOTTSDALE, ARIZONA 85251  
CONTACT: JONATHAN AMMON  
PHONE: 602.689.9552  
EMAIL: JAMMON@JAMMONSTUDIOS.COM

### civil engineering:

CYPRESS CIVIL DEVELOPMENT  
4450 NORTH 12TH STREET, #228  
PHOENIX, ARIZONA 85014  
PROJECT CONTACT: JEFF HUNT  
PHONE: 623.282.2498  
EMAIL: jphunt@cypresscivil.com

## site data

EXISTING ZONING: I-1  
PROPOSED ZONING: I-1  
NET AREA (TOTAL PARCEL): 2.84 ACRES (123,868 S.F.)  
OPEN SPACE REQUIRED:  $(.10 \times \text{NET AREA}) + ((29-12)(.003 \times \text{NET SITE AREA}))$  (I-1)  
 $(.10 \times 123,868 \text{ S.F.}) + ((29-12)(.003 \times 123,868 \text{ S.F.}))$   
18,704 SF

OPEN SPACE PROVIDED 22,958 SF

## sheet index

SHEET	TITLE
L.01	COVER SHEET & NOTES
L.02	PLANTING PLAN

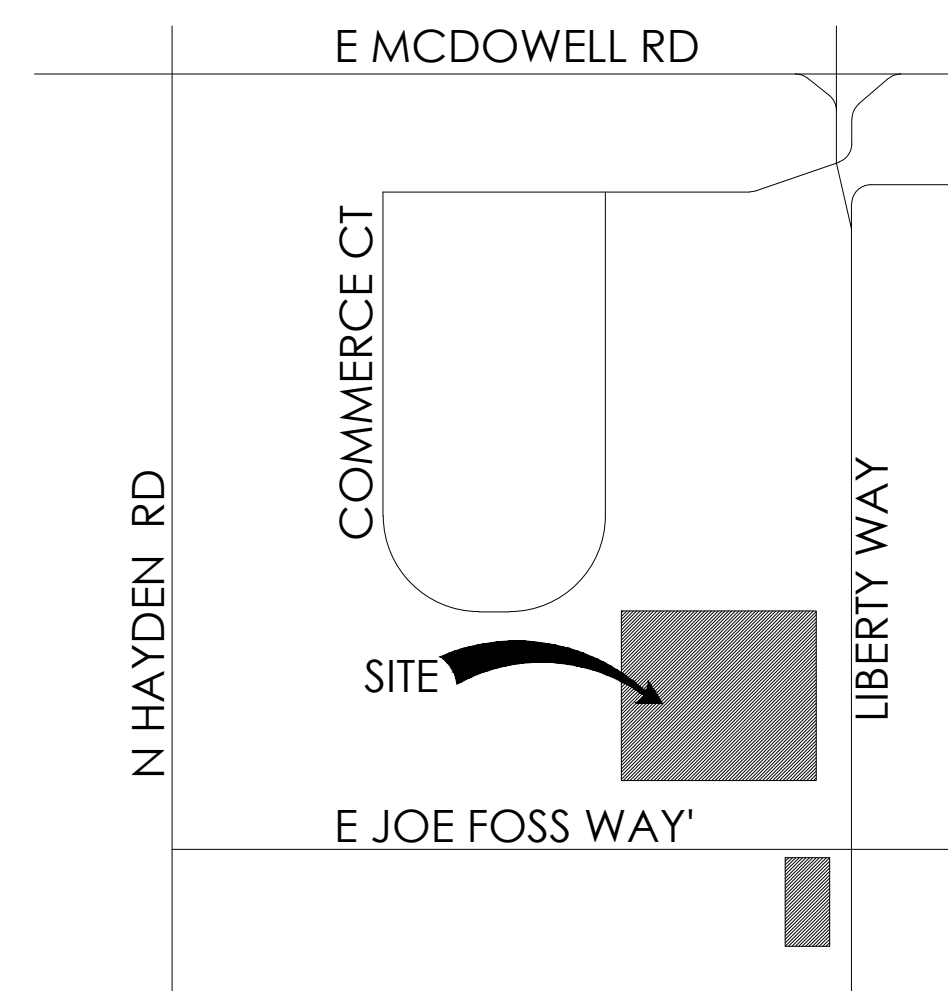

vicinity map



## city of scottsdale notes:

- AREAS OF DECOMPOSED GRANITE WITHOUT PLANT MATERIALS/GROUNDCOVERS SHALL NOT EXCEED DIMENSIONS OF MORE THAN 7' IN ANY ONE DIRECTION, MEASURED BETWEEN PLANT CANOPIES AND/OR COVERAGE.
- A MINIMUM OF 50% OF THE PROVIDED TREES SHALL BE MATURE TREES, PURSUANT TO THE CITY OF SCOTTSDALE'S ZONING ORDINANCE ARTICLE X, SECTION 10.301, AS DEFINED IN THE CITY OF SCOTTSDALE'S ZONING ORDINANCE ARTICLE III, SECTION 3.100
- A SINGLE TRUNK TREE'S CALIPER SIZE, THAT IS TO BE EQUAL OR LESS THAN 4" SHALL BE DETERMINED BY UTILIZING THE SMALLEST DIAMETER OF THE TRUNK 6 INCHES ABOVE FINISHED GRADE ADJACENT TO THE TRUNK. TREE'S CALIPER SIZE, FOR SINGLE TRUNK TREES THAT ARE TO HAVE A DIAMETER GREATER THAN 4-INCHES, SHALL BE DETERMINED BY UTILIZING THE SMALLEST DIAMETER OF THE TRUNK 12-INCHES ABOVE FINISHED GRADE ADJACENT TO THE TRUNK. A MULTIPLE TRUNK TREE'S CALIPER SIZE IS MEASURED AT 6" ABOVE THE LOCATION THAT THE TRUNK SPLITS ORIGINATES, OR 6" ABOVE FINISHED GRADE IF ALL TRUNKS ORIGINATE FROM THE SOIL.
- AREA WITHIN THE SIGHT DISTANCE TRIANGLES IS TO BE CLEAR OF LANDSCAPING, SIGNS, OR OTHER VISIBILITY OBSTRUCTIONS WITH A HEIGHT GREATER THAN 2 FEET. TREES WITHIN THE SAFETY TRIANGLE SHALL HAVE A CANOPY THAT BEGINS AT 7 FEET IN HEIGHT UPON INSTALLATION. ALL HEIGHTS ARE MEASURED FROM NEAREST STREET LINE ELEVATION.
- NO TURF AREAS ARE TO BE PROVIDED.
- RETENTION/DETENTION BASINS SHALL BE CONSTRUCTED SOLELY FROM THE APPROVED DESIGN (ADDITIONAL FILL, BOULDERS, ETC.) SHALL REQUIRE ADDITIONAL FINAL PLANS STAFF REVIEW AND APPROVAL.
- ALL RIGHTS-OF-WAY ADJACENT TO THIS PROPERTY SHALL BE LANDSCAPED AND MAINTAINED BY THE PROPERTY OWNER.
- PRIOR TO THE ESTABLISHMENT OF WATER SERVICE, NON-RESIDENTIAL PROJECTS WITH AN ESTIMATED ANNUAL WATER DEMAND OF TEN (10) ACRE-FEET OF MORE SHALL SUBMIT A CONSERVATION PLAN IN CONFORMANCE WITH SECTIONS 49-245 THROUGH 49-248 OF THE CITY CODE TO THE WATER CONSERVATION OFFICE.
- NO LIGHTING IS PROPOSED WITH THIS SUBMITTAL.
- THE LANDSCAPE SPECIFICATION SECTION(S) OF THESE PLANS ARE NOT REVIEWED AND SHALL NOT BE PART OF THE CITY OF SCOTTSDALE'S APPROVAL.
- ALL SIGNS REQUIRE SEPARATE PERMITS AND APPROVALS.
- NEW LANDSCAPING, INCLUDING SALVAGED PLANT MATERIAL, AND LANDSCAPING INDICATED TO REMAIN, WHICH IS DESTROYED, DAMAGED, OR EXPIRES DURING CONSTRUCTION SHALL BE REPLACED WITH LIKE SIZE, KIND, AND QUANTITY PRIOR TO THE ISSUANCE OF THE CERTIFICATE OF OCCUPANCY / LETTER OF ACCEPTANCE TO THE SATISFACTION OF THE INSPECTION SERVICES STAFF.

LANDSCAPE PLAN  
APPROVED  
CITY OF SCOTTSDALE

CASE NUMBER	APPROVED BY	DATE
CONSTRUCTION AND INSTALLATION SHALL BE IN ACCORDANCE WITH THIS PLAN AND ALL DEVIATIONS WILL REQUIRE REAPPROVAL. THE CITY WILL NOT ISSUE A C O UNTIL INSPECTION SERVICES STAFF APPROVES THE LANDSCAPE INSTALLATION.		

ALL LANDSCAPE AREAS AND MATERIALS, INCLUDING THOSE LOCATED IN PUBLIC RIGHTS-OF-WAY, SHALL BE MAINTAINED IN A HEALTHY, NEAT, CLEAN AND WEED-FREE CONDITION. AMERICAN NATIONAL STANDARDS INSTITUTE (ANSI) A300 STANDARD PRACTICES FOR PRUNING, SUPPORT SYSTEMS, AND SAFETY SHALL BE USED FOR MAINTENANCE CRITERIA. THIS SHALL BE THE RESPONSIBILITY OF THE PROPERTY OWNER.

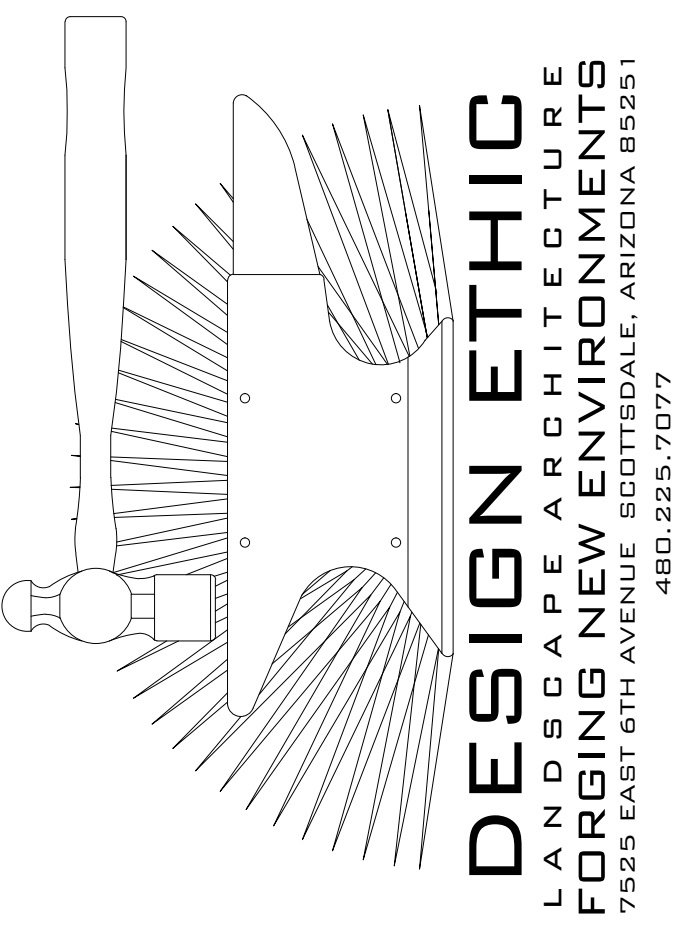

WESTERN TECH  
1395 N HAYDEN RD  
SCOTTSDALE, AZ 85257  
COVER SHEET & NOTES

PROJECT:

SHEET TITLE:

JOB NO: 21-106  
DATE: 04.18.2022  
DRAWN BY: BTP  
SUBMITTED: -  
SET:

SHEET

L.01 of L.02



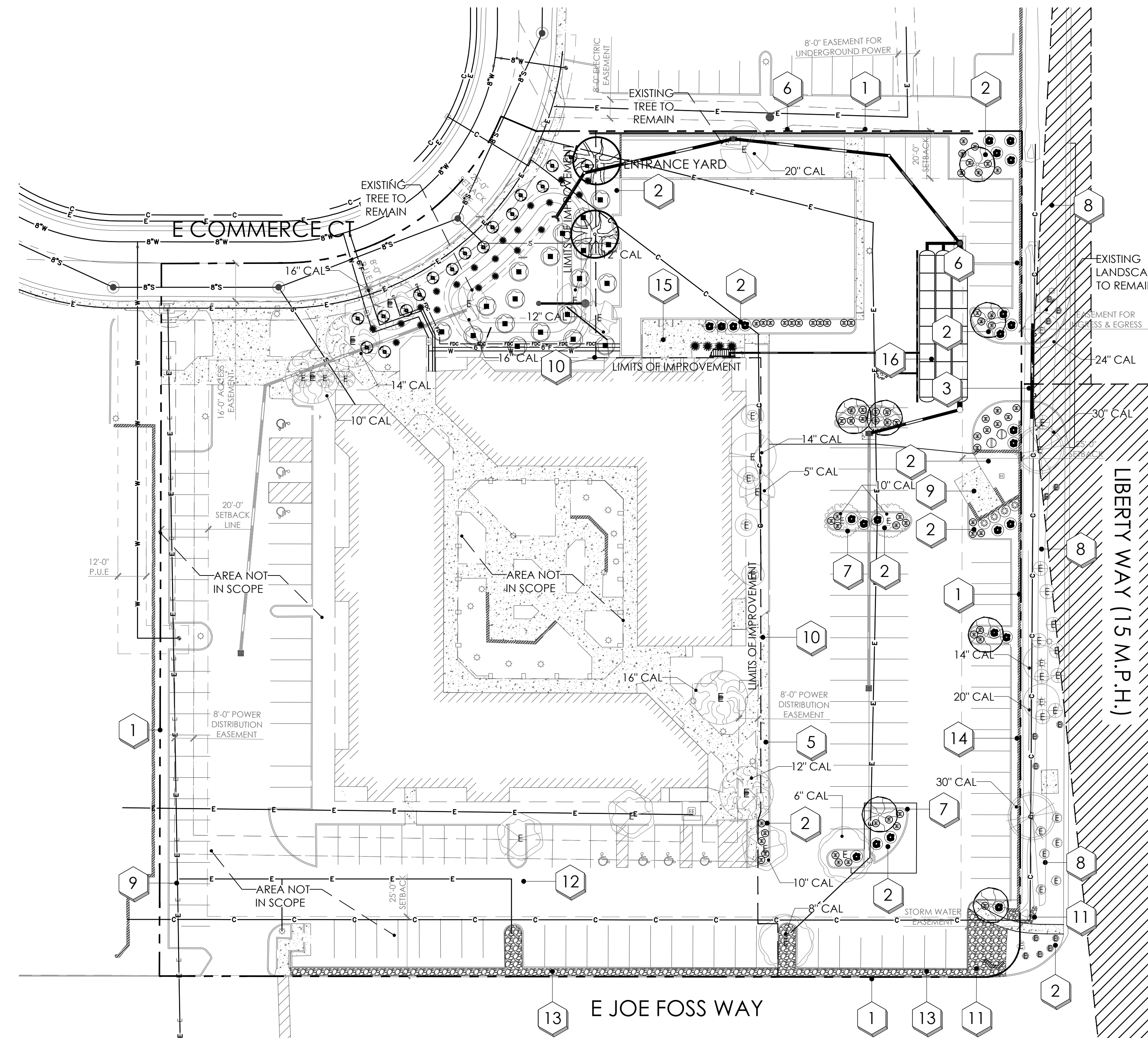

plant legend

	botanical name common name	size	qty	comments
<b>trees</b>				
	ACACIA SALICINA WILLOW ACACIA	(5 @ 1.0 GPH)	24" BOX	7 7.0H., 2.5W., 1.25CAL. STAKE IN PLACE
	PISTACIA X. RED PUSH RED PUSH PISTACHE	(5 @ 1.0 GPH)	24" BOX	2 7.0H., 2.5W., 1.0CAL. STAKE IN PLACE
<b>shrubs</b>				
	BOUGAINVILLEA 'LA JOLLA' LA JOLLA BOUGAINVILLEA	(1 @ 1.0 GPH)	5 GAL.	5
	HESPERALOE PARVIFLORA RED YUCCA	(1 @ 1.0 GPH)	5 GAL.	25
	LEUCOPHYLLUM FRUTESCENS 'GREEN CLOUD' GREEN CLOUD SAGE	(1 @ 1.0 GPH)	5 GAL.	19
	LEUCOPHYLLUM ZYGOPHYLLUM CIMARRON CIMARRON SAGE	(1 @ 1.0 GPH)	5 GAL.	24
	RUELLIA PENINSULARIS BAJA RUELLIA	(1 @ 1.0 GPH)	5 GAL.	3
<b>groundcover</b>				
	EREMOPHILA GLABRA 'MIGNEW GOLD', OUTBACK SUNRISE EMU	(1 @ 1.0 GPH)	5 GAL.	17
	LANTANA MONTEVIDENSIS PURPLE LANTANA	(1 @ 1.0 GPH)	5 GAL.	66
<b>inerts</b>				
	3/4" MINUS DECOMPOSED GRANITE TABLE MESA BROWN	3/4" MINUS	10,422 S.F.	2" MINIMUM IN ALL PLANTERS

existing plant legend

	botanical name common name	size	qty	comments
<b>existing trees</b>				
	ACACIA STENOPHYLLA SHOESTRING ACACIA	SIZE VARIES	2	
	BRACHYCHITON POPULNEUS BOTTLE TREE	SIZE VARIES	4	
	EUCALYPTUS CITRIODORA LEMON-SCENTED GUM	SIZE VARIES	3	
	EUCALYPTUS ROBUSTA SWAMP MAHOGANY	SIZE VARIES	2	
	OLEA EUROPAEA SWAN HILL OLIVE	SIZE VARIES	5	
	PARKINSONIA PRAECOX PALO BREA	SIZE VARIES	3	
	QUERCUS VIRGINIANA SOUTHERN LIVE OAK	SIZE VARIES	2	
	RHUS LANCEA AFRICAN SUMAC	SIZE VARIES	2	
<b>shrubs - remain in place</b>				
	CAESALPINIA PULCHERRIMA RED BIRD OF PARADISE	SIZE VARIES	10	
	NERIUM OLEANDER PETITE PINK OLEANDER	SIZE VARIES	4	
	RUELLIA PENINSULARIS BAJA RUELLIA	SIZE VARIES	6	
	TECOMA CAPENSIS CAPE HONEYSUCKLE	SIZE VARIES	3	
<b>accents - remain in place</b>				
	HESPERALOE PARVIFLORA RED YUCCA	SIZE VARIES	13	
	LOPHOCEREUS SCHOTTII MONSTROSE TOTEM POLE CACTUS	SIZE VARIES	1	

planting key notes

- 1 PROPERTY LINE / RIGHT OF WAY LINE
- 2 DECOMPOSED GRANITE IN ALL PLANTING AREAS
- 3 SIGHT VISIBILITY TRIANGLE, MAXIMUM MATURE PLANT MATERIAL HEIGHT IN THE SIGHT VISIBILITY TRIANGLES IS 24 INCHES
- 4 ACCESSIBLE RAMP. SEE CIVIL ENG. PLANS.
- 5 EXISTING SIDEWALK.
- 6 6' MASONRY WALL. SEE ARCH. PLANS.
- 7 CURB. SEE CIVIL ENG. PLANS.
- 8 STORMWATER RETENTION. SEE CIVIL ENG. PLANS.
- 9 TRASH ENCLOSURE. SEE ARCHITECT'S SITE PLAN.
- 10 LIMITS OF PROJECT IMPROVEMENT.
- 11 EXISTING RIP RAP TO REMAIN.
- 12 NEW VEHICLE GATE. SEE ARCH. PLANS.
- 13 6' WROUGHT IRON GATE. SEE ARCH. PLANS.
- 14 2'-6" WROUGHT IRON GATE ABOVE EXISTING WALL. (6' HEIGHT WALL TOTAL). SEE ARCH. PLANS.
- 15 EXTERIOR COVERED COURTYARD. SEE ARCH. PLANS.
- 16 DRAINAGE STRUCTURE. SEE CIVIL ENG. PLANS.

thorny planting note:

THORNY TREES, SHRUBS, AND CACTI SHALL BE PLANTED SO THAT THEIR MATURE SIZE/CANOPY WILL BE AT LEAST 4 FEET AWAY FROM ANY WALKWAYS OR PARKING AREA CURBING. PLEASE REFER TO DSPM SEC. 2-1.1001.13.

PRELIMINARY  
NOT FOR  
CONSTRUCTION

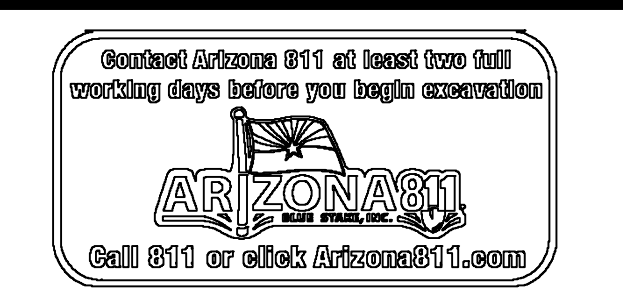
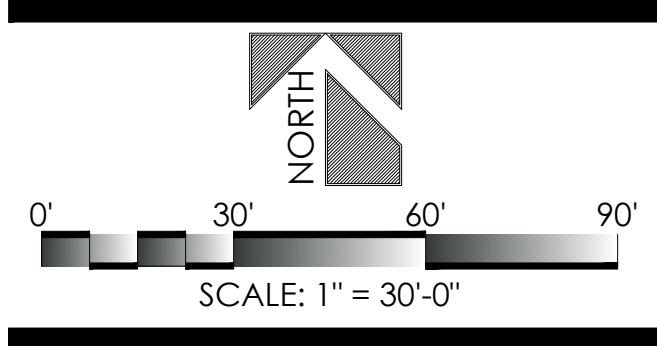

WESTERN TECH  
1395 N HAYDEN RD  
SCOTTSDALE, AZ 85257

PROJECT: SHEET TITLE:

JOB NO: 21-106  
DATE: 04.18.2022  
DRAWN BY: BTP  
SUBMITTED: -  
SET: