

SCOTTSDALE AIRPORT VICINITY DEVELOPMENT SHORT FORM

For development projects within 20,000 feet of Scottsdale Airport NOT located on an Airpark taxilane or adjacent to airport property

The owner of developments within the Airport Influence Area shall complete forms required by the City and Scottsdale Airport to comply with the Scottsdale Revised Code, Chapter 5 – Aviation and the Airpark Rules and Regulations; and submit the completed forms with final plans to the assigned city project manager.

Project Name: Fairmont Scottsdale Privado welcome building and parking area	Plan#: 44-PA-2022
Site Address: 7575 East Princess Drive Scottsdale, AZ 85255	
Contact name: Michale Kollin	Phone: (562) 597-8760

1. HEIGHT ANALYSIS, CH. 5, SEC. 5-354. GENERAL REQUIREMENTS

Applicants must conduct a height analysis for all projects located within 20,000 feet of Scottsdale Airport.

1. Complete a height analysis for all structures, appurtenances or construction equipment through the FAA at: <https://oeaaa.faa.gov/oeaaa/external/portal.jsp>, click on the Notice Criteria Tool (left side). If you do not exceed criteria, submit this FAA response from the website with your packet or you must complete step 2.

IF required by FAA, complete Step 2

2. Submit an FAA form 7460-1 Notice of Proposed Construction or Alteration for review and determination. Please allow about 45 days for this process. A copy of the FAA's response will be required prior to final plan approval.

2. AIRCRAFT NOISE AND OVERFLIGHT DISCLOSURE, CH. 5, SEC. 5-356 & SECT. 5-357

- Incorporate the Airport Disclosure for Development around Scottsdale Airport language into the CC&Rs or other procedural documents and provide a copy. *Exhibit A*
- An avigation easement will need to be granted to the city. If not already recorded for property, submit a notarized Avigation Easement form with packet to your project manager. *Exhibit B*

For questions regarding this form or aviation-related requirements, contact Scottsdale Airport at 480-312-2321.





Notice Criteria Tool

Notice Criteria Tool - Desk Reference Guide V_2018.2.0

The requirements for filing with the Federal Aviation Administration for proposed structures vary based on a number of factors: height, proximity to an airport, location, and frequencies emitted from the structure, etc. For more details, please reference CFR Title 14 Part 77.9.

You must file with the FAA at least 45 days prior to construction if:

- * your structure will exceed 200ft above ground level
- * your structure will be in proximity to an airport and will exceed the slope ratio
- * your structure involves construction of a traverseway (i.e. highway, railroad, waterway etc...) and once adjusted upward with the appropriate vertical distance would exceed a standard of 77.9(a) or (b)
- * your structure will emit frequencies, and does not meet the conditions of the FAA Co-location Policy
- * your structure will be in an instrument approach area and might exceed part 77 Subpart C
- * your proposed structure will be in proximity to a navigation facility and may impact the assurance of navigation signal reception
- * your structure will be on an airport or heliport
- * filing has been requested by the FAA

If you require additional information regarding the filing requirements for your structure, please identify and contact the appropriate FAA representative using the Air Traffic Areas of Responsibility map for Off Airport construction, or contact the FAA Airports Region / District Office for On Airport construction.

The tool below will assist in applying Part 77 Notice Criteria.

Latitude:	<input type="text" value="33"/> Deg <input type="text" value="38"/> M <input type="text" value="43.73"/> S <input type="button" value="N"/>
Longitude:	<input type="text" value="111"/> Deg <input type="text" value="55"/> M <input type="text" value="13.74"/> S <input type="button" value="W"/>
Horizontal Datum:	<input type="button" value="NAD83"/>
Site Elevation (SE):	<input type="text" value="1542"/> (nearest foot)
Structure Height :	<input type="text" value="32"/> (nearest foot)
Traverseway:	<input type="button" value="No Traverseway"/> <small>(Additional height is added to certain structures under 77.9(c)) User can increase the default height adjustment for Traverseway, Private Roadway and Waterway</small>
Is structure on airport:	<input checked="" type="radio"/> No <input type="radio"/> Yes

Results

You exceed the following Notice Criteria:

Your proposed structure is in proximity to a navigation facility and may impact the assurance of navigation signal reception. The FAA, in accordance with 77.9, requests that you file.

The FAA requests that you file

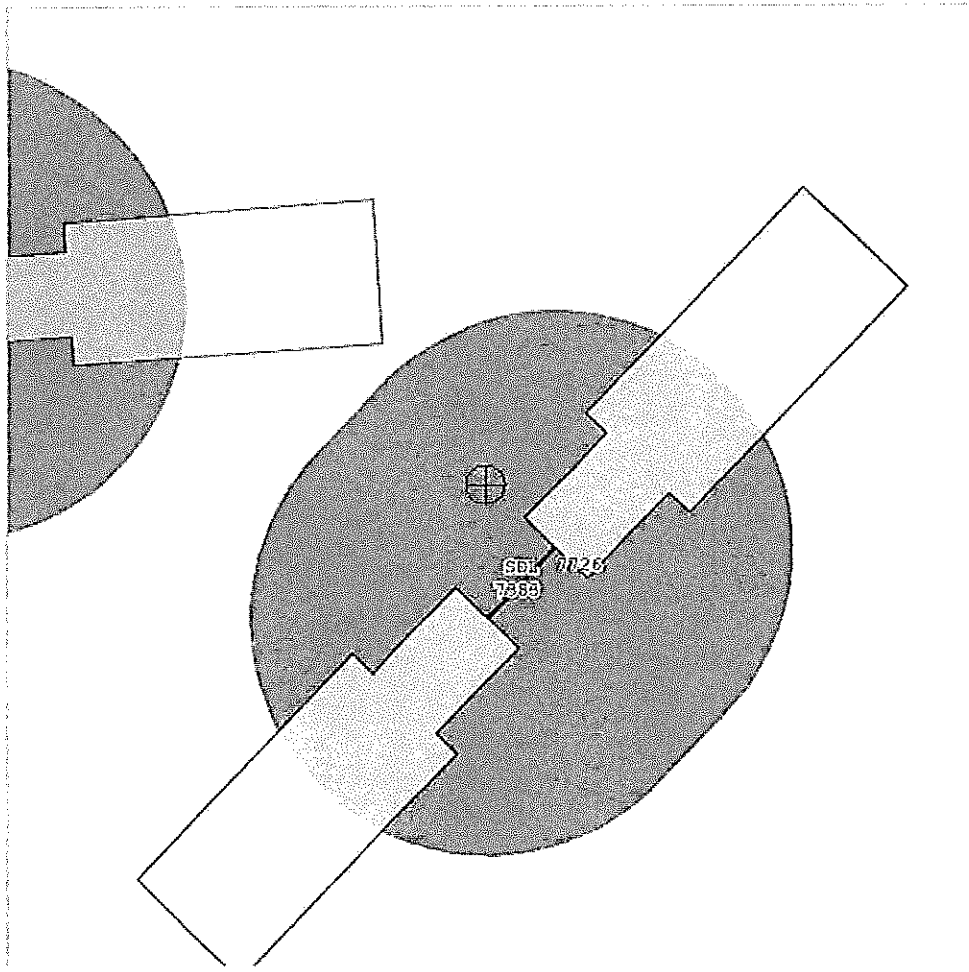

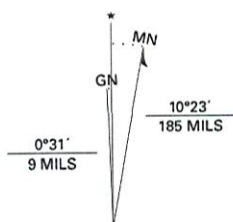
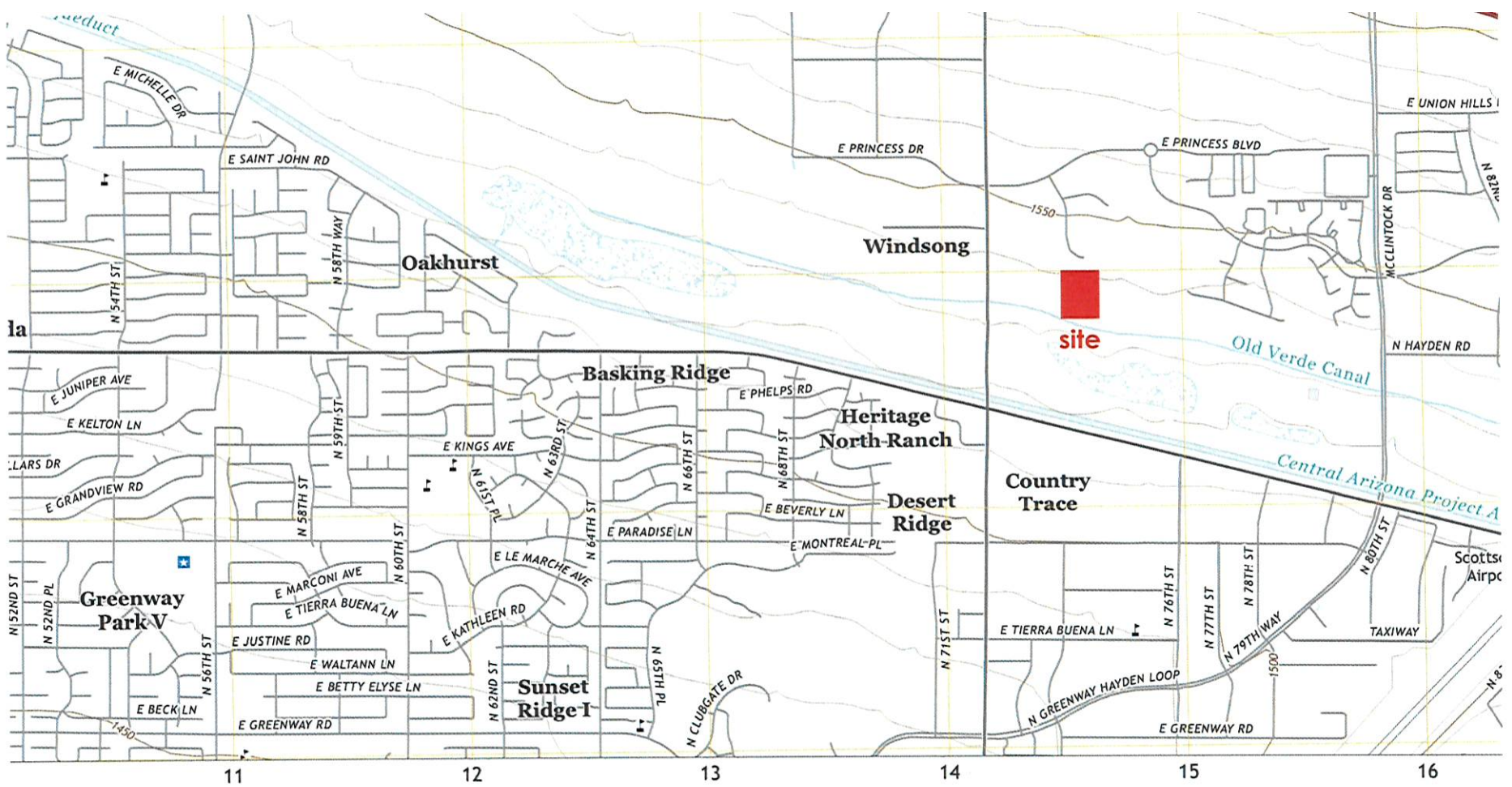

UTM GRID AND 2017 MAGNETIC NORTH DECLINATION AT CENTER OF SHEET

U.S. National Grid
100,000 - m Square ID
VC
Grid Zone Designation

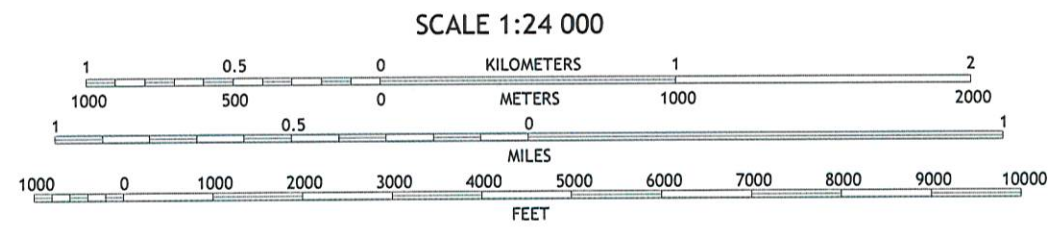

SCALE 1:24 000

CONTOUR INTERVAL 10 FEET
 NORTH AMERICAN VERTICAL DATUM OF 1988

This map was produced to conform with the
 National Geospatial Program US Topo Product Standard, 2011.
 A metadata file associated with this product is draft version 0.6.18



QUADRANGLE LOCATION

- | | | |
|---|---|---|
| 1 | 2 | 3 |
| 4 | 5 | 6 |
| 7 | 8 | |
- 1 New River SE
 - 2 Cave Creek
 - 3 Wildcat Hill
 - 4 Union Hills
 - 5 McDowell Peak
 - 6 Sunnyslope
 - 7 Paradise Valley
 - 8 Sawik Mountain
- ADJOINING QUADRANGLES