

LEGAL DESCRIPTION

THAT PART OF LOT 1, A PROPERTY ASSEMBLAGE IN THE CITY OF SCOTTSDALE, ARIZONA ARMENIAN APOSTOLIC CHURCH OF ARIZONA, ACCORDING TO BOOK 971 OF MAPS, PAGE 46, AND THEREAFTER AFFIDAVIT OF CORRECTION IN RECORDING NO. 2008-0228799, RECORDS OF MARICOPA COUNTY, ARIZONA MORE PARTICULARLY DESCRIBED AS FOLLOWS:

BEGINNING AT THE NORTHEAST CORNER OF SAID LOT 1;

THENCE ALONG THE BOUNDARY OF SAID LOT 1 THE FOLLOWING 7 COURSES;

SOUTH 00 DEGREES 01 MINUTES 53 SECONDS EAST, A DISTANCE OF 642.27 FEET;

NORTH 89 DEGREES 58 MINUTES 49 SECONDS WEST, A DISTANCE OF 88.67 FEET;

SOUTH 00 DEGREES 14 MINUTES 45 SECONDS WEST, A DISTANCE OF 330.14 FEET;

NORTH 89 DEGREES 58 MINUTES 46 SECONDS WEST, A DISTANCE OF 261.00 FEET;

NORTH 00 DEGREES 14 MINUTES 45 SECONDS EAST, A DISTANCE OF 466.89 FEET;

THENCE DEPARTING FROM SAID BOUNDARY LINE OF LOT 1, SOUTH 89 DEGREES 44 MINUTES 15 SECONDS EAST, A DISTANCE OF 212.22 FEET TO POINT OF CURVATURE OF A NON-TANGENT CIRCULAR CURVE TO THE LEFT, HAVING A RADIUS OF 113.52 FEET, A CENTRAL ANGLE OF 34 DEGREES 03 MINUTES 44 SECONDS, AND BEING SUBTENDED BY A CHORD WHICH BEARS NORTH 74 DEGREES 04 MINUTES 45 SECONDS EAST - 66.50 FEET;

THENCE IN A NORTHEASTERLY DIRECTION ALONG SAID CURVE TO THE LEFT, A DISTANCE OF 67.49 FEET;

THENCE NORTH 00 DEGREES 14 MINUTES 45 SECONDS EAST NON-TANGENT TO SAID CURVE, A DISTANCE OF 211.13 FEET;

THENCE NORTH 89 DEGREES 57 MINUTES 59 SECONDS EAST, A DISTANCE OF 21.82 FEET;

THENCE NORTH 00 DEGREES 00 MINUTES 54 SECONDS WEST, A DISTANCE OF 76.96 FEET;

THENCE SOUTH 89 DEGREES 59 MINUTES 06 SECONDS WEST, A DISTANCE OF 22.22 FEET;

THENCE NORTH 00 DEGREES 14 MINUTES 45 SECONDS EAST, A DISTANCE OF 40.07 FEET;

THENCE NORTH 89 DEGREES 45 MINUTES 15 SECONDS WEST, A DISTANCE OF 38.18 FEET;

THENCE NORTH 00 DEGREES 14 MINUTES 45 SECONDS EAST, A DISTANCE OF 67.58 FEET;

THENCE NORTH 89 DEGREES 45 MINUTES 15 SECONDS WEST, A DISTANCE OF 55.38 FEET;

THENCE NORTH 00 DEGREES 01 MINUTES 04 SECONDS EAST, A DISTANCE OF 91.97 FEET TO A POINT ON THE NORTH LINE OF SAID LOT 1 WHICH IS THE SOUTH RIGHT-OF-WAY LINE OF CHOLLA STREET;

THENCE SOUTH 89 DEGREES 58 MINUTES 56 SECONDS EAST ALONG SAID NORTH LINE OF LOT 1 AND RIGHT-OF-WAY LINE, A DISTANCE OF 165.16 FEET TO THE POINT OF BEGINNING.

CONTAINING 180,107 SQUARE FEET OR 4.13 ACRES MORE OR LESS.

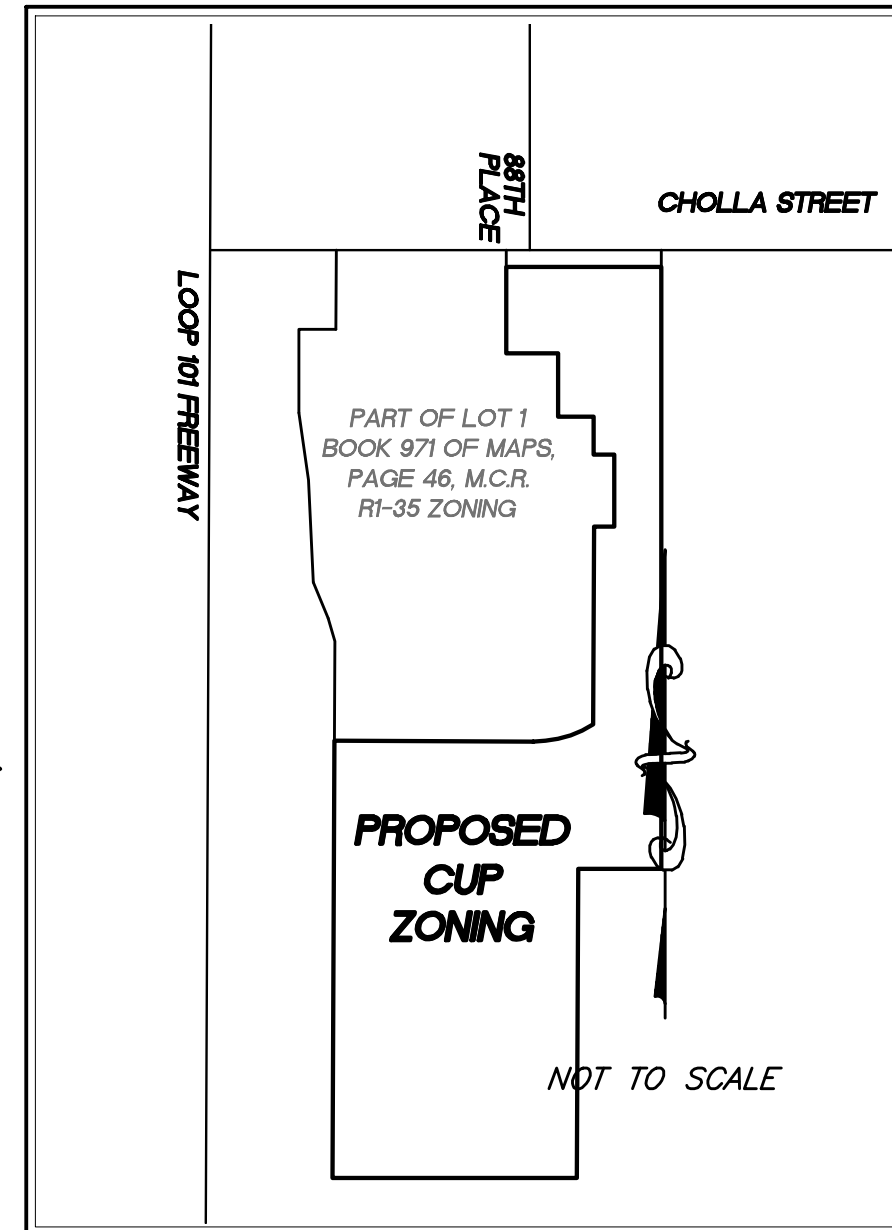

SITE MAP
SEE SHEET 2



LEGAL DESCRIPTION

SHEET 1 OF 2

JOB NO : P18-096

DATE : 10/02/20



Arizona Surveying and Mapping

2440 W. MISSION LANE, SUITE 4, PHOENIX, AZ 85021
TEL (602) 246-9919 FAX (602) 246-9944 info@asami.com