

RECTORY ADDITION TO  
ST. BERNARD OF CLAIRVAUX CATHOLIC CHURCH  
10755 N. 124TH ST. - SCOTTSDALE, ARIZONA 85259  
FLOOR PLAN WORKSHEET

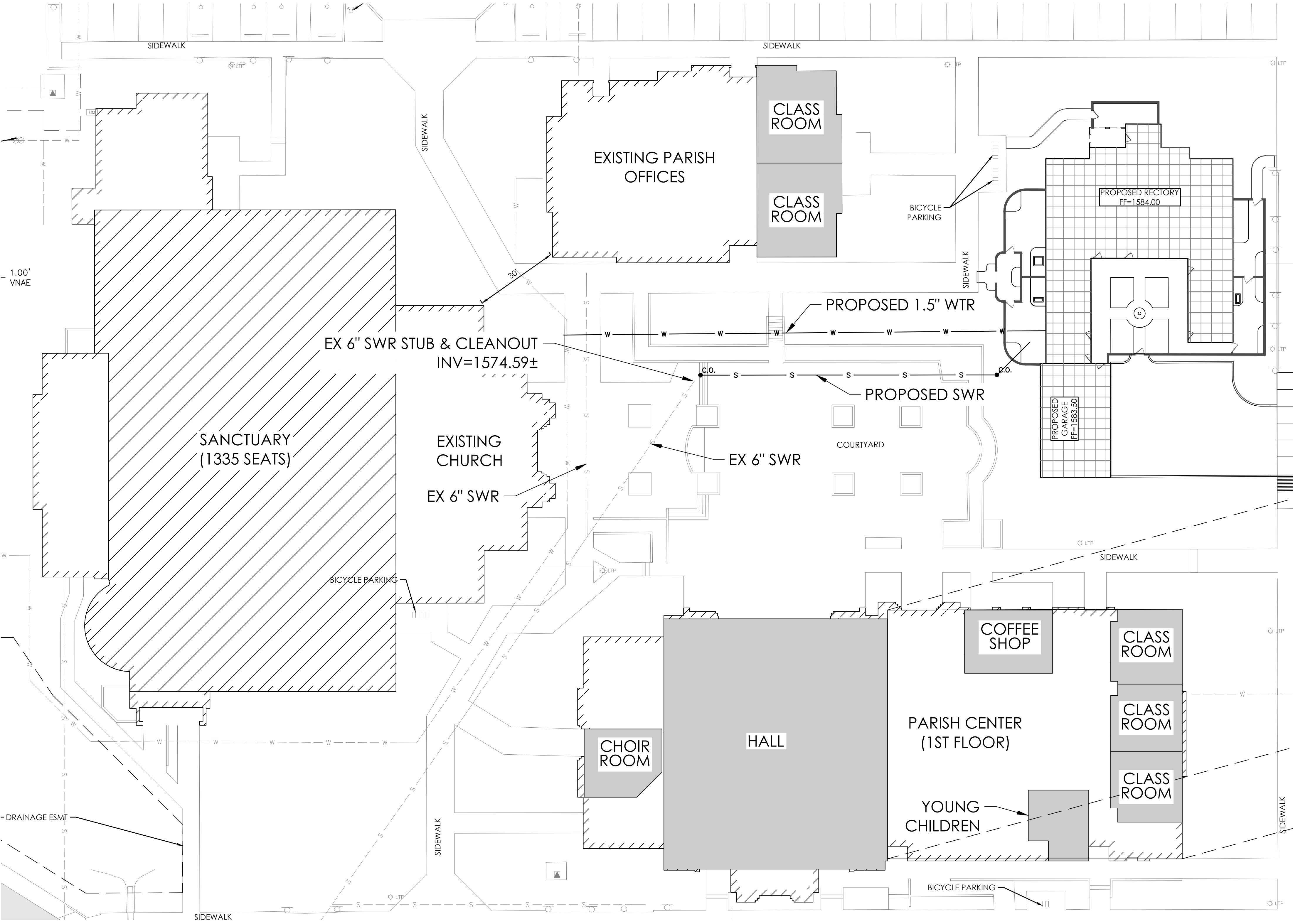

AREA TABULATION	
EXISTING PARISH OFFICES & PARISH CENTER	PROPOSED BUILDINGS
CHOIR PRACTICE ROOM: 634 SF	RECTORY: 3,448 SF
HALL: 6,667 SF	RECTORY GARAGE: 1,009 SF
COFFEE SHOP: 734 SF	TOTAL: 4,657 SF
YOUNG CHILDREN: 479 SF	
CLASSROOMS: 5,859 SF	
YOUTH MEETING: 1,060 SF	
GAME ROOM: 553 SF	
TOTAL: 15,996 SF	

SEATING TABULATION	
SANCTUARY PEWS (FIXED) 18" SPACING PER CODE:	1,224
DISABLED ACCESSIBLE SEATING AREAS:	10
CHAIRS (CHOIR, CHAPEL, CHANCEL):	101
TOTAL:	1,335

PARKING TABULATION	
SPACES REQUIRED	SPACES PROVIDED (EXISTING)
FIXED SEATS (1,335 / 4) =	372
CLASSROOM & MEETING AREAS (15,996 SF / 300) =	16
PROPOSED RECTORY =	2
TOTAL:	390
ACCESSIBLE SPACES REQUIRED (390 x .04) =	16
VAN ACCESSIBLE SPACES REQUIRED (TABLE 9.4 ZONING ORDINANCE) =	2
STANDARD SPACES REQUIRED (390-18)	372
BICYCLE PARKING REQUIRED 390 / 10 =	39
TOTAL REQUIRED:	39
SPACES PROVIDED (PROPOSED)	
STANDARD SPACES (GARAGE) =	3
TOTAL:	3
SPACES REMOVED (PROPOSED)	
STANDARD SPACES REMOVED FOR DRIVE-IN =	(2)
TOTAL:	(2)
SPACES PROVIDED (PROPOSED+EXISTING)	
TOTAL SPACES =	391
BICYCLE PARKING PROVIDED	
EXISTING =	42
PROPOSED =	0
TOTAL PROVIDED:	42

LEGEND

- CLASSROOM & MEETING AREAS
- FIXED SEATING AREAS
- PROPOSED BUILDING

NOTE:

THE SITE CURRENTLY PROVIDES 2 STANDARD PARKING SPACES FOR 2 OF THE PRIESTS. THE RECTORY WILL HOUSE AT LEAST 2 PRIESTS (POSSIBLY 4 IN THE FUTURE). SINCE A 3-CAR GARAGE IS PROVIDED WITHIN THE PROPOSED RECTORY THE PRIESTS THAT RESIDE IN RECTORY WILL NOT OCCUPY AT LEAST 2 OF THE PARKING SPACES EXISTING ON-SITE PARKING SPACES. THERE ARE 5 TOTAL LIVING UNITS IN THE RECTORY. SINCE THERE IS ONE ADDITIONAL PARKING SPACE IN THE GARAGE, THEN CONSERVATIVELY, ONLY 2 SPACES WOULD BE REQUIRED FOR THE RECTORY ADDITION.

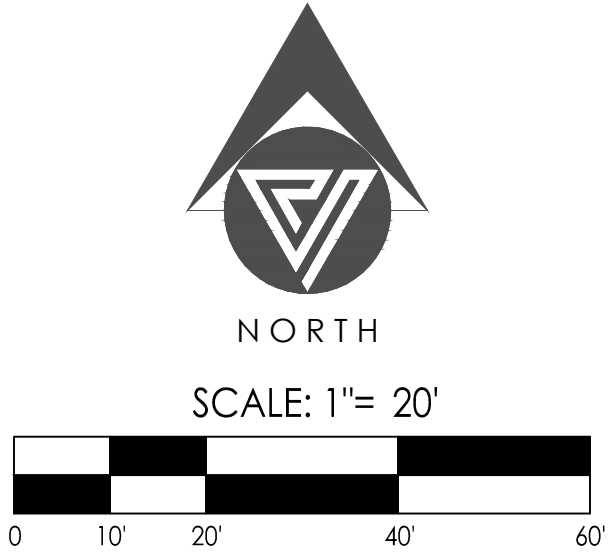
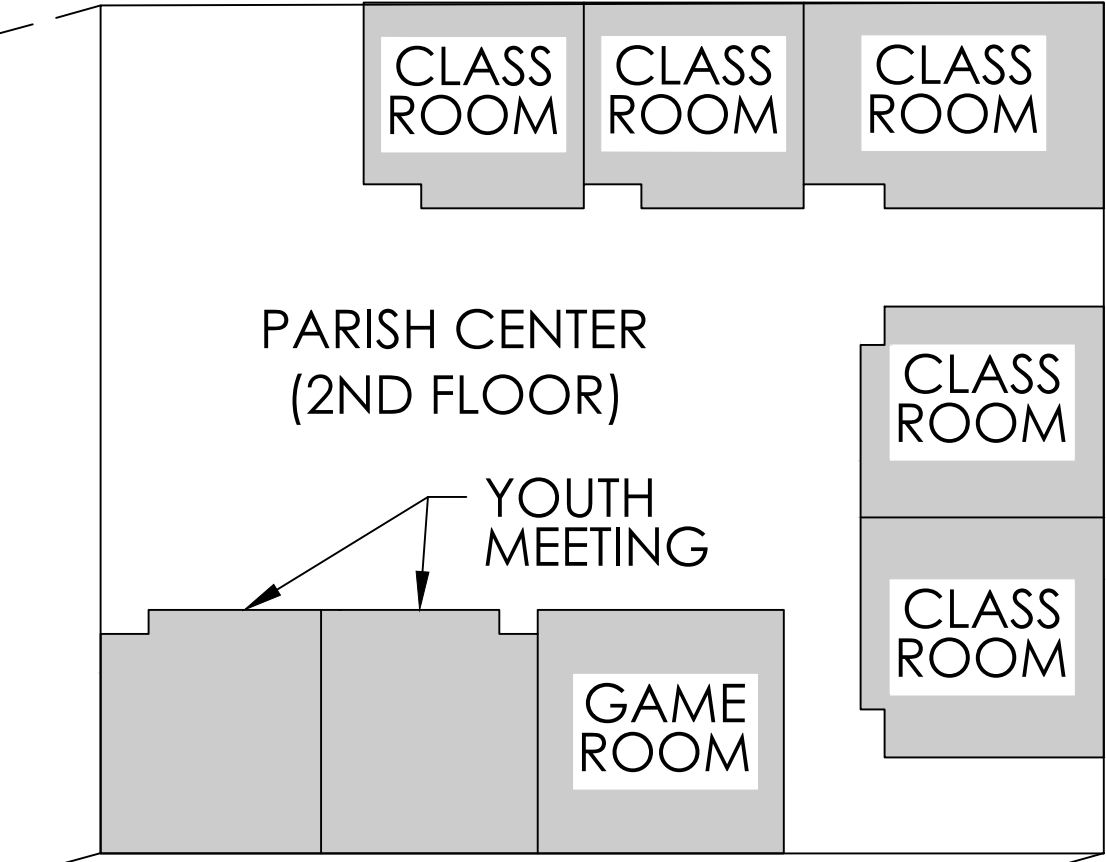

**VESPRO**

8502 E. Via de Ventura, Suite 101  
Scottsdale, AZ 85258  
Ph: (480) 393-3444 Fax: (480) 393-3439  
www.Vespro.net

REVISIONS

RECTORY ADDITION TO ST. BERNARD OF CLAIRVAUX CATHOLIC CHURCH  
10755 N. 124TH ST. - SCOTTSDALE, ARIZONA 85259  
FLOOR PLAN WORKSHEET



PROJECT NO:	20004
DRAWING DATE:	9/21/21
DRAWN BY:	MEC
CHECKED BY:	PV
DRAWING SCALE:	AS SHOWN
DRAWING FILE:	20004-C-SP-1.DWG

FLOOR PLAN WORKSHEET  
**FPW1**  
1 of 1

C.O.S. PROJECT NO. 866-PA-2020 - KEY CODE 91728 - NEW PHASE TO 38-DR-2010