



ARCHITECT:
Robert Rogacki - Project Manager
CHIPMAN DESIGN ARCHITECTURE INC
1350 East Touhy, First Floor East
Des Plaines, IL 60018
P: 847-298-6900
E: rrogacki@chipman-design.com

ENGINEER:
Vincent Burns - Principal
CES
216 E. 45th Street, 16th Floor
New York, NY 10017
P: 203-507-4908

STRUCTURAL ENGINEER:
Rod McComas - Vice President Managing Principal
MCCOMAS/DONNEL & NACCARATO
1717 E. 116th Street, #200
Carmel, IN 46032
P: 317-249-4784

DESIGNER
Leslie Baluga - Senior Designer
PUTTSHACK
303 W. Erie St. Suite 600
Chicago, IL 60654
P: 608-728-1827

DATE:	ISSUED:
03/14/2022	ISSUE FOR PERMIT
04/15/2022	ISSUE FOR BID
05/25/2022	PERMIT CORRECTIONS
06/24/2022	ISSUED FOR CONSTRUCTION
06/24/2022	REVISION #1
08/29/2022	PLANNING DEPARTMENT CORRECTIONS

CLIENT:
PUTTSHACK
303 W. ERIE ST., SUITE 600
CHICAGO, IL 60654

PROJECT:
PUTTSHACK
15059 N. Scottsdale Road, Suite 100
Scottsdale, AZ 85254

DRAWING TITLE:
**REFLECTED CEILING PLAN -
LOWER LEVEL & NOTES**

SEAL & SIGNATURE

I HEREBY CERTIFY THAT THESE PLANS HAVE BEEN PREPARED IN MY OFFICE AND UNDER MY SUPERVISION AND THAT TO THE BEST OF MY KNOWLEDGE, THE SAME COMPLY WITH ALL LAWS, RULES, REGULATIONS AND ORDINANCES OF **SCOTTSDALE, AZ** RELATING TO STRUCTURES AND BUILDINGS.

Date of Signature: N/A
Expiration Date: 12/31/2024

Date: 04/26/2022
CDA ID: 21-2703
Drawn by: [RG/YN]
Checked by: [TS]
Dwg. No.

Drawn by: ## of

SYMBOL LEGEND

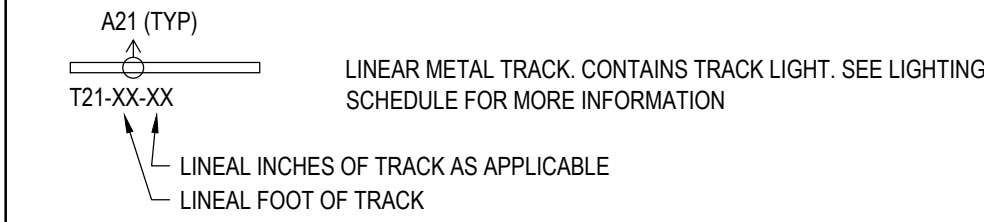

GENERAL CEILING NOTES

- G.C. TO REVIEW CEILING PLAN AND NOTIFY ARCHITECT OF ANY CONFLICTS SUCH AS DUCT WORK, PIPING, ELECTRICAL, ETC. PRIOR TO PROCEEDING WITH CONSTRUCTION.
- ALL ACOUSTICAL CEILING GRIDS SHALL BE ENTERED IN EACH ROOM, U.N.O
- SEE LIFE SAFETY PLANS FOR EXIT SIGN LOCATIONS, WHICH AS SHOWN FOR DESIGN INTENT ONLY. FINAL LOCATIONS SHALL BE VERIFIED WITH THE LOCAL CODE OFFICIALS AND FIRE DEPARTMENT
- SEE ELECTRICAL PLANS FOR FINAL LIGHTING LAYOUT, INCLUDING EMERGENCY BACK-UP FIXTURE
- ELECTRICAL CONTRACTOR TO MAKE ALL FINAL CONNECTIONS TO MILLWORK / FIXTURES / IN FIELD.
- SEE MECHANICAL PLANS FOR FINAL HVAC GRILLS, DIFFUSERS, DUCTS, AIR RETURNS, ETC. LAYOUT
- SEE FIRE PROTECTION DRAWINGS FOR FIRE ALARM AND SPRINKLER LAYOUT
- ALL FIRE PROTECTION SPRINKLER HEADS ARE TO BE PLACED AS TO NOT INTERFERE WITH LIGHTING, HVAC, AND STORE FIXTURING COMPONENTS
- ALL SPRINKLER HEADS IN DROPPED CEILINGS TO BE FLUSH MOUNT WITH COVER PLATE AT ALL FINISHED CEILINGS, CENTERED ON LIGHT FIXTURES LAYOUT OR CEILING TILES AS APPLICABLE.
- PROVIDE MOISTURE RESISTANT GYP. BOARD AT TOILET ROOM CEILINGS
- NOTHING IS PERMITTED TO ATTACH TO, SUSPENDED FROM, OR PENETRATE ROOF DECK. G.C. MAY ONLY ATTACH TO TOP CHORD OF I-BEAMS PER LANDLORD REQUIREMENT. ALL WALL/CLG./OVERHEAD CONSTRUCTION TO BE SUPPORTED IN THIS MANNER. NO WELDING OR SHOOTING INTO STRUCTURE IS PERMITTED. COORDINATE EXTENT OF EXACT REQUIREMENTS WITH LANDLORD'S REP.
- GC TO COORDINATE ALL NECESSARY WALL OR CEILING ACCESS PANELS WITH LAYOUT. PROVIDE ACCESS PANEL LAYOUT TO ARCHITECT AND ENGINEER FOR APPROVAL. REFER TO MEP SHEETS FOR MORE INFORMATION. GC TO INCLUDE IN BID QTY. (12) MIN. 24"x24" CONCEALED TYPE IN GYP. BD. CEILINGS
- GC TO CLEAN ALL INSTALLED LIGHTING FIXTURES PRIOR TO TURN OVER AS REQUIRE
- CEILING GRID IN BACK OF HOUSE SUPPORT OFFICES (U.N.O) ARE TO BE HUNG WITH #12 HANGER WIRES (48"O.C.) WITH ADDITIONAL WIRES AT ALL FOUR CORNERS OF ALL LIGHT FIXTURES, DIFFUSERS, ETC.
- SUSPENDED ACOUSTICAL CEILING SYSTEM IS TO BE IN COMPLIANCE WITH THE APPLICABLE CODE AND ASTM C 635 AND ASTM C 636.
- COORDINATE LIGHTING FIXTURE LOCATIONS AND DIFFUSER LOCATIONS WITH OTHER CEILING COMPONENTS WITH LIGHTING BEING THE DECIDING COMPONENT.
- GENERAL CONTRACTOR TO COORDINATE SCOPE OF WORK WITH SPEAKER VENDOR. GC TO PROVIDE AS REQUIRED J-BOXES, VOLUME CONTROLS, PULL WIRE AND INSTALL SPEAKER CANS. GC TO COORDINATE FINAL HOOK UP OF ALL EQUIPMENT WITH VENDOR.
- CONTRACTOR TO PROVIDE COORDINATION DRAWING FOR ALL TRADES INCLUDING SPRINKLER, MECHANICAL ELECTRICAL, FIRE ALARM, SECURITY, ACCESS PANEL & ETC. IN CEILING FOR ARCHITECT'S APPROVAL PRIOR TO CONSTRUCTION. UNCOORDINATED CONDITIONS THAT ARE CONTRARY TO THE DESIGN INTENT ARE THE SOLE RESPONSIBILITY OF THE CONTRACTOR TO RESOLVE.
- IN THE CASE OF DISCREPANCY BETWEEN THE ARCHITECT'S AND/OR ENGINEER'S DRAWINGS, THE MORE STRINGENT, HIGHER QUANTITY, OR HIGHER QUALITY SHALL PREVAIL. ARCHITECT IS TO BE ADVISED OF ALL DISCREPANCIES PRIOR TO START OF CONSTRUCTION.
- ALL DIMENSIONS TO BE COORDINATED IN THE FIELD WITH PUTTSHACK AND ARE SUBJECT TO EXISTING CONDITIONS DIMENSIONS MARKED AS EQUAL (EQ.) APPLY ONLY WITHIN A GIVEN STRING OF DIMENSIONS UNLESS OTHERWISE MARKED.
- ALL SPEAKERS IN DROPPED CEILINGS MUST BE FLUSH MOUNT AND FINISHED TO MATCH ADJACENT CEILING FINISH. GC TO COORDINATE WITH SPEAKER CONTRACTOR TO CENTER SPEAKERS BETWEEN LIGHT FIXTURES (ALONG STRAIGHT OR DIAGONAL LINE) AS SHOWN ON PLAN WHEREVER POSSIBLE.
- ALL CONDUITS TO BE CONCEALED UNLESS OTHERWISE NOTED. LAYOUT FOR ANY EXPOSED ELECTRICAL CONDUIT TO BE APPROVED BY PUTTSHACK IN FIELD PRIOR TO INSTALLATION.
- GC TO VERIFY ALL CEILING FINISHES WITH PUTTSHACK PRIOR TO CONSTRUCTION. ALL CEILING ELEMENTS AND DEVICES (LIGHT FIXTURE HOUSINGS AND TRIMS, SPEAKERS, SPRINKLER CAPS, GRILLES, DIFFUSERS, ETC.) SHALL BE PRE-FINISHED OR BE PAINTED OR COLORED THE SAME COLOR AS THE ADJACENT CEILING PAINT. ALL PAINTING SHALL BE COMPLETED OFFSITE. GC TO COORDINATE WITH VENDORS AND SUBCONTRACTORS FOR CORRECT FINISHES AND LONG LEAD ITEMS.
- ALL VERTICAL ELEMENTS OF SOFFITS TO BE PAINTED TO MATCH ADJACENT COPLANAR WALL PAINT UNO.
- SEE FINISH SCHEDULE FOR CEILING FLAME SPREAD INFORMATION.
- GC TO PLUG ALL LIGHT LEAKS IN DISPLAY WALLS/FIXTURES.
- ALL TRIMLESS LIGHTS TO RECEIVE TEARAWAY BEAD. TRIMLESS LIGHTS TO HAVE SMOOTH, CLEAN EDGES AND ARE TO BE INSTALLED FLUSH WITH ADJACENT CEILING.
- LIGHT GRID TAKES PRECEDENCE WHEN INSTALLING ALL CEILING ELEMENTS. IF ANY INTERFERENCES OCCUR BETWEEN LIGHT GRID, CEILING DIFFUSERS, SPEAKERS, ETC. THE LIGHT GRID SHALL NOT MOVE. GC SHALL NOTIFY ARCHITECT OF DISCREPANCY. ALL CEILING ELEMENTS TO ALIGN WITH GRID.
- REFER TO LIGHTING FIXTURE SCHEDULE AND NOTES ON ELECTRICAL DRAWINGS FOR FIXTURE SUPPLY/ INSTALLATION RESPONSIBILITIES AND EMERGENCY LIGHTING LOCATIONS.
- GC TO REPAIR ALL EXISTING FIREPROOFING AS REQUIRED TO MAINTAIN REQUIRED FIRE RATING. REFER TO BASE BUILDING DRAWINGS FOR EXISTING FIRE RATING
- ELECTRICIAN TO MARK ALL SWITCH, OUTLET, SPEAKER, CAMERA AND SECURITY LOCATIONS IN FIELD AND WALK THROUGH WITH PUTTSHACK BEFORE INSTALLATION - ALL LOCATIONS ARE SUBJECT TO PUTTSHACK APPROVAL.
- GC TO PROVIDE PLENUM RATED WIRE OR CONDUIT AS REQUIRED BY LOCAL JURISDICTION.

NOTES:

- SEE LIGHTING SCHEDULE ON A-120 & ELECTRICAL DRAWINGS FOR LIGHTING SPECIFICATIONS.
- G.C. TO PROVIDE FIRE TREATED OR NON COMBUSTIBLE BLOCKING ABOVE CEILING OR ON WALL, AS REQUIRED, FOR ALL CEILING / WALL MOUNTED SPECIALTY LIGHTING FIXTURES & SIGNS, U.O.N.
- COORDINATE WORK WITH LANDLORD ON CONNECTIONS TO SHELL BUILDING.
- REPLACE OR COVER EXISTING EXPOSED SPRAY-ON FIRE PROOFING ABOVE FOOD & BEVERAGE SERVICE AREAS TO ALLOW FOR SMOOTH NON-POROUS & CLEANABLE SURFACE. REPLACE SPRAY-ON FIREPROOFING WITH INTUMESCENT PAINT OF THE SAME RATING. ALTERNATE: BOX OUT EXISTING BEAMS WITH TYPE-X GYP. BD. TERMINATE COVERED BEAMS AT NEAREST COLUMN.
- EMERGENCY LIGHTING SHALL BE LOCATED 13' ADF.

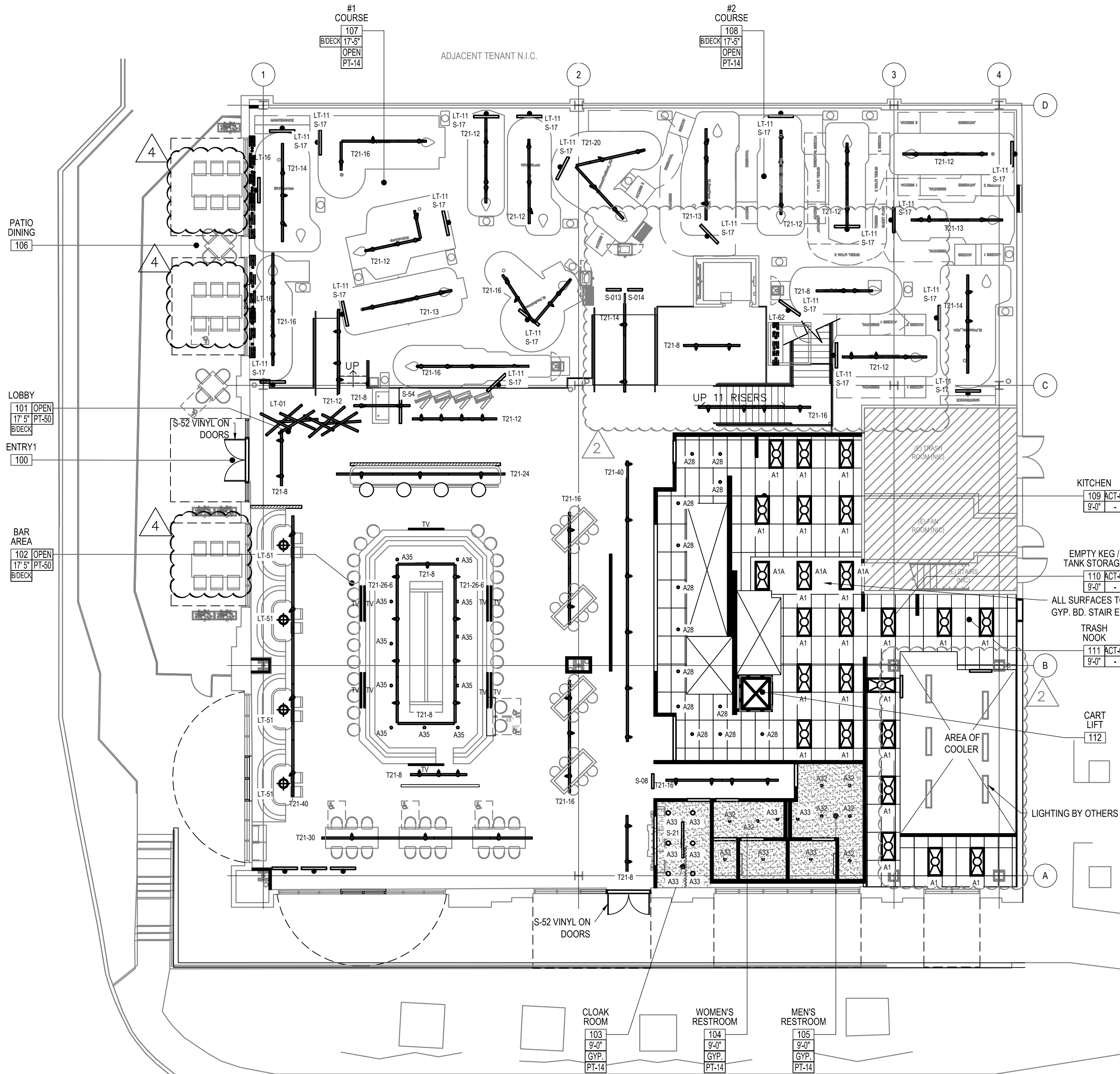

REFLECTED CEILING PLAN - LOWER LEVEL

SCALE: 3/32" = 1'-0"

