

ALTA SURVEY OF A  
PORTION OF THE NORTHWEST  
QUARTER OF THE SOUTHWEST  
QUARTER SOUTHWEST QUARTER  
(GOVERNMENT LOT 4) OF  
SECTION 19, TOWNSHIP 3 NORTH,  
RANGE 5 EAST OF THE SALT RIVER  
BASE AND MERIDIAN, MARICOPA  
COUNTY, ARIZONA

LEGAL DESCRIPTION

That portion of the Northwest quarter of the Southwest quarter of the Southwest quarter (Government Lot 4) of Section 19, Township 3 North, Range 5 East of the Gila and Salt River Base and Meridian, Maricopa County, Arizona, described as follows;

COMMENCING at the Northwest corner of the Northwest quarter of the Southwest quarter of the Southwest quarter of said Section 19, from which the Southwest corner of said Section 19 bears South 00 degrees 20 minutes 21 seconds West, 1320.40 feet;

Thence South 89 degrees 52 minutes 33 seconds East, along the North line of the Northwest quarter of the Southwest quarter of the Southwest quarter of said Section 19, a distance of 365.39 feet to the Point of Beginning;

Thence continuing South 89 degrees 52 minutes 33 seconds East, 273.99 feet to the Northwest corner of Edwards Business Park, a subdivision recorded in Book 287 of Maps, page 20, Maricopa County Records;

Thence South 00 degrees 11 minutes 34 seconds West, along the west line of said Edwards Business Park, 145.00 feet;

Thence North 89 degrees 52 minutes 33 seconds West, parallel with the North line of the Northwest quarter of the Southwest quarter of the Southwest quarter, 137.00 feet;

Thence South 00 degrees 11 minutes 34 seconds West, a distance of 180.00 feet;

Thence North 89 degrees 52 minutes 33 seconds West, parallel with the North line of the Northwest quarter of the Southwest quarter of the Southwest quarter, a distance of 136.99 feet;

Thence North 00 degrees 11 minutes 34 seconds East, 325.00 feet to the Point of Beginning.

LEGEND

	PROPERTY LINE
	EASEMENT LINE
	SECTION LINE
	CENTER LINE
	FOUND MONUMENTS (AS NOTED)
	PROPERTY CORNERS (SET 1/2" REBAR WITH LS 17591 CAP OR AS NOTED)
	AIR CONDITIONING UNIT
	IRRIGATION CONTROL VALVE
	SANITARY SEWER
	BACK OF CURB
	SIDEWALK

BASIS OF BEARINGS

The basis of bearings of this survey is the centerline of Desert Cove Avenue which bears North 89 degrees 52 minutes 33 seconds West per the recorded lot split for the subject parcel as shown in City of Scottsdale Lot Split Number 43LS99 and recorded in the Docket No. 99-1023364 of the Maricopa County Records.

CERTIFICATION

This is to certify to Security Title Agency, Inc., Bertram E. Feingold and Betty A. Feingold, as Trustees of the Feingold Family Trust and Tilldale Management, L.L.C. Pension and Profit Sharing Trust that this map or plat and the survey it is based were made (i) in accordance with "Minimum Standard Detail Requirements for ALTA/ACSM Land Title Surveys," jointly established and adopted by ALTA and ACSM in 1997, and includes items 1, 2, 3, 4, 8 and 11 (above ground evidence only) of Table A thereof, and (ii) pursuant to the Accuracy Standards (as adopted by ALTA and ACSM and in effect on the date of the certification) of a(n) Urban Survey.

DATE OF SURVEY

This parcel was surveyed on January 7, 2002.

PARCEL 2  
(43LS99)  
DKT 99-1023364  
M.C.R.

MARLBORO COURT  
(BOOK 267 OF MAPS, PAGE 36 M.C.R.)

LOT 3  
EDWARDS BUSINESS  
PARK  
(BOOK 257 OF MAPS, PAGE 20 M.C.R.)

NET PARCEL AREA  
60,241.8610 sq. ft.  
or  
1.3830 acres

ACCESS EASEMENT PER  
DKT NO. 99-1023364 M.C.R.

DESERT COVE AVENUE

FLOOD INSURANCE RATE MAP (FIRM) INFORMATION

COMMUNITY NUMBER	PANEL NUMBER (PANEL DATE)	SUFFIX	DATE OF FIRM (INDEX DATE)	FIRM ZONE	BASE FLOOD ELEVATION (IN AD ZONE, USE 007TH)
045012	1685 7-19-01	E	7-19-01	X	N/A

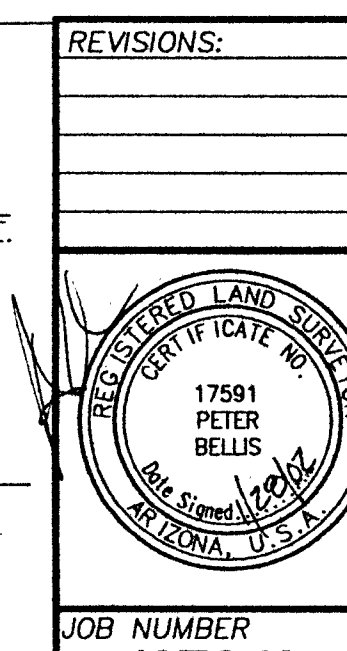
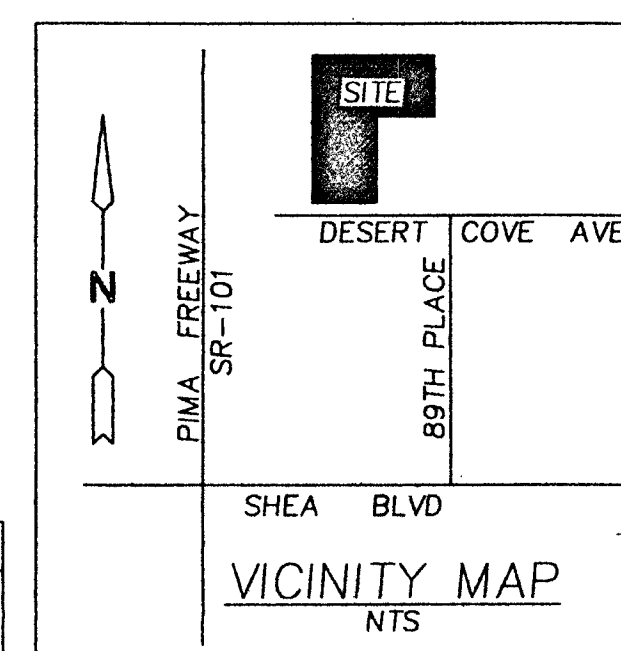

ALTA SURVEY OF A PORTION  
OF SEC 19, T3N, R5E

DESIGN	DRAWN	CHECKED	DATE	FILE NAME	SHEET
JR	JR	PB	1-02	107049	1 OF 1

**PINNACLE  
ENGINEERING, INC.**

8712 EAST VISTA BONITA DRIVE  
SCOTTSDALE, ARIZONA 85255 • (480) 585-6013  
EMAIL: support@pinnacleengineers.com FAX (480) 585-1777

JOB NUMBER  
107049