



500 Washington Avenue South, Suite 1080  
Minneapolis, MN 55415  
p 612.339.5508 | f 612.339.5382  
www.esgarch.com

I hereby certify that this plan, specification, or report was prepared by me or under my direct supervision and that I am a duly licensed architect under the laws of the State of Arizona

Signature \_\_\_\_\_

Typed or Printed Name \_\_\_\_\_

License # \_\_\_\_\_ Date \_\_\_\_\_

**NOT FOR CONSTRUCTION**

**DRB SUBMITTAL**  
**01/31/2023**

REVISIONS No.	Description	Date

221564  
PROJECT NUMBER  
Author \_\_\_\_\_  
DRAWN BY CHECKER BY \_\_\_\_\_

KEY PLAN

Gold Dust Ave &  
Scottsdale Rd

EXTERIOR BUILDING MATERIALS

**A.z.6**



STUCCO  
TEXTURE ONLY, REFER TO COLORS ON RIGHT

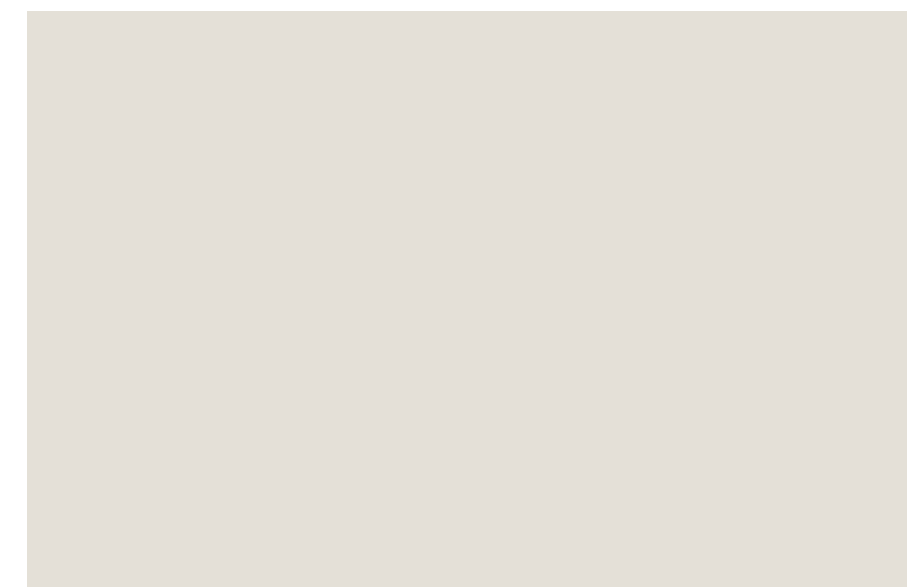

ST-1 STUCCO  
SW 9585 | SUNBLEACHED  
LRV: 75



ST-2 STUCCO  
SW 7528 | WINDSOR GREIGE  
LRV: 47



ST-3 STUCCO  
SW 7069 | IRON ORE  
LRV: 6



ST-4 STUCCO  
SW 9597 | WESTERN RESERVE  
LRV: 36



ST-5 STUCCO  
SW 9098 | BAKED COOKIE  
LRV: 16

**ELEVATION MATERIAL KEY**

ST-1	STUCCO - COLOR 'A'
ST-2	STUCCO - COLOR 'B'
ST-3	STUCCO - COLOR 'C'
ST-4	STUCCO - COLOR 'D'
ST-5	STUCCO - COLOR 'E'
STN-1	STONE
TR-1	TILE ROOFING
R-1	STEEL RAILING
CT-1	DECORATIVE TILE
DS-1	COPPER DOWNSPOUT
W-1	WINDOW/DOORS
SF-1	ALUMINUM STOREFRONT
PERG	PERGOLA SHADING ELEMENT
RT-1	PAINTED RAFTER TAILS



STN-1 STONE  
GINGER



TR-1 CONCRETE TILE ROOF  
TERRACOTTA



CT-1 DECORATIVE TILE

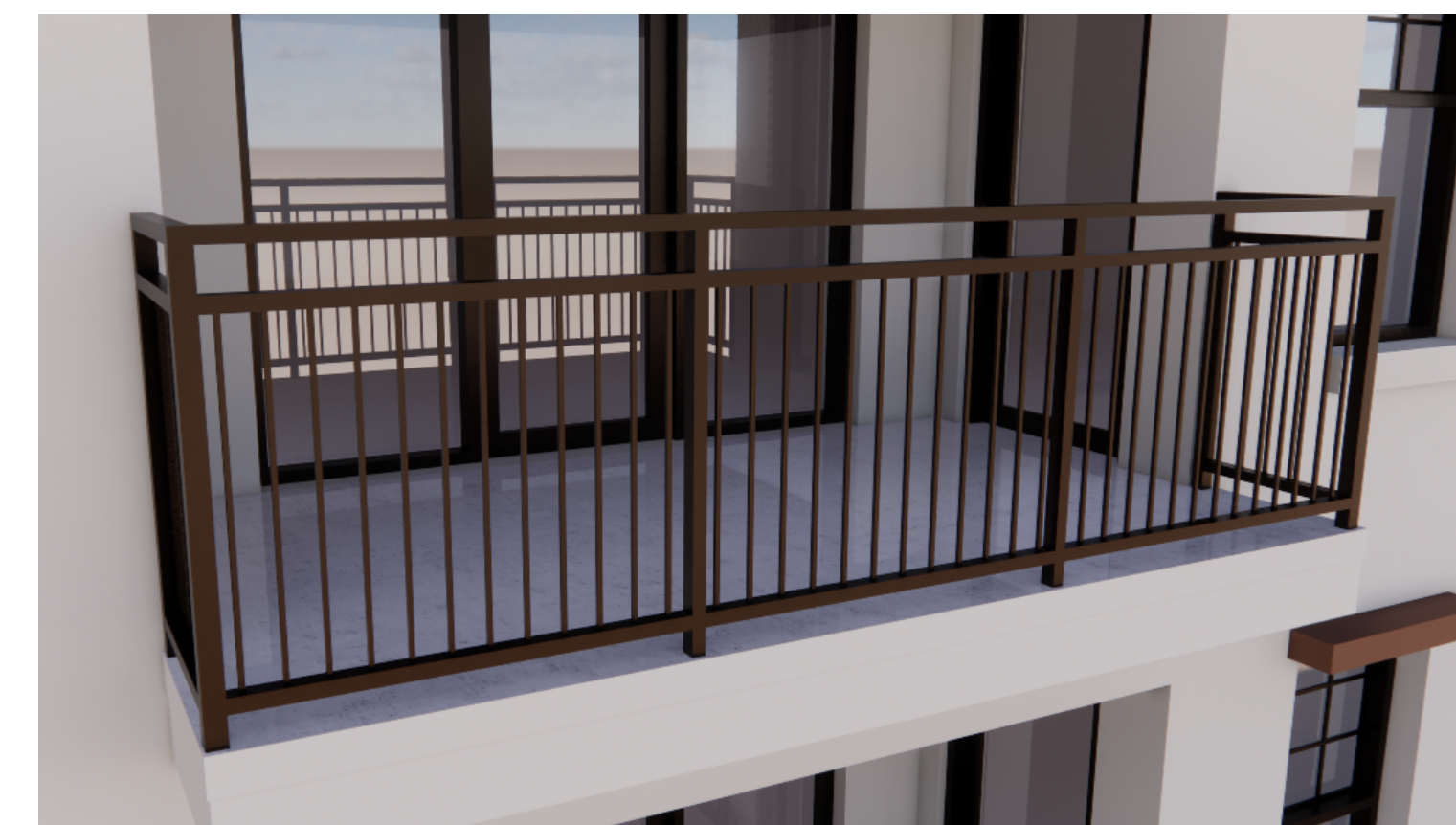

R-1 STEEL RAILING  
COLOR: DARK BRONZE

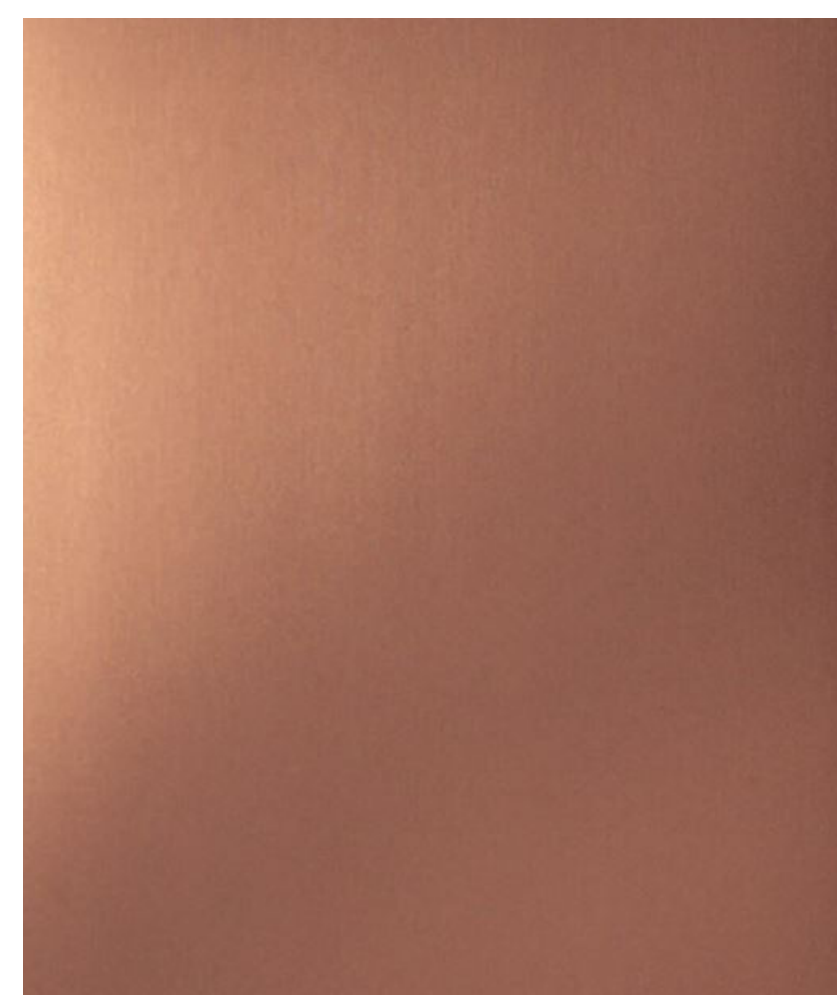

DS-1 COPPER COLORED DOWNPOUT

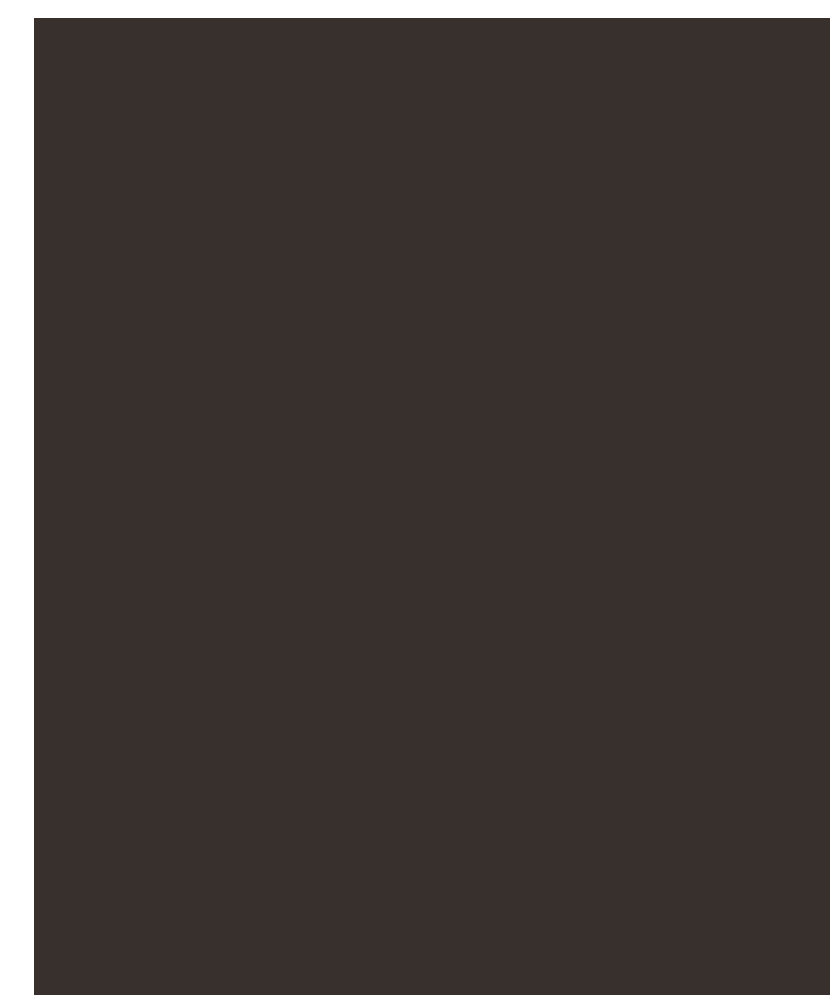

SF-1 ALUMINUM STOREFRONT  
COLOR: DARK BRONZE

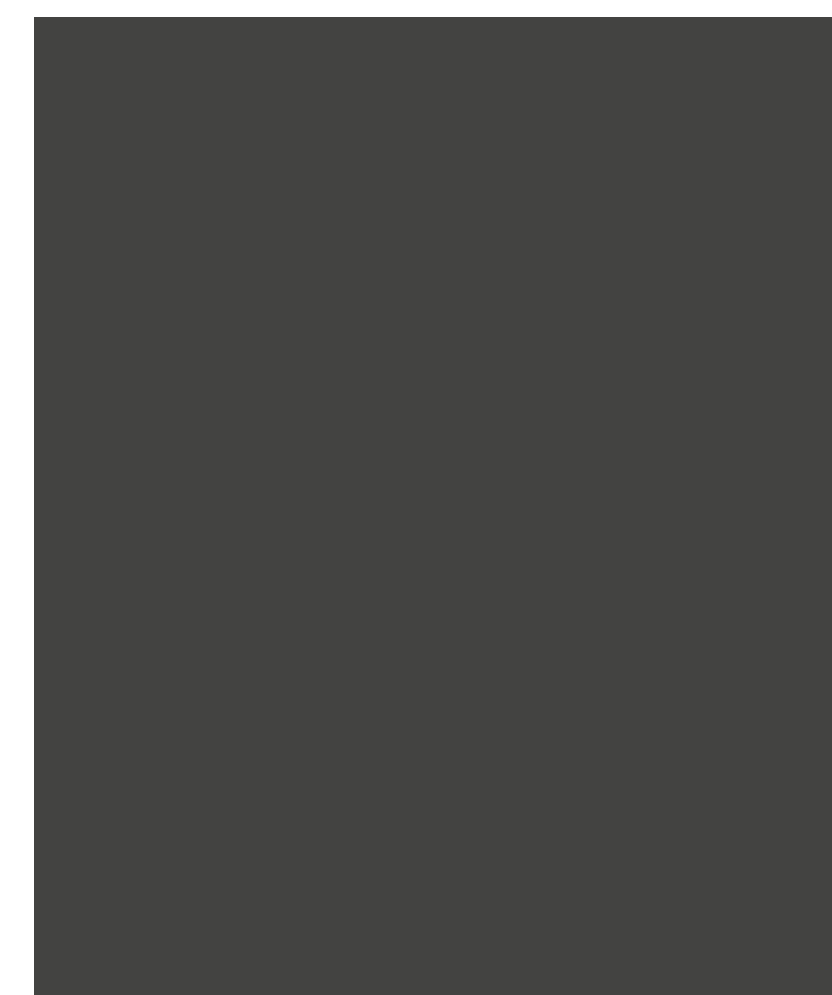

RT-1 PAINTED RAFTER TAILS  
SW 7069 | IRON ORE



PERG PERGOLA SHADING ELEMENT

