

MATCH LINE SEE SHEET C5.1

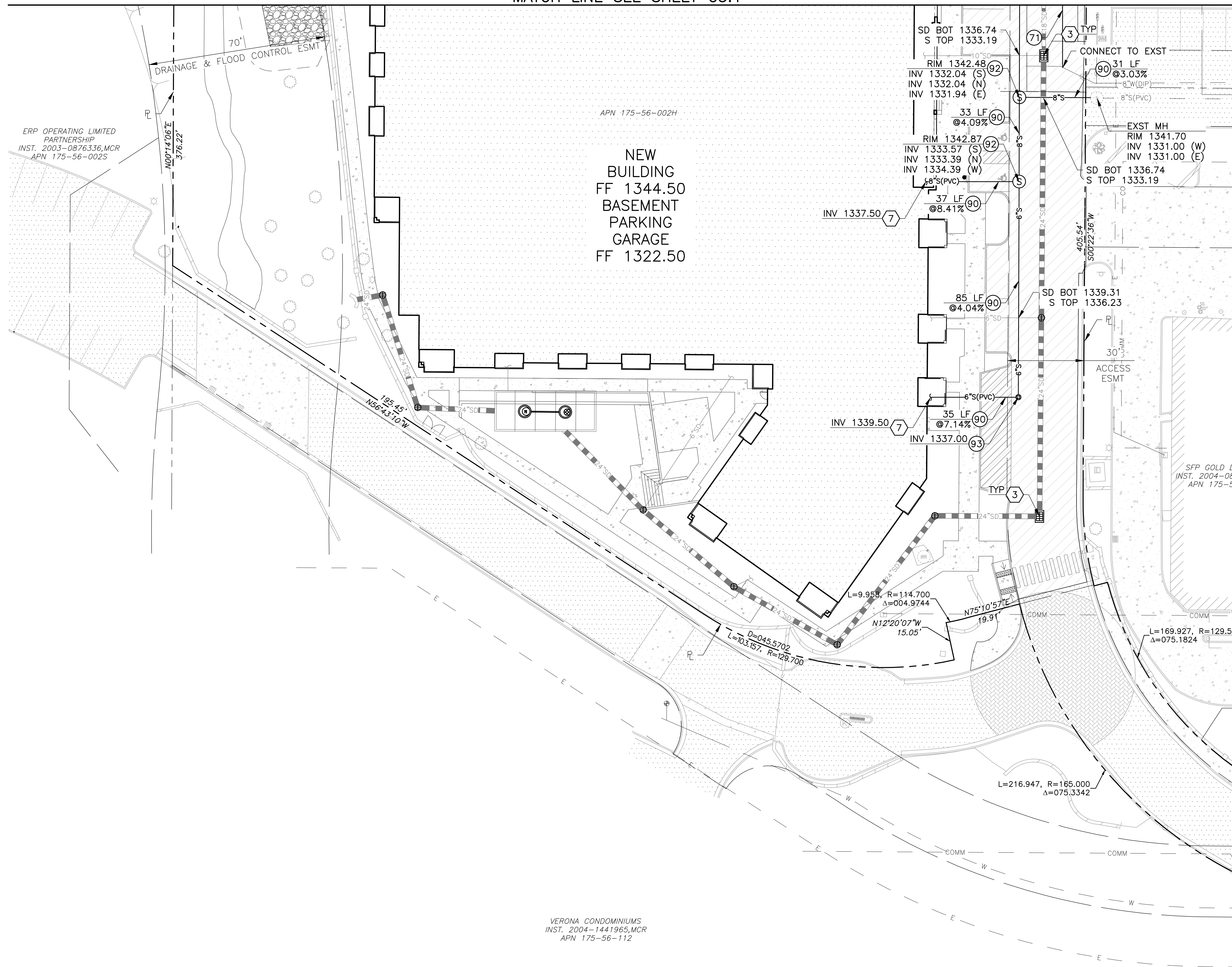

CONSTRUCTION NOTES

- 71 WATER LINE W/FITTINGS, DIP CL 350 W/POLYWRAP, SIZE PER PLAN
- 90 SEWER SERVICE LINE, PVC SDR 35 SIZE PER PLAN
- 92 SEWER MANHOLE COS STD DET 2420
- 93 SEWER CLEANOUT W/BOX & COVER MAG STD DET 441

REFERENCE NOTES

- 3 DRAINAGE IMPROVEMENTS REFER TO GRADING & DRAINAGE PLANS
- 7 FOR CONTINUATION REFER TO PLUMBING PLANS

NOTES:  
 1. EXISTING UTILITIES ARE SHOWN WITH BEST AVAILABLE INFORMATION. NOT ALL UTILITIES MAY BE SHOWN. CONTRACTOR SHALL VERIFY THE HORIZONTAL AND VERTICAL LOCATION OF ALL EXISTING UTILITIES PRIOR TO CONSTRUCTION.

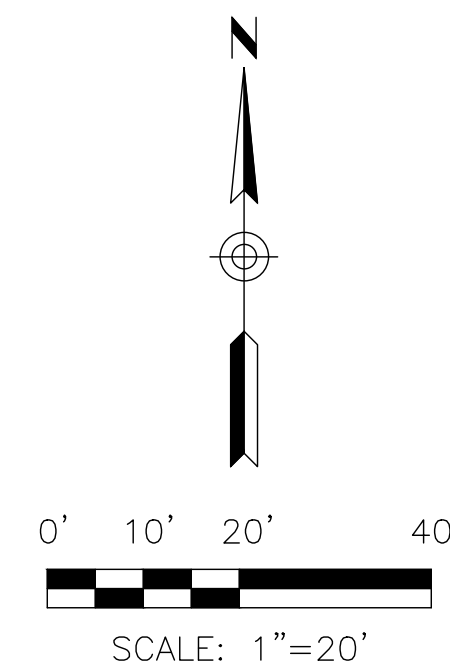

Gold Dust Ave & Scottsdale Rd

Scottsdale, AZ



500 Washington Avenue South, Suite 1080  
 Minneapolis, MN 55415  
 p 612.339.5508 | f 612.339.5382  
 www.esgarch.com

DRB  
 RE-SUBMITTAL  
 04/17/2023

ORIGINAL ISSUE:

REVISIONS  
 No. Description Date

221564  
 PROJECT NUMBER  
 KR SM  
 DRAWN BY CHECKED BY

KEY PLAN

Gold Dust Ave & Scottsdale Rd

UTILITY PLAN

C5.2

VERONA CONDOMINIUMS  
 INST. 2004-1441965, MCR  
 APN 175-56-112

APN 175-56-002H

ERP OPERATING LIMITED  
 PARTNERSHIP  
 INST. 2003-0876336, MCR  
 APN 175-56-002S

NEW  
 BUILDING  
 FF 1344.50  
 BASEMENT  
 PARKING  
 GARAGE  
 FF 1322.50

SFP GOLD DUST LLC  
 INST. 2004-0809318, MCR  
 APN 175-56-002Q