



500 Washington Avenue South, Suite 1080
Minneapolis, MN 55415
p 612.339.5508 | f 612.339.5382
www.esgarch.com

CONSTRUCTION NOTES

- ① ASPHALT PAVEMENT (1/2" MIX)
3"AC/6"ABC/NATIVE COMPACTED TO 95%
REFER TO GEOTECHNICAL REPORT PREPARED BY
SPEEDIE DATED NOVEMBER 9, 2021
- ④ CONCRETE SINGLE CURB
MAG STD DET 222, TYPE A
- ⑤ CONCRETE CURB & GUTTER
MAG STD DET 220-1, TYPE A
- ⑦ CONCRETE SIDEWALK, WIDTH PER PLAN
MAG STD DET 230
- ⑬ CONCRETE SIDEWALK RAMP
DET 1, SHEET C6.1
- ⑳ ADA PARKING SIGN & POST
DET 2, SHEET C6.1
- ㉓ CONCRETE DRIVEWAY
COS STD DET 2256 CL-1
- ㉔ PAVEMENT MARKING
ADA ACCESSIBLE SYMBOL
ADA ACCESSIBLE SYMBOL
DET 3, SHEET C6.1

REFERENCE NOTES

- ③ DRAINAGE IMPROVEMENTS
REFER TO GRADING & DRAINAGE PLANS
- ④ NEW BUILDING
REFER TO ARCHITECTURAL PLANS
- ⑤ WALL/FENCE/GATE
REFER TO ARCHITECTURAL PLANS

- NOTES:
- 1. ALL RADII ARE 3 FEET UNLESS OTHERWISE NOTED.
 - 2. ALL DIMENSIONS ARE MEASURED TO FACE OF CURB UNLESS OTHERWISE NOTED.
 - 3. REFER TO LANDSCAPE PLANS FOR ALL CUSTOM CONCRETE FINISHES, COLORS, JOINT LAYOUTS, GEOMETRIC LAYOUTS AND ADDITIONAL INFORMATION

DRB
RE-SUBMITTAL
04/17/2023

ORIGINAL ISSUE:
REVISIONS
No. Description Date

221564
PROJECT NUMBER
KR SM
DRAWN BY CHECKED BY

KEY PLAN

Gold Dust Ave & Scottsdale Rd

SITE PLAN

C3.1

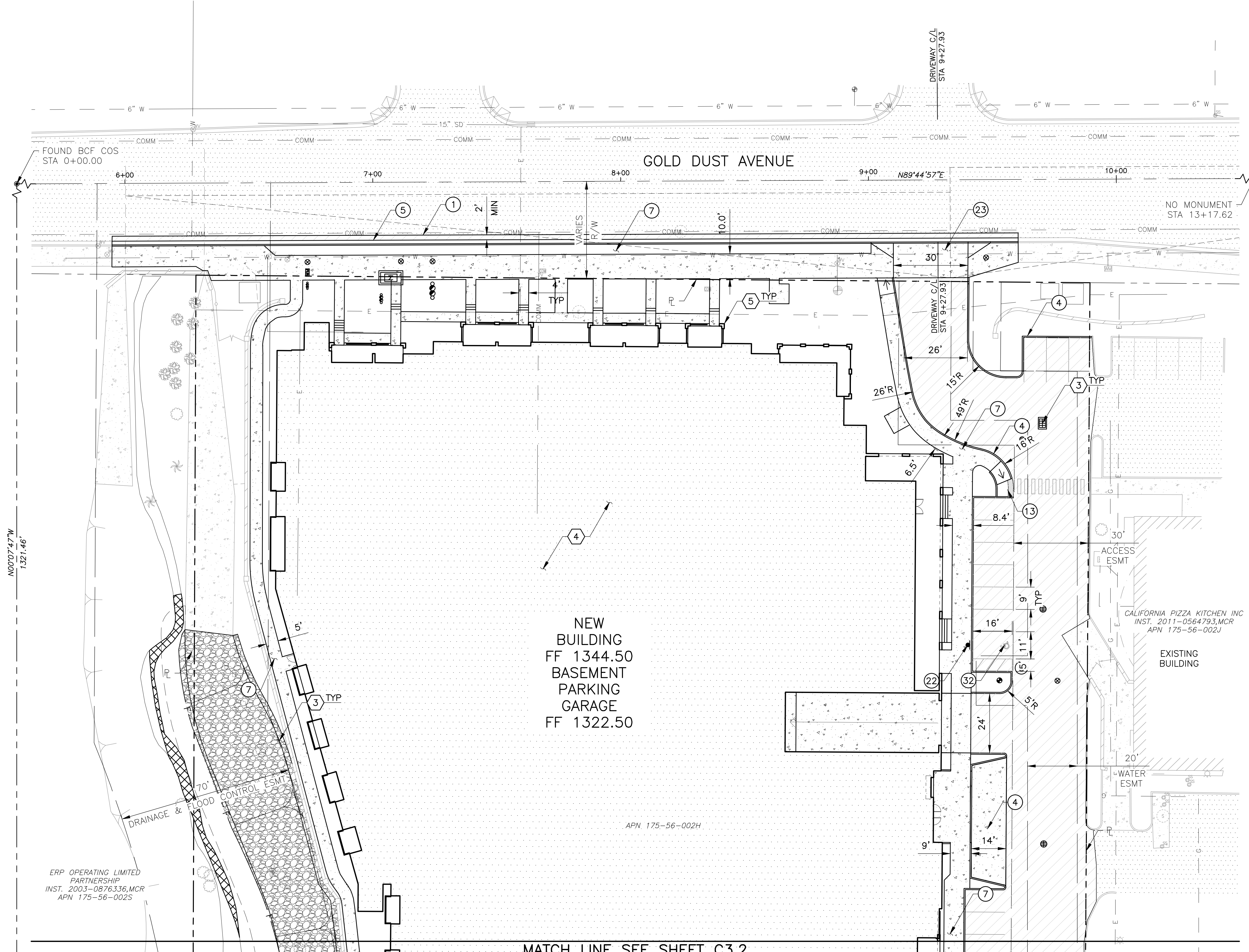

MATCH LINE SEE SHEET C3.2

G:\2023\1122028_Gold_Dust_Apartments\CA0\1122028_C3_X_SITE.dwg 17/04/2023

ERP OPERATING LIMITED PARTNERSHIP
INST. 2003-0876336, MCR
APN 175-56-002S

APN 175-56-002H

