

I hereby certify that this plan, specification, or report was prepared by me or under my direct supervision and that I am a duly licensed architect under the laws of the State of Arizona

Signature _____
Typed or Printed Name _____
License # Date _____

DRB
RE-SUBMITTAL
04/17/23

REVISIONS No.	Description	Date

221564
PROJECT NUMBER
ESG
DRAWN BY
ESG
CHECKED BY

KEY PLAN

Gold Dust Ave & Scottsdale Rd

PARKING PLANS & METRICS WORKSHEET

A.s.1

PARKING METRICS

VEHICLE PARKING QUANTITY	Requirement	Provided
Yoga, Gym (Fitness Studio) = 1,250 SF of GFA = 2,500 GFA nonres / 250 = 10	10 spaces req.	-
Co-Working (Office) = 1,300 SF of GFA = 5,000 GFA / 300 = 16.7 = 17	17 spaces req.	-
Live/Work Units (Office area) = 1,300 SF of GFA = 3,870 GFA of Office area / 300 = 12.9 = 13	13 spaces req.	-
Guest: 1 per 6 units (= 215 / 6 = 35.83 = 36)	36 standard spaces req.	-
1BR: 1.3 spaces/unit (= 1.3 x 165 = 214.5 = 215)	215 standard spaces req.	-
2BR: 1.7 spaces/unit (48 units) (standard = 1.7 x 48 = 81.6 = 82)	82 standard spcs req.	-
3BR: 1.9 spaces/unit (2 units) (1.9 x 2 = 3.8 = 4)	4 standard spcs req.	-
Total Commercial: 40 spaces req.		
Total Residential: 337 standard spaces req.		166+181= 347 standard provided (within structure)
Accessible parking = 4% of the provided		
Within Structure: 347 x .04 = 13.88 = 14 spaces	14 spaces req. (within structure)	16 accessible provided (within structure)
		(347+16=363 provided (within structure, incl. accessible))
		16 provided (surface)
Surface: 16 x .04 = 0.64 = 1 space	1 space req. (surface)	3 accessible provided (surface)
		(16+3=19 provided (surface, incl. accessible))
Total Parking: 377 spaces req. (40+337)		382 Total Provided (incl. accessible stalls)
BIKE PARKING QUANTITY		
2 spaces for every 40 required vehicular pkg spcs (max. 100 req'd)		26 (within structure)
Overall required: (377 / 40 = 9.425 x 2 = 18.85 = 19 spcs req.)	19 spaces req. overall	18 (surface, 9 racks)
		44 Total provided

P1 PARKING METRICS - PROVIDED

STANDARD:	166
(COMPACT: 2)*	
ACCESSIBLE:	9
TOTAL:	175 (177 TOTAL)

P2 PARKING METRICS - PROVIDED

STANDARD:	181
(COMPACT: 2)*	
ACCESSIBLE:	7
TOTAL:	188 (190 TOTAL)

*COMPACT STALLS DO NOT COUNT TOWARD CITY CODE MINIMUM-REQUIRED PARKING

*COMPACT STALLS DO NOT COUNT TOWARD CITY CODE MINIMUM-REQUIRED PARKING

OVERALL PARKING METRICS - PROVIDED

P1 & P2

STANDARD:	347
ACCESSIBLE:	16
TOTAL:	363

SURFACE

STANDARD:	16
ACCESSIBLE:	3
TOTAL:	19

TOTAL

STANDARD:	363
ACCESSIBLE:	19
TOTAL:	382

GENERAL NOTES

- WITHIN TOTAL PROVIDED PARKING, PROVIDING 10 TOTAL DUAL ELECTRIC VEHICLE CHARGING STATIONS (= 20 VEHICLES)

PARKING KEY

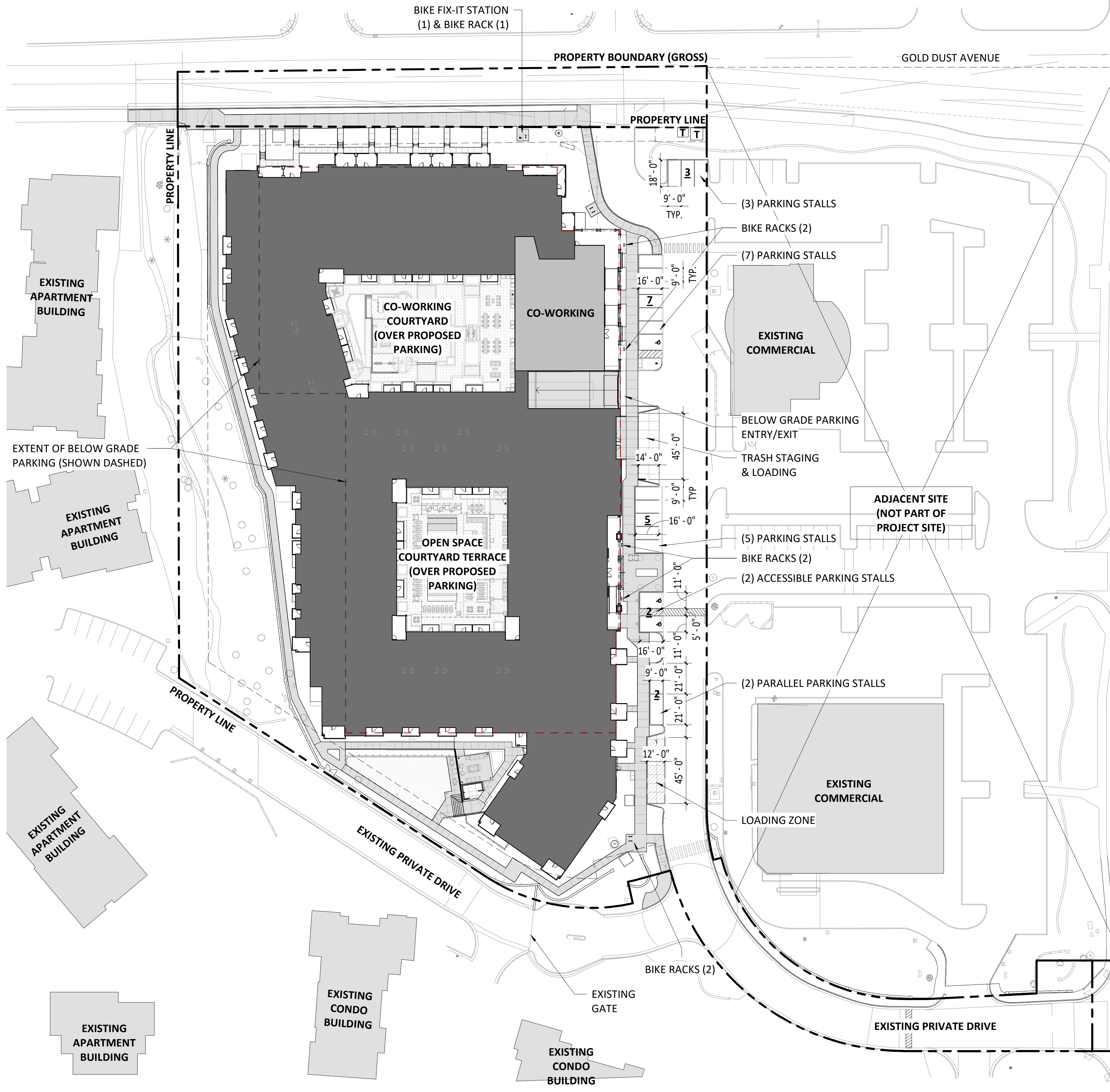
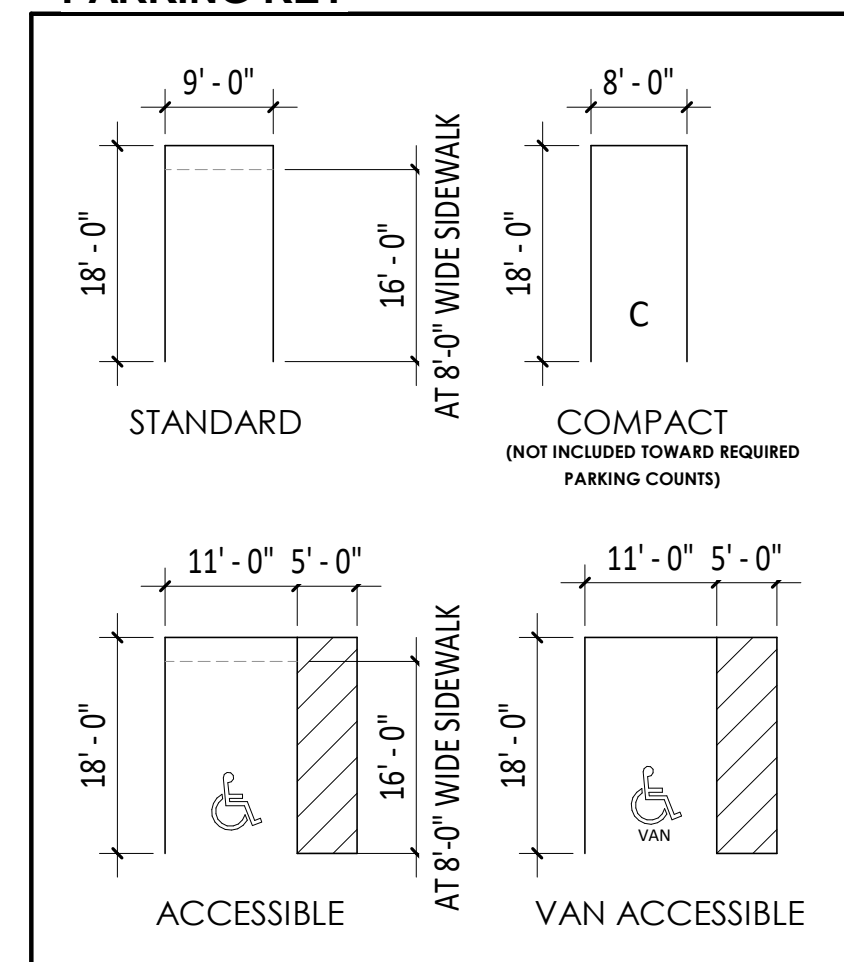

1 SITE PLAN - PARKING
A.s.1 1" = 40'-0"