

Gold Dust Ave & Scottsdale Rd

Scottsdale, AZ



500 Washington Avenue South, Suite 1080
Minneapolis, MN 55415
p 612.339.5508 | f 612.339.5382
www.esgarch.com

I hereby certify that this plan, specification, or report was prepared by me or under my direct supervision and that I am a duly licensed architect under the laws of the State of Arizona

Signature

Typed or Printed Name

License # Date

DRB
RE-SUBMITTAL
04/17/23

REVISIONS No.	Description	Date
---------------	-------------	------

221564	PROJECT NUMBER
ESG	ESG
DRAWN BY	CHECKED BY

KEY PLAN

Gold Dust Ave & Scottsdale Rd

REFUSE PLAN

A.h.1

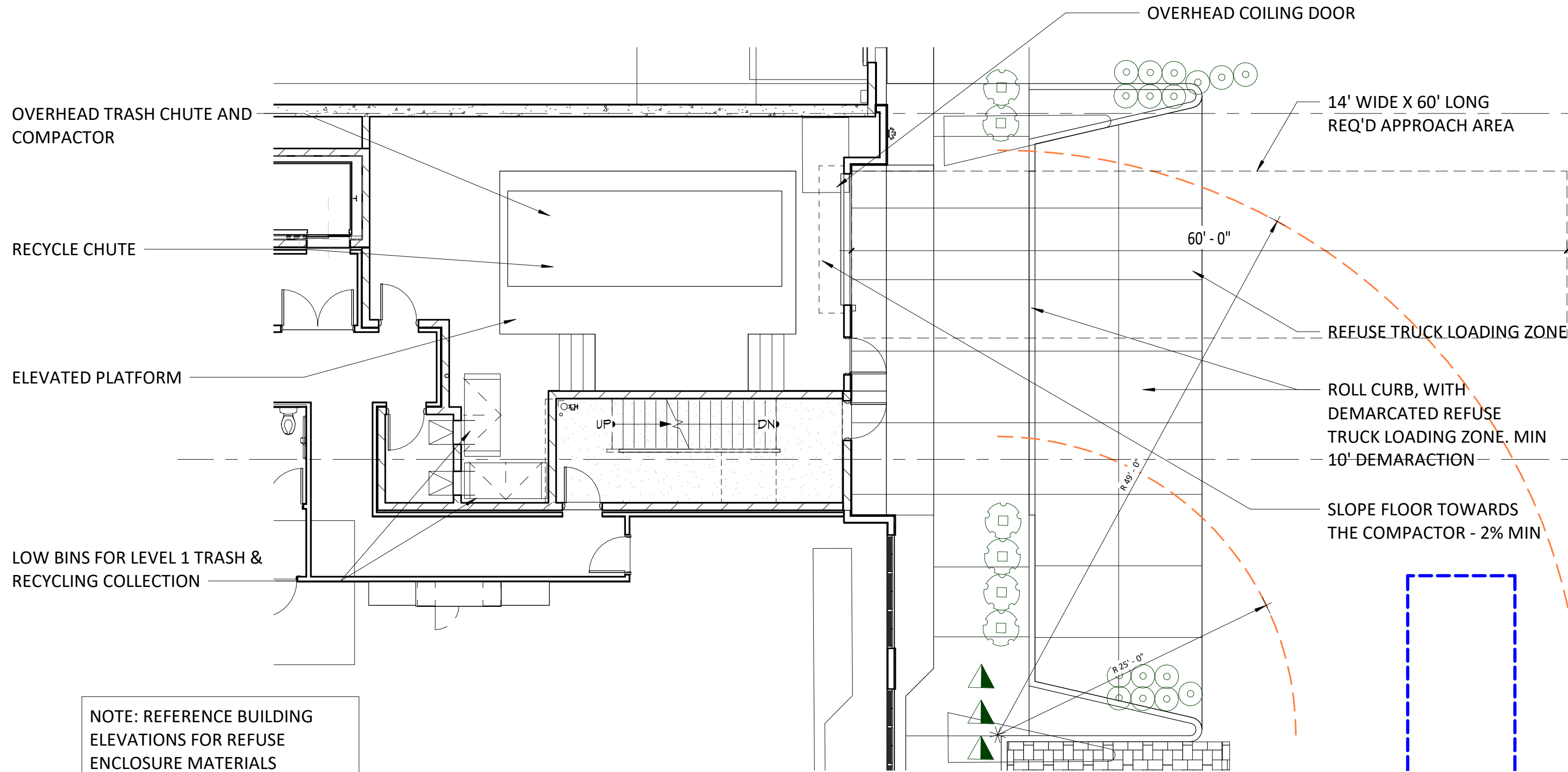

2 ENLARGED FLOOR PLAN - TRASH / RECYCLING ROOM

A.h.1 1/8" = 1'-0"

CITY ENCLOSURE REQUIREMENT (FREE-STANDING CONDITION)

2 ENCLOSURES FOR EVERY 30 UNITS WITH REFUSE & RECYCLING
 $215 / 30 = 7.17 \times 2 = 14.34 =$
15 3-YD (45 CU YDS) REFUSE/RECYCLING ENCLOSED REQ'D

ALTERNATE DESIGN FOR 28 YD DUAL COMPACTOR:

PROVIDING

1 (28 CU YDS, 118 CU YDS UNCOMPACTED) REFUSE/RECYCLING DUAL COMPACTOR (SEE COMPACTOR NOTES BELOW)

WASTE LOAD/COMPACTOR CALCULATIONS (APPROX. ACTUAL WASTE GENERATION MAY VARY)

0.5 CU YD OF UNCOMPACTED REFUSE/RECYCLING PER RESIDENT/WEEK
 $215 \times 0.5 = 108 \text{ CU YDS}$
TOTAL UNCOMPACTED REFUSE/RECYCLING/WEEK

AVG COMPACTOR RATIO 4:1
 $108/4 = 27 \text{ CU YDS/WEEK}$
TOTAL REFUSE/RECYCLING AFTER COMPACTION

SERVICED 1-2 TIME/WEEK (INCLUDES RECYCLING)

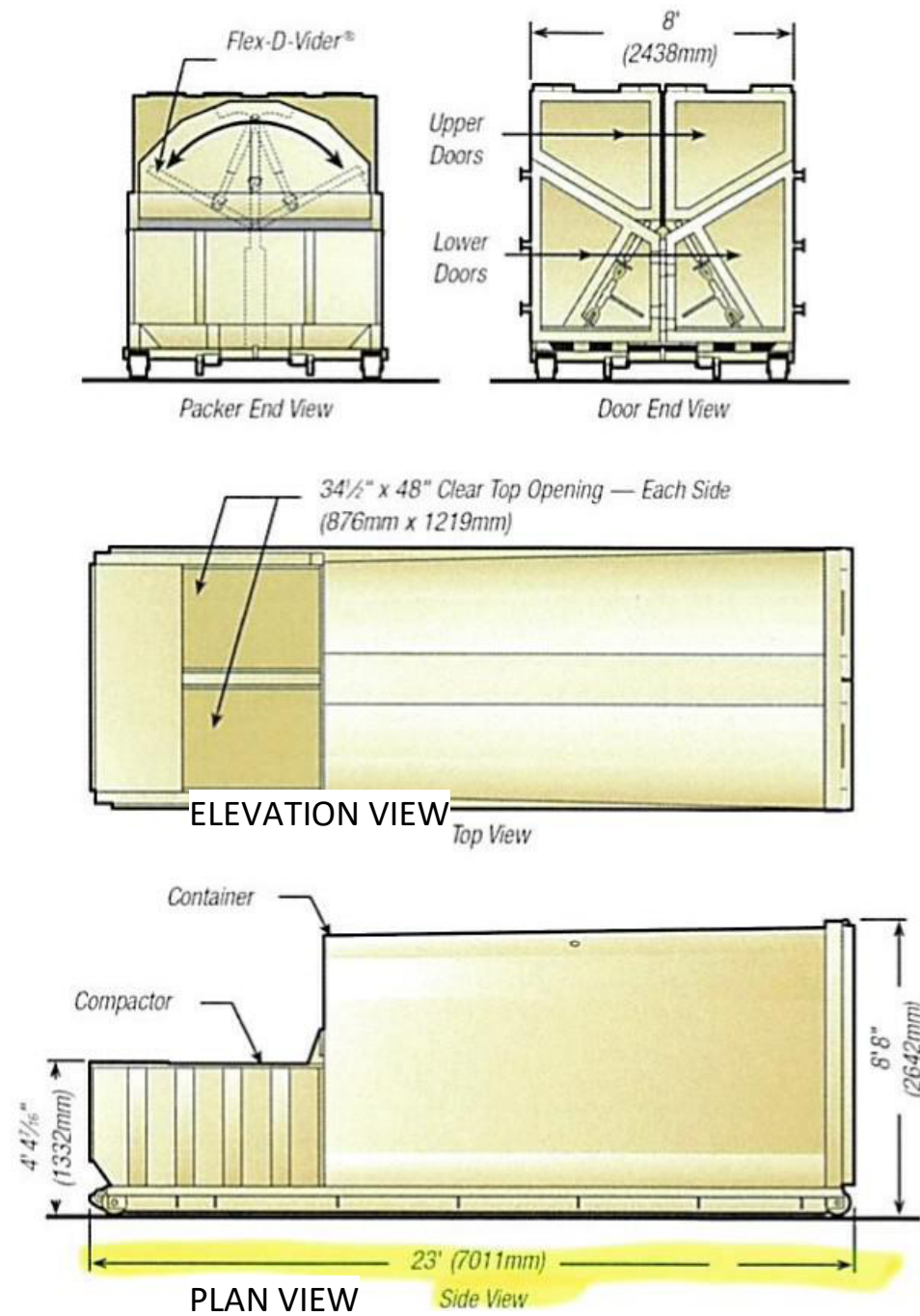

3 TRASH - COMPACTOR

A.h.1 1/2" = 1'-0"

1 SITE PLAN - TRASH COLLECTION PATHWAY

A.h.1 1" = 60'-0"



TRASH/RECYCLING NOTES:

- 1) TRASH & RECYCLING CHUTES ARE LOCATED ON ALL AT- AND ABOVE-GRADE FLOORS. CHUTES TERMINATE IN TRASH/RECYCLING ROOM ADJACENT TO EAST ACCESS DRIVE.
- 2) TRASH AND RECYCLING IS COMPACTED.
- 3) 14' TALL COILING DOOR PROVIDED AT PICK UP LOCATION FOR TRUCK ACCESS.

REFUSE TRUCK PATH OF ACCESS. MIN. 25'-0" VERTICAL CLEARANCE PROVIDED THROUGHOUT. PATH OF ACCESS TO ALLOW FOR MIN 45' TURNING RADIUS. REFER TO CIVIL FOR DETAILS.

PROPERTY BOUNDARY (GROSS)

REFUSE TRUCK ACCESS VIA PRIVATE DRIVE FROM SCOTTSDALE RD