

THIS DRAWING IS PROVIDED AS AN INSTRUMENT OF SERVICE BY DPA ARCHITECTS, INC. ANALYSIS FOR CONSULTANTS AND IS INTENDED FOR USE ONLY BY THE PROJECT TEAM. THIS DRAWING REMAINS THE PROPERTY OF DPA ARCHITECTS, INC. AND SHALL BE RETURNED TO THEM UPON COMPLETION OF THE CONSTRUCTION WORK. PURSUANT TO THE ARCHITECTURAL WORKS CONTRACT ACT OF 2008, ALL DRAWINGS, SPECIFICATIONS, NOTES AND EXHIBITS, INCLUDING THE ORIGINAL, COPYRIGHTED WORK OF THE ARCHITECTS, INC. AND INFORMATION, USE OR DISCLOSURE OF INFORMATION CONTAINED HEREIN WITHOUT WRITTEN CONSENT FROM DPA ARCHITECTS, INC. IS STRICTLY PROHIBITED. © 2018 DPA ARCHITECTS, INC.

1ST STREET

1ST STREET

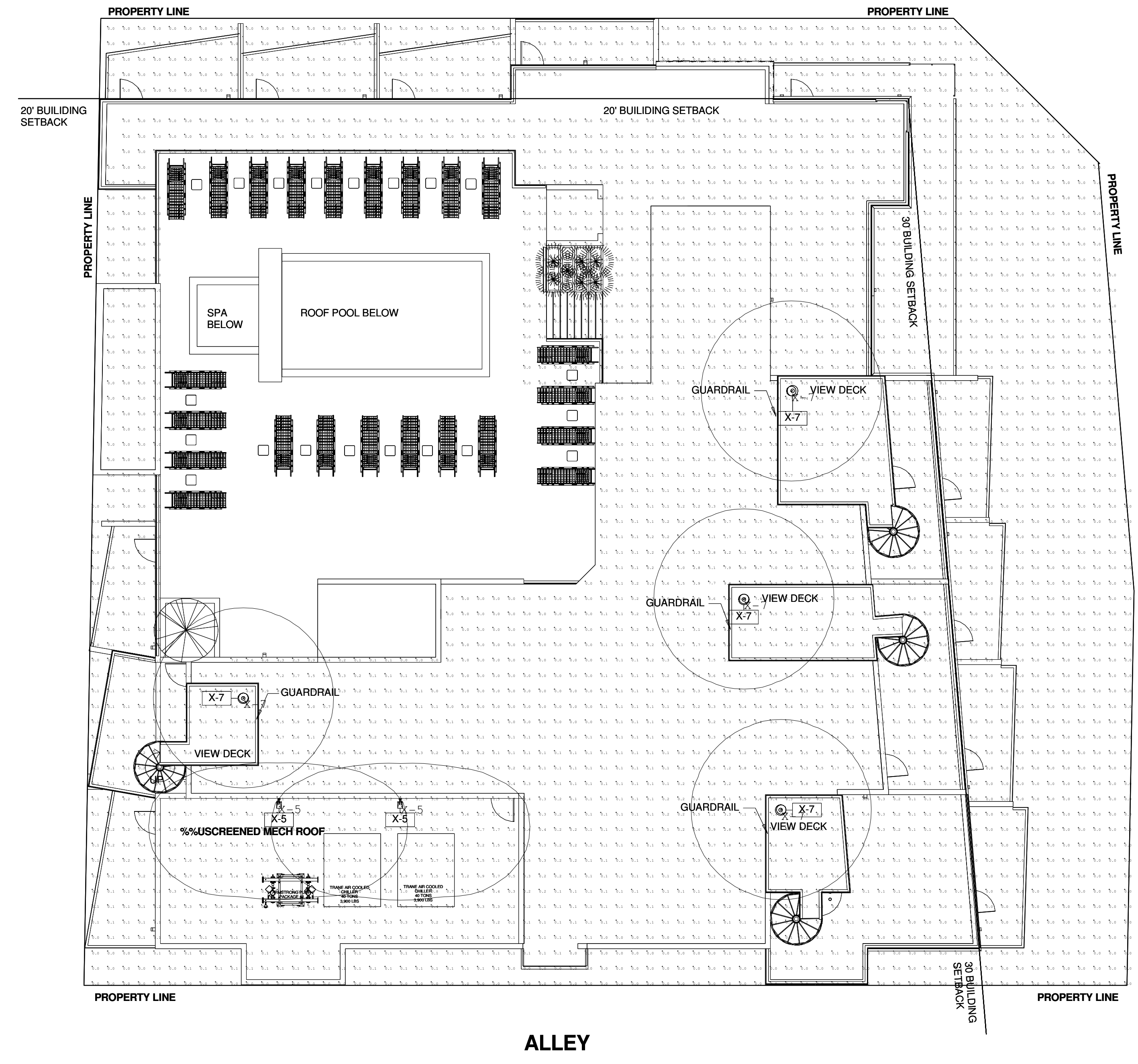
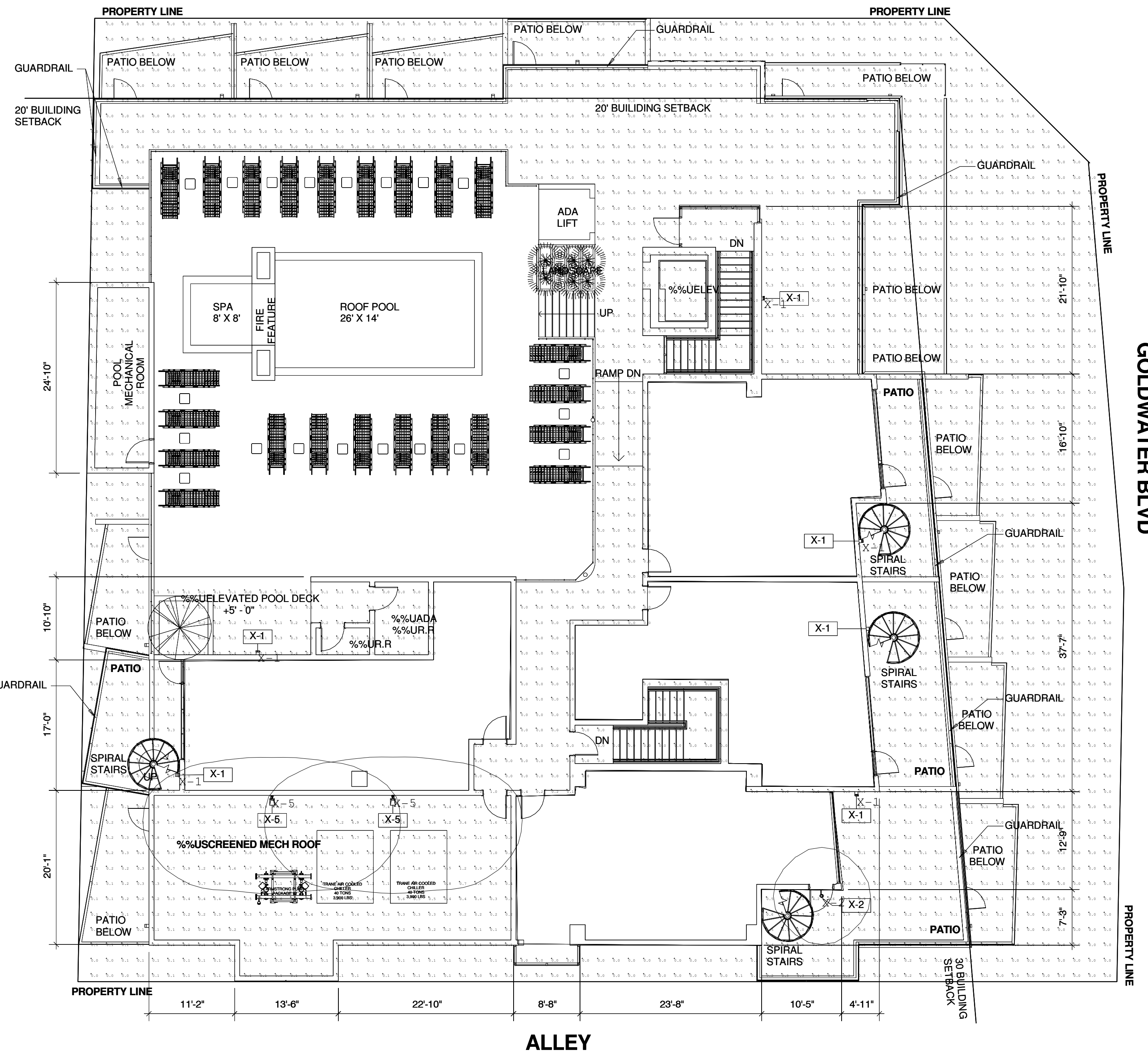

Luminaire Schedule									
Symbol	Qty	Label	Arrangement	LLF	Description	Tag	Lum. Lumens	Lum. Watts	[MANUFAC]
□	5	X-1	SINGLE	1.060	AR-FS-20-LED-3000K	7'	175	9.62	TEKA ILLUMINATION
+	4	X-5	SINGLE	0.900	BV15 (PROFILE_01)_LV40	7.6'	1400	16.8	iGuzzini illuminazione S.p.A
○	4	X-7	SINGLE	0.900	BPM-SD15-LED-x45-A	6'	1913	22.2959	TEKA ILLUMINATION
⊙	1	X-2	SINGLE	0.900	SWM-LED-L16	8.6'	803	19.6071	TEKA ILLUMINATION

Calculation Summary							
Label	CalcType	Units	Avg	Max	Min	Avg/Min	Max/Min
CalcPts_1	Illuminance	Fc	0.23	7.9	0.0	N.A.	N.A.
CalcPts_2	Illuminance	Fc	0.67	10.0	0.0	N.A.	N.A.

EXTERIOR LIGHTING SITE PHOTOMETRIC - ROOF LEVEL

CITY OF SCOTTSDALE
 REZONING/DR DEVELOPMENT SUBMITTAL
 PRE-APP CASE #486 - PA - 2018

WINERY SUITES OF SCOTTSDALE
 6951 / 6961 E 1ST ST. SCOTTSDALE, AZ. 85251
 GOLDWATER BLVD



dpa
 DESIGNERS OF
 PROGRESSIVE
 ARCHITECTURE
 7272 e indian school rd ste 214
 scottsdale, arizona 85251
 telephone 480 941 4222
 www.dpaarchitects.com

REVISION INFORMATION	
#:	Description: Date:

drawn by: YT
 project no.: 18024
 date: 11/13/18

