

1ST STREET

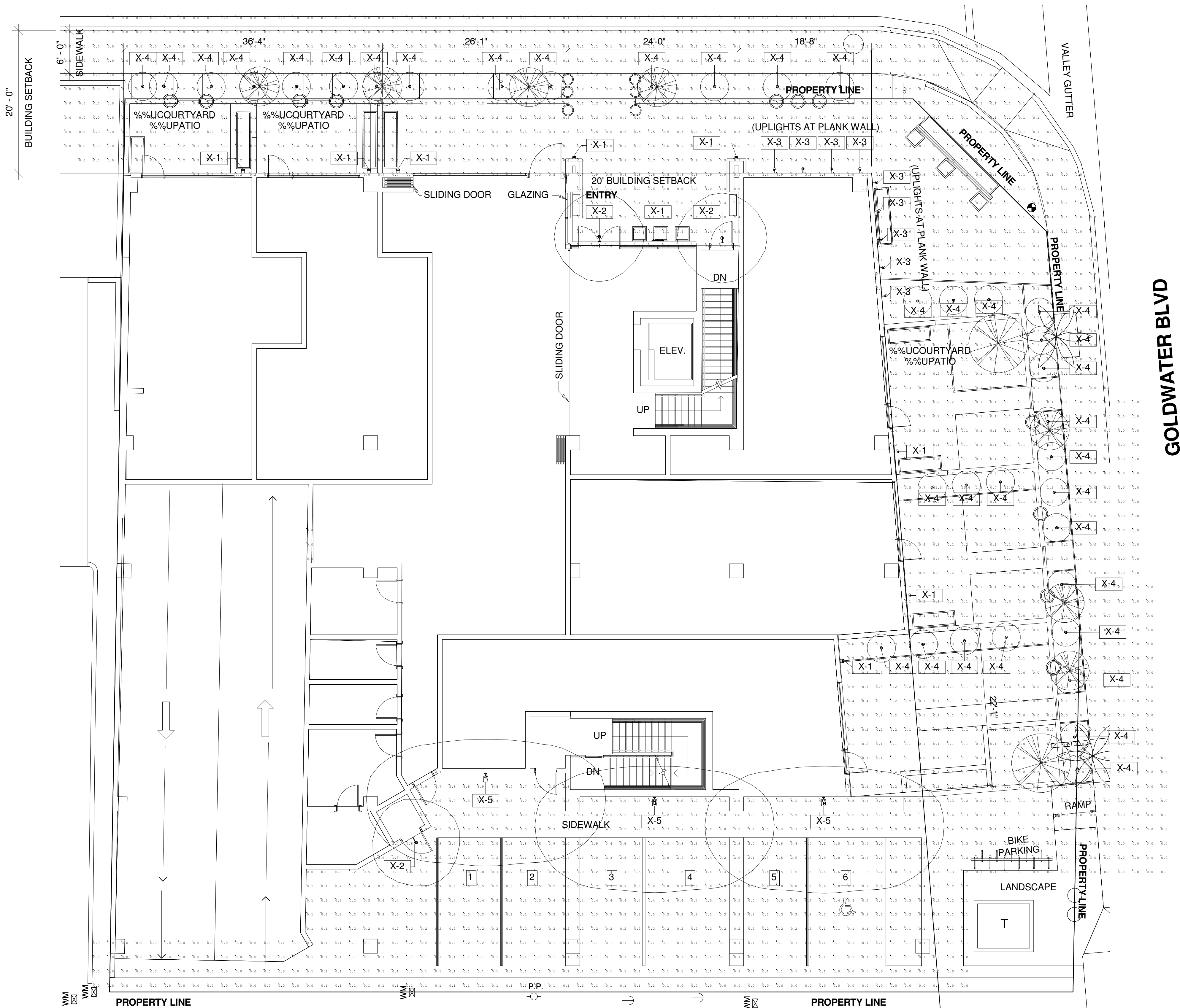

Symbol	Qty	Label	Arrangement	LLF	Description	Tag	Lum. Lumens	Lum. Watts	[MANUFAC]
⊞	9	X-1	SINGLE	1.160	AR-FS-20-LED-3000K	7'	175	9.62	TEKA ILLUMINATION
⊙	3	X-2	SINGLE	0.900	SWM-LED-L16	8.6'	803	19.6071	TEKA ILLUMINATION
⊙	9	X-3	SINGLE	0.900	PNF-12-LED-e65-WHP-12-FL-C	.5'	445	8.27279	TEKA ILLUMINATION
⊙	36	X-4	SINGLE	0.900	HLP-LED-e71-WHP-B	1'	100	0.396	TEKA ILLUMINATION
⊙	3	X-5	SINGLE	0.900	BV15 (PROFILE_01)_LV40	7.6'	1400	16.8	iGuzzini illuminazione S.p.A

Calculation Summary								
Label	CalcType	Units	Avg	Max	Min	Avg/Min	Max/Min	
Floor Plan	Illuminance	Fc	1.02	67.7	0.0	N.A.	N.A.	

EXTERIOR LIGHTING SITE PHOTOMETRIC - STREET LEVEL

CITY OF SCOTTSDALE
 REZONING/DR DEVELOPMENT SUBMITTAL
 PRE-APP CASE #486 - PA - 2018

WINERY SUITES OF SCOTTSDALE
 6951 / 6961 E 1ST ST. SCOTTSDALE, AZ. 85251

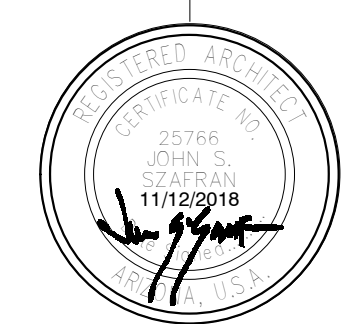

expres 30 June 2019
 dpa
 DESIGNERS OF
 PROGRESSIVE
 ARCHITECTURE
 7272 e indian school rd ste 214
 scottsdale, arizona 85251
 telephone 480 941 4222
 www.dpaarchitects.com

REVISION INFORMATION	
#:	Description: Date:

drawn by: YT
 project no.: 18024
 date: 11/13/18

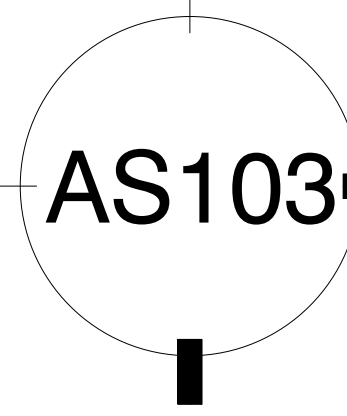

THIS DRAWING IS PROPERTY OF DPA ARCHITECTS, INC. AND IS INTENDED FOR USE ON THIS PROJECT ONLY. THE DRAWING REMAINS THE PROPERTY OF DPA ARCHITECTS, INC. AND SHALL BE RETURNED TO THEM UPON COMPLETION OF THE CONSTRUCTION WORK. PUBLISHED TO THE ARCHITECTURAL WORKS COPYRIGHT ACT OF 1976. ALL DRAWINGS, SPECIFICATIONS, NOTES AND EXHIBITS INCLUDING THE ORIGINAL, REVISIONS, AND SUPPLEMENTAL SHEETS SHALL BE THE PROPERTY OF DPA ARCHITECTS, INC. ANY REPRODUCTION OF THIS DRAWING WITHOUT WRITTEN CONSENT FROM DPA ARCHITECTS, INC. IS STRICTLY PROHIBITED. © 2018 DPA ARCHITECTS, INC.