

**SCOTTSDALE CITY CENTER**

7201 EAST CAMELBACK ROAD  
SCOTTSDALE, AZ 85251

**SMITHGROUP**

455 NORTH THIRD STREET  
SUITE 250  
PHOENIX, AZ 85004  
602.265.2200  
smithgroup.com

**SUSTAINABILITY ENGINEERING GROUP**

CIVIL ENGINEER  
9280 E GELDING DRIVE, SUITE 101  
SCOTTSDALE, AZ 85260  
480.588.7226

**SMITHGROUP**  
LANDSCAPE ARCHITECT  
455 N THIRD STREET, SUITE 250  
PHOENIX, AZ 85004  
602.265.2200

**ced** national accounts  
Design solutions  
LIGHTING DESIGN  
22785 SAVI RANCH PARKWAY  
YORBA LINDA, CA 92887  
562.926.7202

ISSUED FOR	REV	DATE
DEVELOPMENT REVIEW		11/11/2024
DR 1ST REVIEW COMMENTS		01/24/2025
DR 2ND REVIEW COMMENTS		05/16/2025

SEALS AND SIGNATURES

**NOT FOR CONSTRUCTION**

CONCEPTUAL PLANS FOR DRB REVIEW ONLY

SHEET TITLE

**EXTERIOR LIGHTING PHOTOMETRIC ANALYSIS**

PROJECT NUMBER 14165.000

**DRB**  
SHEET NUMBER

**50.1**

TYPE	IMAGE	DESCRIPTION	CATALOG NO.	DIMMING TYPE	LAMP, CCT, LUMEN, OPTICS, CRI	FIXT VOLT	FIXT WATT	MOUNT	REMARKS
A1		TREE STRAP MOUNTED ADJUSTABLE LANDSCAPE ACCENT	CED-SCP-SCC-A1	MLV	INTEGRAL LED, 2700K, 397LM, 23°, 80CRI	12V	7	TREE STRAP	VERIFY FINISH. REQUIRES REMOTE LOW VOLTAGE TRANSFORMER.
A2		ADJUSTABLE INGRADE WELL LANDSCAPE ACCENT	CED-SCP-SCC-A2	MLV	INTEGRAL LED, 2700K, 397LM, 23°, 80CRI	12V	7	INGRADE	VERIFY FINISH. REQUIRES REMOTE LOW VOLTAGE TRANSFORMER.
A2 ALT 1		ADJUSTABLE ABOVE GRADE LANDSCAPE ACCENT	CED-SCP-SCC-AZALT1	MLV	INTEGRAL LED, 2700K, 663LM, 35°, 80CRI	120V	12	PARTIALLY INGRADE	VERIFY FINISH.
A3		ADJUSTABLE INGRADE SPOT	CED-SCP-SCC-A3	0-10V (15%)	INTEGRAL LED, 2700K, 2210LM, 12°, 90CRI	120-277V	33	INGRADE	VERIFY FINISH. REQUIRES REMOTE TRANSFORMER.
B1		BOLLARD	CED-SCP-SCC-B1	0-10V (10%)	INTEGRAL LED, 3000K, 594LM, 360° SYMMETRICAL, 80CRI	120-277V	11.2	FIXING PLATE MOUNTED TO CONCRETE PAD	VERIFY FINISH. PROVIDE CONCRETE PAD FOR MOUNTING.
B1 ALT 1		BOLLARD	CED-SCP-SCC-B1ALT1	0-10V (15%)	INTEGRAL LED, 3000K, 938LM, ACCENT, 90CRI	120-277V	24	FIXING PLATE MOUNTED TO CONCRETE PAD	VERIFY FINISH. PROVIDE CONCRETE PAD FOR MOUNTING.
B1 ALT 2		BOLLARD	CED-SCP-SCC-B1ALT2	0-10V (15%)	INTEGRAL LED, 3000K, 1528LM, ACCENT, 90CRI	120-277V	41.3	FIXING PLATE MOUNTED TO CONCRETE PAD	ALUMINUM GRAY FINISH. PROVIDE CONCRETE PAD FOR MOUNTING.
B1 ALT 3		BOLLARD	CED-SCP-SCC-B1ALT3	0-10V (15%)	INTEGRAL LED, 3000K, 950LM, ACCENT, 90CRI	120-277V	24	FIXING PLATE MOUNTED TO CONCRETE PAD	VERIFY FINISH. PROVIDE CONCRETE PAD FOR MOUNTING.
D1		ROUND RECESSED DEEP REGRESS LED DOWNLIGHT	CED-SCP-SCC-D1	0-10V (1%)	INTEGRAL LED, 2700K, 2120LM, 25°, 80CRI	120-277V	22	RECESSED	VERIFY FINISH. VERIFY EMERGENCY OPTIONS.
L1		ENCAPSULATED FULL DIFFUSION IP69 TOP BEND LINEAR LED	CED-SCP-SCC-L1	ELV/MLV OR 0-10V	INTEGRAL LED, 2700K, 141LM/FT	24V	1.8W/FT	SURFACE	REQUIRES REMOTE LOW VOLTAGE TRANSFORMER.
L2		FLEXIBLE COVE	CED-SCP-SCC-L2	0-10V (1%)	INTEGRAL LED, 2700K, 2400LM, WALL WASH, 90CRI	120-277V	26	SURFACE	REQUIRES REMOTE TRANSFORMER.
M1		4 WINDOW MARKER LIGHT	CED-SCP-SCC-M1	0-10V	INTEGRAL LED, 3000K, 170LM, 80CRI	120-277V	8	SURFACE	REQUIRES REMOTE TRANSFORMER.
P1		15'-0" ADJUSTABLE 4 HEAD POLE	CED-SCP-SCC-P1	ELV	INTEGRAL LED, 3000K, 950LM, NARROW FLOOD, 90CRI	120-277V	64	15' POLE	VERIFY FINISH. PROVIDE CONCRETE PAD FOR MOUNTING.
P2		15'-0" PARKING AREA POLE	CED-SCP-SCC-P2	0-10V (15%)	INTEGRAL LED, 3000K, 3865LM, TYPE 2, 70CRI	120-277V	46.5	15' POLE	GRAY FINISH. PROVIDE CONCRETE PAD FOR MOUNTING.
P2 ALT 1		PARKING AREA POLE	CED-SCP-SCC-P2ALT1	0-10V (10%)	INTEGRAL LED, 3000K, 4300LM, TYPE 2, 70CRI	120-277V	33	15' POLE	GRAY FINISH. PROVIDE CONCRETE PAD FOR MOUNTING.
S1		STEP LIGHT	CED-SCP-SCC-S1	ELV	INTEGRAL LED, 3000K, 401LM, DOWNWARD ASYMMETRIC, 80CRI	120-277V	10	RECESSED	CONCRETE FINISH. REQUIRES REMOTE LOW VOLTAGE TRANSFORMER.
W1		WALL PACK	CED-SCP-SCC-W1	0-10V (10%)	INTEGRAL LED, 3000K, 887LM, DOWN, 90CRI	120-277V	24	SURFACE	MOUNTING HEIGHT 10'-0" AFG. VERIFY FINISH. VERIFY JUNCTION BOX STYLE.
W1 ALT 1		WALL PACK	CED-SCP-SCC-W1ALT1	0-10V	INTEGRAL LED, 3000K, 1890LM, Type IV, 80CRI	120-277V	24	SURFACE	VERIFY FINISH.
W1 ALT 2		WALL PACK	CED-SCP-SCC-W1ALT2	0-10V	INTEGRAL LED, 3000K, 985LM, Type II, 80CRI	120-277V	13	SURFACE	VERIFY FINISH.

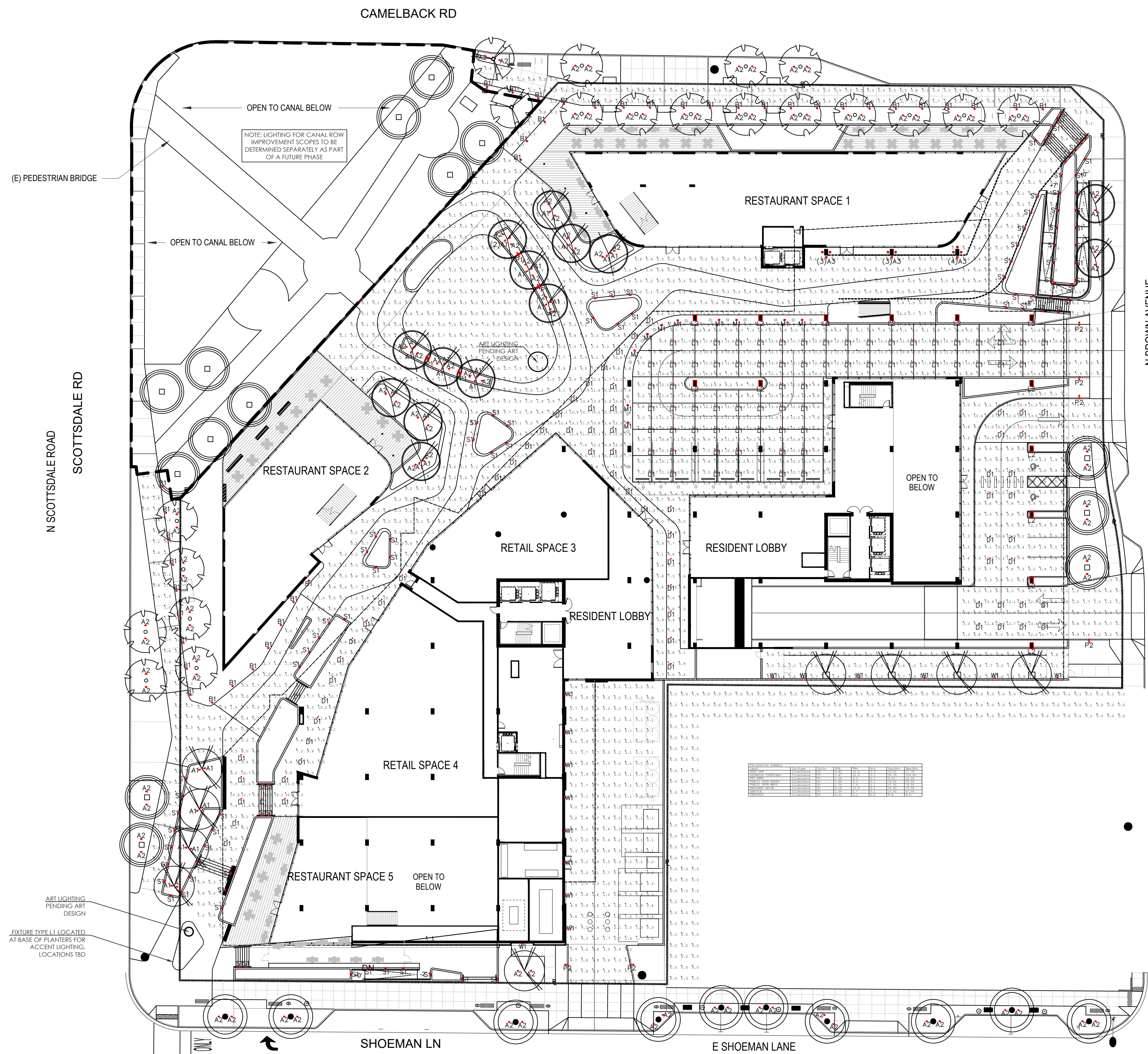

**1 EXTERIOR LIGHTING PHOTOMETRIC ANALYSIS**  
1" = 30'-0"