

This drawing is an instrument of service and the property of Floor Associates and shall remain their property. The use of this drawing shall be restricted to the original site for which it was prepared and publication thereof is expressly limited to such use. Reuse, reproduction or publication by any method, in whole or in part, is prohibited without written consent.

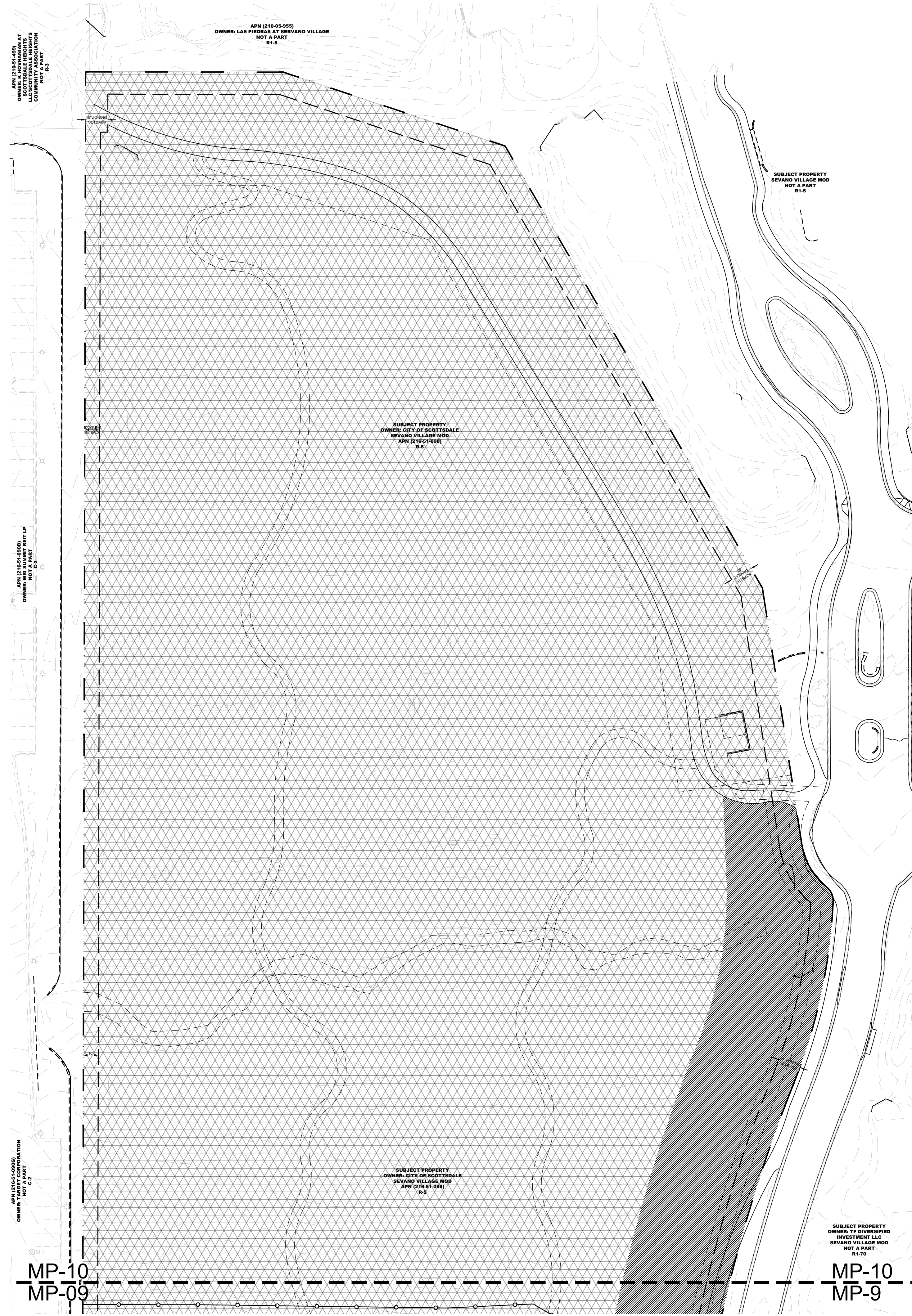

SITE DATA

PROJECT NAME: ASHLER HILLS PARK
 PROJECT ADDRESS: Ashler Hills Dr. & N. 74th Way
 PARCEL #: 216-51-098
 SUBDIVISION: SEVANO VILLAGE MOD
 S/I/R: 14 5N 4E
 LAT/LONG: 33.7799, -111.9209
 Q# 56-45
 PARCEL ZONING: R-5 ESL
 ADJACENT ZONING: N: R1-5 / E: R1-70 / S: R1-130 / W: C-2, R1-43
 GROSS LOT AREA: 653,228 SF | 15.00 Acres
 NET LOT AREA: 391,231 SF | 8.98 Acres
 GROSS FLOOR AREA: 960 SF (Restrooms / Maintenance)

VEHICULAR PARKING REQUIREMENTS: lot size / type: 15 acres / park
 required stalls: 45 (3 spaces per 1 acre)
 proposed stalls: 70

ACCESSIBLE PARKING REQUIREMENTS: required stalls: 3 (4% of 45 total req'd. stalls)
 proposed stalls: 3

BIKE PARKING REQUIREMENTS: required spaces: 5 (1 per every 10 req'd. parking stalls)
 proposed spaces: 24

FIRE LANE REQUIREMENTS: required radius for R2: 49' for commercial and multi-family residential uses
 proposed radius: 52' diameter
 required fire lane width: minimum width 24'-0"
 proposed: 24'-0" - 28'-0"

OPEN SPACE DATA

NET LOT AREA: 391,231 SF | 8.98 ACRES
 MIN. OPEN SPACE: 0.24 X 8.98 = 2.16 ACRES
 PROVIDED OPEN SPACE: 552,525 SF | 12.68 ACRES
 MIN. FRONTAGE OPEN SPACE: 0.5 X 2.16 = 1.08 ACRES
 PROVIDED FRONTAGE OPEN SPACE: 76,322 SF | 1.75 ACRES

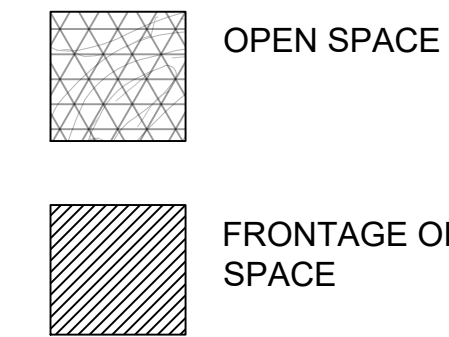

FLOOR associates

1425 N. First Street
 Second Floor
 Phoenix, AZ 85004
 602.462.1425 P
 602.462.1427 F

OWNER: CITY OF SCOTTSDALE
 CONTACT: BRAD WALLDORF, PE
 PHONE: 480.312.7790

CONSULTANTS: CONSULTANTS FIELD
 CONSULTANT ADDRESS 1

CERTIFICATION

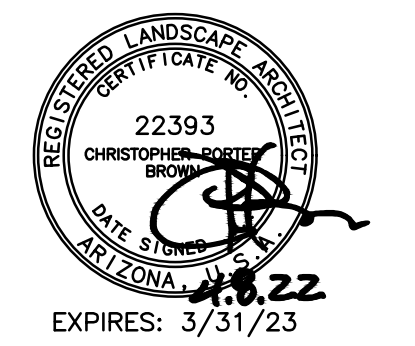

ASHLER HILLS PARK
 ASHLER HILLS DRIVE & NORTH 74TH WAY
 SCOTTSDALE, ARIZONA

PROJECT NO.: 20027
 DRAWN BY: FA TEAM
 CHECKED BY: CB

SUBMITTAL NO.	DATE	ISSUED FOR
1	11.05.21	MUNICIPAL USE MASTER SITE PLAN
2	04.08.22	MUNICIPAL USE MASTER SITE PLAN

ISSUED FOR MUNICIPAL USE MASTER SITE PLAN
 PARTIAL OPEN SPACE PLAN

MP-10

SHEET 02 OF 02

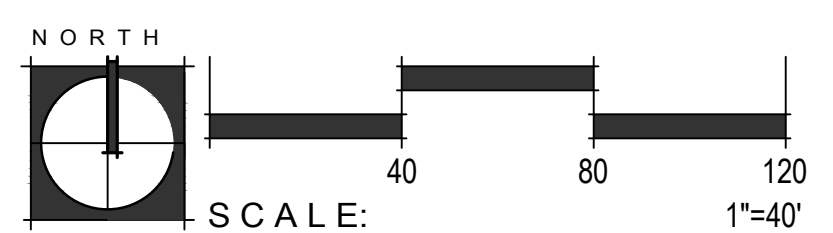

PROJECT #: 960 PA: 2020 KEY CODE: 22N53